

FRONT YARD PARKING APPEAL - 14 HUMWOOD DRIVE

APPENDIX 'A'

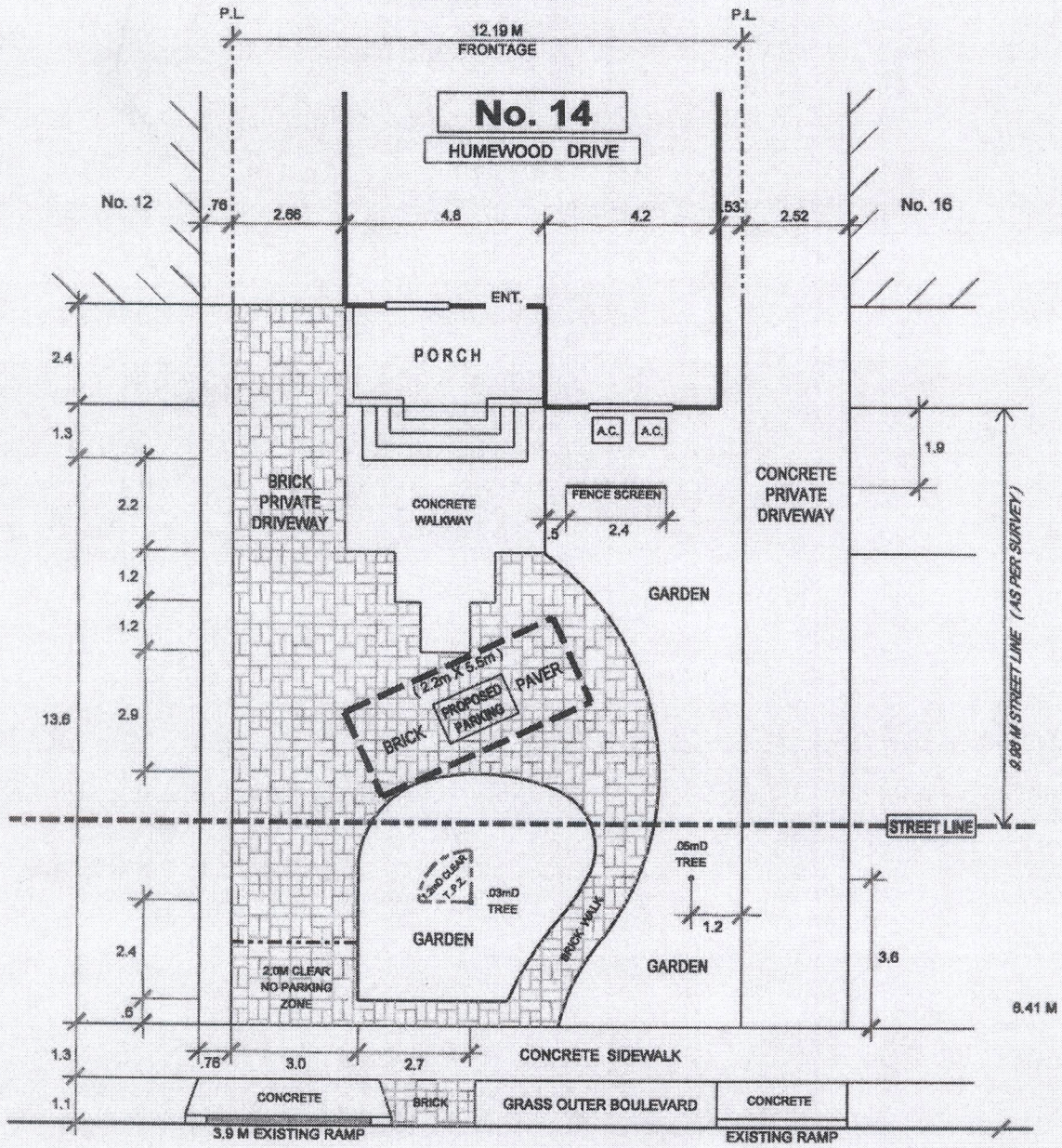

HUMWOOD DRIVE

SOFT LANDSCAPING NOT MET ON PRIVATE PROPERTY



TRANSPORTATION SERVICES DIVISION  
TORONTO AND EAST YORK DISTRICT  
RIGHT OF WAY MANAGEMENT - OFF STREET PARKING



NORTH

FRONT YARD PARKING CHAPTER 918 F.Y.P. - 93250

TOTAL PARKING AREA ON STREET ALLOWANCE	PRIVATE PROPERTY			STREET ALLOWANCE		
	AREA M <sup>2</sup>	%	CODE	AREA M <sup>2</sup>	%	CODE
TOTAL AREA	128.3	100		59.6	100	
LANDSCAPED OPEN SPACE	82.1	64	50% min.	44.7	75	50% min.
PAVED AREA	46.2	36	50% max.	14.9	25	50% max.
SOFT LANDSCAPING	38.9	47	75% min.	36.4	81	75% min.

REVISIONS	
Date	By
JUNE 15 '11	R.A.M.

DRAWN BY: R. MUNSON

DATE: MAY 05 '11

SCALE: 1:100

# Front Yard Parking Appeal

14 Humewood Drive

APPENDIX "B"



**Licensed Locations  
Number of Parking Spaces**

Loc.	FYP	Loc.	FYP	Loc.	CBP
3	1	26	1		
5	1				
11	1				
13	1				
15	1				
17	2				

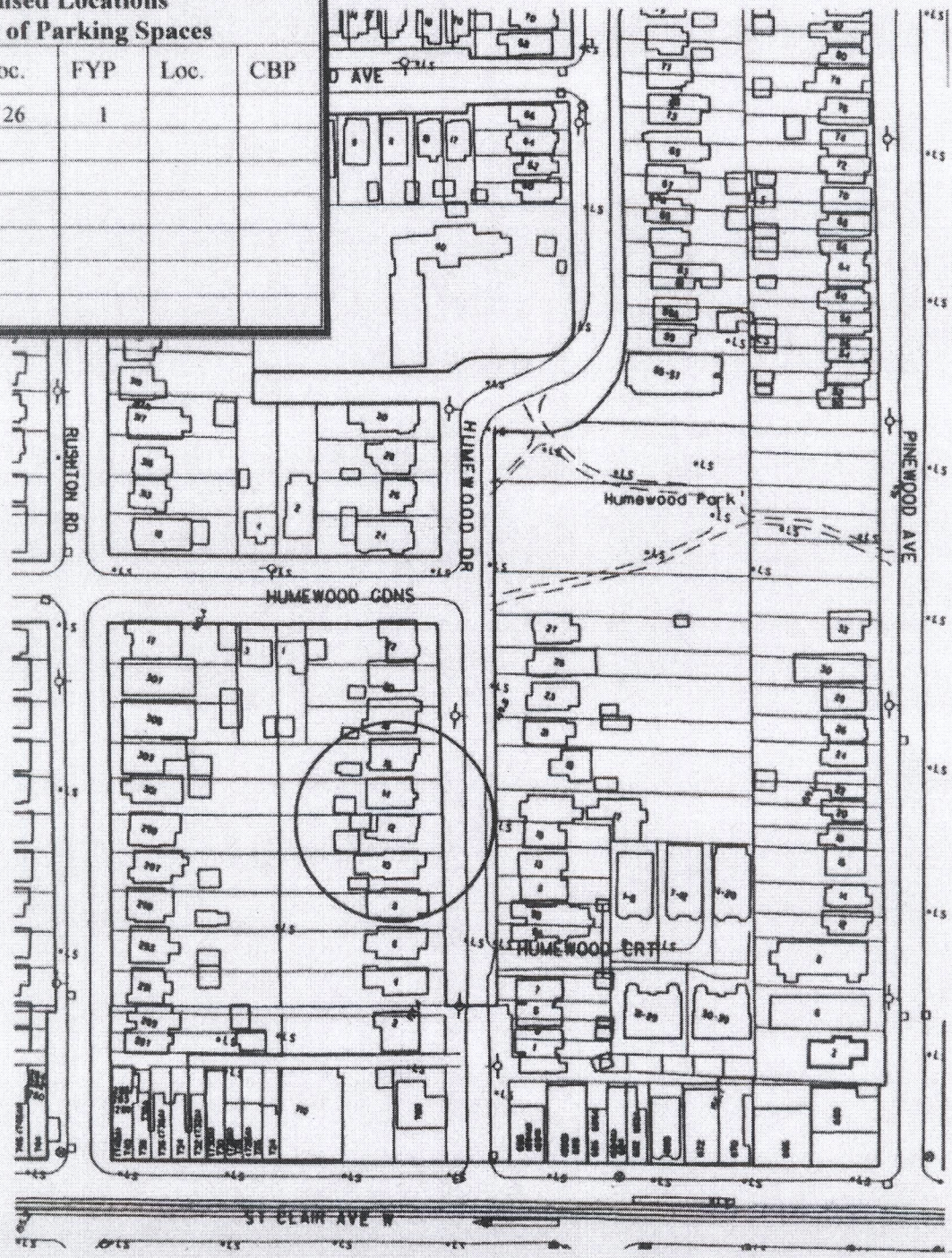

**Front Yard Parking Appeal – 14 Humewood Drive**

**APPENDIX 'C'**



14 Humewood Drive - November 7, 2011

FRONT YARD PARKING APPEAL - 14 HUMEWOOD DRIVE

APPENDIX 'D'

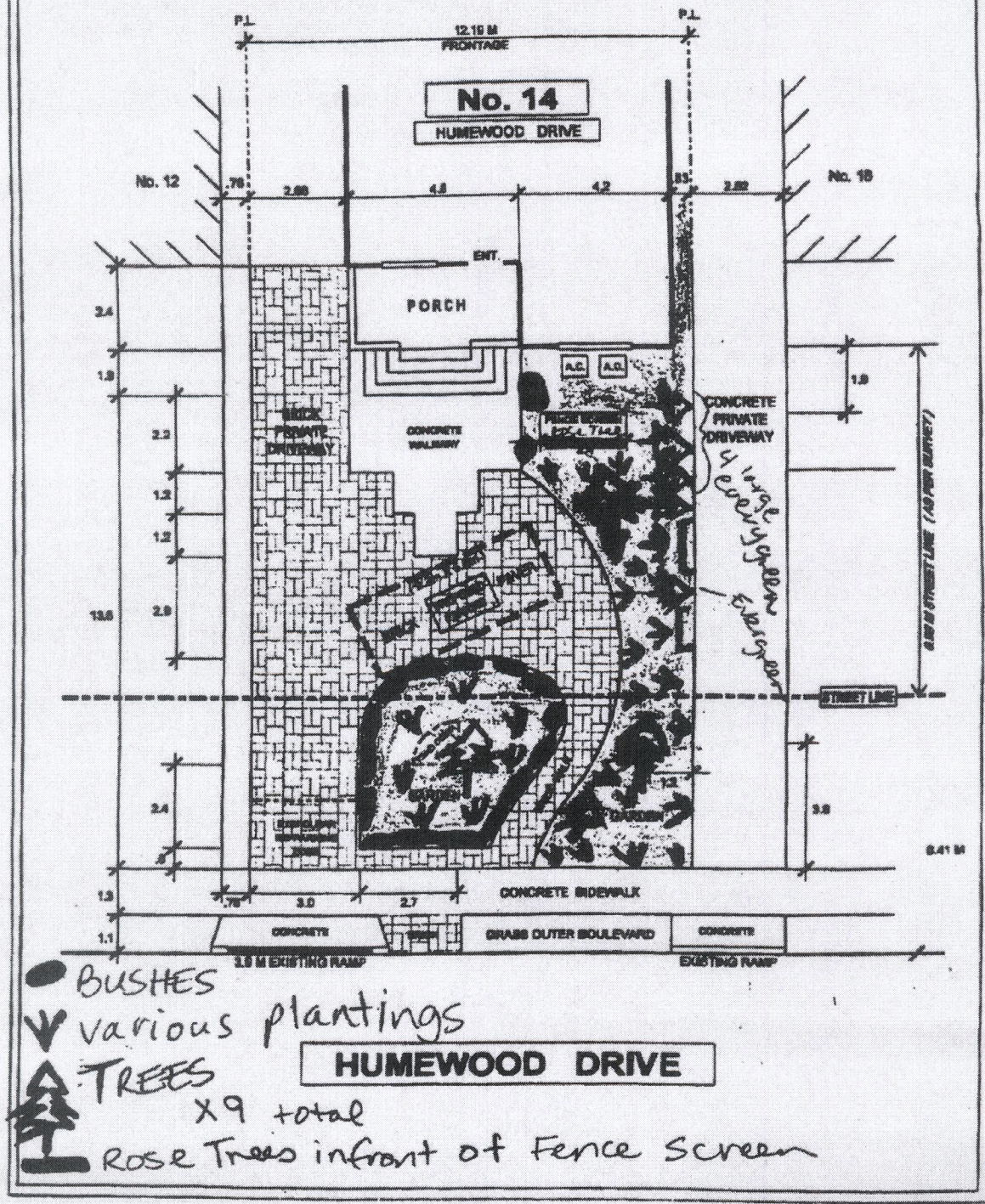

- BUSHES
- ▼ various plantings
- ▲ TREES
- x 9 total
- Rose Trees in front of Fence Screen