

NOTE:
 INFORMATION ON THIS PLAN IS BASED
 ON OFFICE RECORDS AND IS SUBJECT
 TO FIELD VERIFICATION.

MACPHERSON AVE AVENUE RD - YONGE ST EXISTING PARKING REGULATIONS

LEGEND:

- EXISTING NO PARKING ANYTIME
- EXISTING 1HR PARKING 10AM - 6PM, 16TH TO THE END OF EACH MONTH, APRIL 1 TO NOV 30 AND EXISTING PERMIT PARKING, 12:01AM - 10AM
- EXISTING NO PARKING 16TH TO THE END OF EACH MONTH, APRIL 1 - NOV 30
- EXISTING NO PARKING DEC 1 - MAR 31, 1ST TO THE 15TH OF EACH MONTH, APRIL 1 - NOV 30
- EXISTING 1HR PARKING 10AM - 6PM, DEC 1 - MAR 31, 1ST - 15TH OF EACH MONTH, APRIL 1 TO NOV 30 AND EXISTING PERMIT PARKING, 12:01AM - 10AM



A MATCH LINE A

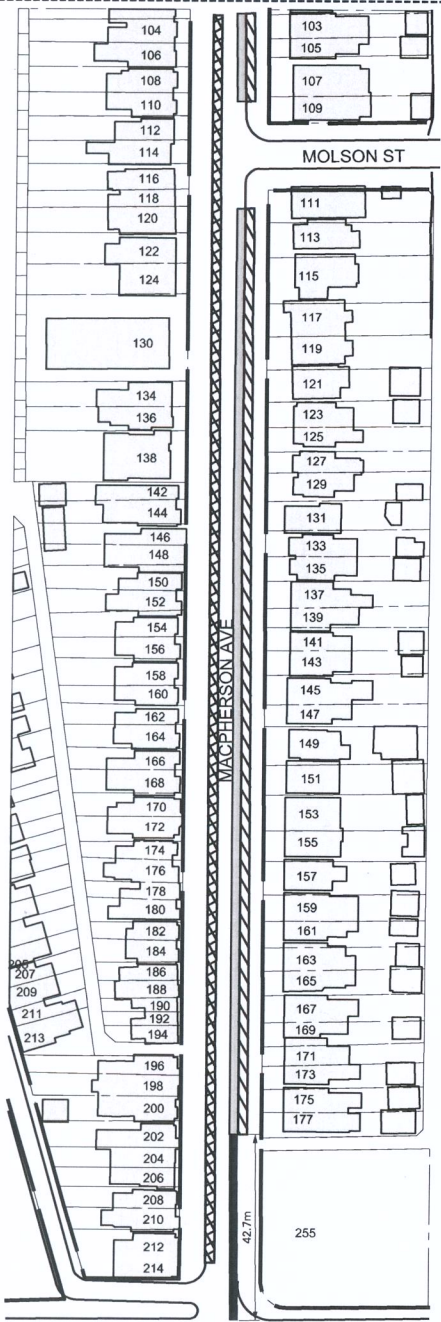

AVENUE RD

MOLSON ST

MACPHERSON AVE

42.7m

255

YONGE ST

MACPHERSON AVE

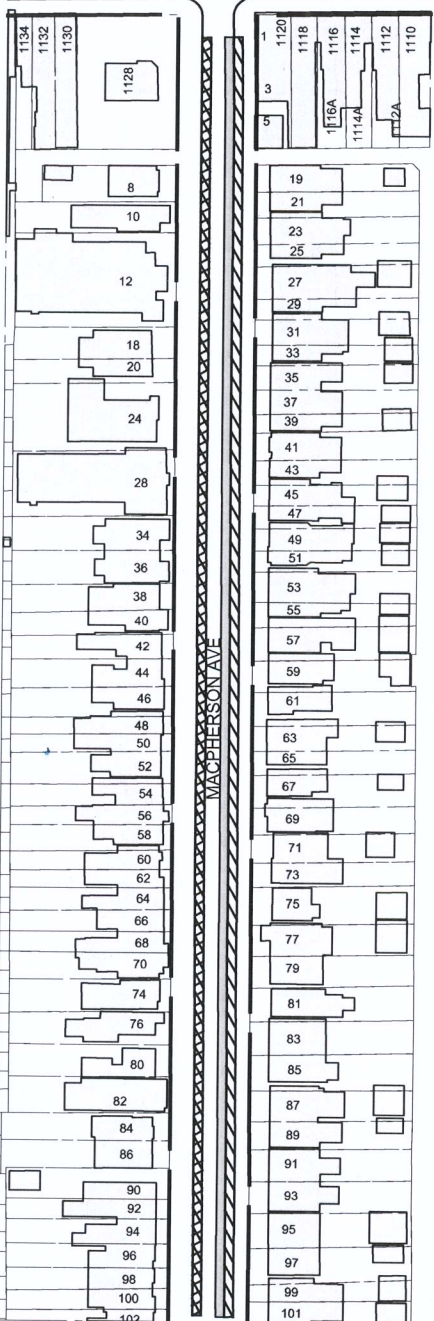
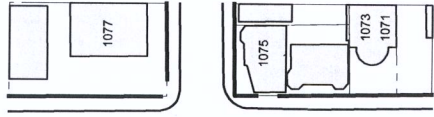

A MATCH LINE A

NOTE:
INFORMATION ON THIS PLAN IS BASED
ON OFFICE RECORDS AND IS SUBJECT
TO FIELD VERIFICATION

LEGEND:

EXISTING NO PARKING ANYTIME

PROPOSED 1HR PARKING 10AM - 6PM

PROPOSED NO PARKING ANYTIME

PROPOSED PERMIT PARKING, 12:01AM - 10AM

MACPHERSON AVE AVENUE RD - YONGE ST PROPOSED PARKING REGULATIONS