

Attachment 1

The Holocaust Memorial Earl Bales Park Revitalization Plan

The Canadian Society For Yad Vashem

Presented June 5th, 2013
At Earl Bales Park Community Centre
4169 Bathurst St, Toronto, M3H 3P7



Remembering the past, Shaping the future®

About Us

The Canadian Society for Yad Vashem is one of the largest and most prominent societies among Yad Vashem's 28 representative bodies worldwide.

The Society supports Yad Vashem's initiatives and implements its important vision across Canada. Through its educational and commemorative activities, the Society carries out Yad Vashem's mission of ensuring that the Holocaust and its lessons are forever engraved in the memory of humankind.

About Yad Vashem

Yad Vashem, The Holocaust Martyrs' and Heroes' Remembrance Authority, in Jerusalem, is the universal guardian and imparter of the Shoah's (Holocaust's) legacy and the protector of human values. Visited by more than one million people annually, Yad Vashem is internationally recognized as being at the forefront of Holocaust commemoration, education, documentation, and research. www.yadvashem.org.

About the Holocaust

The Holocaust was the murder of six million Jews, among them 1.5 million children, by Nazi Germany and its collaborators. While the Nazi persecution of the Jews began in 1933, the mass murder was committed over a period of four and a half years during World War II.



Remembering the past, Shaping the future®

About the Canadian Society for Yad Vashem Holocaust Memorial Site, Earl Bales Park



The Canadian Society for Yad Vashem Holocaust Memorial Site represents the Canadian community's eternal commitment to never forget the lessons and legacy of the Holocaust.

The Canadian Society for Yad Vashem Holocaust Memorial Site is situated in Earl Bales Park, a 15-hectare (36-acre) tract of parkland in North York, Toronto. The Holocaust Memorial Site was constructed by the founders of the Canadian Society as a permanent reminder not only of the Holocaust's devastating toll on humanity, but of the triumph of the spirit over sorrow and calamity.

The Canadian Society for Yad Vashem Holocaust Memorial Flame at Earl Bales Park, Toronto, was unveiled in 1991, with the Wall of Remembrance following in 2001. The eight marble walls rimming the site are engraved with the story of the Holocaust, the names of Canadians' family members who perished in the Holocaust, and Holocaust Survivors who rebuilt their lives in Canada and have since passed on.



Remembering the past, Shaping the future®

Revitalizing the Canadian Society for Yad Vashem Holocaust Memorial Site

R E M E M B E R . R E F L E C T . R E C O M M I T .

To learn more about the campaign, please visit our website at www.yadvashem.ca.

Over the last several years, Ontarians have expressed their desire to learn more about the Holocaust and to memorialize their loved ones who perished in the Shoah and/or survived and have since passed on.

With that in mind, the Canadian Society for Yad Vashem has embarked on a charitable campaign called “Remember. Reflect. Recommit.” The campaign is devoted to raising support for the revitalization plan at the Holocaust Memorial Site..

The campaign provides donors the opportunity to be directly involved in ensuring that the story of the Holocaust and its universal lessons are conveyed today and in the future with honour, dignity, and respect.



Remembering the past, Shaping the future®

The Holocaust Memorial Revitalization Plan

The revitalization will make one of Toronto's most popular parks more visually appealing and provide ample opportunities for reflection, education, and healing.

The revitalized site will provide Holocaust Survivors and their families the opportunity to commemorate loved ones, while offering a place where they are comforted and their experiences are validated. Youth, the leaders of tomorrow, will be provided with a means for gaining a better understanding of the Holocaust and the importance of being Torch Bearers of Holocaust Remembrance for the future.

The plan for the revitalization of the Holocaust Memorial Site includes the following:

- Improvements to existing gardens, sidewalks, and pathways
- Entrance pillars and garden pillars
- A memorial in the centre square: The Spirit of Bravery Square
- The enhancement of the Memorial Walls with dedications
- Small garden plaques
- A pergola and menorah



The Revitalization Plan envisions structures, existing and new, and landscaped gardens serving as a backdrop to meaningful events, programs, and initiatives that will bring people of all faiths to the site to learn about the Holocaust and its universal lessons.

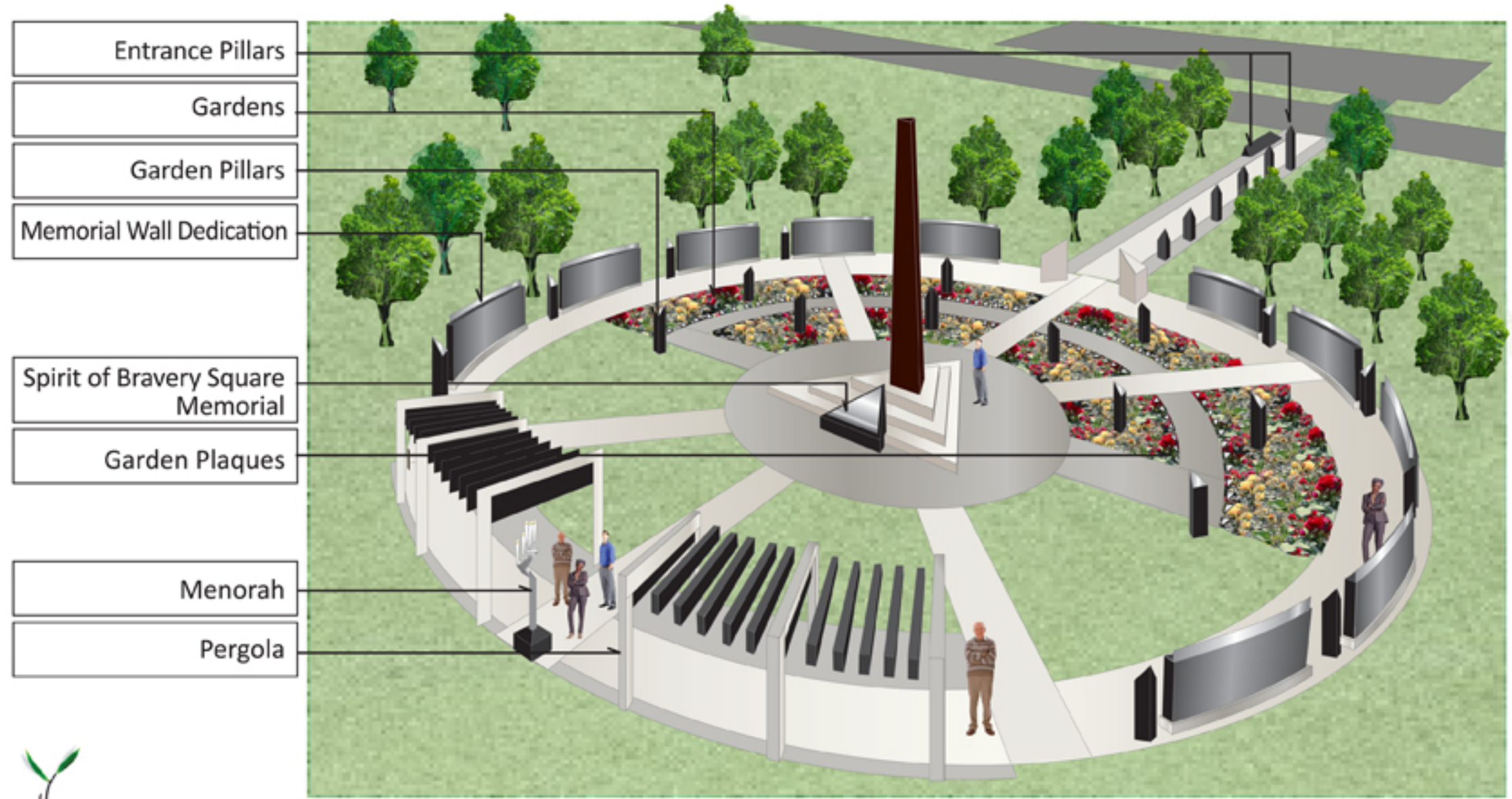

Remembering the past, Shaping the future®

Entrance Pillars

Sidewalk and Path



BEFORE



AFTER

Gate of Remembrance, Reflection, and Recommitment



Remembering the past, Shaping the future®

Spirit of Bravery
Square Memorial



BEFORE



AFTER
Spirit of Bravery Square



Remembering the past, Shaping the future®

Garden Pillars

Memorial Wall Dedication



BEFORE



AFTER

In garden: pillar called "Tribute Garden"
Foreground memorial wall with dedication: The Ed and Fran Sonshine Children's Memorial Wall
Background memorial wall with dedication: The True Heroes' Wall



Remembering the past, Shaping the future®



BEFORE



AFTER
Pillars of Recollection



Conclusion

The mission of the Revitalization Plan is to improve the memorial site's current condition, making one of Toronto's most popular parks more visually appealing, as well as provide ample opportunities for reflection, education, and healing.

The Revitalization Plan will provide many memorial and dedication opportunities.

The Canadian Society for Yad Vashem will be funding the entire project through the Remember. Reflect. Recommit. donor campaign.

The Canadian Society for Yad Vashem is committed to working with Parks and Recreation to help achieve a sustainable and maintainable garden environment.

The Canadian Society for Yad Vashem is working to bring a sense of pride to the community's landmark destination The Holocaust Memorial Site in Earl Bales Park.