

SECTION "A"-"A"

EGLINTON AVENUE WEST

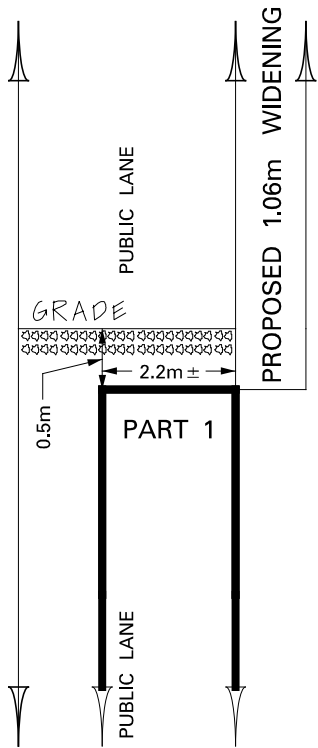

NOT TO SCALE

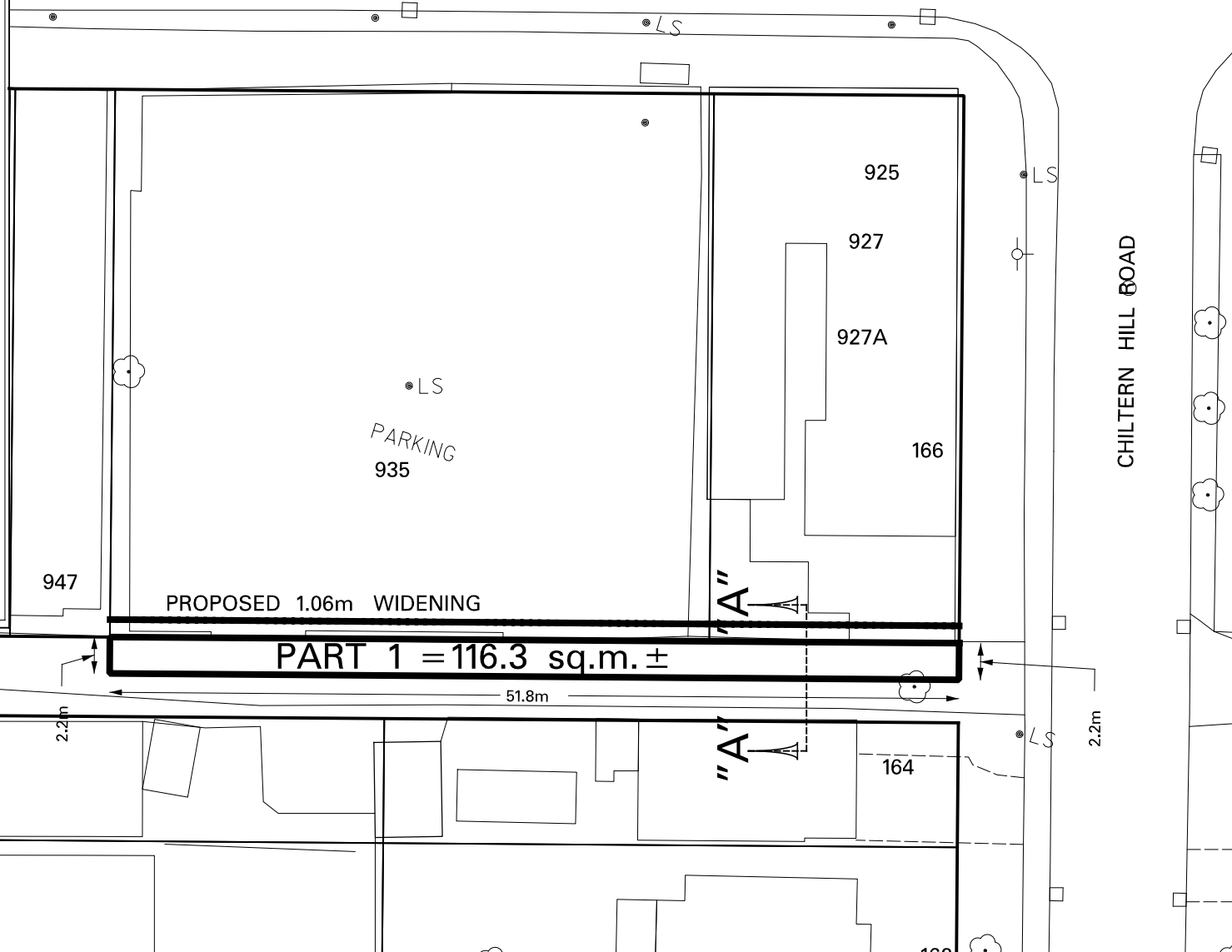

PART 1 = 116.3 sq.m. ±

PROPOSED 1.06m WIDENING

PUBLIC LANE

51.8m

164

162



TECHNICAL SERVICES DIVISION  
SURVEY & MAPPING SERVICES

NOTE:

THIS SKETCH HAS BEEN  
COMPILED FROM OFFICE  
RECORDS. MEASUREMENTS  
SHOWN ARE APPROXIMATE

NOT TO SCALE

WARD 21 - ST. PAUL'S  
DATE: MAY 29, 2012

PROPERTY INFORMATION SHEET

CITY OWNED LAND  
SKETCH SHOWING A PORTION OF THE PUBLIC LANE ABUTTING THE REAR  
OF NOS. 927 AND 935 EGLINTON AVENUE WEST

PREPARED BY: DWAYNE PITT

CHECKED BY: JOHN HOUSE

SKETCH No. PS-2012-054