



**TORONTO** City Planning  
**Schedule '55'**

**1530 & 1540 Victoria Park Avenue;  
 1770-1790 Eglinton Avenue East**

Approved by: A. Theobald

City of Toronto By-Law 569-2013  
 Not to Scale  
 5/6/2014

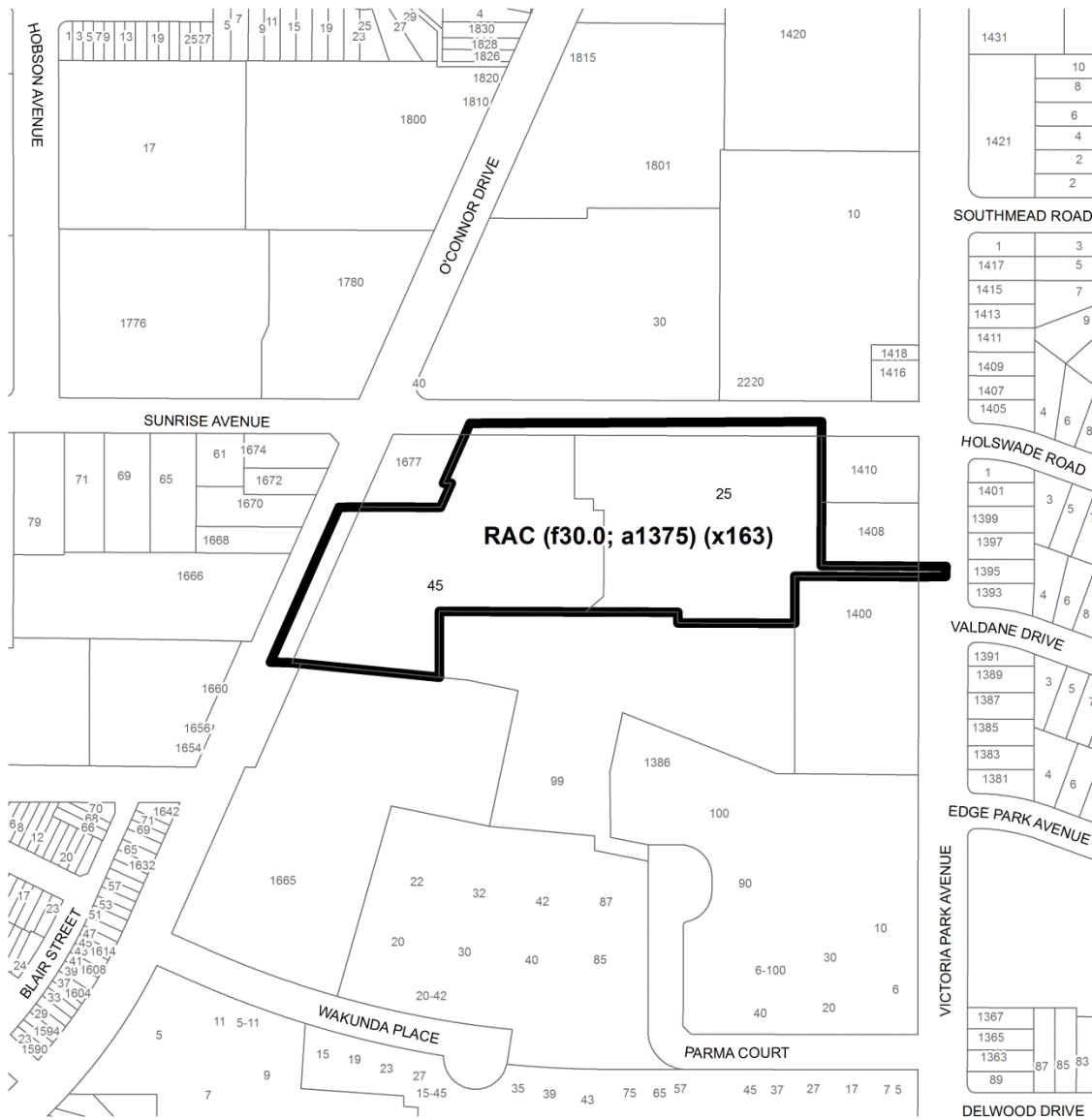

**Toronto** City Planning  
Schedule '56'

**25 & 45 Sunrise Avenue**

Approved by: A. Theobald

City of Toronto By-Law 569-2013  
Not to Scale  
5/6/2014



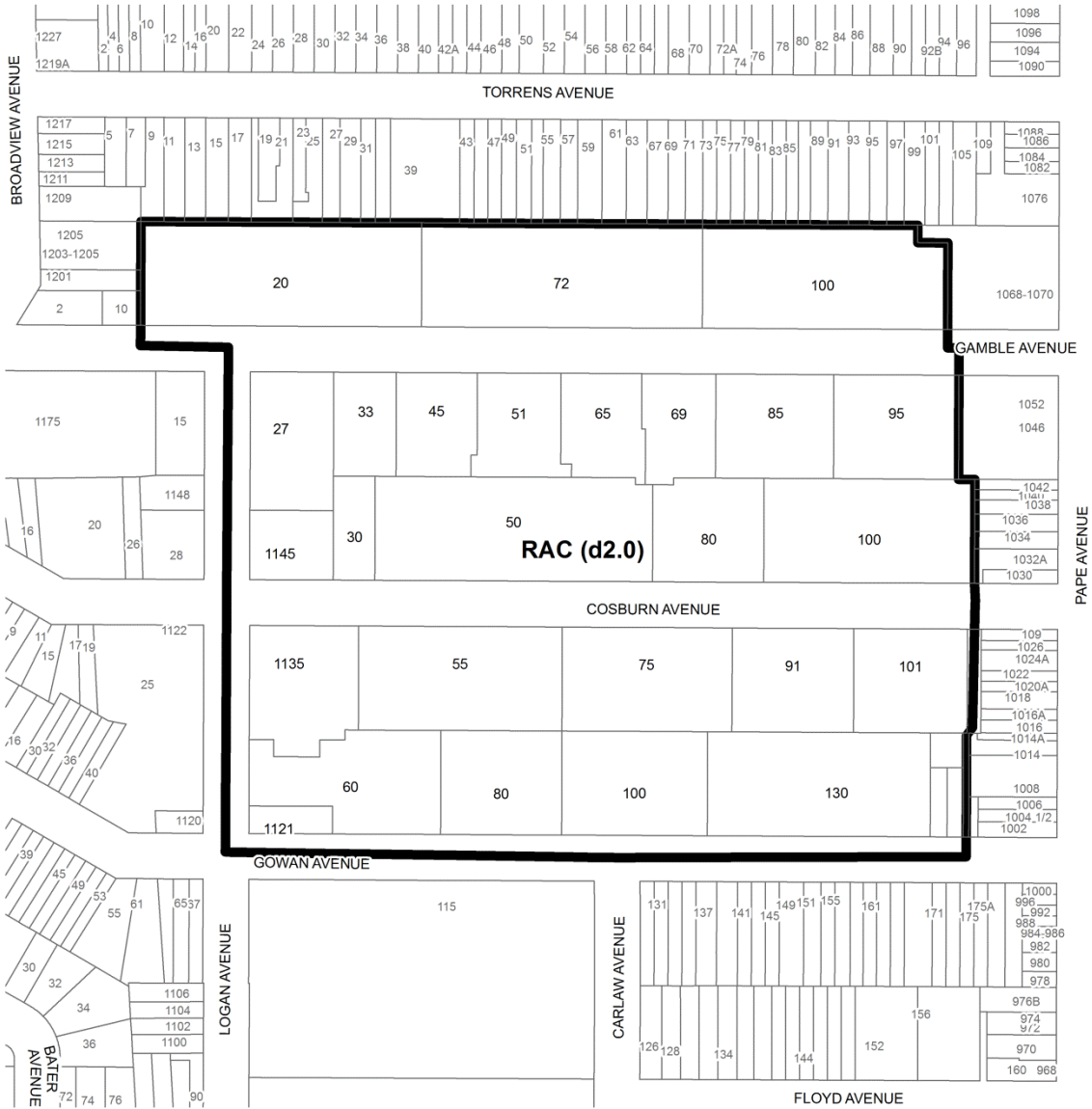

**Toronto** City Planning  
Schedule '58'

## Cosburn Avenue and Logan Avenue Area

Approved by: A. Theobald

City of Toronto By-Law 569-2013  
Not to Scale  
5/6/2014

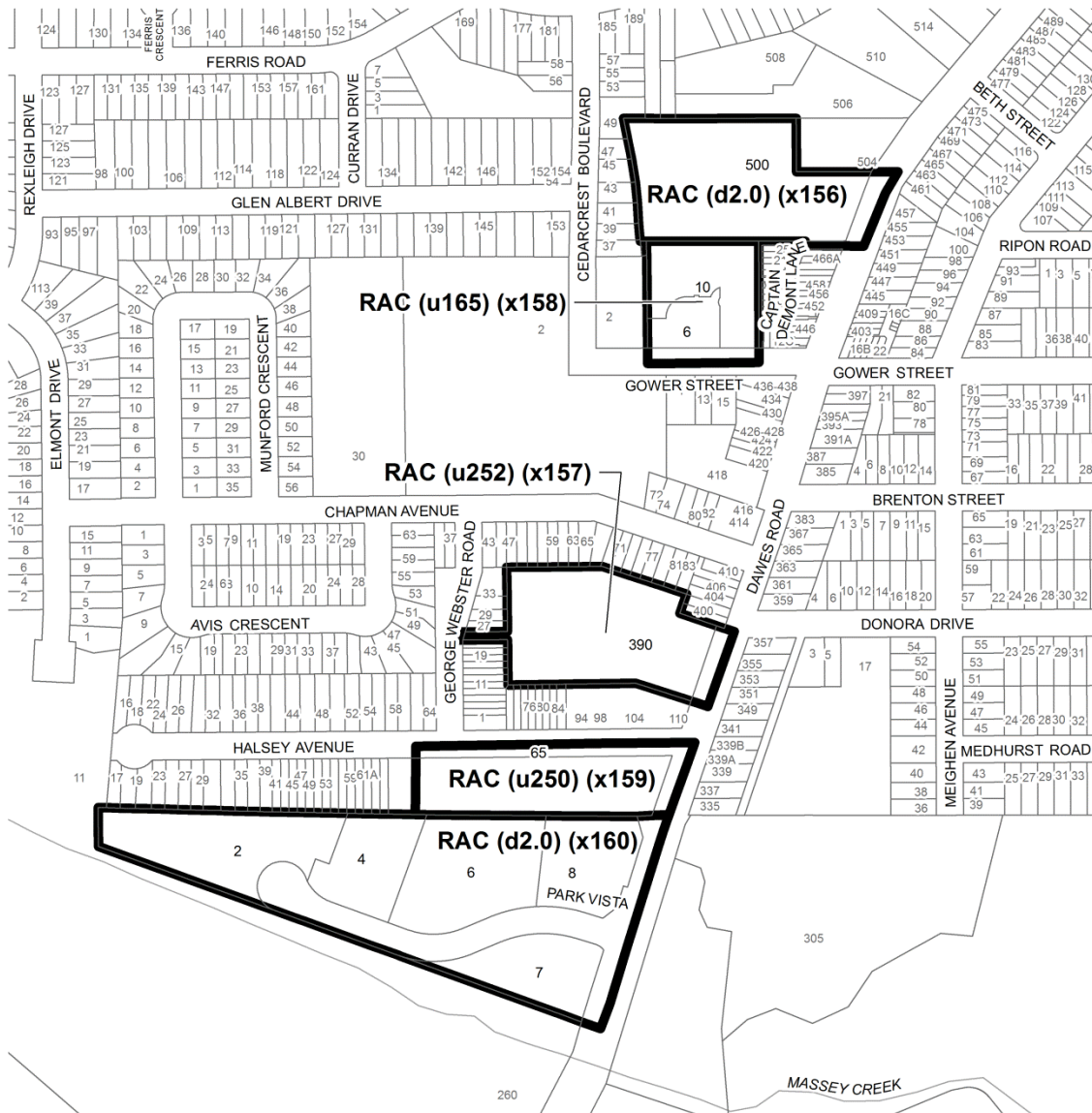

**Schedule '59'**

## Dawes Road and Chapman Avenue Area

Approved by: A. Theobald

City of Toronto By-Law 569-2013  
Not to Scale  
5/6/2014



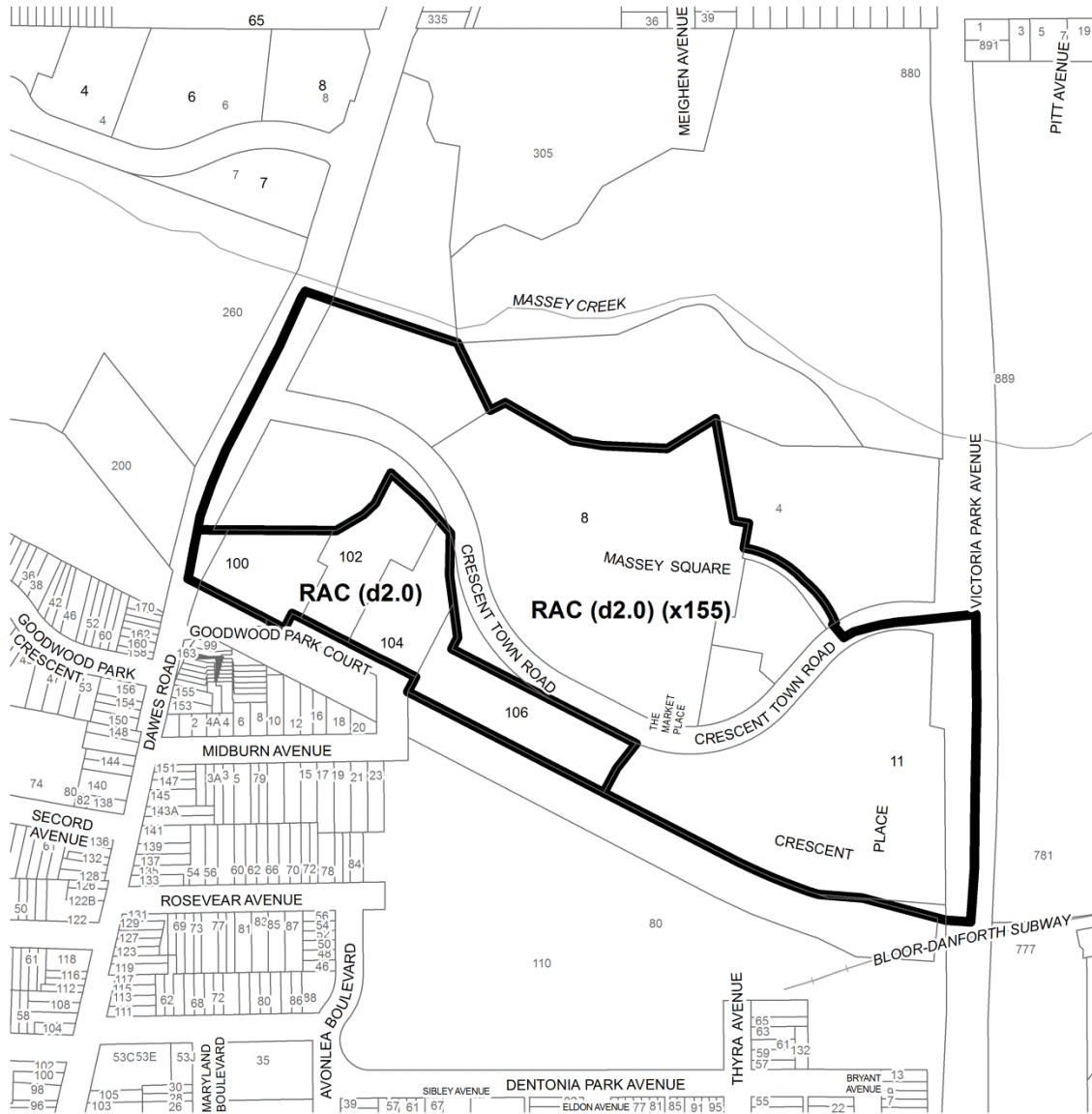

**Toronto** City Planning  
Schedule '60'

## Crescent Town Road Area

Approved by: A. Theobald

City of Toronto By-Law 569-2013  
Not to Scale  
5/6/2014



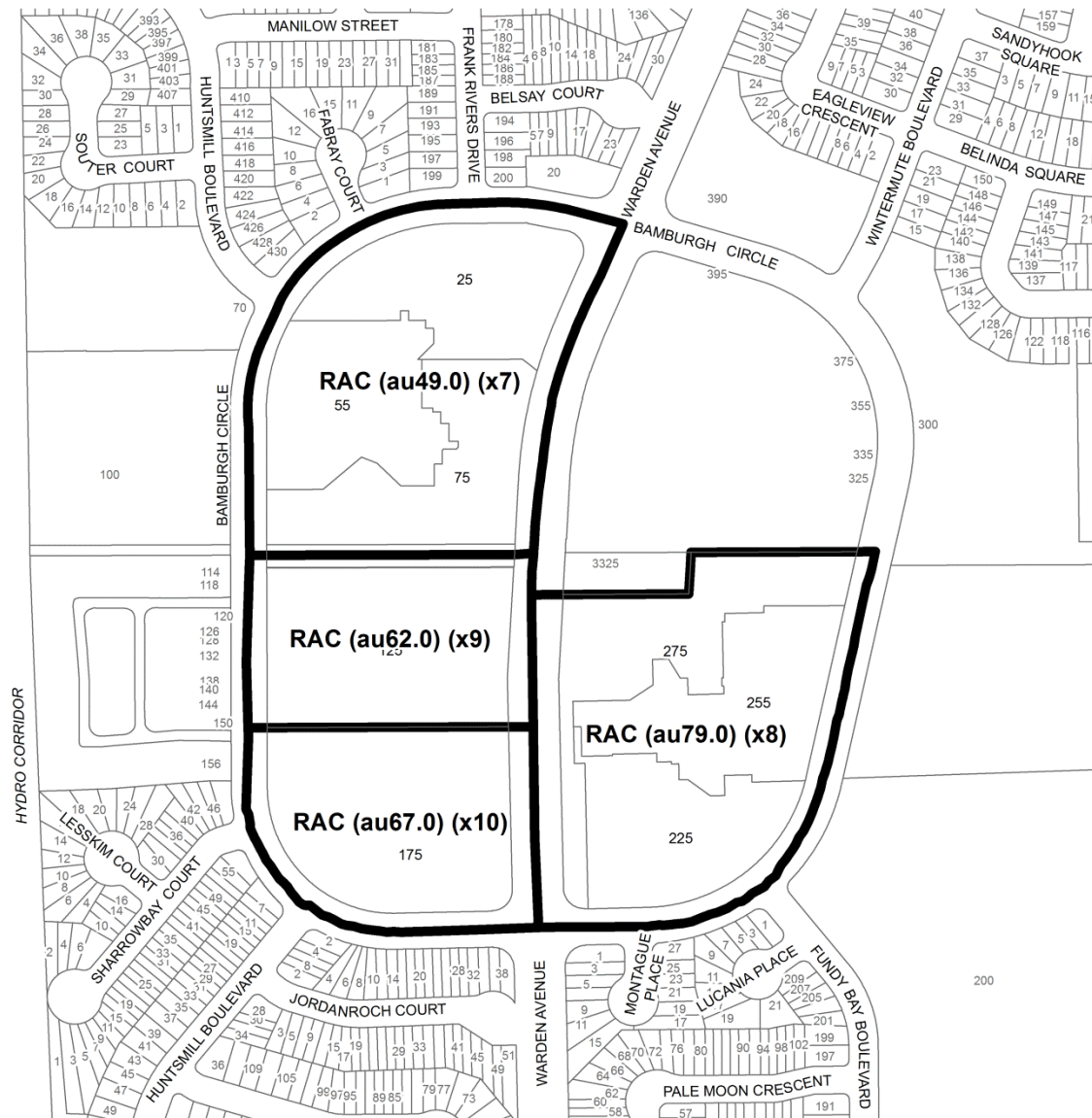

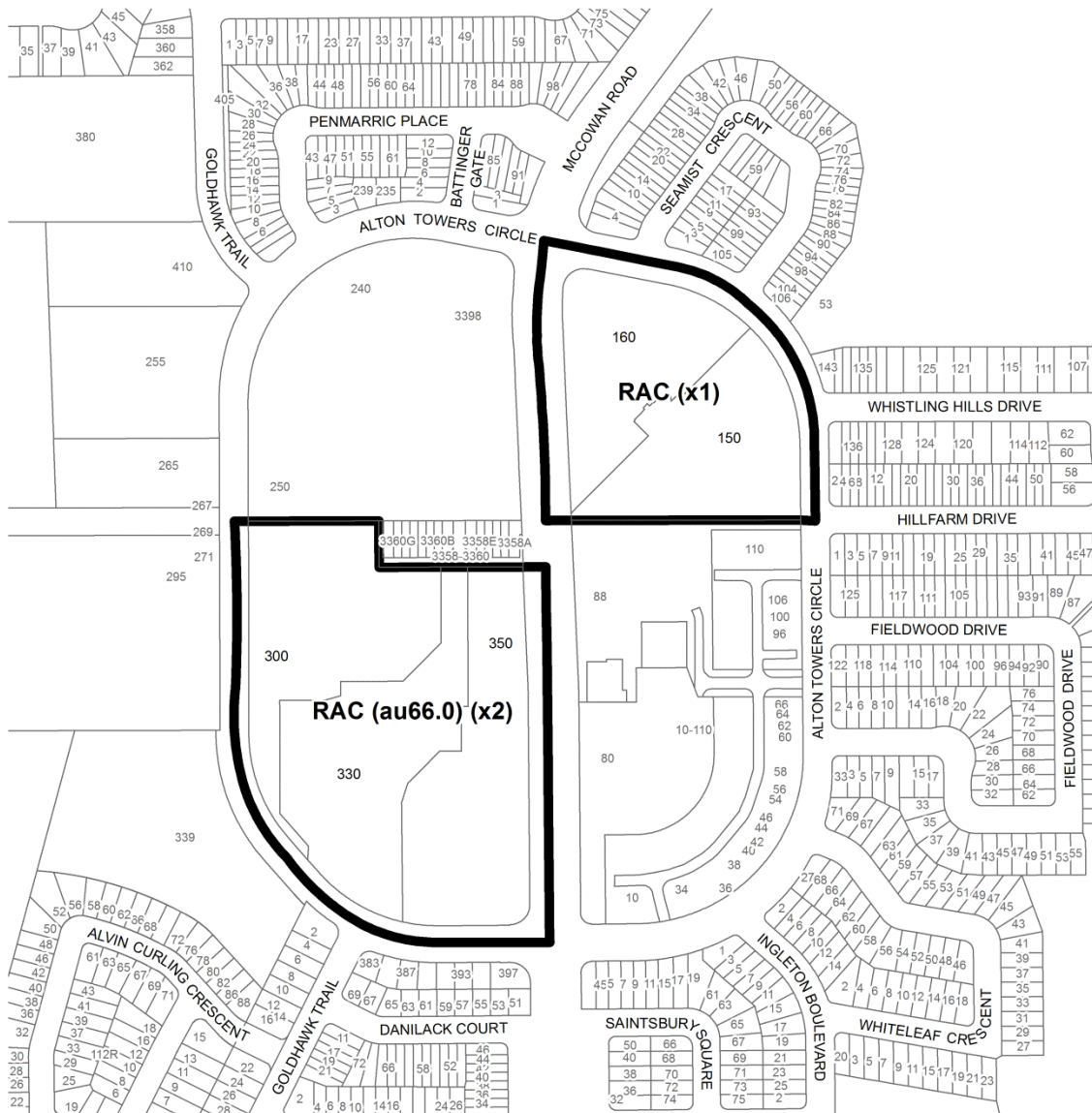





**Toronto** City Planning  
Schedule '63'

**2550 Pharmacy Avenue and  
288 Sprucewood Court**



City of Toronto By-Law 569-2013  
Not to Scale  
5/20/2014

Approved by: A. Theobald

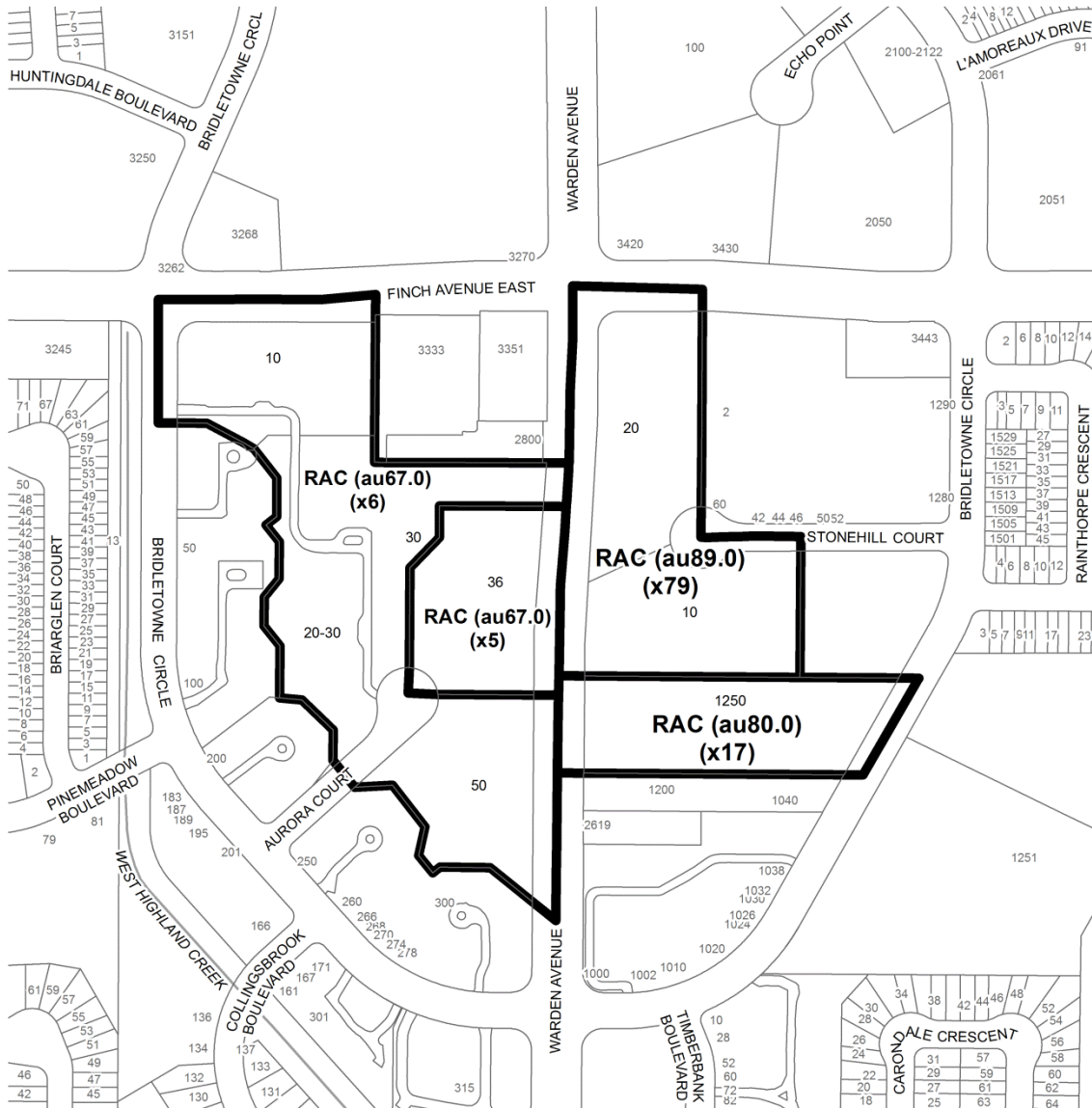

**Toronto** City Planning  
Schedule '64'

## Warden Avenue and Finch Avenue East Area

Approved by: A. Theobald

City of Toronto By-Law 569-2013  
Not to Scale  
5/6/2014

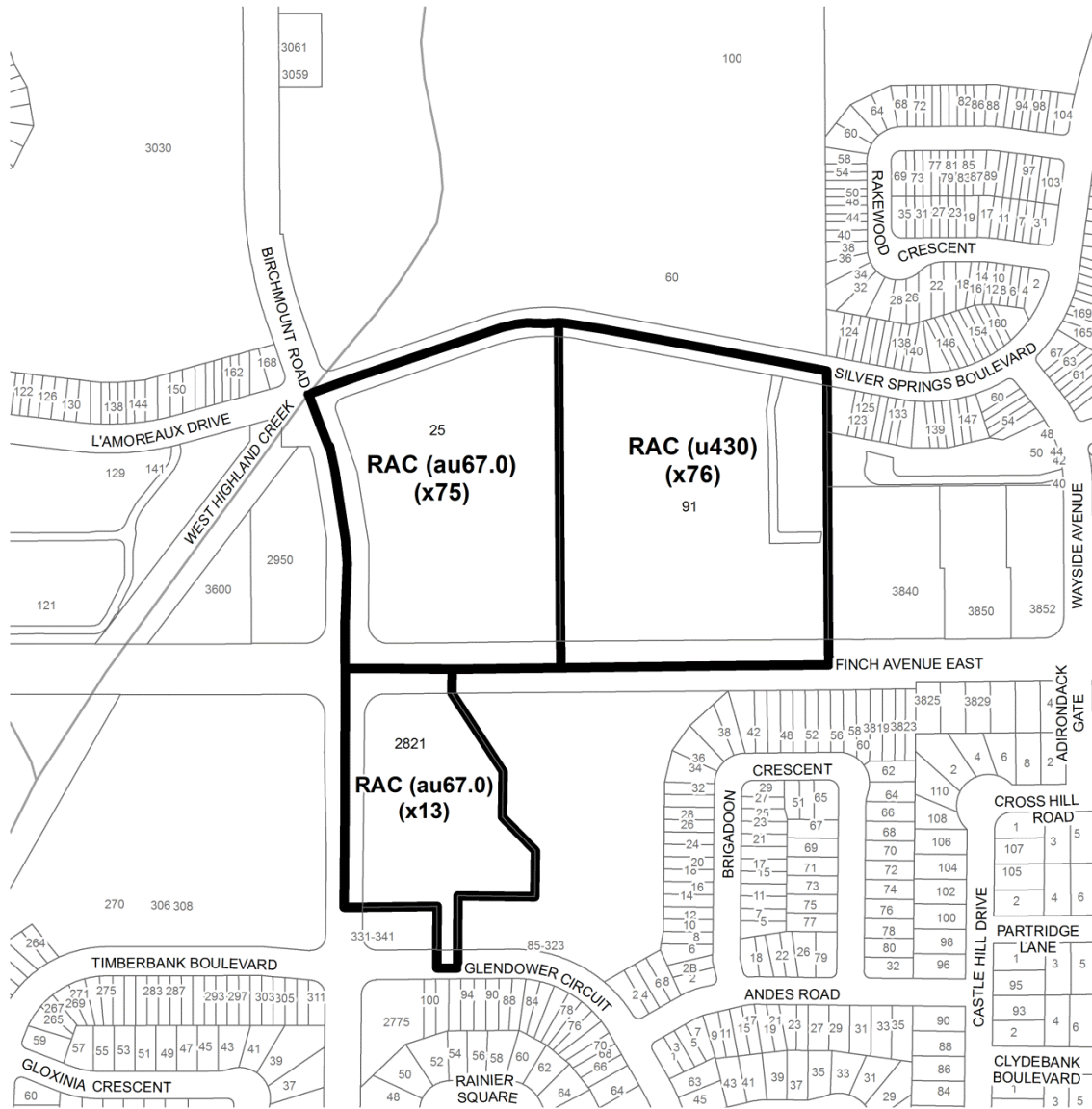

**Toronto** City Planning  
Schedule '65'

## Birchmount Road and Finch Avenue East Area

Approved by: A. Theobald

City of Toronto By-Law 569-2013  
Not to Scale  
5/6/2014

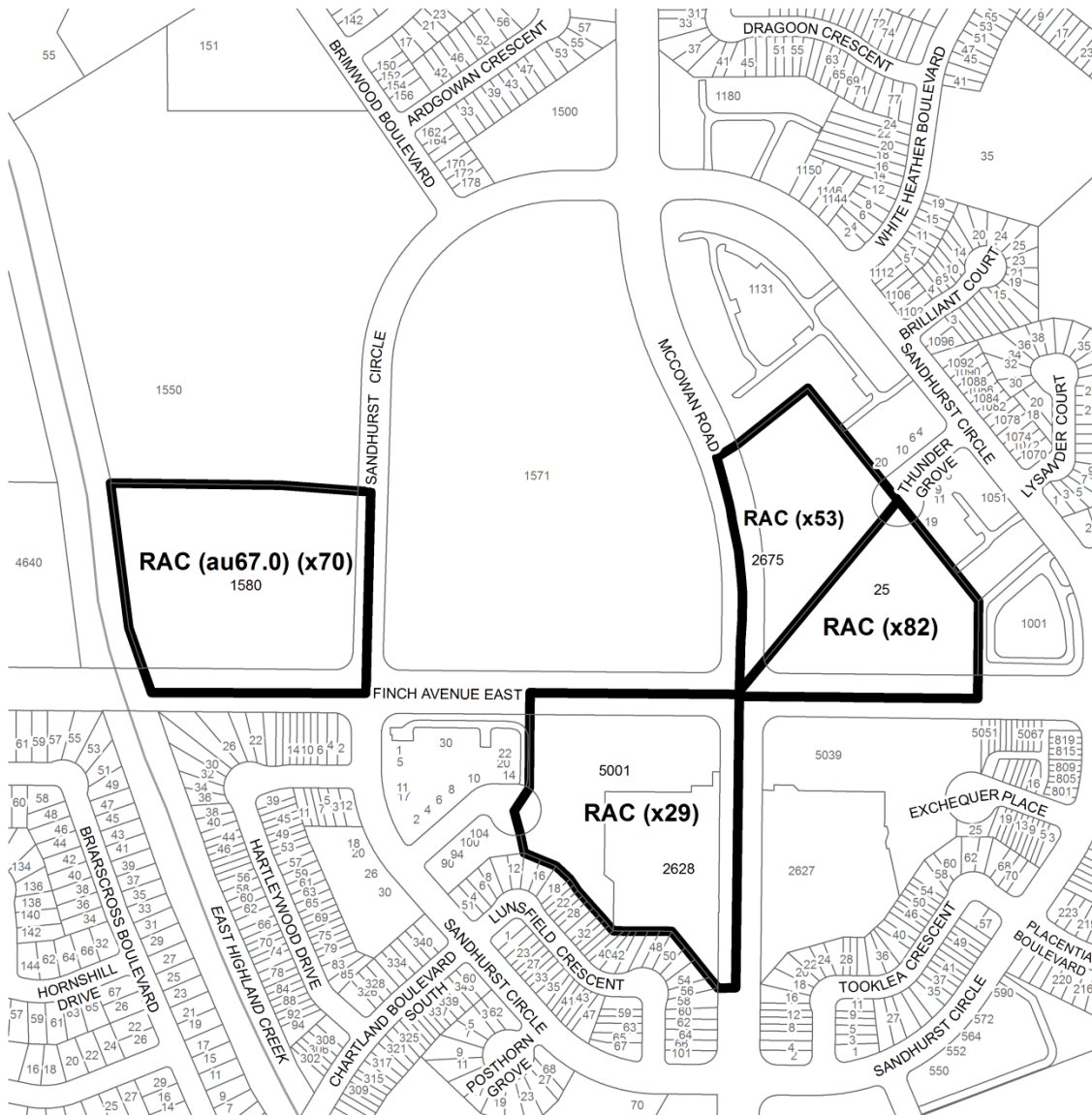

**Schedule '66'**

## McCowan Road and Finch Avenue East Area

Approved by: A. Theobald



City of Toronto By-Law 569-2013  
Not to Scale  
5/6/2014





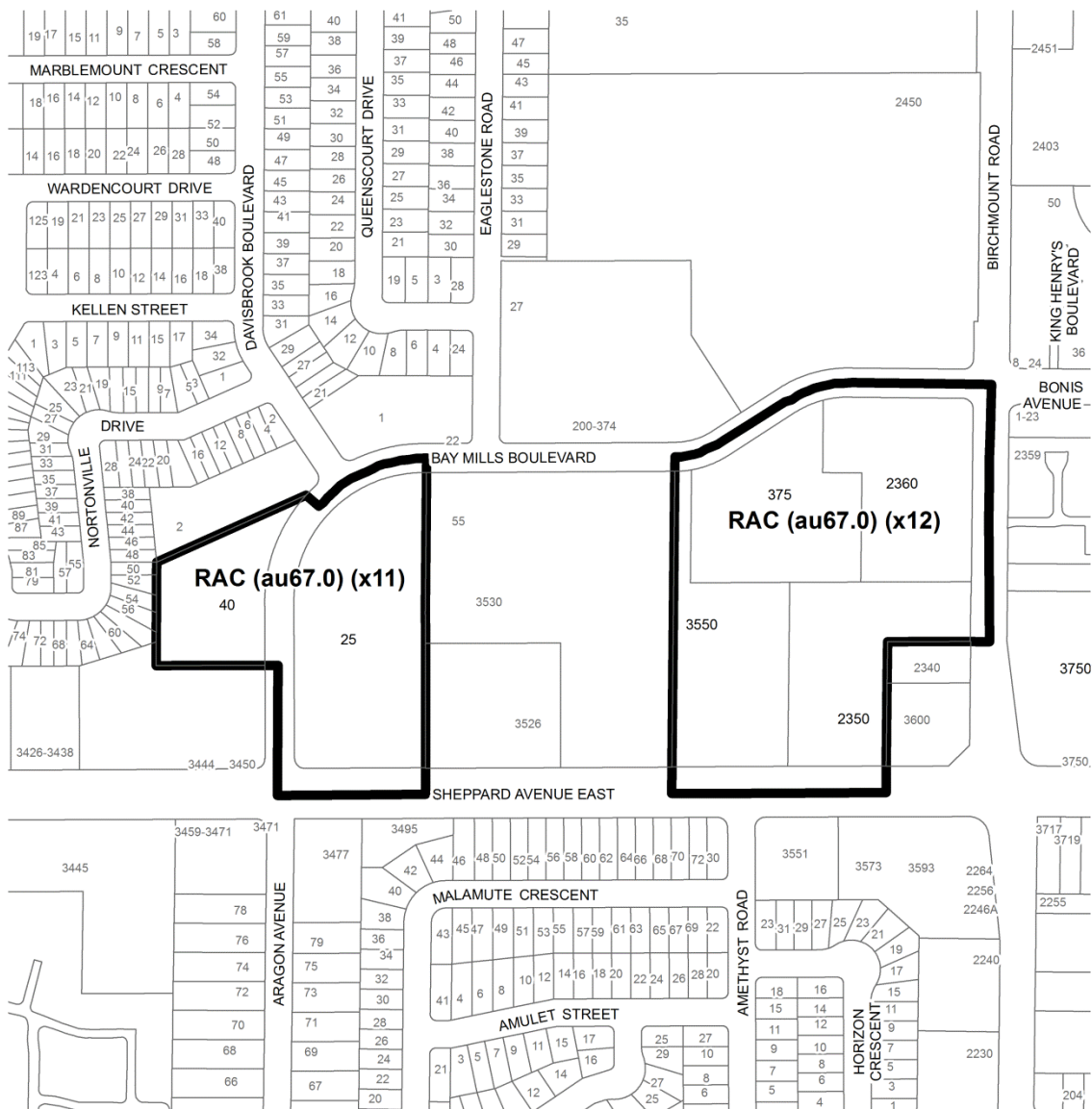

**Schedule '68'**

## Bay Mills Boulevard and Sheppard Avenue East Area

Approved by: A. Theobald

  
 City of Toronto By-Law 569-2013  
 Not to Scale  
 5/6/2014



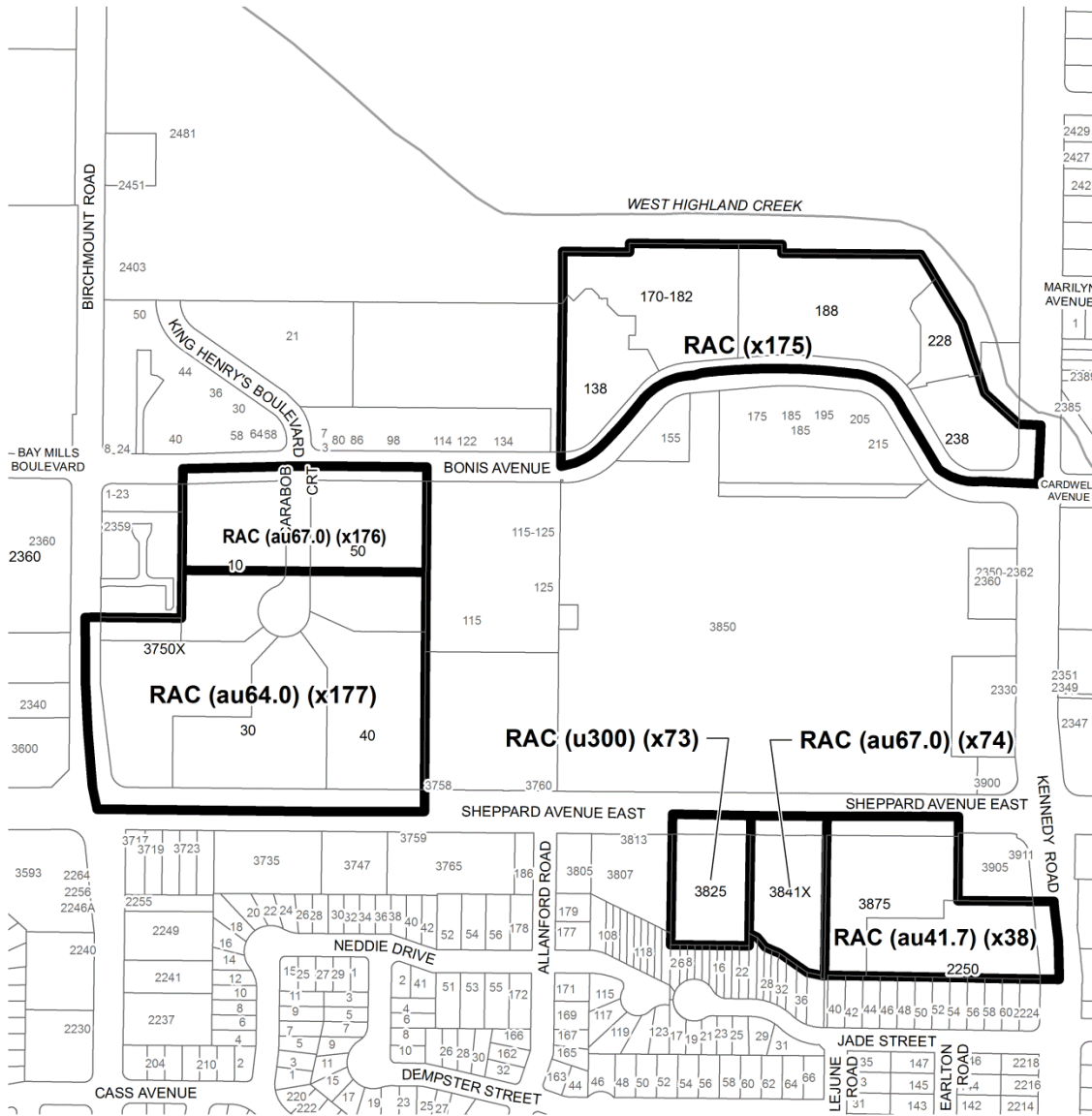

**Schedule '69'**

## Kennedy Road and Sheppard Avenue East Area

Approved by: A. Theobald

City of Toronto By-Law 569-2013  
Not to Scale  
5/6/2014









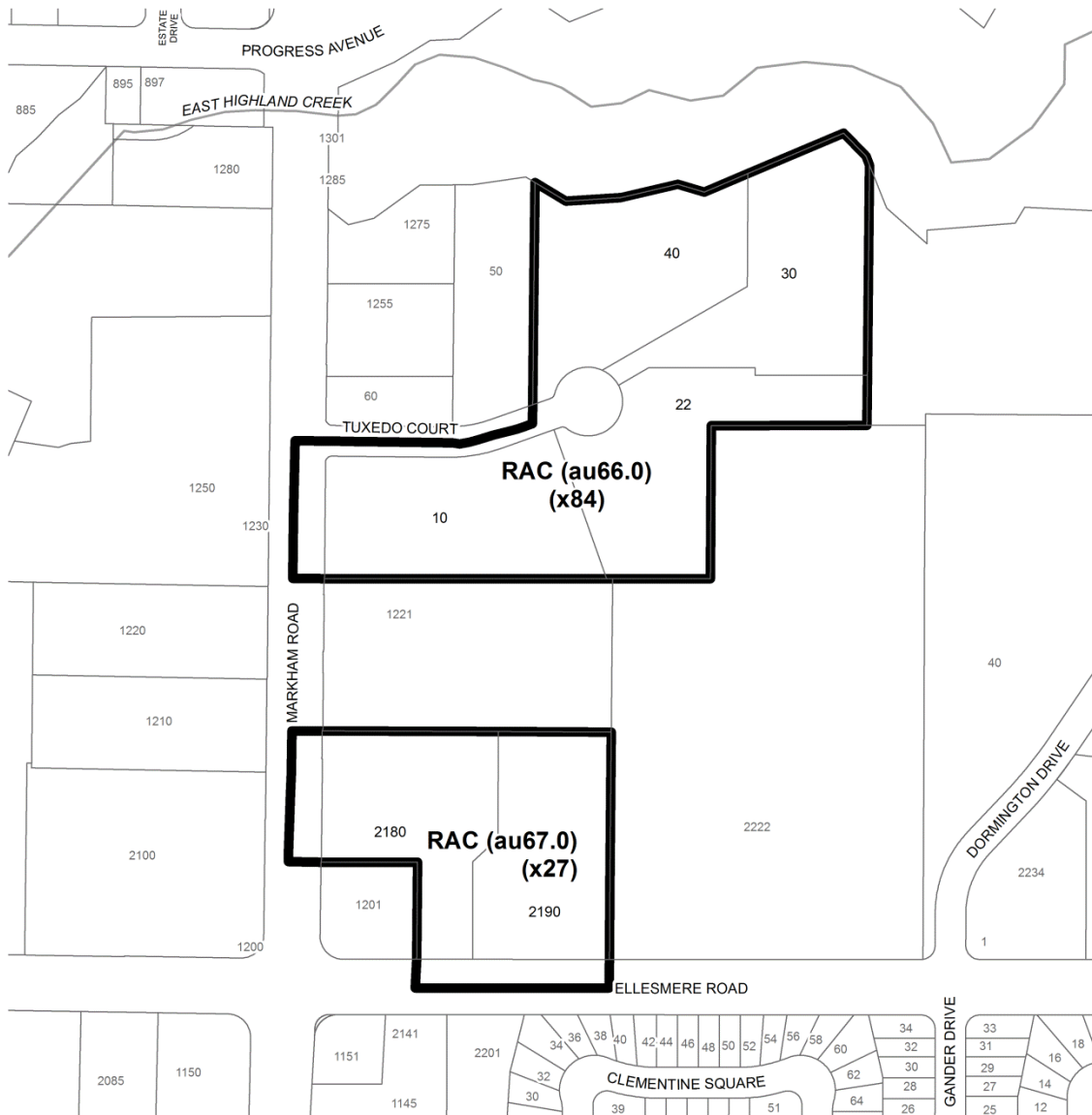

**Toronto** City Planning  
Schedule '73'

**10-40 Tuxedo Court;  
2180 & 2190 Ellesmere Road**



City of Toronto By-Law 569-2013  
Not to Scale  
5/6/2014

Approved by: A. Theobald



**Toronto** City Planning  
Schedule '74'

**555 Brimorton Drive;  
960 & 1050 Markham Road**

Approved by: A. Theobald

City of Toronto By-Law 569-2013  
Not to Scale  
5/6/2014



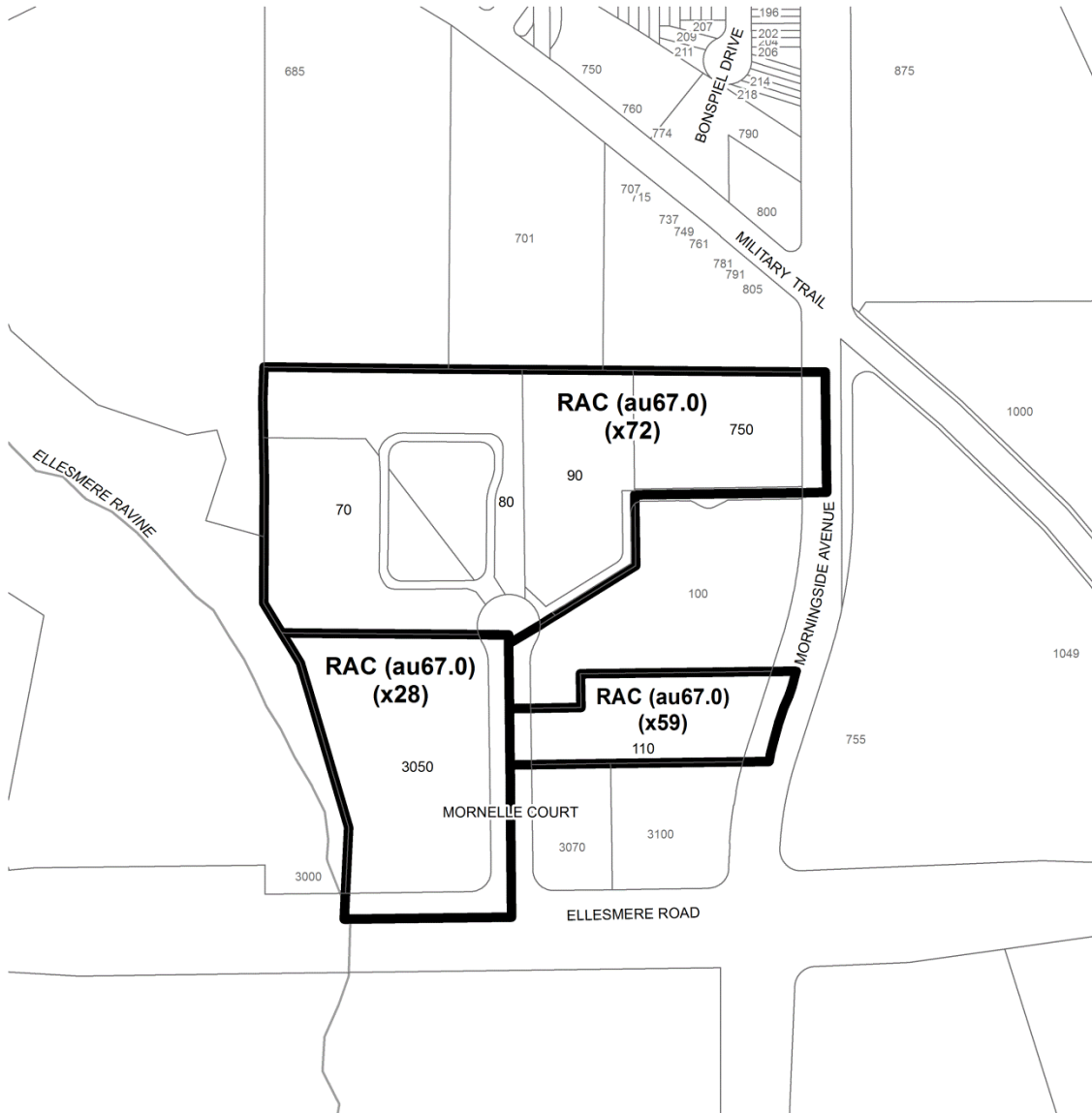

**Toronto** City Planning  
Schedule '75'

## Morningside Avenue at Ellesmere Road Area

Approved by: A. Theobald

City of Toronto By-Law 569-2013  
Not to Scale  
5/7/2014

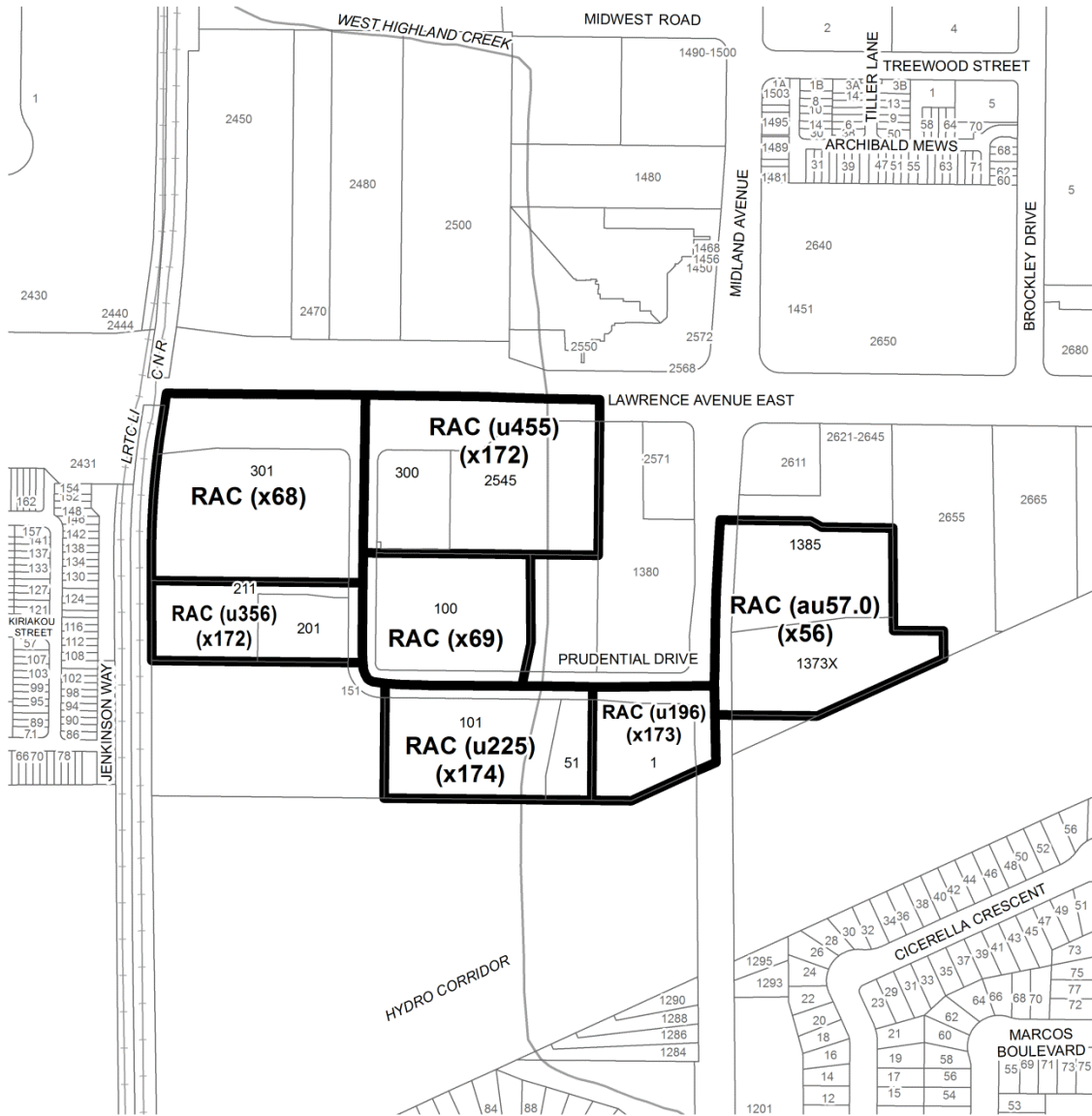

**Toronto** City Planning  
Schedule '76'

## Midland Avenue at Prudential Drive Area

Approved by: A. Theobald

City of Toronto By-Law 569-2013  
Not to Scale  
5/6/2014

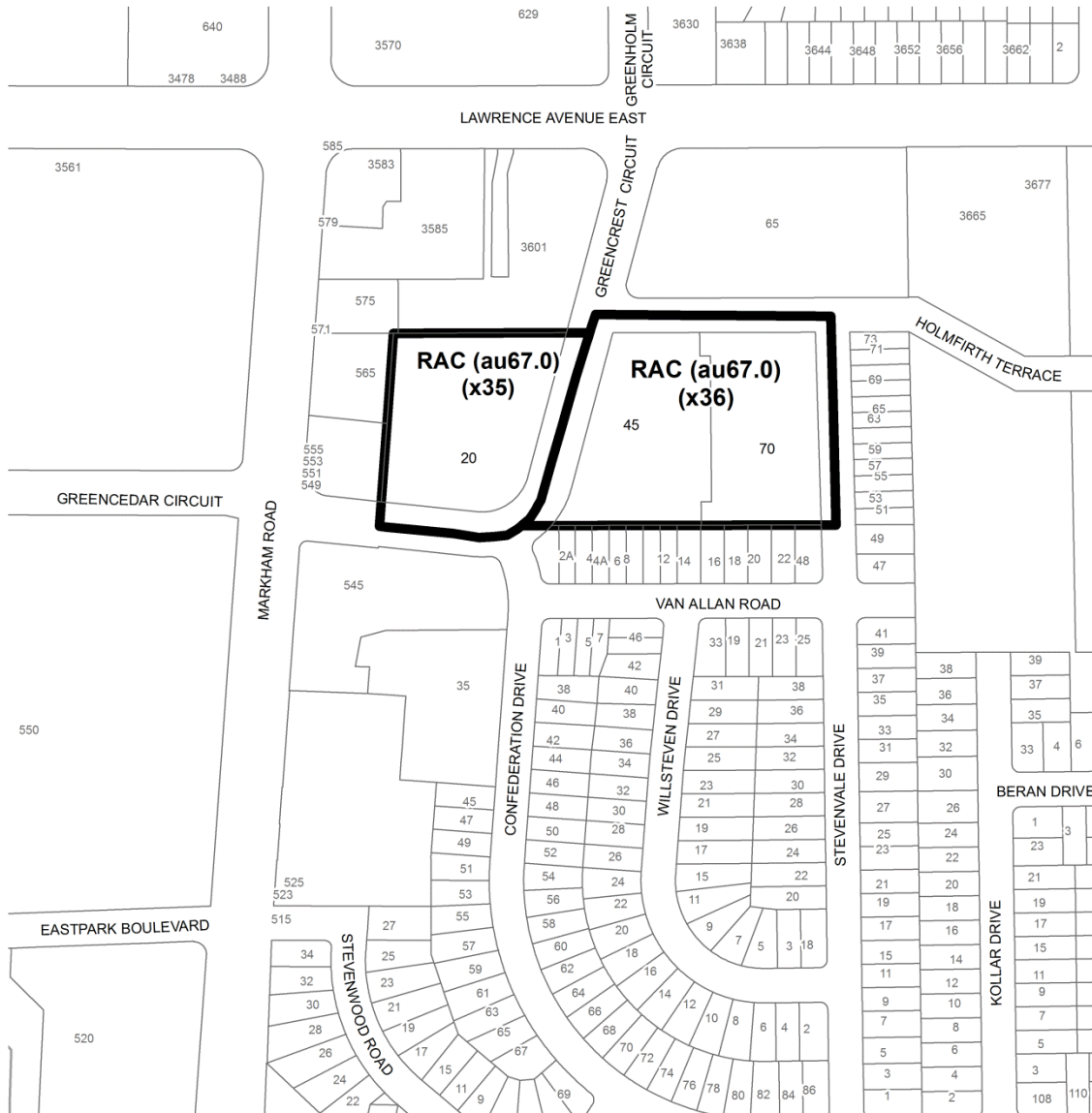

**Toronto** City Planning  
Schedule '77'

## Markham Road at Lawrence Avenue East Area

Approved by: A. Theobald

City of Toronto By-Law 569-2013  
Not to Scale  
5/7/2014

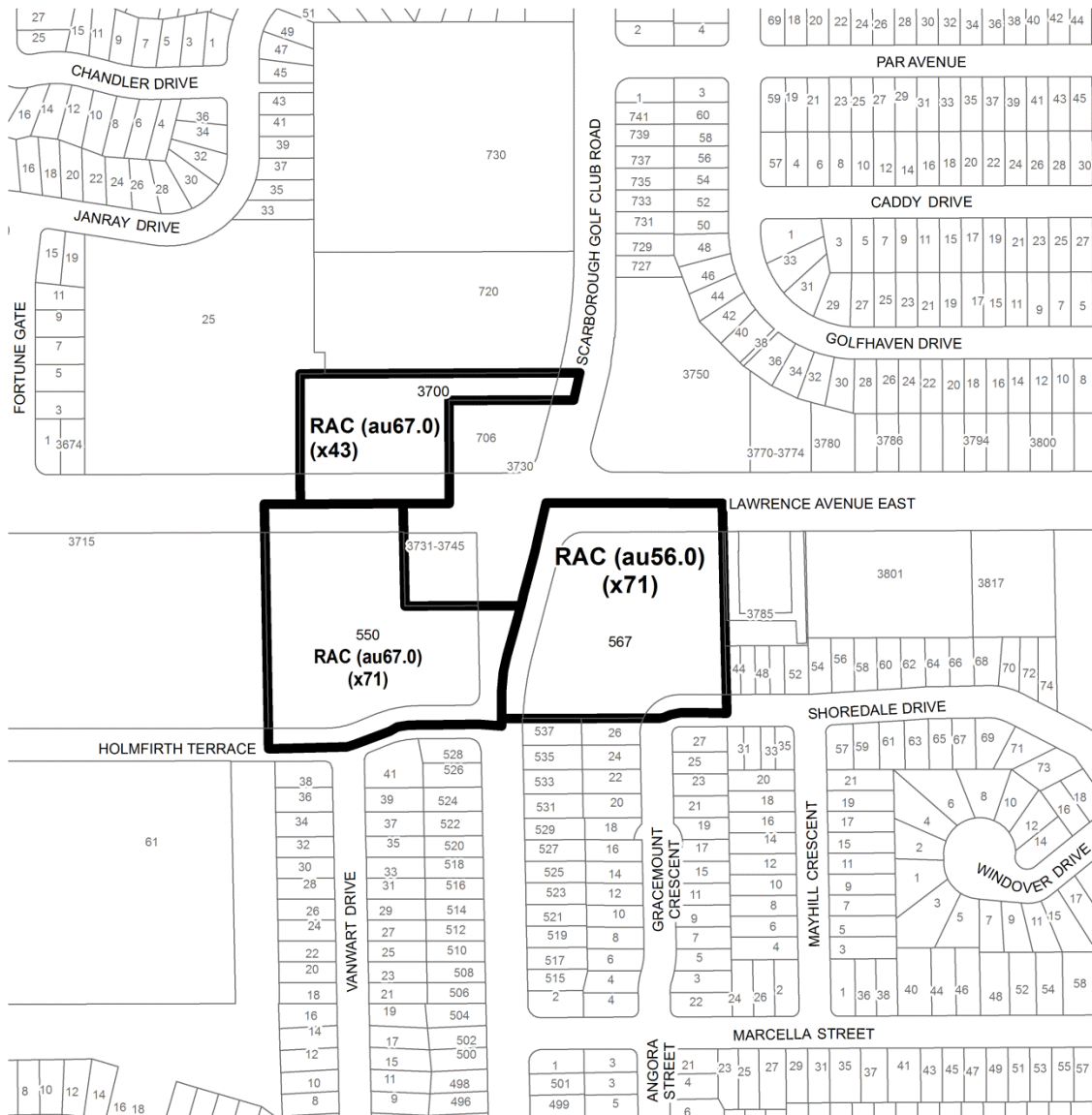

## Scarborough Golf Club Road at Lawrence Avenue East Area Schedule '78'

Approved by: A. Theobald

  
 City of Toronto By-Law 569-2013  
 Not to Scale  
 5/7/2014

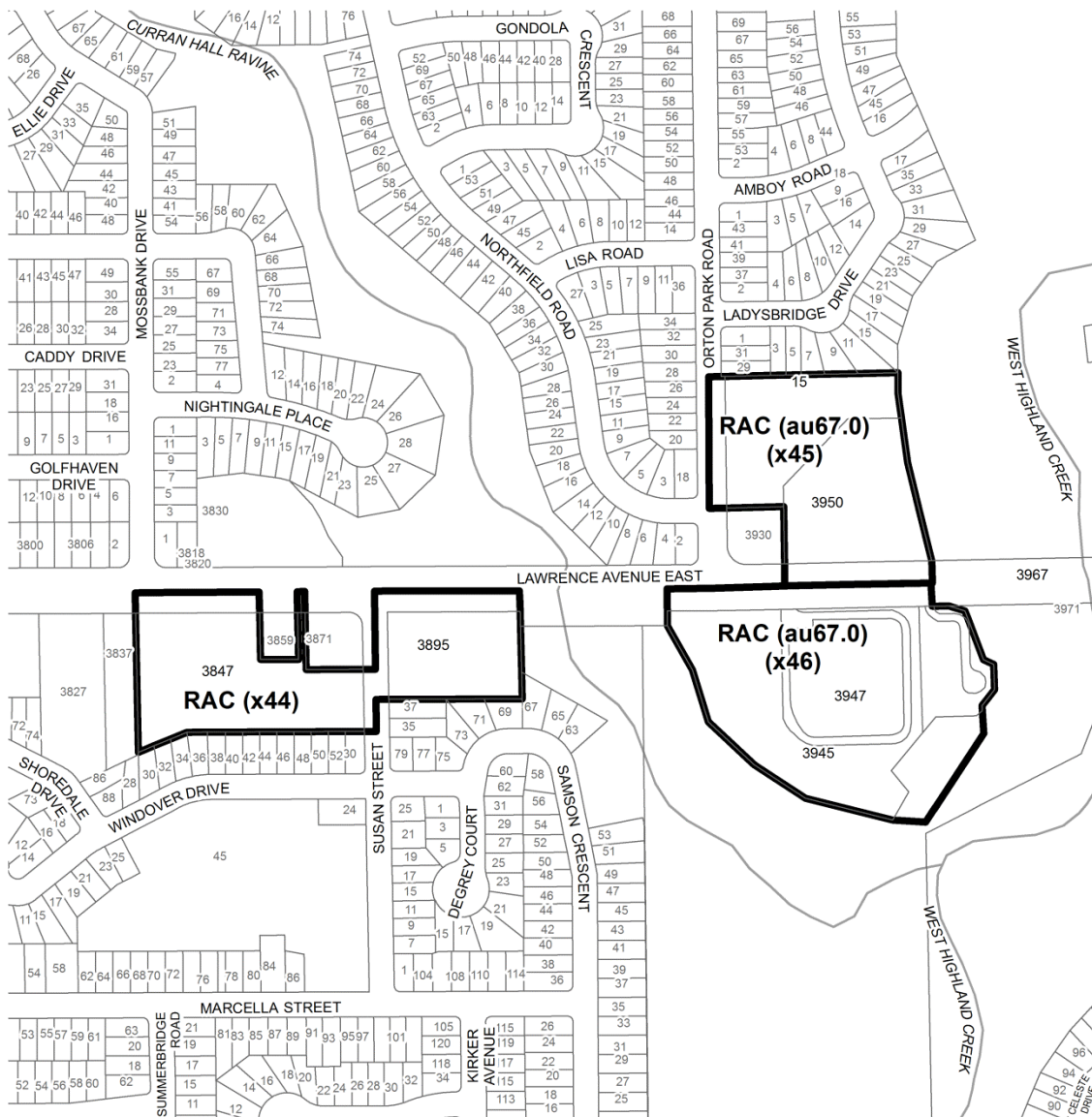

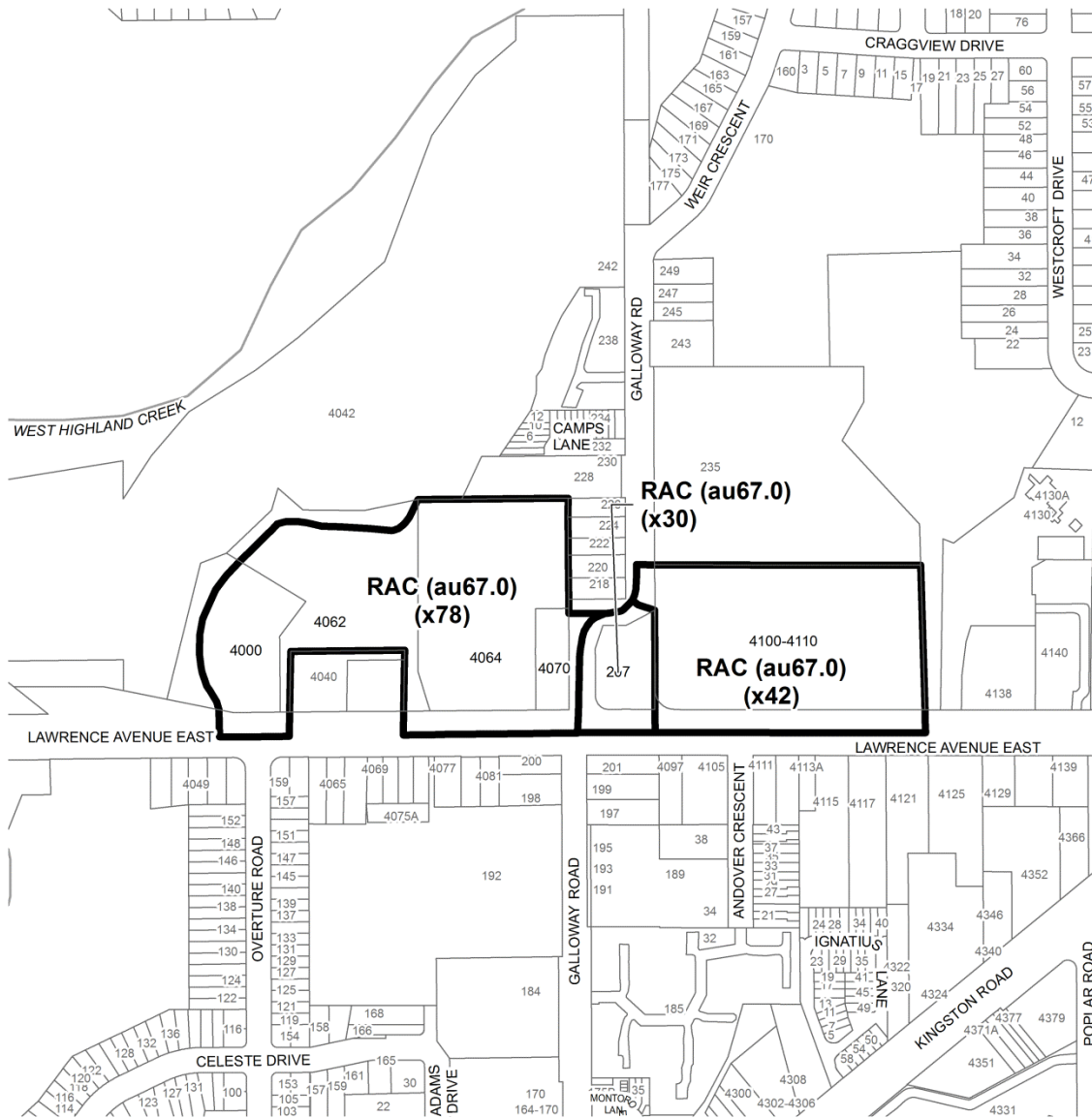

**Schedule '80'**

## Galloway Road at Lawrence Avenue East Area



City of Toronto By-Law 569-2013  
Not to Scale  
5/7/2014

Approved by: A. Theobald



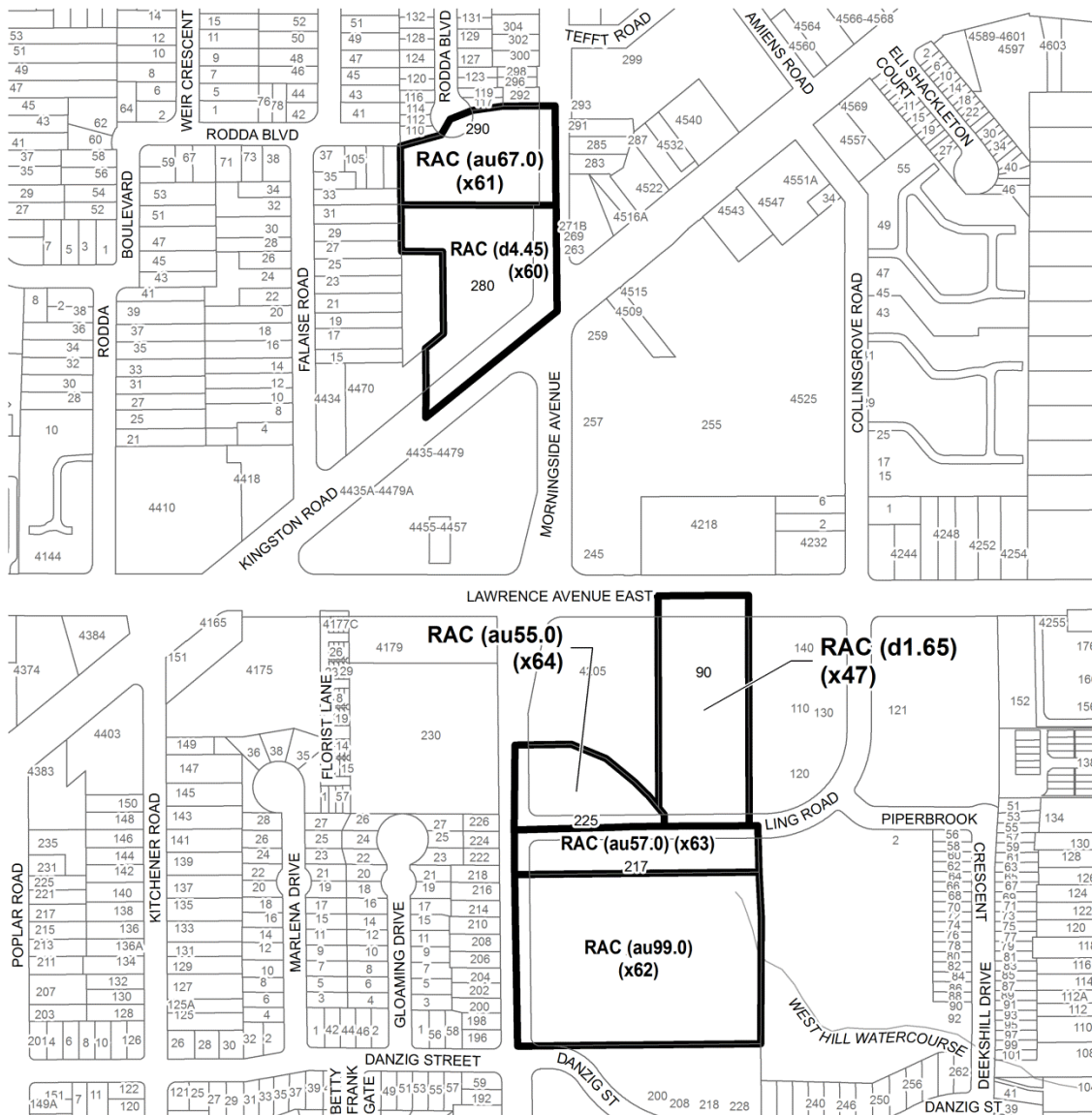

## Morningside Avenue at Lawrence Avenue East Area

Schedule '81'



City of Toronto By-Law 569-2013  
Not to Scale  
5/6/2014

Approved by: A. Theobald



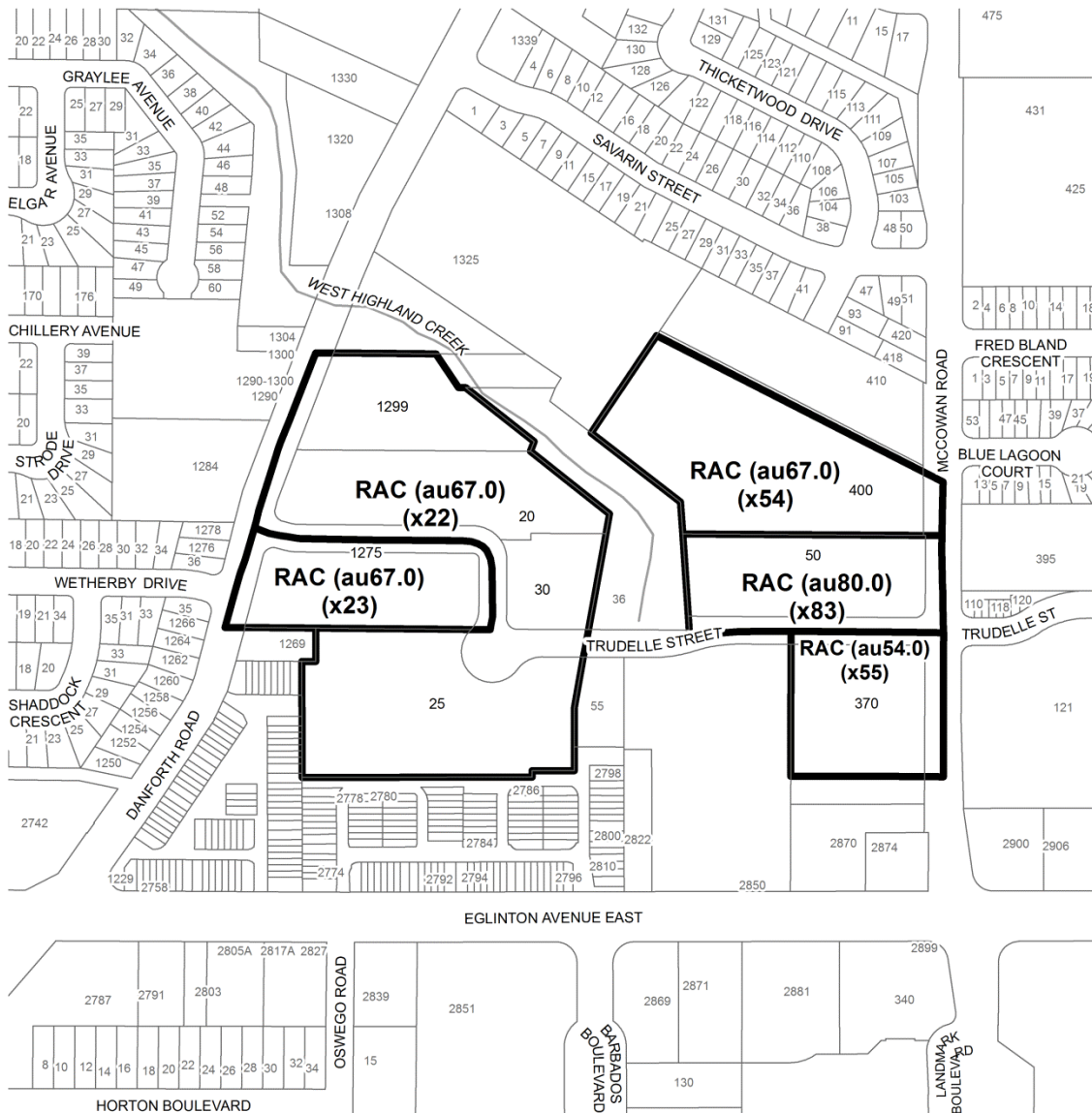





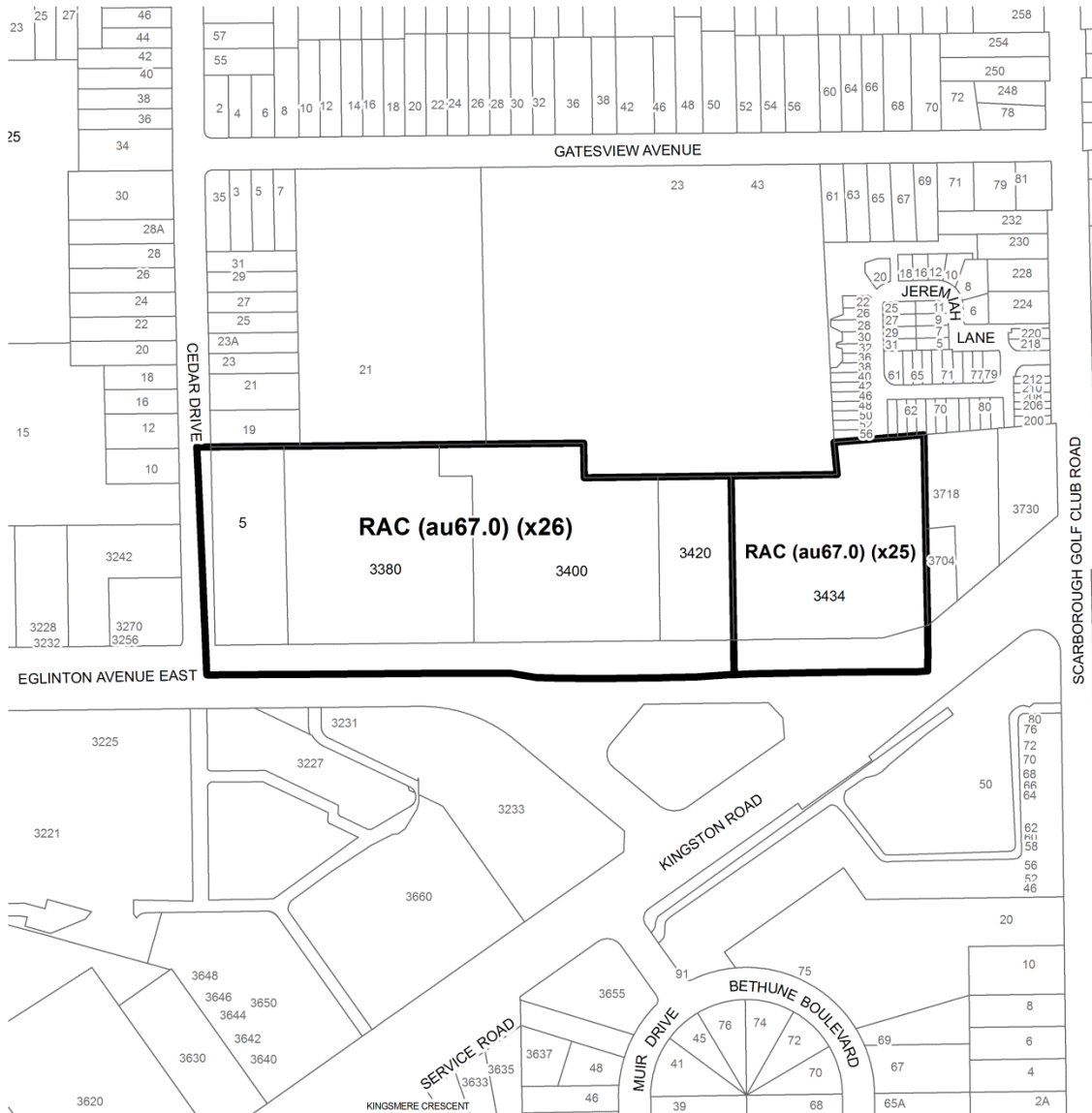

**Toronto** City Planning  
Schedule '86'

## Kingston Road at Eglinton Avenue East Area

Approved by: A. Theobald

City of Toronto By-Law 569-2013  
Not to Scale  
5/6/2014







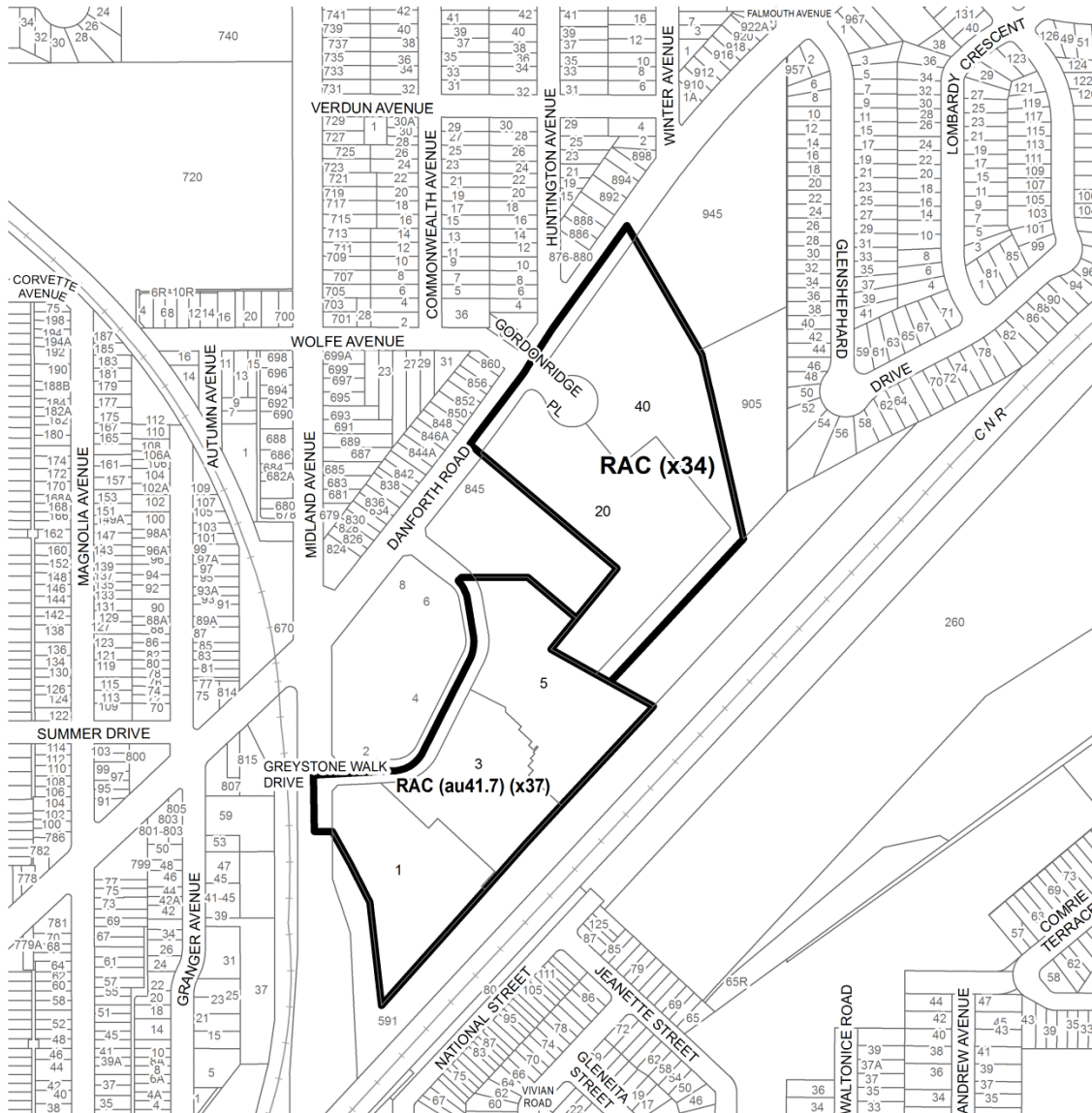

**Toronto** City Planning  
Schedule '88'

## Midland Avenue at Danforth Road Area

Approved by: A. Theobald

City of Toronto By-Law 569-2013  
Not to Scale  
5/6/2014

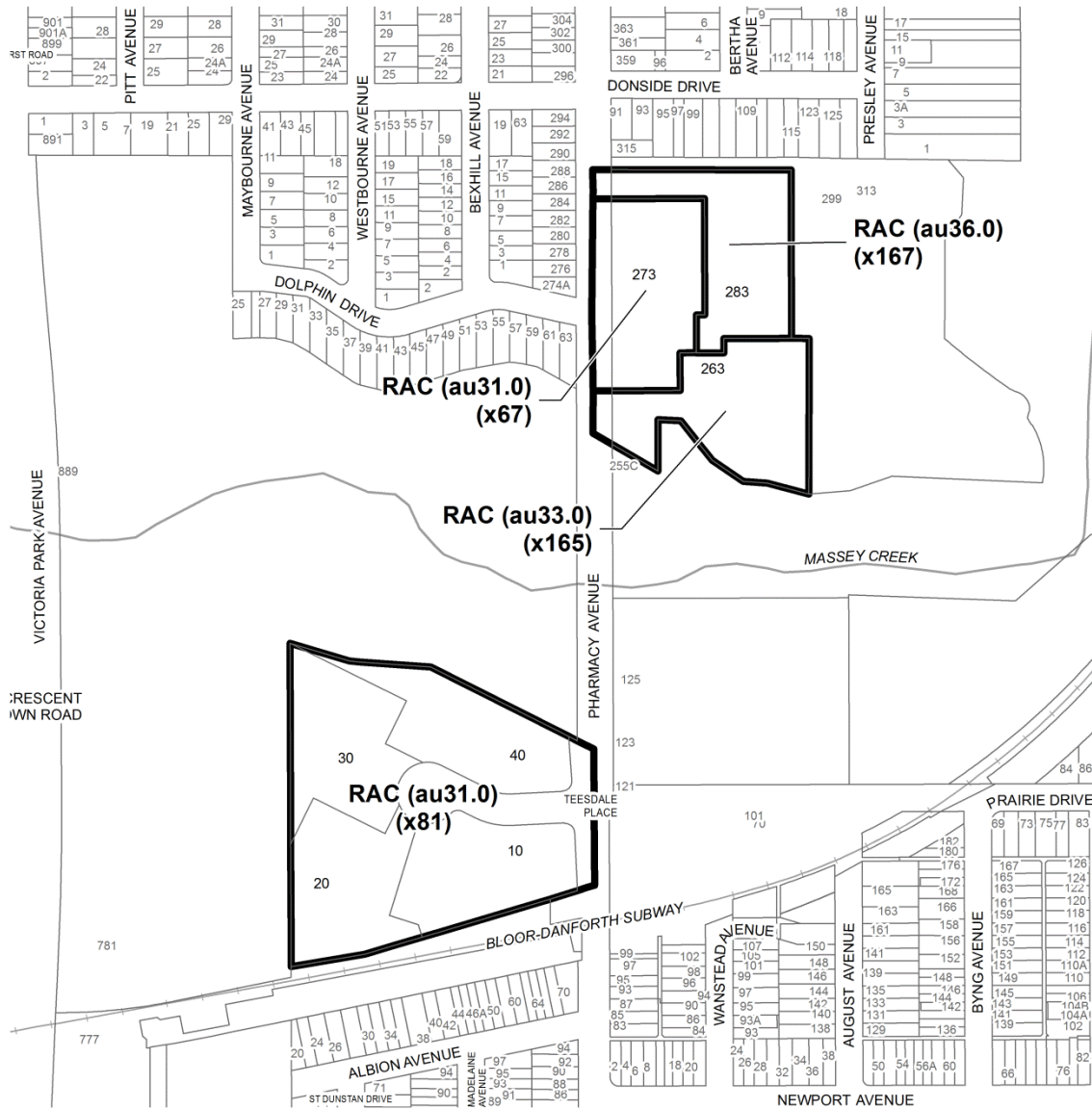

**Toronto** City Planning  
Schedule '89'

**10-40 Teesdale Place;  
263-283 Pharmacy Avenue**



City of Toronto By-Law 569-2013  
Not to Scale  
5/6/2014

Approved by: A. Theobald

