



POPS

Creative Place Making to Enhance Urban Life



PLANNING A GREAT CITY
TOGETHER

POPS

Privately

Owned

Publicly-Accessible

Space

Council Direction

Council requested City Planning to:

- Identify existing POPS
- Develop a signage template for ALL new POPS
- Develop design guidelines for new POPS

What are POPS?



What are POPS?

Places of retreat, relaxation, respite





Places to engage in civic life



What are POPS?



What are POPS?

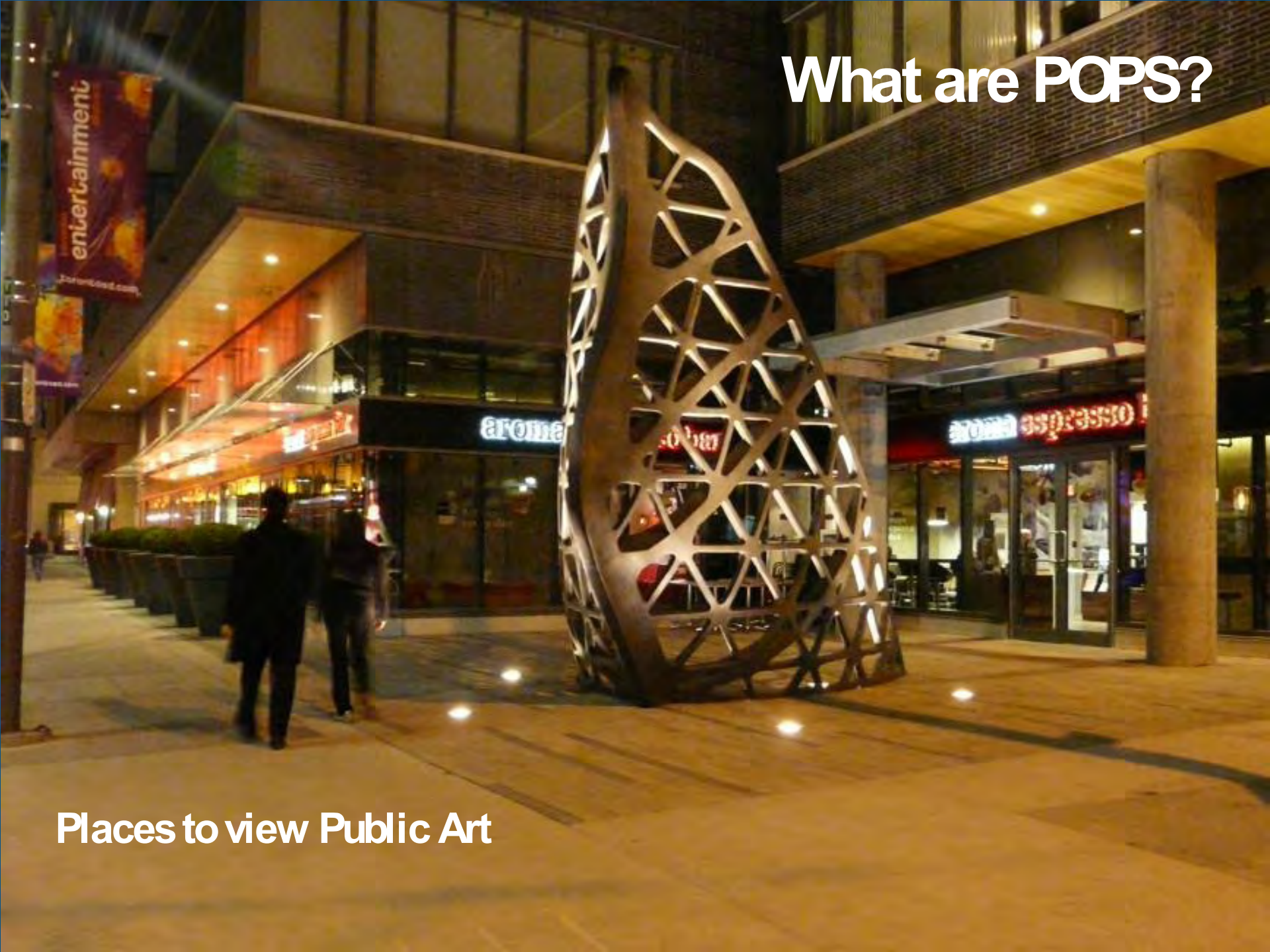

Places to view Public Art

What are POPS?

Places to view Public Art



What are POPS?

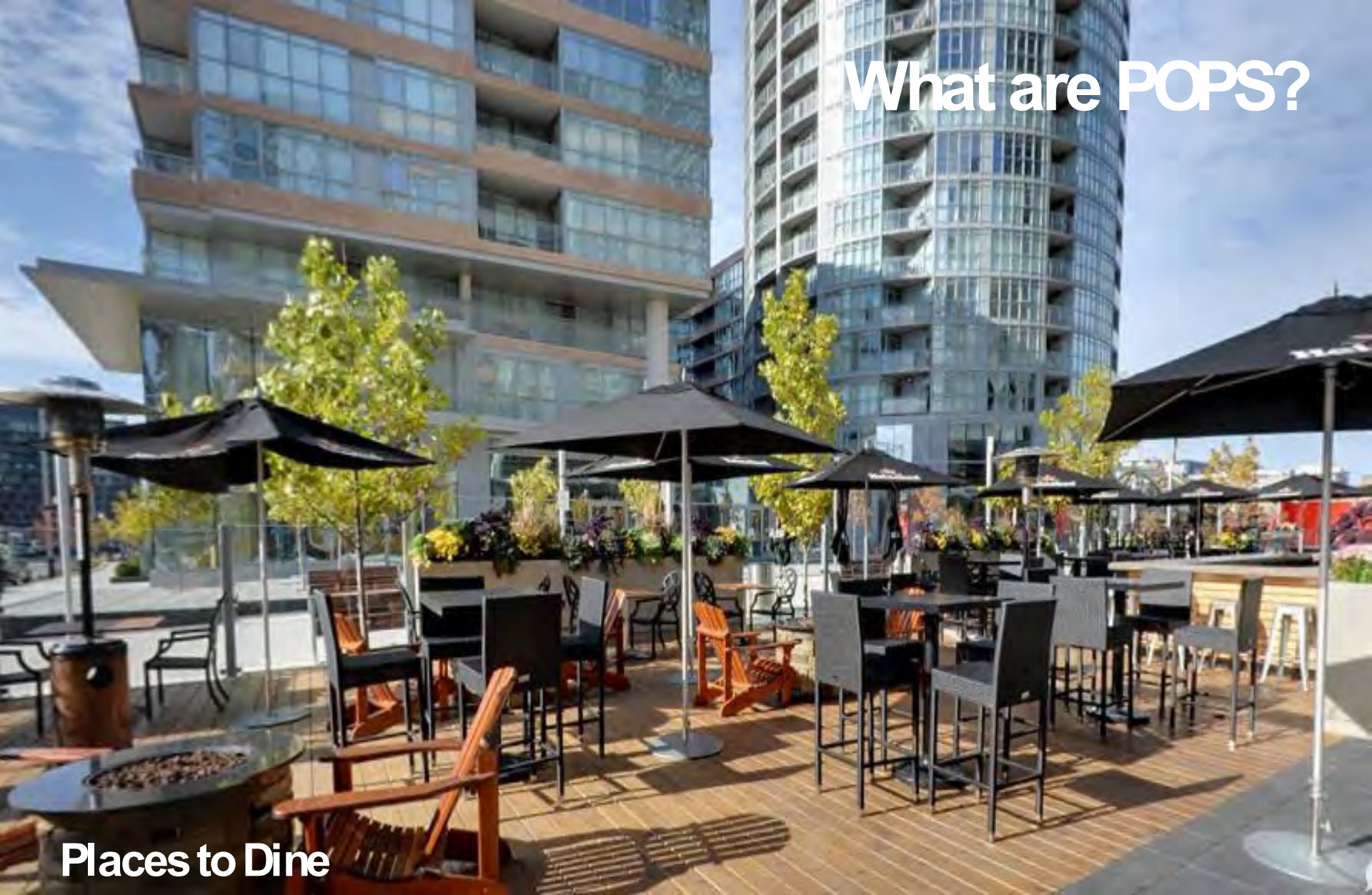

Places to Dine

What are POPS?



Places of Retreat

What are POPS?

Places to celebrate Urban Pageantry

What are POPS?



Places to engage in civic life



PLANNING A GREAT CITY
TOGETHER

POPS Signage & Website

POPS Signage

To increase:

- public accessibility
- awareness
- comfort in using the space
- legibility of the POPS “brand”



POPS Signage



The image shows a rectangular metal sign mounted on a stone wall. The sign has a light grey background with black text and graphics. At the top, the title 'Iceboat Terrace' is written in a serif font. Below the title is a stylized tree logo with a squirrel at its base, and the letters 'POPS' are printed in a large, bold, sans-serif font. Underneath 'POPS' is the text 'Privately Owned Publicly-Accessible Space'. To the right of the tree logo, a paragraph of text explains that the space is provided by Concord Adex Inc. in partnership with the City of Toronto. Below this is a bulleted list of rules and information. At the bottom of the sign, there are three elements: the Concord Adex logo, a QR code, and the City of Toronto logo.

Iceboat Terrace



POPS
Privately Owned Publicly-Accessible Space

This Publicly-Accessible Privately Owned Space is provided by Concord Adex Inc. in partnership with the City of Toronto

- This space is available for your enjoyment from 6:00 a.m. to 11:00 p.m.
- Please respect the space and the enjoyment of others
- As with all publicly-accessible spaces, City by-laws apply
- If you have questions or concerns, call 311

Creative Place Making to Enhance Urban Life





POPS Signage

POPS Signage

Signage Product Option 1



Signage Product Option 2



Signage Product Option 3



- City of Toronto's Transportation Services, Pedestrian Projects
- TO360 Wayfinding Strategy - Pilot Project for the Downtown
- Printed and digital maps

Search A↑ A↓ ↺

[Living In Toronto -](#) [Doing Business -](#) [Visiting Toronto -](#) [Accessing City Hall -](#)

[City of Toronto](#) > [Your City](#) > [City Planning](#) > [Urban Design](#)

City Planning

- Developing Toronto
- Community Planning
- Strategic Initiatives, Policy & Analysis
- Urban Design
 - Heritage Preservation
 - Design Review Panel
 - Design Guidelines
 - Streetscape Manual
 - Design Studies
 - Eglinton Connects
 - Avenues and Mid-Rise Buildings Study
 - Urban Design Awards
- Transportation Planning
- Zoning & Environment
- Feeling Congested
- Comprehensive to the Core

POPS



Privately Owned Publicly-Accessible Space

Creative Place Making to Enhance Urban Life



What are POPS?

As Toronto continues to grow, there is an increasing need and demand to revitalize existing parks and open spaces as well as to create new parks and open spaces.

In order to provide this much needed open space within Toronto's dense urban landscape, the City often negotiates with private developers to include Privately Owned Publicly-Accessible Spaces, or "POPS" for short, as part of the development application and review process. POPS are a specific type of open space which the public are invited to use, but remain privately owned. They are a key part of the city's public realm network, providing open space in much needed locations across the city and complementing existing and planned parks, open spaces and natural areas.

POPS Location Map



Map showing the location of POPS (Privately Owned Publicly-Accessible Spaces) across Toronto. The map includes a search bar, print and share options, and a scale bar (0 to 6 km). The map shows various locations marked with pins, primarily concentrated in the downtown and waterfront areas.

Questions? Contact Us

[Contact Us](#)

Coming Soon

POPS Design Guidelines

Coming Soon. Check back for updates.



Downloadable POPS Map (Interactive PDF Version)

Coming Soon. Check back for Updates.



Accessibility

 **Need Assistance Reading Content?**
Call: 416 338 5700
E: sbowen1@toronto.ca

[Translate](#) | [Contact us](#) | [311](#) | [Accessibility](#) | [Privacy](#)

© City of Toronto, 1998-2014

view the map

download the guidelines

download the interactive PDF map

Translate | Contact us | 311 | Accessibility | Privacy

© City of Toronto, 1998-2014

POPS Website

www.toronto.ca/planning/pops

POPS_Map_May2014_Rev.pdf - Adobe Reader

File Edit View Window Help

1 / 1 76.2%

Sign Comment

Address: 2230 Lakeshore
Description: A publicly-accessible open space.

Click for Close-up

This is an interactive map. Please place your cursor over the dots on the map to view more information

Private**O**w**N**ed Publicly-Access**S**ible Space

Creative Place Making to Enhance Urban Life

5:55 PM 05/22/2014

POPS Website

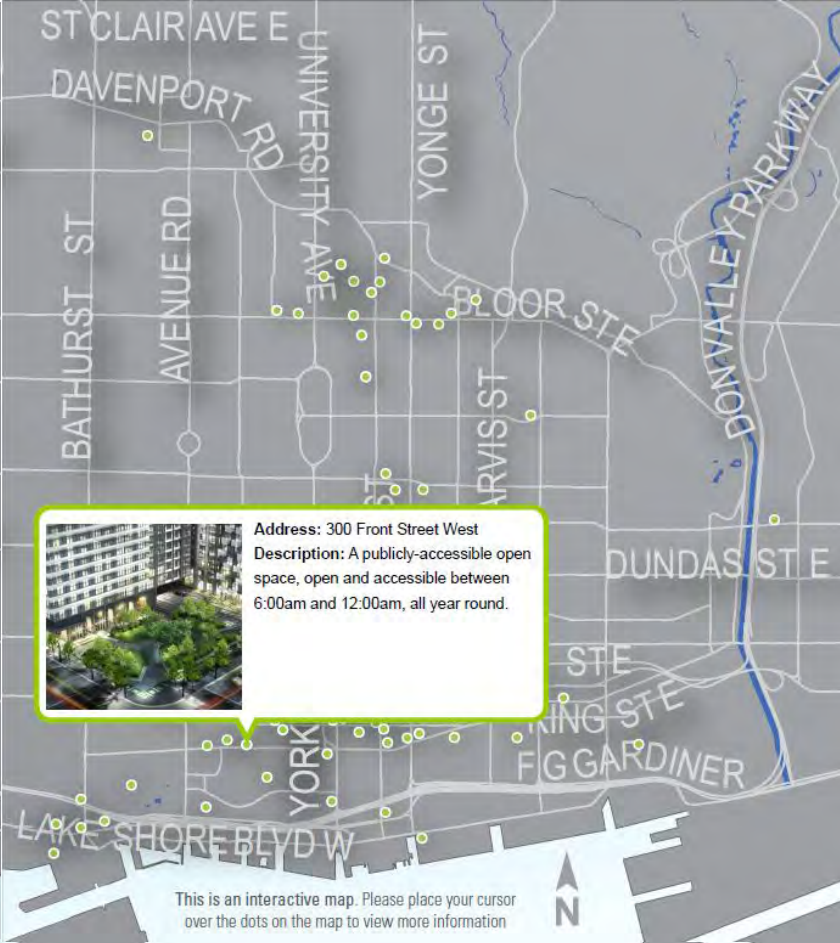

www.toronto.ca/planning/pops

Downtown Keymap Note: POPS locations are approximate. Access to some POPS locations may be refused in certain circumstances.



Address: 300 Front Street West
Description: A publicly-accessible open space, open and accessible between 6:00am and 12:00am, all year round.

This is an interactive map. Please place your cursor over the dots on the map to view more information

 **Privately Owned Publicly-Accessible Space**
Creative Place Making to Enhance Urban Life 

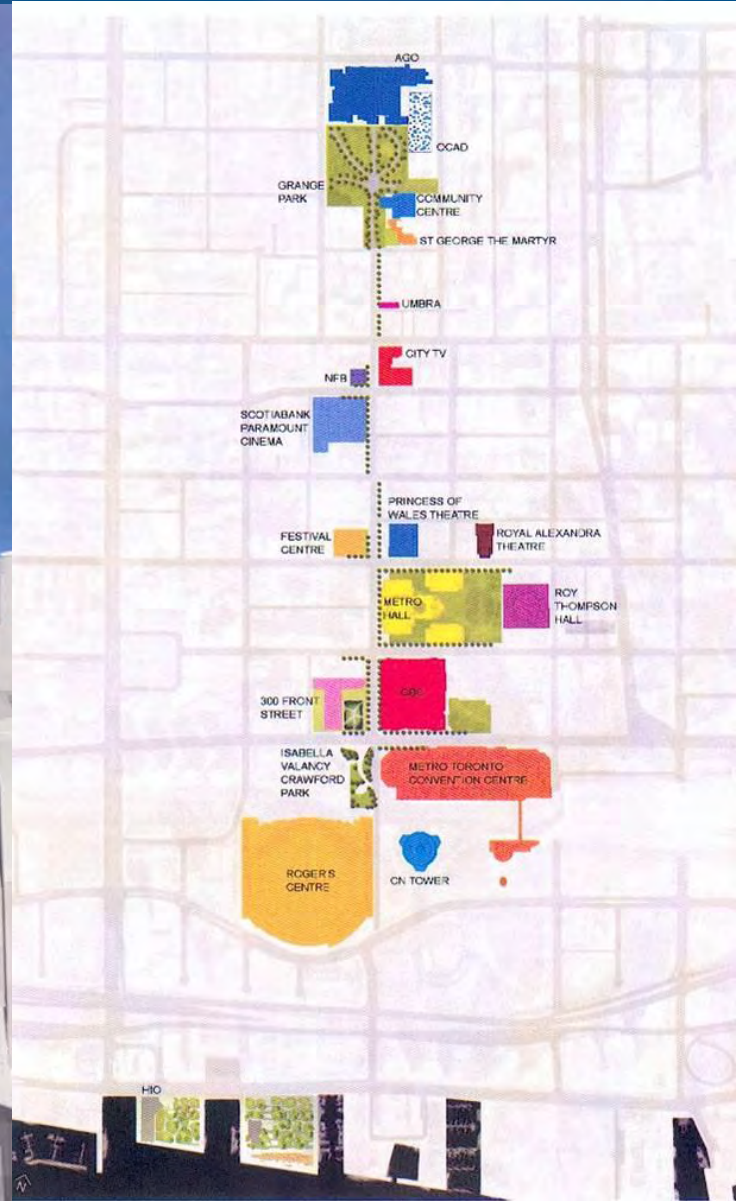

300 Front Street West



300 Front Street West

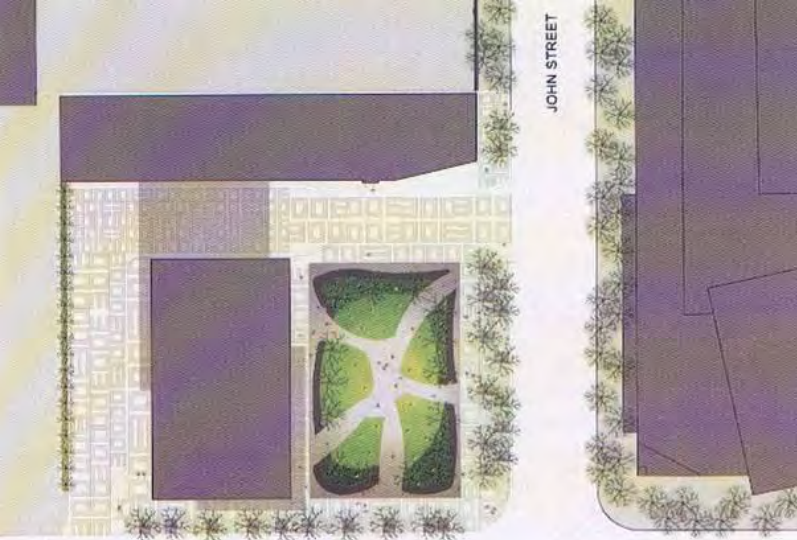

FRONT STREET WEST



300 FRONT STREET

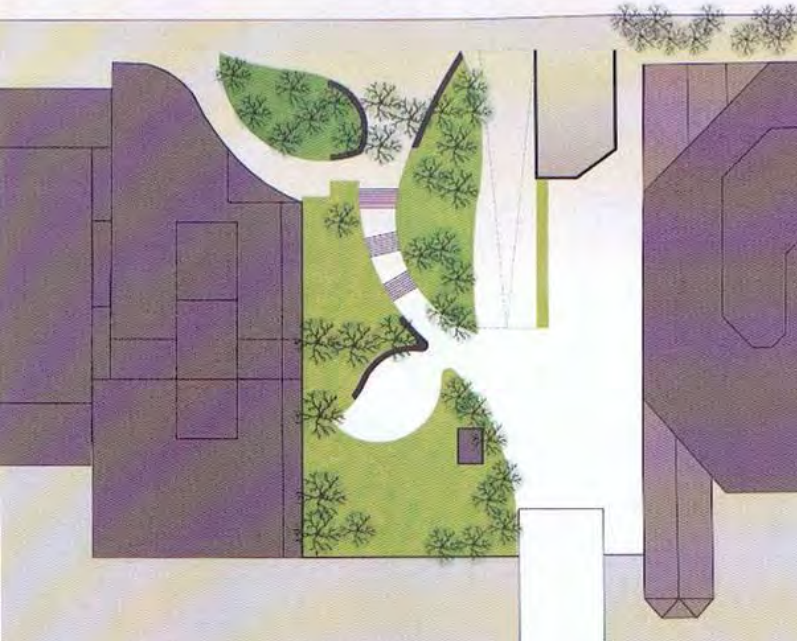

300 Front Street West





300 Front Street West

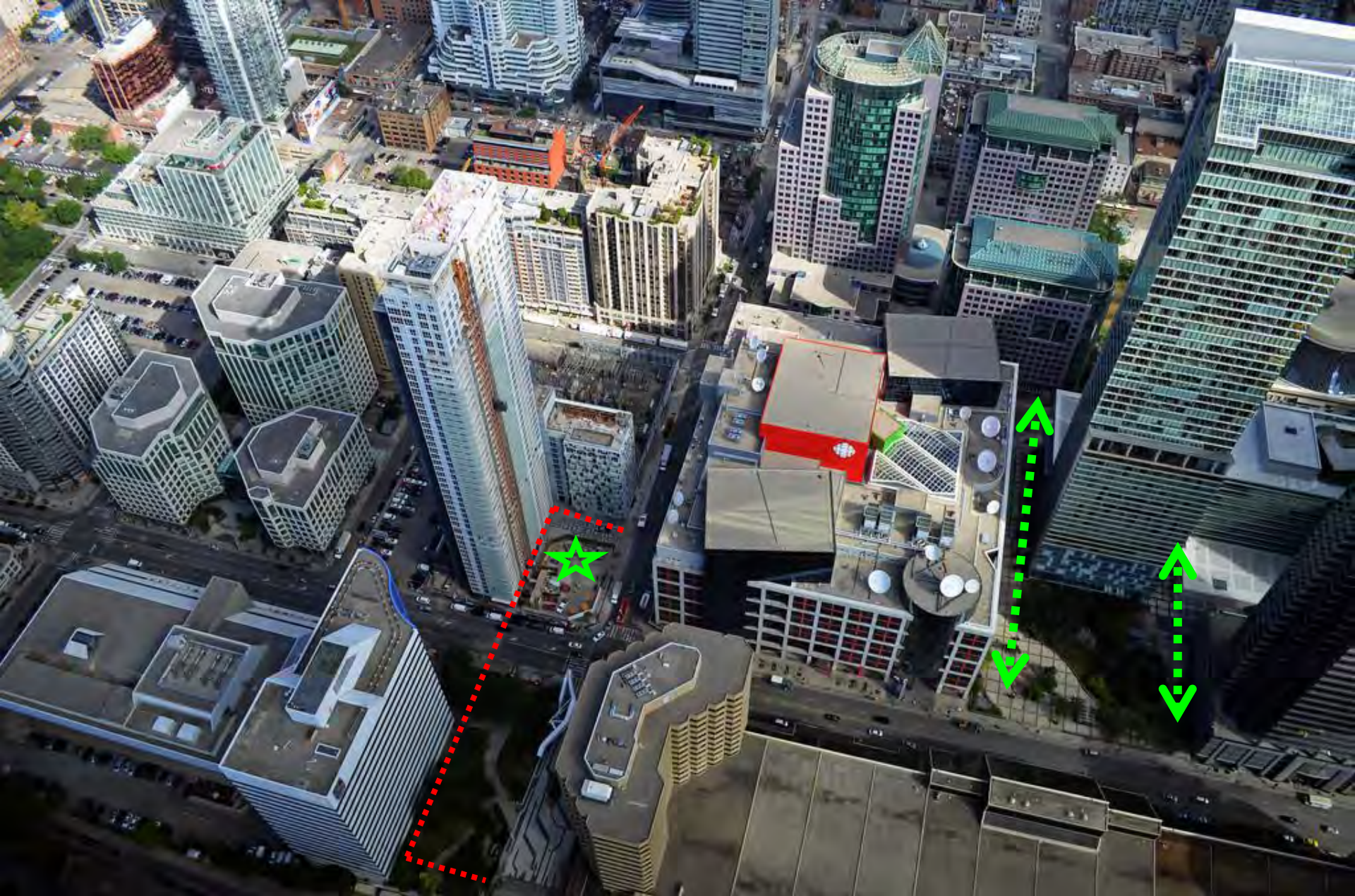

Simcoe Place – RBC / Ritz Carlton Hotel

2 Simcoe Place – Ritz Carlton & RBC

Downtown Keymap Note: POPS locations are approximate. Access to some POPS locations may be refused in certain circumstances.

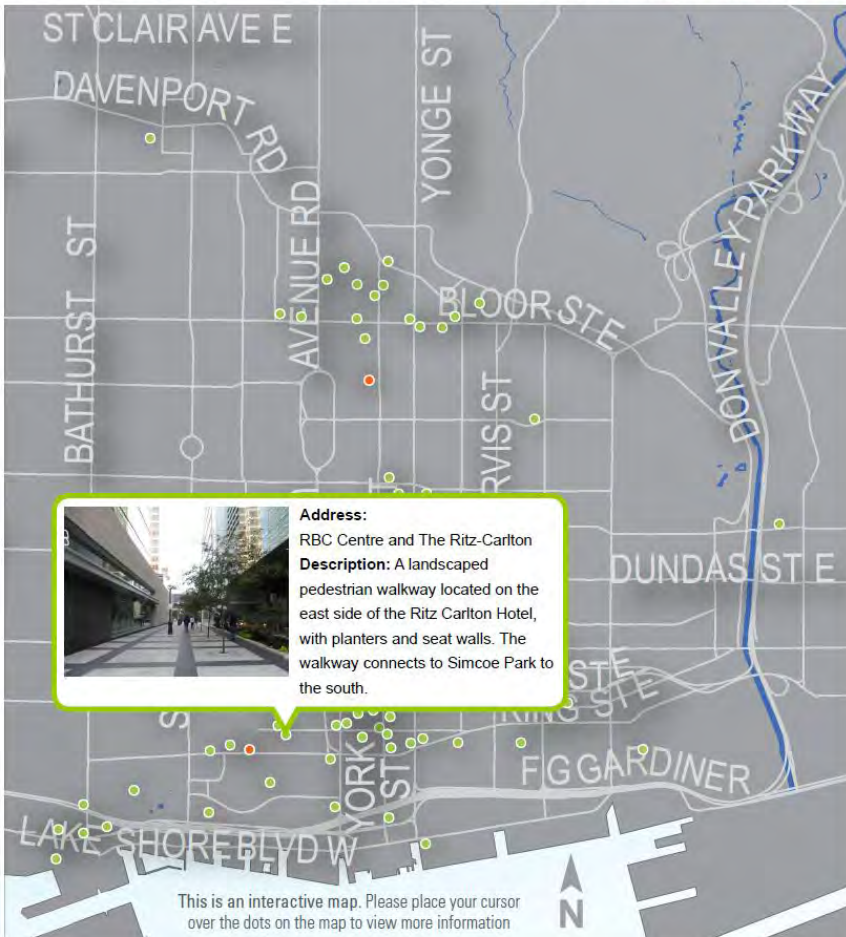

Address:
RBC Centre and The Ritz-Carlton

Description: A landscaped pedestrian walkway located on the east side of the Ritz Carlton Hotel, with planters and seat walls. The walkway connects to Simcoe Park to the south.

This is an interactive map. Please place your cursor over the dots on the map to view more information

 **Privately Owned Publicly-Accessible Space**
Creative Place Making to Enhance Urban Life

 **TORONTO**



Simcoe Place – RBC / Ritz Carlton Hotel



Simcoe Place – RBC / Ritz Carlton Hotel

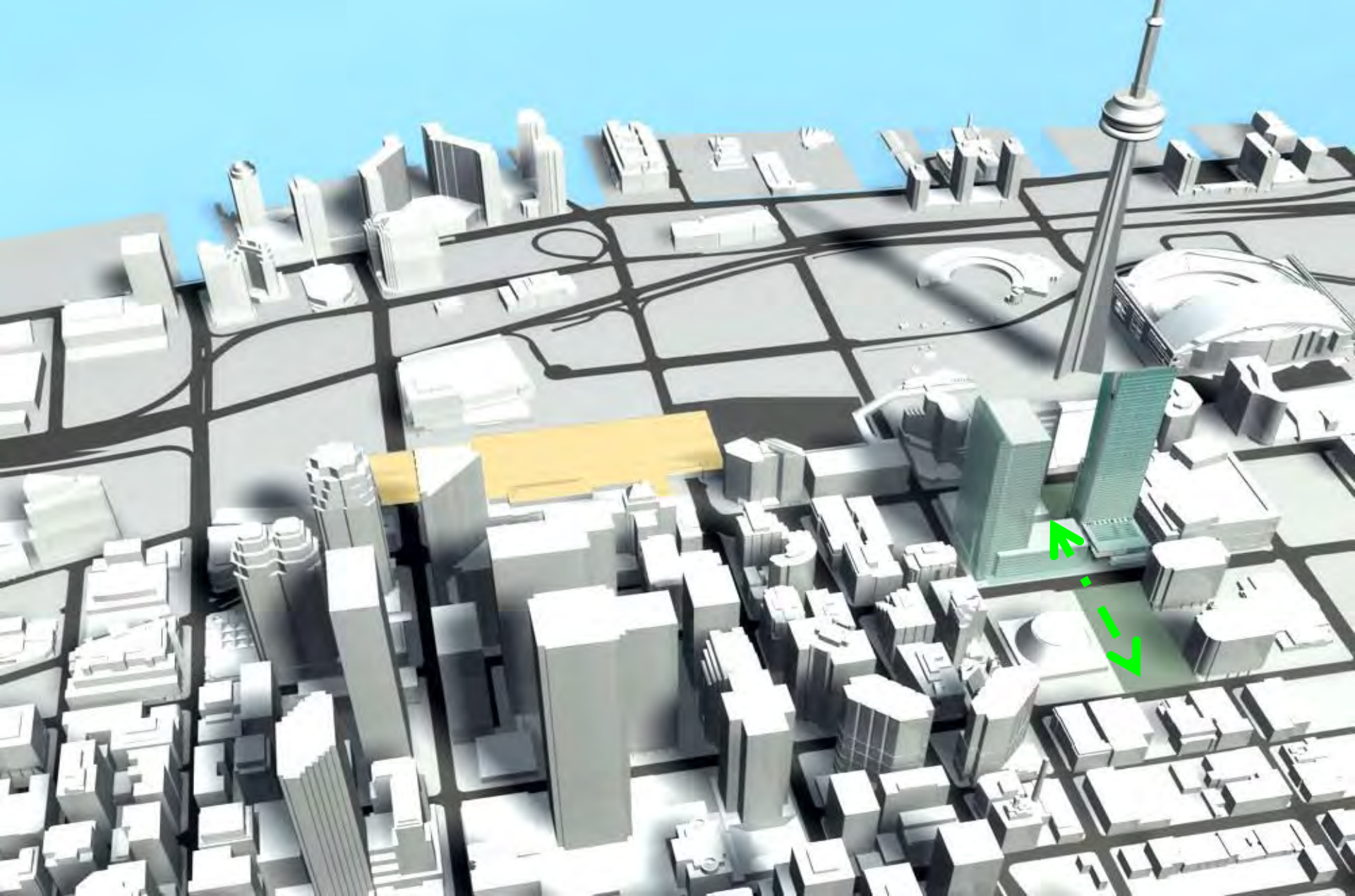

Simcoe Place – RBC / Ritz Carlton Hotel



Simcoe Place – RBC / Ritz Carlton Hotel



Simcoe Place – RBC / Ritz Carlton Hotel



Simcoe Place – RBC / Ritz Carlton Hotel

3. Four Seasons Hotel Rose Garden

Downtown Keymap Note: POPS locations are approximate. Access to some POPS locations may be refused in certain circumstances.

Address: Rose Garden
Description: A landscaped open space with a public art and misting fountain at Yorkville Avenue and Bay Streets.

This is an interactive map. Please place your cursor over the dots on the map to view more information

 **Privately Owned Publicly-Accessible Space**
Creative Place Making to Enhance Urban Life

 **TORONTO**

Toronto Urban Design Guidelines



Bloor-Yorkville/North Midtown



Four Season's Hotel – Rose Garden



Four Season's Hotel – Rose Garden



Four Season's Hotel – Rose Garden

AFTER



Four Season's Hotel – Rose Garden



Four Season's Hotel – Rose Garden



Four Season's Hotel – Rose Garden

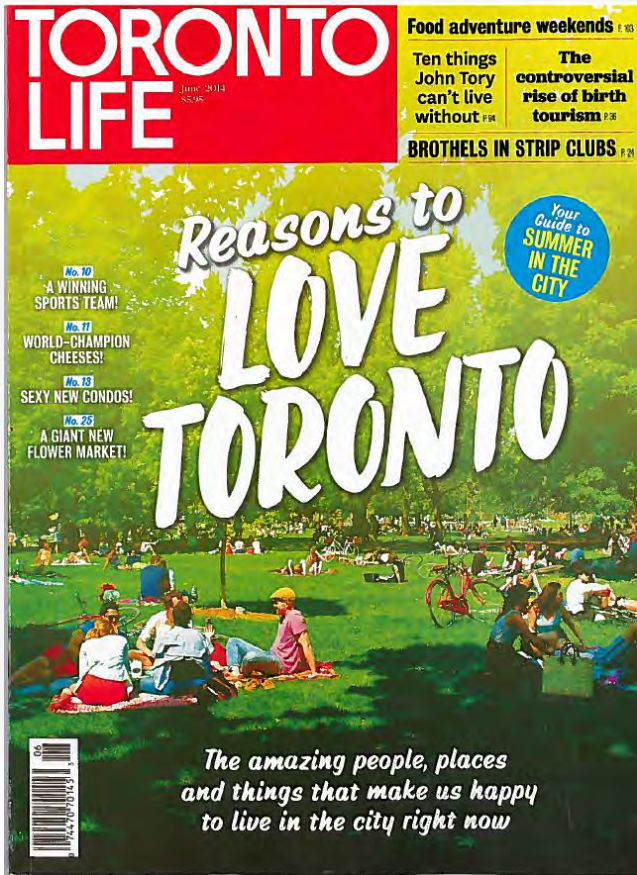

THE 10 MOST AMAZING THINGS IN TORONTO PARKS

Unmissable treasures we found while exploring the city's park system



CASTLE
The Jamie Bell Adventure Playground in High Park has awesome turrets and twisty slides.



PETER PAN
Glenn Gould Park's whimsical 14-foot sculpture is a copy of one in London's Kensington Gardens.



MEGA-SLIDE
Toronto's best playground slide is a 15-foot drop, built into the hill at Corktown Common.



DOG PATCH
The Brick Works' off-leash canine playground is a woodland retreat with lots of nooks for exploring.



TRAIN RIDE
The railway theme at Roundhouse Park extends to the mini-steam engine you can ride in the summertime.



VEGGIE PATCH
You can water the plants at the storybook-cute Franklin Children's Garden on Centre Island.



COOL ZONE
Misty Rose Garden next door to the Four Seasons incorporates a fog of fine cooling mists.



JAW-DROPPER
Bluffer's Park beach and gravel hiking trail are set against majestic vistas of the mighty bluffs.



SKATE PARK
Ashbridges Bay's smooth-as-silk 20,000-square-foot park is built using eco-friendly concrete.



STONE ART
Guildwood Park in Scarborough has a stately collection of dozens of stone sculptures and columns.



Four Season's Hotel – Rose Garden

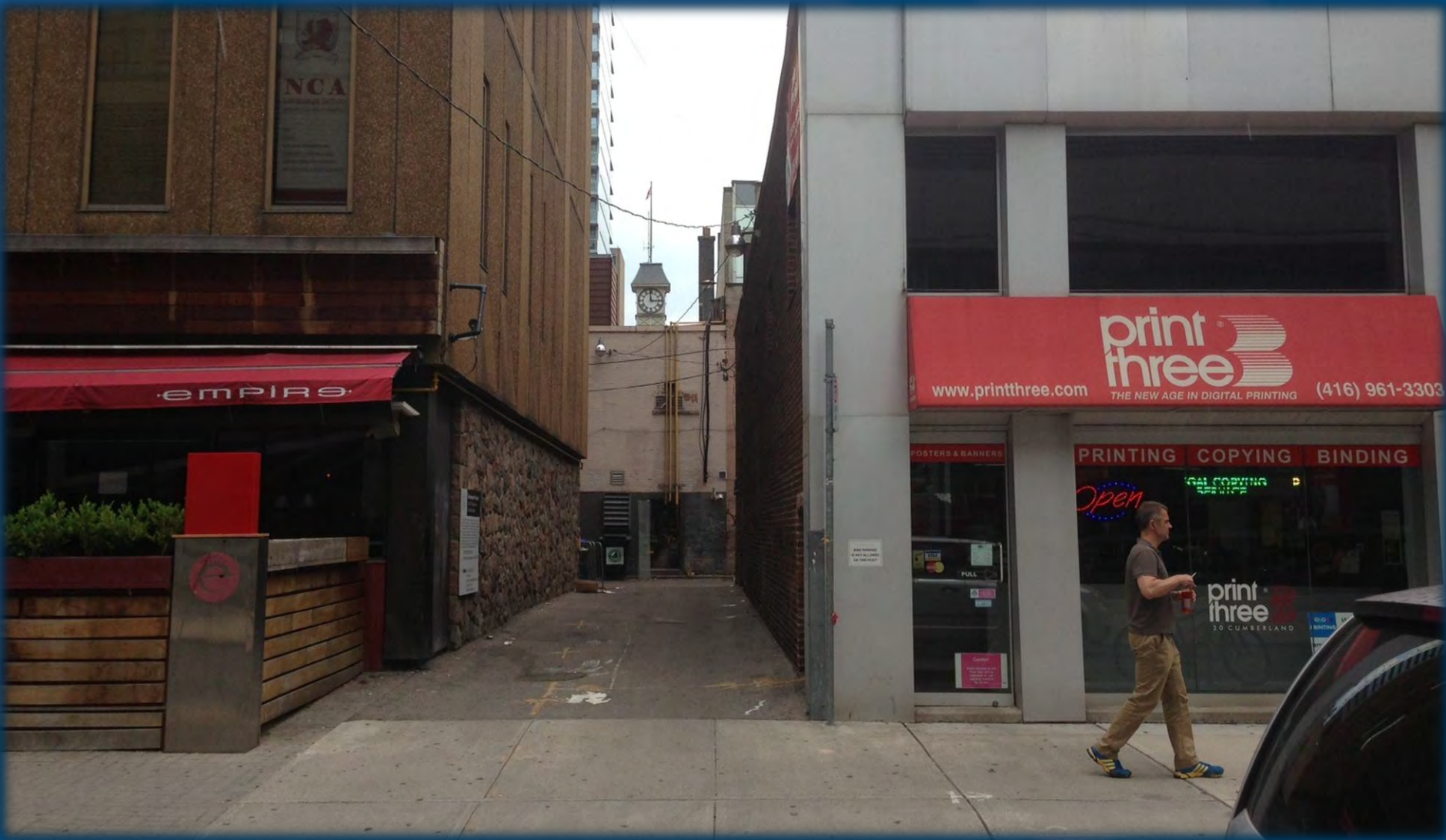

LOOKING NORTH FROM CUMBERLAND STREET



LOOKING NORTH FROM CUMBERLAND STREET



LOOKING NORTH FROM CUMBERLAND STREET

4. 50 St. Joseph Street

Downtown Keymap

Note: POPS locations are approximate. Access to some POPS locations may be refused in certain circumstances.

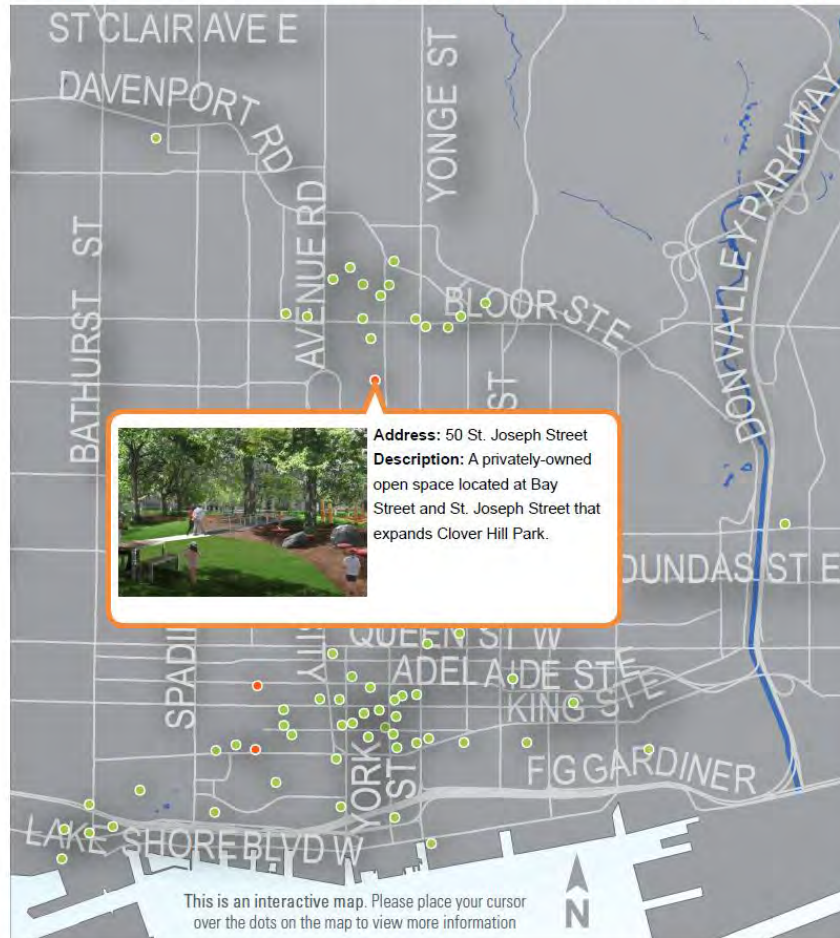

Privately Owned Publicly-Accessible Space

Creative Place Making to Enhance Urban Life





St. Joseph Street

Bay Street

Subway Sandv

50 St. Joseph Street

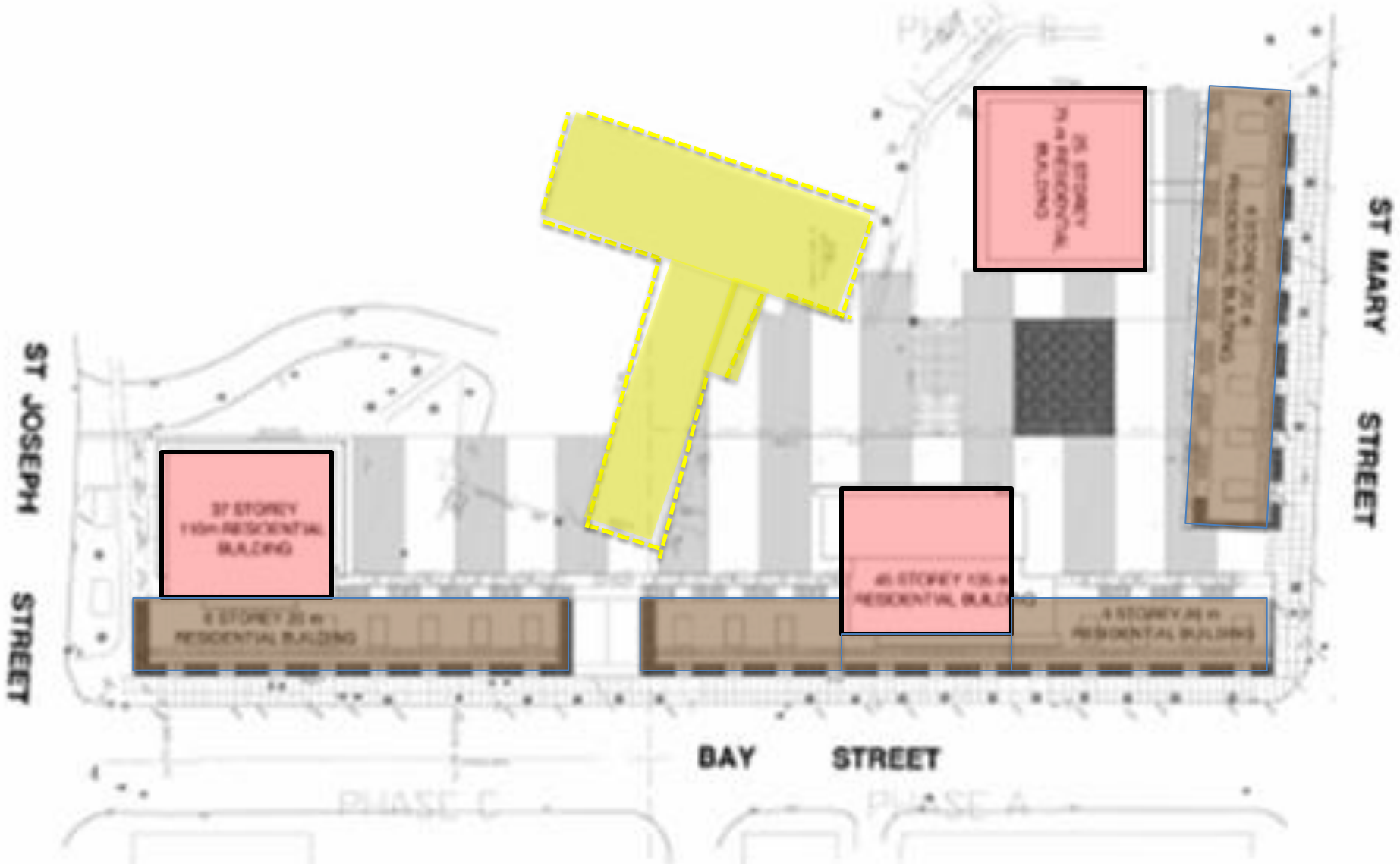

50 St. Joseph Street



50 St. Joseph Street / Cloverhill Park



50 St. Joseph Street / Cloverhill Park

5. Yonge Street & Alvin Avenue



Address: Yonge - Alvin
Pedestrian Corridor

Description: A parkette located near Yonge Street and St. Clair Avenue East with seating and water features.

Click for Close-up

This is an interactive map. Please place your cursor over the dots on the map to view more information

 **Privately Owned Publicly-Accessible Space**
Creative Place Making to Enhance Urban Life

Note: POPS locations are approximate. Access to some POPS locations may be refused in certain circumstances.





St. Clair / Alvin

YONGE

HEATH

ALVIN

St. Clair / Alvin





St. Clair / Alvin



St. Clair / Alvin



St. Clair / Alvin

6. 8 Eglinton Avenue East

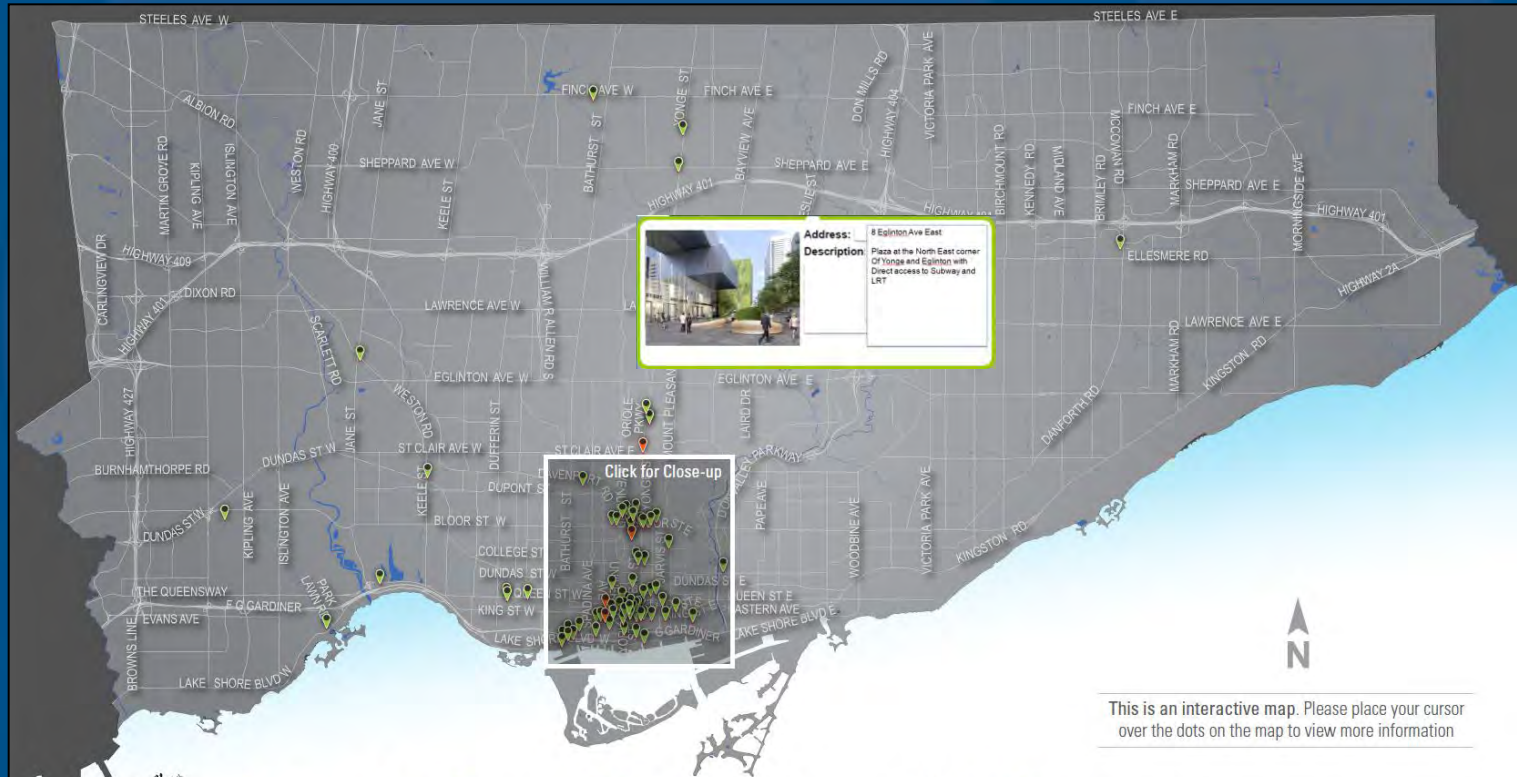

Privately Owned Publicly-Accessible Space

Creative Place Making to Enhance Urban Life

Note: POPS locations are approximate. Access to some POPS locations may be refused in certain circumstances.





8 Eglinton Avenue East



8 Eglinton Avenue East



8 Eglinton Avenue East

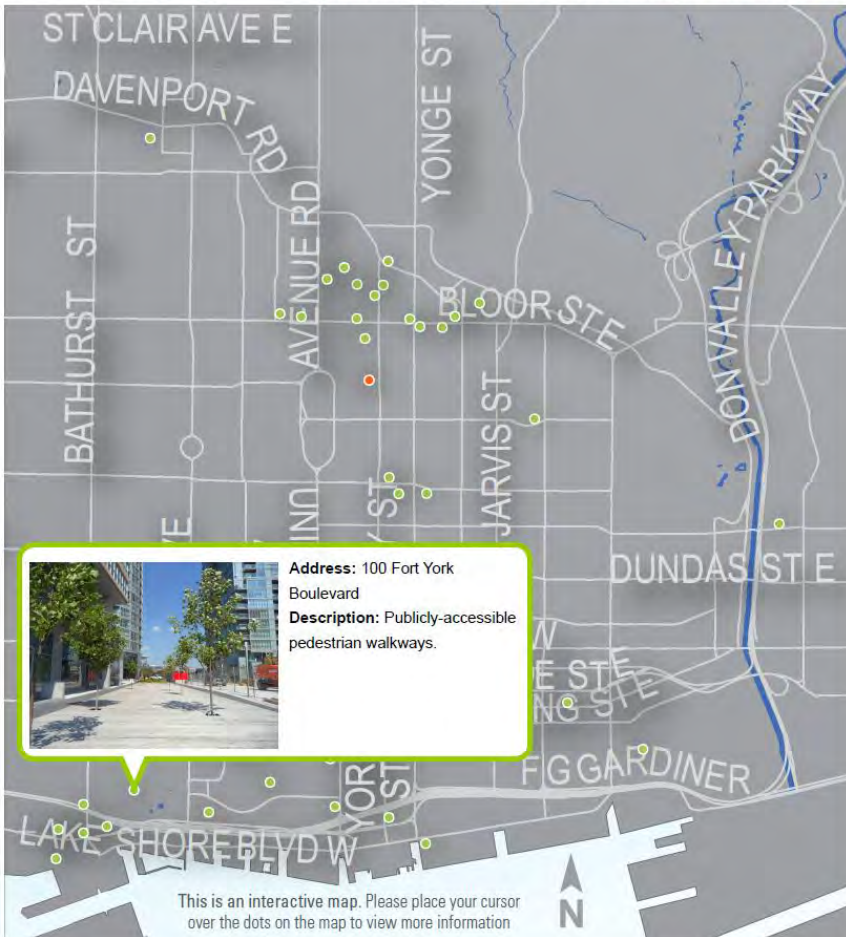

7. 100 Fort York Boulevard – Iceboat Terrace

Downtown Keymap Note: POPS locations are approximate. Access to some POPS locations may be refused in certain circumstances.



Address: 100 Fort York Boulevard
Description: Publicly-accessible pedestrian walkways.

This is an interactive map. Please place your cursor over the dots on the map to view more information

 **Privately Owned Publicly-Accessible Space**
Creative Place Making to Enhance Urban Life 



Iceboat Terrace – 100 Fort York Blvd.



Cityplace Farmers Market

PRODUCT ON OUR OWN FARM
All Natural
No Hormones
No Antibiotics

SPEERS FARMS AMARANTH
Orangeville, ON

ANGUS BEEF

STEAKS	ROASTS
Tenderloin & Rib Eye	Prime Rib Bone C
N.Y. Striploin	Prime Rib Bone C
T Bone	Sirloin
Baron Wrap	Eye of Round
Sirloin Medallions	Inside Round
Sirloin	Outside Round
Blade	Brisket
Flank	Cross Rib
Hanger	Short Rib
Skirt	Blade
Flat Iron	

OTHER CUTS

- Sausage
- Franks
- Patties
- Ground Beef
- Stewing Beef
- Kabob Meat
- Pepperettes
- Braising Ribs
- Texas Ribs
- Liver
- Sliced Liver
- Kidneys
- Heart
- Tongue
- Ox Tail
- Soup Bones
- Dog Bones

Dry Aged 21 Days

Beef on a bun
Beef
Beef
Kids hot dog
Pommes
Add egg, onion
Sweet potato, onion
Water or pop
Apple, Orange or Y

Iceboat Terrace – 100 Fort York Blvd.



Iceboat Terrace – 100 Fort York Blvd.

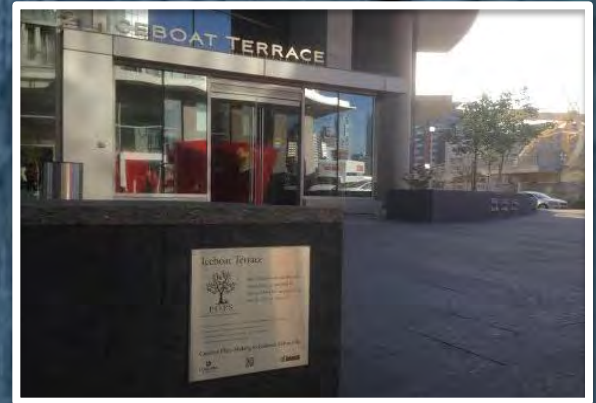
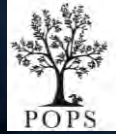

Iceboat Terrace – 100 Fort York Blvd.



Iceboat Terrace – 100 Fort York Blvd.



Iceboat Terrace – 100 Fort York Blvd.

Photography Tom Arban

8. North Downtown Urban Design Study

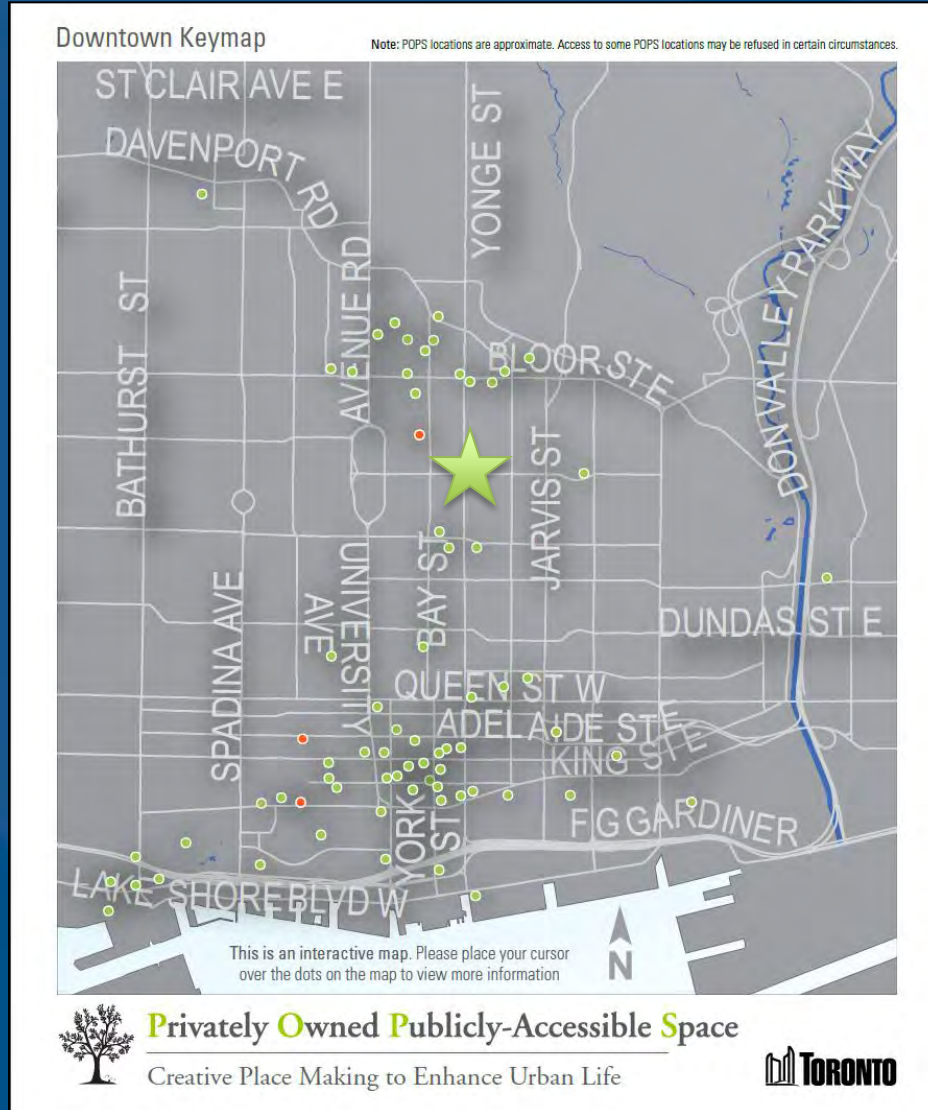

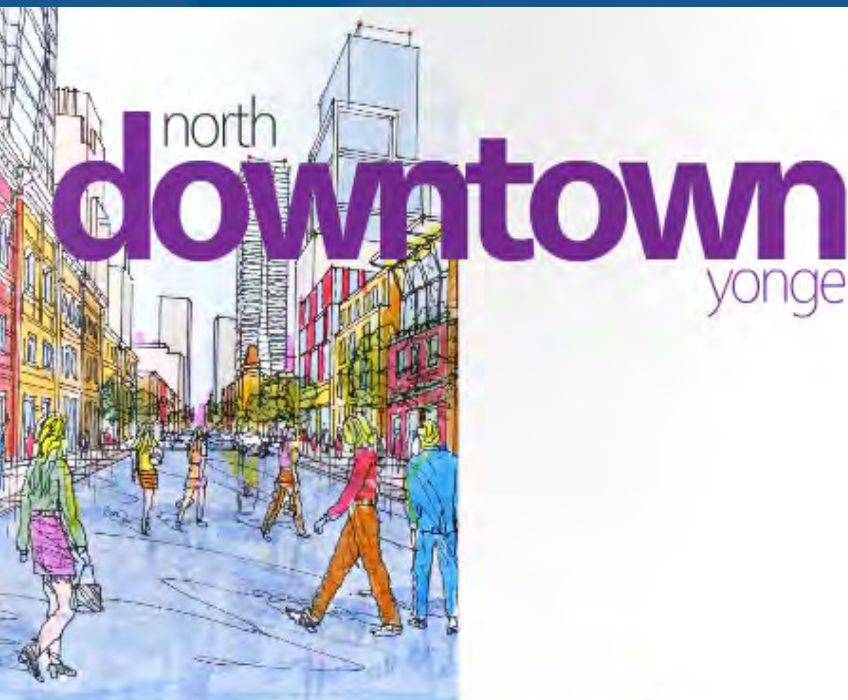

north downtown yonge

The North Downtown Yonge Area Specific Official Plan Policies and Urban Design Guidelines provide the necessary vision and implementation tools to create a unique sense of place in a dynamic mixed use community.

These policies provide direction and guidance for the built form and the public realm. They accommodate both local and regional needs and support a diversity of housing, employment, and recreational opportunities in this transit-integrated community.

OVERVIEW

In response to the Downtown Tall Buildings Study and to address the quantity and type of new development occurring in the area, City Planning undertook the North Downtown Yonge Street Planning Framework (NDYPF) and community consultation. The original direction of the NDYPF was to provide area-specific urban design guidelines, but as the study process evolved it was determined that a planning framework should also be provided through an Official Plan Amendment with area-specific policies. In late 2012, City Council adopted both the urban design guidelines and Official Plan Amendment, delivering to the community a policy framework and design direction to shape the future of the neighbourhood where they live, work, and play.

COMMUNITY CONSULTATION:

Active community involvement was a critical component throughout the study. Planning staff led a comprehensive consultation process for the North Downtown Yonge Study that included a variety of engagement techniques, including the development of a fully accessible webpage, area walks, series of open houses, a minicharette, and a working group.

STUDY PLANNING OBJECTIVES

- Focus on the built form of the area.
- Respect the area's extensive heritage attributes.
- Identify places and streets of special interest.
- Improve the pedestrian experience.
- Recognize and identify opportunities to increase open space.

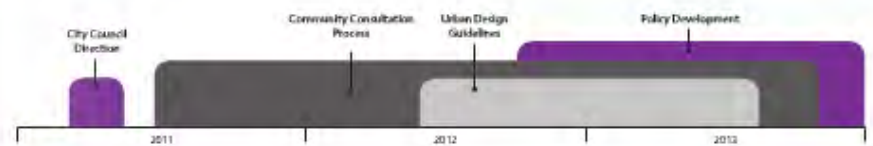
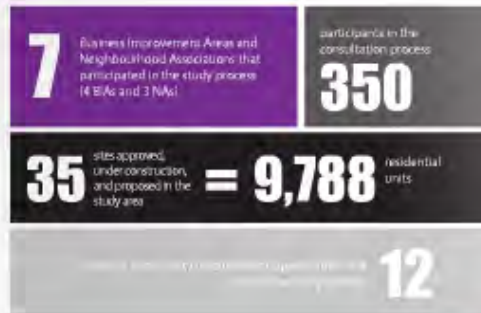

North Downtown Yonge Study



North Downtown Yonge Study



North Downtown Yonge Study

9. Union Plaza / Maple Leaf Square

Downtown Keymap Note: POPS locations are approximate. Access to some POPS locations may be refused in certain circumstances.

Address: Union Plaza – 25 York Street

Description: The New South Entrance to Union Station opens up to this New civic plaza which is a focal Point for many sports-related gatherings

This is an interactive map. Please place your cursor over the dots on the map to view more information

Privately Owned Publicly-Accessible Space
Creative Place Making to Enhance Urban Life

TORONTO



25 York Street – Union Plaza



Pan Am
TORONTO
2015



AIR CANADA CENTRE

NO
STANDING
→



25 York Street – Union Plaza



25 York Street – Union Plaza – “Maple Leaf Square”



25 York Street – Union Plaza – “Jurassic Park”



PLANNING A GREAT CITY
TOGETHER

POPS

Urban Design Guidelines

Urban Design Guidelines



POPS

Creative Place Making to Enhance Urban Life

PRIVATELY-OWNED PUBLICLY ACCESSIBLE SPACES

URBAN DESIGN
GUIDELINES

June 2014

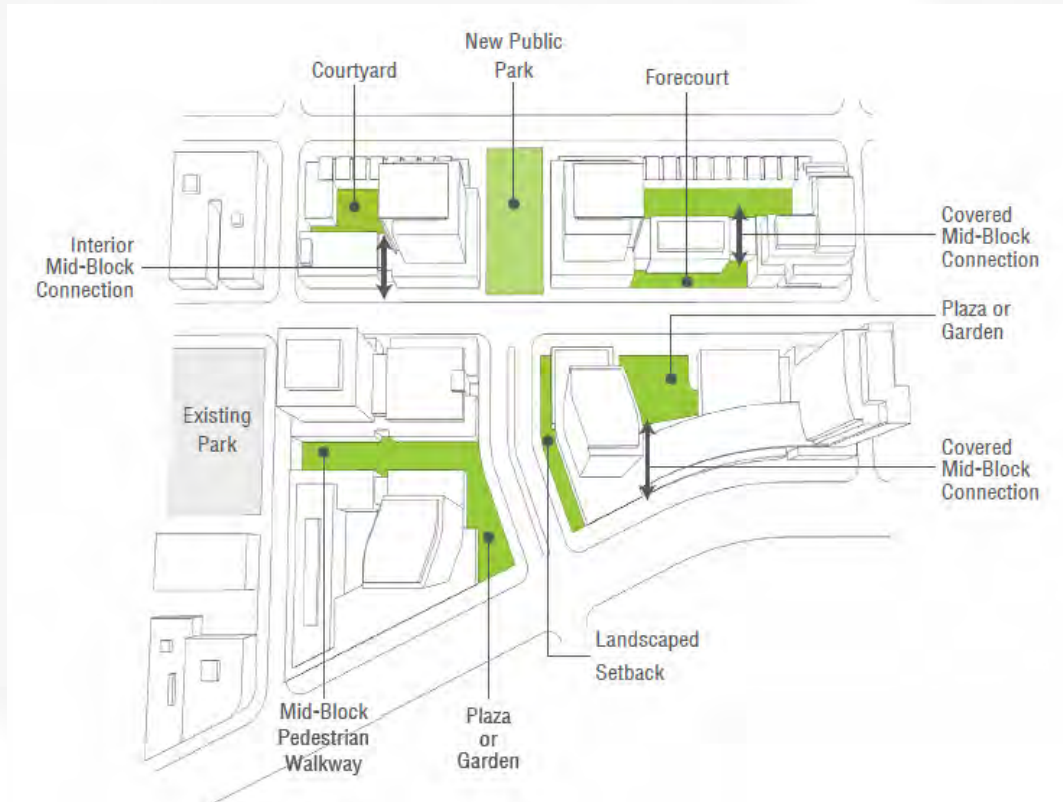

Table of Contents

1. Introduction	1
What are POPS?	1
Role of Parks & Open Space in City Building	2
Purpose of the Design Guidelines	4
2. Role of POPS in the Open Space Network	5
2.1 Creating a Network of Open Spaces	6
2.2 Enhancing Building & Site Program	8
2.3 Respecting & Celebrating Natural & Cultural Heritage	9
3. Open Space Classifications	11
3.1 Courtyards	12
3.2 Plaza	13
3.3 Urban Gardens	14
3.4 Walkways / Mid-Block Pedestrian Connections	15
3.5 Forecourts	16
3.6 Landscaped Setbacks	17
3.7 Publicly-Accessible Interior Pedestrian Connections	18
4. Design	19
4.1 Pedestrian Comfort	19
4.2 Pedestrian Access & Circulation	20
4.3 Public Safety	20
4.4 Active Edges	21
4.5 Building Servicing	21
5. Elements	23
5.1 Seating	23
5.2 Public Art	24
5.3 Soft Landscaping	25
5.4 Paving & Surface Materials	26
5.5 Lighting	26
5.6 Weather Protection	27
5.7 Other Amenities	28
6. POPS Signage	29
6.1 Signage Design	30
6.2 Signage Placement	31
Appendix A - References	32
Appendix B - Glossary	33

Urban Design Guidelines

2.1 Creating a Network of Open Spaces



- Filling in gaps
- Creating new focal points
- Protecting important views
- Enlivening the public realm.

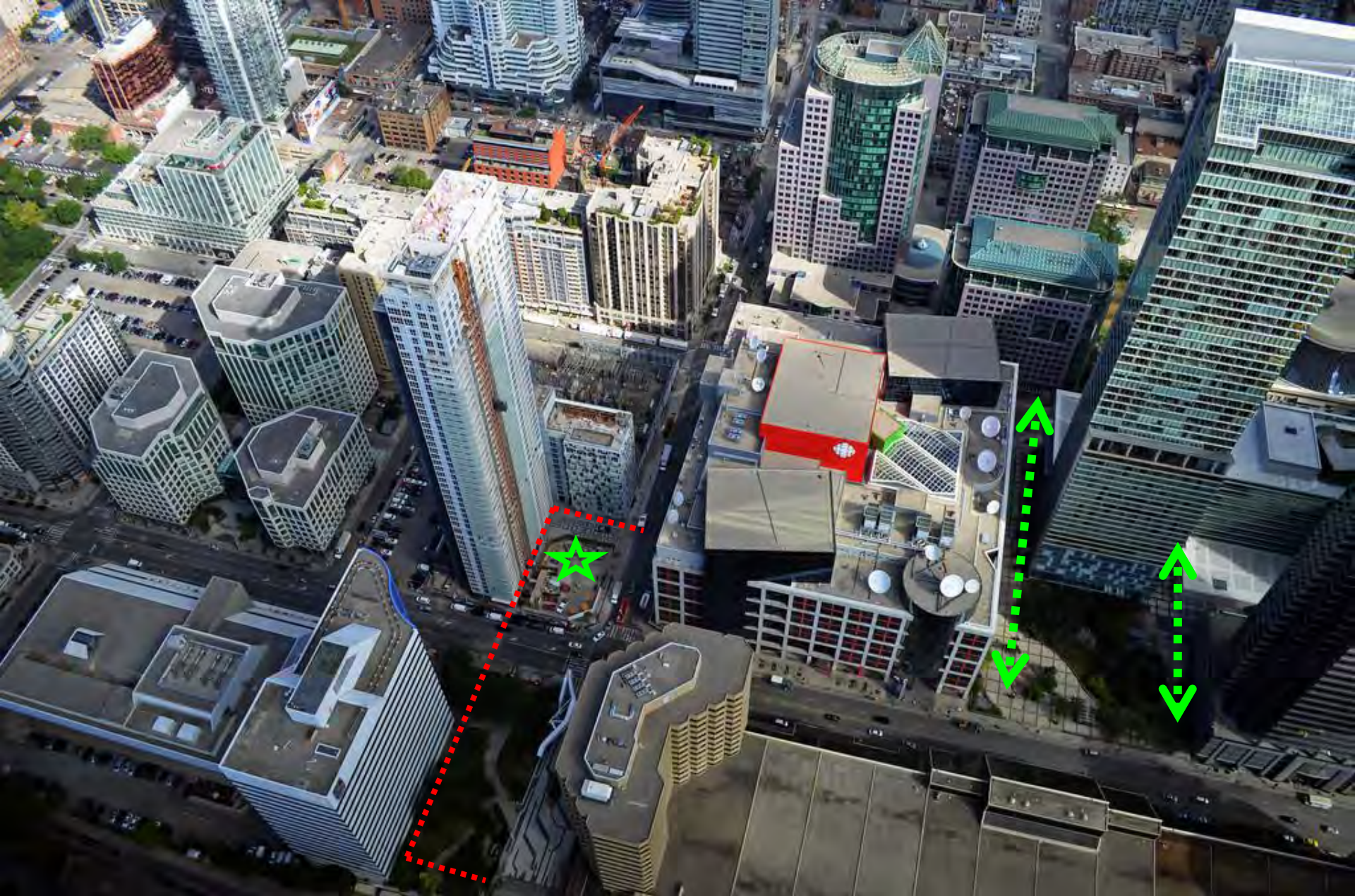

Urban Design Guidelines

2.3 Respecting & Celebrating Heritage



- Use POPS highlight important views
- Use public art / amenities to highlight heritage
- Ensure appropriate setbacks

Urban Design Guidelines

3.0 Open Space Types

- Courtyards
- Plazas
- Urban Gardens
- Walkways / Mid-Block Pedestrian Connections
- Forecourts
- Landscaped Setbacks
- Publicly-Accessible Interior Pedestrian Connections



Urban Design Guidelines

4.1 Pedestrian Comfort



- Maximize sky-views & sunlight
- Minimize adverse wind conditions

Urban Design Guidelines

4.3 Public Safety



- Crime Prevention Through Environmental Design
- Visible from public streets & spaces
- Pedestrian scale lighting
- Materials & amenities that are durable

Urban Design Guidelines

5.1 Seating

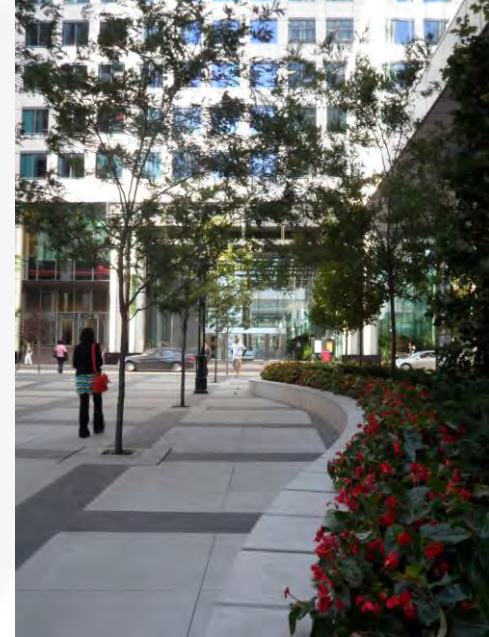

"People tend to sit where there are places to sit"
(William Whyte, *Social Life of Small Urban Spaces*)

- Seating options – sun, shade, groups, alone, movable, fixed
- Multi-functional – terrain, planter walls

Urban Design Guidelines

5.5 Lighting



- Lighting contributes to usability and safety
- Can be used creatively and artfully

Urban Design Guidelines

5.7 Other Amenities



- Program & space dependent
- Bike racks, dog fountains, playground equipment
- Durable and high quality

Thank You

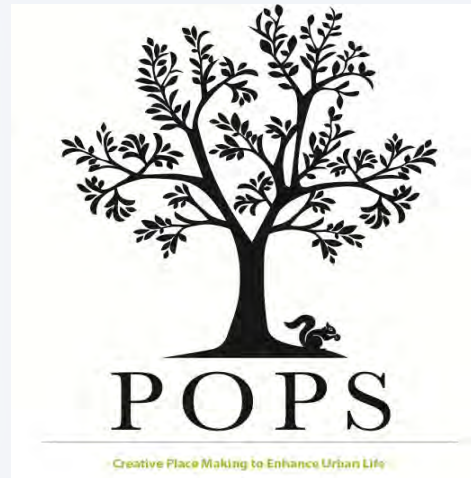

www.toronto.ca/planning/pops

