

APPENDIX B
At-Grade Section Retaining Wall Inventory

RETAINING WALLS	LOCATION	LENGTH (m)
RW 1	B/W F.G GARDINER EXPY AND HWY 427 TO F.G GARDINER EXPY EB RAMP ALONG W SIDE OF THE EAST MALL	25
RW 2	B/W F.G GARDINER EXPY AND HWY 427 TO F.G GARDINER EXPY EB RAMP ALONG E SIDE OF THE EAST MALL	22
RW 3	S OF HWY 427 TO F.G. GARDINER EXPY EB RAMP ALONG E SIDE OF THE EAST MALL	126
RW 4	WEST OF WICKMAN RD. ALONG S SIDE OF F.G GARDINER EXPY	450
RW 5	EAST OF WICKMAN RD. ALONG S SIDE OF F.G. GARDINER EXPY	201
RW 6	ALONG N SIDE OF F.G. GARDINER EXPY AT ZORRA ST.	75
RW 7	SOUTH OF F.G. GARDINER EXPY ALONG N SIDE OF CNR OVERHEAD	35
RW 8	NORTH OF F.G. GARDINER EXPY ALONG S SODE OF CNR OVERHEAD	94
RW 9	AT S OF LAKESHORE BLVD. W UNDERPASS	16
RW 10	AT NW OF JAMESON AVE UNDERPASS	33
RW 11	AT SW OF JAMESON AVE. UNDERPASS	18
RW 12	AT SE OF JAMESON AVE. UNDERPASS	26
RW 13	AT NE OF JAMESON AVE. UNDERPASS	24
RW 14	AT NE OF LAKESHORE BLVD. W UNDERPASS	24
RW 15	AT SW OF LAKESHORE BLVD. W UNDERPASS	15
RW 16	W OF DUFFERIN AVE. UNDERPASS ALONG S SIDE OF F.G. GARDINER EXPY	435
RW 17	AT NW OF DUFFERIN AVENUE UNDERPASS	27
RW 18	AT NE OF DUFFERIN AVENUE UNDERPASS	15
RW 19	E OF DUFFERIN AVE. UNDERPASS ALONG S SIDE OF F.G. GARDINER EXPY	160
TOTAL		1821

RETAINING WALLS WITH PARAPET	LOCATION	LENGTH (m)
RWP 1	ALONG S SIDE OF BROWNS LINE TO F.G GARDINER EXPY EB	200
RWP 2	WEST OF WICKMAN RD. ALONG N SIDE OF F.G. GARDINER EXPY	470
RWP 3	EAST OF WICKMAN RD. TO KIPLING AVENUE ALONG N SIDE OF F.G GARDINER EXPY	420
RWP 4	WEST OF ISLINGTON AVENUE ALONG N SIDE OF F.G. GARDINER EXPY	147
RWP 5	EAST OF ISLINGTON AVENUE ALONG S SIDE OF F.G. GARDINER EXPY	536
RWP 6	AT SW OF ROYAL YORK RD. UNDERPASS	104
RWP 7	AT NW OF ROYAL YORK RD. UNDERPASS	76
RWP 8	AT NW OF PARKLAWN OVERPASS	14
RWP 9	AT SW OF PARKLAWN OVERPASS	17
RWP 10	AT NE OF PARKLAWN OVERPASS	16
RWP 11	AT SE OF PARKLAWN OVERPASS	22
RWP 12	W OF LAKESHORE OFFRAMP ALONG S SIDE OF F.G. GARDINER EXPY	23
RWP 13	E OF LAKESHORE WB OFFRAMP ALONG S SIDE OF F.G. GARDINER EXPY	89
RWP 14	E OF LAKESHORE EB ONRAMP ALONG N SIDE OF LAKESHORE EB OFFRAMP	77
RWP 15	E OF LAKESHORE WB OFFRAMP ALONG S SIDE OF F.G. GARDINER EXPY	58
RWP 16	E OF LAKESHORE WB OFFRAMP ALONG N SIDE OF F.G. GARDINER EXPY	190
RWP 17	W OF TTC ALONG S SIDE OF LAKESHORE EB OFFRAMP	100
RWP 18	E OF TTC ALONG S SIDE OF LAKESHORE EB OFFRAMP	155
RWP 19	AT SW OF WINDERMERE RD. OVERPASS	35
RWP 20	AT NW OF WINDERMERE RD. OVERPASS	11
RWP 21	AT NE OF WINDERMERE RD. OVERPASS	12
RWP 22	E OF WINDERMERE RD. ALONG S SIDE OF GARDINER EXPY	245
RWP 23	AT NW OF ELLIS AVENUE OVERPASS	13
RWP 24	AT SE OF ELLIS AVENUE OVERPASS	35
RWP 25	AT NE OF ELLIS AVENUE OVERPASS	10
RWP 26	AT SW OF COLBORNE LODGE OVERPASS	11
RWP 27	AT NW OF COLBORNE LODGE OVERPASS	13
RWP 28	AT NE OF COLBORNE LODGE OVERPASS	13
RWP 29	AT SE OF COLBORNE LODGE OVERPASS	11
RWP 30	AT SW OF PARKSIDE DRIVE OVERPASS	11
RWP 31	AT NW OF PARKSIDE DRIVE OVERPASS	12
RWP 32	AT NE OF PARKSIDE DRIVE OVERPASS	12
RWP 33	AT SE OF PARKSIDE DRIVE OVERPASS	11
RWP 34	W OF DOWLING AVENUE ALONG S OF F.G. GARDINER EXPY	174
RWP 35	E OF DOWLING AVENUE ALONG S OF F.G. GARDINER EXPY	68
RWP 36	W OF JAMESON AVENUE ALONG N SIDE OF F.G. GARDINER EXPY	85
RWP 37	AT NW OF LAKESHORE BLVD. W OVERPASS	51
RWP 38	AT SE OF LAKESHORE BLVD. W OVERPASS	24
TOTAL		3571

NOISE WALLS	LOCATION	LENGTH (m)
NW 1	E OF ISLINGTON AVENUE TO ROYAL YORK RD. ALONG S SIDE OF F.G. GARDINER EXPY	834
NW 2	E OF ROYAL YORK RD. ALONG N SIDE OF F.G. GARDINER EXPY	490
NW 3	E OF ROYAL YORK RD. TO GRAND AVE. ALONG S SIDE OF F.G. GARDINER EXPY	650
NW 4	E OF GRAND AVE. ALONG N SIDE OF F.G. GARDINER EXPY	180
TOTAL		2154

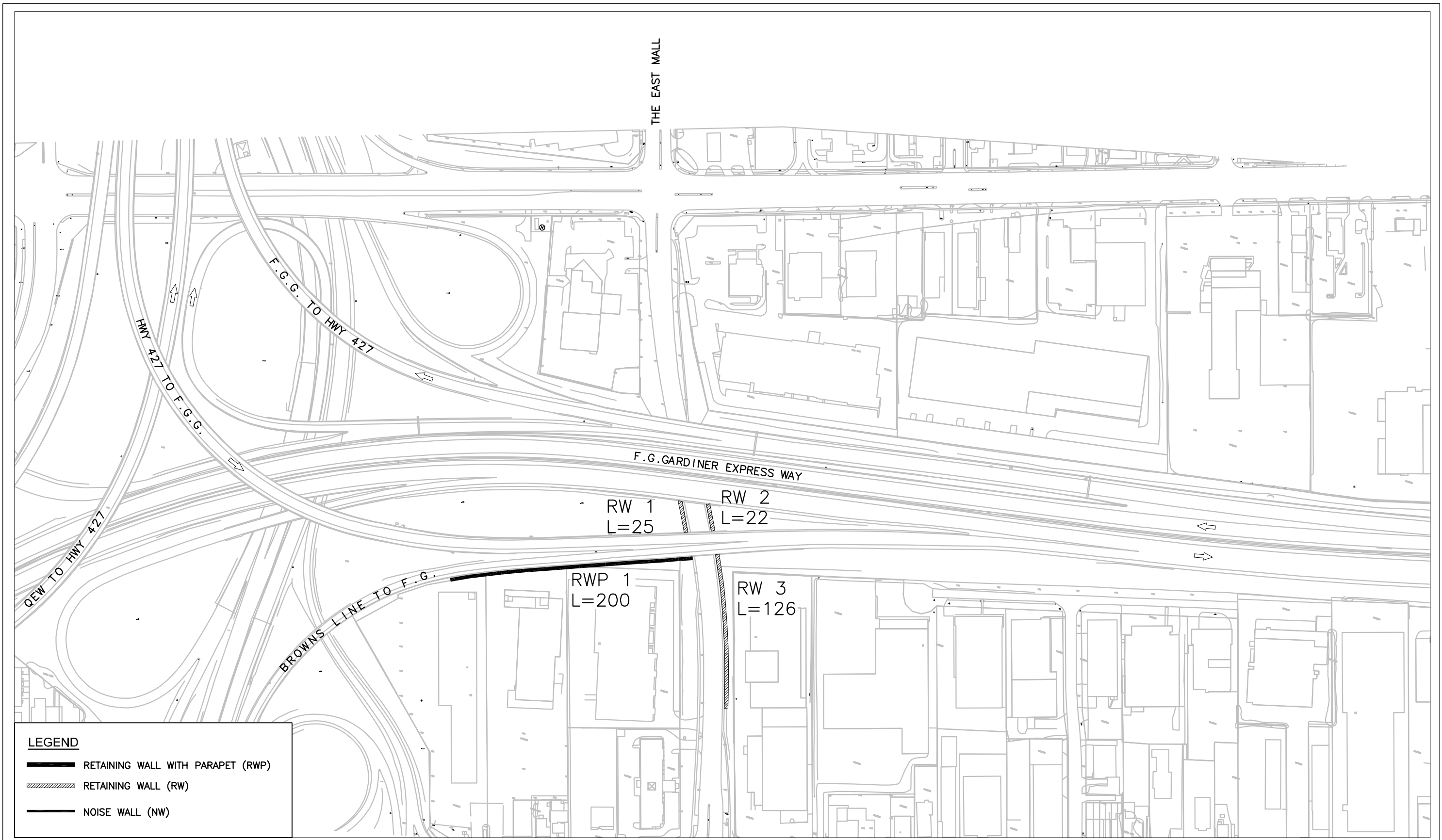

LEGEND

	RETAINING WALL WITH PARAPET (RWP)
	RETAINING WALL (RW)
	NOISE WALL (NW)



AT-GRADE SECTION RETAINING WALL KEYPLAN
(1)

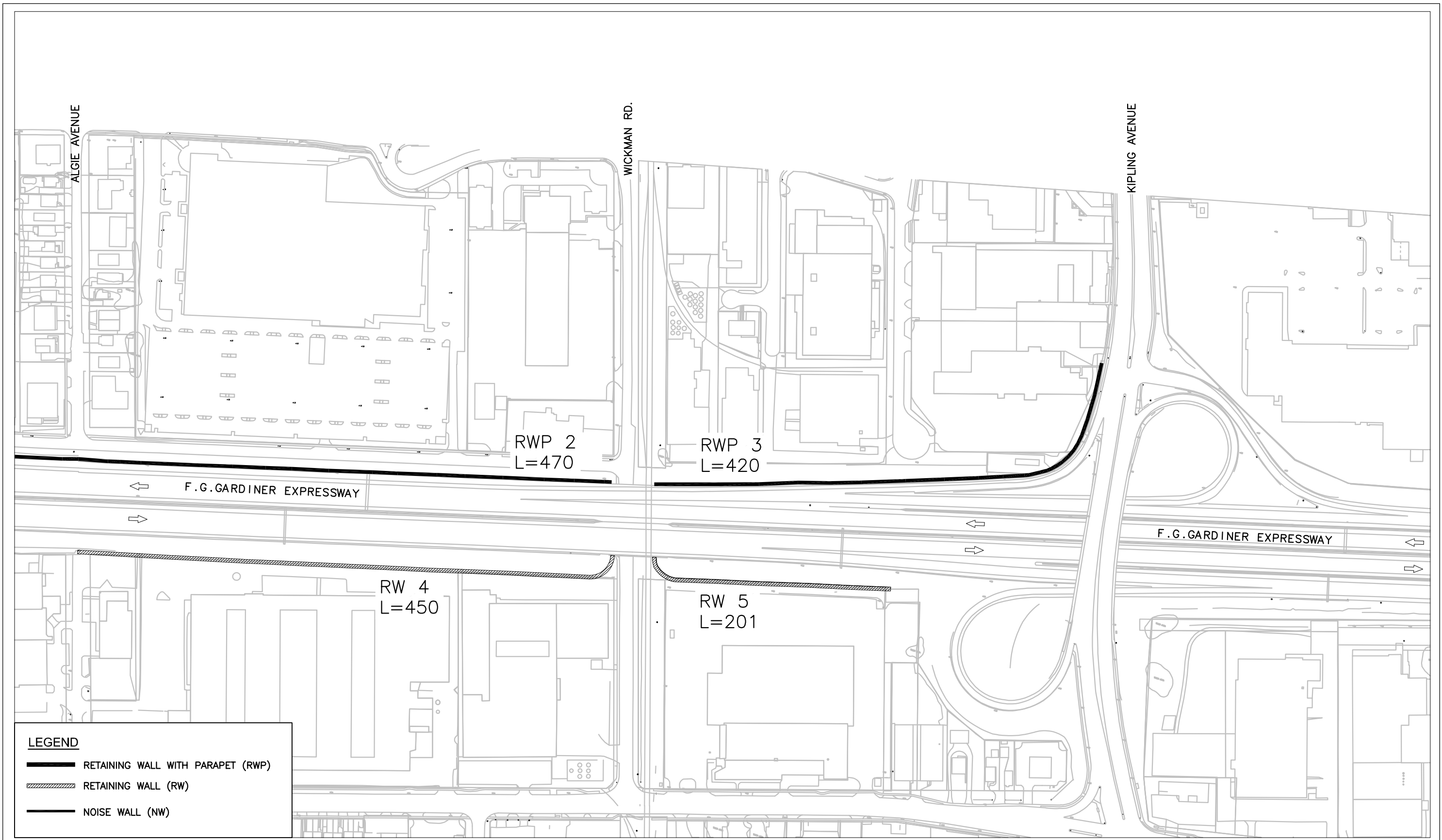

STRATEGIC PLAN FOR REHABILITATION OF
F.G. GARDINER EXPRESSWAY
APPENDIX B - AT-GRADE SECTION RETAINING WALL INVENTORY

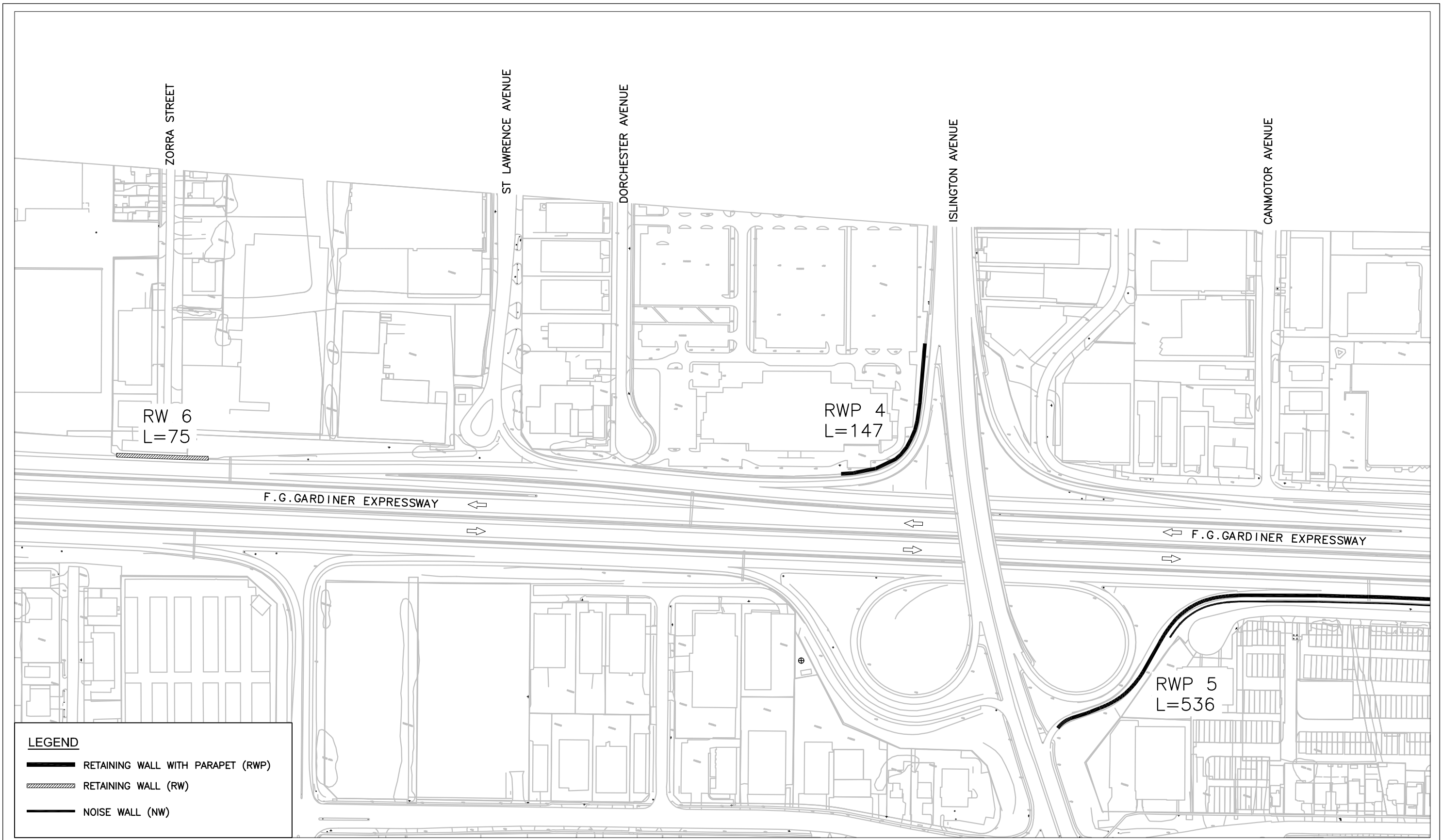

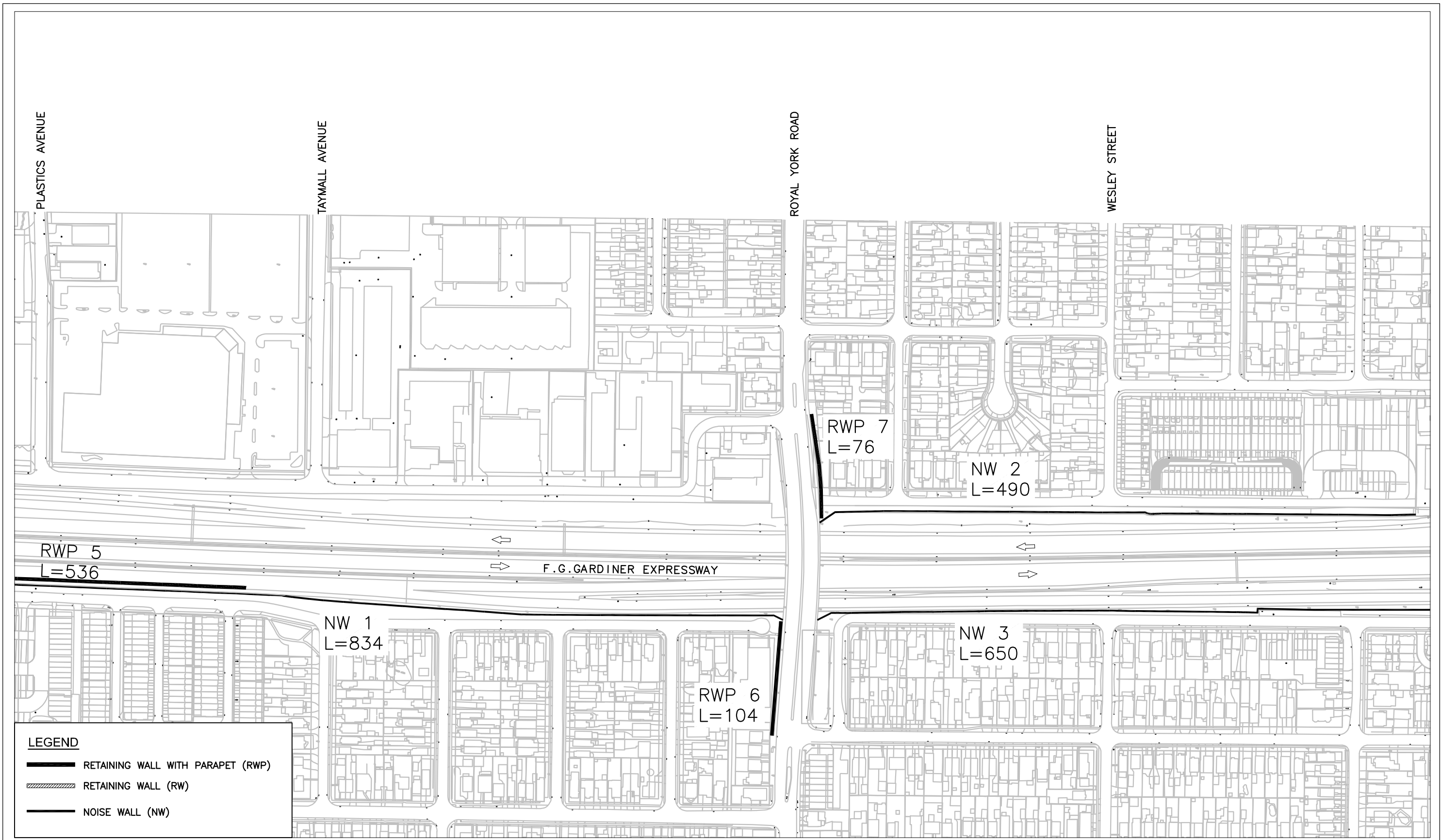

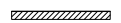

LEGEND

-  RETAINING WALL WITH PARAPET (RWP)
-  RETAINING WALL (RW)
-  NOISE WALL (NW)



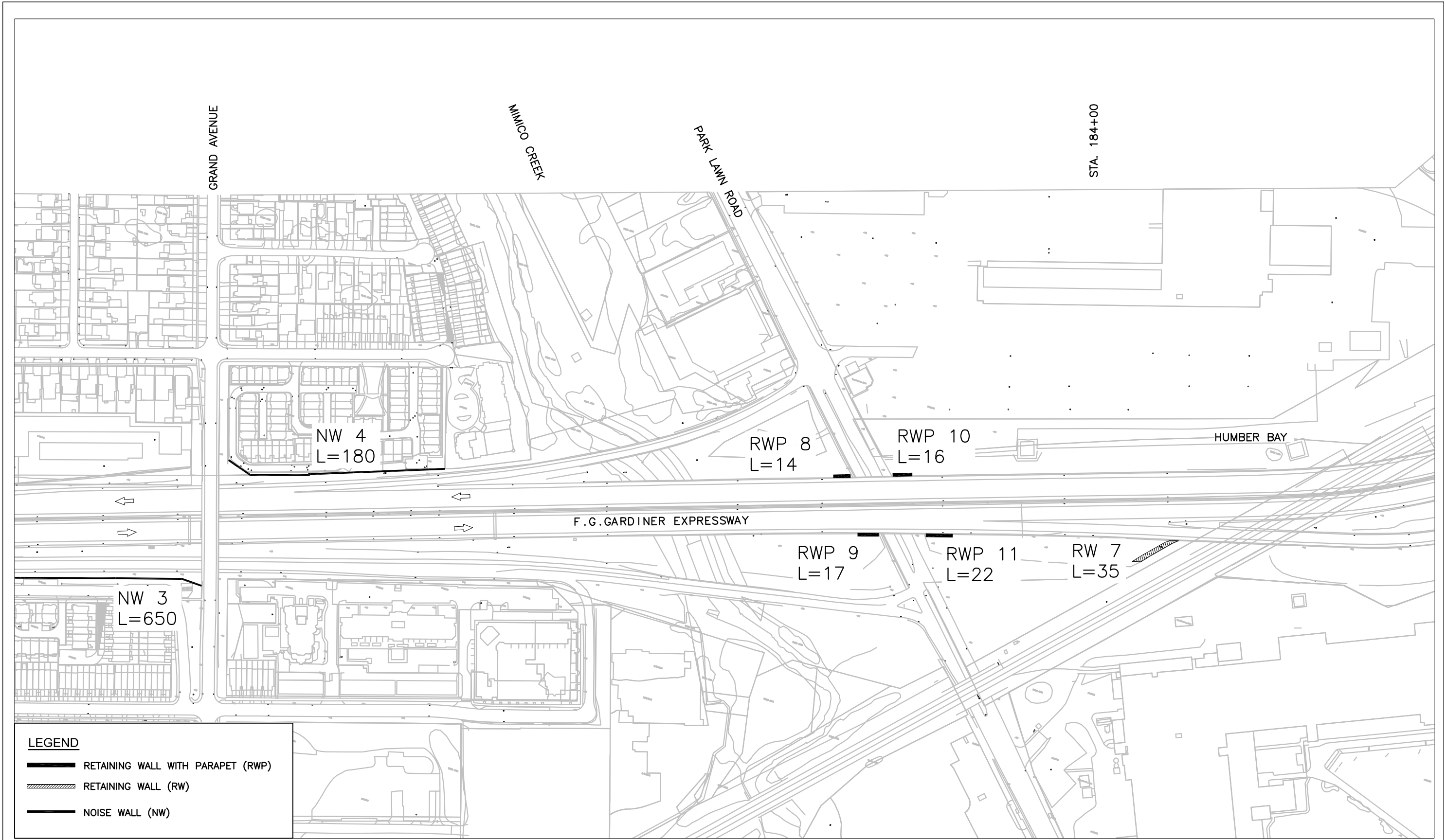

AT-GRADE SECTION RETAINING WALL KEYPLAN
(4)

STRATEGIC PLAN FOR REHABILITATION OF
F.G. GARDINER EXPRESSWAY
APPENDIX B - AT-GRADE SECTION RETAINING WALL INVENTORY

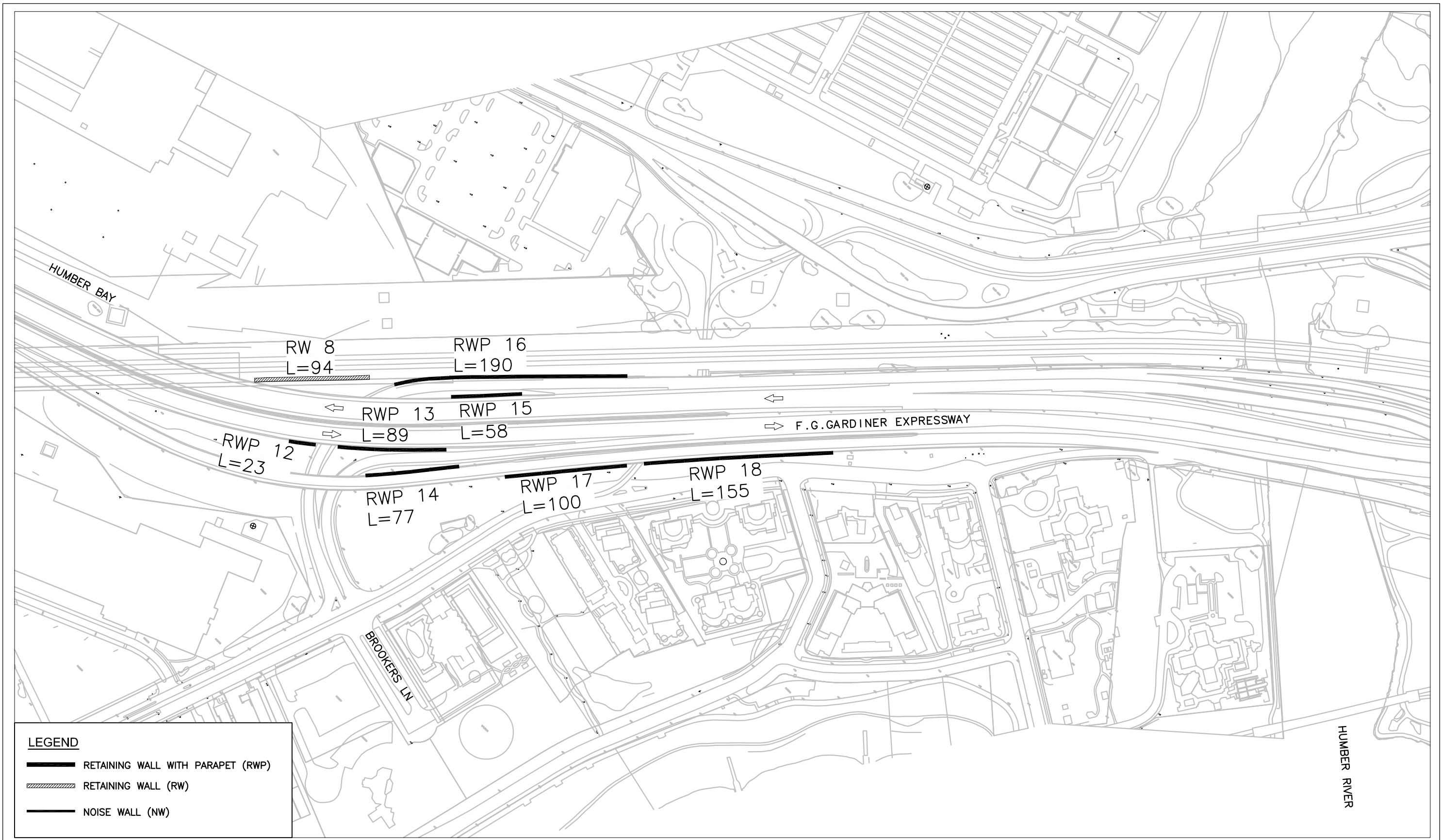



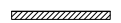

LEGEND

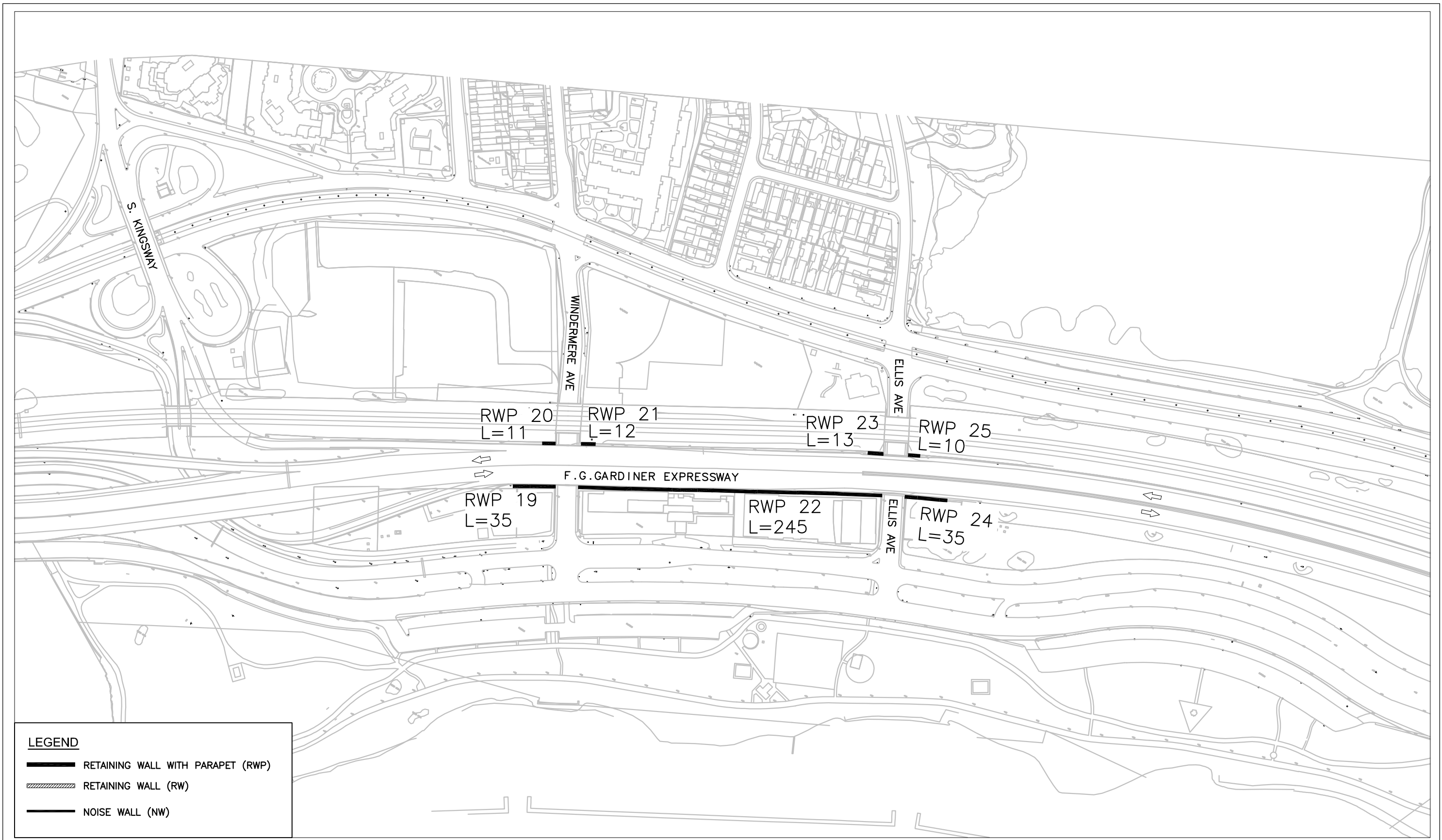
-  RETAINING WALL WITH PARAPET (RWP)
-  RETAINING WALL (RW)
-  NOISE WALL (NW)

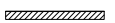

LEGEND

-  RETAINING WALL WITH PARAPET (RWP)
-  RETAINING WALL (RW)
-  NOISE WALL (NW)

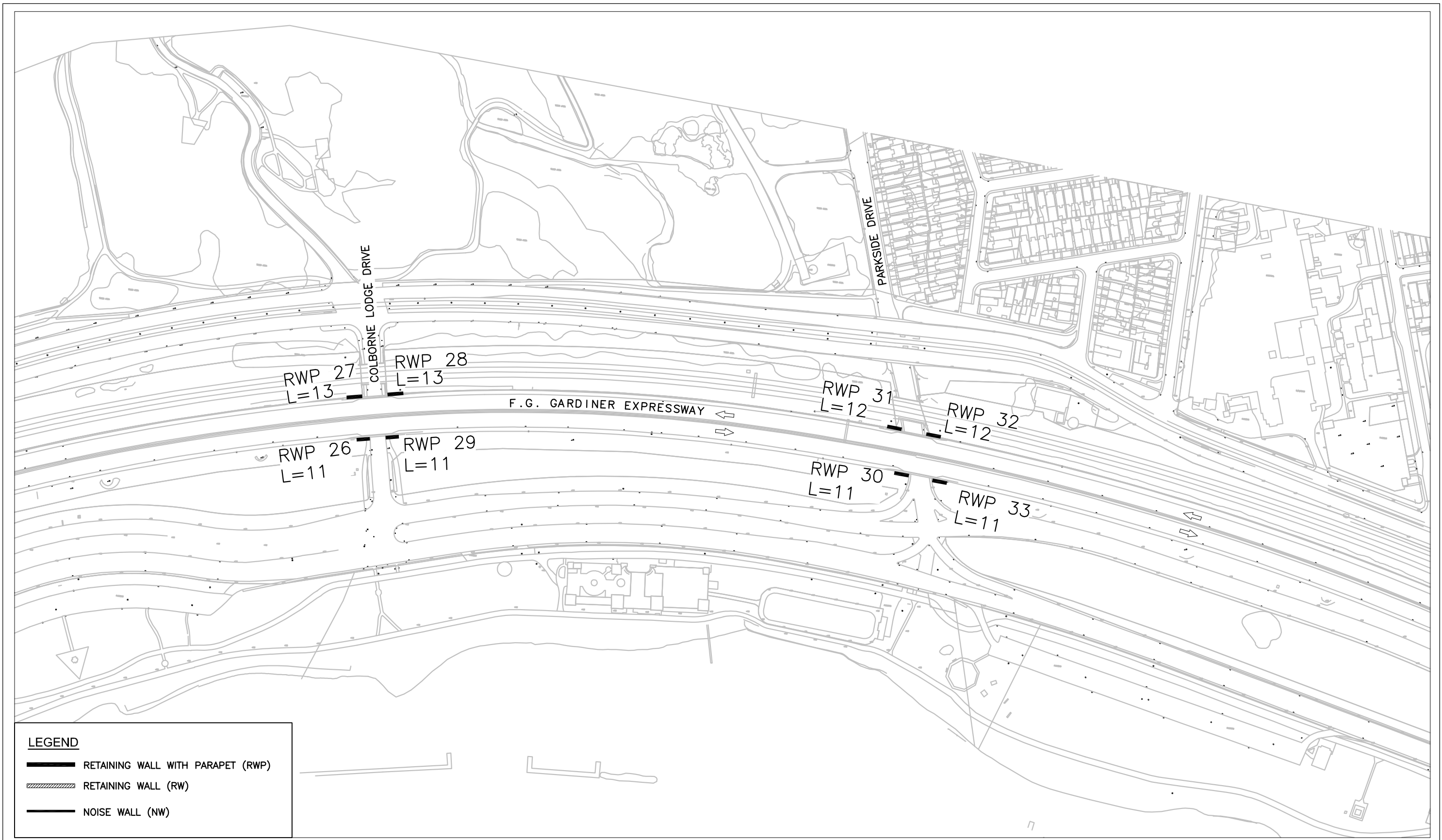

LEGEND

- RETAINING WALL WITH PARAPET (RWP)
- RETAINING WALL (RW)
- NOISE WALL (NW)

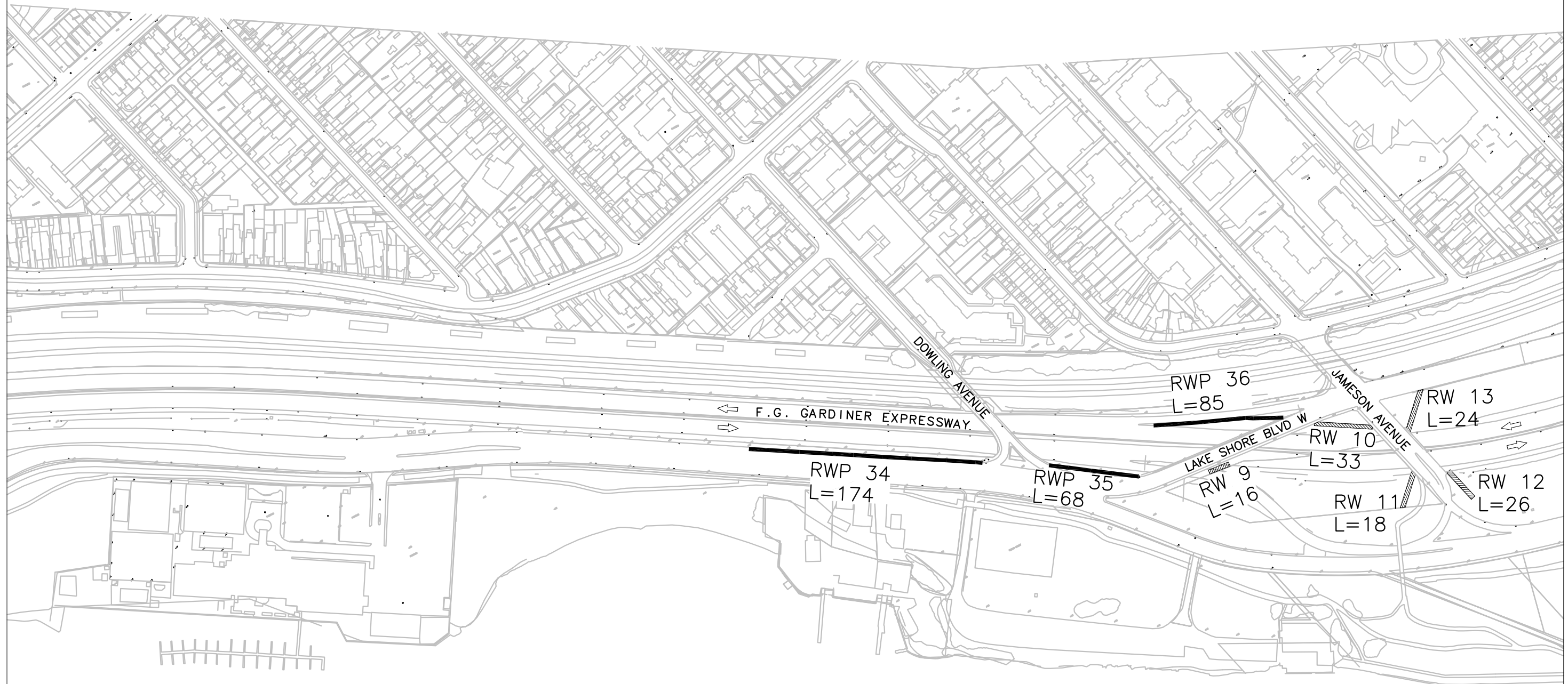

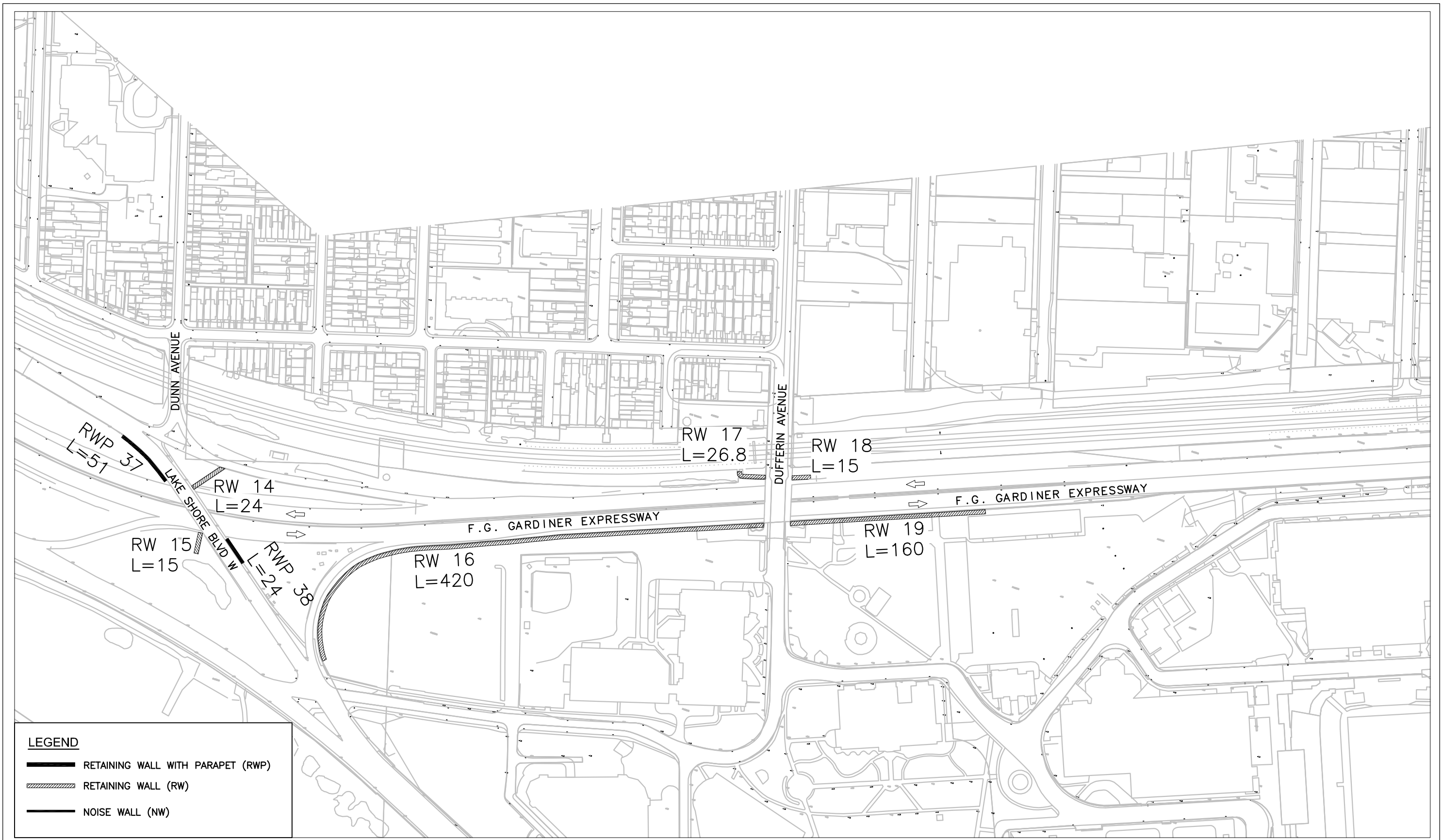

LEGEND

	RETAINING WALL WITH PARAPET (RWP)
	RETAINING WALL (RW)
	NOISE WALL (NW)

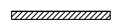

LEGEND

-  RETAINING WALL WITH PARAPET (RWP)
-  RETAINING WALL (RW)
-  NOISE WALL (NW)



AT-GRADE SECTION RETAINING WALL KEYPLAN
(10)

STRATEGIC PLAN FOR REHABILITATION OF
F.G. GARDINER EXPRESSWAY
APPENDIX B - AT-GRADE SECTION RETAINING WALL INVENTORY