

Authority: Etobicoke and York Community Council EY4- , as adopted by City of Toronto Council on March 31, 2014

CITY OF TORONTO

Bill No.

BY-LAW No. -2015

To permanently close a portion of Highway 27 abutting the rail corridor east of Highway 27 between Bethridge Road and Vulcan Street

WHEREAS it is recommended that a portion of Highway 27 abutting the rail corridor east of Highway 27 between Bethridge Road and Vulcan Street, designated as Parts 2, 3, 7, 8, 9 and 10 on Reference Plan 66R-26522 be permanently closed as a public highway; and

WHEREAS notice of the proposed by-law to permanently close the above-referenced portion of Highway 27 was posted on the notices page of the City's web site in accordance with the requirements of City of Toronto Municipal Code Chapter 162 and no one appeared to address the Etobicoke and York Community Council at its meeting held on February 18, 2015;

The Council of the City of Toronto enacts:

1. A portion of Highway 27 abutting the rail corridor east of Highway 27 between Bethridge Road and Vulcan Street, described as follows, is hereby permanently closed as a public highway:

Firstly:

Part of Lot 26, Concession 2 Fronting the Humber designated as Part 2 on Plan 66R-26522, City of Toronto;

Secondly:

Part of Lot 26, Concession 2 Fronting the Humber designated as Part 3 on Plan 66R-26522, City of Toronto; and

Thirdly:

Part of Lot 26, Concession 2 Fronting the Humber designated as Parts 7, 8, 9 and 10 on Plan 66R-26522, City of Toronto.

Enacted and passed on _____, 2015.

Frances Nunziata,
Speaker

Ulli S. Watkiss,
City Clerk

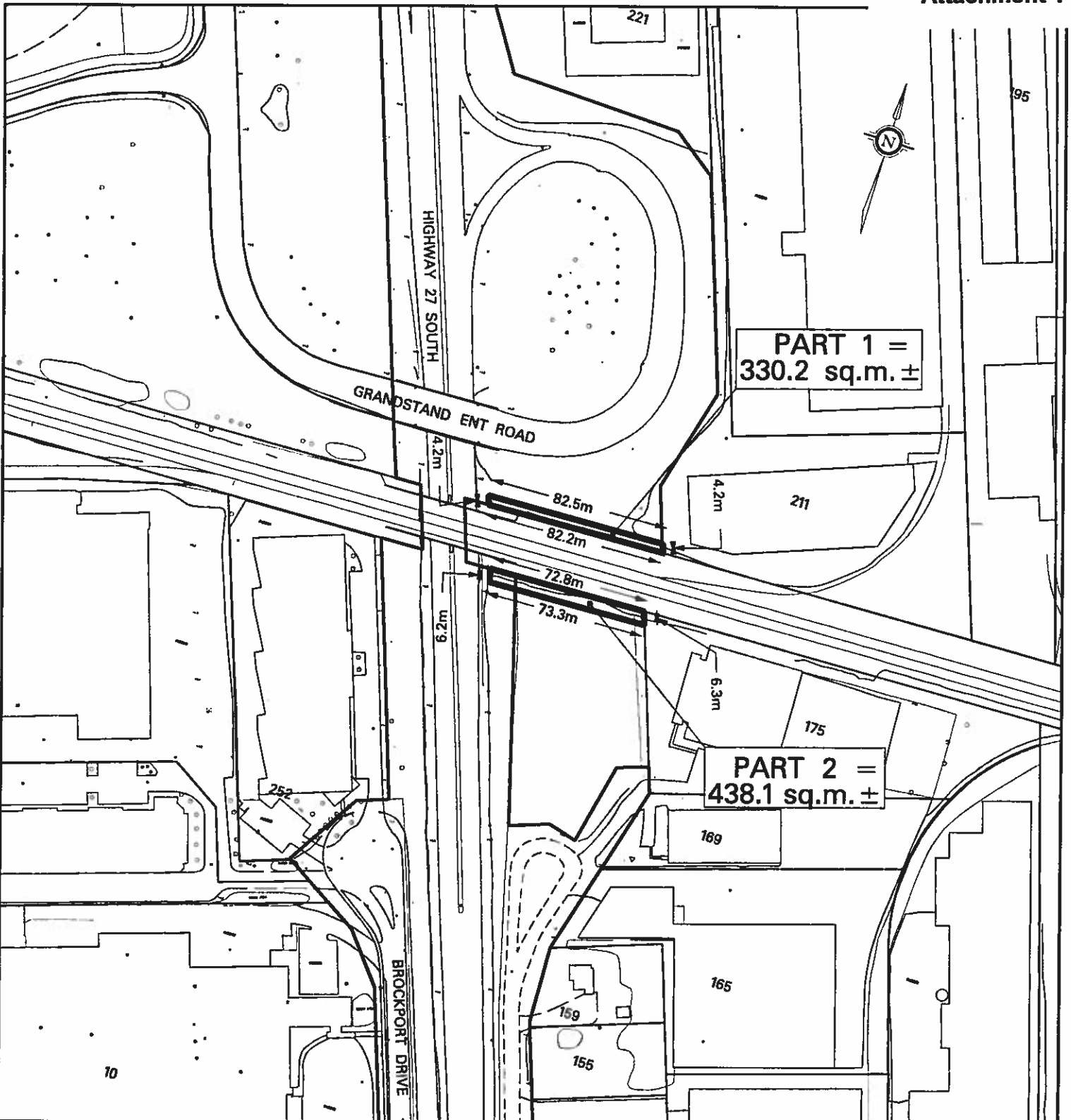

PROPERTY INFORMATION SHEET

CITY OWNED LAND

SKETCH SHOWING PORTIONS OF HIGHWAY 27
ABUTTING THE METROLINX RAIL CORRIDOR SOUTH
OF BETHRIDGE ROAD

TORONTO

TECHNICAL SERVICES DIVISION
SURVEY & UTILITY MAPPING

NOTE:

THIS SKETCH HAS BEEN
COMPILED FROM OFFICE
RECORDS. MEASUREMENTS
ARE APPROXIMATE

CHECK BY JOHN HOUSE

PREPARED BY: DWAYNE PITT

WARD 2 - ETOBICOKE NORTH

DATE: JANUARY 25, 2013

SKETCH No. PS-2013-007