

Appendix 2 – Area-Specific Amendment Sought by Pattison

BY-LAW No. XXX-2015

To amend Schedule B, Signage Master Plans and Area Specific Amendments, to Chapter 694, Signs, General, to implement an area specific amendment with respect to the premises municipally known as 2751-2753 Eglinton Avenue East

The Council of the City of Toronto HEREBY ENACTS as follows:

XX. 2751-2753 Eglinton Avenue East – Notwithstanding §§ 694-15B(10) and but subject to all other provisions of this Chapter, the area consisting of the premises municipally known as 2751-2753 Eglinton Avenue East, as delineated with heavy lines on the diagram indicated at Subsection XX(2) as Area Map 1 – 2751-2753 Eglinton Avenue East, may contain, in addition to any other signs permitted by subsections 694-21D, the following sign:

(1) One third party ground sign provided:

(a) The sign shall contain no more than two sign faces;

(b) Where the sign has two sign faces, the sign faces shall be back-to-back;

(c) Each of the two sign faces shall not exceed 20.0 square metres;

(d) Each of the two sign faces shall be rectangular;

(e) The centre line of each of the two sign faces shall not exceed 6.10 metres;

(f) The bisecting line of each of the two sign faces shall not exceed 3.05 metres;

(g) Each of the two sign faces shall display static copy or mechanical copy;

(h) The height shall not exceed 7.61 metres;

(i) The sign shall be entirely located within the area indicated by the shaded area bounded by heavy lines on the diagram indicated at Subsection XX(3) as Detail Map 1 – 2751-2753 Eglinton Avenue East;

(j) The sign shall not be erected within 30.0 metres of the intersection of a major street with any other street;

(k) The sign shall not be erected within 30.0 metres of any premises located, in whole or in part, in an R, RA, or OS sign district;

(l) If illuminated, the sign shall not be up-lit; and

(m) No other third party sign is erected or displayed within the area delineated with heavy lines on the diagram indicated at Subsection XX(2) as Area Map 1 – 2751-2753 Eglinton Avenue East.



(2) Area Map 1 – 2751-2753 Eglinton Avenue East

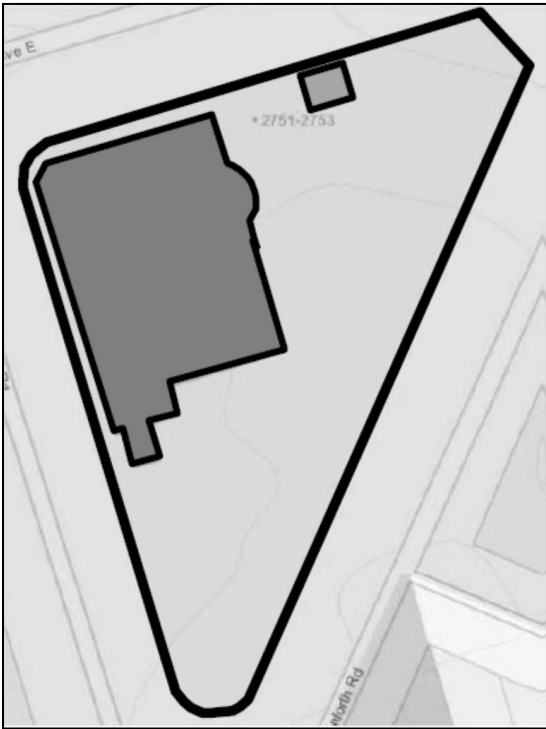

2751-2753 Eglinton Avenue East

(3) Detail Map 1 - 2751-2753 Eglinton Avenue East



	Sign Location
	Existing Building