

## **Appendix 2: Draft By-law – 555 Rexdale Boulevard**

BY-LAW No. XXX-2015

**To amend Schedule B, Signage Master Plans and Area Specific Amendments, to Chapter 694, Signs, General, to implement an area specific amendment with respect to the premises municipally known as 555 Rexdale Boulevard**

The Council of the City of Toronto HEREBY ENACTS as follows:

1. XX. 555 Rexdale Boulevard - Notwithstanding, §§ 694-22A, 694-22D and 694-24A(10), but subject to all other provisions of this chapter, the premises municipally known as 555 Rexdale Boulevard, delineated with heavy lines on the diagram indicated at Subsection XX(8), may contain, in addition to those signs permitted in a E-Employment sign district provided for in §§ 694-21E, and 694-25B, the following signs:

(1) A non-illuminated topiary sign provided:

- (a) The sign shall only display static copy;
- (b) The height shall not exceed 1.5 metres;
- (c) The sign shall have no more than 1 sign face;
- (d) The sign face area of the sign shall not exceed 150.0 square metres;
- (e) The sign face shall be shaped as a rectangle; and

[1] The sign may have a measurement for the dimension labelled as "x1", "x2" or "x3" on the diagram indicated at Subsection XX(10) of no more than 5.0 metres; and

[2] The sign may have a measurement for the dimension labelled as "y1", "y2" or "y3" on the diagram indicated at Subsection XX(10) of no more than 30.0 metres;

(f) The sign shall not be less than 50.0 metres from another sign located on the premises municipally known as 555 Rexdale Boulevard as delineated with heavy lines on the diagram indicated at Subsection XX(8);

(g) The sign shall only:

[1] Display third party sign copy consisting of the logo, corporate symbol, insignia, or motto of a business, hospital, charitable, cultural or community organizations, provincial, municipal or civic organizations, the City of Toronto's special purpose bodies, agencies, boards, commissions and corporations;

- (h) The sign shall not display more than 1 message;
- (i) The sign shall not be within 4.0 metres of the easterly boundary of the premises;
- (j) The sign is entirely located within the portion of the premises labelled as Map 1 on the diagram indicated at Subsection XX(9);
- (k) The sign is erected and displayed within the location indicated at Subsection XX(10), as "Sign 1", "Sign 2" or "Sign 3"; and
- (l) There shall be no more than 3 such signs erected and displayed within the location on the premises labelled as Map 1 on the diagram indicated at Subsection XX(9).

(2) A non-illuminated topiary sign provided:

- (a) The sign shall only display static copy;
- (b) The height shall not exceed 1.5 metres;
- (c) The sign shall have no more than 1 sign face;
- (d) The sign face area of the sign shall not exceed 150.0 square metres;
- (e) The sign face shall be shaped as a rectangle; and

[1] The sign may have a measurement for the dimension labelled as "x4", "x5", "x6" or "x7" on the diagram indicated at Subsection XX(11) of no more than 5.0 metres; and

[2] The sign may have a measurement for the dimension labelled as "y4", "y5", "y6" or "y7" on the diagram indicated at Subsection XX(11) of no more than 30.0 metres;

(f) The sign shall not be less than 50.0 metres from another sign located on the premises municipally known as 555 Rexdale Boulevard as delineated with heavy lines on the diagram indicated at Subsection XX(8);

(g) The sign shall only:

[1] Display third party sign copy consisting of the logo, corporate symbol, insignia, or motto of a business, hospital, charitable, cultural or community organizations, provincial, municipal or civic organizations, the City of Toronto's special purpose bodies, agencies, boards, commissions and corporations;

(h) The sign shall not display more than 1 message;

- (i) The sign shall not be within 4.0 metres of the easterly boundary of the premises;
- (j) The sign is entirely located within the portion of the premises labelled as Map 2 on the diagram indicated at Subsection XX(9);
- (k) The sign is erected and displayed within the location indicated at Subsection XX(11), as "Sign 4", "Sign 5", "Sign 6" or "Sign 7"; and
- (l) There shall be no more than 4 such signs erected and displayed within the location on the premises labelled as Map 2 on the diagram indicated at Subsection XX(9).

(3) A non-illuminated topiary sign provided:

- (a) The sign shall only display static copy;
- (b) The height shall not exceed 1.5 metres;
- (c) The sign shall have no more than 1 sign face;
- (d) The sign face area of the sign shall not exceed 150.0 square metres;
- (e) The sign face shall be shaped as a rectangle; and

[1] The sign may have a measurement for the dimension labelled as "x8", "x9", "x10" or "x11" on the diagram indicated at Subsection XX(12) of no more than 5.0 metres; and

[2] The sign may have a measurement for the dimension labelled as "y8", "y9", "y10" or "y11" on the diagram indicated at Subsection XX(12) of no more than 30.0 metres;

- (f) The sign shall not be less than 50.0 metres from another sign located on the premises municipally known as 555 Rexdale Boulevard as delineated with heavy lines on the diagram indicated at Subsection XX(8);

(g) The sign shall only:

[1] Display third party sign copy consisting of the logo, corporate symbol, insignia, or motto of a business, hospital, charitable, cultural or community organizations, provincial, municipal or civic organizations, the City of Toronto's special purpose bodies, agencies, boards, commissions and corporations;

- (h) The sign shall not display more than 1 message;
- (i) The sign shall not be within 4.0 metres of the easterly boundary of the premises;

(j) The sign is entirely located within the portion of the premises labelled as Map 3 on the diagram indicated at Subsection XX(9);

(k) The sign is erected and displayed within the location indicated at Subsection XX(12), as "Sign 8", "Sign 9", "Sign 10" or "Sign 11"; and

(l) There shall be no more than 4 such signs erected and displayed within the location on the premises labelled as Map 3 on the diagram indicated at Subsection XX(9).

(4) A non-illuminated topiary sign provided:

(a) The sign shall only display static copy;

(b) The height shall not exceed 1.5 metres;

(c) The sign shall have no more than 1 sign face;

(d) The sign face area of the sign shall not exceed 150.0 square metres;

(e) The sign face shall be shaped as a rectangle; and

[1] The sign may have a measurement for the dimension labelled as "x12", "x13", "x14" or "x15" on the diagram indicated at Subsection XX(13) of no more than 5.0 metres; and

[2] The sign may have a measurement for the dimension labelled as "y12", "y13", "y14" or "y15" on the diagram indicated at Subsection XX(13) of no more than 30.0 metres;

(f) The sign shall not be less than 50.0 metres from another sign located on the premises municipally known as 555 Rexdale Boulevard as delineated with heavy lines on the diagram indicated at Subsection XX(8);

(g) The sign shall only:

[1] Display third party sign copy consisting of the logo, corporate symbol, insignia, or motto of a business, hospital, charitable, cultural or community organizations, provincial, municipal or civic organizations, the City of Toronto's special purpose bodies, agencies, boards, commissions and corporations;

(h) The sign shall not display more than 1 message;

(i) The sign shall not be within 4.0 metres of the easterly or northerly boundary of the premises;

(j) The sign is entirely located within the portion of the premises labelled as Map 4 on the diagram indicated at Subsection XX(9);

(k) The sign is erected and displayed within the location indicated at Subsection XX(13), as "Sign 12", "Sign 13", "Sign 14" or "Sign 15"; and

(l) There shall be no more than 4 such signs erected and displayed within the location on the premises labelled as Map 4 on the diagram indicated at Subsection XX(9).

(5) A non-illuminated topiary sign provided:

(a) The sign shall only display static copy;

(b) The height shall not exceed 1.5 metres;

(c) The sign shall have no more than 1 sign face;

(d) The sign face area of the sign shall not exceed 150.0 square metres;

(e) The sign face shall be shaped as a rectangle; and

[1] The sign may have a measurement for the dimension labelled as "x16", "x17", "x18" or "x19" on the diagram indicated at Subsection XX(14) of no more than 5.0 metres; and

[2] The sign may have a measurement for the dimension labelled as "y16", "y17", "y18" or "y19" on the diagram indicated at Subsection XX(14) of no more than 30.0 metres;

(f) The sign shall not be less than 50.0 metres from another sign located on the premises municipally known as 555 Rexdale Boulevard as delineated with heavy lines on the diagram indicated at Subsection XX(8);

(g) The sign shall only:

[1] Display third party sign copy consisting of the logo, corporate symbol, insignia, or motto of a business, hospital, charitable, cultural or community organizations, provincial, municipal or civic organizations, the City of Toronto's special purpose bodies, agencies, boards, commissions and corporations;

(h) The sign shall not display more than 1 message;

(i) The sign shall not be within 4.0 metres of the northerly boundary of the premises;

(j) The sign is entirely located within the portion of the premises labelled as Map 5 on the diagram indicated at Subsection XX(9);

(k) The sign is erected and displayed within the location indicated at Subsection XX(14), as "Sign 16", "Sign 17", "Sign 18" or "Sign 19"; and

(l) There shall be no more than 4 such signs erected and displayed within the location on the premises labelled as Map 5 on the diagram indicated at Subsection XX(9).

(6) A non-illuminated topiary sign provided:

(a) The sign shall only display static copy;

(b) The height shall not exceed 1.5 metres;

(c) The sign shall have no more than 1 sign face;

(d) The sign face area of the sign shall not exceed 150.0 square metres;

(e) The sign face shall be shaped as a rectangle; and

[1] The sign may have a measurement for the dimension labelled as "x20", "x21" or "x22" on the diagram indicated at Subsection XX(15) of no more than 5.0 metres; and

[2] The sign may have a measurement for the dimension labelled as "y20", "y21" or "y22" on the diagram indicated at Subsection XX(15) of no more than 30.0 metres;

(f) The sign shall not be less than 50.0 metres from another sign located on the premises municipally known as 555 Rexdale Boulevard as delineated with heavy lines on the diagram indicated at Subsection XX(8);

(g) The sign shall only:

[1] Display third party sign copy consisting of the logo, corporate symbol, insignia, or motto of a business, hospital, charitable, cultural or community organizations, provincial, municipal or civic organizations, the City of Toronto's special purpose bodies, agencies, boards, commissions and corporations;

(h) The sign shall not display more than 1 message;

(i) The sign shall not be within 4.0 metres of the easterly or northerly boundary of the premises;

(j) The sign is entirely located within the portion of the premises labelled as Map 6 on the diagram indicated at Subsection XX(9);

(k) The sign is erected and displayed within the location indicated at Subsection XX(15), as "Sign 20", "Sign 21" or "Sign 22"; and

(l) There shall be no more than 3 such signs erected and displayed within the location on the premises labelled as Map 6 on the diagram indicated at Subsection XX(9).

(7) A non-illuminated topiary sign provided:

(a) The sign shall only display static copy;

(b) The height shall not exceed 1.5 metres;

(c) The sign shall have no more than 1 sign face;

(d) The sign face area of the sign shall not exceed 150.0 square metres;

(e) The sign face shall be shaped as a rectangle; and

[1] The sign may have a measurement for the dimension labelled as "x23", "x24" or "x25" on the diagram indicated at Subsection XX(16) of no more than 5.0 metres; and

[2] The sign may have a measurement for the dimension labelled as "y23", "y24" or "y25" on the diagram indicated at Subsection XX(16) of no more than 30.0 metres;

(f) The sign shall not be less than 50.0 metres from another sign located on the premises municipally known as 555 Rexdale Boulevard as delineated with heavy lines on the diagram indicated at Subsection XX(8);

(g) The sign shall only:

[1] Display third party sign copy consisting of the logo, corporate symbol, insignia, or motto of a business, hospital, charitable, cultural or community organizations, provincial, municipal or civic organizations, the City of Toronto's special purpose bodies, agencies, boards, commissions and corporations;

(h) The sign shall not display more than 1 message;

(i) The sign shall not be within 4.0 metres of the easterly or northerly boundary of the premises;

(j) The sign is entirely located within the portion of the premises labelled as Map 7 on the diagram indicated at Subsection XX(9);

(k) The sign is erected and displayed within the location indicated at Subsection XX(16), as "Sign 23", "Sign 24" or "Sign 25"; and

(1) There shall be no more than 3 such signs erected and displayed within the location on the premises labelled as Map 7 on the diagram indicated at Subsection XX(9).

(8) Premises Map – 555 Rexdale Boulevard

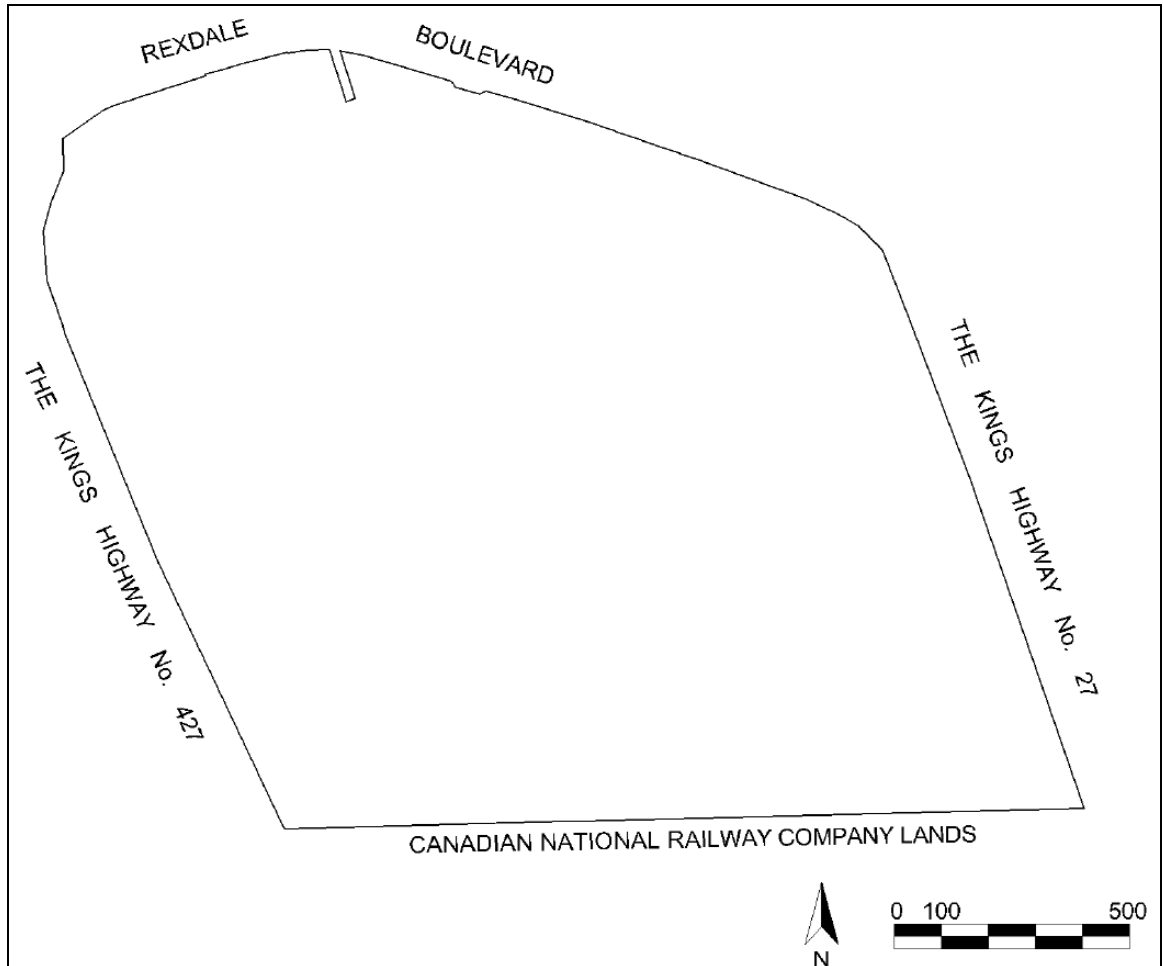



(9) Location Map – 555 Rexdale Boulevard

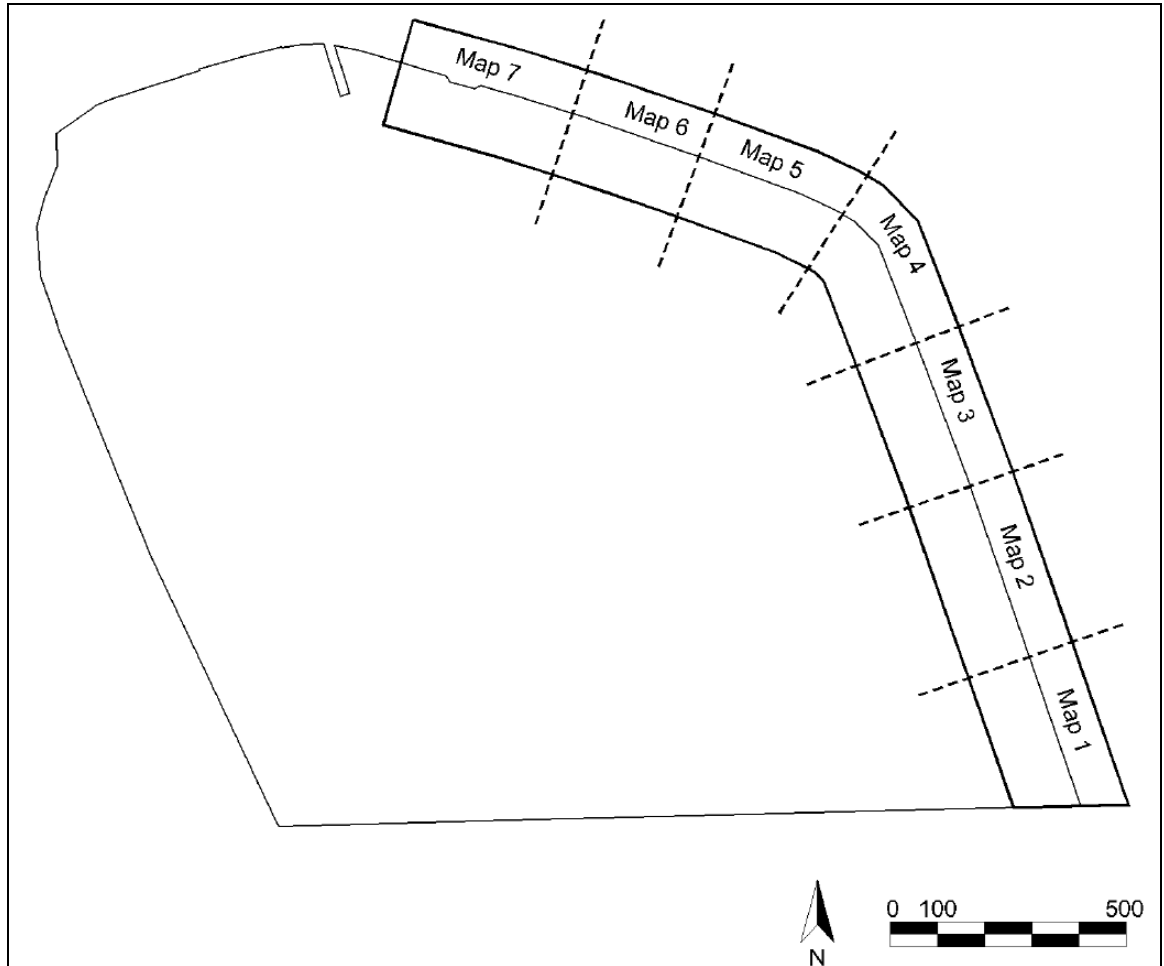

(10) Map 1 – 555 Rexdale Boulevard

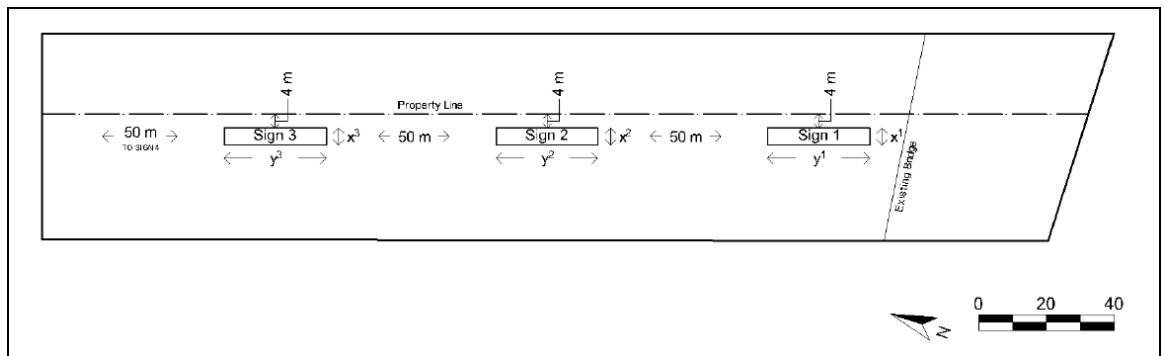

(11) Map 2 – 555 Rexdale Boulevard

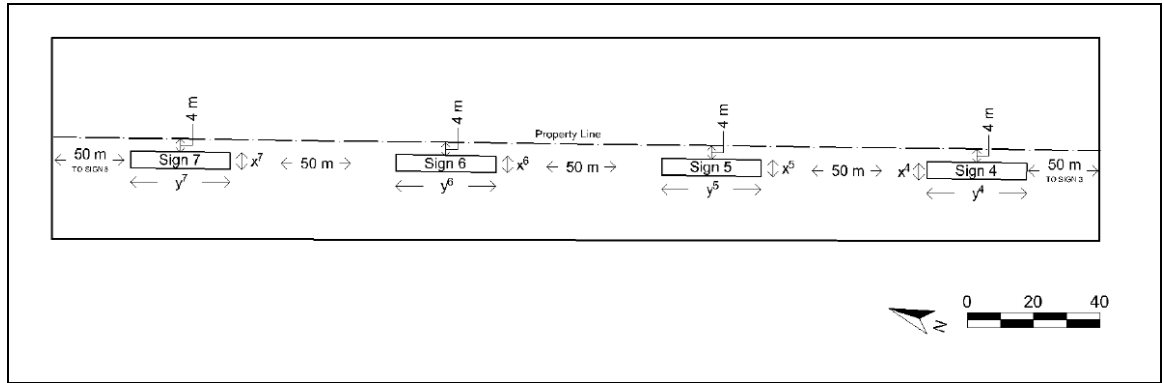

(12) Map 3 – 555 Rexdale Boulevard

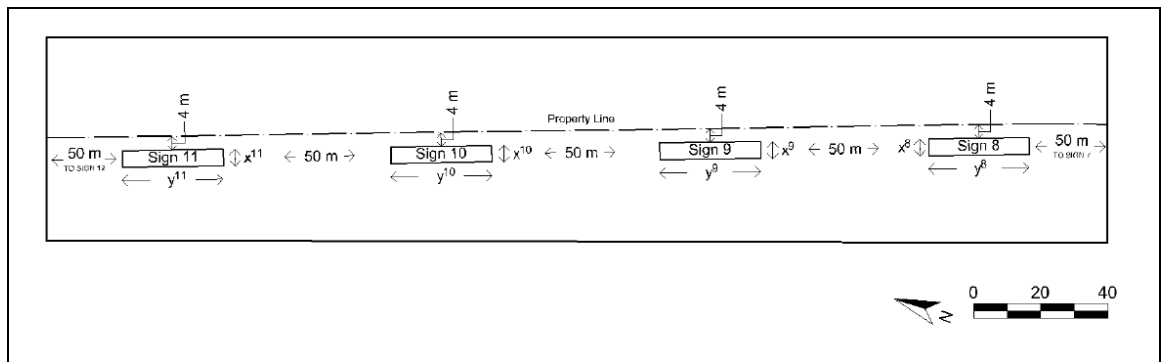

(13) Map 4 – 555 Rexdale Boulevard

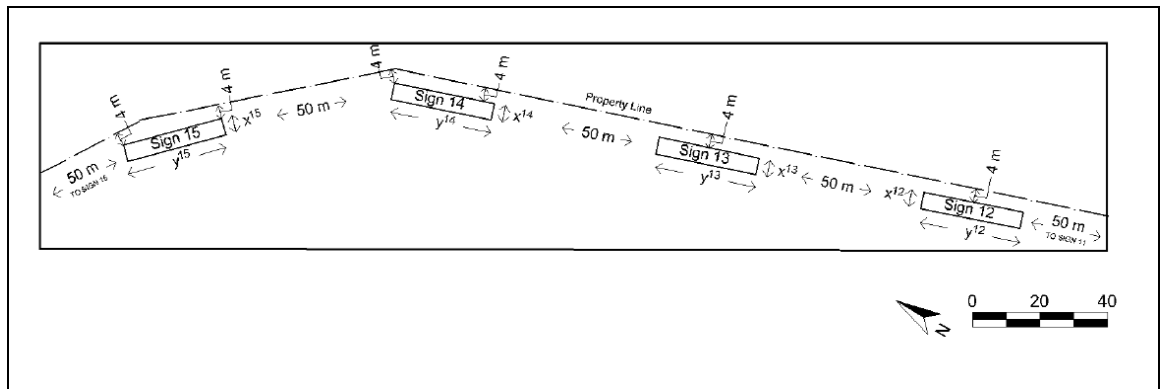

(14) Map 5 – 555 Rexdale Boulevard

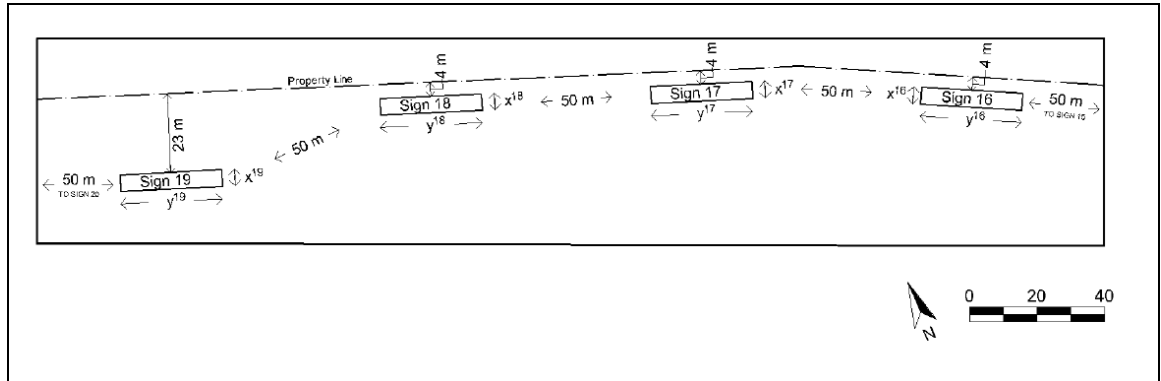

(15) Map 6 – 555 Rexdale Boulevard

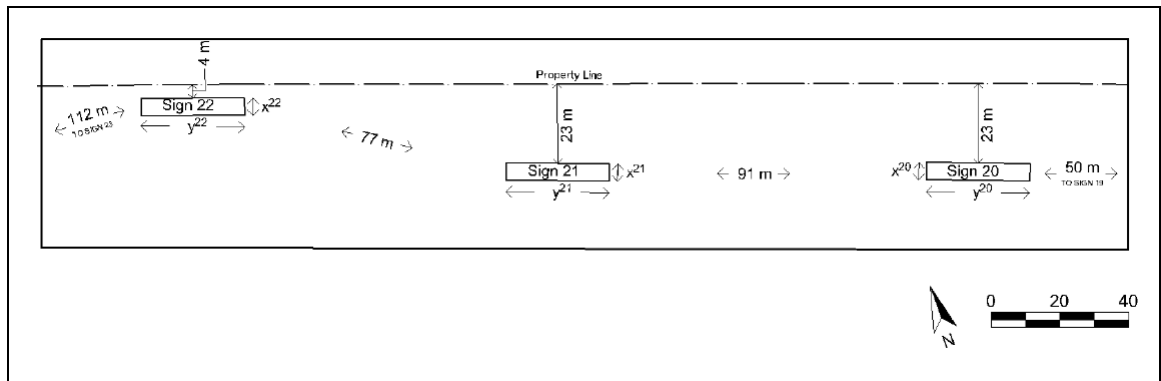

(16) Map 7 – 555 Rexdale Boulevard

