

**FRONT YARD PARKING APPEAL - 269 GLEBEHOLME BOULEVARD**

**APPENDIX 'A'**

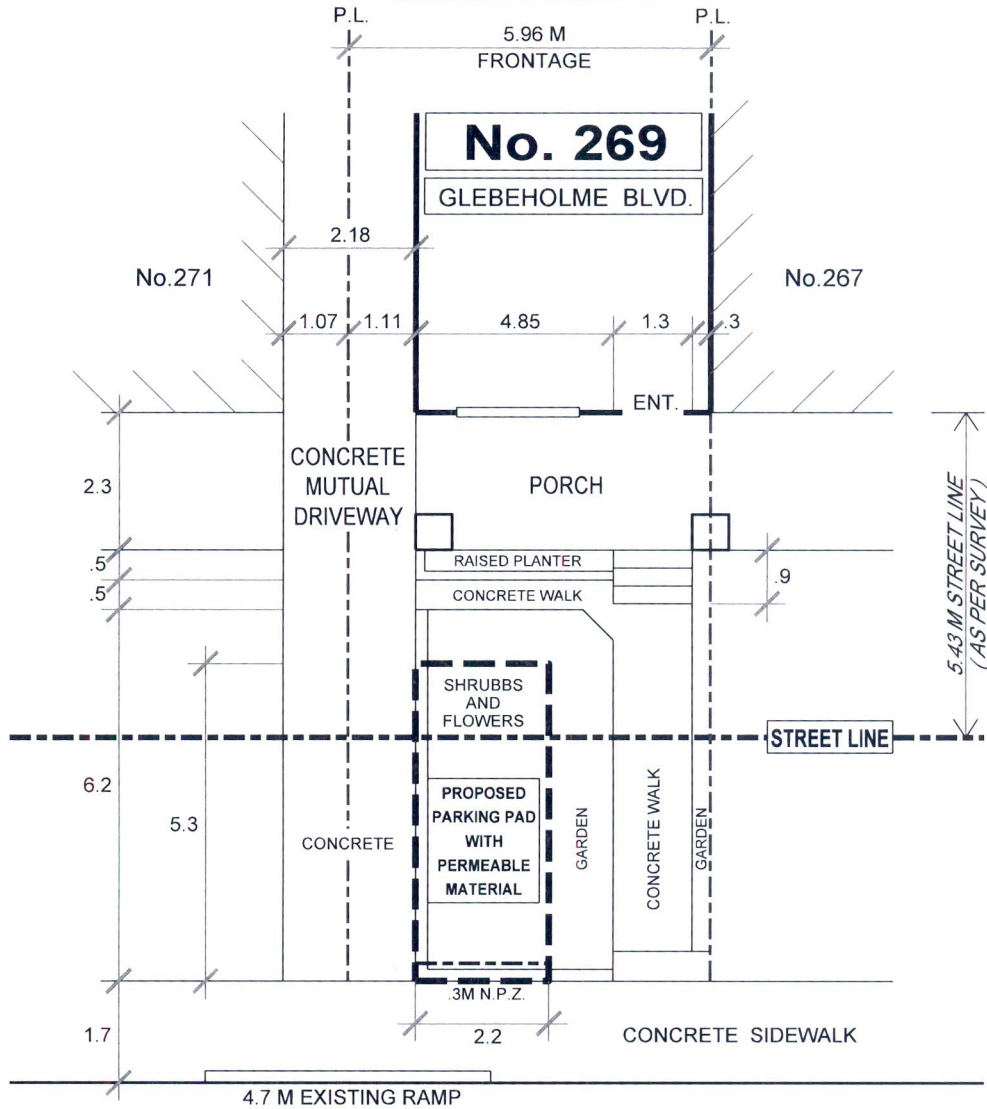

**GLEBEHOLME BOULEVARD**

PERMIT PARKING ON SAME SIDE  
NO LOSS OF PERMIT PARKING SPACE  
DUE TO USE OF EXISTING RAMP

SOFT LANDSCAPING NOT MET  
ON PRIVATE PROPERTY

SOFT LANDSCAPING NOT MET  
ON BOULEVARD

LANDSCAPE OPEN SPACE  
NOT MET ON BOULEVARD



**TRANSPORTATION SERVICES DIVISION**

TORONTO AND EAST YORK DISTRICT  
RIGHT OF WAY MANAGEMENT - OFF STREET PARKING

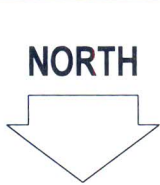

**FRONT YARD PARKING CHAPTER 918 F.Y.P. - 98590**

TOTAL PARKING AREA ON STREET ALLOWANCE	9.0 M <sup>2</sup>	PRIVATE PROPERTY			STREET ALLOWANCE		
		AREA M <sup>2</sup>	%	CODE	AREA M <sup>2</sup>	%	CODE
TOTAL AREA		21.1	100		24.3	100	
LANDSCAPED OPEN SPACE		12.5	59	50% min.	10.8	44	50% min.
PAVED AREA		8.7	41	50% max.	13.5	56	50% max.
SOFT LANDSCAPING		6.1	49	75% min.	5.4	50	75% min.

REVISIONS	
Date	By
DEC. 11'14	R.A.M.
JULY 23'15	R.A.M.

DRAWN BY: R. MUNSON

DATE: NOVEMBER 24, 2014

SCALE: 1:100