

YONGE ST

COLBORNE ST

EXISTING CONSTRUCTION STAGING AREA

SCOTT ST

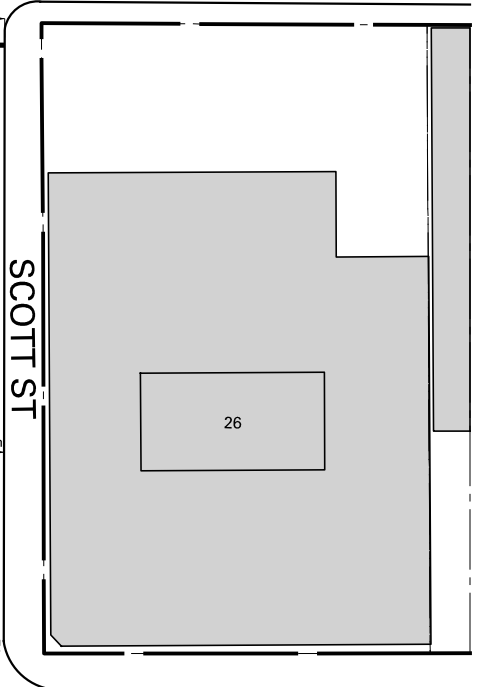
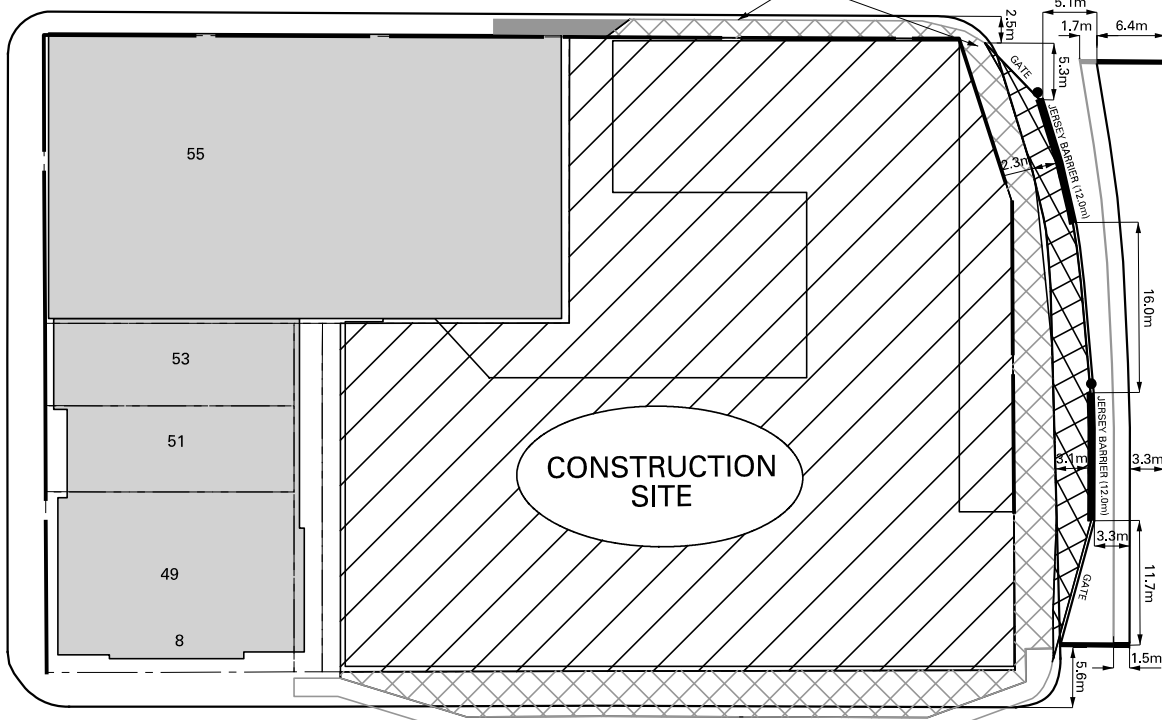

WELLINGTON ST E



EXISTING CONSTRUCTION STAGING AREA AND PEDESTRIAN WALKWAY TO BE REMOVED DEC. 31, 2015



LEGEND:

-  PROPOSED CONSTRUCTION STAGING AREA
-  PROPOSED JERSEY BARRIER
-  PROPOSED ENERGY ATTENUATOR

NOTE:
 INFORMATION ON THIS PLAN IS BASED ON OFFICE RECORDS AND IS SUBJECT TO FIELD VERIFICATION.
 ALL DIMENSIONS ARE APPROXIMATE.
 PROPOSED PAVEMENT MARKING IS SHOWN IN BLACK.
 EXISTING PAVEMENT MARKING IS SHOWN IN GREY.
 ALL PROPOSED PAVEMENT MARKINGS TO BE INSTALLED BY CONTRACTOR.

SCOTT ST: PROPOSED CONSTRUCTION STAGING AREA WIDENING

