



STAFF REPORT ACTION REQUIRED

Assumption of Services, Registered Plan 66R-18892, 66R-18851 Michael Power Place Port Royal Place Developments Inc.

| | |
|--------------------------|---|
| Date: | September 19, 2016 |
| To: | Etobicoke and York Community Council |
| From: | Judy Tse, Director, Development Engineering |
| Wards: | Ward No. 05 Etobicoke Lakeshore |
| Reference Number: | P:\2016\Cluster B\TEC\EY16040 (AFS# 23673) |

SUMMARY

This report recommends that the municipal services installed under the terms of the Section 37 Agreement for Plans 66R-18892, dated October 24, 2000 and 66R-18851, dated September 2, 2000, between Port Royal Place Developments Inc. and the City of Toronto be assumed by the City.

RECOMMENDATIONS

It is recommended that:

1. the City formally assume the road Michael Power Place, and the municipal services that were constructed as part of the residential development located on the site with the former address of 5055 Dundas Street West;
2. the Director, Engineering Review be authorized to release the performance guarantee;
3. an assumption By-law be prepared to assume Michael Power Place;
4. the City solicitor be authorized and directed to register the assumption By-law in the Land Registry Office, at the expense of the Owner; and

5. the City Clerk and Treasurer be authorized to sign any release or other documentation necessary to give effect thereto.
6. the appropriate City officials be authorized to transfer ownership of the street lighting system constructed within Michael Power Place to Toronto Hydro.

Financial Impact

There are no financial implications resulting from the adoption of this report.

ISSUE BACKGROUND

The subject development shown on the attached map is a 3.8ha site with eight condominium towers ranging in height from 8-storey to 30-storey with a total of 1,275 residential units, a public road, and a public park. The municipal services required under the terms of the Section 37 Agreement for Plans 66R-18892, dated October 24, 2000 and 66R-18851, dated September 2, 2000, between Port Royal Place Developments Inc. and the City of Toronto are in the required condition to be assumed by the City.

COMMENTS

Obligations respecting the roads and municipal services contained in the Section 37 Agreement have been satisfied. The relevant City divisions have provided clearance with respect to the Assumption of the roads and municipal services. It is now appropriate for Council to pass an assumption by-law to assume the municipal services and road in Reference Plans 66R-18892 and 66R-18851.

CONTACT

Ashraf Hanna, P.Eng
Manager, Development Engineering
Etobicoke & York District
Tel: (416) 394-8383
E-mail: ahanna@toronto.ca

Giovanni Baldesarra, P.Eng
Senior Engineer, Development Engineering
Etobicoke & York District
Tel: (416) 394-8398
E-mail: gbaldes@toronto.ca

SIGNATURE

Judy Tse, P.Eng
Director, Engineering & Construction Services
Engineering Review.

ATTACHMENT

Attachment #1 66R-18851 and 66R-18892 (Michael Power Place)

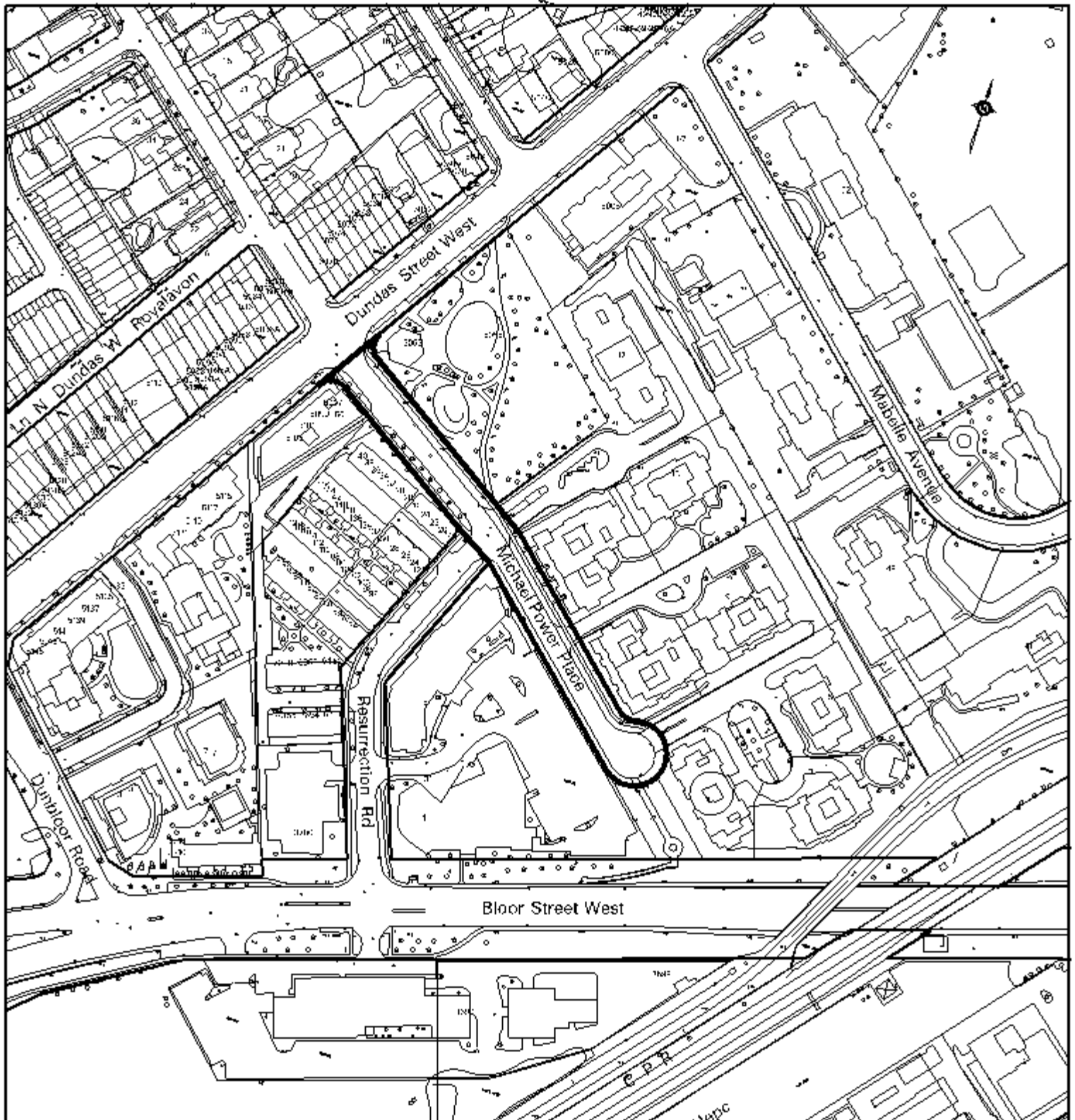

Toronto

ENGINEERING & CONSTRUCTION SERVICES
INCORPORATING SURVEYING SERVICES
A Division of City of Toronto

NOTES:
THIS SKETCH HAS BEEN
COMPILED FROM OFFICE
RECORDS. MEASUREMENTS
ARE APPROXIMATE

CHECK BY JOHN HOUSE

PREPARED BY: J. WAYNE HILL

WARD 5 - ETOBICOKE-LAKESHORE
DATE: SEPTEMBER 20, 2016

PROPERTY INFORMATION SHEET

ATTACHMENT #1 - 66R-18851 AND 66R-18892 (MICHAEL POWER PLACE) ASSUMPTION OF SERVICES

SKETCH No. PS-2016-121