

# FRONT YARD PARKING APPEAL - 82 LAWRENCE AVENUE WEST

## APPENDIX 'D'

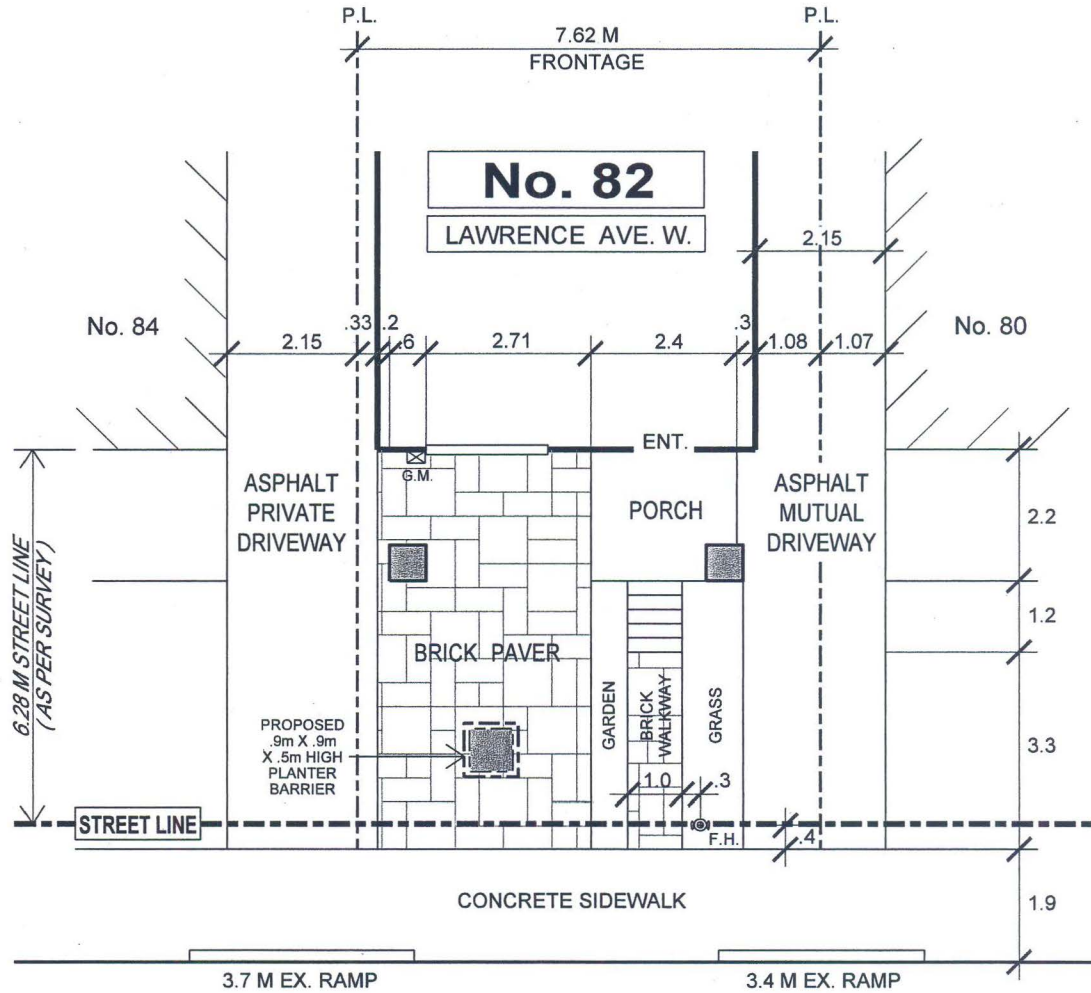

## LAWRENCE AVENUE WEST



**TRANSPORTATION SERVICES DIVISION**  
 NORTH YORK DISTRICT  
 RIGHT OF WAY MANAGEMENT



**FRONT YARD PARKING      CHAPTER 918      F.Y.P. - 100840**

TOTAL PARKING AREA ON STREET ALLOWANCE	PRIVATE PROPERTY			STREET ALLOWANCE		
	AREA M <sup>2</sup>	%	CODE	AREA M <sup>2</sup>	%	CODE
TOTAL AREA						
LANDSCAPED OPEN SPACE						
PAVED AREA						
SOFT LANDSCAPING						
DRAWN BY: R. MUNSON		DATE: OCTOBER 05' 2015		SCALE: 1:100		

REVISIONS	
Date	By
OCT.08'15	R.A.M.
OCT.17'15	R.A.M.
JAN.05'16	R.A.M.
MAR.09'16	R.A.M.