

# FRONT YARD PARKING APPEAL - 252 GLENROSE AVENUE

## APPENDIX 'A'

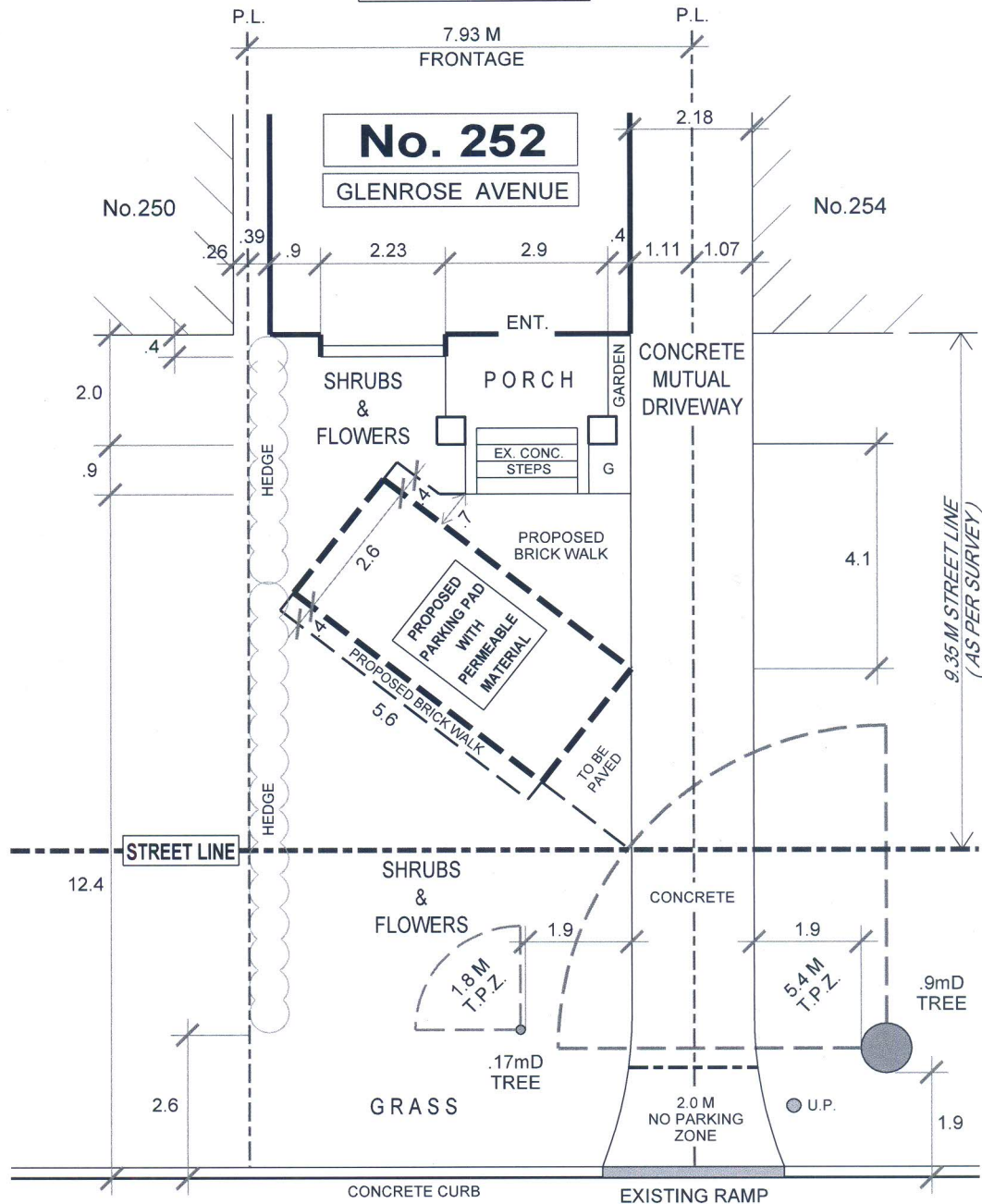

## GLENROSE AVENUE



**TRANSPORTATION SERVICES DIVISION**  
 TORONTO AND EAST YORK DISTRICT  
 RIGHT OF WAY MANAGEMENT - OFF STREET PARKING



**NORTH**

**FRONT YARD PARKING**

**CHAPTER 918**

**F.Y.P. - 101116**

TOTAL PARKING AREA ON STREET ALLOWANCE

PRIVATE PROPERTY

STREET ALLOWANCE

TOTAL AREA

AREA

%

CODE

AREA

%

CODE

PAVED AREA

27.6

41

50% max.

6.9

15

50% max.

LANDSCAPED OPEN SPACE

39.7

59

50% min.

38.7

85

50% min.

50% LANDSCAPED OPEN SPACE REQUIRED

33.7

22.8

75% SOFT LANDSCAPING REQUIRED

25.2

17.1

SOFT LANDSCAPING AREA

28.8

85

75% min.

38.7

170

75% min.

DRAWN BY: R. MUNSON

DATE: SEPTEMBER 09, 2016

SCALE: 1:100

REVISIONS

DATE BY

SEP.19'16 R.A.M.