

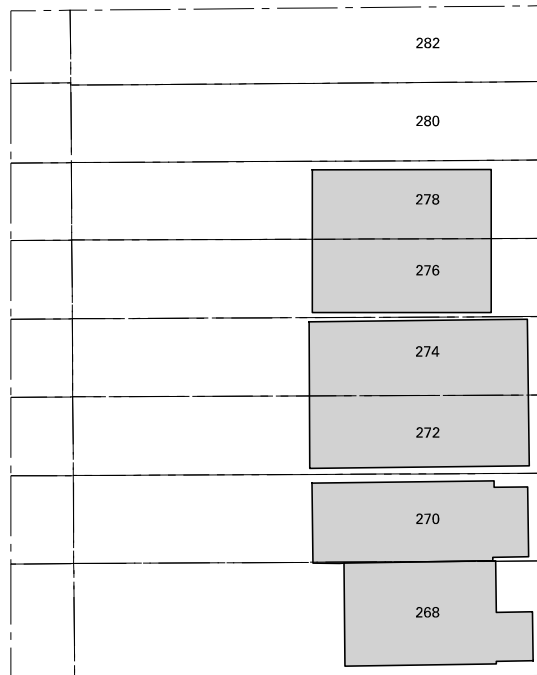

PUBLIC LANE



LEGEND

-  PROPOSED ACCESSIBLE PARKING SPACE
 -  EXISTING ACCESSIBLE LOADING ZONE
- 8:30AM - 7:00PM, MON-FRI, TO BE RESCINDED

NOTE:

INFORMATION ON THIS PLAN IS BASED ON OFFICE RECORDS AND IS SUBJECT TO FIELD VERIFICATION.

ALL DIMENSIONS ARE APPROXIMATE.

ARLINGTON AVE

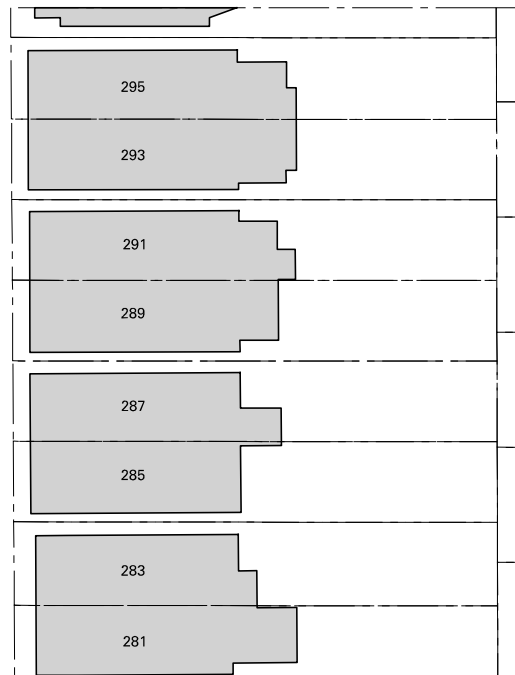

VALEWOOD AVE

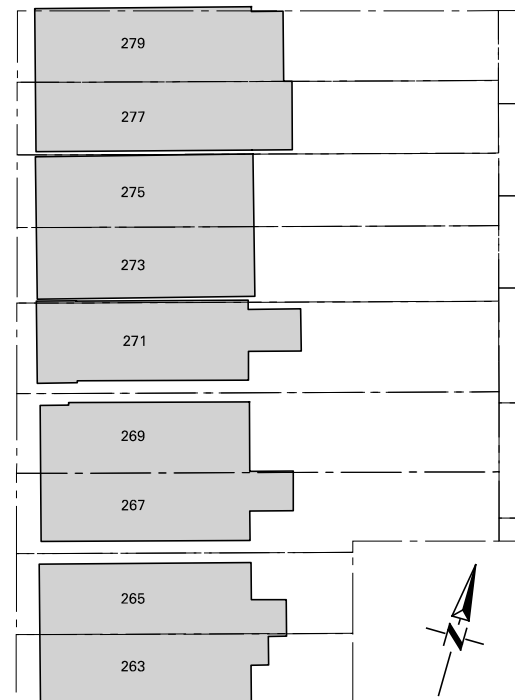

ARLINGTON AVE AT VALEWOOD AVE: PROPOSED ACCESSIBLE PARKING SPACE