

## **Permanent Closure of the Public Lane Abutting the North Limit of 299 Campbell Avenue**

**Date:** May 25, 2017  
**To:** Toronto and East York Community Council  
**From:** Director, Transportation Services, Toronto and East York District  
**Wards:** Ward 18 - Davenport

### **SUMMARY**

---

Transportation Services recommends that the public lane abutting the north limit of 299 Campbell Avenue be permanently closed. The lane to be closed will be replaced with a new public lane at the south end of the development site.

### **RECOMMENDATIONS**

---

Transportation Services recommends that:

1. City Council authorize the permanent closure of the public lane abutting the north limit of 299 Campbell Avenue, shown as Part 1 on the attached Sketch No. PS-2014097 (the "Existing Lane") upon conveyance to the City and dedication of a new public lane, shown as Part 2 on Sketch No. PS-2014-097 (the "New Lane Outlet") attached to the report, dated May 25, 2017, from the Director, Transportation Services, Toronto and East York District; and
2. City Council enact a by-law substantially in the form of the draft by-law attached as Appendix "A" to the report, dated May 24, 2017, from the Director, Transportation Services, Toronto and East York District.

### **FINANCIAL IMPACT**

---

Permanent Closure of the public lane abutting 299 Campbell Avenue

The closing of the Existing Lane will not result in any costs to the City as the purchaser of the Existing Lane is responsible to pay all costs associated with the closing of the Existing Lane.

The Deputy City Manager and Chief Financial Officer has reviewed this report and agrees with the financial impact information.

## **DECISION HISTORY**

---

In accordance with the City's Real Estate Disposal by-law 814-2007, the Existing Lane was declared surplus on January 11, 2017 by DAF No 2017-006, conditional upon City Council approving the permanent closure of the Existing Lane, with the intended manner of disposal to be by way of inviting an offer to purchase the Existing Lane from the owner of 299 Campbell Avenue (the "Applicant"), the owner of the abutting lands, that includes an exchange of land for the New Lane Outlet at the south end of the development site.

By DAF No. 2017-142, dated May 24, 2017, the Chief Corporate Officer authorized the General Manager, Transportation Services, to give notice to the public of a proposed by-law to close the Existing Lane in accordance with the requirements of the City of Toronto Municipal Code Chapter 162 and the Municipal Class Environmental Assessment for Schedule "A+" activities. Also, by DAF No. 2017-142, the Director of Real Estate Services authorized a land exchange with the Applicant that includes the sale of the Existing Lane and the construction and conveyance of the New Lane Outlet to the City.

## **COMMENTS**

---

Transportation Services has reviewed the feasibility of closing the Existing Lane and has determined that the Existing Lane can be permanently closed upon conveyance to the City of the New Lane Outlet once it has been constructed by the Applicant.

The Existing Lane contains a 300mm diameter combined sewer and must be relocated at the Applicant's expense.

In addition, a NPS 1SC HP gas main is located with the Existing Lane that will require relocation at the Applicant's expense. The estimated cost for the relocation of the gas main is to be paid in full by the Applicant and written confirmation from Enbridge is to be provided to the City prior to closing, as a condition of the Purchase/Land Exchange Agreement.

Permanent Closure of the public lane abutting 299 Campbell Avenue

The closing process requires approval from City Council. The draft by-law is an Appendix to this report and is tabled at the same Toronto and East York Community Council meeting at which the public has the opportunity to speak to the matter if they wish to do so.

The requirement for the Municipal Class Environmental Assessment for Schedule "A+" activities will be met during the posting of the public notice on the notice page of the City's Web site for at least five working days prior to the Toronto and East York Community Council meeting at which the proposed by-law to close the Existing Lane will be considered.

## **CONTACT**

---

Lukasz Pawlowski, Acting Manager  
Traffic Planning, Toronto and East York District  
Phone: 416-392-7713; Fax: 416-392-1920  
E-mail: Lukasz.Pawlowski@toronto.ca

## **SIGNATURE**

---

Dave Twaddle, Acting Director  
Transportation Services  
Toronto and East York District

## **ATTACHMENTS**

---

Attachment 1 - Draft By-law Appendix "A"  
Attachment 2 - Sketch No. PS-2014-097

P:\2017\Cluster B\Tra\Toronto and East York\Top\Ts2017125te.top.doc - acb

Permanent Closure of the public lane abutting 299 Campbell Avenue

**Attachment 1 – Appendix "A" - Draft By-law**

**APPENDIX "A"**

Authority: Toronto and East York Community Council Item No. T~~EXX~~, as adopted by City of Toronto Council on July 5, 6 and 7, 2017

**CITY OF TORONTO**

**Bill No.**

**BY-LAW No.   -2017**

**To permanently close the public lane abutting the north limit of 299 Campbell Avenue**  
WHEREAS it is recommended that the public lane abutting Dupont Street north of 299 Campbell Avenue be permanently closed; and

WHEREAS notice of the proposed by-law to permanently close the said public lane was posted on the notices page of the City's web site in accordance with the requirements of City of Toronto Municipal Code Chapter 162 and no one appeared to address the Toronto and East York Community Council at its meeting held on June 13, 2017;

The Council of the City of Toronto enacts:

1. The public lane, described as follows, is hereby permanently closed:

PIN 21329-0144 (LT)

PCL 5006 Sec F. Toronto; Pt Lt 149 Pl M13 Toronto; Pt Lt 155 Pl M13 Toronto; Pt Lt 156 Pl M13 Toronto Comm at a point in the S limit of Dupont St formerly Royce Av. distant 19 ft WLY thereon from the NE angle of Lt 156. Thence S 16 degrees 4 minutes E being to and along the centre line of a certain 17 ft siding ROW of the Canadian National Railway a distance of 21 ft 6 inches. Thence WLY parallel to the SLY limit of Dupont St 200 ft more or less to the E limit of Campbell Av. Thence NLY along said E limit of Campbell Av. 21 ft 6 inches more or less to the NW angle of Lt 149. Thence ELY along said S limit of Dupont St 200 ft more or less to the POB, save and except Part 1, Plan R-1115; Toronto; City of Toronto

Enacted and passed on \_\_\_\_\_, 2017.

Frances Nunziata,  
Speaker

Ulli S. Watkiss,  
City Clerk

(Seal of the City)

Permanent Closure of the public lane abutting 299 Campbell Avenue

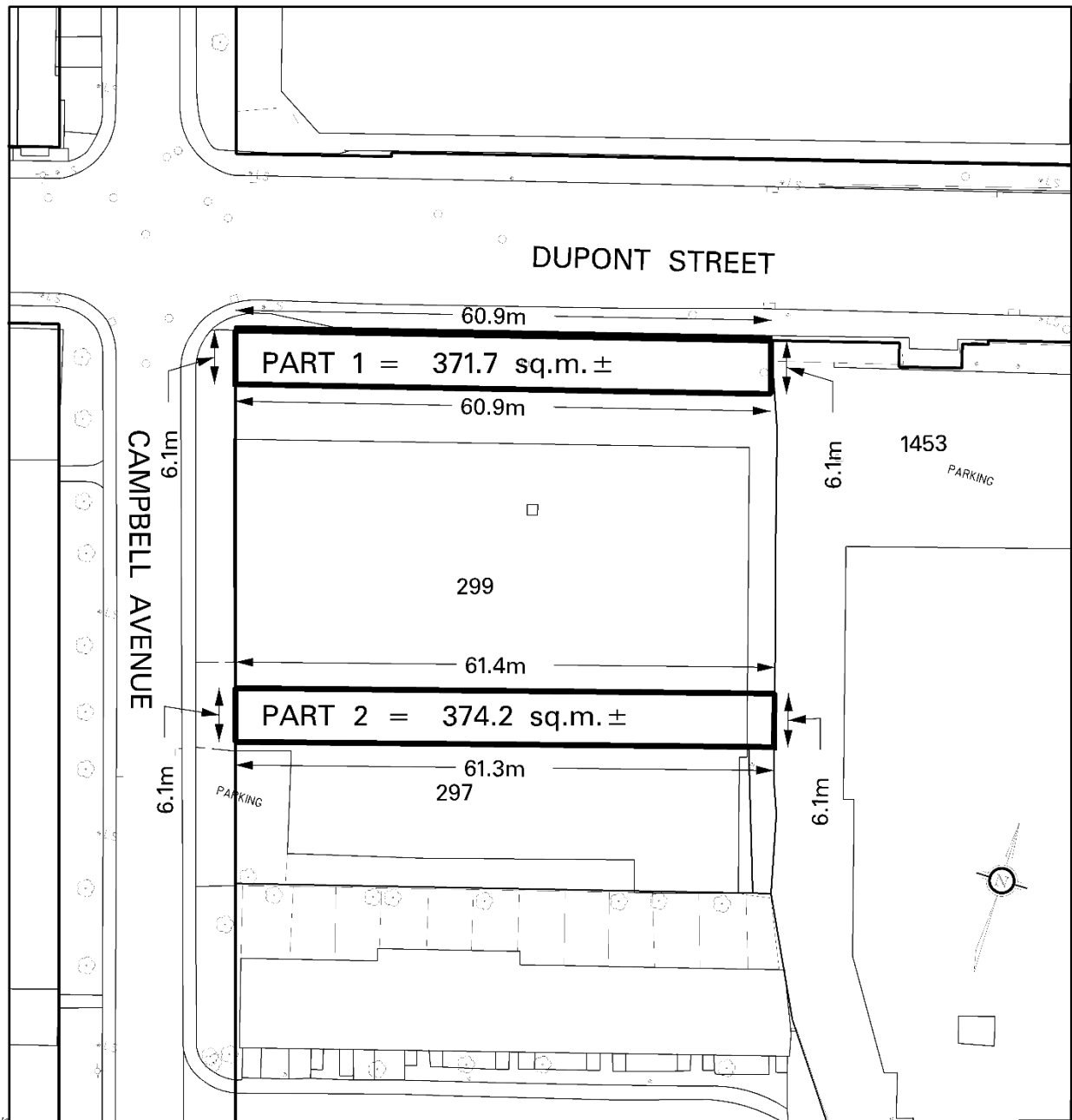

NOTE:  
THIS SKETCH HAS BEEN  
COMPILED FROM OFFICE  
RECORDS. MEASUREMENTS  
ARE APPROXIMATE

CHECK BY JOHN HOUSE  
PREPARED BY: DWAYNE PITT

# PROPERTY INFORMATION SHEET SKETCH SHOWING THE PUBLIC LANE ABUTTING NO. 299 CAMPBELL AVENUE (PART 1) AND A PORTION OF NO. 299 CAMPBELL AVENUE (PART 2)

WARD 18 – DAVENPORT  
DATE: AUGUST 22, 2014

SKETCH No. PS-2014-097

Permanent Closure of the public lane abutting 299 Campbell Avenue