

City of Toronto By-law No. 942-2015(OMB)

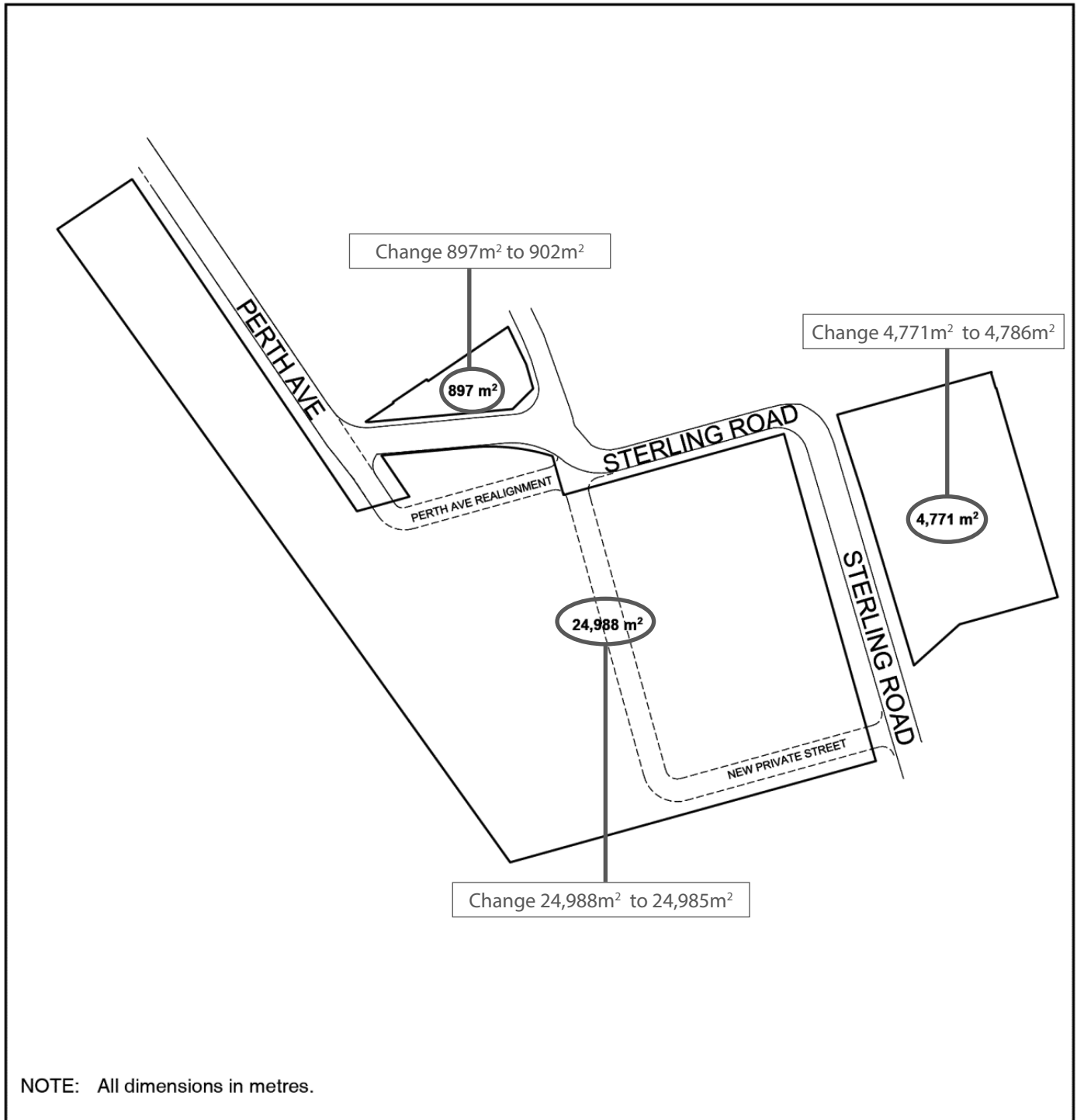

City of Toronto By-law No. 942-2015(OMB)

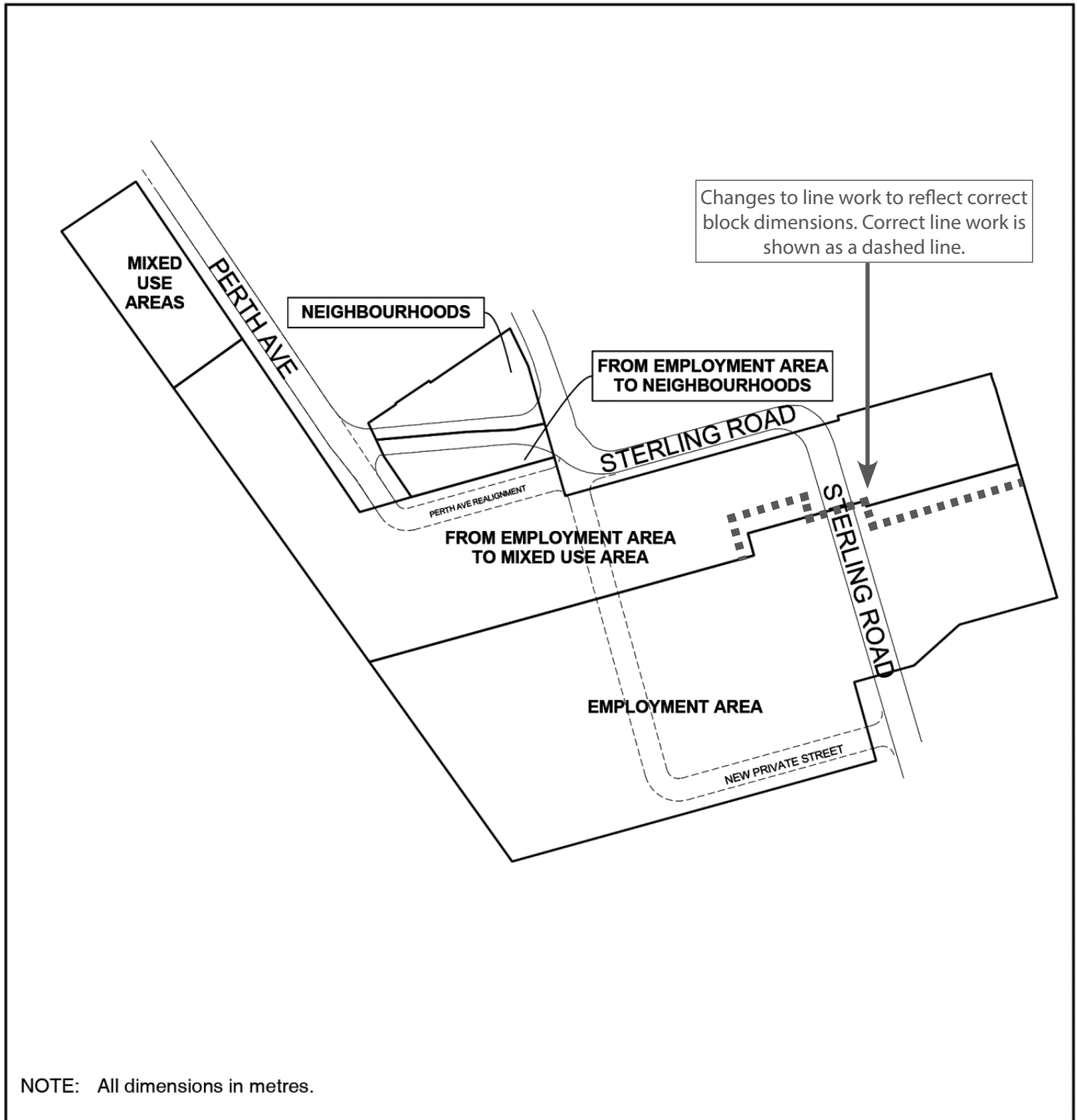

NOTE: All dimensions in metres.

City of Toronto By-law No. 942-2015(OMB)

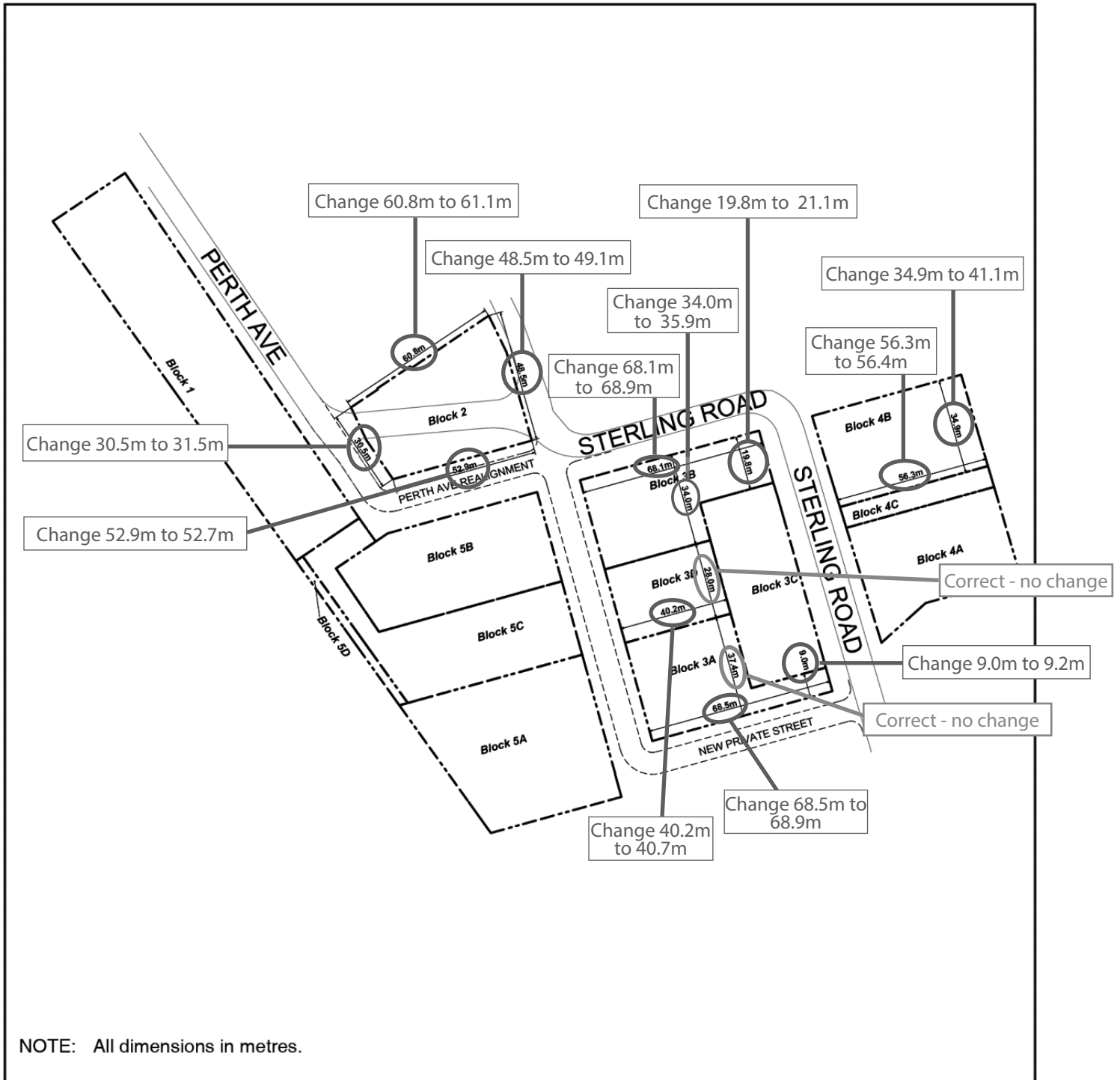

NOTE: All dimensions in metres.

# Redlined Map Illustrating the Required Corrections to the Original Zoning Maps

July 2018

City of Toronto By-law No. 943-2015(OMB)

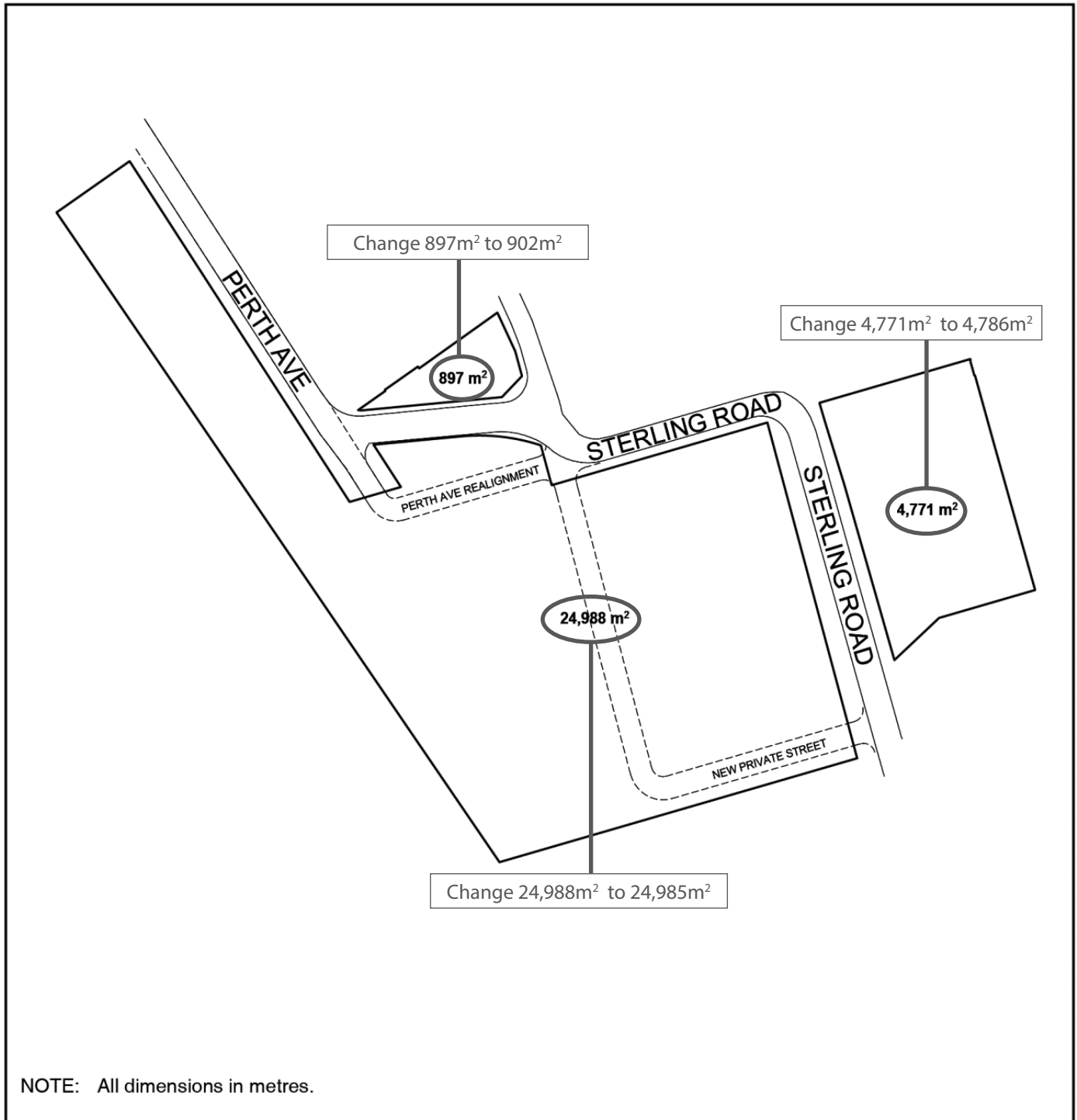

 **TORONTO** City Planning

Map 1

158 Sterling Road

File # 11 \_ 228729 STE 18 0Z

Site



Not to Scale  
05/30/2014

# Redlined Map Illustrating the Required Corrections to the Original Zoning Maps

July 2018

## City of Toronto By-law No. 943-2015(OMB)

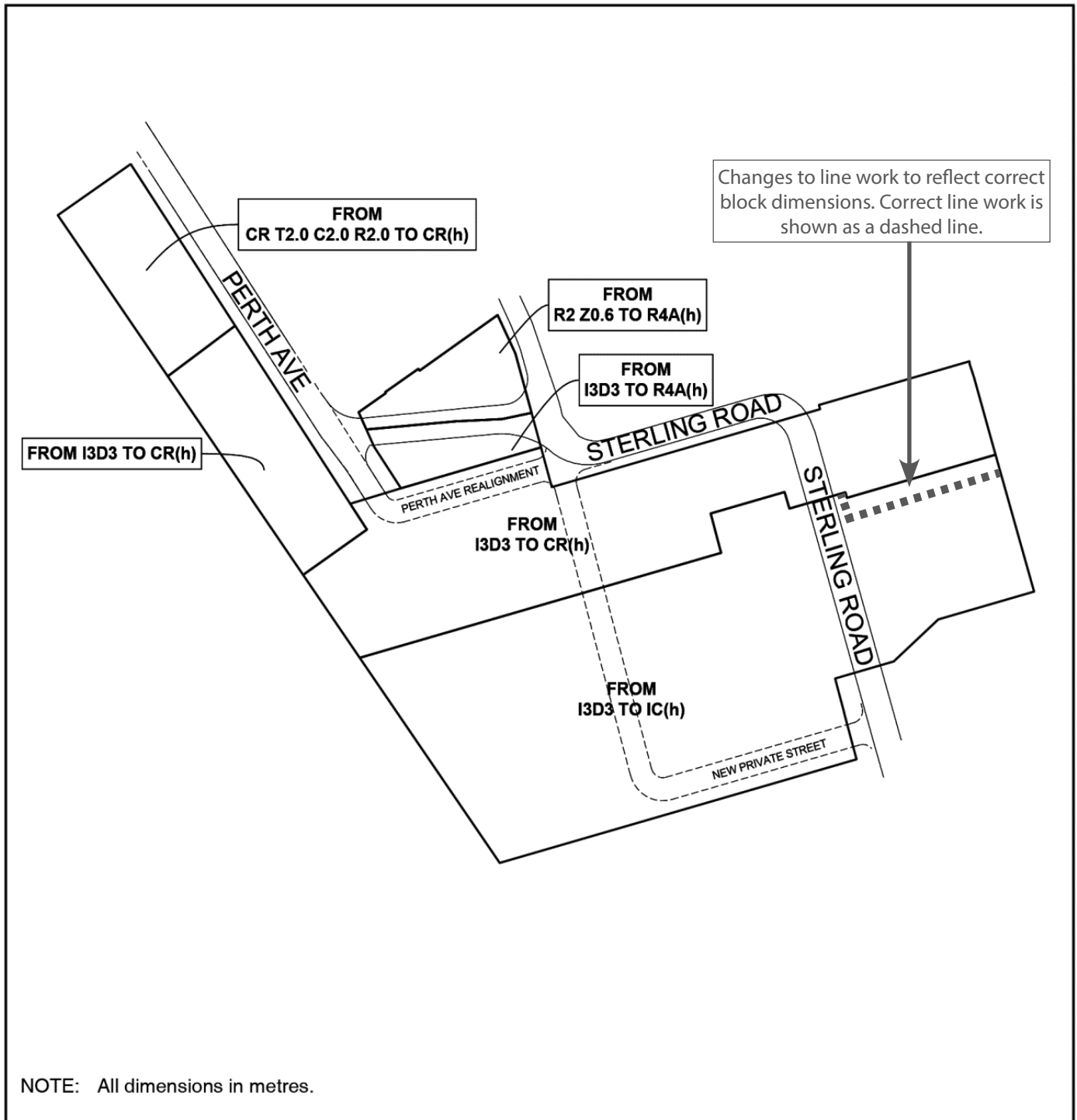

# Redlined Map Illustrating the Required Corrections to the Original Zoning Maps

July 2018

## City of Toronto By-law No. 943-2015(OMB)

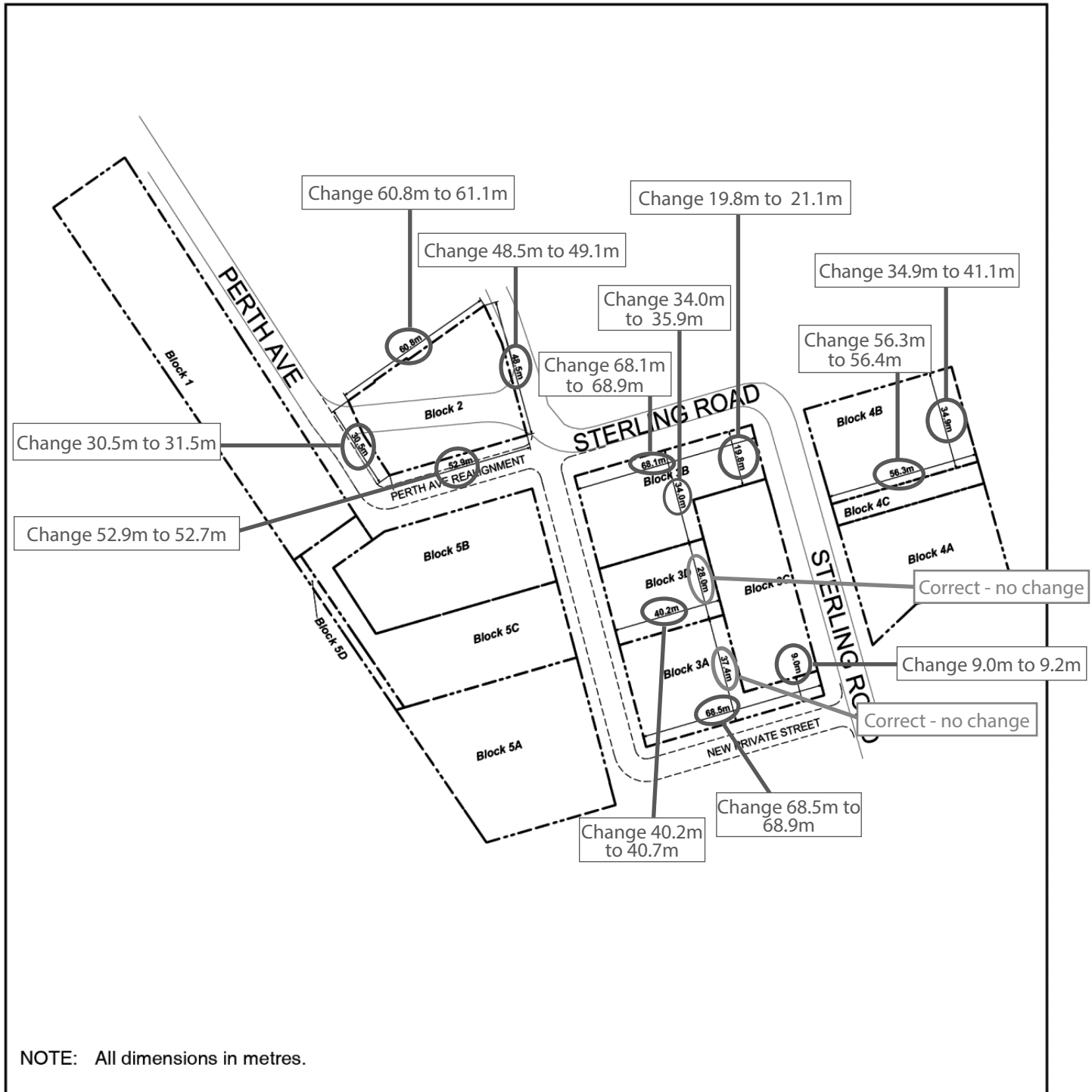

City of Toronto By-law No. 943-2015(OMB)

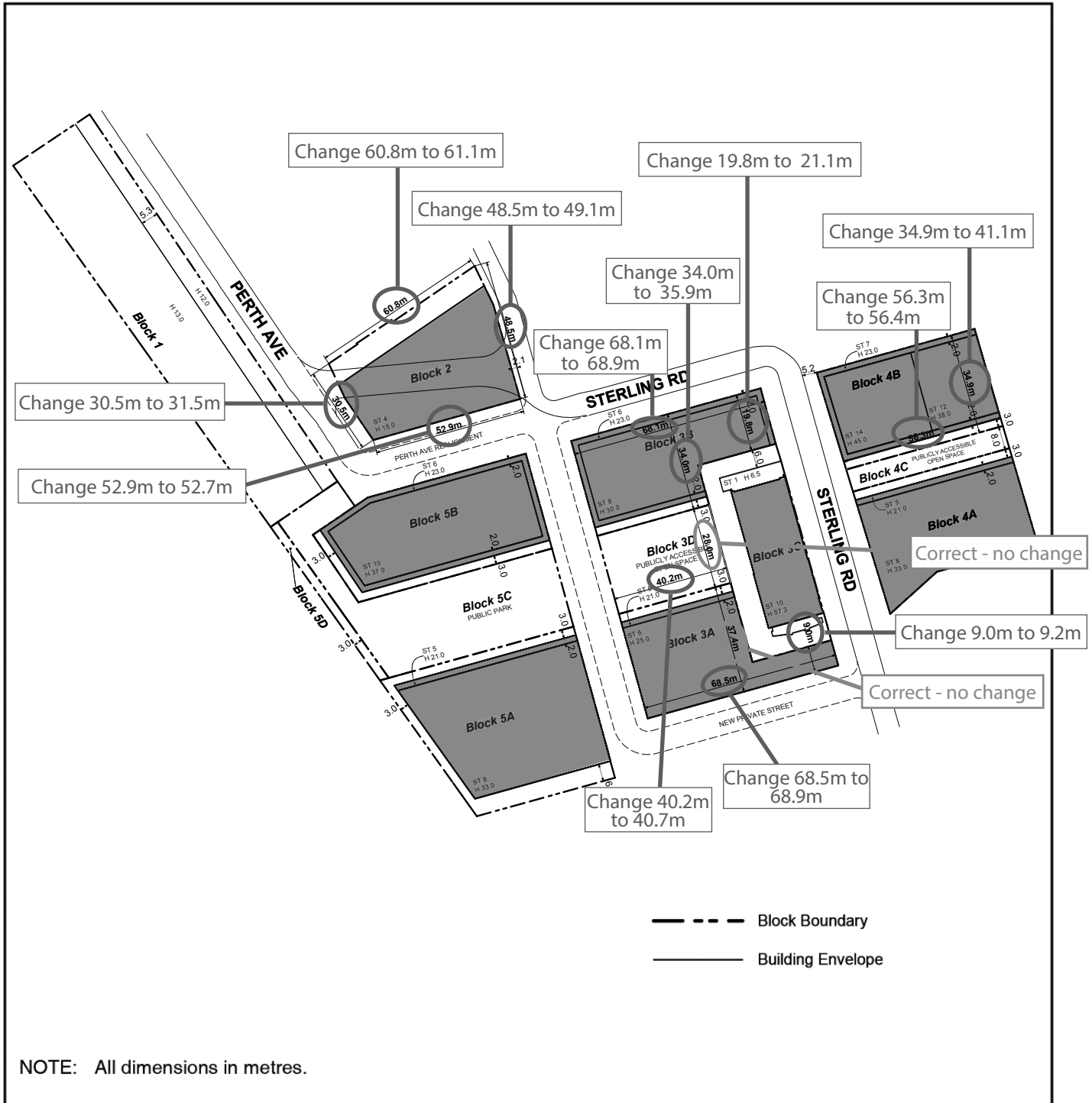

# Redlined Map Illustrating the Required Corrections to the Original Zoning Maps

July 2018

## City of Toronto By-law No. 943-2015(OMB)

