

North York Community Council

From: Daniel Aide <daide@marigoldsandonions.com>
Sent: May 11, 2018 9:34 AM
To: North York Community Council
Cc: Al Salomon; John Valente; Chris Perez
Subject: Request for Letter of Non-Objection - related to Alcohol
Attachments: 2018-02-21 Tennis Canada Liquor Licence Support Letter.doc.pdf; 2017 Rogers Cup SITE PLAN.pdf; Rogers Cup Site Plan.pdf

Greetings,

Further to Al Salomon's telephone conversation with Celeste, I am pleased to attach for your review the information required in order for us to obtain a "letter of non-objection" from North York.

This letter will enable us to receive our temporary extensions for the AGCO.

Thank you for your assistance.

The name of the Event:

- Rogers Cup Tennis Tournament

The exact address or location of the Event:

- Aviva Centre. 1 Shoreham Drive, North York, ON M3N 3A6 on York University Grounds.

The purpose of the Event:

- An annual international tennis tournament played at the Aviva Centre.
- <http://www.rogerscup.com/>

The date(s) of the Event:

- Saturday August 4th – Sunday August 12th 2018.
- Should the event be rained out on the last day, it will be extended to Monday August 13th

The times the Event begins and ends:

- Daily from 10:00 AM – 12:00 AM (24:00)

Attached you will find:

- A letter provided by York University, the property owner, to Tennis Canada indicating their approval.
- A general map of the site.
- A detailed map of the site.

We are hoping you would be able to consider our application for a non-objection letter at your next upcoming meeting. Should you have any questions or require additional information please contact me at the number below.

Thank you for your continued support,

Daniel Aide on behalf of Al Salomon
Special Event Operations
Marigolds and Onions Ltd.
2700 Dufferin Street, Unit 18

Toronto, On, M6B 4J3
Tel: 416-256-4882 ext. 331
Fax: 416-783-1383
daide@marigoldsandonions.com



Marigolds & Onions
CATERING & EVENT PRODUCTION



 Please consider the environment before printing this email.

NOTICE OF CONFIDENTIALITY

This communication including any information transmitted with it is intended only for the use of the addressee and is confidential.

If you receive this communication in error or without authorization please notify us immediately by return e-mail and permanently delete the entire communication from any computer.

YORK



UNIVERSITÉ
UNIVERSITY

Office of the Vice-
President Finance
and Administration

4700 Keele St.
Toronto ON
Canada M3J 1P3
416-736-2100
EXT 40505

February 21, 2018

Mr. Richard Lant
Tennis Canada
1 Shorcham Drive
Suite 100
Toronto, ON M3N 3A6

Dear Mr. Lant:

**Re: Tennis Canada Liquor Licence
Temporary Extension Application for the Rogers Cup
Landlord Letter of Approval**

As the landlord, York University has been notified by Tennis Canada that it is making an application to the AGCO for a Temporary Extension of the Liquor Sales Licence for the Rogers Cup.

It is our understanding that the proposed Temporary Extension of the licence may increase the current licenced areas to include Tennis Canada's entire site for the Rogers Cup within the fence line that surrounds the property.

Accordingly, York University is providing approval of this application.

Sincerely,

Carol McAulay
Vice President, Finance and Administration



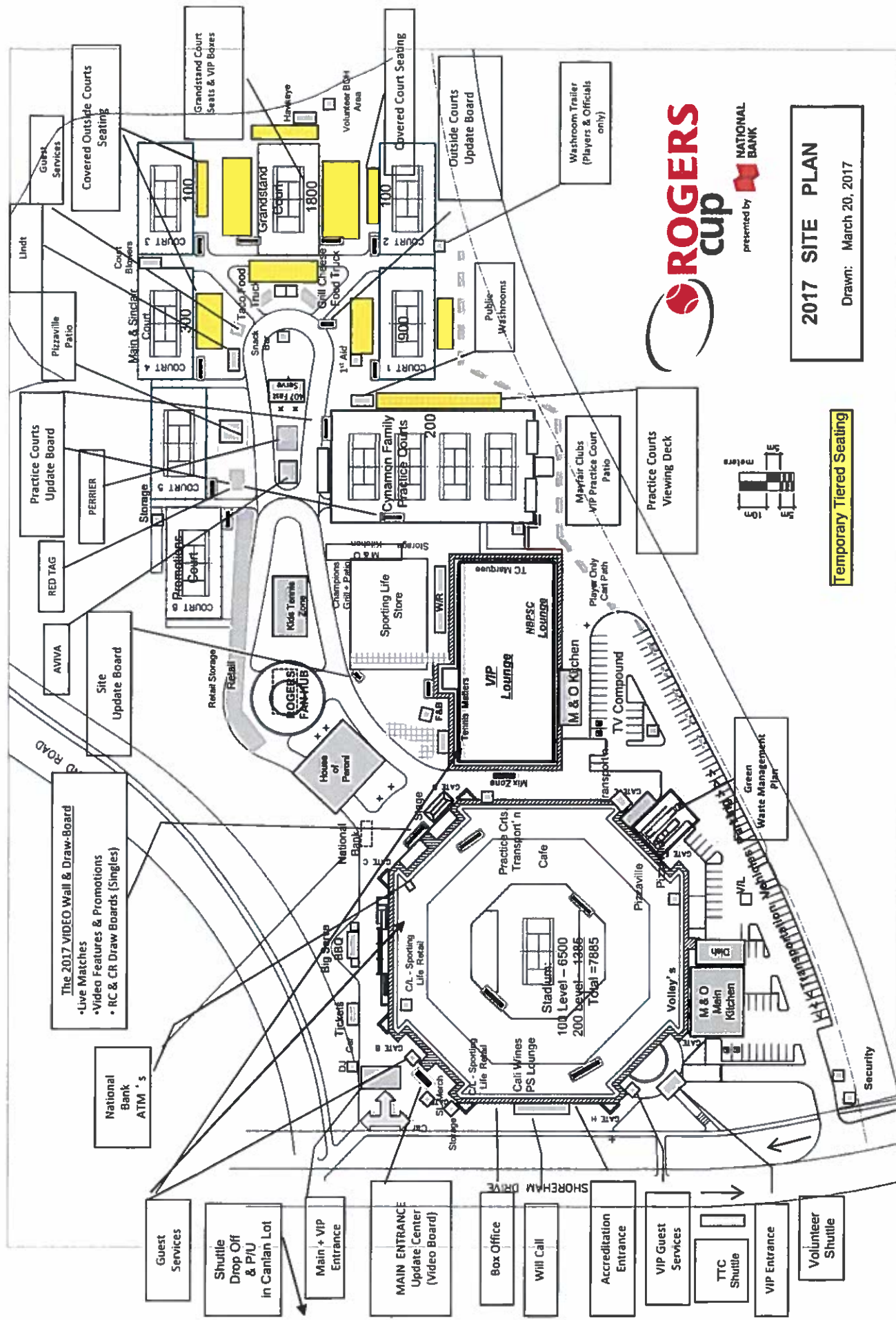

2017 SITE PLAN
Drawn: March 20, 2017

Temporary Tiered Seating

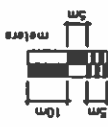

The 2017 VIDEO Wall & Draw-Board
• Live Matches
• Video Features & Promotions
• RC & CR Draw Boards (Singles)

National Bank ATM's

- Guest Services
- Shuttle Drop Off & P/U in Carlian Lot
- Main + VIP Entrance
- MAIN ENTRANCE Update Center (Video Board)
- Box Office
- Will Call
- Accreditation Entrance
- VIP Guest Services
- TTC Shuttle
- VIP Entrance
- Volunteer Shuttle

Tennis Canada Site Plan for Temporary Extension Application

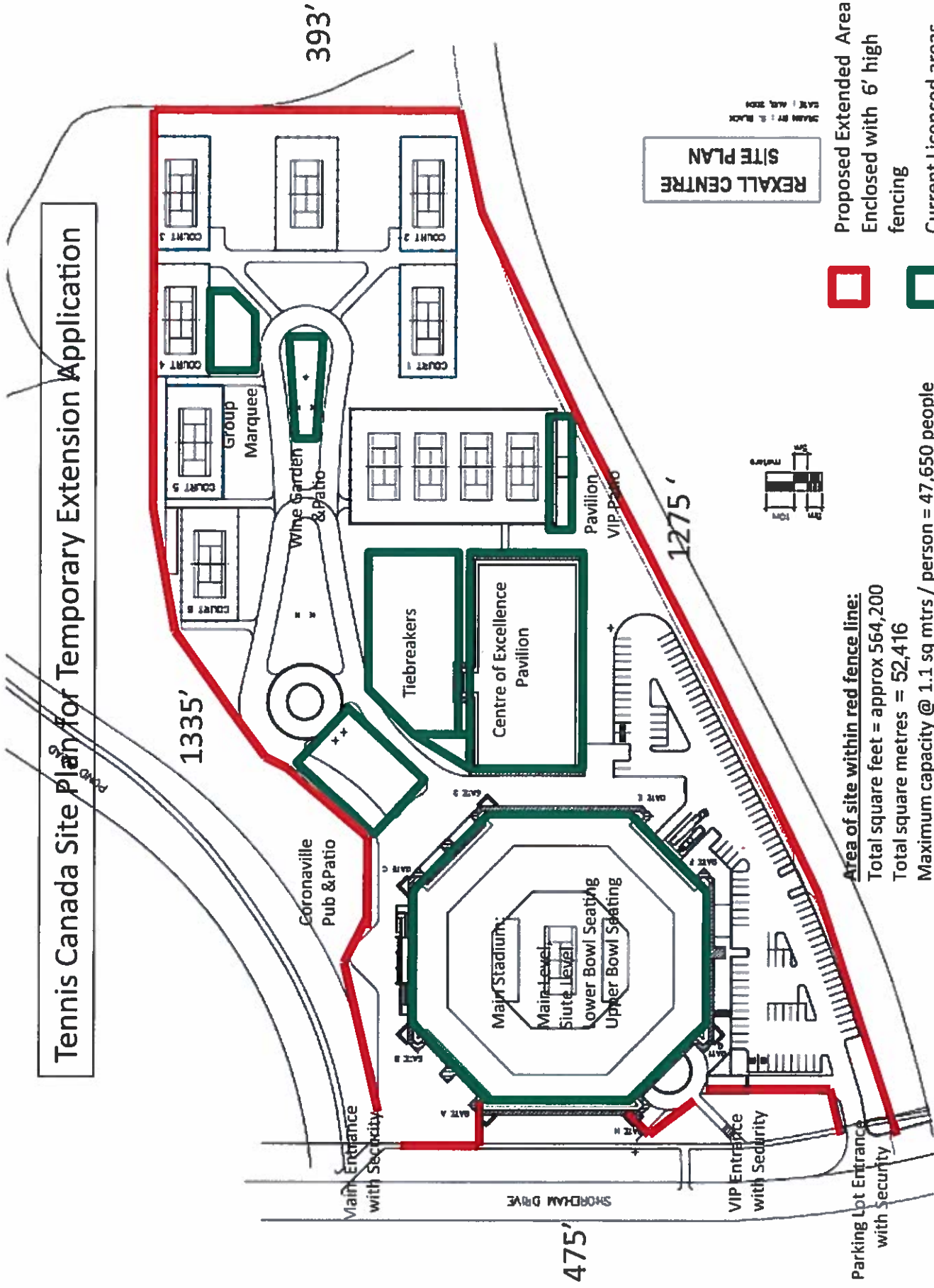

- Proposed Extended Area Enclosed with 6' high fencing
- Current Licenced areas

Area of site within red fence line:
 Total square feet = approx 564,200
 Total square metres = 52,416
 Maximum capacity @ 1.1 sq mtrs / person = 47,650 people

REXALL CENTRE SITE PLAN

SCALE: 1:1000
 DATE: 10/10/2010



475'

1335'

393'

1275'

SPORSHAM DRIVE

Parking Lot Entrance with security

Main Entrance with Security

VIP Entrance with Security

Main Stadium:

Main Level Suite
 Lower Bowl Seating
 Upper Bowl Seating

Coronaville Pub & Patio

Tiebreakers

Centre of Excellence Pavilion

Pavilion
 VIP Pavilion

Wine Garden & Patio

Group Marquee

COURT 5

COURT 4

COURT 3

COURT 2

COURT 1