

Traffic Amendments – Arundel Avenue

Date: January 30, 2018
To: Toronto and East York Community Council
From: Acting Director, Transportation Services, Toronto and East York District
Wards: Ward 29, Toronto-Danforth

SUMMARY

This staff report is about a matter that Community Council has delegated authority to make a final decision, provided that it is not amended so that it varies with City policy or by-laws.

Two at-grade elevators and a station exit building will be constructed at the Toronto Transit Commission's (TTC) Chester subway station as part of the TTC's Easier Access Program and Second Exit Program.

Transportation Services is requesting approval to close a portion of the public laneway for a period of 17 months to accommodate construction activities for the planned second exit building. Also, approval is requested to temporarily convert a section of Arundel Avenue from one-way southbound traffic operations to two-way traffic operations. This will allow the vehicles to access the Toronto Parking Authority (TPA) parking lot located at 14 Arundel Avenue from Danforth Avenue.

RECOMMENDATIONS

The Acting Director, Transportation Services, Toronto and East York District recommends that:

1. Toronto and East York Community Council approve the implementation of two-way traffic operations on Arundel Avenue, between Danforth Avenue and a point 87 metres north, from May 1, 2018 to December 31, 2020.
2. Toronto and East York Community Council approve the closure of a portion of the public laneway (Ln N Danforth E Chester) between the Toronto Parking Authority surface parking lots from May 1, 2018 to September 30, 2019.
3. Toronto and East York Community Council rescind the existing parking prohibition in effect at all times on the east and west sides of Arundel Avenue, between a point 66 metres north of Danforth Avenue and a point 87 metres north of Danforth Avenue.

4. Toronto and East York Community Council rescind the existing parking prohibition in effect from 16th day to the last day of each month, from April 1 to November 30, inclusive on the east side of Arundel Avenue, between Danforth Avenue and a point 66 metres north.

5. Toronto and East York Community Council rescind the existing maximum one-hour parking regulation in effect from 9:00 a.m. to 6:00 p.m., Monday to Friday, first day to the 15th day of each month, from April 1 to November 30, inclusive on the east side of Arundel Avenue, between Danforth Avenue and a point 66 metres north.

6. Toronto and East York Community Council rescind the existing maximum one-hour parking regulation in effect from 9:00 a.m. to 6:00 p.m., Monday to Friday, December 1 of one year to March 31 of the following year, inclusive on the east side of Arundel Avenue, between Danforth Avenue and a point 66 metres north.

7. Toronto and East York Community Council rescind the existing parking prohibition in effect from first day to the 15th day of each month, from April 1 to November 30, inclusive on the west side of Arundel Avenue, between Danforth Avenue and a point 66 metres north.

8. Toronto and East York Community Council rescind the existing parking prohibition in effect from December 1 of one year to March 31 of the following year, inclusive on the west side of Arundel Avenue, between Danforth Avenue and a point 66 metres north.

9. Toronto and East York Community Council rescind the existing maximum one-hour parking regulation in effect from 9:00 a.m. to 6:00 p.m., Monday to Friday, 1st day to the 15th day of each month, from April 1 to November 30, inclusive on the west side of Arundel Avenue, between Danforth Avenue and a point 66 metres north.

10. Toronto and East York Community Council prohibit standing at all times on the east and west sides of Arundel Avenue, between Danforth Avenue and a point 87 metres north.

FINANCIAL IMPACT

There is no financial impact to the City. TTC will be responsible for all costs associated with the installation of signage and pavement markings on Arundel Avenue.

DECISION HISTORY

This is a new initiative.

COMMENTS

Station improvements in the form of two at-grade elevators and a second exit building are planned at the Toronto Transit Commission (TTC) Chester subway station. The station is located at 22 Chester Avenue and surrounded by existing residential uses to the north and south, Chester Avenue to the east and a public laneway (Ln N Danforth and W Chester) to the west.

The planned at-grade elevators are part of the TTC's Easier Access Program and will be installed at the main station building. The planned second exit building will be constructed within the TPA surface parking lot located at 29-31 Chester Avenue (hereafter referred to as the west parking lot). The subject west TPA parking lot is located directly opposite to the main station building and fronts onto the east side of Chester Avenue.

Another nearby TPA surface parking lot is located at 14 Arundel Avenue (hereafter referred to as the east parking lot). The east and west parking lots are connected by a north-south public laneway (Ln N Danforth E Chester), thus enabling east-west traffic movements between the two parking lots. The east parking lot can be accessed from Arundel Avenue (one-way southbound) and from Chester Avenue via the west parking lot.

The public laneway, between the two parking lots, provides vehicular access to the parking garages of the residential units along Chester Avenue and Arundel Avenue and can also be accessed from Ainsworth Road.

Construction of the project will be undertaken in several stages and is expected to be completed in approximately 32 months. With the exception of Stages 1 and 2, construction activities during all stages will be contained within the property limits of the main station and the east parking lot, with no proposed occupation of the road right-of-way.

During the Stages 1 and 2 of the construction, a portion of the public laneway (Ln N Danforth E Chester) between the two TPA parking lots will be closed to accommodate construction activities for the second exit building. The proposed closure of a portion of the public laneway will not eliminate vehicular access to the parking garages of the residential units along Chester Avenue and Arundel Avenue, as the parking garages can be accessed from Ainsworth Road. However, with the proposed closure of a portion of the public laneway in place, the east-west traffic movements between the two TPA parking lots will be restricted, thus limiting vehicular access to the east parking lot from Arundel Avenue only.

In order to provide additional vehicular access to the east parking lot from Danforth Avenue, it is recommended that a section of Arundel Avenue, between Danforth Avenue and the northern limit of the east parking lot, be converted to two-way traffic operations for the entire duration of the project.

Arundel Avenue, between Danforth Avenue and Browning Avenue is a local roadway and operates one-way southbound, on a pavement width of 7.3 metres. There is no TTC bus service on this roadway. Furthermore, the east and west side Arundel Avenue belongs to permit parking area 8A. This area has 974 parking spaces available and 906 parking permits have been issued as of January 17, 2018.

The following parking regulations are in effect on the subject section of Arundel Avenue:

East Side:

- "No Parking, Anytime" between a point 66 metres north of Danforth Avenue and a point 87 metres north of Danforth Avenue.
- "No Parking, 16th day to the last day of each month, from April 1 to November 30, inclusive" between Danforth Avenue and a point 66 metres north.
- "Permit Parking, 3:30 p.m. to 10:00 a.m.", from a point 96 metres north of Danforth Avenue to a point 43.4 metres north of Fulton Avenue.
- "Maximum One-Hour Parking, 9:00 a.m. to 6:00 p.m., Monday to Friday, first day to the 15th day of each month, from April 1 to November 30, inclusive" between Danforth Avenue and a point 66 metres north.
- "Maximum One-Hour Parking, 9:00 a.m. to 6:00 p.m., Monday to Friday, December 1 of one year to March 31 of the next following year, inclusive" between Danforth Avenue and a point 66 metres north.

West Side:

- "No Parking, Anytime" between a point 66 metres north of Danforth Avenue and a point 87 metres north of Danforth Avenue.
- "No Parking, first day to the 15th day of each month, from April 1 to November 30, inclusive" between Danforth Avenue and a point 66 metres north.
- "No Parking, Anytime, from December 1 of one year to March 31 of the next following year, inclusive" between a Danforth Avenue and a point 66 metres north.
- "Permit Parking, 3:30 p.m. to 10:00 a.m.", from a point 96 metres north of Danforth Avenue to a point 43.4 metres north of Fulton Avenue.
- "Maximum One-Hour Parking, 9:00 a.m. to 6:00 p.m., Monday to Friday, 1st day to the 15th day of each month, from April 1 to November 30, inclusive" between Danforth Avenue and a point 66 metres north.

During a site investigation, it has been revealed that the permit parking regulations on the east and west side of Arundel Avenue, between a point 96 metres north of Danforth Avenue to a point 43.4 metres north of Fulton Avenue do not correspond with on-street signage. Therefore, in order to ensure that there are no issues with regards to enforcement of the signs, the parking regulation will be amended to operate between a point 35 metres north of Danforth Avenue and a point 43 metres north of Fulton Avenue. The Permit Parking Unit will amend the permit parking regulations subsequent to the completion of the project.

Subject to approval, it is recommended that the section of Arundel Avenue, between Danforth Avenue and a point 87 metres north, be converted from a one-way southbound traffic operations to a two-way traffic operations. A two-way traffic operations will allow vehicles to access the east parking lot from Danforth Avenue for the duration of the project.

The existing parking regulations on both sides of Arundel Avenue, between Danforth Avenue and a point 87 metres north, will need to be amended to a "No Standing, Anytime" prohibition in order to provide unobstructed two-way traffic flow on the subject section of the roadway. As a result, four on-street permit parking spaces would temporarily be removed. In order to accommodate the permit holders, TTC has arranged additional permit parking spaces at the east TPA parking lot for the duration of the construction.

Councillor Mary Fragedakis' office has been advised of the recommendations of this staff report.

CONTACT

Bruce Clayton
Manager, Traffic Operations
Toronto and East York District
Transportation Services
Telephone: (416) 397-5021
Fax: (416) 392-1920
E-mail: Bruce.Clayton@toronto.ca

SIGNATURE

Dave Twaddle, C.E.T.
Acting Director, Transportation Services
Toronto and East York District

ATTACHMENTS

Drawing No. 421G-2858, dated January 2018
Drawing No. 421G-2859, dated January 2018

P:\2018\Cluster B\Tra\ts2018033te.top.doc - nb

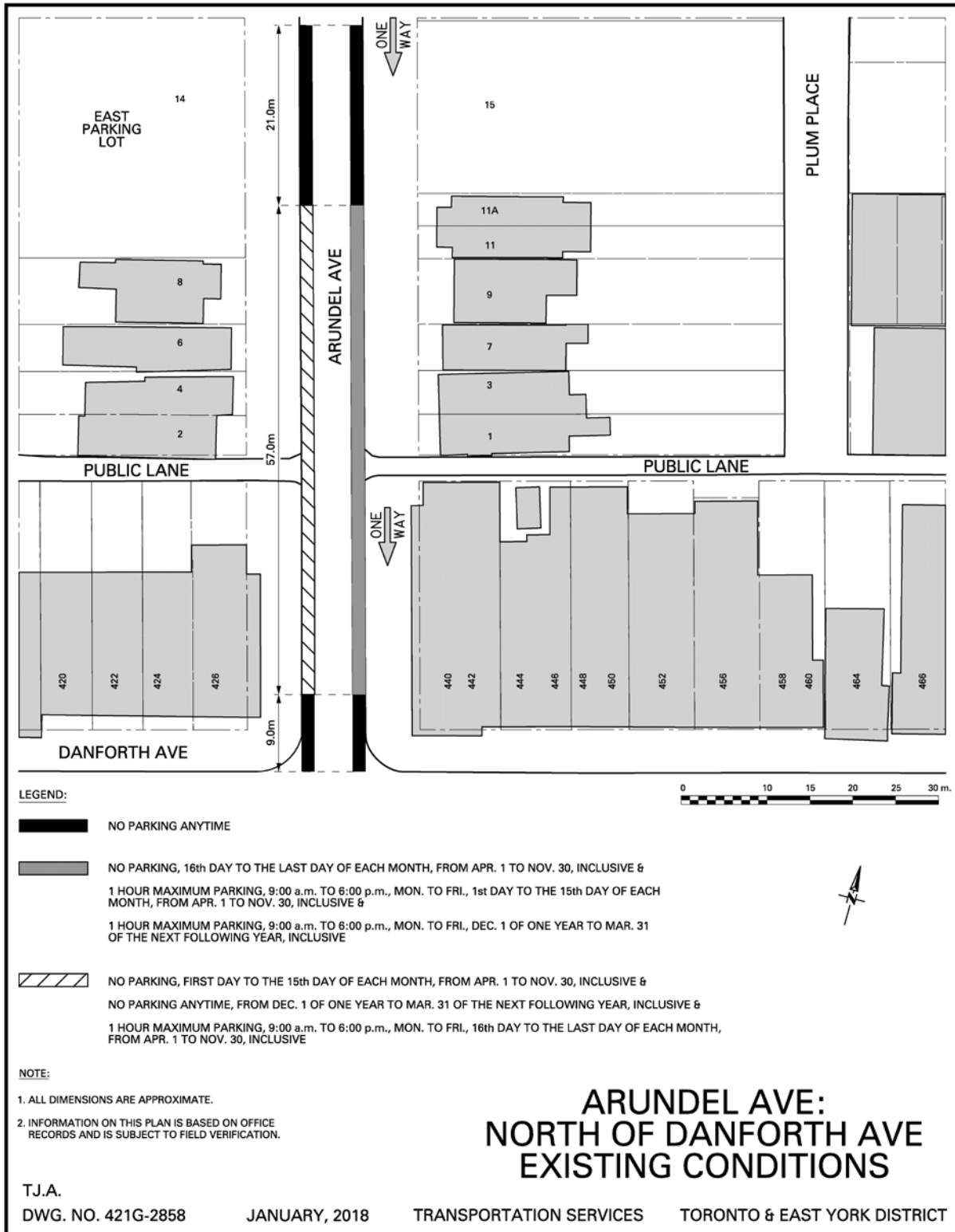

Arundel Avenue: Existing Conditions

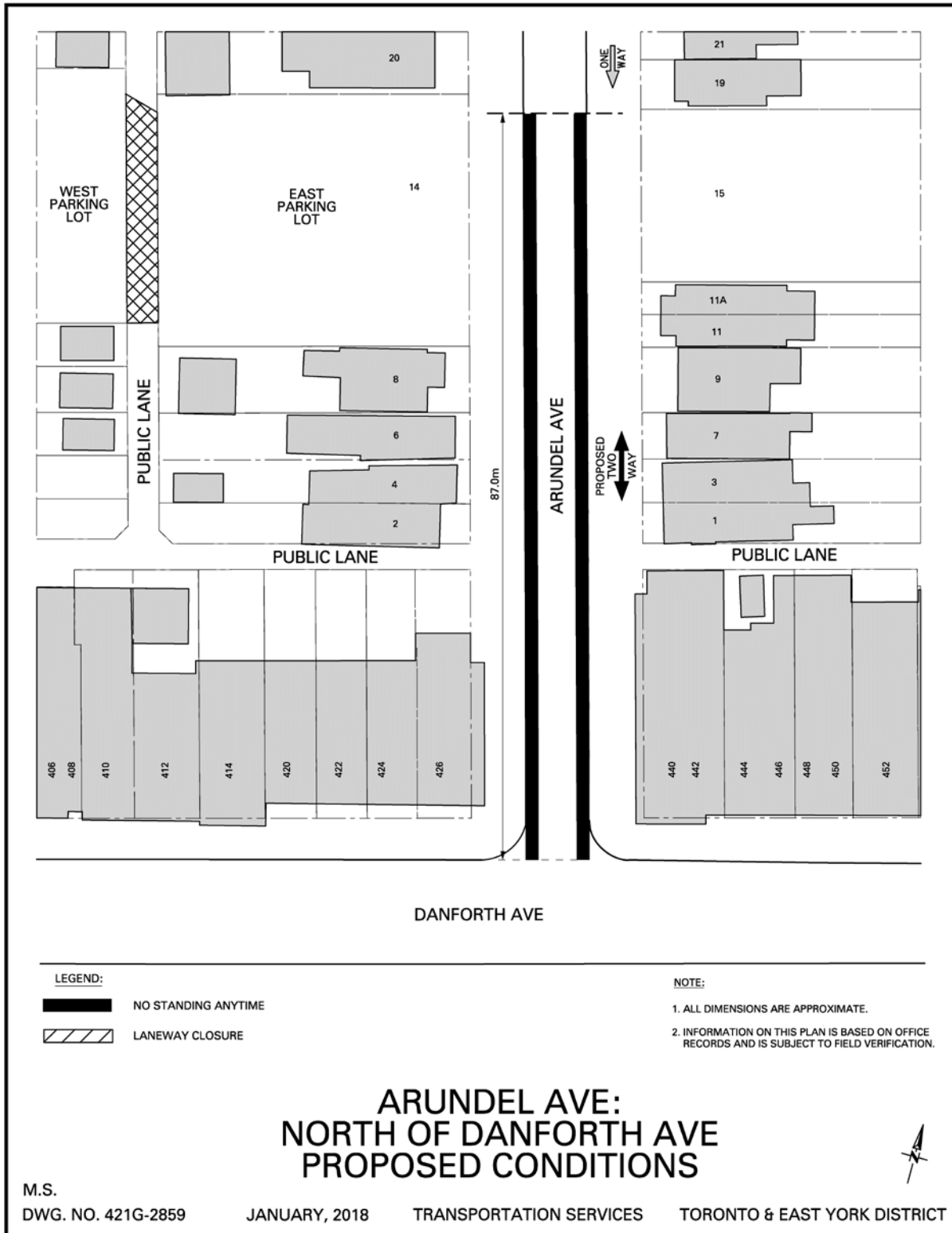

Arundel Avenue: Proposed Conditions