

Parking Amendments - Lillian Street and Redpath Avenue

Date: August 28, 2019
To: Toronto and East York Community Council
From: Acting Director, Traffic Management, Transportation Services
Wards: Ward 12, Toronto - St. Paul's

SUMMARY

This staff report is about a matter for which Community Council has delegated authority from City Council to make a final decision, provided that it is not amended so that it varies with City Policy or by-laws.

Transportation Services is recommending that standing be prohibited at all times on the east side of Lillian Street and the west side of Redpath Avenue, between Eglinton Avenue East and Soudan Avenue. This is in response to complaints about vehicles parking in the existing "No Parking Anytime" areas and blocking sightlines for motorists using driveways on these two roads. This will discourage illegal parking and not allow parking by vehicles with accessible permits. This proposal will not result in the loss of any parking spaces on Lillian Street or on Redpath Avenue.

RECOMMENDATIONS

The Acting Director, Traffic Management, Transportation Services, recommends that:

1. Toronto and East York Community Council rescind the existing parking prohibition in effect at all times on the east side of Lillian Street, between Eglinton Avenue East and a point 88 metres north of Soudan Avenue.
2. Toronto and East York Community Council prohibit standing at all times on the east side of Lillian Street, between Eglinton Avenue East and a point 88 metres north of Soudan Avenue.
3. Toronto and East York Community Council rescind the existing parking prohibition in effect at all times on the west side of Redpath Avenue, between Soudan Avenue and Eglinton Avenue East.

4. Toronto and East York Community Council prohibit standing at all times on the west side of Redpath Avenue, between Eglinton Avenue East and Soudan Avenue.

FINANCIAL IMPACT

All costs associated with the necessary signage installation are included within the Transportation Services 2019 Operating Budget.

DECISION HISTORY

This report addresses a new initiative.

COMMENTS

Redpath Avenue, between Eglinton Avenue East and Soudan Avenue, operates two-way on a pavement width of 8.5 metres and has a maximum speed limit of 30 km/h. Traffic calming (speed humps) have been installed on this section of Redpath Avenue. There is no TTC service provided on Redpath Avenue. The following parking regulations are generally in effect on Redpath Avenue, between Eglinton Avenue East and Soudan Avenue:

East side

- No parking from 7:00 a.m. to 9:00 a.m. and from 4:00 p.m. to 6:00 p.m., Monday to Friday, except public holidays;
- Pay-and-display parking from 9:00 a.m. to 4:00 p.m. and 6:00 p.m. to 9:00 p.m., Monday to Friday; from 8:00 a.m. to 9:00 p.m. Saturday and from 1:00 p.m. to 9:00 p.m. Sunday, for a maximum period of three hours; and
- Parking is permitted for a maximum period of three hours at all other times.

West side

- No parking anytime.

Lillian Street, between Eglinton Avenue East and Soudan Avenue, operates one-way in the southbound direction on a pavement width of 8.5 metres and has a maximum speed limit of 30 km/h. There is no TTC service provided on Lillian Street. The following parking regulations are generally in effect on Lillian Street, between Eglinton Avenue East and Soudan Avenue:

East side

- No parking anytime between a point 88 metres north of Soudan Avenue and Eglinton Avenue East;
- Pay-and-display parking from 8:00 a.m. to 9:00 p.m., Monday to Saturday; and from 1:00 p.m. to 9:00 p.m. Sunday, for a maximum period of three hours, between a point 56 metres north of Soudan Avenue and a point 32 metres further north;
- No stopping anytime between Soudan Avenue and a point 56 metres north; and
- Parking is permitted for a maximum period of three hours at all other times.

West side

- Pay-and-display parking from 8:00 a.m. to 9:00 p.m., Monday to Saturday; and from 1:00 p.m. to 9:00 p.m. Sunday, for a maximum period of three hours, between a point 93.5 metres north of Soudan Avenue and Eglinton Avenue East;
- No stopping anytime between Soudan Avenue and a point 93.5 metres north; and
- Parking is permitted for a maximum period of three hours at all other times.

The areas on the east side of Lillian Street, between Eglinton Avenue East and a point 88 metres north of Soudan Avenue, and on the west side of Redpath Avenue, between Eglinton Avenue East and Soudan Avenue, have "No Parking Anytime" regulations. Our review has confirmed the presence of illegal parking and vehicles that are parked with accessible permits in these areas that sometimes block sightlines for motorists using driveways on these two roads.

Transportation Services staff investigated the feasibility of prohibiting standing on the east side of Lillian Street and on the west side of Redpath Avenue, between Eglinton Avenue East and Soudan Avenue. Based on our review and consultation with Councillor Josh Matlow, we can support the installation of "No Standing Anytime" on the east side of Lillian Street, between Eglinton Avenue East and a point 88 metres north of Soudan Avenue, and on the west side of Redpath Avenue, between Eglinton Avenue East and Soudan Avenue. This will discourage illegal parking and will not allow for parking of vehicles with accessible permits in these areas. This proposal will not result in the loss of any parking spaces on Lillian Street or Redpath Avenue.

Councillor Josh Matlow has been advised of the recommendations of this staff report.

CONTACT

Shawn Dillon
Manager, Traffic Operations (Area 1)
Traffic Management
Transportation Services
Telephone: (416) 397-5021
Fax: (416) 392-1920
E-mail: Shawn.Dillon@toronto.ca

SIGNATURE

Roger Browne, M.A.Sc., P.Eng.,
Acting Director,
Traffic Management
Transportation Services

ATTACHMENTS

1. Drawing No. 421G - 3501, dated August 2019

P:\2019\Cluster B\Tra\Toronto and East York\Top\Ts2019224te.top.doc – mb

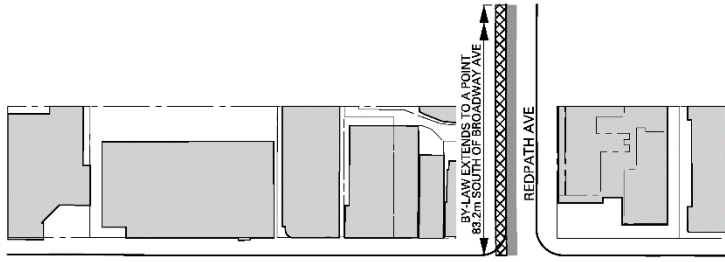

EGLINTON AVE E

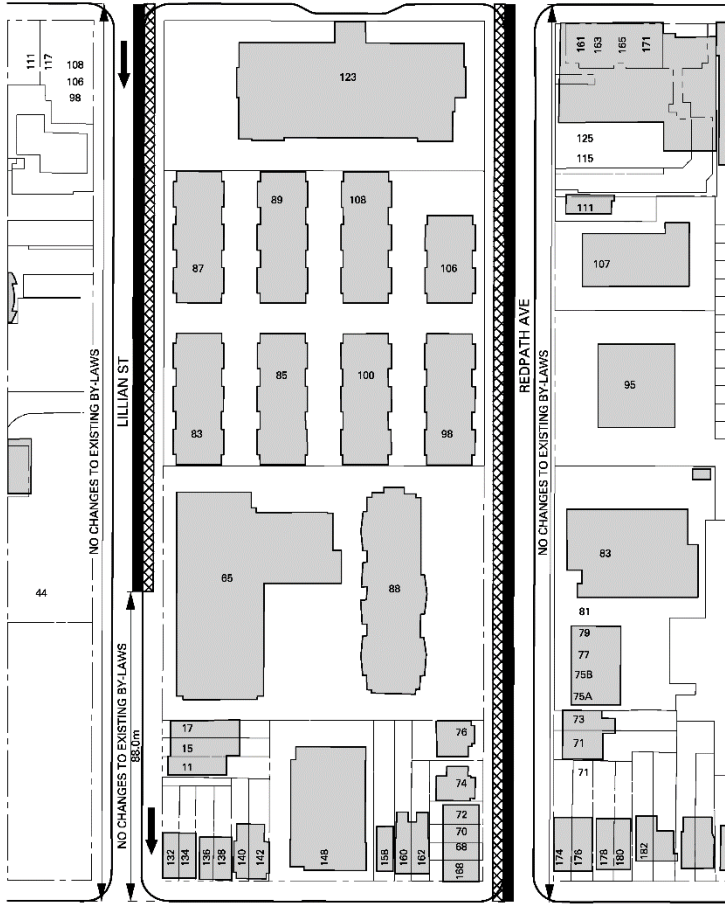

SOUDAN AVE

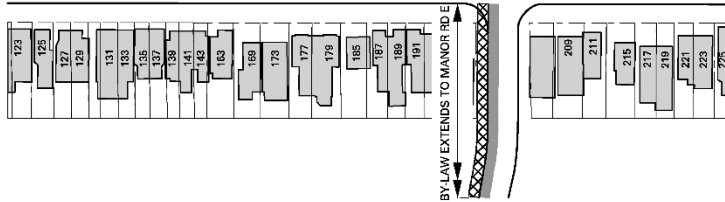

LEGEND:

- PROPOSED NO PARKING ANYTIME
- PROPOSED NO STANDING ANYTIME
- ▨ EXISTING NO PARKING ANYTIME TO BE RESCINDED

NOTE:

1. ALL DIMENSIONS ARE APPROXIMATE.
2. INFORMATION ON THIS PLAN IS BASED ON OFFICE RECORDS AND IS SUBJECT TO FIELD VERIFICATION.

REDPATH ST: PROPOSED PARKING AMENDMENTS & LILLIAN ST: PROPOSED PARKING AMENDMENTS

DWG. NO. 421G-3501

T.J.A.

AUGUST, 2019

TRANSPORTATION SERVICES

TORONTO & EAST YORK DISTRICT