

General Notes:

- These Contract Documents are the property of the Architect. The Architect bears no responsibility for the interpretations of these documents by the contractor. Upon written application the Architect will provide written clarification or supplementary information regarding the intent of the Contract Documents. The Architect will review Shop Drawings submitted by the Contractor for design conformance only. Drawings are not to be scaled for construction. Contractor to verify all existing conditions and dimensions required to perform the Work, and report any discrepancies with the Contract Documents to the Architect before commencing work.
- Positions of exposed or finished mechanical or electrical devices, fittings, and fixtures are indicated on the Architectural drawings. The locations shown on the Architectural drawings govern over the Mechanical and Electrical drawings. These items not clearly located will be located as directed by the Architect.

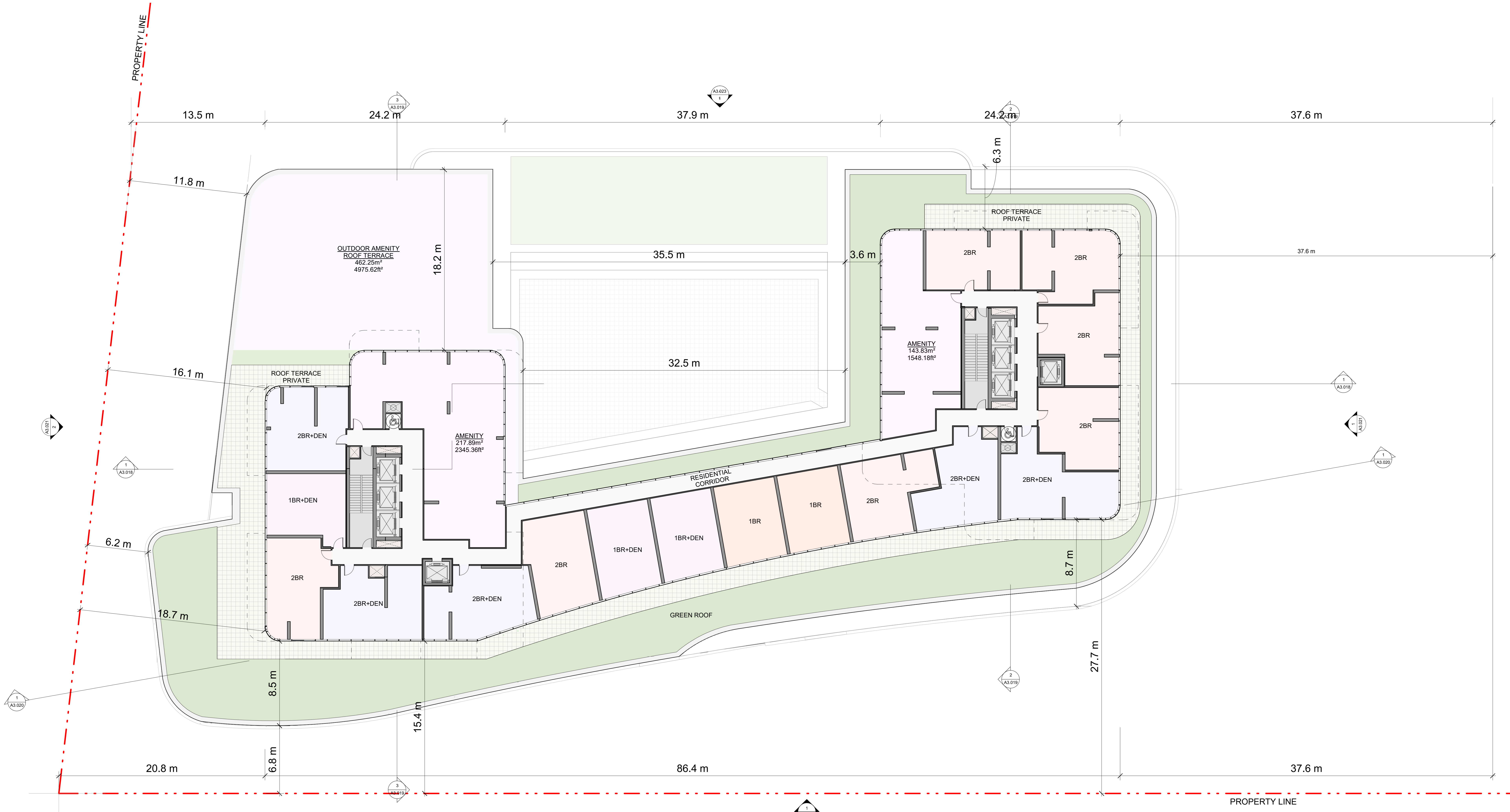
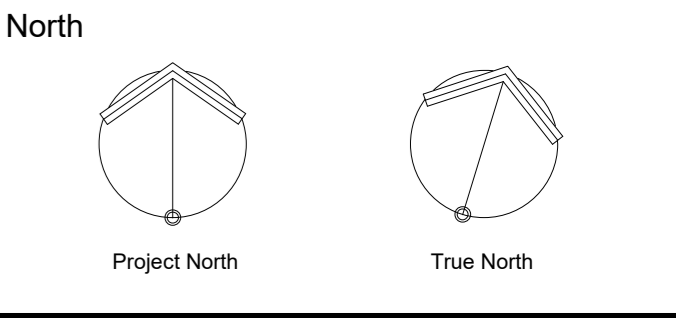

- 1BR
- 1BR+DEN
- 2BR
- 2BR+DEN
- AMENITY
- ELEVATOR SHAFT
- EL.C.
- EXIT STAIR
- GARBAGE
- GREEN ROOF
- LANDSCAPE BUFFER
- MECH.C.
- OUTDOOR AMENITY
- RESIDENTIAL CORRIDOR
- ROOF TERRACE
- ROOF TERRACE PRIVATE

Rev.	Issue / Description	Date
4	SUBMISSION	Apr 22, 2020
3	SUBMISSION	Jan 22, 2020
2	REV. ISSUED FOR OPA/ZBA	Nov 14, 2018
1	ISSUED FOR OPA/ZBA	July 21, 2017



Architect of Record:  
**HARIRI PONTARINI ARCHITECTS**  
 235 Carlaw Avenue  
 Suite 301  
 Toronto, Canada M4M 2S1  
 TEL: 416 929 4901  
 FAX: 416 929 8924  
 info@hp-arch.com  
 hariripontarini.com

Project Title:  
**BAYVIEW VILLAGE SOUTH-WEST DEVELOPMENT**  
 Address: TORONTO, ONTARIO

**FLOOR PLAN 6**

Project number: 1432  
 Scale: 1/150  
 Date: 08/11/20  
 Drawn by: HPA

Drawing No.: Revision:

**A3.013**

General Notes:

- These Contract Documents are the property of the Architect. The Architect bears no responsibility for the interpretations of these documents by the contractor. Upon written application the Architect will provide written clarification or supplementary information regarding the intent of the Contract Documents. The Architect will review Shop Drawings submitted by the Contractor for design conformance only. Drawings are not to be scaled for construction. Contractor to verify all existing conditions and dimensions required to perform the Work, and report any discrepancies with the Contract Documents to the Architect before commencing work.
- Positions of exposed or finished mechanical or electrical devices, fittings, and fixtures are indicated on the Architectural drawings. The locations shown on the Architectural drawings govern over the Mechanical and Electrical drawings. These items not clearly located will be located as directed by the Architect.

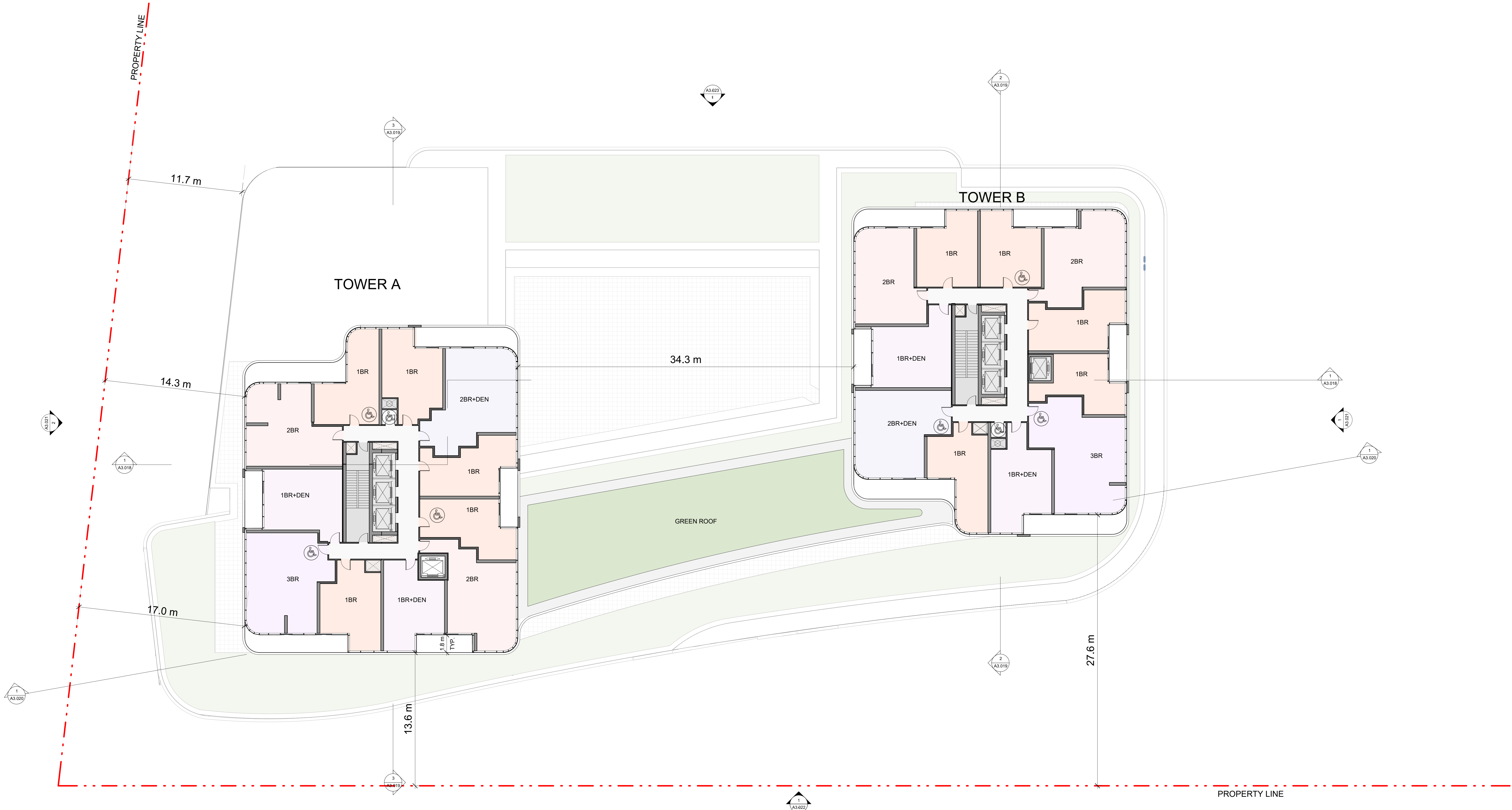
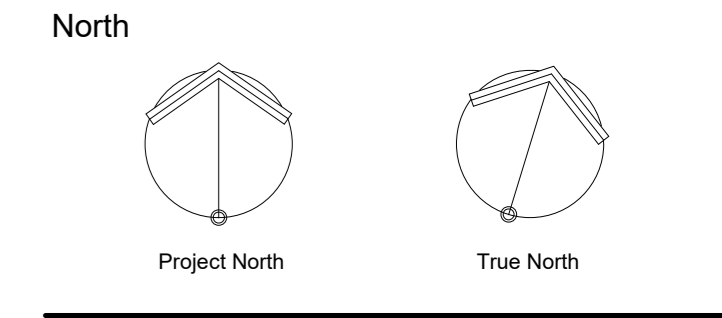

- 1BR
- 1BR+DEN
- 2BR
- 2BR+DEN
- 3BR
- BALCONY
- ELEVATOR SHAFT
- EL.C.
- EXIT STAIR
- GARBAGE
- GREEN ROOF
- MECH.C.
- RESIDENTIAL CORRIDOR
- ROOF TERRACE

Rev.	Issue / Description	Date
4	SUBMISSION	Apr 22, 2020
3	SUBMISSION	Jan 22, 2020
2	REV. ISSUED FOR OPA/ZBA	Nov 14, 2018
1	ISSUED FOR OPA/ZBA	July 21, 2017



Architect of Record:  
**HARIRI PONTARINI ARCHITECTS**  
 235 Carlaw Avenue  
 Suite 301  
 Toronto, Canada M4M 2S1  
 TEL: 416 929 4901  
 FAX: 416 929 8924  
 info@hp-arch.com  
 hariripontarini.com

Project Title:  
**BAYVIEW VILLAGE SOUTH-WEST DEVELOPMENT**  
 Address: TORONTO, ONTARIO

**FLOOR PLAN 7**

Project number: 1432  
 Scale: 1/150  
 Date: 08/11/20  
 Drawn by: HPA

Drawing No.: Revision:

**A3.014**

4/21/2020 6:18:11 PM

General Notes:

- These Contract Documents are the property of the Architect. The Architect bears no responsibility for the interpretations of these documents by the contractor. Upon written application the Architect will provide written clarification or supplementary information regarding the intent of the Contract Documents. The Architect will review Shop Drawings submitted by the Contractor for design conformance only. Drawings are not to be used for construction. Contractor to verify all existing conditions and dimensions required to perform the Work, and report any discrepancies with the Contract Documents to the Architect before commencing work.
- Positions of exposed or finished mechanical or electrical devices, fittings, and fixtures are indicated on the Architectural drawings. The locations shown on the Architectural drawings govern over the Mechanical and Electrical drawings. These items not clearly located will be located as directed by the Architect.

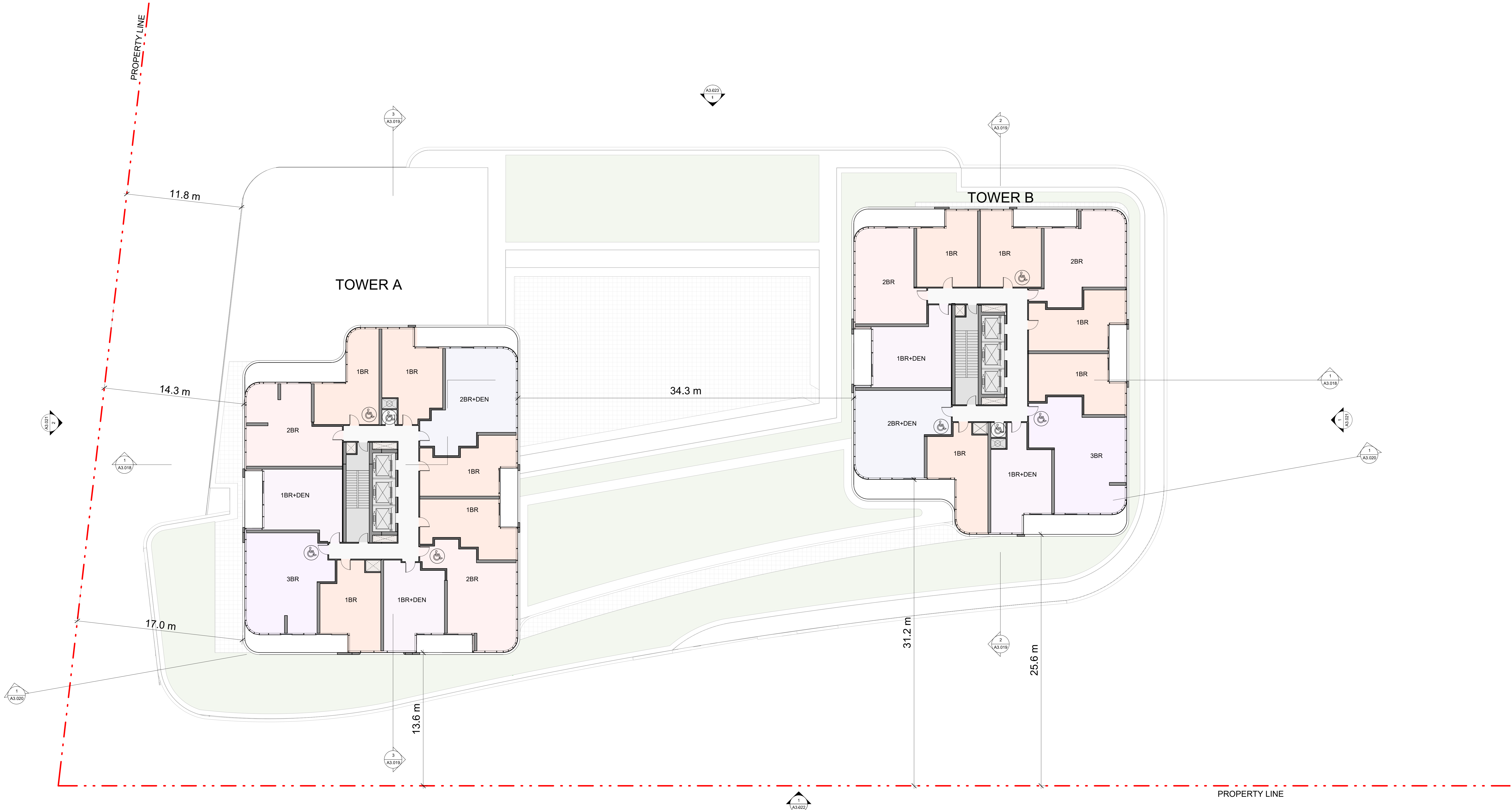
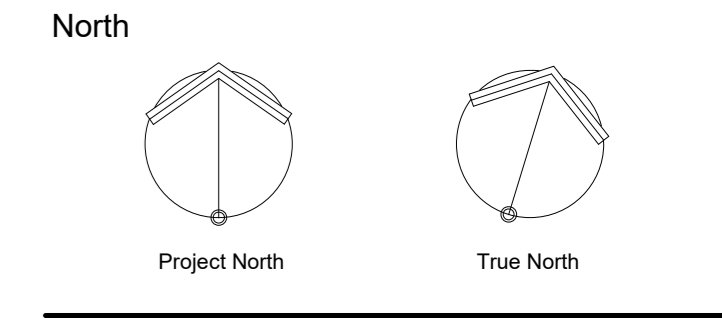

- 1BR
- 1BR+DEN
- 2BR
- 2BR+DEN
- 3BR
- BALCONY
- ELEVATOR SHAFT
- EL.C.
- EXIT STAIR
- GARBAGE
- MECH.C.
- RESIDENTIAL CORRIDOR

Rev	Issue / Description	Date
4	SUBMISSION	Apr 22, 2020
3	SUBMISSION	Jan 22, 2020
2	REV. ISSUED FOR OPA/ZBA	Nov 14, 2018
1	ISSUED FOR OPA/ZBA	July 21, 2017



Architect of Record:  
**HARIRI PONTARINI ARCHITECTS**  
 235 Carlaw Avenue  
 Suite 301  
 Toronto, Canada M4M 2S1  
 TEL: 416 929 4901  
 FAX: 416 929 8924  
 info@hp-arch.com  
 hariripontarini.com

Project Title:  
**BAYVIEW VILLAGE SOUTH-WEST DEVELOPMENT**  
 Address: TORONTO, ONTARIO

**TYPICAL TOWERS FLOOR PLAN**

Project number: 1432  
 Scale: 1/150  
 Date: 08/11/20  
 Drawn by: HPA

Drawing No.: Revision:

**A3.015a**

General Notes:

- These Contract Documents are the property of the Architect. The Architect bears no responsibility for the interpretations of these documents by the contractor. Upon written application the Architect will provide written clarification or supplementary information regarding the intent of the Contract Documents. The Architect will review Shop Drawings submitted by the Contractor for design conformance only. Drawings are not to be scaled for construction. Contractor to verify all existing conditions and dimensions required to perform the Work, and report any discrepancies with the Contract Documents to the Architect before commencing work.
- Positions of exposed or finished mechanical or electrical devices, fittings, and fixtures are indicated on the Architectural drawings. The locations shown on the Architectural Drawings govern over the Mechanical and Electrical drawings. These items not clearly located will be located as directed by the Architect.

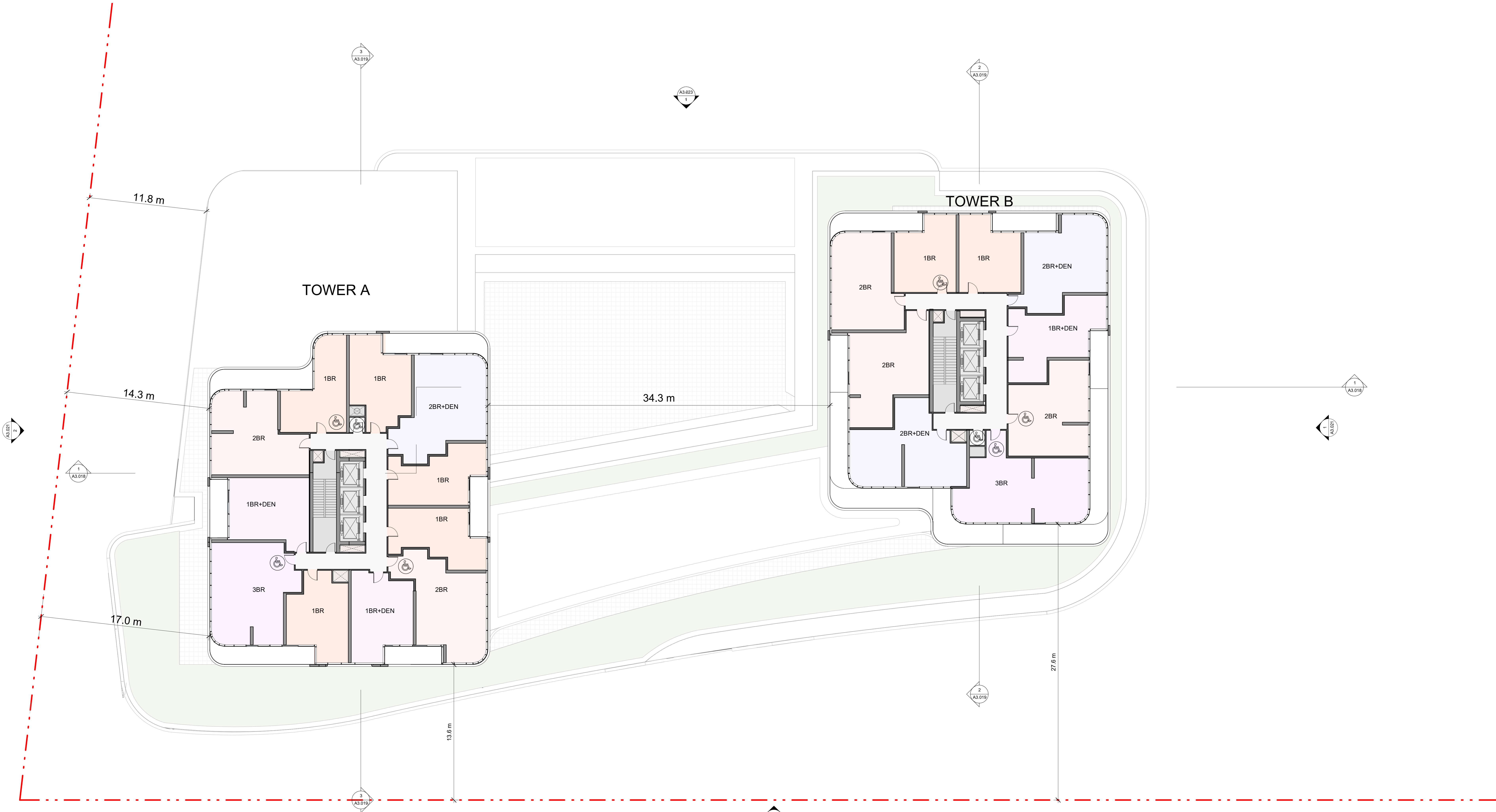
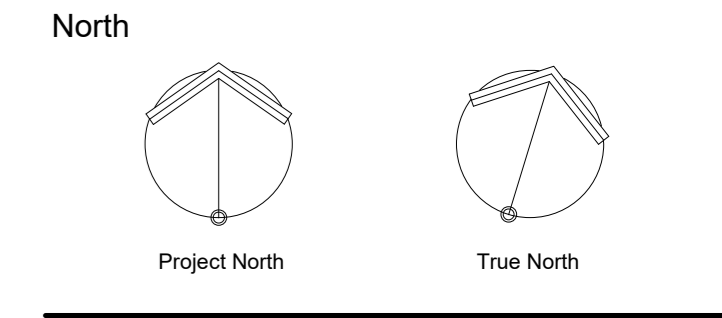

Rev.	Issue / Description	Date
4	SUBMISSION	Apr 22, 2020
3	SUBMISSION	Jan 22, 2020
2	REV. ISSUED FOR OPA/ZBA	Nov 14, 2018
1	ISSUED FOR OPA/ZBA	July 21, 2017



Architect of Record:  
**HARIRI PONTARINI ARCHITECTS**  
 235 Carlaw Avenue  
 Suite 301  
 Toronto, Canada M4M 2S1  
 TEL: 416 929 4901 FAX: 416 929 8924  
 info@hp-arch.com hariripontarini.com

Project Title:  
**BAYVIEW VILLAGE SOUTH-WEST DEVELOPMENT**  
 Address: TORONTO, ONTARIO

**TOWER B LEVEL 29**

Project number: 1432  
 Scale: 1/150  
 Date: 08/11/20  
 Drawn by: HPA

Drawing No.: Revision:

**A3.015b**

General Notes:

- These Contract Documents are the property of the Architect. The Architect bears no responsibility for the interpretations of these documents by the contractor. Upon written application the Architect will provide written clarification or supplementary information regarding the intent of the Contract Documents. The Architect will review Shop Drawings submitted by the Contractor for design conformance only. Drawings are not to be scaled for construction. Contractor to verify all existing conditions and dimensions required to perform the Work, and report any discrepancies with the Contract Documents to the Architect before commencing work.
- Positions of exposed or finished mechanical or electrical devices, fittings, and fixtures are indicated on the Architectural drawings. The locations shown on the Architectural Drawings govern over the Mechanical and Electrical drawings. Those items not clearly located will be located as directed by the Architect.

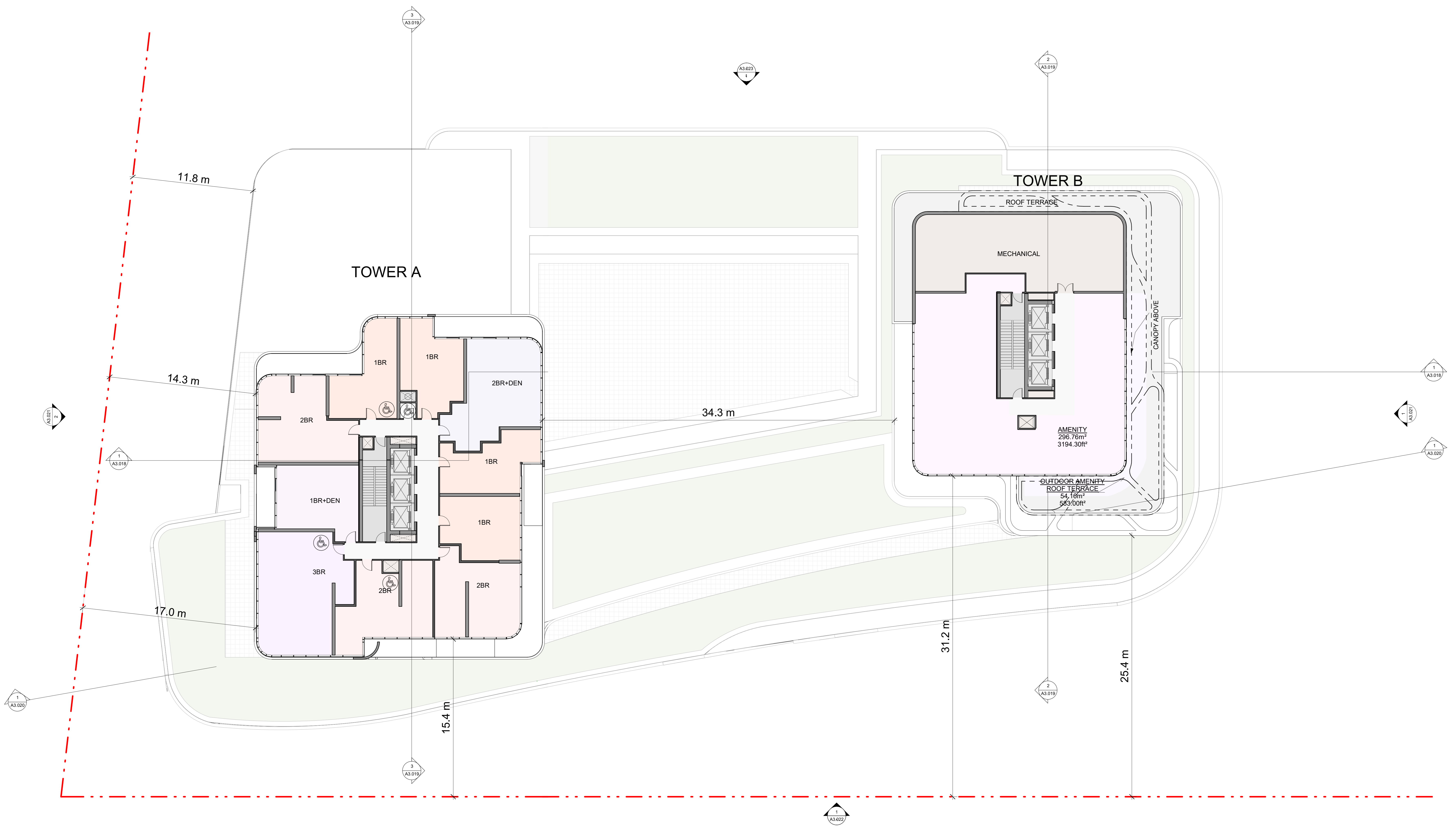
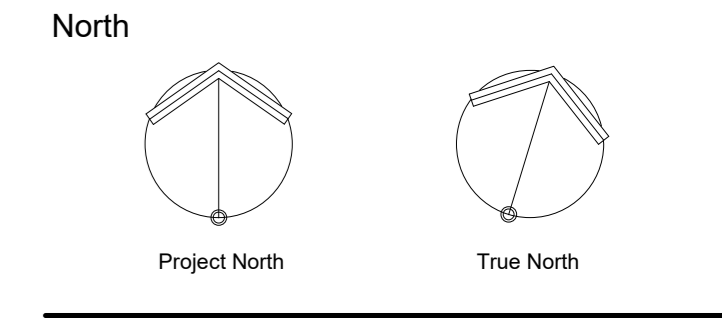

Rev.	Issue / Description	Date
4	SUBMISSION	Apr 22, 2020
3	SUBMISSION	Jan 22, 2020
2	REV. ISSUED FOR OPA/ZBA	Nov 14, 2018
1	ISSUED FOR OPA/ZBA	July 21, 2017



Architect of Record:  
**HARIRI PONTARINI ARCHITECTS**  
 235 Carlaw Avenue  
 Suite 301  
 Toronto, Canada M4M 2S1  
 TEL: 416 929 4901  
 FAX: 416 929 8924  
 info@hp-arch.com  
 hariripontarini.com

Project Title:  
**BAYVIEW VILLAGE SOUTH-WEST DEVELOPMENT**  
 Address: TORONTO, ONTARIO

**TOWER A LEVEL 30 & TOWER B MECH PH**

Project number: 1432  
 Scale: 1:150  
 Date: 08/11/20  
 Drawn by: HPA

Drawing No.: Revision:

A3.016a

4/21/2020 6:18:27 PM

General Notes:

- These Contract Documents are the property of the Architect. The Architect bears no responsibility for the interpretations of these documents by the contractor. Upon written application the Architect will provide written clarification or supplementary information regarding the intent of the Contract Documents. The Architect will review Shop Drawings submitted by the Contractor for design conformance only. Drawings are not to be scaled for construction. Contractor to verify all existing conditions and dimensions required to perform the Work, and report any discrepancies with the Contract Documents to the Architect before commencing work.
- Positions of exposed or finished mechanical or electrical devices, fittings, and fixtures are indicated on the Architectural drawings. The locations shown on the Architectural drawings govern over the Mechanical and Electrical drawings. These items not clearly located will be located as directed by the Architect.

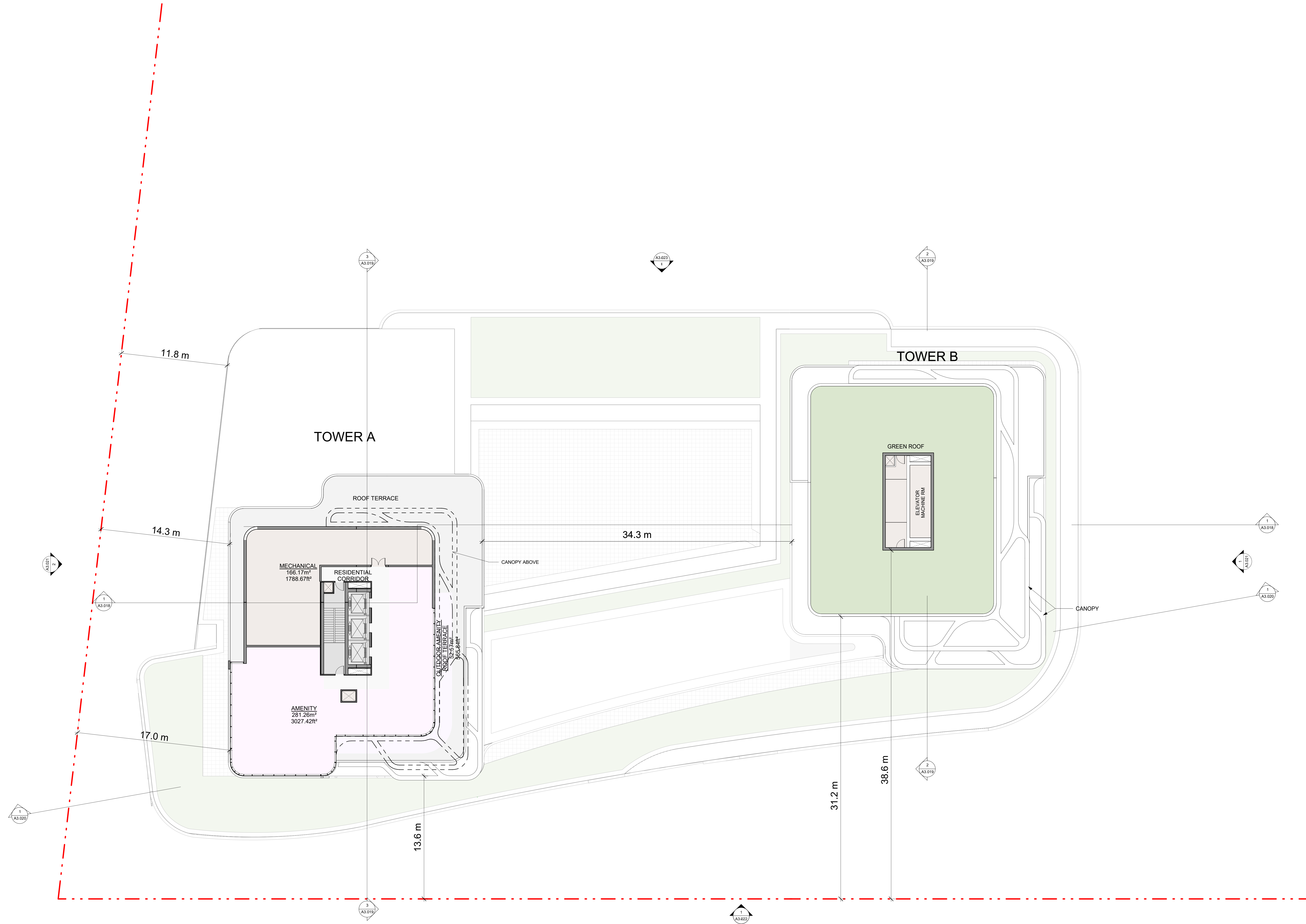
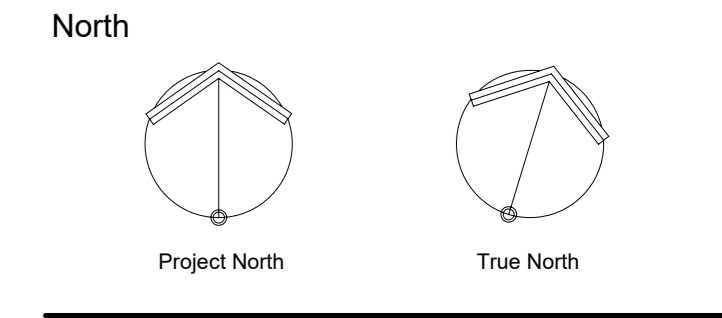

Rev.	Issue / Description	Date
4	SUBMISSION	Apr 22, 2020
3	SUBMISSION	Jan 22, 2020
2	REV. ISSUED FOR OPA/ZBA	Nov 14, 2018
1	ISSUED FOR OPA/ZBA	July 21, 2017



Architect of Record:  
**HARIRI PONTARINI ARCHITECTS**  
 235 Carlaw Avenue  
 Suite 301  
 Toronto, Canada M4M 2S1  
 TEL: 416 929 4901 FAX: 416 929 8924  
 info@hp-arch.com hariripontarini.com

Project Title:  
**BAYVIEW VILLAGE SOUTH-WEST DEVELOPMENT**  
 Address: TORONTO, ONTARIO

**TOWER A MECH PH**

Project number: 1432  
 Scale: 1/150  
 Date: 08/11/20  
 Drawn by: HPA

Drawing No.: Revision:

**A3.016b**