













This drawing is a technical drawing of a building and is provided under the copyright of Turner Fleischer Architects Inc. The user of this drawing is responsible for its use and for any errors or omissions. Turner Fleischer Architects Inc. is not responsible for any errors or omissions. This drawing is not to be used for any other purpose without the written consent of Turner Fleischer Architects Inc. The user of this drawing is responsible for its use and for any errors or omissions. This drawing is not to be used for any other purpose without the written consent of Turner Fleischer Architects Inc.

- ANGLAR PLANE BOUNDARY
- ZONING HEIGHT MAP BOUNDARY
- BUILDABLE AREA LIMIT

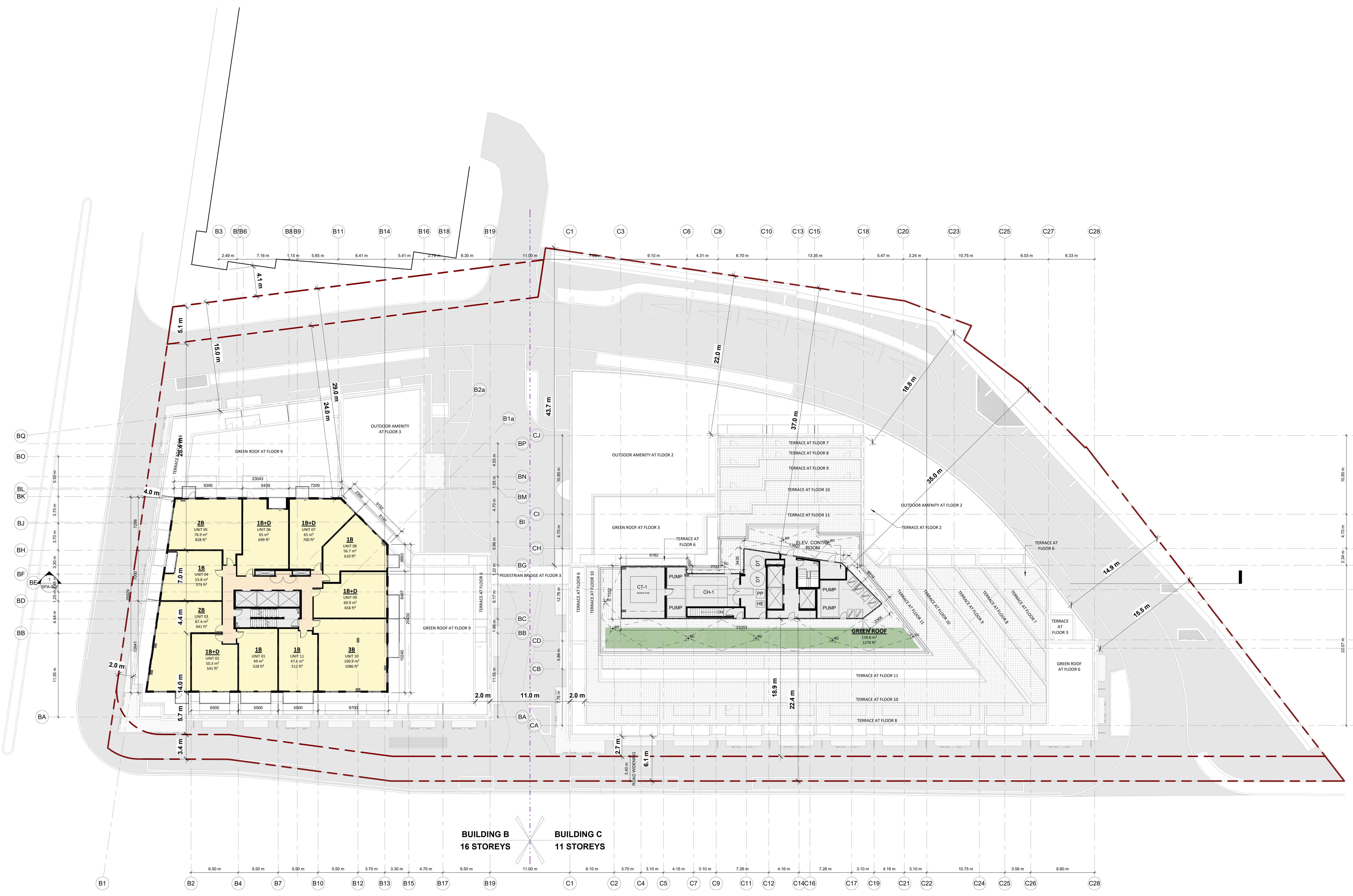

**WITHOUT  
PREJUDICE**

2020-02-20

10	NOV 05.20	RE-ISSUED FOR SPA	KLM
9	APR 16.20	ISSUED FOR SPA	KL
8	JULY 04.20	ISSUED FOR PRELIMINARY REVIEW	AY
7	APR 04.20	RE-ISSUED FOR REZONING	KL
6	JUN 17.19	ISSUED FOR REZONING	KL
No.	Date:	Issued/Revised:	By:

**TURNER FLEISCHER**  
TURNER FLEISCHER ARCHITECTS INC.  
67 Leavelle Road, Toronto, ON Canada M5S 1R8  
Telephone: (416) 467-1122 Fax: (416) 467-6777  
turnerfleischer.com

Project: **660 EGLINTON AVE E**  
660 EGLINTON AVENUE EAST,  
TORONTO, ON

Drawing Name: **FLOOR 12 & BLDG C MPH**

Proj no.: 17\_176C3 Date: May 2019  
Drawn by: AY Scale: 1:200  
Checked by: SF

Drawing No: **SPA-115**

**BUILDING B**  
16 STOREYS

**BUILDING C**  
11 STOREYS























