



NEXT PLACE

Exhibition Place Master Plan Strategy

Tenant Liaison Committee Meeting – January 20, 2020

Why A Master Plan? Why now?

- ✓ Long-term (20+ year) vision for the site – high-level physical planning framework
- ✓ Improve public spaces to support economic benefits and enhance visitor experience
- ✓ Rehabilitate heritage buildings and landscapes as part of the site's identity
- ✓ Leverage transit initiatives that improve accessibility and connectivity
- ✓ Position Exhibition Place relative to Ontario Place redevelopment

Master Plan Process – Potential Timeline

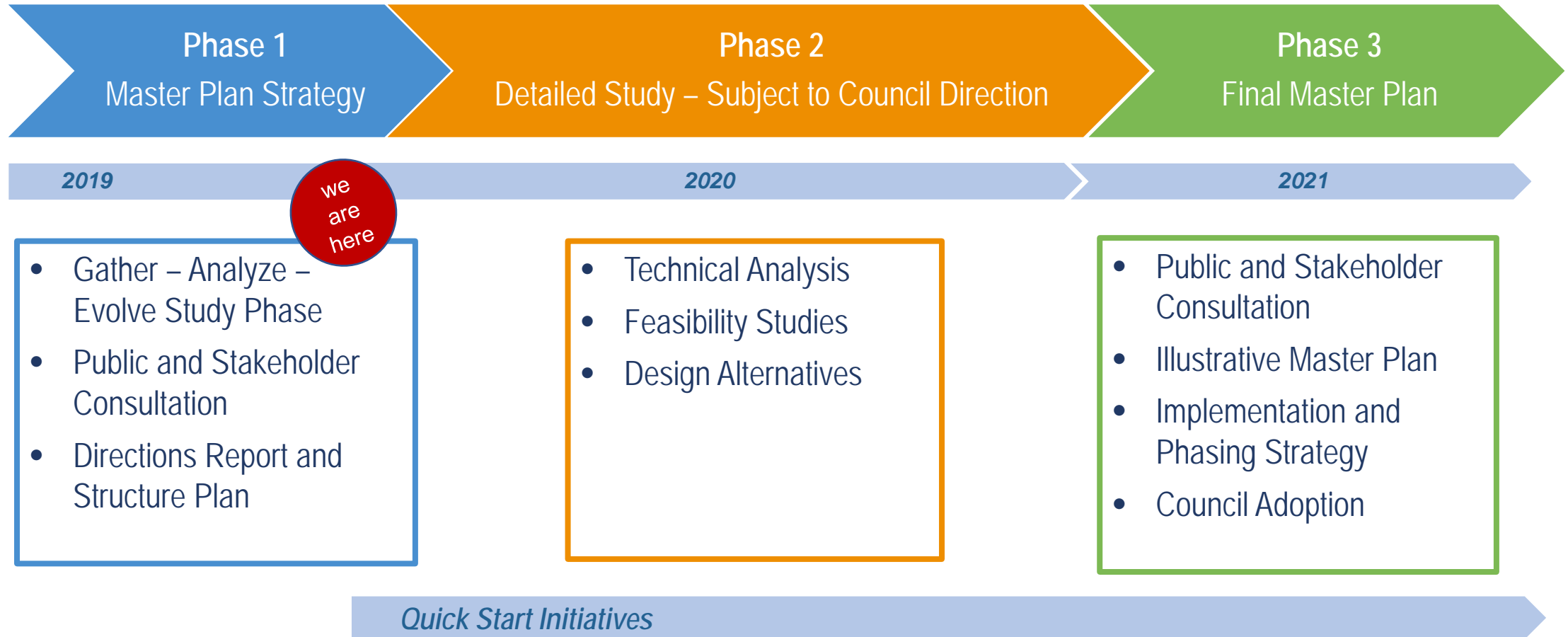

2010 Structure Plan

New Considerations since 2010:

- Cultural Heritage Landscape Assessment
- Transformation of adjacent Neighbourhoods & Bentway
- TOCore Parks and Public Realm Plan “Shoreline Stitch”
- Ontario Place Call for Development
- Transit Investment
- On-site Development

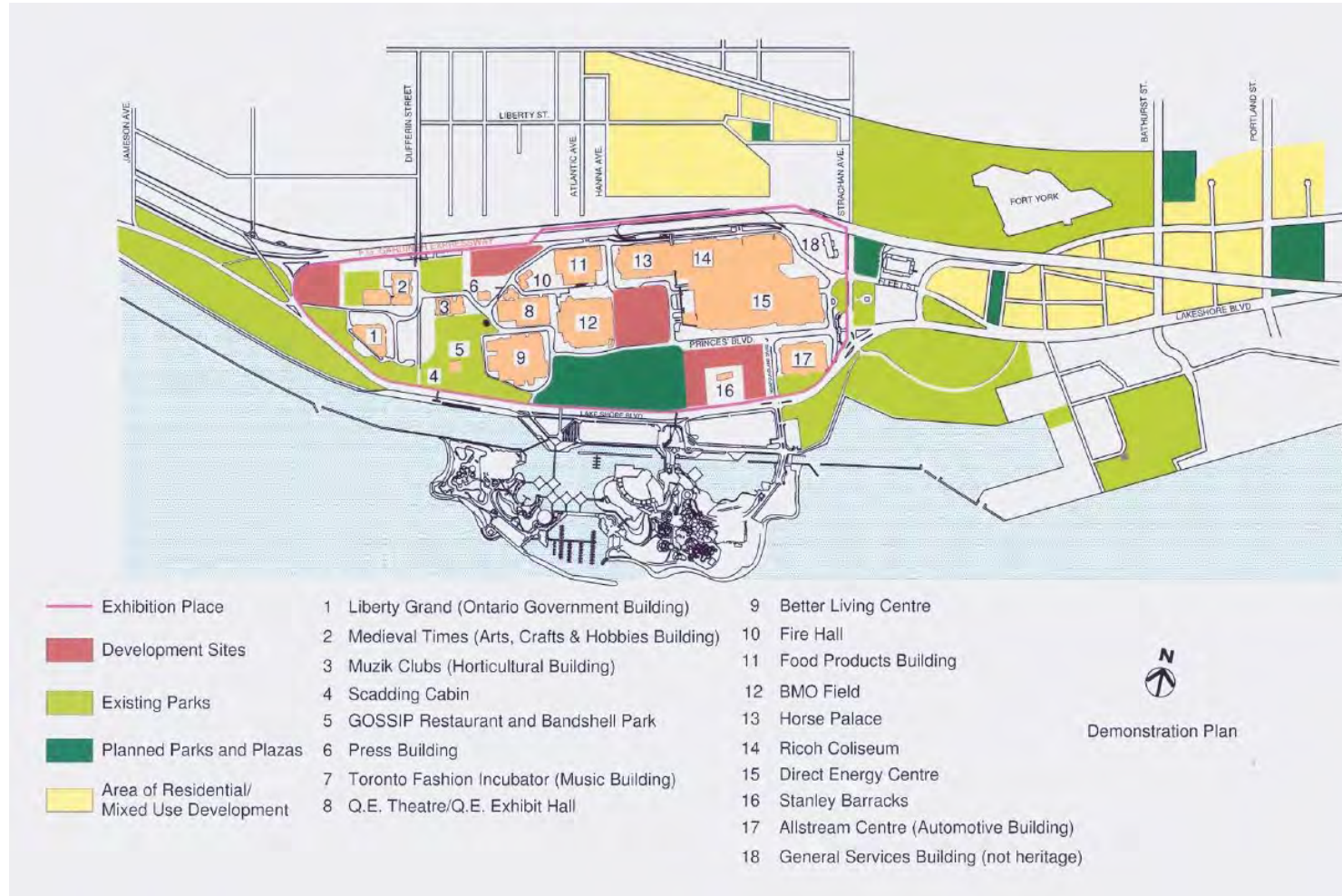

Cultural Heritage Landscape Assessment

- Exhibition Place is a **significant cultural heritage landscape** with a rich layering of designed and evolved landscape systems
- The primary conservation approach is **rehabilitation**
- **10 rehabilitation principles** for planning and interventions at Exhibition Place, including:
 - Conserve the **legacy of design excellence** at Exhibition Place by promoting high quality architectural and landscape interventions that are compatible with the monumental buildings and landscapes of the site.
 - Conserve and enhance designed landscape qualities and attributes through new development within and adjacent to Exhibition Place.



Princess Margaret Fountain, preceded by the Gooderham Fountain, is a historical meeting place (1929)

Vision Statement

Exhibition Place is Toronto's gathering place. Its historic and landmark buildings, landscapes and features provide the foundation for signature events, festivals and activities that bring people together and inspire us. The ongoing evolution of Exhibition Place will build upon this tradition by showcasing innovation and enhancing spaces for all visitors to Relax, Entertain and Exhibit.

Vision

A green destination

A unique place within the City that is easily accessible and provides public parkland and a green retreat, with connections to the waterfront open space network.

A historic place

A location of extensive cultural heritage resources, including landscapes, buildings and public art, which are conserved and enhanced to celebrate the City's cultural heritage and historic character.

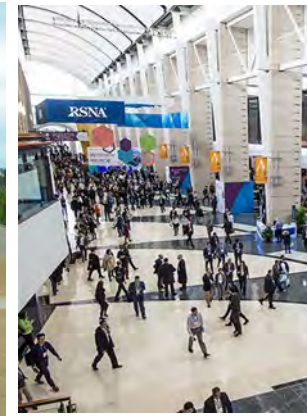

A place of innovation, inspiration and economic development

A centre for premier events, including sporting and cultural events, public celebrations, conferences, trade and consumer shows, and recurring festivals and exhibitions.

A place of entertainment

A year-round entertainment hub for Torontonians, tourists and event goers.

A place of recreation

A multi-seasonal destination offering active and passive recreation opportunities for local residents, visitors and surrounding communities.

Enhancing its role as a place of innovation, inspiration and economic development

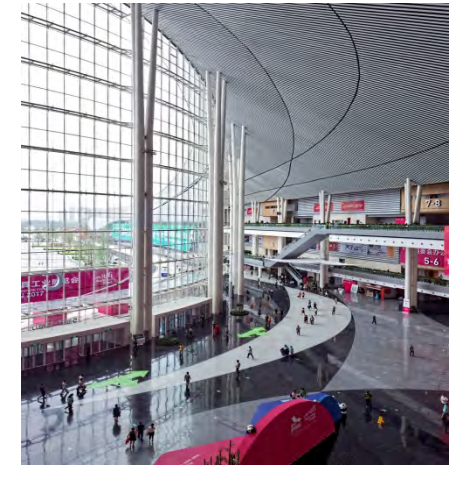
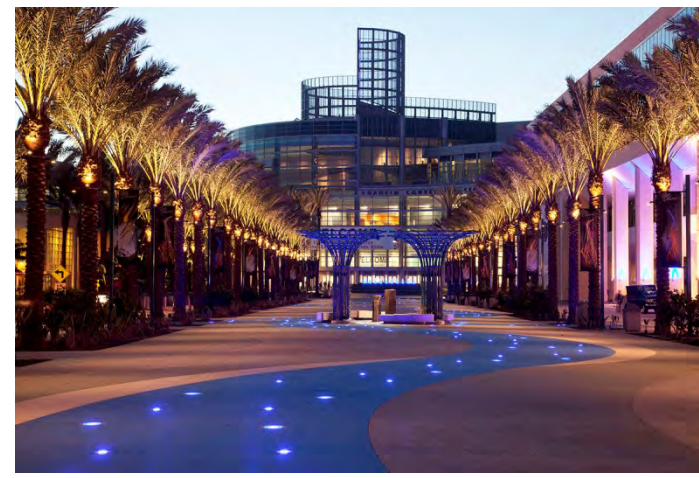
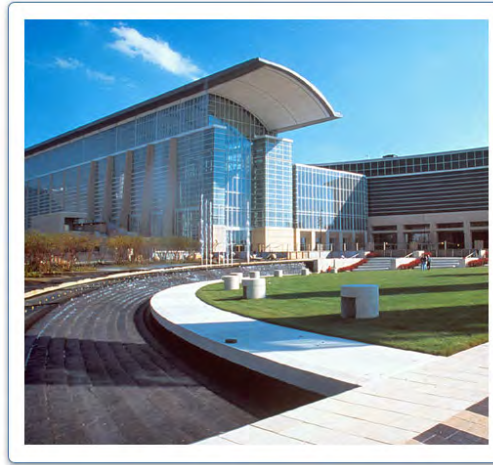

Expand, renovate and modernize trade and exhibition space to compete globally

How to Realize the Vision?

Heritage &
Archaeology

Implement **CHLA** recommendations for heritage conservation and rehabilitation

Public
Realm
Open Space

Improve the **Public Realm** to benefit visitors and strengthen the site's identity as a gathering place

Mobility

Prioritize **Transit** and **Multi-Modal Mobility** to and through the site

Connectivity
& Linkages

Enhance and create new **Gateways** linking the grounds to neighbourhoods, waterfront, Ontario Place, and the rest of the city

How to Realize the Vision?

Built Form

Identify appropriate sites for potential future **Development**

Operations

Accommodate event **Operations** and optimize **Parking** to support the success and growth of attractions, balanced with public realm objectives

Resilience

Build upon leadership and innovation in **Sustainability** and Resilience

Stakeholder
Engagement

Continue robust stakeholder **Engagement** in decision-making

Gateways



North Gateway_Transit Hub



South Gateway_Ontario Place Connection



Expansion of Enercare Centre

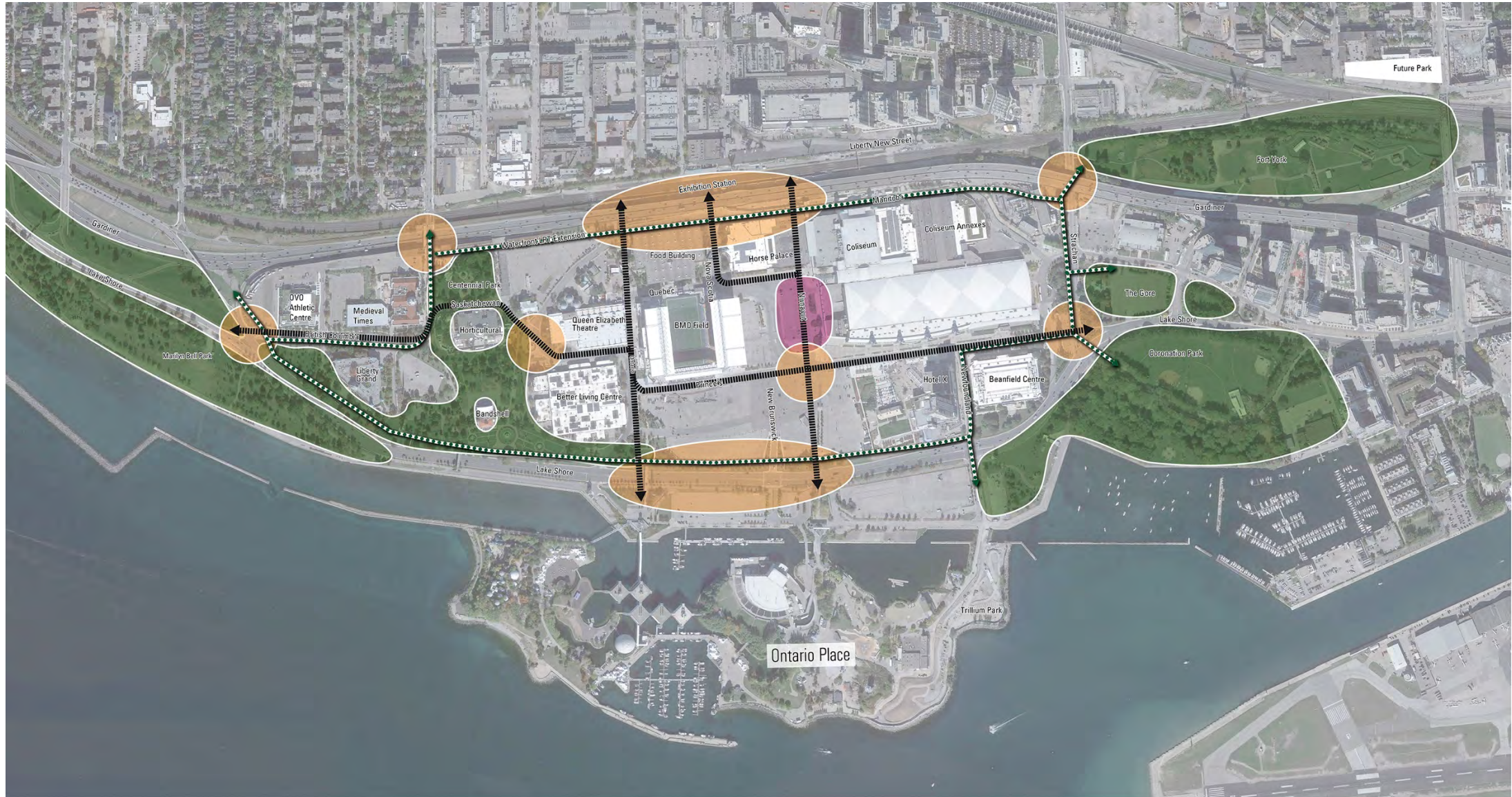

Expansion of Hotel X

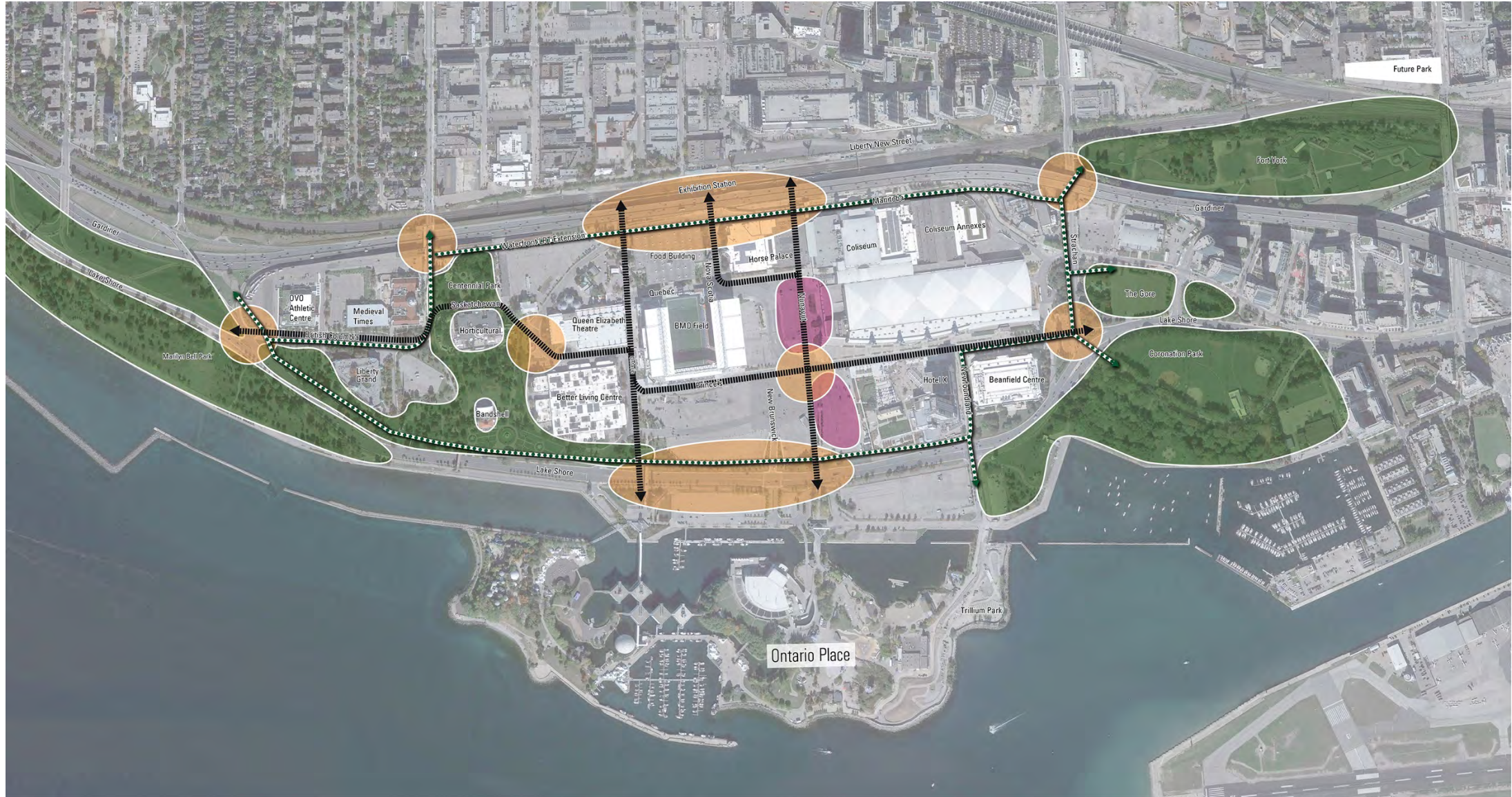

Opportunities



Key Transportation Directions

Improve integration and connectivity with adjacent neighbourhoods and Ontario Place.



Enhanced and expanded local and regional transit will provide opportunities to optimize parking above & below grade.

Supplement first and last-mile transportation needs with on-site shuttles, enhancing “door-to-door” accessibility and connectivity for site patrons.



Preserve adequate durable/hardscaped open space to accommodate event operating and parking needs.

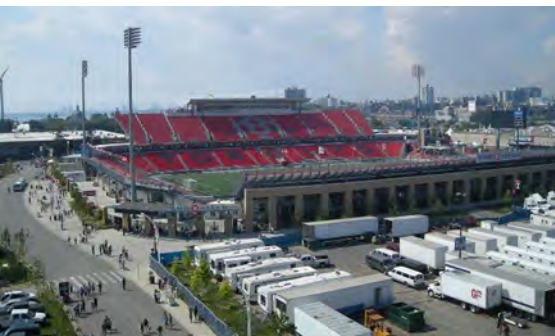

Previous Draft Plan (Nov 2019)



Emerging Structure Plan (Dec 2019)

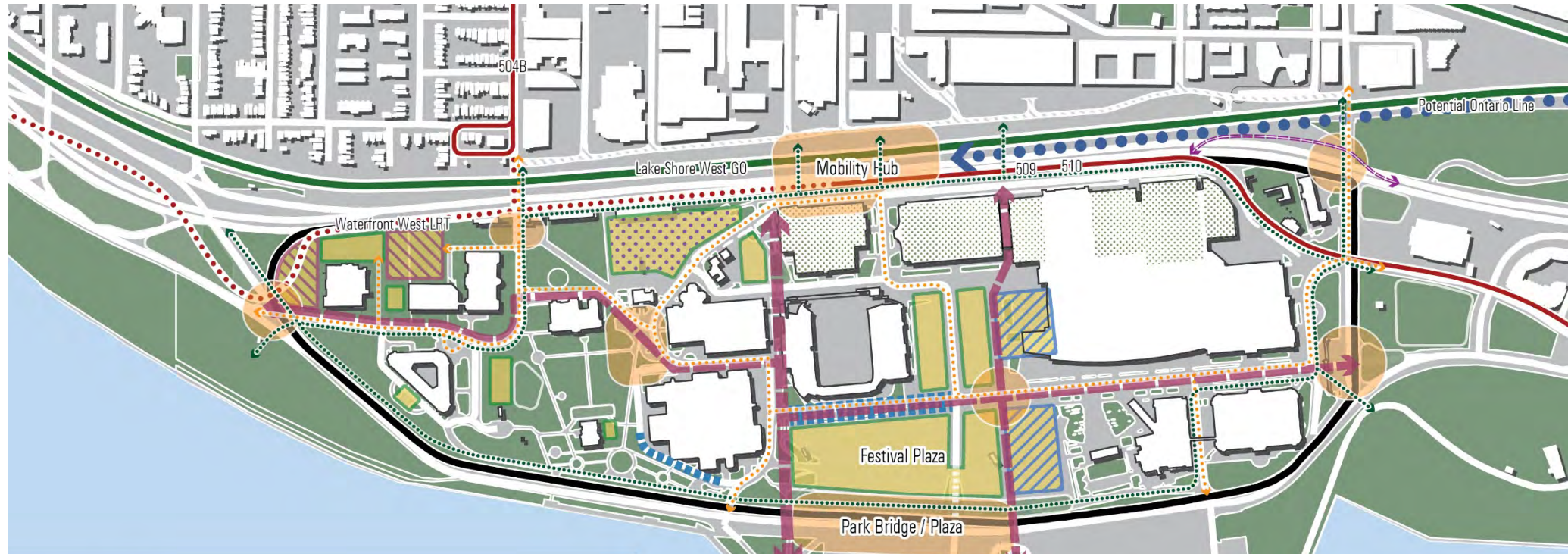

structure plan

flexible hardscaped open space
programming, parking, operations, etc.



potential pedestrianization



potential development
& below-grade parking



potential shuttle routes



potential development
& above-grade parking



perimeter promenade



cultural zone & flexible
hardscaped open space



under Gardiner improvements



gateways / meeting places



primary axis



green roof



study area



Multi-Use Plaza – Lansdowne Park, Ottawa



Multi-Use Plaza – Lansdowne Park, Ottawa



Multi-Use Plaza – Lansdowne Park, Ottawa



Discussion Questions

- **How does your operation use space at Exhibition Place?**
- **Tell us about your parking needs and challenges.**
- **The Master Plan is intended to articulate a long-term vision. What should we be taking into account with respect to phasing?**
- **Do you have concerns with any of the other proposed plan elements or guiding principles (not related to parking/staging)?**
- **What do you think should be the priorities for the physical development or improvement of Exhibition Place?**

NEXT Steps

