

Assumption of Services, Registered Plan 66M-2528, 4750 Eglinton Ave. W. - National Homes (Eglinton) Inc.

Date: February 6, 2020
To: Etobicoke and York Community Council
From: Director, Engineering Review, Engineering and Construction Services
Wards: Ward 2 - Etobicoke Centre

SUMMARY

This report recommends that the municipal services installed under the terms of the Subdivision Agreement between National Homes (Eglinton) Inc. and the City of Toronto for Plan 66M-2528, dated April 10, 2015, be assumed by the City.

RECOMMENDATIONS

The Director, Engineering Review recommends that City Council:

1. assume the services installed at Dryden Way and that the City formally assume the road within the Plan of Subdivision.
2. authorize the Director, Engineering Review to release the portion of the performance guarantee held with respect to this Plan of Subdivision.
3. direct that an assumption By-law be prepared to assume the public highway and municipal services within the Subdivision at Dryden Way.
4. authorize and direct the City Solicitor to register the assumption By-law in the Land Registry Office at the expense of the Owner.
5. authorize the City Clerk and Treasurer to sign any release or other documentation necessary to give effect thereto.
6. authorize the appropriate City officials to transfer ownership of the street lighting system constructed within the Plan of Subdivision at Dryden Way to Toronto Hydro.

FINANCIAL IMPACT

There are no financial implications resulting from adoption of this report.

DECISION HISTORY

The subject subdivision as shown on the attached map, Attachment #1 - 66M-2528 Assumption of Services Site Map, is approximately 1.37 ha in area and is located on the northeast corner of Kipling Avenue and Eglinton Avenue West.

The municipal services required under the terms of the Subdivision Agreement are in an acceptable condition to be assumed by the City for the Plan 66M-2528 dated April 10, 2015, between National Homes (Eglinton) Inc. and the City of Toronto. This includes the new road Dryden Way. Toronto Hydro has also provided sign-off.

COMMENTS

Obligations respecting the roads and municipal services contained in the Subdivision Agreement have been satisfied. Council can now pass an assumption By-law to assume the municipal services and road works in subdivision Plan 66M-2528.

CONTACT

Grace Tesa, P.Eng., Manager, (Acting) Development Engineering, Etobicoke York District Telephone: 416-394-8383, email: Grace.Tesa@toronto.ca

SIGNATURE

John P. Kelly, P.Eng
Director, Engineering Review
Engineering & Construction Services

ATTACHMENTS

Attachment No. 1: 66M-2528 Assumption of Services Site Map

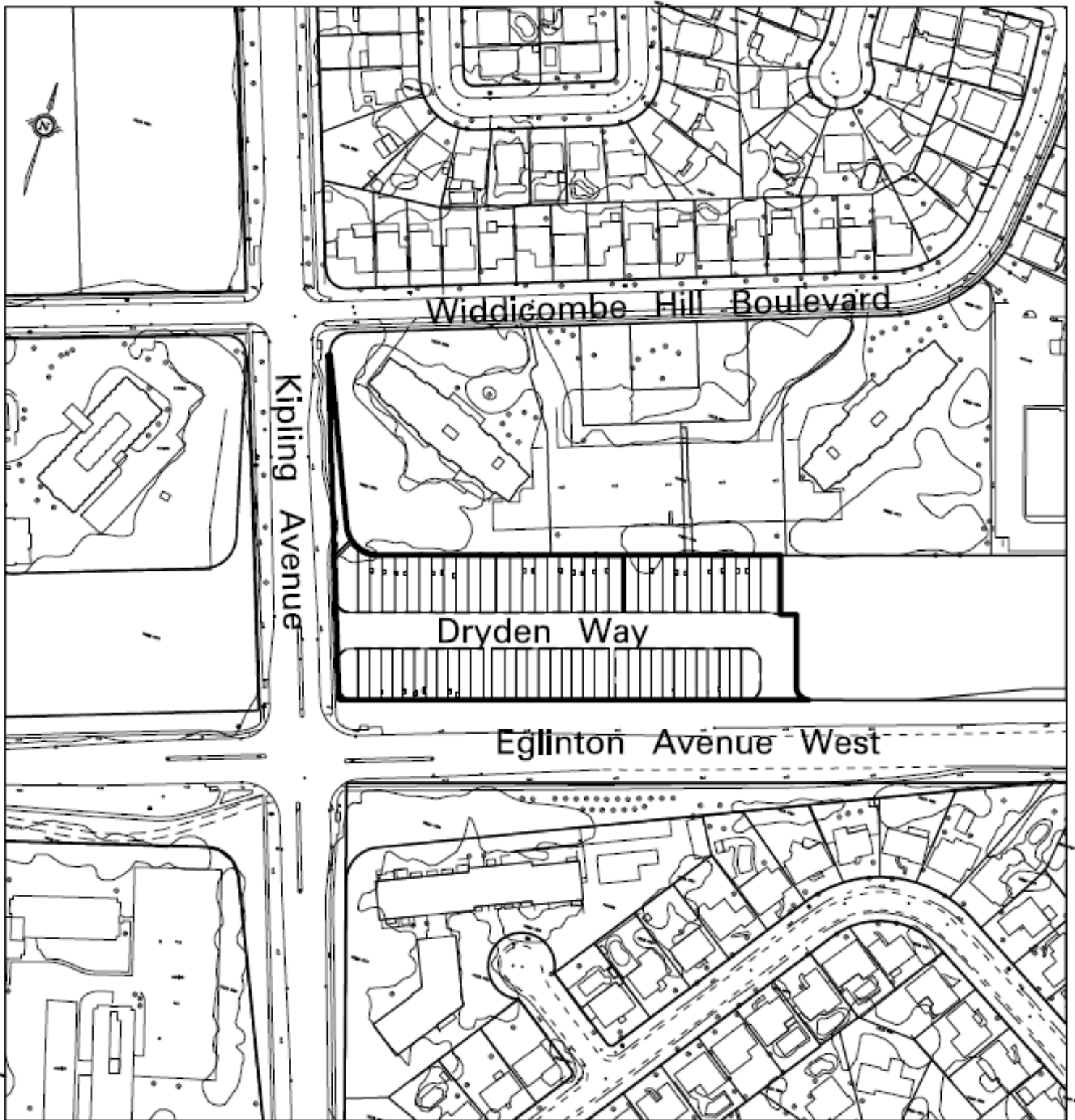

Toronto

ENGINEERING & CONSTRUCTION SERVICES
ENGINEERING SUPPORT SERVICES
LAND & PROPERTY SURVEYS

NOTE:

THIS SKETCH HAS BEEN
COMPILED FROM OFFICE
RECORDS, MEASUREMENTS
ARE APPROXIMATE

CHECK BY JOHN HOUSE

PREPARED BY: DWAYNE PITT

WARD 2 - ETOBICOKE CENTRE
DATE: JANUARY 20, 2020

PROPERTY INFORMATION SHEET
ATTACHMENT #1 - 66M-2528
ASSUMPTION OF SERVICES SITE MAP

SKETCH No. PS-2020-010