



# **PB17.4**

**Intention to Designate under Part IV,  
Section 29 of the Ontario Heritage Act,  
Alterations to Designated Heritage  
Properties, and Authority to Enter into  
a Heritage Easement Agreement - 80  
and 84 Queen's Park (Ward 11)**

# PB17.4 80-84 Queen's Park

Location Map

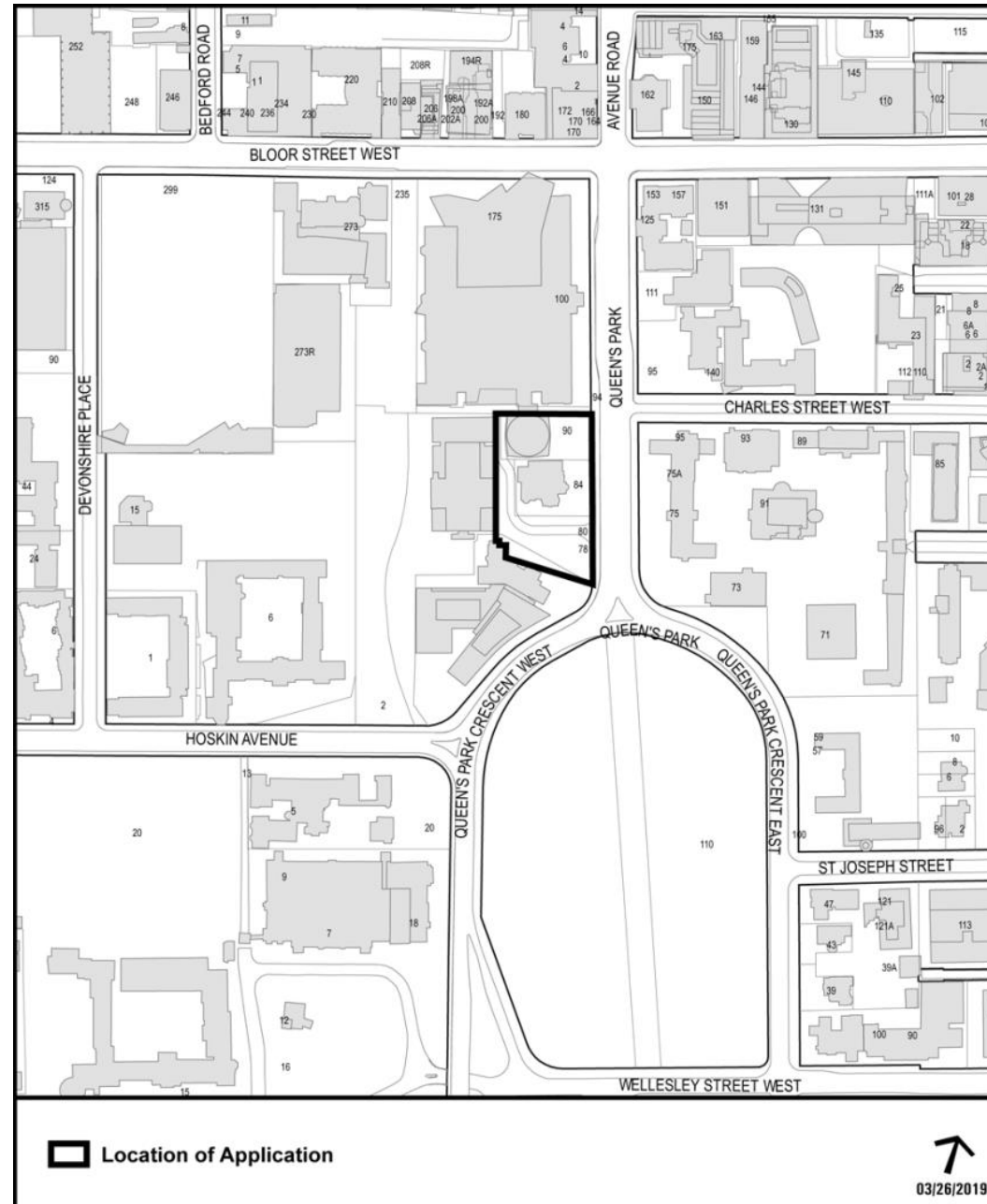

---

**PB17.4**  
**80-84 Queen's Park**



Wymilwood, now known as Falconer Hall, 1902, principal, east elevation (above), entry (top left), chimney (top right) and rear, west elevation (right) (Heritage Planning, 2020)

## PB17.4 80-84 Queen's Park

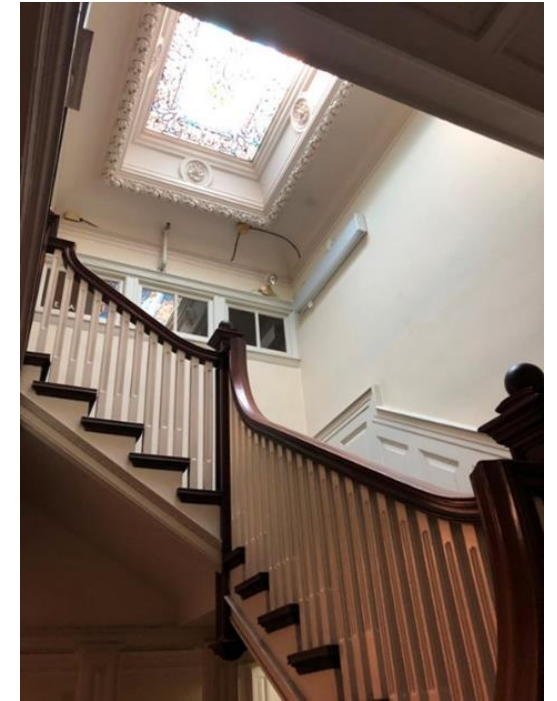

Wymilwood/Falconer Hall interiors: Billiard Room with Circassian walnut panelling (above), Library with murals and carved plaster work attributed to Gustav Hahn (centre), Principle Staircase balustrade and stained glass skylight (top) and Living Room with panelling and inglenook with Elizabethan strapwork carving (Heritage Planning, 2020)

## PB17.4 80-84 Queen's Park



Edward Johnson Building, 1960-61, principal, east elevation (above)  
West elevation facing Philosopher's Walk (top right), the view past  
Falconer Hall to the Edward Johnson Building from Queen's Park  
(right) (Heritage Planning, 2020)



---

**PB17.4**  
**80-84 Queen's Park**

Edward Johnson Building Interiors:  
Main Foyer with skylights  
(Heritage Planning)

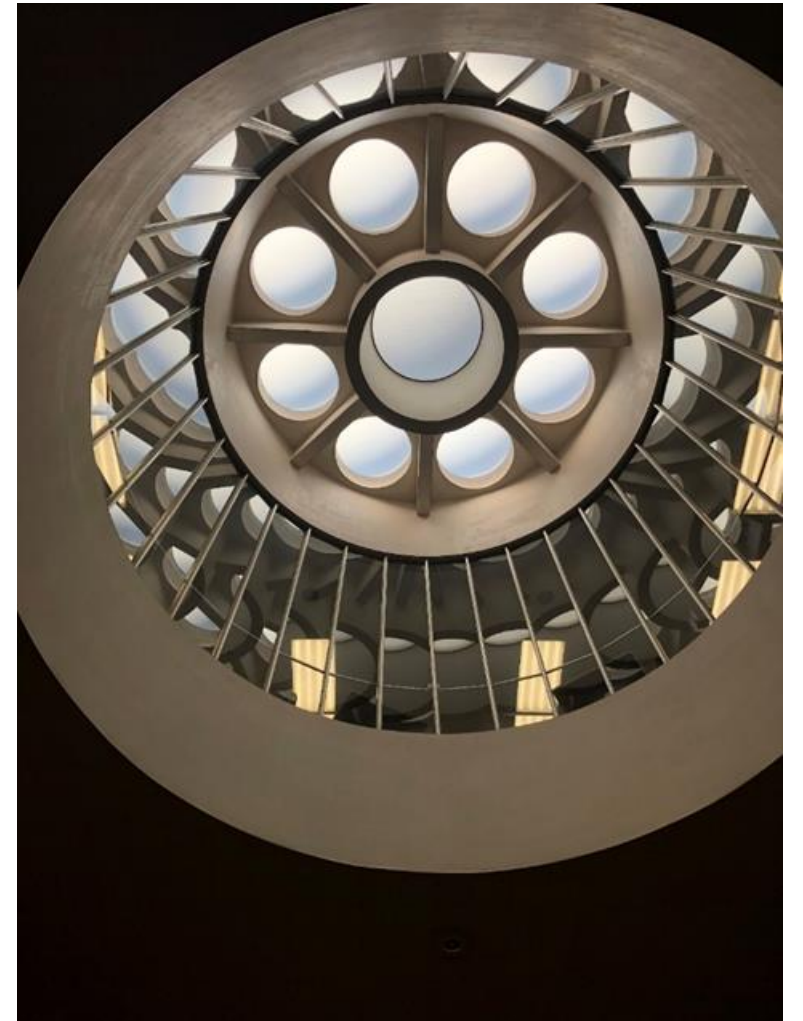

## PB17.4 80-84 Queen's Park

Ground Level Plan shows new project footprint at rear of Falconer Hall, setback considerably from Queen's Park frontage with generous landscaping proposed at public realm spaces

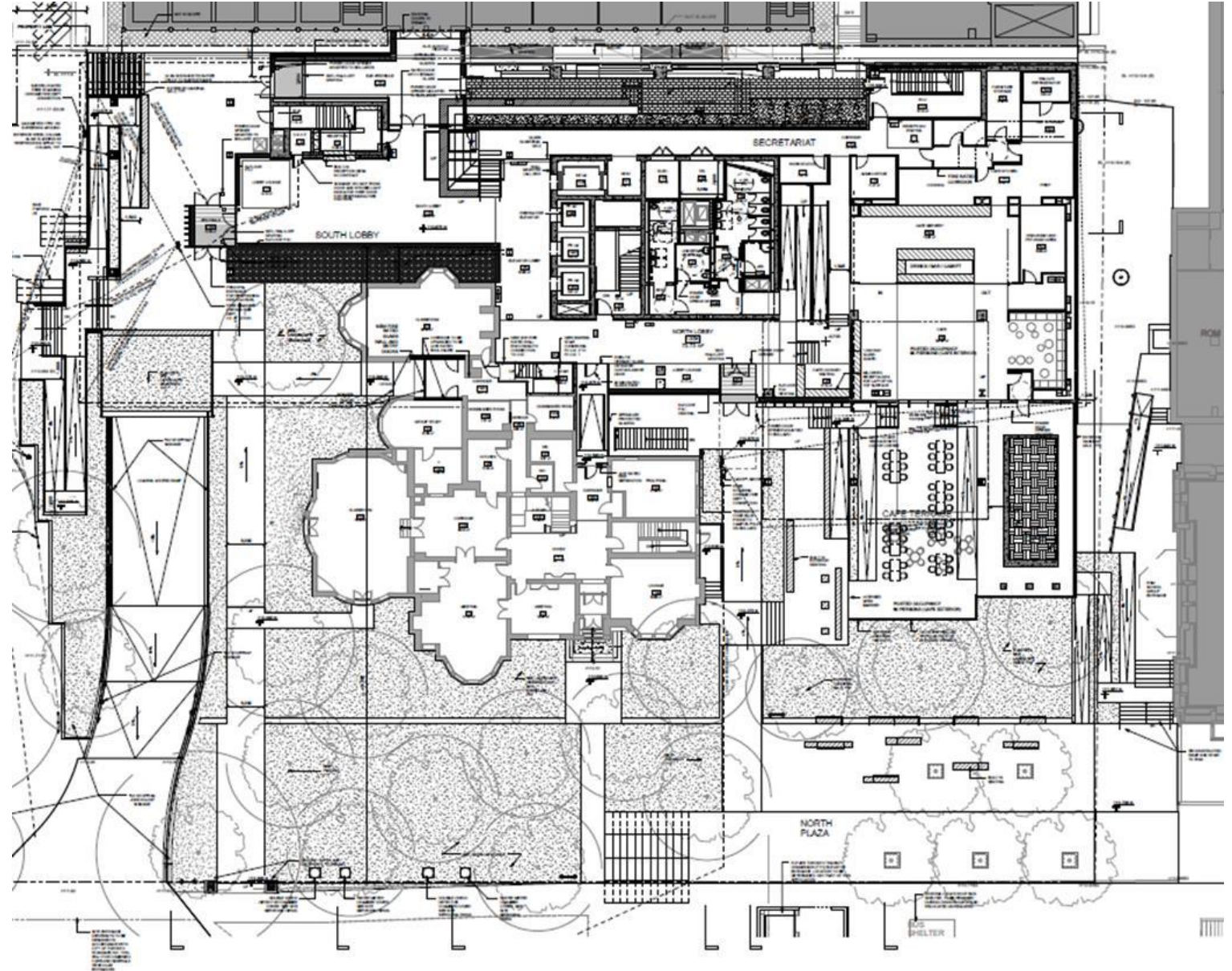

---

## PB17.4 80-84 Queen's Park

Render of new project located  
behind Falconer Hall and east of  
Edward Johnson Building

