

Parking Amendments - Edmund Avenue

Date: February 24, 2020
To: Toronto and East York Community Council
From: Acting Director, Traffic Management, Transportation Services
Wards: Ward 12, Toronto - St. Paul's

SUMMARY

This staff report is about a matter that Community Council has delegated authority to make a final decision, provided that it is not amended so that it varies with City Policy or by-laws.

Transportation Services is recommending maximum one-hour parking from 10:00 a.m. to 6:00 p.m., Monday to Saturday, on the north side of Edmund Avenue, between a point 30.5 metres west of Avenue Road and Poplar Plains Road, in place of the existing statutory unsigned maximum three-hour parking limit. This is in response to a petition received from the residents of Edmund Avenue requesting that the time limit for on-street parking be reduced to prevent long-term parking. This proposal will not result in the loss of any parking spaces on Edmund Avenue.

RECOMMENDATION

The Acting Director, Traffic Management, Transportation Services, recommends that:

1. Toronto and East York Community Council authorize parking for a maximum period of one-hour from 10:00 a.m. to 6:00 p.m., Monday to Saturday, on the north side of Edmund Avenue, between a point 30.5 metres west of Avenue Road and Poplar Plains Road.

FINANCIAL IMPACT

All costs associated with the necessary signage installation are included within the Transportation Services 2020 Interim Operating Budget estimates.

DECISION HISTORY

This report addresses a new initiative.

COMMENTS

Councillor Josh Matlow, on receipt of a petition from area residents, requested that parking be limited to a maximum period of one hour, Monday to Saturday on Edmund Avenue.

Edmund Avenue is classified as a local roadway and operates two-way, east-west traffic on a pavement width of about 8.5 metres. The regulation speed limit is 30 km/h. Heavy trucks are prohibited at all times. There is no TTC service provided on Edmund Avenue. Currently, the following regulations are in place on Edmund Avenue:

North Side

- No parking anytime between Avenue Road and a point 30.5 metres west,
- Permit parking from 2:01 a.m. to 10:00 a.m., between a point 30.5 metres west of Avenue Road and Poplar Plains Road, and
- Maximum three-hour parking outside of permit parking hours.

South Side

- No parking anytime between Avenue Road and Poplar Plains Road.

In the petition, residents expressed concern regarding non-residents parking on-street for extended periods of time. In order to deter such activity and to continue to maintain on-street parking, residents of Edmund Avenue requested that parking be limited to a maximum period of one-hour from 10:00 a.m. to 6:00 p.m., Monday to Saturday. This proposal will not result in the loss of any parking spaces on Edmund Avenue.

Councillor Josh Matlow has been advised of the recommendation of this staff report.

CONTACT

Shawn Dillon
Manager, Traffic Operations (Area 1)
Traffic Management
Transportation Services
Telephone: (416) 397-5021
Fax: (416) 392-1920
E-mail: Shawn.Dillon@toronto.ca

SIGNATURE

Roger Browne, M.A.Sc., P.Eng.,
Acting Director,
Traffic Management
Transportation Services

ATTACHMENTS

1. Drawing No. 421G-3690, dated February 2020

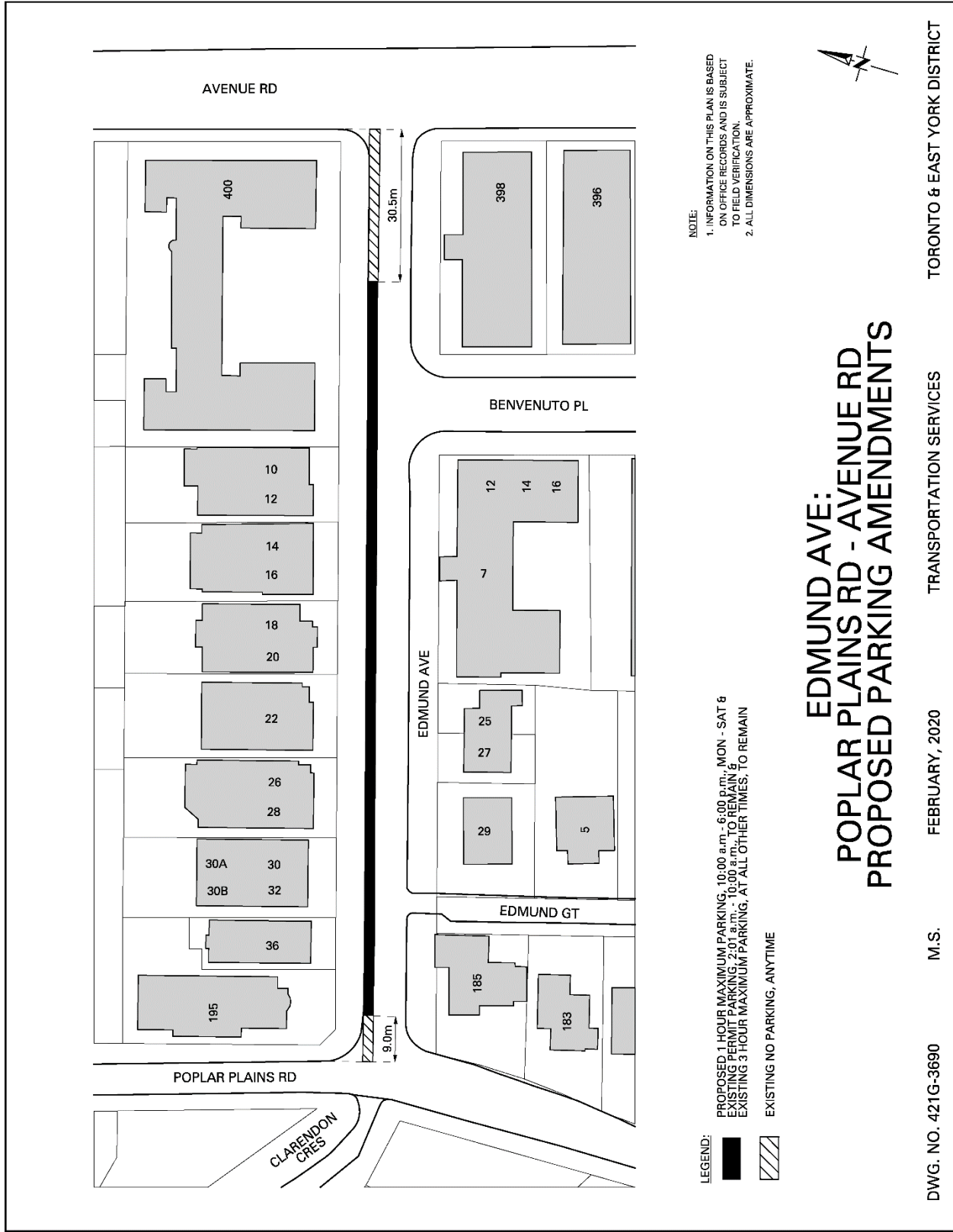

NOTE:
 1. INFORMATION ON THIS PLAN IS BASED ON OFFICE RECORDS AND IS SUBJECT TO FIELD VERIFICATION.
 2. ALL DIMENSIONS ARE APPROXIMATE.

LEGEND:
 PROPOSED 1 HOUR MAXIMUM PARKING, 10:00 a.m. - 6:00 p.m., MON - SAT &
 EXISTING PERMIT PARKING, 2:01 a.m. - 10:00 a.m., TO REMAIN &
 EXISTING 3 HOUR MAXIMUM PARKING, AT ALL OTHER TIMES, TO REMAIN
 EXISTING NO PARKING, ANYTIME

EDMUND AVE: POPLAR PLAINS RD - AVENUE RD PROPOSED PARKING AMENDMENTS



DWG. NO. 421G-3690 M.S. FEBRUARY, 2020 TRANSPORTATION SERVICES TORONTO & EAST YORK DISTRICT