

ALL TREE PLANTING AND SOIL VOLUME LOCATIONS SHOWN ON THE PLAN ARE PRELIMINARY AND WILL BE SUBJECT TO THE DETAILED DESIGN PROCESS. TREE LOCATIONS THAT HAVE A HIGH DEGREE OF UNCERTAINTY WITH RESPECT TO FEASIBILITY HAVE BEEN NOTED SEPARATELY AND WILL BE RE-EVALUATED AT THE APPROPRIATE TIMES.

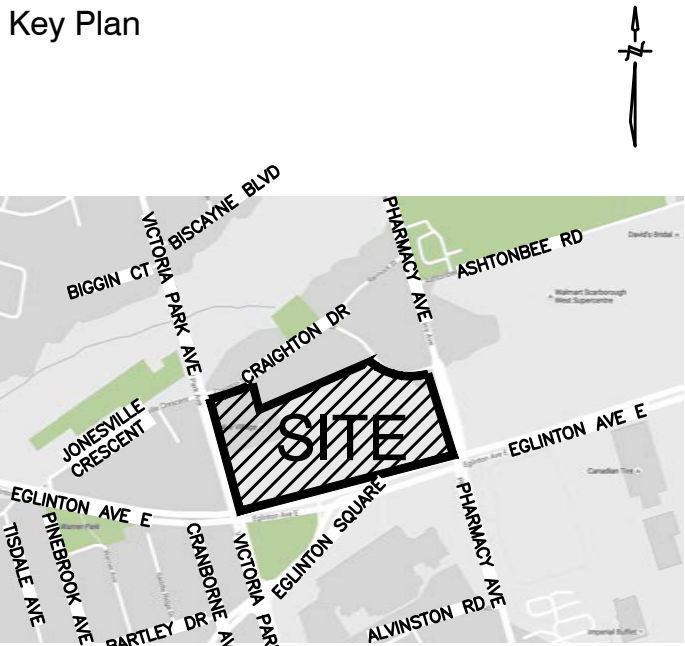
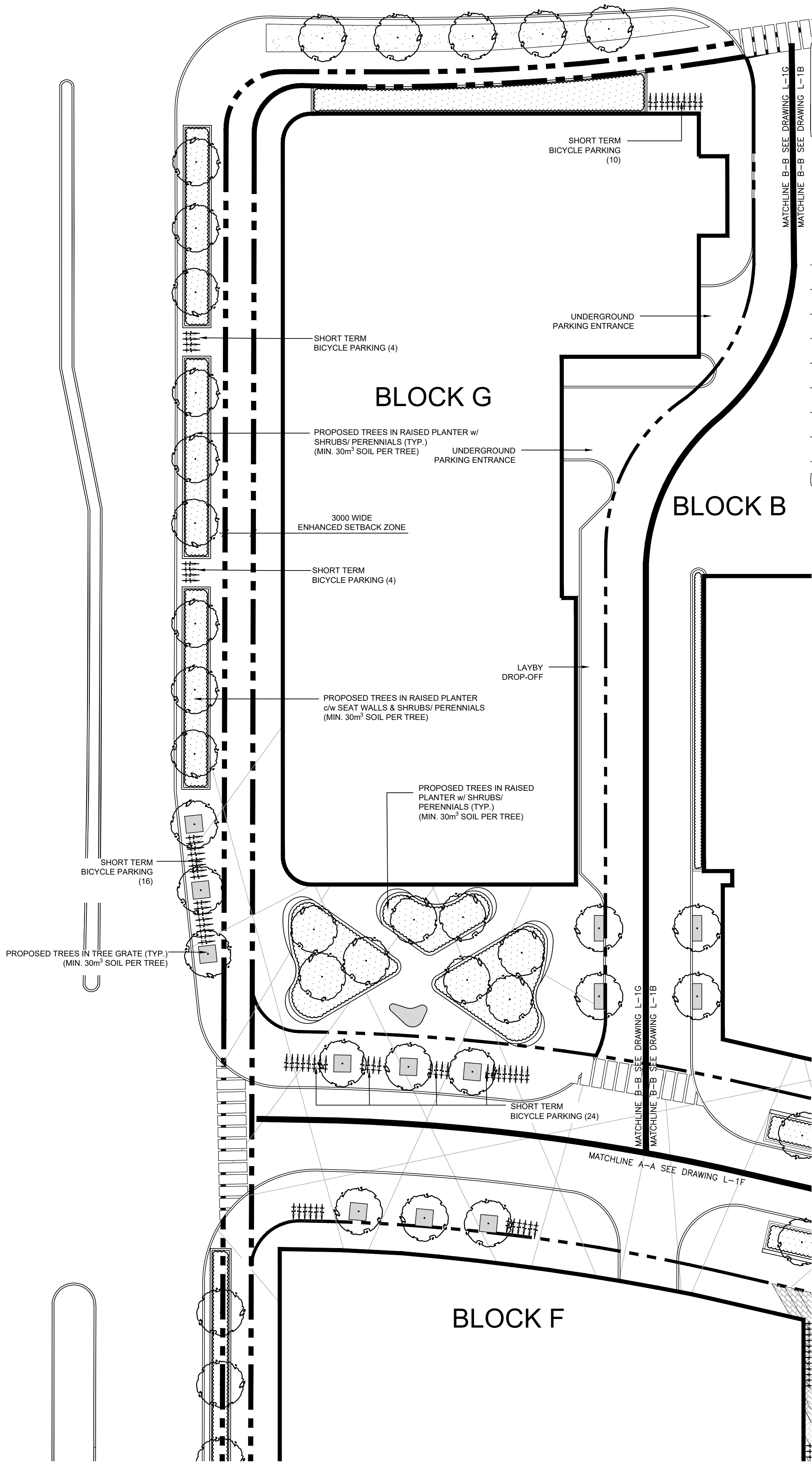

- Legend
- LIMIT OF DEVELOPMENT
  - - - LIMIT OF BLOCK
  - PROPOSED BUILDING FOOTPRINT (FOR ARCHITECTURAL INFORMATION REFER TO DWGS PREPARED BY GIANNONE PETRICONE ASSOCIATES)
  - PROPOSED PLAZA PAVING
  - PROPOSED POPS PAVING
  - PROPOSED ENHANCED VEHICULAR PAVING
  - PROPOSED ENHANCED VEHICULAR LAYBY PAVING
  - PROPOSED PLAY SURFACING
  - PROPOSED PEDESTRIAN CROSSWALK
  - PROPOSED STREET TREE PLANTING - TREE GRATE (MIN. 30m<sup>3</sup> SOIL/ TREE)
  - PROPOSED STREET TREE PLANTING - FLUSH CURBS w/ BUILT-IN SEATING (MIN. 30m<sup>3</sup> SOIL/ TREE)
  - PROPOSED STREET TREE PLANTING - RAISED PLANTER (MIN. 30m<sup>3</sup> SOIL/ TREE)
  - POTENTIAL LANDSCAPE SEATING
  - POTENTIAL OUTDOOR MOVEABLE SEATING
  - PROPOSED BIKE RACKS
  - PROPOSED BOLLARDS

3.0	June 16, 2021	Confidential and Without Prejudice Submission #3 - For 3.95 Settlement	JSJ
2.0	Apr 28, 2021	Confidential and Without Prejudice Submission #2 - For 3.95 Settlement	JSJ
1.0	Nov 03, 2020	Confidential and Without Prejudice Submission #1	JSJ
No	Date	Revisions	By

This drawing, as an instrument of service, is provided by, and is the property of The MBTW Group. The contractor shall check and verify all dimensions and report all errors and omissions to the Landscape Architect whose seal is affixed to this drawing before proceeding with the work. This drawing is not to be scaled.

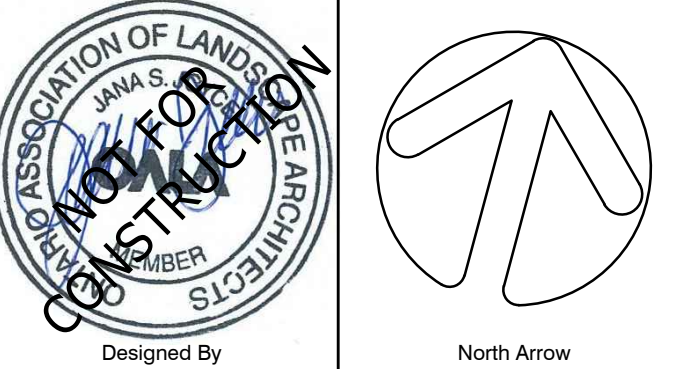

the mbtw group  
landscape architecture | urban design | design solutions | construction | post design | interior design  
285 Warden Ave., Unit 14 | Toronto, Ontario, Canada M6H 1B8  
T: (416) 448-7767 | F: (416) 448-1801 | www.mbtw-od.com

Project Name: 1880 Eglinton Avenue / Golden Mile

Municipality: Scarborough, ON

Sheet Title: Landscape Layout Plan BLOCK G

Designed: JJ	Drawn: MC	Scale: 1:300	Drawing No.: L-1F
Date of Drawing: July 2020	Job No.: CPR004		





Key Plan



Legend

3.0	June 16, 2021	Confidential and Without Prejudice Submission #3 - For 3.95 Settlement	JSJ
2.0	Apr 28, 2021	Confidential and Without Prejudice Submission #2 - For 3.95 Settlement	JSJ
1.0	Nov 03, 2020	Confidential and Without Prejudice Submission #1	JSJ
No	Date	Revisions	By

This drawing, as an instrument of service, is provided by, and is the property of, The MBTW Group. The contractor shall check and verify all dimensions and report all errors and omissions to the Landscape Architect whose seal is affixed to this drawing before proceeding with the work. This drawing is not to be scaled.

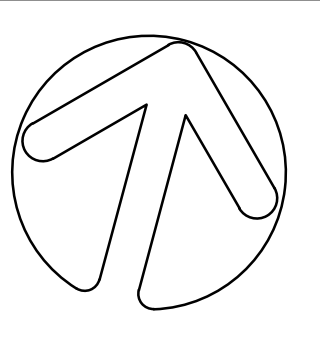

the mbtw group  
landscape architecture | urban design | design solutions | construction | post design | interior design  
280 West Beaver Ave., Unit 10, Richmond Hill, Ontario L4B 1M8  
T: (416) 448-7767 | F: (416) 448-1801 | www.mbtw-ogd.com

Project Name: 1880 Eglinton Avenue / Golden Mile			
Municipality: Scarborough, ON			
Sheet Title: Landscape Rendering			
Designed: JJ	Drawn: MC	Scale: N.T.S.	Drawing No.: L-2
Date of Drawing: July 2020	Job No.: CPR004		



ALL TREE PLANTING AND SOIL VOLUME LOCATIONS SHOWN ON THE PLAN ARE PRELIMINARY AND WILL BE SUBJECT TO THE DETAILED DESIGN PROCESS. TREE LOCATIONS THAT HAVE A HIGH DEGREE OF UNCERTAINTY WITH RESPECT TO FEASIBILITY HAVE BEEN NOTED SEPARATELY AND WILL BE RE-EVALUATED AT THE APPROPRIATE TIMES.



Sample Statistics Template  
Toronto Green Standard Version 3.0  
Soil volume for Tree Planting

Soil Area	Soil Area (m <sup>2</sup> )	Soil Depth (m)*	Soil Volume (m <sup>3</sup> )	Tree Quantity	Soil Volume per tree (m <sup>3</sup> )	Irrigation provided (Yes/No)
1	2181	1	2181	29	75	TBD*
2	180	1	180	6	30	TBD*
3	197	1	197	6	33	TBD*
4	31	1	31	1	31	TBD*
5	150	1	150	5	30	TBD*
6	33	1	33	1	33	TBD*
7	60	1	60	2	30	TBD*
8	150	1	150	5	30	TBD*
9	247	1	247	6	41	TBD*
10	185	1	185	5	37	TBD*
11	33	1	33	1	33	TBD*
12	120	1	120	4	30	TBD*
13	230	1.2	276	9	31	TBD*
14	68	1.5	102	3	34	TBD*
15	617	1	617	5	123	TBD*
16	47	1.5	70.5	2	35	TBD*
17	71	1	71	2	36	TBD*
18	151	1	151	5	30	TBD*
19	154	1	154	5	31	TBD*
20	66	1	66	2	33	TBD*
Totals	4971	VARIES	5075	104	49	

\* To be determined / subject to change

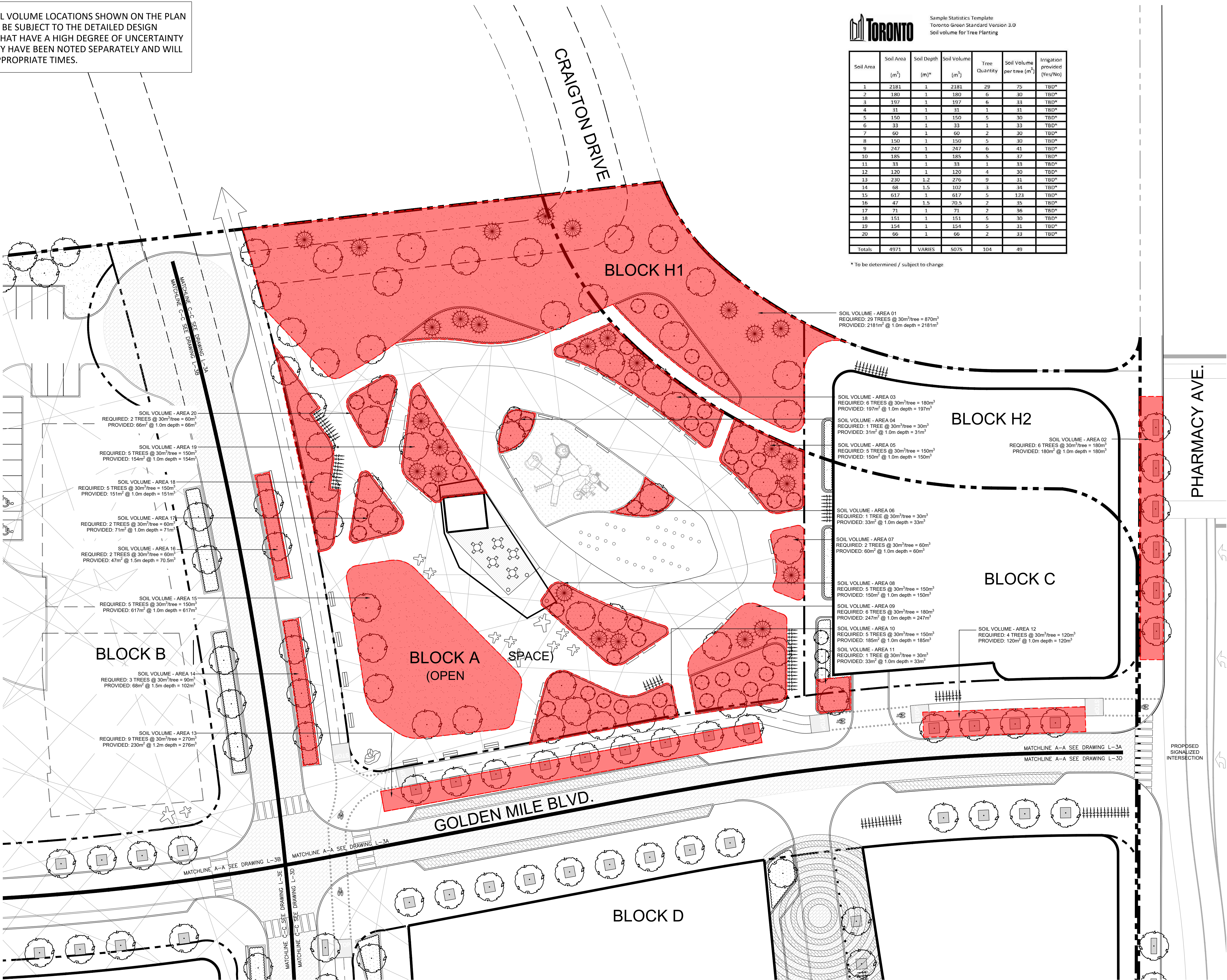

Key Plan

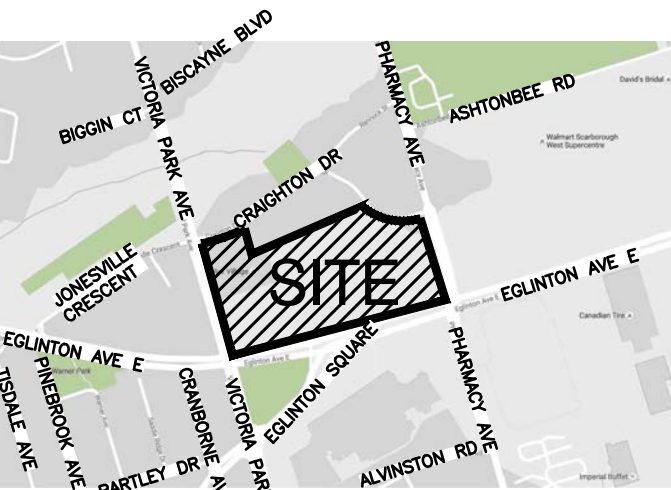

Legend

- LIMIT OF DEVELOPMENT
- - - LIMIT OF BLOCK
- PROPOSED BUILDING FOOTPRINT  
(FOR ARCHITECTURAL INFORMATION  
REFER TO DWGS PREPARED BY  
GIANNONE PETRICONE ASSOCIATES)
- PROPOSED PLAZA PAVING
- PROPOSED POPS PAVING
- PROPOSED ENHANCED  
VEHICULAR PAVING
- PROPOSED ENHANCED  
VEHICULAR LAYBY PAVING
- PROPOSED PLAY SURFACING
- PROPOSED PEDESTRIAN CROSSWALK
- PROPOSED STREET TREE PLANTING  
- TREE GRATE (MIN. 30m<sup>3</sup> SOIL/  
TREE)
- PROPOSED STREET TREE PLANTING  
- FLUSH CURBS w/ BUILT-IN  
SEATING (MIN. 30m<sup>3</sup> SOIL/  
TREE)
- PROPOSED STREET TREE PLANTING  
- RAISED PLANTER (MIN. 30m<sup>3</sup>  
SOIL/  
TREE)
- POTENTIAL LANDSCAPE SEATING
- POTENTIAL OUTDOOR  
MOVEABLE SEATING
- PROPOSED BIKE RACKS
- PROPOSED BOLLARDS
- SOIL VOLUME AREA

3.0	June 16, 2021	Confidential and Without Prejudice Submission #3 - For 3.95 Settlement	JSJ
2.0	Apr 28, 2021	Confidential and Without Prejudice Submission #2 - For 3.95 Settlement	JSJ
1.0	Nov 03, 2020	Confidential and Without Prejudice Submission #1	JSJ
No	Date	Revisions	By

This drawing, as an instrument of service, is provided by, and is the property of The MBTW Group. The contractor shall check and verify all dimensions and report all errors and omissions to the Landscape Architect whose seal is affixed to this drawing before proceeding with the work. This drawing is not to be scaled.



Designed By North Arrow

the mbtw group  
landscape architecture | urban design | design solutions | construction | post design | interior design  
200 Woodbine Ave., Unit 14 | Toronto, Ontario, Canada M4B 1B8  
T: (416) 448-7767 | F: (416) 448-1883 | www.mbtw-vgd.com

Project Name:

1880 Eglinton Avenue  
/ Golden Mile

Municipality: Scarborough, ON

Sheet Title:

Soil Volume Plan  
BLOCK A & C

Designed: JJ	Drawn: MC	Scale: 1:300	Drawing No.: L-3A
Date of Drawing: October 2020	Job No.: CPR004		





Sample Statistics Template  
Toronto Green Standard Version 3.0  
Soil volume for Tree Planting

Soil Area	Soil Area (m <sup>2</sup> )	Soil Depth (m)*	Soil Volume (m <sup>3</sup> )	Tree Quantity	Soil Volume per tree (m <sup>3</sup> )	Irrigation provided (Yes/No)
1	112	1.5	168	4	42	TBD*
2	45	1.5	68	2	34	TBD*
3	460	1.5	690	23	30	TBD*
4	316	1.5	474	15	32	TBD*
5	20	1.5	30	1	30	TBD*
6	20	1.5	30	1	30	TBD*
7	23	1.5	35	1	35	TBD*
8	80	1.5	120	4	30	TBD*
9	30	1	30	1	30	TBD*
10	30	1	30	1	30	TBD*
11	27	1.2	32	1	32	TBD*
12	40	1.5	60	2	30	TBD*
13	60	1	60	2	30	TBD*
14	60	1.5	90	3	30	TBD*
15	60	1.5	90	3	30	TBD*
16	60	1.5	90	3	30	TBD*
17	60	1	60	2	30	TBD*
18	54	1.2	65	2	32	TBD*
19	75	1.5	113	3	38	TBD*
20	270	1	270	9	30	TBD*
Totals	1902	VARIES	2604	83	31	

\* To be determined / subject to change

ALL TREE PLANTING AND SOIL VOLUME LOCATIONS SHOWN ON THE PLAN ARE PRELIMINARY AND WILL BE SUBJECT TO THE DETAILED DESIGN PROCESS. TREE LOCATIONS THAT HAVE A HIGH DEGREE OF UNCERTAINTY WITH RESPECT TO FEASIBILITY HAVE BEEN NOTED SEPARATELY AND WILL BE RE-EVALUATED AT THE APPROPRIATE TIMES.

Key Plan



Legend

- LIMIT OF DEVELOPMENT
- - - LIMIT OF BLOCK
- PROPOSED BUILDING FOOTPRINT (FOR ARCHITECTURAL INFORMATION REFER TO DWGS PREPARED BY GIANNONE PETRICONE ASSOCIATES)
- PROPOSED PLAZA PAVING
- PROPOSED POPS PAVING
- PROPOSED ENHANCED VEHICULAR PAVING
- PROPOSED ENHANCED VEHICULAR LAYBY PAVING
- PROPOSED PLAY SURFACING
- PROPOSED PEDESTRIAN CROSSWALK
- PROPOSED STREET TREE PLANTING - TREE GRATE (MIN. 30m<sup>3</sup> SOIL/ TREE)
- PROPOSED STREET TREE PLANTING - FLUSH CURBS w/ BUILT-IN SEATING (MIN. 30m<sup>3</sup> SOIL/ TREE)
- PROPOSED STREET TREE PLANTING - RAISED PLANTER (MIN. 30m<sup>3</sup> SOIL/ TREE)
- POTENTIAL LANDSCAPE SEATING
- POTENTIAL OUTDOOR MOVEABLE SEATING
- PROPOSED BIKE RACKS
- PROPOSED BOLLARDS
- SOIL VOLUME AREA

No	Date	Revisions	By
3.0	June 16, 2021	Confidential and Without Prejudice Submission #3 - For 3.95 Settlement	JSJ
2.0	Apr 28, 2021	Confidential and Without Prejudice Submission #2 - For 3.95 Settlement	JSJ
1.0	Nov 03, 2020	Confidential and Without Prejudice Submission #1	JSJ

This drawing, as an instrument of service, is provided by, and is the property of, The MBTW Group. The contractor shall check and verify all dimensions and report all errors and omissions to the Landscape Architect whose seal is affixed to this drawing before proceeding with the work. This drawing is not to be scaled.

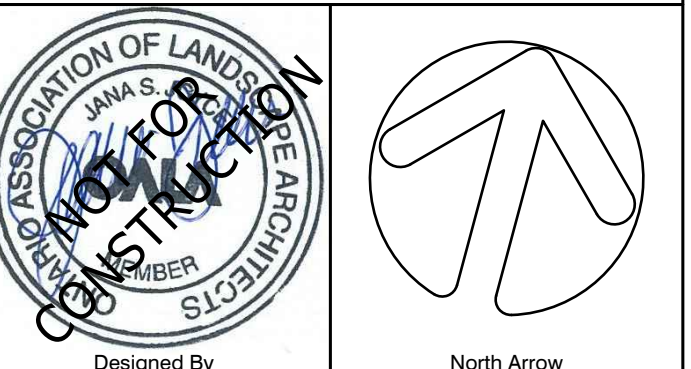

the mbtw group  
landscape architecture | urban design | design strategy | construction | post design | interior design  
200 Woodbine Ave., Unit 14 | Toronto, Ontario, Canada M4B 1W8  
Tel: (416) 448-7767 | Fax: (416) 448-1880 | www.mbtw-od.com

Project Name:	1880 Eglinton Avenue / Golden Mile		
Municipality:	Scarborough, ON		
Sheet Title:	Soil Volume Plan BLOCK B		
Designed:	Drawn:	Scale:	Drawing No.: <b>L-3B</b>
JJ	MC	1:300	
Date of Drawing:	Job No.:		
October 2020	CPR004		