

C

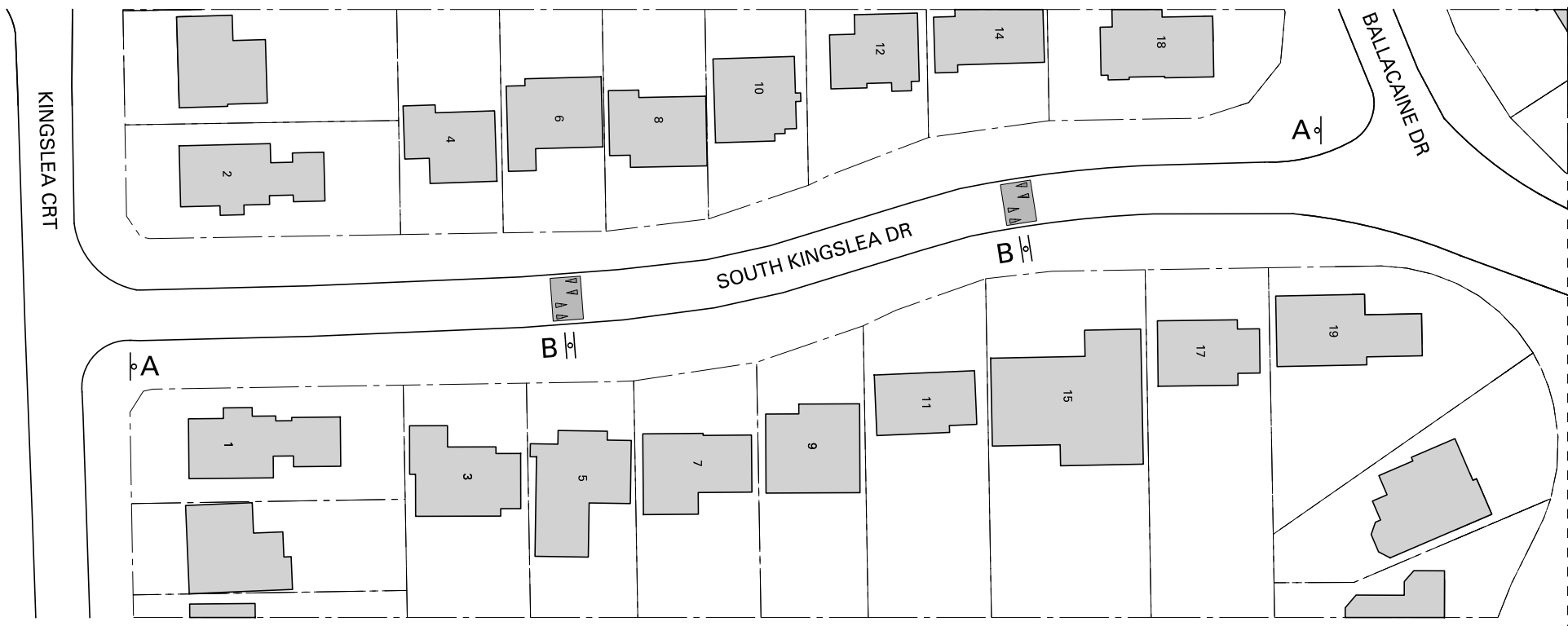

N.T.S.

LEGEND

A		B			PROPOSED TWO-WAY SPEED HUMPS



C

- NOTE :
1. INFORMATION ON THIS PLAN IS BASED ON OFFICE RECORDS AND IS SUBJECT TO FIELD VERIFICATION.
 2. SPEED HUMPS MAY NOT BE CONSTRUCTED EXACTLY IN THE LOCATIONS SHOWN DUE TO FIELD CONDITIONS.
 3. EVERY ATTEMPT WILL BE MADE TO UTILIZE EXISTING POLES FOR SPEED HUMP SIGNS, HOWEVER IT MAYBE NECESSARY TO INSTALL NEW POLES FOR THESE SIGNS.

SOUTH KINGSLEA DR: KINGSLEA CRT TO PARK LAWN RD PROPOSED SPEED HUMP LOCATIONS PLAN

SHEET 1 OF 2

C



N.T.S.

LEGEND

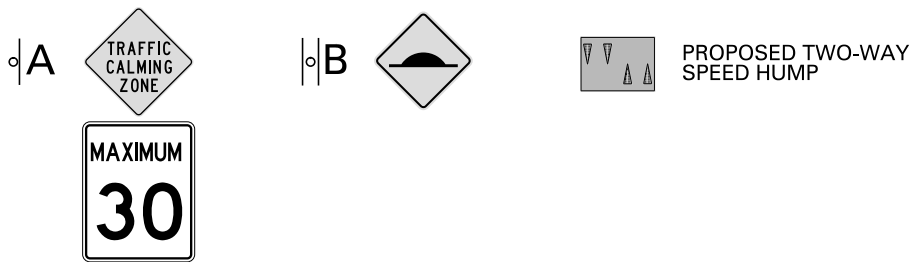

NOTE :

1. INFORMATION ON THIS PLAN IS BASED ON OFFICE RECORDS AND IS SUBJECT TO FIELD VERIFICATION.
2. SPEED HUMPS MAY NOT BE CONSTRUCTED EXACTLY IN THE LOCATIONS SHOWN DUE TO FIELD CONDITIONS.
3. EVERY ATTEMPT WILL BE MADE TO UTILIZE EXISTING POLES FOR SPEED HUMP SIGNS, HOWEVER IT MAYBE NECESSARY TO INSTALL NEW POLES FOR THESE SIGNS.

SOUTH KINGSLEA DR: KINGSLEA CRT TO PARK LAWN RD PROPOSED SPEED HUMP LOCATIONS PLAN

SHEET 2 OF 2