



# **PB22.2**

**Inclusion on the City of Toronto's Heritage Register, Intention to Designate under Part IV, Section 29 of the Ontario Heritage Act, Alterations to a Heritage Property and Authority to Enter into a Heritage Easement Agreement – 260 Church Street**

# PB22.2 260 Church Street

This location map is for information purposes only; the exact boundaries of the property are not shown.

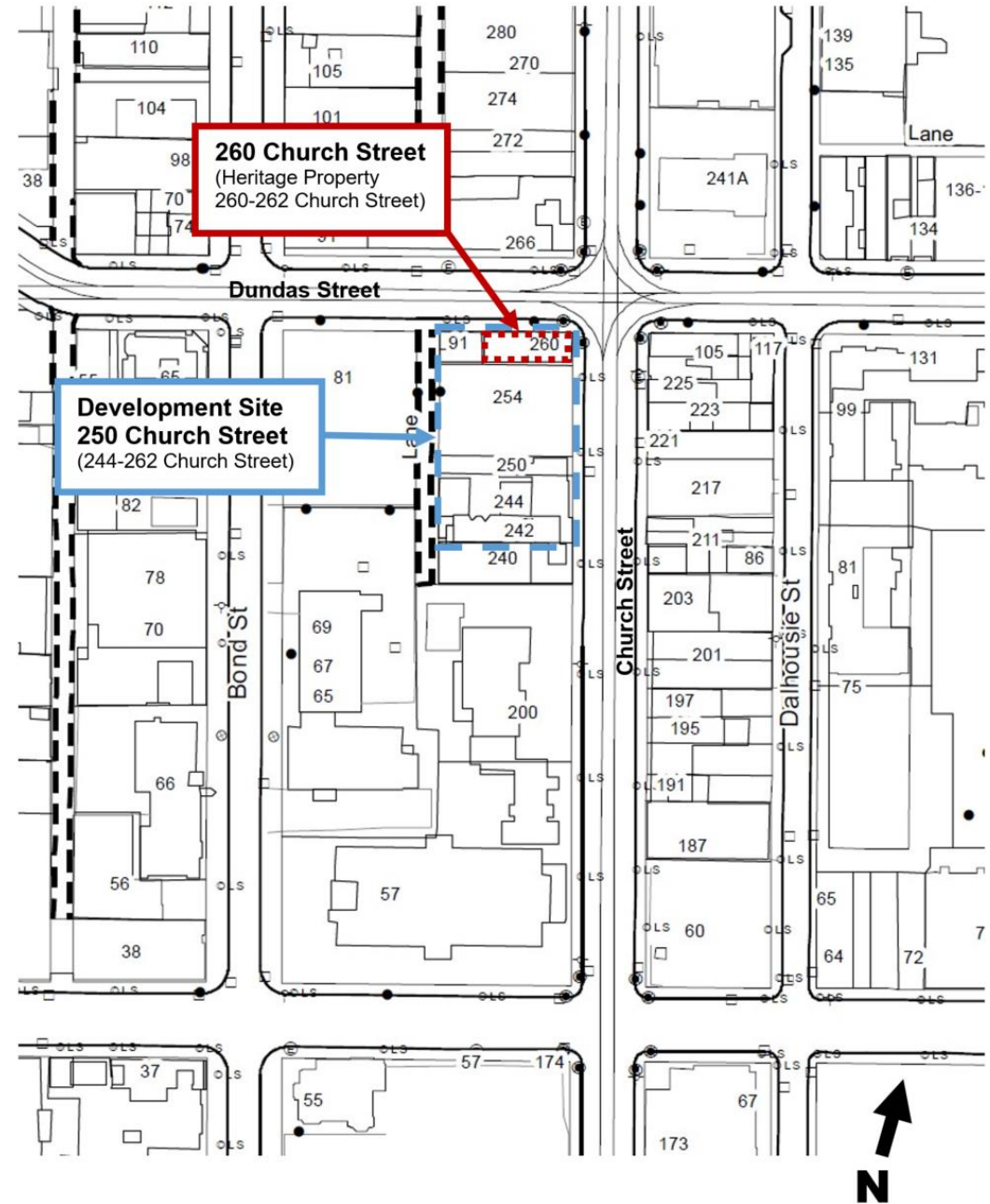

## PB22.2 260 Church Street



1971 archival photo of The Sterling Bank at 260 Church St (above left); current photograph of St. Michael's Cathedral (above centre); current photograph of the properties at 60-64 Queen St & 131-135 Church St (above right); and, current photograph of the surviving portion of the Georgian terraces at 191-197 Church St (right).





## PB22.2 260 Church Street



1981 archival photo of the property at 260 Church Street (above); Current image of the property showing the applied commercial signage and tiling at the first-floor level (right)

---

**PB22.2**  
**260 Church Street**

Satellite view of the subject property at 260 Church Street. (Google Maps)  
The arrow marks the location of the site.





---

**PB22.2**  
**260 Church Street**

Project Rendering  
(Looking West along Dundas Street)



ARCHITECTURAL VISUALIZATION - VIEW LOOKING WEST







# PB22.2 260 Church Street



East Elevation - Lower Level Detail



North Elevation Lower Level Detail



Full East Elevation

Full North Elevation

---

**PB22.2**  
**260 Church Street**



Architectural Rendering - Looking North up Church Street



Architectural Rendering - Looking South down Church Street



---

**PB22.2**  
**260 Church Street**



Architectural Rendering - Looking East across Dundas Street



Architectural Rendering - Looking West across Dundas Street

---

**PB22.2**  
**260 Church Street**



Architectural Rendering - Looking South West across the intersection of Church and Dundas Streets



---

**PB22.2**  
**260 Church Street**



Architectural Renderings - Original Submission