

Attachment 1 - Proposed Amendments to Speed Limits on Local Roads and Public Lanes in Ward 4, Ward 9 and Ward 19

1. Insert the following into Schedule XLV (Part 1) in § 950-1344 as follows:

(Column 1) Designated Area Name	(Column 2) East Limit / West Limit of Designated Area	(Column 3) North Limit / South Limit of Designated Area	(Column 4) Excluded Highways	(Column 5) Speed (km/h)	(Column 6) Designated Area Map
(Area 1) in Ward 4	West side of Keele Street / east side of Runnymede Road	South side of Canadian Pacific Railway / north side of Bloor Street West	Dundas Street West between Runnymede Road and Keele Street Annette Street between Runnymede Road and Keele Street Pacific Avenue between Annette Street and Dundas Street West Clendenan Avenue between Bloor Street West and Annette Street High Park Avenue between Bloor Street West and Annette Street Humber Avenue between High Park Avenue and Keele Street Glenlake Avenue between High Park Avenue and Keele Street	30	(Area 1) in Ward 4
(Area 2) in Ward 4	West side of Runnymede Road / east side of Jane Street	South side of Canadian Pacific Railway / north side of Bloor Street West	Dundas Street West between Runnymede Road and Jane Street Annette Street between Runnymede Road and Jane Street Colbeck Street between Runnymede Road and Jane Street St John's Road between Runnymede Road and Jane Street	30	(Area 2) in Ward 4
(Area 3) in Ward 4	West side of Jane Street / east side of Humber River	South side of Canadian Pacific Railway / north side of Bloor Street West	Dundas Street West between Jane Street and Humber River Scarlett Road between Dundas Street West and CPR Catherine Street between Old Mill Drive and Humber River Baby Point Road between Humbercrest Boulevard and Jane Street Humbercrest Boulevard between Baby Point Road and St Mark's Road St Mark's Road between Jane Street and Varsity Road Varsity Road between Old Dundas Street and St Mark's Road Old Dundas Street between Varsity Road and Humber Hill Avenue Humber Hill Avenue between Old Dundas Street and Dundas Street West	30	(Area 3) in Ward 4
(Area 4) in Ward 4	West side of Parkside Drive / east side of Humber River	South side of Bloor Street West / north side of Lake Ontario	South Kingsway between Bloor Street West and The Queensway The Queensway between Parkside Drive and Humber River Lake Shore Boulevard West between Parkside Drive and Humber River F G Gardiner Expressway West between Parkside Drive and Humber River Morningside Ave between South Kingsway and Ellis Avenue Ellis Avenue between Morningside Avenue and Lake Shore Boulevard West Windermere Avenue between Bloor Street West and The Queensway Colborne Lodge Drive between Lake Shore Boulevard West and Bloor Street West	30	(Area 4) in Ward 4
(Area 1) in Ward 9	West side of Dufferin Street / east side of Canadian Pacific Railway	South side of Eglinton Avenue West / north side of Rogers Road	Caledonia Road between Eglinton Avenue West and Rogers Road	30	(Area 1) in Ward 9
(Area 2) in Ward 9	West side of Oakwood Avenue / east side of Dufferin Street	South side of Rogers Road / north side of St. Clair Avenue West		30	(Area 2) in Ward 9
(Area 3) in Ward 9	West side Dufferin Street / east side of Caledonia Road	South side of Rogers Road / north side of St. Clair Avenue West	Earls Court Avenue between St. Clair Avenue West and Hope Street Hope Street between Nairn Avenue and Dufferin Street Nairn Avenue between Hope Street and Rogers Road	30	(Area 3) in Ward 9
(Area 4) in Ward 9	West side Dufferin Street / east side of Caledonia Park Road	South side of St. Clair Avenue West / north side of Davenport Road	Lansdowne Avenue between Davenport Road and St. Clair Avenue West Via Italia between Auburn Avenue and St. Clair Avenue West Auburn Avenue between Via Italia and Dufferin Street	30	(Area 4) in Ward 9
(Area 5) in Ward 9	West side Dufferin Street / east side of Symington Avenue	South side of Davenport Road / north side of Canadian Pacific Railway	Lansdowne Avenue between Canadian Pacific Railway and Davenport Road	30	(Area 5) in Ward 9
(Area 6) in Ward 9	West side of Ossington Avenue / east side of Dufferin Street	South side of Davenport Road / north side of Canadian Pacific Railway	Geary Avenue between Dufferin Street and Dovercourt Road Dovercourt Road between Canadian Pacific Railway and Davenport Road	30	(Area 6) in Ward 9
(Area 7) in Ward 9	West side of Symington Avenue / east side of Old Weston Road	South side of Davenport Road / north side of Canadian Pacific Railway	Osler Street between Canadian Pacific Railway and Davenport Road	30	(Area 7) in Ward 9
(Area 8) in Ward 9	West side of Winona Drive / east side of Dufferin Street	South side of Street Clair Avenue West / north side of Davenport Road	Oakwood Avenue between Davenport Road and St. Clair Avenue West	30	(Area 8) in Ward 9

(Column 1) Designated Area Name	(Column 2) East Limit / West Limit of Designated Area	(Column 3) North Limit / South Limit of Designated Area	(Column 4) Excluded Highways	(Column 5) Speed (km/h)	(Column 6) Designated Area Map
(Area 9) in Ward 9	West side of Caledonia Park Road / east side of Old Weston Road	South side of St. Clair Avenue West / north side of Davenport Road	Laughton Avenue between Davenport Road and St. Clair Avenue West	30	(Area 9) in Ward 9
(Area 10) in Ward 9	West side of Caledonia Park Road / east side of Old Weston Road	South side of Rogers Road / north side of St. Clair Avenue West	Rockwell Avenue between Old Weston Road and Silverthorn Avenue Silverthorn Avenue between St. Clair Avenue West and Rogers Road	30	(Area 10) in Ward 9
(Area 11) in Ward 9	East side of Winona Drive / east side of Oakwood Avenue	North side of Holland Park Avenue / north side of St. Clair Avenue West		30	(Area 11) in Ward 9
(Area 1) in Ward 19	West side of Victoria Park Avenue / east side of Bermondsey Road	South side of Sunrise Avenue / north side of Holland Avenue between Victoria Park Avenue and the west end of Holland Avenue and from a point at the west end of Holland Drive to the intersection of O'Connor Drive and Skopkje Gate and north side of O'Connor Drive between Bermondsey Road and Holland Avenue	O'Connor Drive between Skopje Gate and Sunrise Avenue	30	(Area 1) in Ward 19

2. Insert the following into Schedule XLV (Part 2) in § 950-1344 as follows:

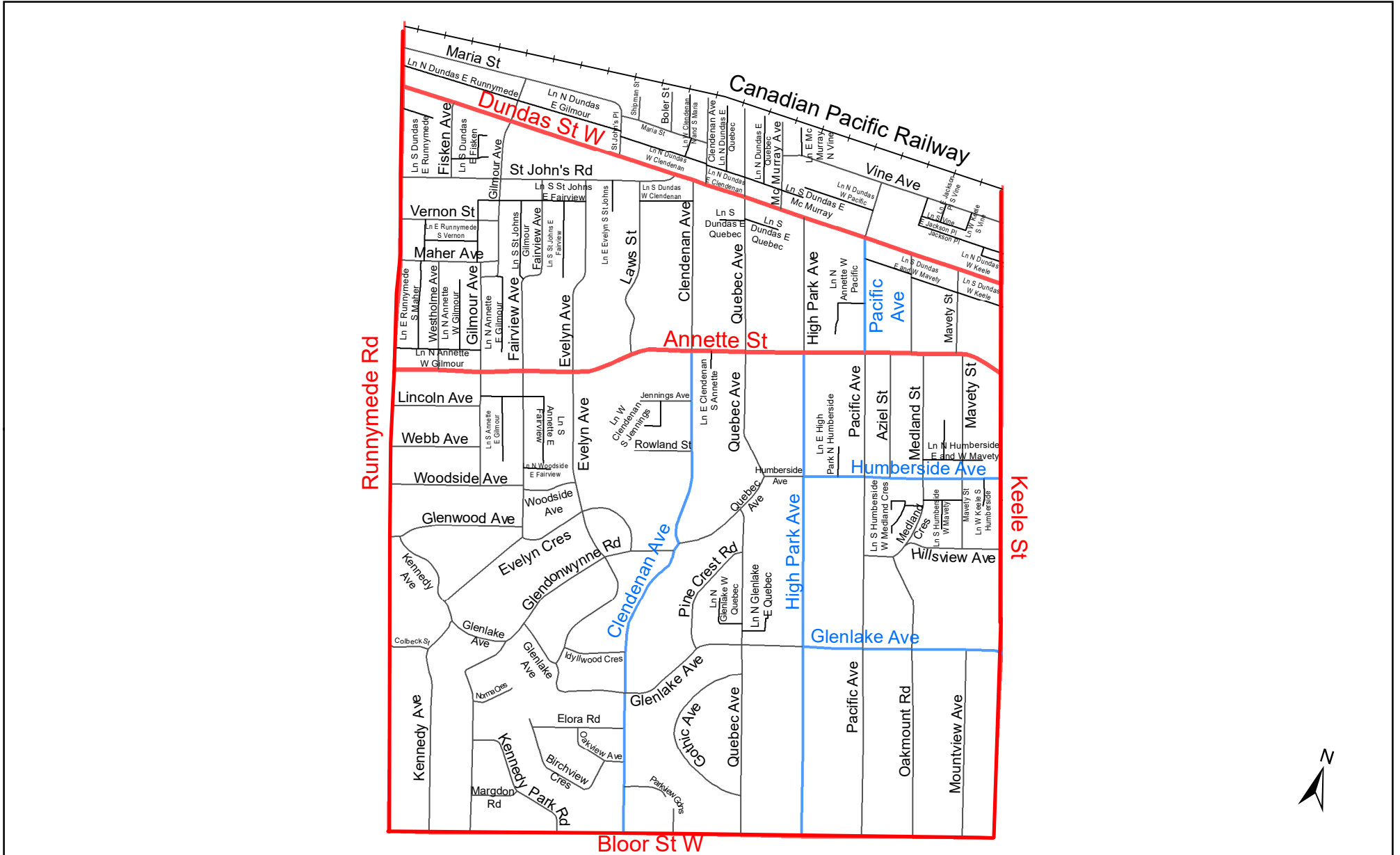

Local Road Speed Limit Reduction (Area 1) in Ward 4

Legend

- Expressway
- Major Arterial; Minor Arterial
- Collector
- Local ; Laneway
- Pending
- Railway

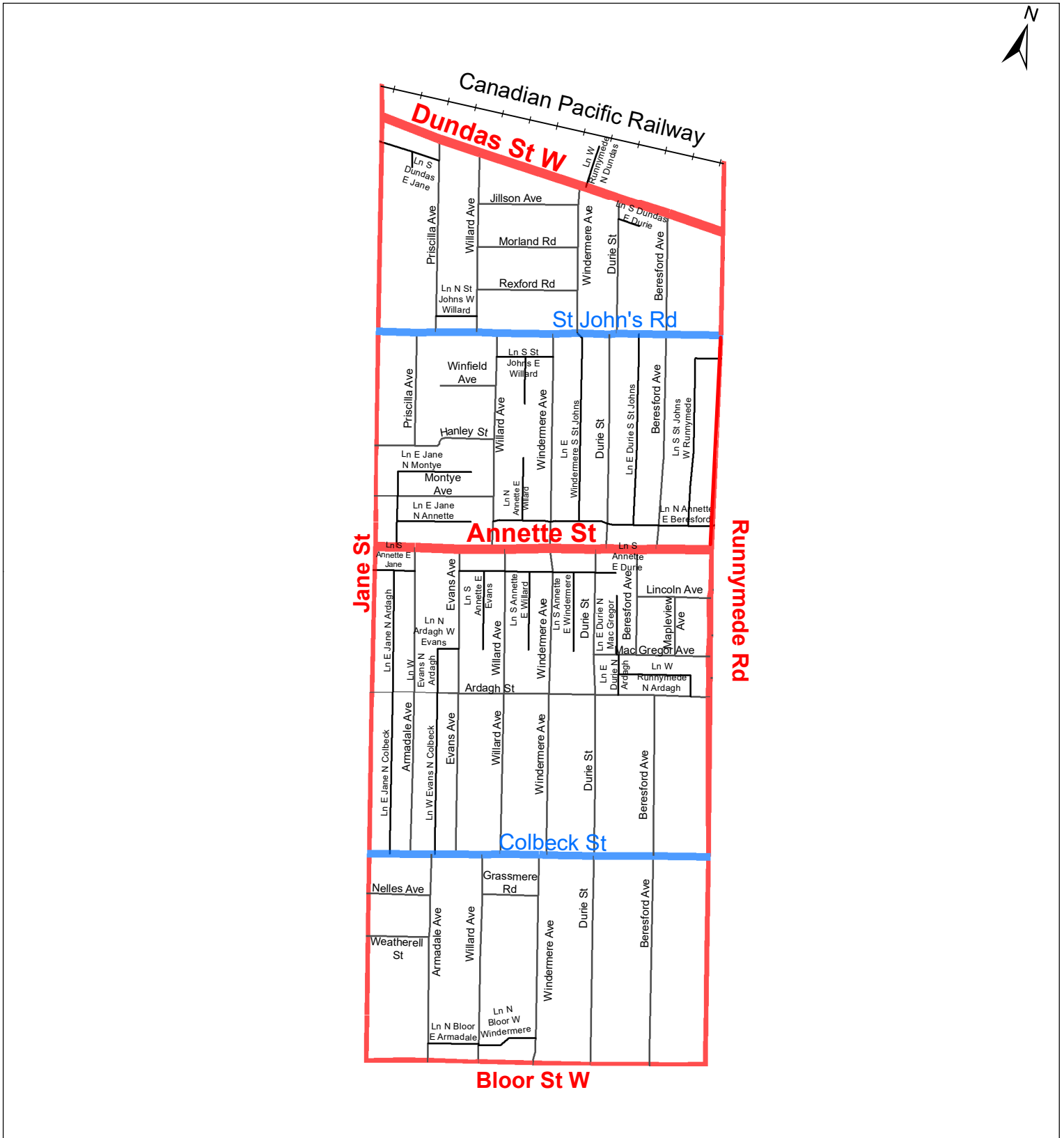

- Expressway
- Major Arterial; Minor Arterial

- Collector
- Local ; Laneway
- Pending
- Railway

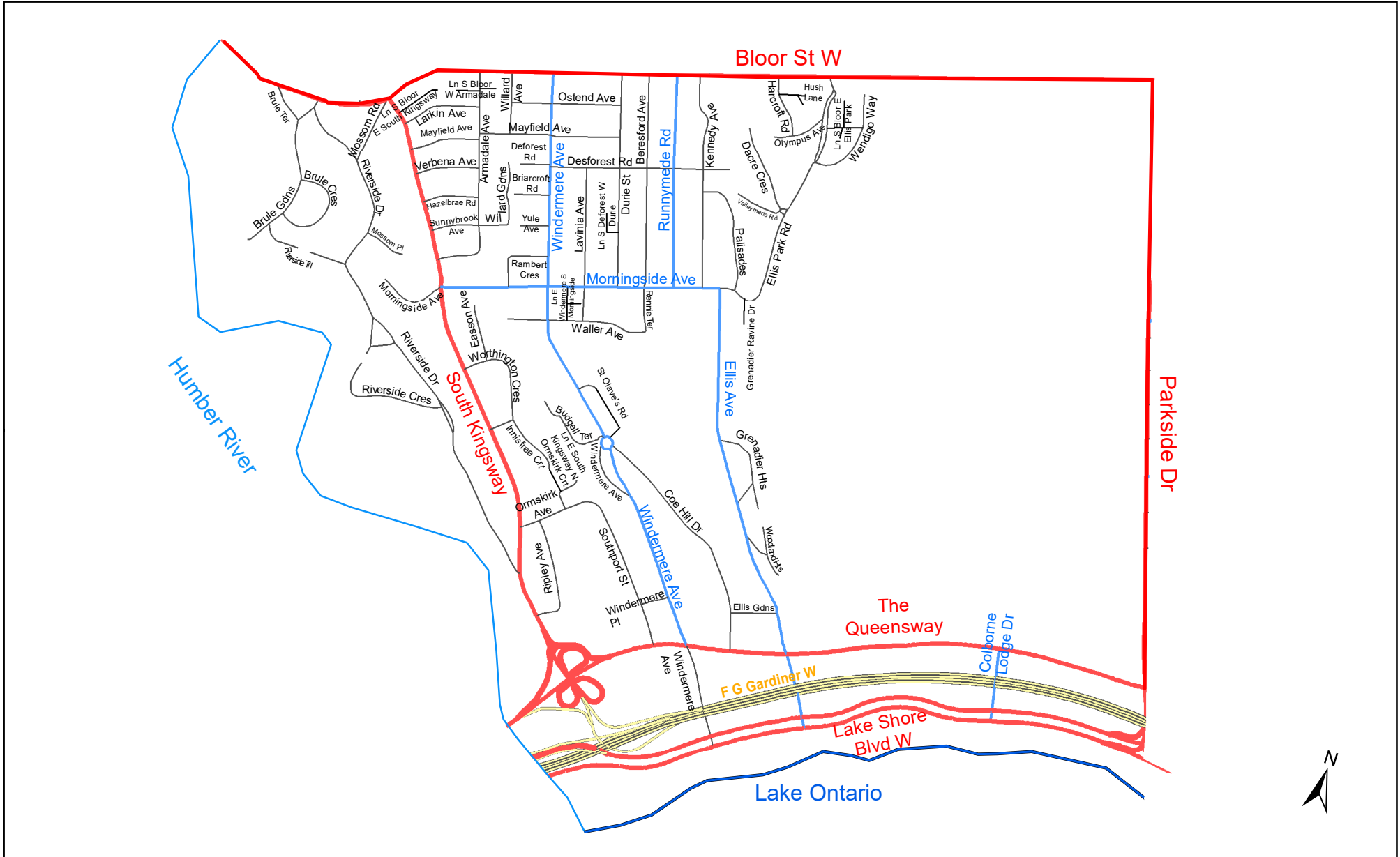

Local Road Speed Limit Reduction (Area 4) in Ward 4

- Legend**
- Major Arterial; Minor Arterial
 - Collector
 - Expressway
 - Local ; Laneway
 - Pending
 - River
 - Lake



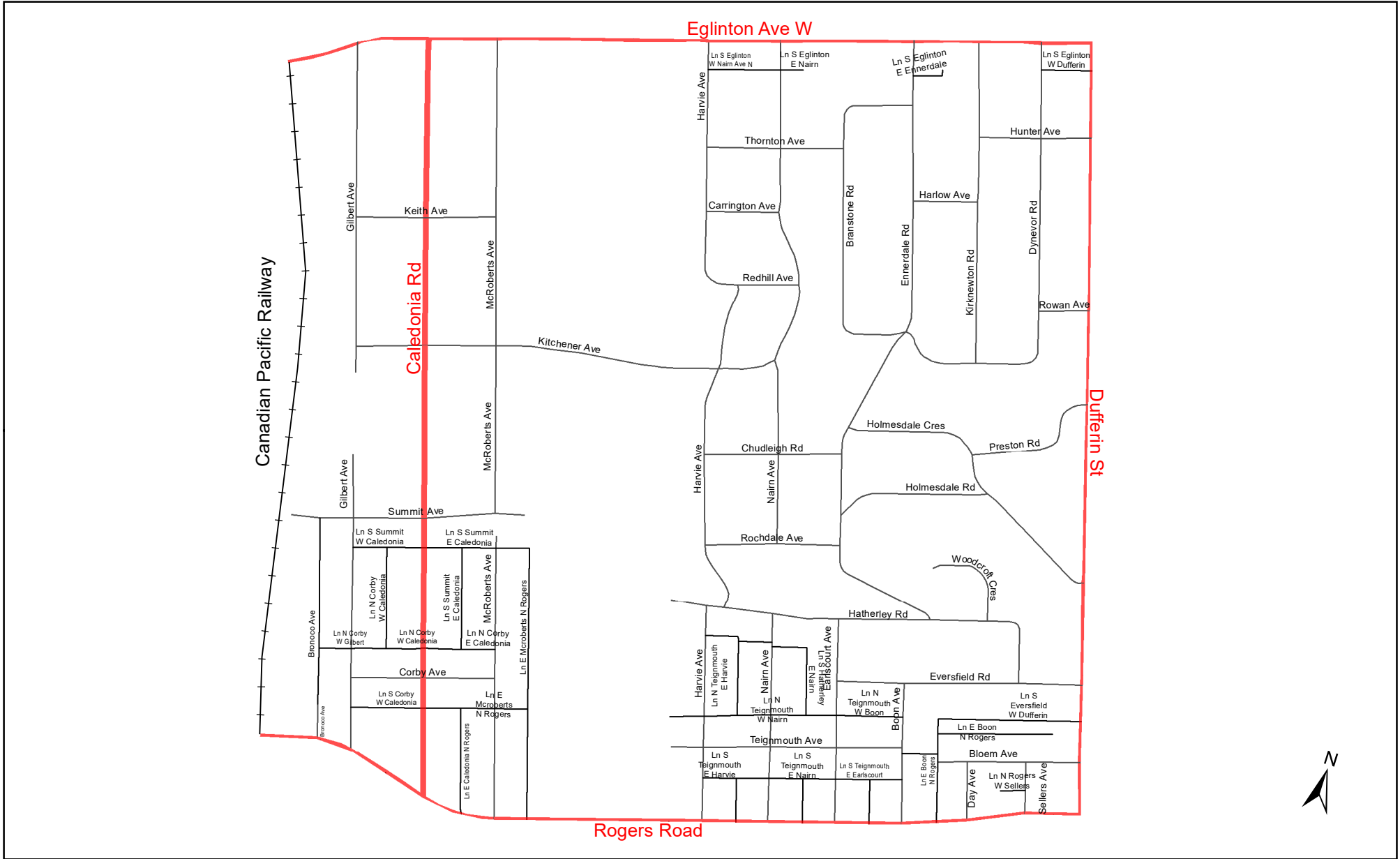

Local Road Speed Limit Reduction (Area 1) in Ward 9

Legend

- Expressway
- Major Arterial; Minor Arterial
- Collector
- Local; Laneway
- Pending
- Railway

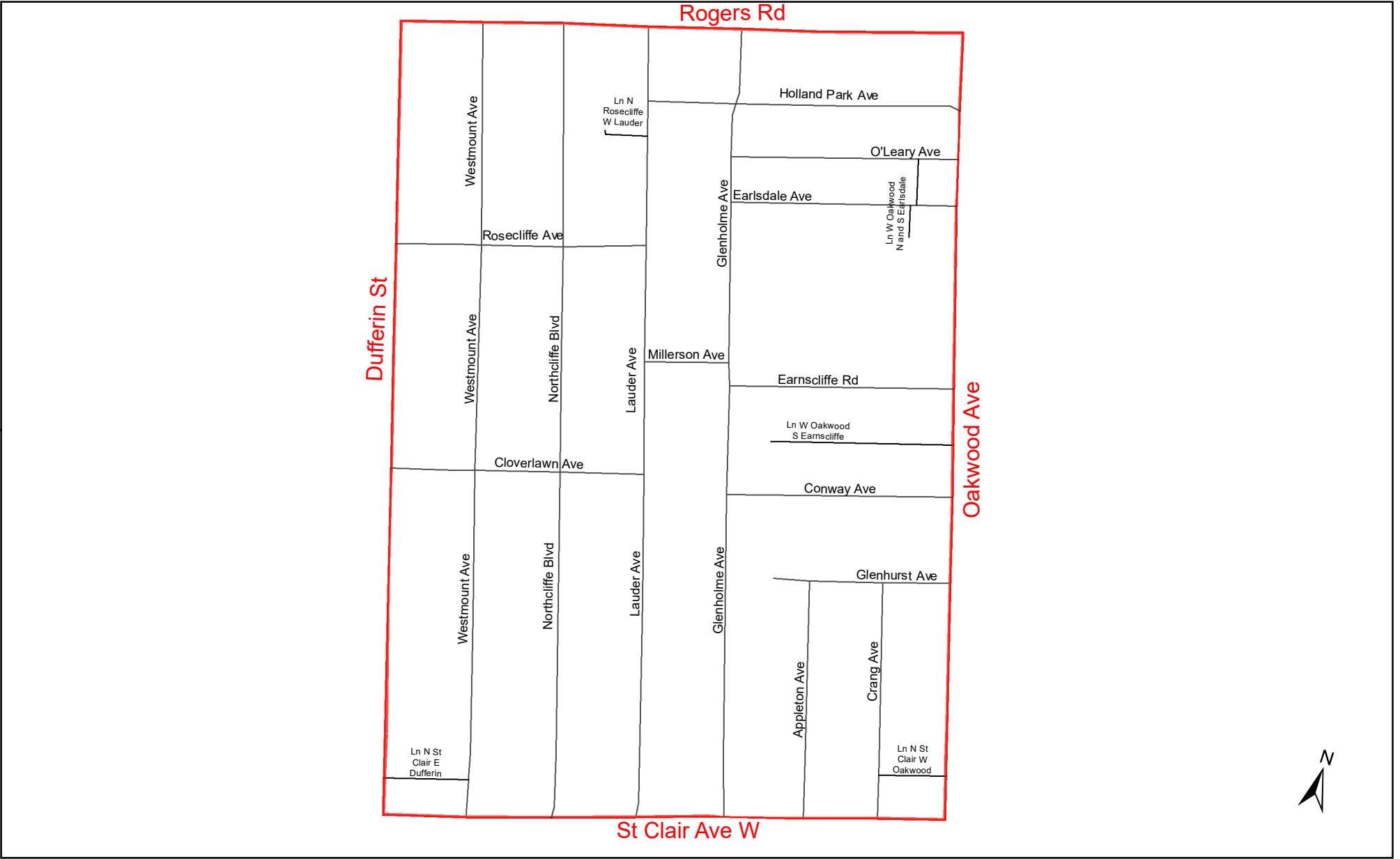

Local Road Speed Limit Reduction (Area 2) in Ward 9

- Legend**
- Collector
 - Expressway
 - Local ; Laneway
 - Major Arterial; Minor Arterial
 - Pending



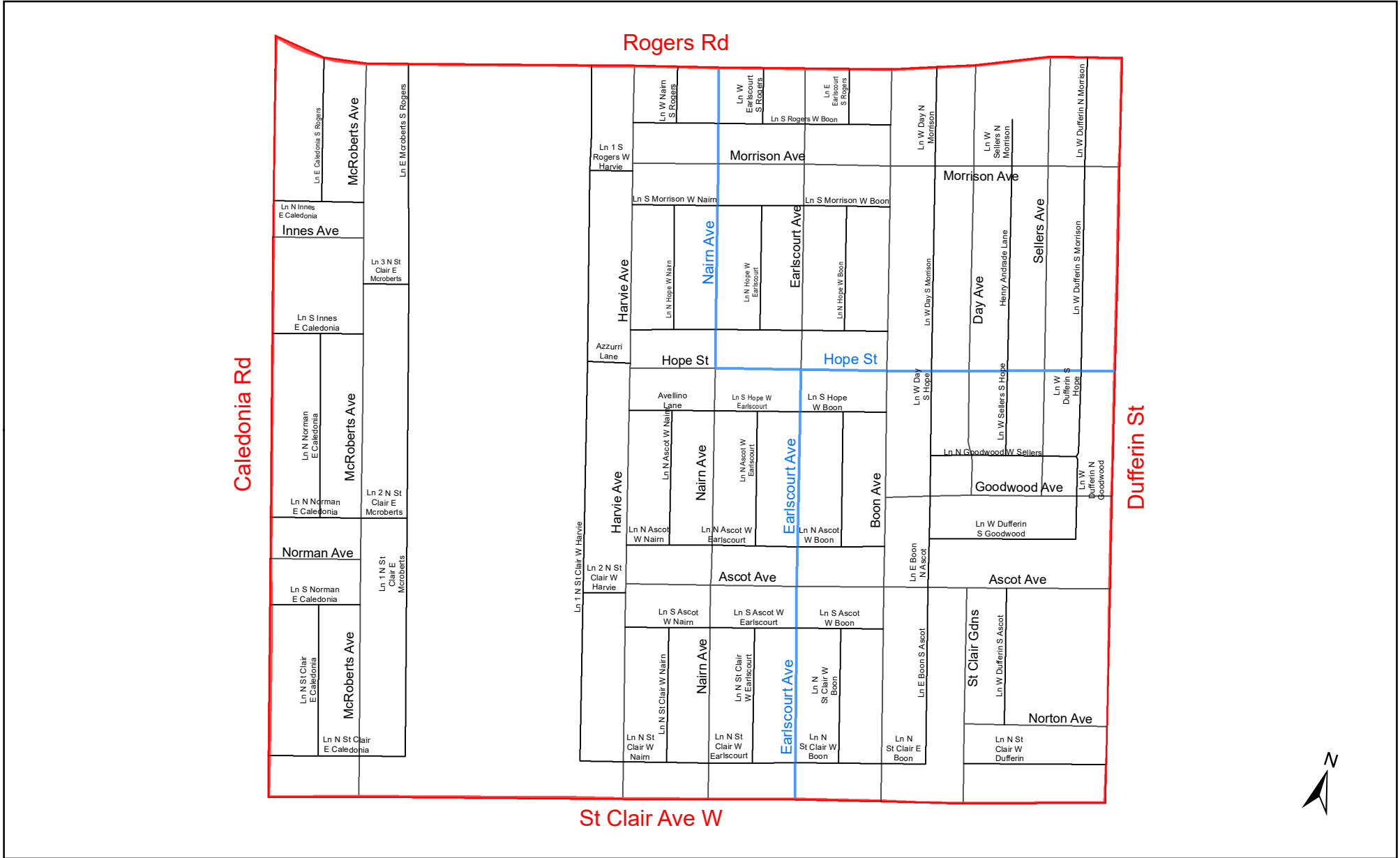

Local Road Speed Limit Reduction (Area 3) in Ward 9

- Legend**
- Collector
 - Expressway
 - Local ; Laneway
 - Major Arterial; Minor Arterial
 - Pending



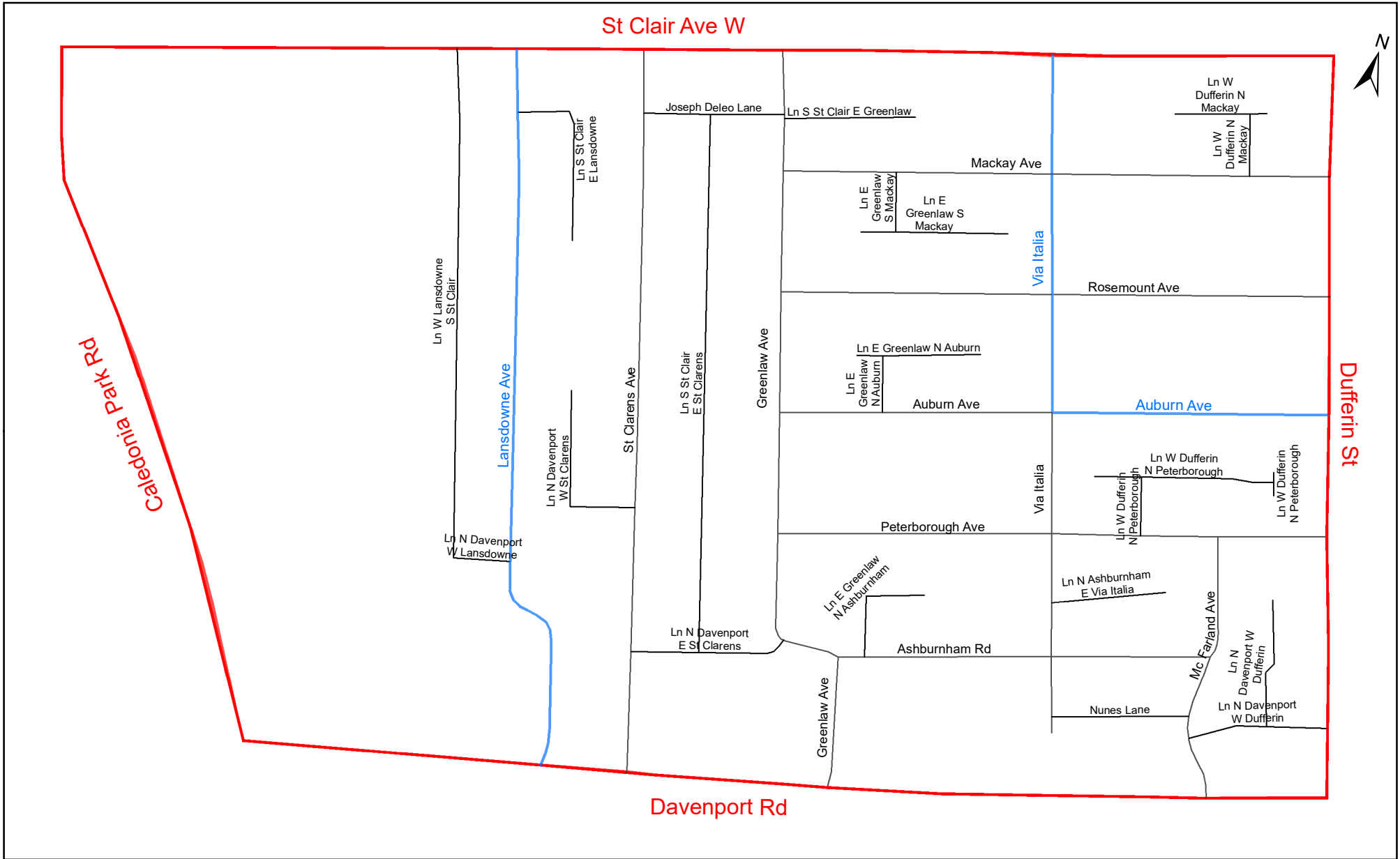

Local Road Speed Limit Reduction (Area 4) in Ward 9

- Legend**
- Expressway
 - Major Arterial; Minor Arterial
 - Collector
 - Local ; Laneway
 - Pending



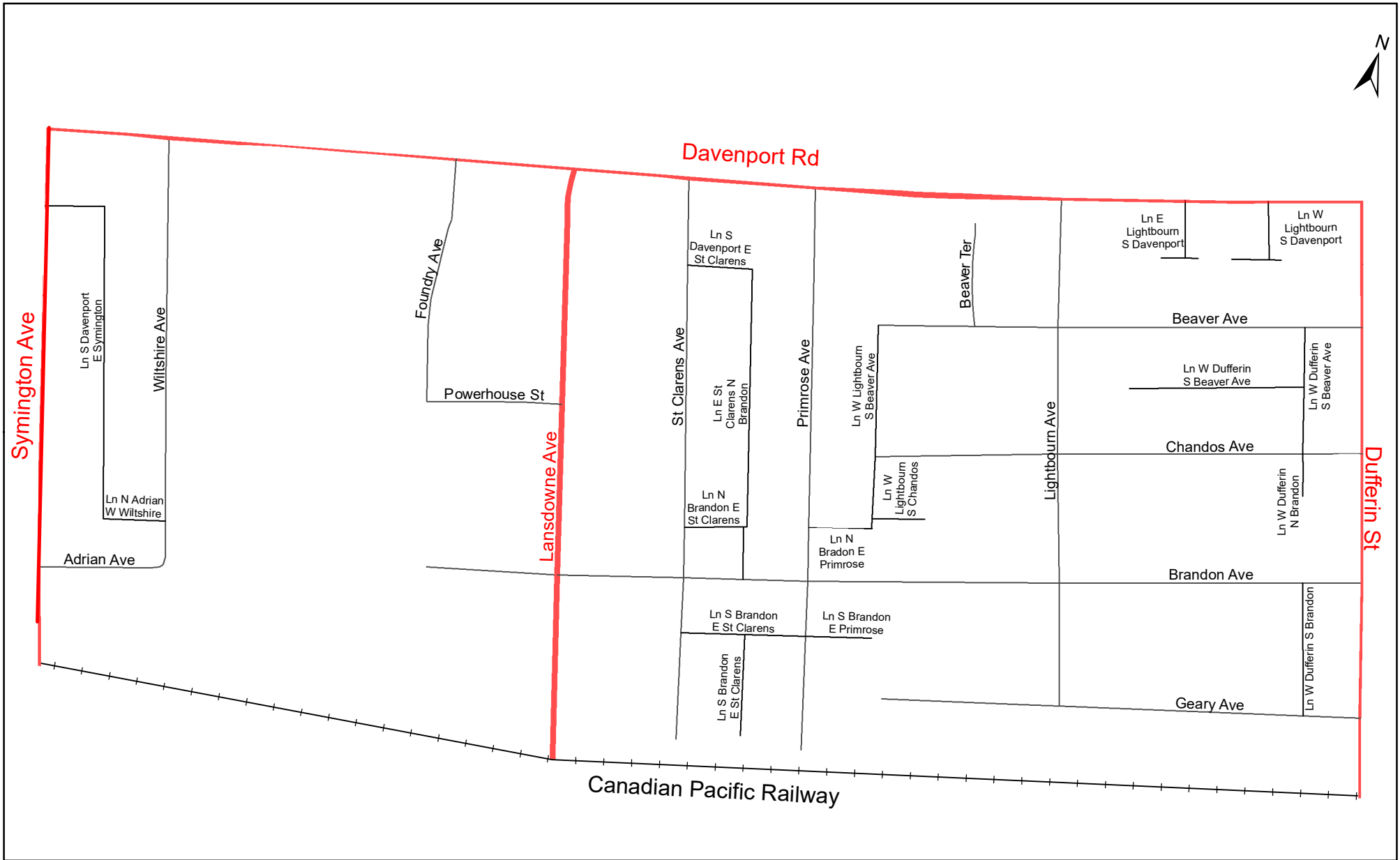

Local Road Speed Limit Reduction (Area 5) in Ward 9

- Legend**
- Major Arterial; Minor Arterial
 - Collector
 - Expressway
 - Local ; Laneway
 - Pending
 - Pending

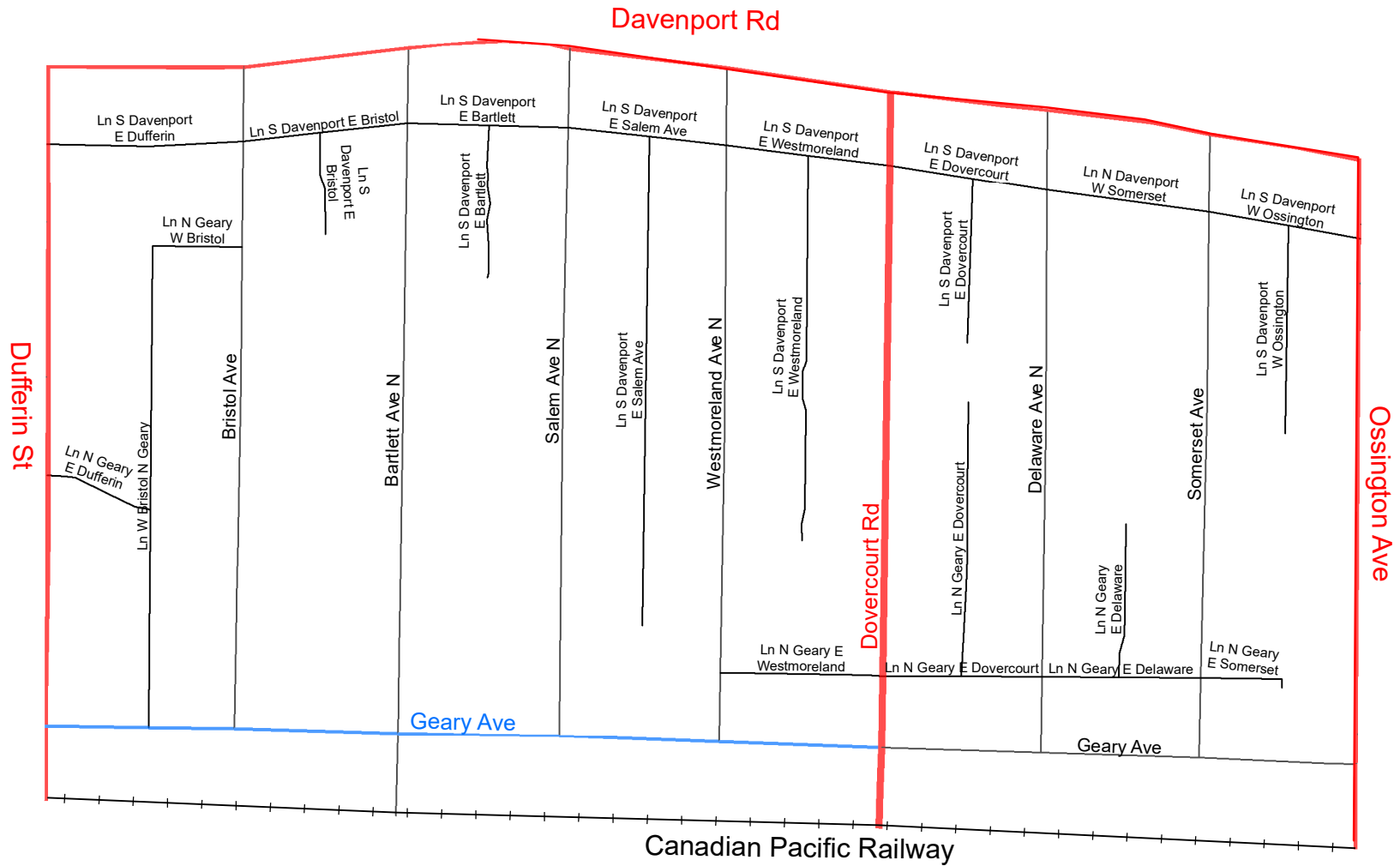

Local Road Speed Limit Reduction (Area 6) in Ward 9



Legend

- Major Arterial; Minor Arterial
- Collector
- Local ; Laneway
- Pending
- Railway

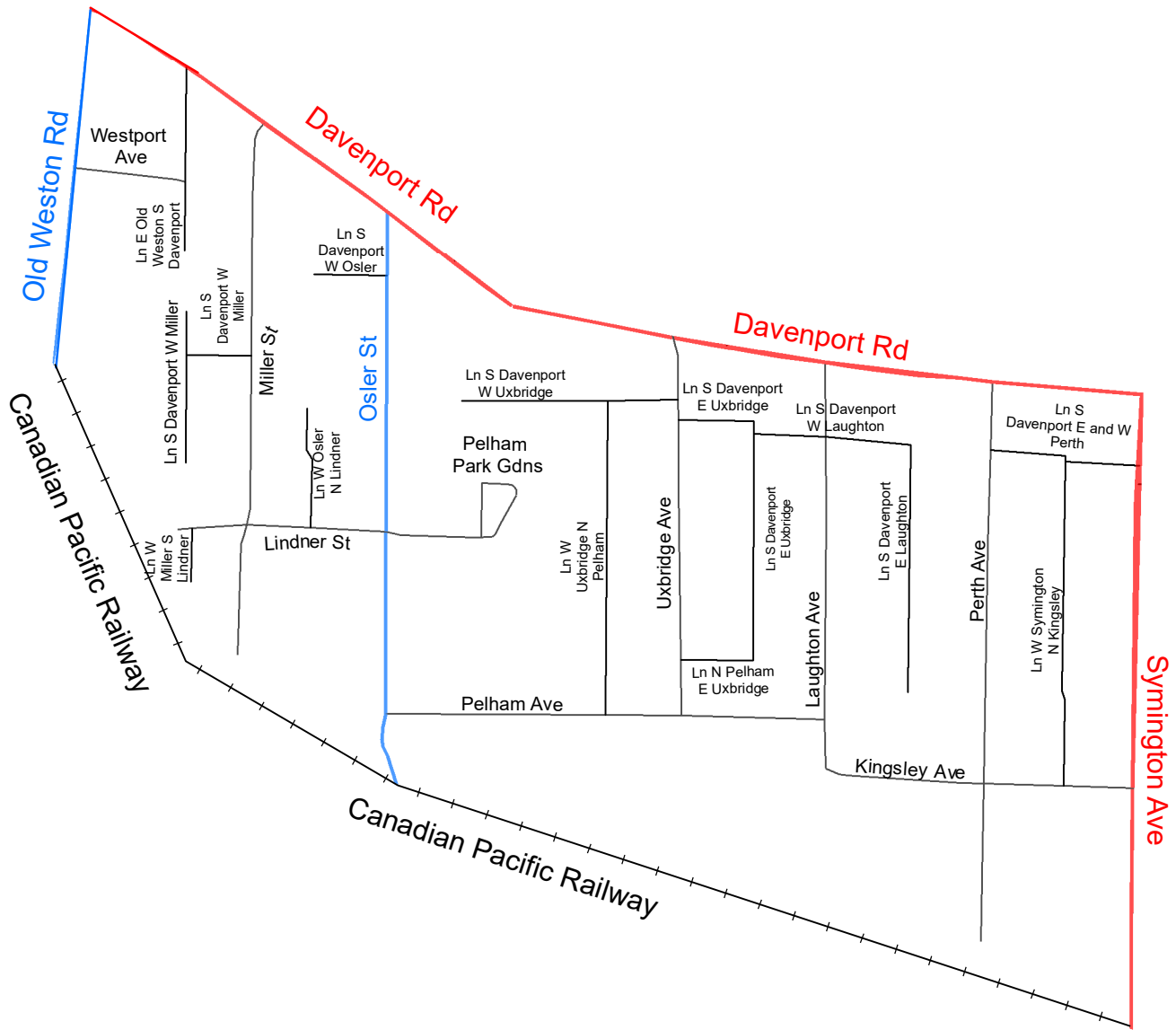

Local Road Speed Limit Reduction (Area 7) in Ward 9



- Legend**
- Major Arterial; Minor Arterial
 - Collector
 - Local ; Laneway
 - Pending
 - Expressway
 - Railway

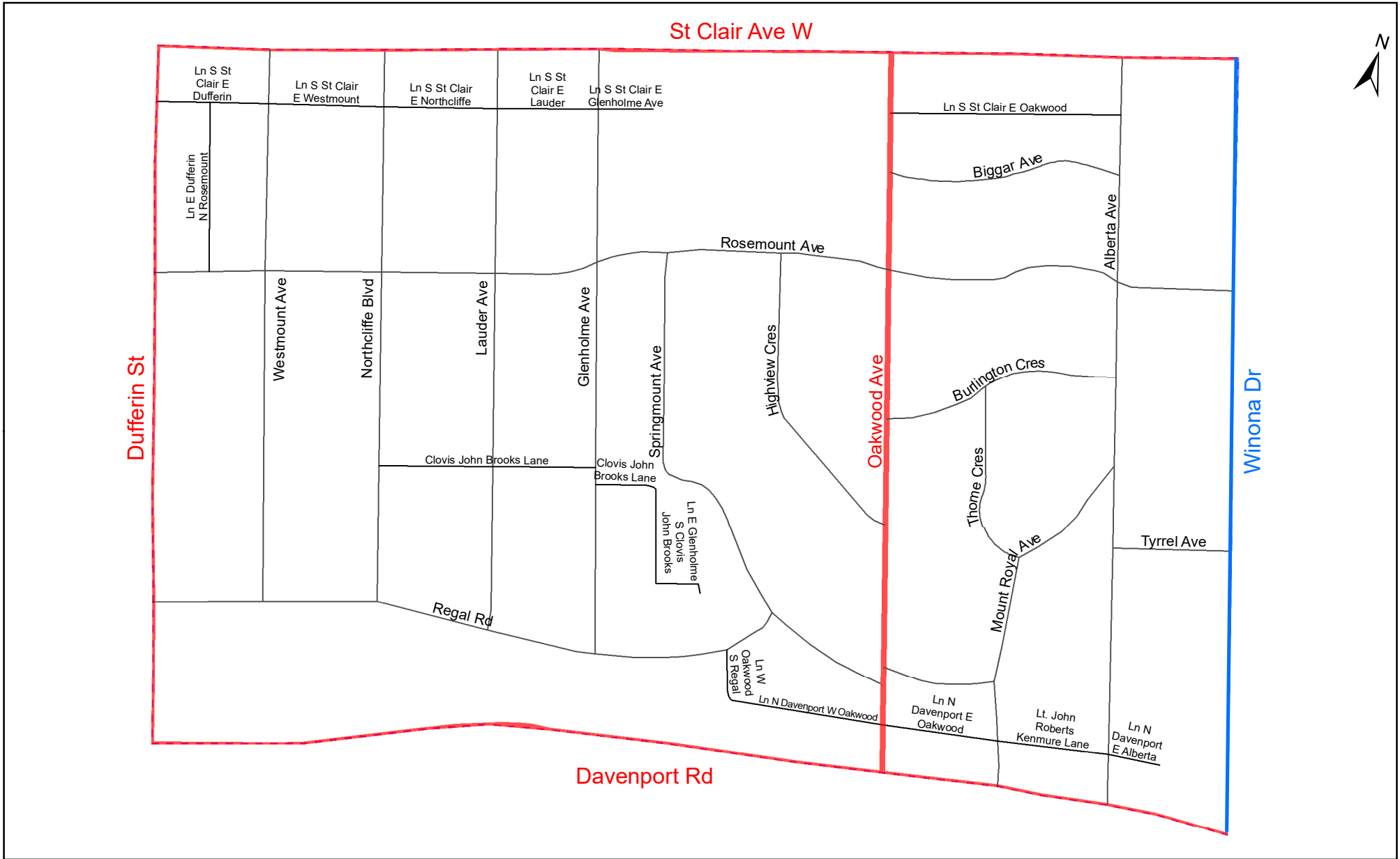

Local Road Speed Limit Reduction (Area 8) in Ward 9



- Legend**
- Expressway
 - Major Arterial; Minor Arterial
 - Collector
 - Local ; Laneway
 - Pending

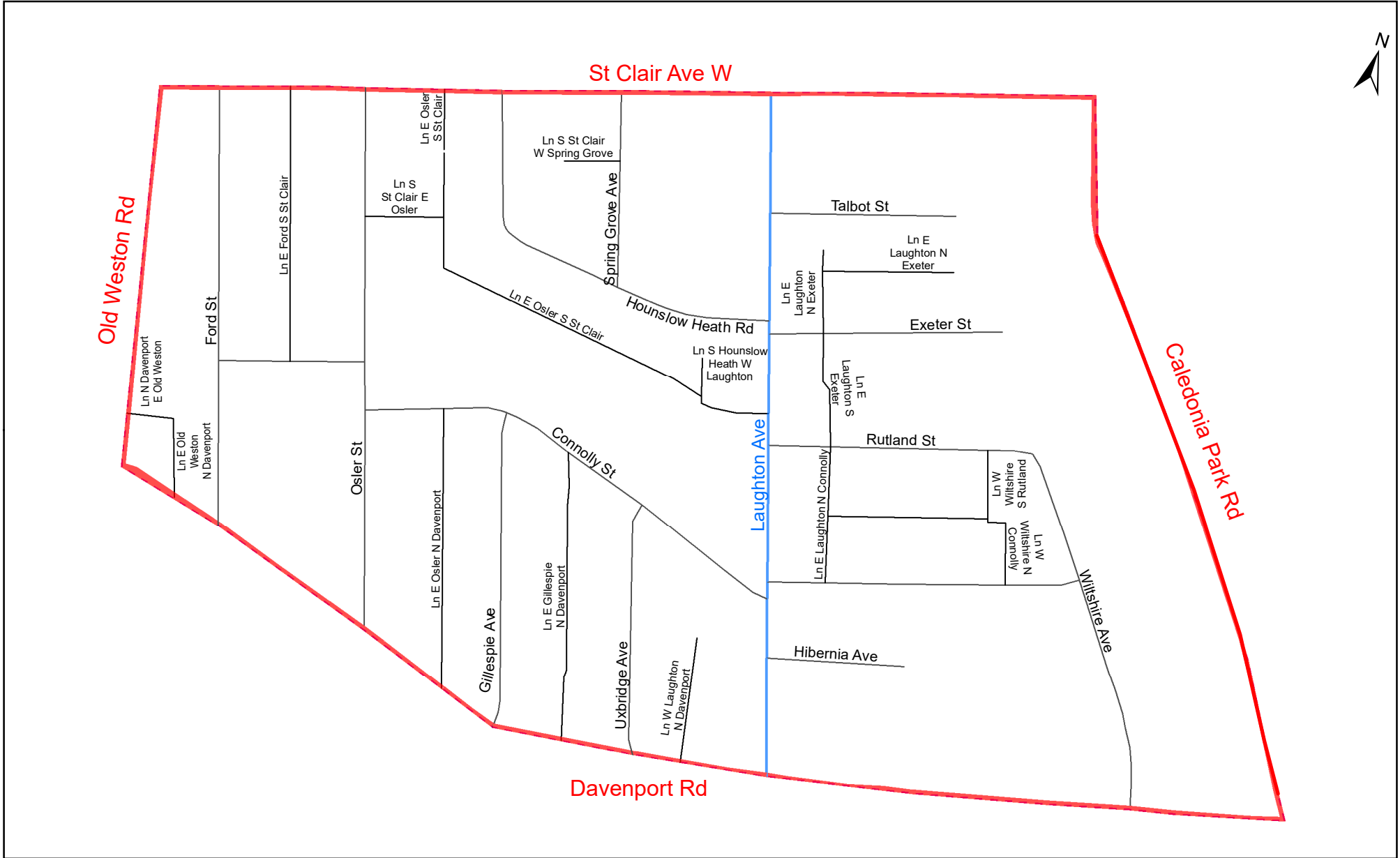

Local Road Speed Limit Reduction (Area 9) in Ward 9

- Legend**
- Major Arterial; Minor Arterial
 - Collector
 - Expressway
 - Local ; Laneway
 - Pending

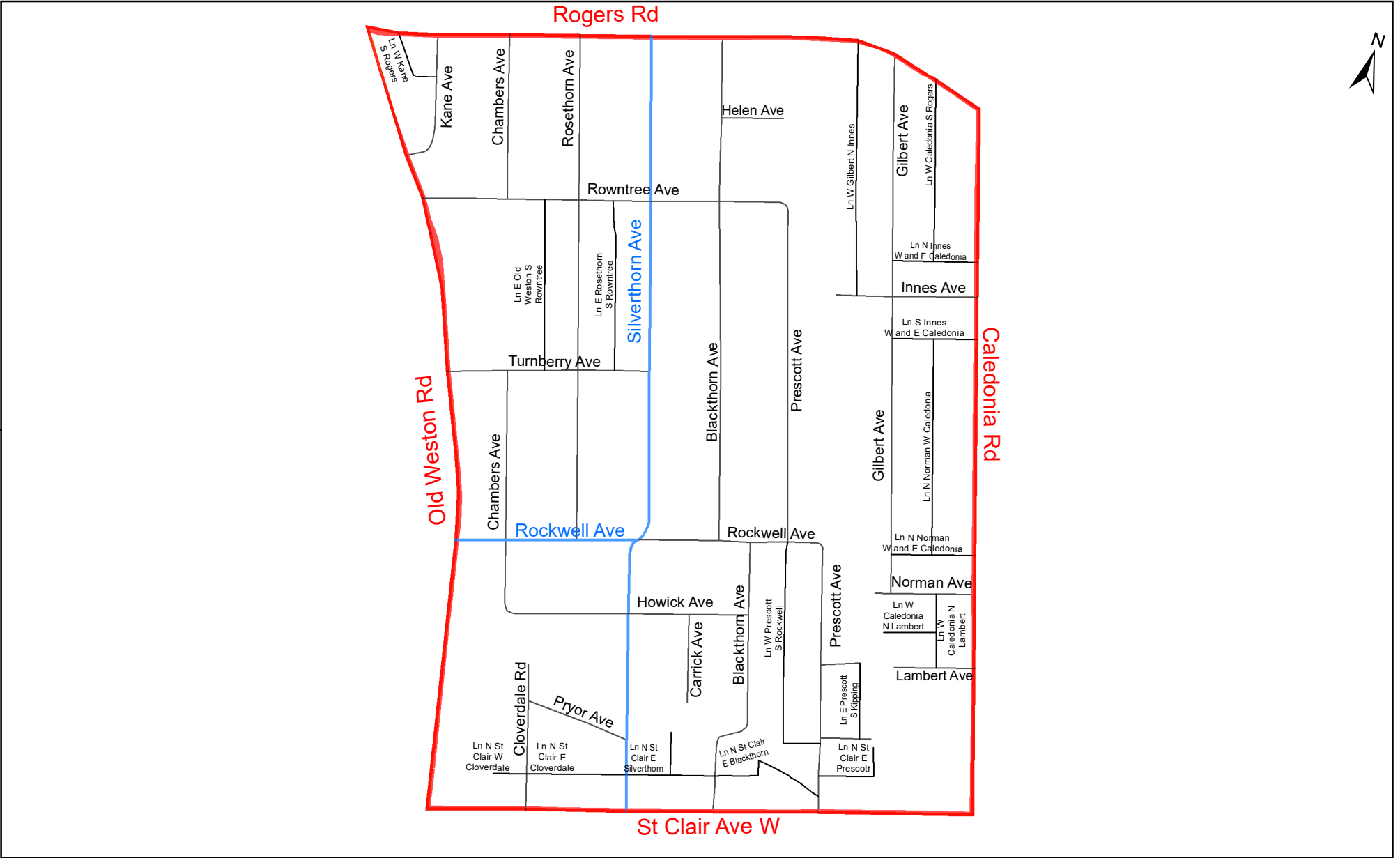

Local Road Speed Limit Reduction (Area 10) in Ward 9 Legend





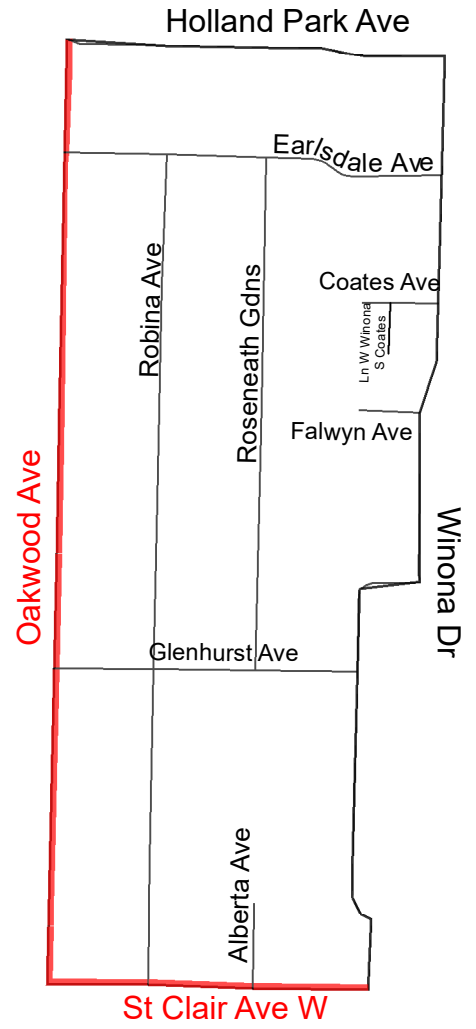

- Expressway
- Major Arterial; Minor Arterial
- Collector
- Local ; Laneway
- Pending



Local Road Speed Limit Reduction (Area 11) in Ward 9 Legend





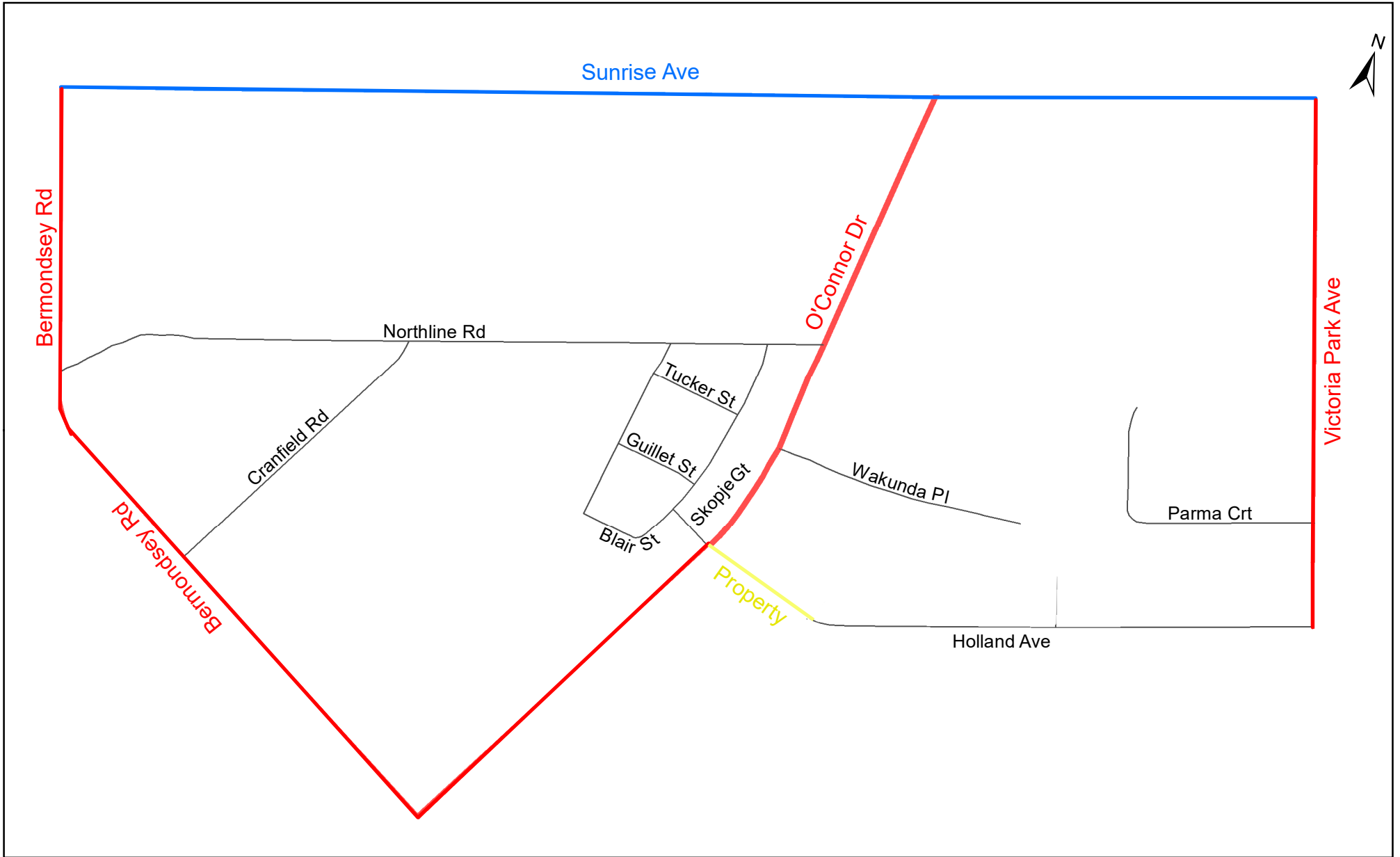



-  Expressway
-  Major Arterial; Minor Arterial
-  Collector
-  Local ; Laneway
-  Pending



Local Road Speed Limit Reduction (Area 1) in Ward 19



	Expressway		Collector		Property
	Major Arterial; Minor Arterial		Local ; Laneway		Pending

3. Rescind the following from Schedule XXXV in § 950-1334 as follows:

Highway	Between	Speed Limit (km/h)	Action
Althea Road	Varsity Road and Skylark Road	30	Rescind
Ardagh Street	Runnymede Road and Jane Street	40	Rescind
Armadale Avenue	Bloor Street West and Colbeck Street	30	Rescind
Armadale Avenue	Colbeck Street and Annette Street	40	Rescind
Aziel Street	Humberside Avenue and Annette Street	40	Rescind
Beresford Avenue	A point 36 metres north of Annette Street (east intersection) and Dundas Street West	40	Rescind
Beresford Avenue	Bloor Street West and Ardagh Street	40	Rescind
Beresford Avenue	MacGregor Avenue and a point approximately 36 metres north of Annette Street	40	Rescind
Beresford Avenue	Morningside Avenue and Bloor Street West	40	Rescind
Bradley Avenue	Watson Avenue and Jane Street	30	Rescind
Bralorne Crescent	Crosby Avenue and Varsity Road	40	Rescind
Bridgeview Road	Humberview Road and Langmuir Crescent	40	Rescind
Brookside Avenue	St. Mark's Road and Dundas Street West	40	Rescind
Clendenan Avenue	Annette Street and Dundas Street West	30	Rescind
Coe Hill Drive	The Queensway and Windermere Avenue	40	Rescind
Colbeck Street	Jane Street and Kennedy Avenue	40	Rescind
Dacre Crescent	Ellis Park Road and the northwest end of Dacre Crescent	40	Rescind
Deforest Road	Runnymede Road and the east end of Deforest Road	40	Rescind
Deforest Road	Windermere Avenue and Runnymede Road	40	Rescind
Doran Avenue	Varsity Road and Althea Road	30	Rescind
Durie Street	Bloor Street West and Colbeck Street	30	Rescind
Durie Street	Colbeck Street and a point approximately 36.2 metres north of Annette Street	40	Rescind
Durie Street	Morningside Avenue and Bloor Street West	40	Rescind
Ellis Park Road	Dacre Crescent and Wendigo Way	30	Rescind
Ellis Park Road	Ellis Avenue/Morningside Avenue and Dacre Crescent	40	Rescind
Ellis Park Road	Wendigo Way and Bloor Street West	40	Rescind
Evelyn Avenue	Annette Street and St. John's Road	40	Rescind
Evelyn Avenue	Glenlake Avenue and Woodside Avenue	40	Rescind
Evelyn Avenue	Woodside Avenue and Annette Street	30	Rescind
Evelyn Crescent	Kennedy Avenue and Glendonwynne Road	40	Rescind
Fairview Avenue	Annette Street and St. John's Road	40	Rescind
Fairview Avenue	Evelyn Crescent and Woodside Avenue	40	Rescind
Fairview Avenue	Woodside Avenue and Annette Street	40	Rescind
Folkes Street	Jane Street and a point 38.3 metres west	40	Rescind
Folkes Street	Rivercrest Road and a point 38.3 metres west of Jane Street	40	Rescind
Gilmour Avenue	Annette Street and Dundas Street	30	Rescind
Gilmour Avenue	Annette Street and Dundas Street West	30	Rescind
Gilmour Avenue	Woodside Avenue and Annette Street	40	Rescind
Glendonwynne Road	Bloor Street West and Norma Crescent	40	Rescind
Glendonwynne Road	Kennedy Park Road and Quebec Avenue	40	Rescind
Glenlake Avenue	Glendonwynne Road and Keele Street	30	Rescind
Glenlake Avenue	Kennedy Avenue and Glendonwynne Road	40	Rescind
Glenwood Avenue	Kennedy Avenue and Fairview Avenue	40	Rescind
Gooch Avenue	Underwood Avenue and Dundas Street West	40	Rescind
Gothic Avenue	Quebec Avenue (north intersection) and Quebec Avenue (south intersection)	40	Rescind
Grassmere Road	Willard Avenue and Windermere Avenue	40	Rescind
Grenadier Heights	Ellis Avenue (south intersection) and Ellis Avenue (north intersection)	40	Rescind
Halford Avenue	Old Mill Drive and Humberview Road	30	Rescind
Hanley Street	Jane Street and Willard Avenue	40	Rescind
Harcroft Road	Bloor Street West and Olympus Avenue	40	Rescind
High Park Avenue	Dundas Street West and Annette Street	40	Rescind
Hillsview Avenue	Keele Street and Medland Crescent	40	Rescind
Humber Trail	Folkes Street and Humberview Road	40	Rescind
Humbercrest Boulevard	Humberview Road and Baby Point Road	30	Rescind
Humbercrest Boulevard	St. John's Road and Dundas Street West	30	Rescind
Humbercrest Boulevard	St. Mark's Road and St. John's Road	40	Rescind
Humberside Avenue	Keele Street and Quebec Avenue	40	Rescind
Humberview Road	Langmuir Crescent and a point 38.4 metres west of Jane Street	40	Rescind
Idyllwood Crescent	Evelyn Avenue and Clendenan Avenue	40	Rescind
Innisfree Court	Worthington Crescent and the southeast end of Innisfree Court	40	Rescind
Jennings Avenue	The west end of Jennings Avenue and Clendenan Avenue	30	Rescind
Jillson Avenue	Willard Avenue and Windermere Avenue	40	Rescind
Kennedy Avenue	A point 91.4 metres south of Colbeck Street and Glenwood Avenue	30	Rescind
Kennedy Avenue	Morningside Avenue and Bloor Street West	30	Rescind

Highway	Between	Speed Limit (km/h)	Action
Kennedy Park Road	Glendonwynne Road and Bloor Street West	40	Rescind
Langmuir Crescent	Humberview Road and Humbercrest Boulevard	40	Rescind
Larkin Avenue	South Kingsway and Armdale Avenue	30	Rescind
Lavinia Avenue	Waller Avenue and Deforest Road	40	Rescind
Laws Street	Annette Street and St. John's Road	40	Rescind
Lincoln Avenue	Beresford Avenue and Runnymede Road	40	Rescind
Lincoln Avenue	Runnymede Road and Gilmour Avenue	40	Rescind
Magwood Court	Varsity Road and Gooch Avenue	40	Rescind
Maher Avenue	Runnymede Road and Gilmour Avenue	40	Rescind
Margdon Road	Glendonwynne Road and Kennedy Park Road	40	Rescind
Maria Street	Runnymede Road and Clendenan Avenue	30	Rescind
Mavety Street	Dundas Street West and Annette Street	40	Rescind
Mavety Street	Hillsview Avenue and Annette Street	40	Rescind
Medland Crescent	Oakmount Road and Humber Side Avenue	40	Rescind
Medland Street	Oakmount Road and Dundas Street West	40	Rescind
Mountview Avenue	Bloor Street West and Glenlake Avenue	40	Rescind
Nelles Avenue	Jane Street and Armadale	40	Rescind
Oakmount Road	Bloor Street West and Pacific Avenue	40	Rescind
Old Dundas Street	Dundas Street West and the east end of Old Dundas Street	40	Rescind
Old Mill Drive	A point 89.7 metres north of Bloor Street West and Riverside Drive	30	Rescind
Old Mill Drive	Bloor Street West and a point 89.9 metres northwest of Bloor Street West	40	Rescind
Old Mill Drive	Riverside Drive and Humberview Road	40	Rescind
Olympus Avenue	Ellis Park Road and the west end of Olympus Avenue	40	Rescind
Orchard Crest Road	Humberview Road and Langmuir Crescent	40	Rescind
Ormskirk Avenue	South Kingsway and Southport Street	40	Rescind
Pacific Avenue	Bloor Street West and Dundas Street West	40	Rescind
Pacific Avenue	Dundas Street West and Vine Avenue	30	Rescind
Palisades	Valleymede Road and Ellis Park Road	40	Rescind
Pasadena Gardens	Varsity Road and the south end of Pasadena Gardens	40	Rescind
Pine Crest Road	Glenlake Avenue and Quebec Avenue	40	Rescind
Priscilla Avenue	Hanley Street and Dundas Street West	30	Rescind
Quebec Avenue	Annette Street and Dundas Street West	30	Rescind
Quebec Avenue	Bloor Street West and Glenlake Avenue	40	Rescind
Quebec Avenue	Dundas Street West and the north end of Quebec Avenue	40	Rescind
Quebec Avenue	Glenlake Avenue and Annette Street	40	Rescind
Rambert Crescent	Morningside Avenue and Windermere Avenue	40	Rescind
Rennie Terrace	Waller Avenue and Morningside Avenue	40	Rescind
Rexford Road	Willard Avenue and Windermere Avenue	30	Rescind
Rivercrest Road	Humberview Road and a point 38.3 metres west of Jane Street	40	Rescind
Riverside Drive	Bloor Street West (west intersection) and Old Mill Drive	40	Rescind
Riverside Drive	Bloor Street West and South Kingsway	30	Rescind
Riverview Gardens	A point 51.3 metres north of Bloor Street West and Halford Avenue (east intersection)	30	Rescind
Riverview Gardens	Bloor Street West and Halford Avenue	30	Rescind
Riverview Gardens	Halford Avenue and a point 314.6 metres south of Halford Avenue	40	Rescind
Skylark Road	Van Stassen Boulevard and Gooch Avenue	40	Rescind
Southport Street	Ormskirk Avenue and The Queensway	40	Rescind
Traymore Crescent	A point 24.1 metres north of Bloor Street West and Riverside Drive	40	Rescind
Traymore Crescent	Bloor Street West and a point 49.1 metres north of Bloor Street West	40	Rescind
Underwood Avenue	Varsity Road and Gooch Avenue	40	Rescind
Valleymede Road	Ellis Park Road and a point 126.46 metres west of Ellis Park Road	40	Rescind
Vernon Street	Runnymede Road and Gilmour Avenue	40	Rescind
Vine Avenue	McMurray Avenue and Keele Street	30	Rescind
Waller Avenue	Rennie Terrace and Windermere Avenue	40	Rescind
Warren Crescent	Varsity Road and Crosby Avenue	40	Rescind
Watson Avenue	St. Mark's Road and Dundas Street West	40	Rescind
Weatherell Street	Jane Street (south intersection) and Armadale Avenue	30	Rescind
Weatherell Street	Jane Street and a point 38.9 metres west of Jane Street	40	Rescind
Weatherell Street	Rivercrest Road and a point 38.91 metres west of Jane Street	40	Rescind
Webb Avenue	Runnymede Road and Gilmour Avenue	40	Rescind
Westholme Avenue	Annette Street and Maher Avenue	40	Rescind
Willard Avenue	A point 61 metres north of Annette Street and Dundas Street West	30	Rescind
Willard Avenue	Mayfield Avenue and a point approximately 42.6 metres north of Annette Street	40	Rescind
Windermere Avenue	A point 61 metres north of Annette Street and Dundas Street West	30	Rescind
Windermere Avenue	Bloor Street West and Annette Street	30	Rescind

Highway	Between	Speed Limit (km/h)	Action
Woodside Avenue	Fairview Avenue and Evelyn Avenue	40	Rescind
Woodside Avenue	Runnymede Road and Fairview Avenue	40	Rescind
Worthington Crescent	South Kingsway (northwest intersection) and South Kingsway (southeast intersection)	40	Rescind
Adrian Avenue	Symington Avenue and Wiltshire Avenue	40	Rescind
Alberta Avenue	Davenport Road and St. Clair Avenue West	40	Rescind
Appleton Avenue	A point 58 metres north of St. Clair Avenue West and Glenhurst Avenue	30	Rescind
Ascot Avenue	Boon Avenue and Harvie Avenue	40	Rescind
Ascot Avenue	Dufferin Street and Boon Avenue	40	Rescind
Bartlett Avenue North	Dupont Street and Geary Avenue	30	Rescind
Bartlett Avenue North	Geary Avenue and Davenport Road	30	Rescind
Beaver Avenue	Dufferin Street and the west end of Beaver Avenue	40	Rescind
Beaver Terrace	Beaver Avenue and the north end of Beaver Terrace	40	Rescind
Biggar Avenue	Oakwood Avenue and Alberta Avenue	40	Rescind
Blackthorn Avenue	A point 38.1 metres north of Rowntree Avenue and Rogers Road	30	Rescind
Blackthorn Avenue	A point 60.1 metres south of Helen Avenue and Rogers Road	40	Rescind
Blackthorn Avenue	St. Clair Avenue West and a point 38.1 metres north of Rowntree Avenue	30	Rescind
Bloem Avenue	The west end of Bloem Avenue and Dufferin Street	40	Rescind
Boon Avenue	Morrison Avenue and a point 29.4 metres north of Morrison Avenue	40	Rescind
Boon Avenue	Rogers Road and Eversfield Road	40	Rescind
Boon Avenue	St. Clair Avenue West and a point 29.4 metres north of Morrison Avenue	30	Rescind
Boon Avenue	St. Clair Avenue West and Morrison Avenue	30	Rescind
Brandon Avenue	Dufferin Street and Lansdowne Avenue	40	Rescind
Branstone Road	Ennerdale Road (south intersection) and Ennerdale Road (north intersection)	40	Rescind
Bristol Avenue	Geary Avenue and Davenport Road	30	Rescind
Burlington Crescent	Oakwood Avenue and Alberta Avenue	40	Rescind
Carrick Avenue	The south end of Carrick Avenue and Howick Avenue	40	Rescind
Carrington Avenue	Harvie Avenue and Nairn Avenue	40	Rescind
Chambers Avenue	Howick Avenue and Rockwell Avenue	40	Rescind
Chambers Avenue	Rockwell Avenue and Turnberry Avenue	40	Rescind
Chandos Avenue	Dufferin Street and the west end of Chandos Avenue	40	Rescind
Chudleigh Road	Harvie Avenue and Ennerdale Road	40	Rescind
Cloverdale Road	St. Clair Avenue West and the north end of Cloverdale Road	40	Rescind
Connolly Street	Osler Street (south intersection) and Laughton Avenue	40	Rescind
Cranfield Road	Bermondset Road and Northline Road	30	Rescind
Crang Avenue	A point 55 metres north of St. Clair Avenue West and Glenhurst Avenue	30	Rescind
Day Avenue	Goodwood Avenue and a point 29 metres north of Morrison Avenue	40	Rescind
Day Avenue	Rogers Road and Bloem Avenue	40	Rescind
Delaware Avenue North	Geary Avenue and Davenport Road	40	Rescind
Dynevor Road	Ennerdale Road and Eglinton Avenue West	40	Rescind
Earlscourt Avenue	Ascot Avenue and a point 29.8 metres north of Morrison Avenue	30	Rescind
Earlscourt Avenue	Morrison Avenue and a point 29.8 metres north of Morrison Avenue	40	Rescind
Earlscourt Avenue	Rogers Road and Hatherley Road	40	Rescind
Earlscourt Avenue	St. Clair Avenue West and Morrison Avenue	30	Rescind
Earlsdale Avenue	Glenholme Avenue and Oakwood Avenue	40	Rescind
Earncliffe Road	Glenholme Avenue and Oakwood Avenue	40	Rescind
Ennerdale Road	Hatherley Road and Eglinton Avenue West	40	Rescind
Eversfield Road	Earlscourt Avenue and Dufferin Street	40	Rescind
Ford Street	St. Clair Avenue West and Davenport Road	40	Rescind
Geary Avenue	Dufferin Street and the west end of Geary Avenue	40	Rescind
Geary Avenue	Ossington Avenue and Dovercourt Road	40	Rescind
Gilbert Avenue	A point 173.3 metres south of Rogers Road and Summit Avenue	30	Rescind
Gilbert Avenue	Kitchener Avenue and Eglinton Avenue West	40	Rescind
Gilbert Avenue	Norman Avenue and a point 124.8 metres north of Innes Avenue	40	Rescind
Gilbert Avenue	Rogers Road and Summit Avenue	30	Rescind
Glenholme Avenue	Regal Road and St. Clair Avenue West	40	Rescind
Glenholme Avenue	St. Clair Avenue West and Vaughan Road	30	Rescind
Goodwood Avenue	Dufferin Street and Boon Avenue	40	Rescind
Greenlaw Avenue	Davenport Road and St. Clair Avenue West	40	Rescind
Guillet Street	Blair Street (west branch) and Blair Street (east branch)	30	Rescind
Harlow Avenue	Ennerdale Road and Kirknewton Road	40	Rescind
Harvie Avenue	Hatherley Road (east intersection) and Redhill Avenue	30	Rescind
Harvie Avenue	Morrison Avenue and a point 30.4 metres north of Morrison Avenue	40	Rescind
Harvie Avenue	Redhill Avenue and Eglinton Avenue West	30	Rescind
Harvie Avenue	Rogers Road and Hatherley Road (west intersection)	30	Rescind

Highway	Between	Speed Limit (km/h)	Action
Harvie Avenue	St. Clair Avenue West and a point 30.4 metres north of Morrison Avenue	30	Rescind
Harvie Avenue	St. Clair Avenue West and Morrison Avenue	30	Rescind
Hatherley Road	The west end of Hatherley Road and Eversfield Road	40	Rescind
Highview Crescent	Rosemount Avenue and Oakwood Avenue	40	Rescind
Holland Park Avenue	Oakwood Avenue and Winona Drive	40	Rescind
Holmesdale Crescent	Ennerdale Road and Holmesdale Road	40	Rescind
Holmesdale Road	Ennerdale Road and Dufferin Street	40	Rescind
Hope Street	Dufferin Street and Harvie Avenue	40	Rescind
Hounslow Heath Road	Laughton Avenue and St. Clair Avenue West	30	Rescind
Howick Avenue	Chambers Avenue and Blackthorn Avenue	40	Rescind
Hunter Avenue	Kirknewton Road and Dufferin Street	40	Rescind
Innes Avenue	McRoberts Avenue and the west end of Innes Avenue	40	Rescind
Kingsley Avenue	Laughton Avenue and Symington Avenue	40	Rescind
Kirknewton Road	Dynevor Road and Eglinton Avenue West	40	Rescind
Kitchener Avenue	McRoberts Avenue and Nairn Avenue	40	Rescind
Lambert Avenue	Caledonia Road and the west end of Lambert Avenue	40	Rescind
Lauder Avenue	A point 60.4 metres north of St. Clair Avenue West and Millerson Avenue	30	Rescind
Lauder Avenue	Regal Road and St. Clair Avenue West	40	Rescind
Laughton Avenue	Davenport Road and Pelham Avenue	40	Rescind
Lightbourn Avenue	Geary Avenue and Davenport Road	40	Rescind
Lindner Street	Osler Street and the west end of Lindner Street	40	Rescind
McRoberts Avenue	A point 76.3 metres south of Rogers Road and Corby Avenue	30	Rescind
McRoberts Avenue	Corby Avenue and a point 201 metres north	40	Rescind
McRoberts Avenue	Rogers Road and Corby Avenue	30	Rescind
McRoberts Avenue	St. Clair Avenue West and Rogers Road	30	Rescind
Miller Street	Davenport Road and the south end of Miller Street	40	Rescind
Mount Royal Avenue	Davenport Road and Alberta Avenue	40	Rescind
Nairn Avenue	Rochdale Avenue and Eglinton Avenue West	40	Rescind
Nairn Avenue	Rogers Road and Hatherley Road	40	Rescind
Nairn Avenue	St. Clair Avenue West and a point 30 metres north of Morrison Avenue	30	Rescind
Norman Avenue	McRoberts Avenue and the west end of Norman Avenue	40	Rescind
Northcliffe Boulevard	A point 60.3 metres north of St. Clair Avenue West and Cloverlawn Avenue	30	Rescind
Northcliffe Boulevard	Cloverlawn Avenue and Rogers Road	40	Rescind
Northcliffe Boulevard	Regal Road and St. Clair Avenue West	40	Rescind
Northline Road	Bermondsey Road and O'Connor Drive	30	Rescind
Norton Avenue	St. Clair Gardens and Dufferin Street	30	Rescind
O'Leary Avenue	Glenholme Avenue and Oakwood Avenue	30	Rescind
Osler Street	St. Clair Avenue West and Davenport Road	30	Rescind
Pelham Avenue	Osler Street and Laughton Avenue	30	Rescind
Perth Avenue	Davenport Road and a point 102.2 metres south of Kingsley Avenue	40	Rescind
Peterborough Avenue	Greenlaw Avenue and Dufferin Street	30	Rescind
Prescott Avenue	St. Clair Avenue West and Rowntree Avenue	30	Rescind
Preston Road	Holmesdale Crescent and Dufferin Street	40	Rescind
Pryor Avenue	Cloverdale Road and Silverthorn Avenue	40	Rescind
Redhill Avenue	Harvie Avenue and the east end of Redhill Avenue	40	Rescind
Regal Road	Oakwood Avenue and Dufferin Street	40	Rescind
Robina Avenue	A point 54.9 metres north of St. Clair Avenue West and Earlsdale Avenue	40	Rescind
Robina Avenue	St. Clair Avenue West and a point 51 metres north	40	Rescind
Rochdale Avenue	Harvie Avenue and Ennerdale Road	40	Rescind
Rockwell Avenue	Old Weston Road and Prescott Avenue (east intersection)	40	Rescind
Rosemount Avenue	Dufferin Street and Oakwood Avenue	30	Rescind
Rosethorn Avenue	Rockwell Avenue and a point 38.6 metres north of Rowntree Avenue	40	Rescind
Rowan Avenue	Dynevor Road and Dufferin Street	40	Rescind
Rowntree Avenue	Old Weston Road and Prescott Avenue	40	Rescind
Rutland Street	Laughton Avenue and Wiltshire Avenue	30	Rescind
Salem Avenue North	Geary Avenue and Davenport Road	30	Rescind
Sellers Avenue	Goodwood Avenue and a point 28.7 metres north of Goodwood Avenue	40	Rescind
Sellers Avenue	Rogers Road and Bloem Avenue	40	Rescind
Skopje Gate	Blair Street and O'Connor Drive	30	Rescind
Somerset Avenue	Geary Avenue and Davenport Road	40	Rescind
Spring Grove Avenue	Hounslow Heath Road and St. Clair Avenue West	30	Rescind
Teignmouth Avenue	The west end of Teignmouth Avenue and Boon Avenue	40	Rescind
Thome Crescent	Burlington Crescent and Mount Royal Avenue	40	Rescind
Thornton Avenue	Harvie Avenue and Branstone Road	40	Rescind

Highway	Between	Speed Limit (km/h)	Action
Tucker Street	Blair Street (west branch) and Blair Street (east branch)	30	Rescind
Turnberry Avenue	Old Weston Road and Silverthorn Avenue	40	Rescind
Tyrrel Avenue	Alberta Avenue and Winona Drive	40	Rescind
Via Italia	St. Clair Avenue West and the south end of Via Italia	40	Rescind
Westmoreland Avenue North	Geary Avenue and Davenport Road	30	Rescind
Westmount Avenue	A point 60.3 metres north of St. Clair Avenue West and Gibson Street	30	Rescind
Westmount Avenue	Regal Road and St. Clair Avenue West	30	Rescind
Wiltshire Avenue	Davenport Road and Adrian Avenue	40	Rescind
Wiltshire Avenue	Rutland Street and Davenport Road	40	Rescind
Winona Drive	A point 54.6 metres north of St. Clair Avenue West and Glenhurst Avenue	40	Rescind
Winona Drive	Earlsdale Avenue (north intersection) and Vaughan Road	40	Rescind
Winona Drive	Glenhurst Avenue and Earlsdale Avenue (north intersection)	30	Rescind
Woodcroft Crescent	Hatherley Road and the west end of Woodcroft Crescent	40	Rescind

4. Enact the following to Schedule XXXV in § 950-1334 as follows:

Highway	Between	Speed Limit (km/h)	Action
Bartlett Avenue North	Dupont Street and Canadian Pacific Railway	30	Enact
Colbeck Street	Jane Street and Runnymede Road	40	Enact
Earlscourt Avenue	St Clair Avenue West and Hope Street	30	Enact
Glenholme Avenue	Rogers Road to Vaughn Road	30	Enact
Glenlake Avenue	High Park Avenue and Keele Street	30	Enact
Hope Street	Dufferin Street and Nairn Ave	40	Enact
Humberside Avenue	Keele Street and High Park Avenue	40	Enact
Nairn Avenue	Hope Street and a point approximately 30 metres north of Morrison Avenue	30	Enact
Old Dundas Street	Dundas Street West and Varsity Road	40	Enact
Pacific Avenue	Annette Street and Dundas Street West	40	Enact
Rockwell Avenue	Old Weston Road and Silverthorn Avenue	40	Enact
Via Italia	St Clair Avenue West and Auburn Avenue	40	Enact
Westmount Avenue	Rogers Road and Gibson St	30	Enact
Winona Drive	Holland Park Avenue and Vaughan Road	40	Enact