



# 5. THE NEW MASTER PLAN





# 5. THE NEW MASTER PLAN

## 5.1. MASTER PLAN

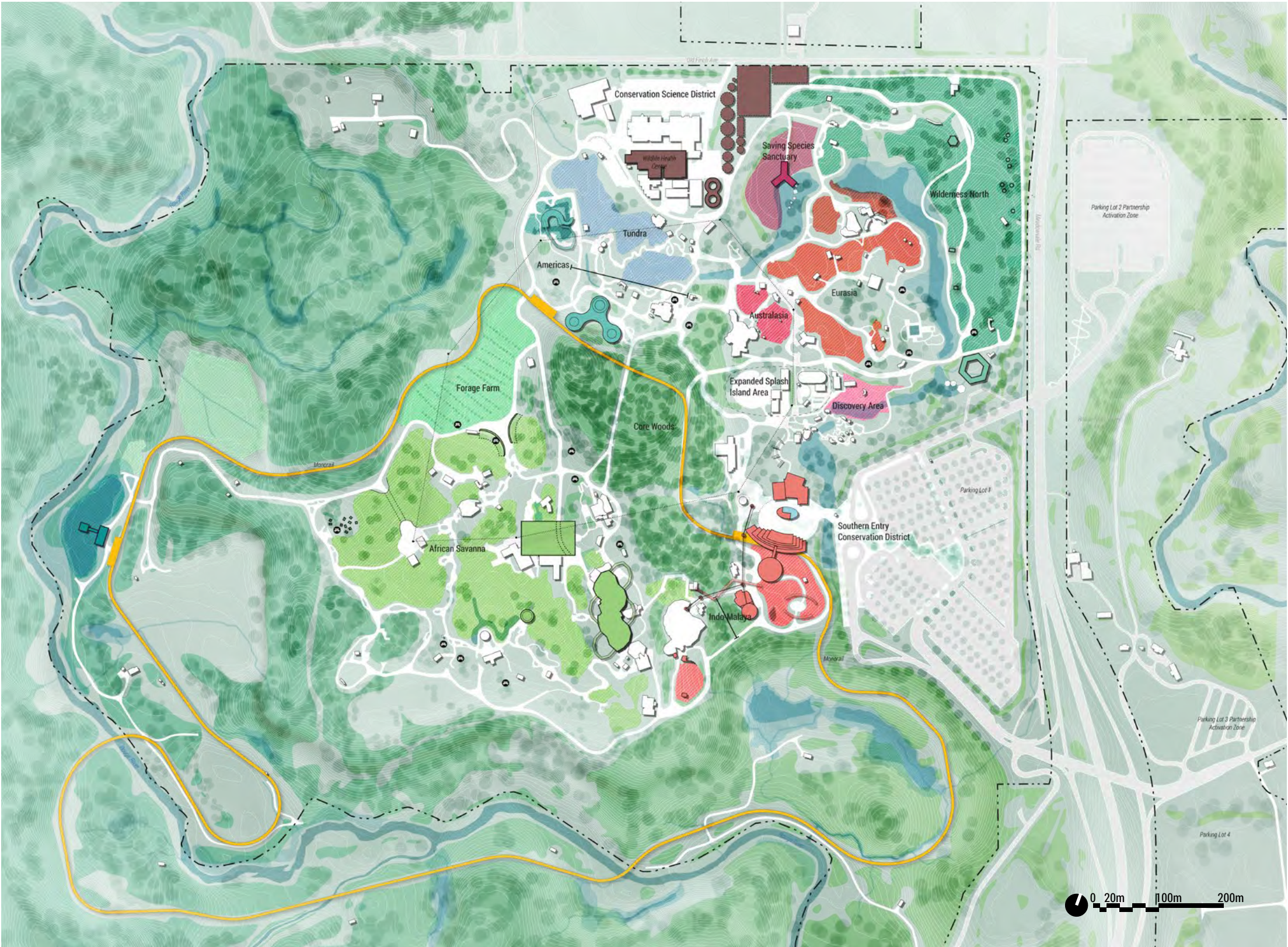

### Legend

- Conservation Science District
- Saving Species Sanctuary
- Wilderness North
- Eurasia
- Australasia
- Tundra
- Americas
- Core Woods
- Discovery Area
- Forage Farm and Demonstration Site
- African Savanna
- Indo-Malaya
- Building - New or Redeveloped
- Building - Existing
- Parking
- Site Boundary

**Note:** All project names indicated in the Master Plan are indicative of what these spaces can become, but specific names will be decided together in collaboration with project partners.



# 5. THE NEW MASTER PLAN

## 5.2. ZOOM-IN AREA 1: ARRIVAL AND CONSERVATION CAMPUS DISTRICT

The Conservation Campus creates a sense of awe even before entering Your Zoo gates. Views of animals as guests are entering the Zoo site immediately connect guests to Your Zoo’s mission, remaining with them as they re-encounter these species as they exit, building a deeper connection to Your Zoo. Developed with key partners, a theatre hall, research facilities and event space in this area can host guests and events beyond regular Zoo hours, becoming a launching place for conversations with local and global communities engaged in larger discussions about habitat, sustainable resources, and climate change mitigation by Your Zoo and academic research partners.

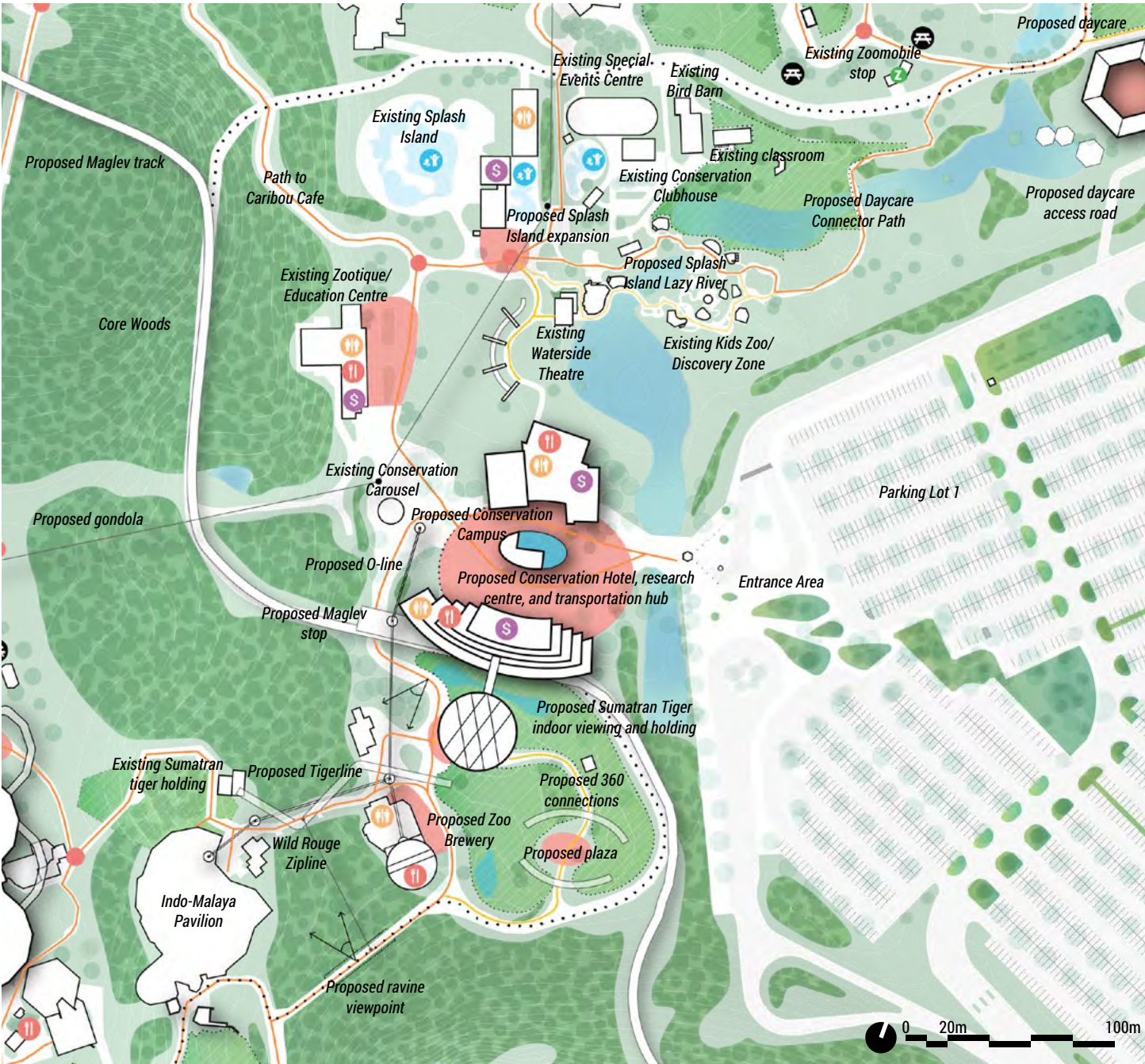
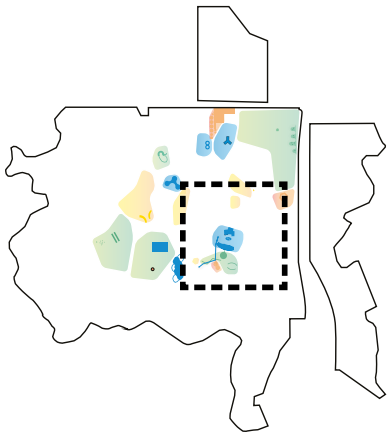

### Legend

#### Forms:

- Habitats
- Building - New or Redeveloped
- Building - Existing
- Designated gathering space
- Decision-making Points
- Stormwater Ponds
- Habitat Water Body
- Floating Wetlands
- Existing Site Topography - 1m Contours
- Site Boundary
- Fences

#### Flows:

- Main guest path
- Secondary guest paths
- Zoomobile route
- Zoomobile stops

#### Guest Amenities:

- Water Play Area
- Washrooms
- Food
- Retail
- Donor/Volunteer Recognition Area
- Picnic Area



# 5. THE NEW MASTER PLAN

## 5.2. ZOOM-IN AREA 1: ARRIVAL AND CONSERVATION CAMPUS DISTRICT

Iconic species in the Conservation Campus entry area, as well as the Kids Zoo/Discovery Zone, bring some charismatic species right near Your Zoo's entrance. Bringing playful, curious species to these areas creates an immediate connection between guests and species as they enter - and exit - Your Zoo, setting the stage for their exploration around the rest of Your Zoo as well as serving as a catalyst for their actions beyond Your Zoo's gates upon leaving.

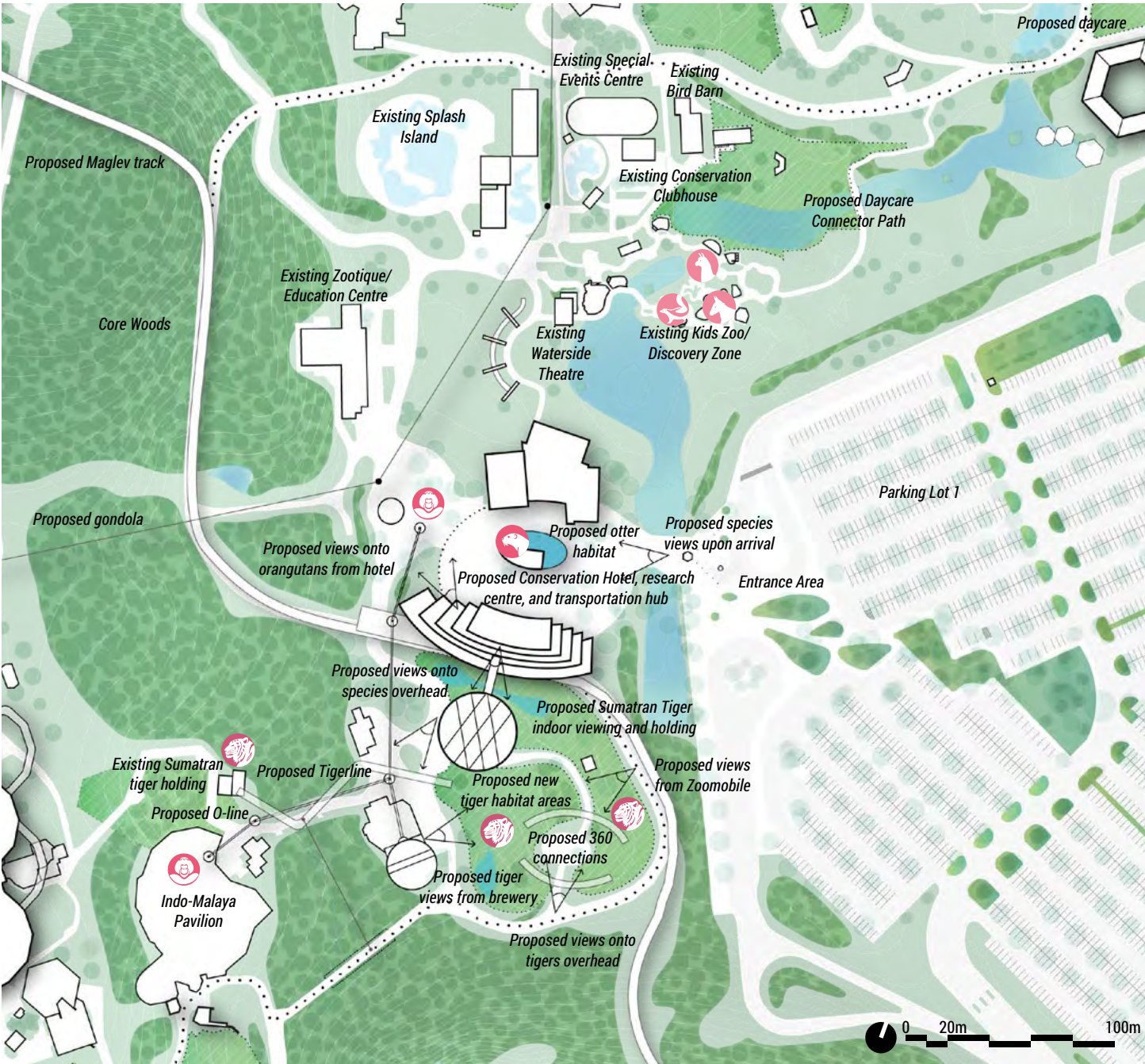

### Iconic Species in Entry Area



Sumatran Orangutan

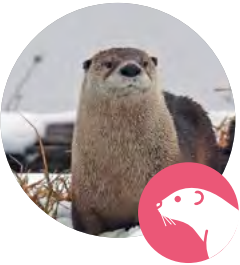

River Otter

### Iconic Species in Kids Zoo/Discovery Zone



Alpaca

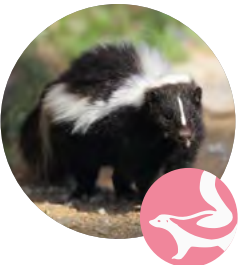

Striped Skunk



Miniature Donkey

### Iconic Species in Indo-Malaya



Sumatran Tiger



# 5. THE NEW MASTER PLAN

## 5.2. ZOOM-IN AREA 2: AFRICAN SAVANNA AND FORAGE FARM

African Savanna is a shining example of Your Zoo’s forward-looking approach to larger habitats and combined species. The focus here is on elevating these successes to be equally present in winter, with a new, large indoor viewing pavilion for the many African species in the Savanna landscape. In the African Rainforest Pavilion habitats become similarly expanded and connected through 360 tubes. Outdoors, the western Savanna habitats are expanded, with some becoming joined by a landbridge allowing species to walk overtop of guests, between habitat areas, while guests are immersed in the interpretive tunnel tucked underneath the landscape. The existing fictional "Kesho-Park" becomes rebranded to partner with a real, existing conservancy in Kenya, to directly support in-situ conservation, and the Forage Farm site further highlights Your Zoo’s commitment to sustainability.

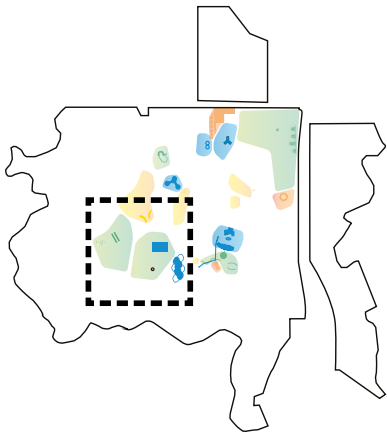

### Legend

#### Forms:

- Habitats
- Building - New or Redeveloped
- Building - Existing
- Designated gathering space
- Decision-making Points
- Habitat Water Body
- Existing Site Topography - 1m Contours
- Site Boundary
- Fences

#### Flows:

- Main guest path
- Secondary guest paths
- Zoomobile route
- Zoomobile stops

#### Guest Amenities:

- Washrooms
- Food
- Retail
- Donor/Volunteer Recognition Area
- Picnic Area



# 5. THE NEW MASTER PLAN

## 5.2. ZOOM-IN AREA 2: AFRICAN SAVANNA

Iconic species in the outdoor African Savanna and Safari Meander habitats focus on larger, charismatic species celebrated by the large landscapes that they occupy here. Focal species in the African Rainforest Pavilion vary in size, speed of movement, as well as the spaces that they occupy within the pavilion, being it submerged in pools of water, perched on lower outcrops or in lush plantings, or climbing high in the canopy for better views. By combining these species strategically within the pavilion, the existing expansive vertical spaces within the building can be used to their full potential, and eye-to-eye experiences can be created close to the ground as well as up in the canopy, as both guests and species move through these different levels throughout the pavilion.

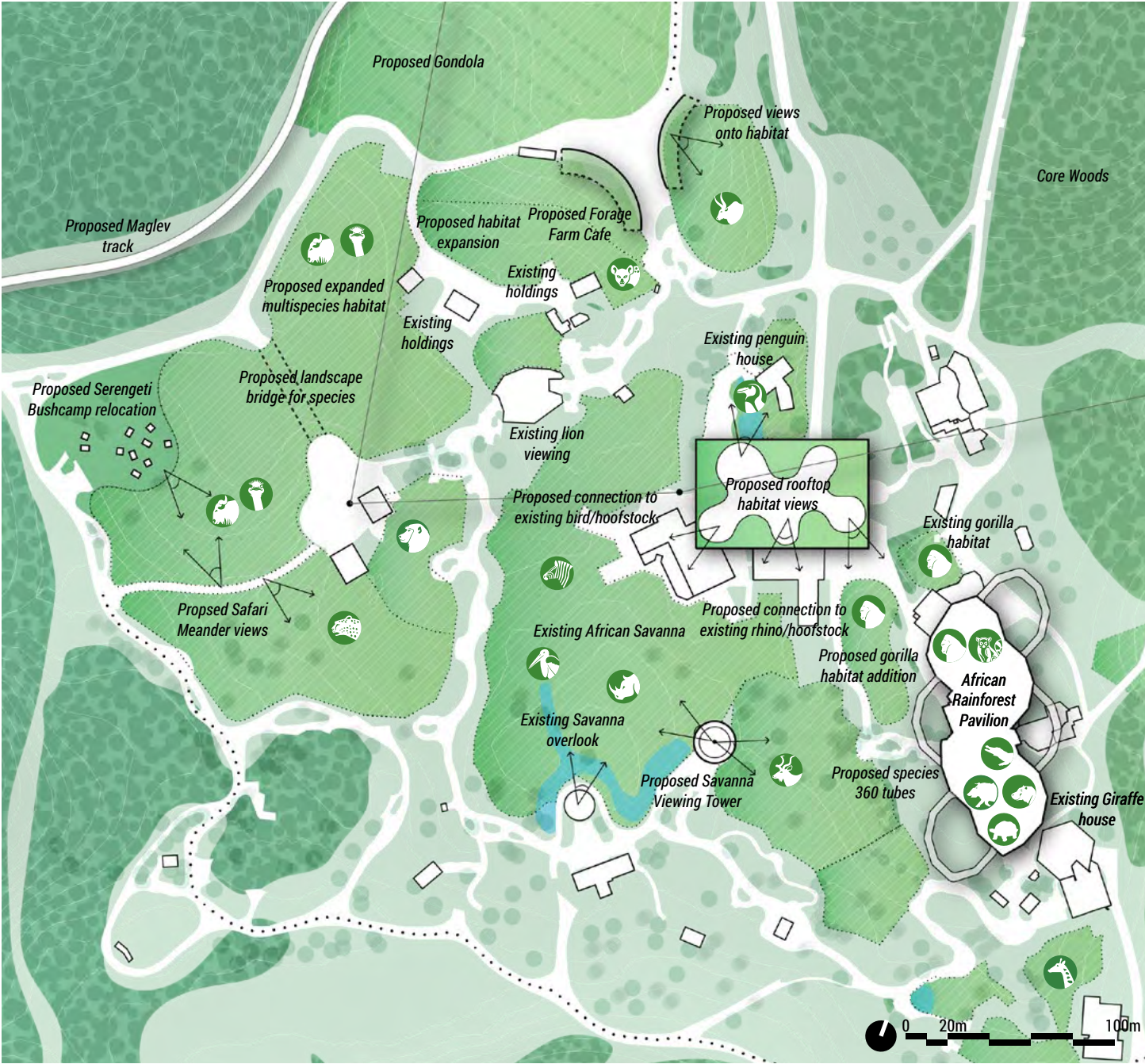

### Iconic Species in African Savanna and Safari Meander



White Rhinoceros



Cheetah



Masai Giraffe



Grevy's Zebra

### Iconic Species in African Rainforest Pavilion



Western Lowland Gorilla



Red River Hog



West African Dwarf Crocodile



Ring Tailed Lemur



Pygmy Hippopotamus



Aldabra Tortoise



# 5. THE NEW MASTER PLAN

## 5.2. ZOOM-IN AREA 3: WILDERNESS NORTH

Focus of redevelopment in this area is on bringing Canadian species into a more accesible part of Your Zoo to be celebrated, and to showcase Your Zoo's mission. A cultural layer is also added to this narrative, with a Cultural Pavilion and artwalk embedded in this space. Creation of the Saving Species Sanctuary further forefronts Your Zoo's focus on connecting people with the plight of species at risk in Canada as well as those in peril around the globe. Addition of an air-conditioned viewing building to see red pandas in summer creates more comfortable and inviting experiences for guests throughout the year.

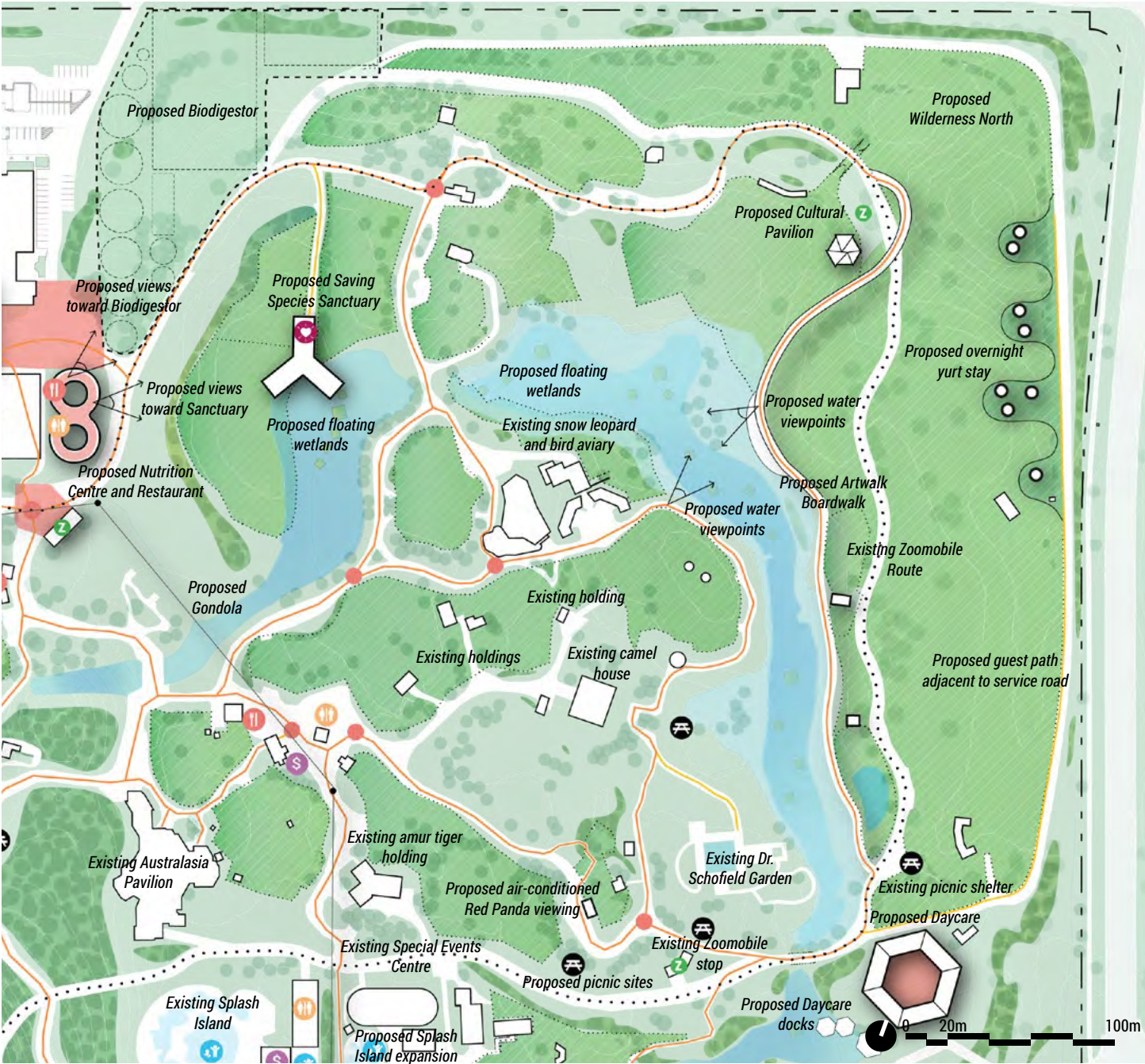
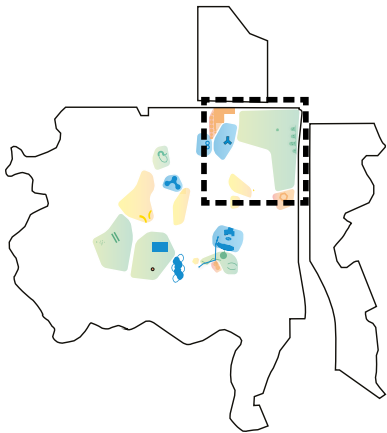

### Legend

#### Forms:

- Habitats
- Building - New or Redeveloped
- Building - Existing
- Designated gathering space
- Decision-making Points
- Stormwater Ponds
- Habitat Water Body
- Floating Wetlands
- Existing Site Topography - 1m Contours
- Site Boundary
- Fences

#### Flows:

- Main guest path
- Secondary guest paths
- Zoomobile route
- Zoomobile stops

#### Guest Amenities:

- Water Play Area
- Washrooms
- Food
- Retail
- Donor/Volunteer Recognition Area
- Picnic Area



# 5. THE NEW MASTER PLAN

## 5.2. ZOOM-IN AREA 3: WILDERNESS NORTH

Iconic species in this area showcase Your Zoo’s continued and strengthened commitment to preserving species globally, while specifically bringing to the forefront the incredible work that is being done on species right in our collective Canadian backyard. While species in the Saving Species Sanctuary will not call this home longer-term, the work of the Sanctuary highlights the trafficking of exotic species globally, as well as more local threats to injured, orphaned and confiscated species.

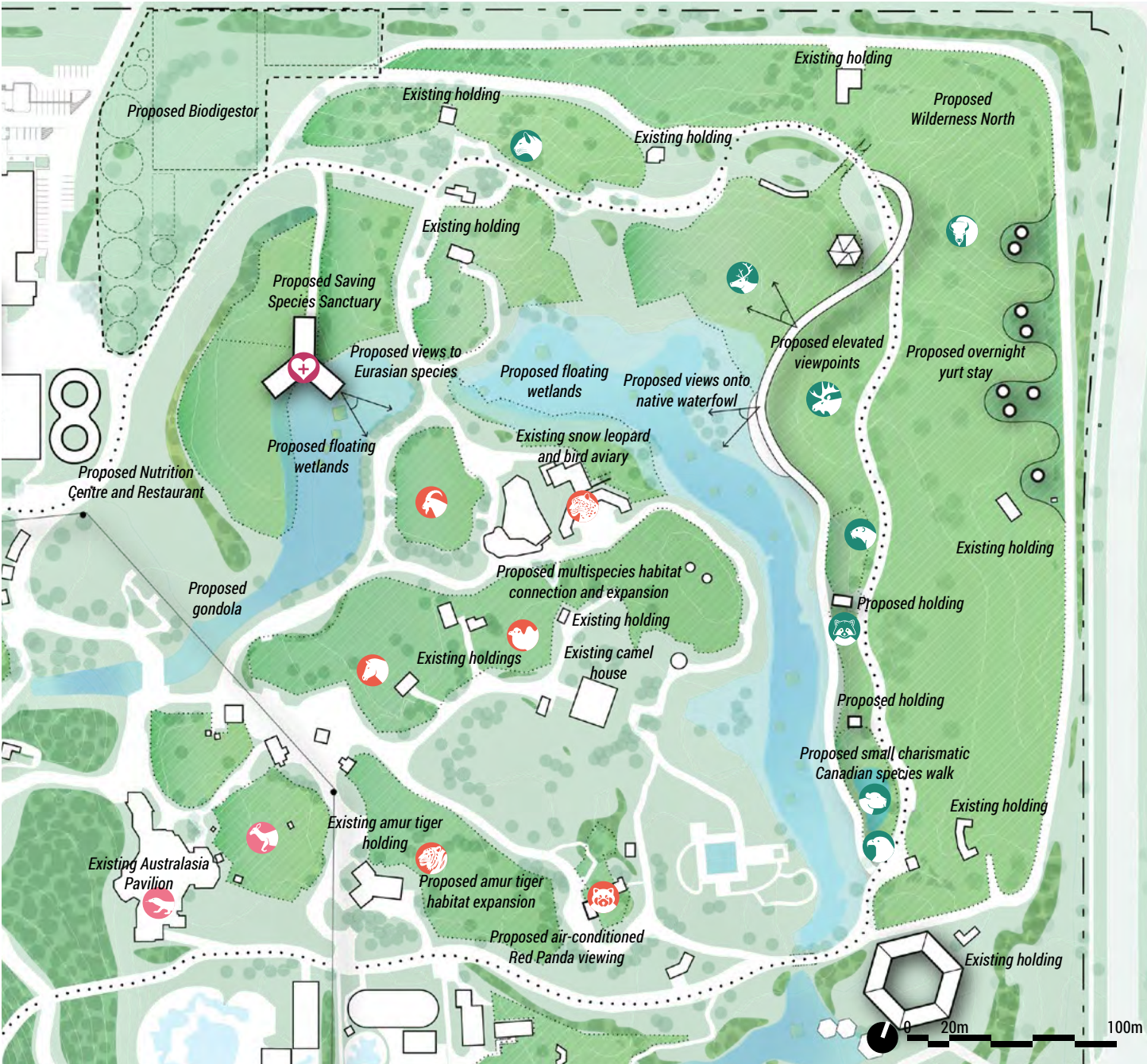

### Iconic Species in Wilderness North



Wood Bison



Porcupine Caribou



Cougar

### Iconic Species in Eurasia



Amur Tiger



Red Panda



Snow Leopard



Bactrian Camel



Asian Wild Horse

### Iconic Species in Australasia



Komodo Dragon



Western Grey Kangaroo



# 5. THE NEW MASTER PLAN

## 5.2. ZOOM-IN AREA 4: CONSERVATION SCIENCE DISTRICT

This area becomes transformed from back-of-house to an area that highlights the science, research, sustainability, and conservation work that are at the heart of Your Zoo’s mission. This area becomes an active hub, and a location for congregating and spending more time on the Zoo site, be it during regular hours or for an evening outing, with many different programs offered here. The programs here work synergistically to showcase Your Zoo’s work on site to continually improve welfare, as well as through research in the field, while also demonstrating the commitment to sustainability on site and as part of the greater push to be a conservation and sustainability leader and role model in the Toronto community.

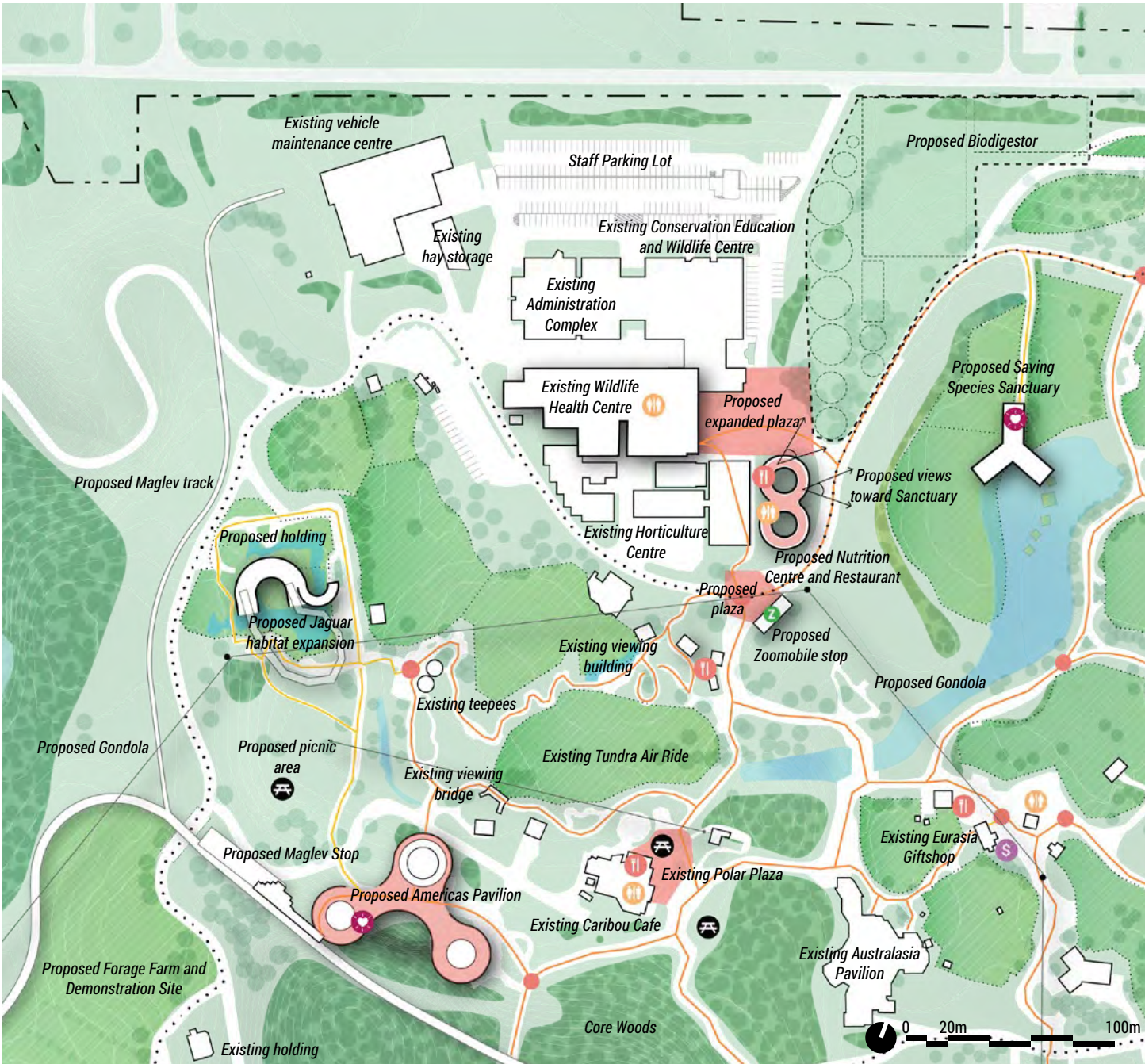
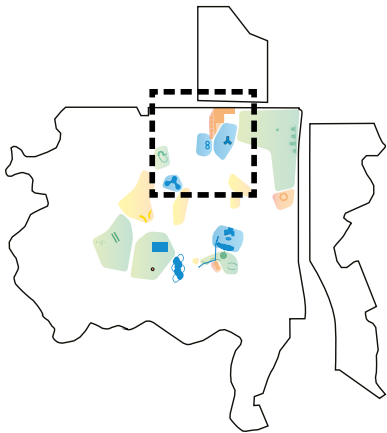

### Legend

#### Forms:

- Habitats
- Building - New or Redeveloped
- Building - Existing
- Designated gathering space
- Decision-making Points
- Stormwater Ponds
- Habitat Water Body
- Floating Wetlands
- Existing Site Topography - 1m Contours
- Site Boundary
- Fences

#### Flows:

- Main guest path
- Secondary guest paths
- Zoomobile route
- Zoomobile stops

#### Guest Amenities:

- Washrooms
- Food
- Retail
- Donor/Volunteer Recognition Area
- Picnic Area



# 5. THE NEW MASTER PLAN

## 5.2. ZOOM-IN AREA 4: CONSERVATION SCIENCE DISTRICT

The iconic species in this part of Your Zoo are vast in their differences, ranging from very small, charismatic, climbing species such as the golden lion tamarin, to much larger iconic species like the polar bear. The differences between the species in the Americas and the Tundra allow guests to witness a range of different behaviours that are visible in the vastly different habitats that they occupy, while celebrating different climates and biomes and forefronting the story of climate change and the actions that we can take to help reduce it. These species also serve to open up a dialogue about habitat preservation at home and abroad, as well as the perils facing native Canadian species, and Your Zoo’s role in bringing these species back in the wild.

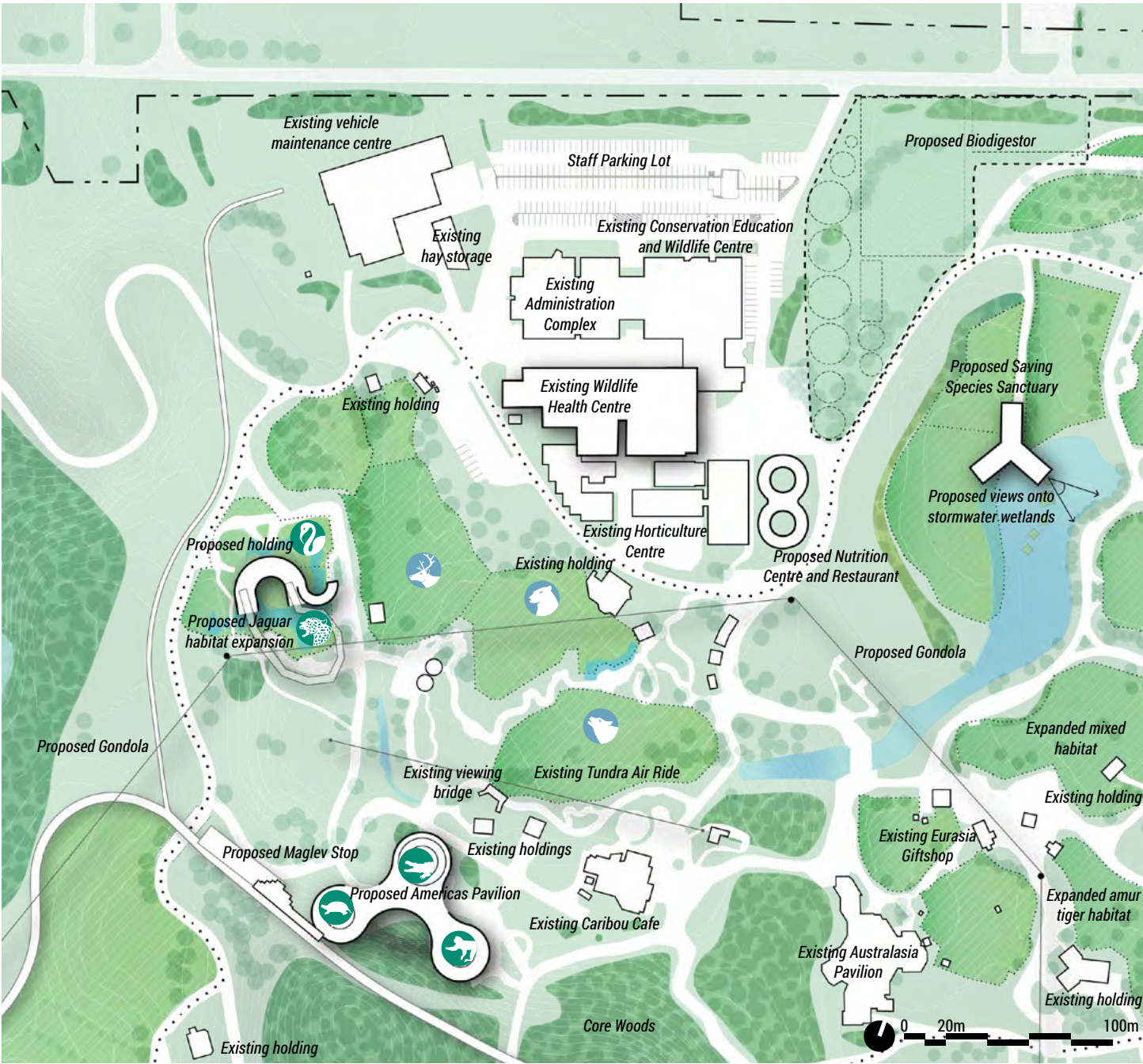

### Centrepiece Species in Tundra Trek



Polar Bear



Arctic Wolf



Caribou

### Centrepiece Species in Americas at Mayan Temple Ruins



Jaguar



American Flamingo

### Centrepiece species in Americas Pavilion



Blanding’s Turtle



American Alligator



Golden Lion Tamarin



# 5. THE NEW MASTER PLAN

## 5.2. ZOOM-IN AREA 5: NORTH OF OLD FINCH AVENUE

This underutilized Zoo land on the North side of Old Finch Avenue becomes a space that will host two new programs. The Conservation Breeding Program makes use of the existing barn site with a new building combining all three structures, and ample sheltered habitat space behind this, where sensitive species can be bred in a quiet, secluded space. In the middle of this area, set back from the road for privacy, is a space reserved for indigenous programming and cultural gatherings. Both of these programs are protected from the noise and foot traffic of the day-to-day Zoo activities, but are in close proximity to Your Zoo's main site, enabling Your Zoo to have the opportunity to welcome groups, if desired.

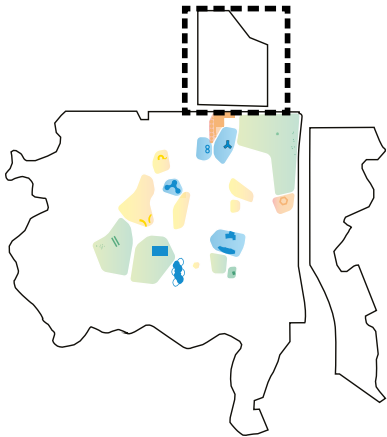

### Legend

Forms:

- Habitats
- Building - New or Redeveloped
- Building - Existing
- Site Boundary
- Fences



# 5. THE NEW MASTER PLAN

## 5.3. CAPITAL PROJECTS: HEAVY LIFTERS, MIGHTIES, LOW-HANGING FRUIT AND PARTNERSHIP-FUNDED

Many capital projects are presented in the Master Plan, including varying degrees of detail. Each of these projects has been developed as a starting point for establishing the principles for further detailed design of the building massing and spaces, in an attempt to create a cohesive site as each of these projects and areas are developed. While building forms are suggested in many projects, this is very flexible and will be further studied through the detail design of each project as they move forward, to establish the best massings, materials, and spatial layouts that work collectively to enhance Your Zoo, building off of the principles established in this Master Plan. Specific project names will be decided together in collaboration with project partners.

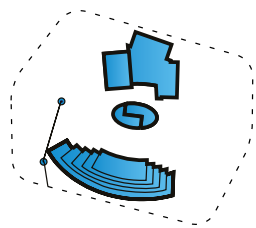

Conservation Campus

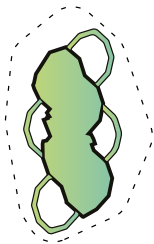

Gorilland

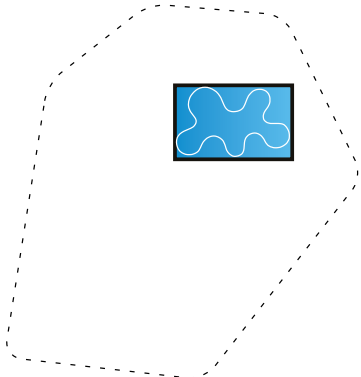

Indoor Winter Viewing and Holding



Nutrition Centre and Restaurant



Jaguar Jungle

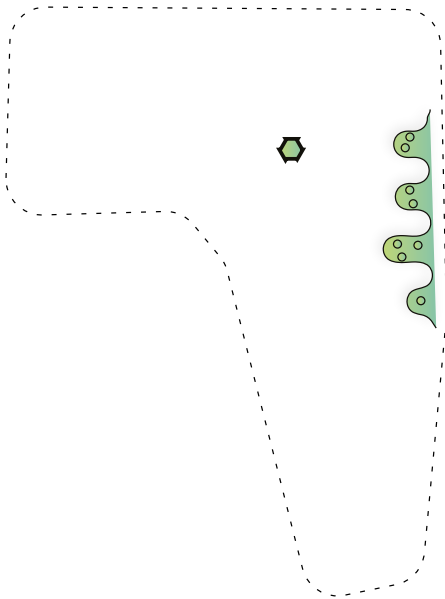

Wilderness North

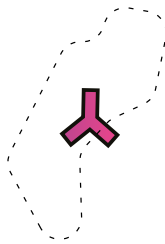

The Saving Species Sanctuary

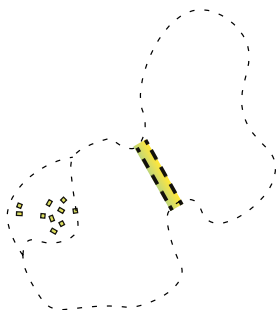

Safari Meander

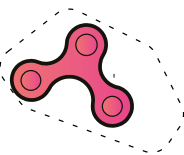

Americas Pavilion

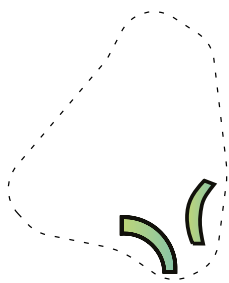

The Forage Farm and Demonstration Site

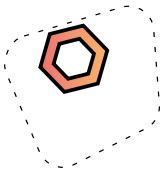

The Daycare

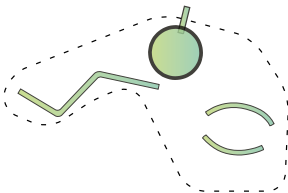

Sumatran Tigerline

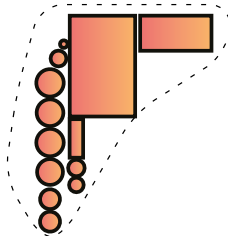

The Biodigester

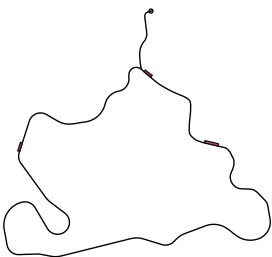

The Monorail Path

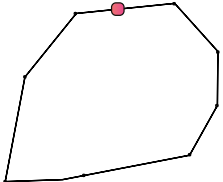

The Gondola



Zoo Brewery + Malayan Woods Renewal



Savanna Viewing Tower



# 5. THE NEW MASTER PLAN

## 5.3. CAPITAL PROJECTS: HEAVY LIFTERS, MIGHTIES, LOW-HANGING FRUIT AND PARTNERSHIP-FUNDED

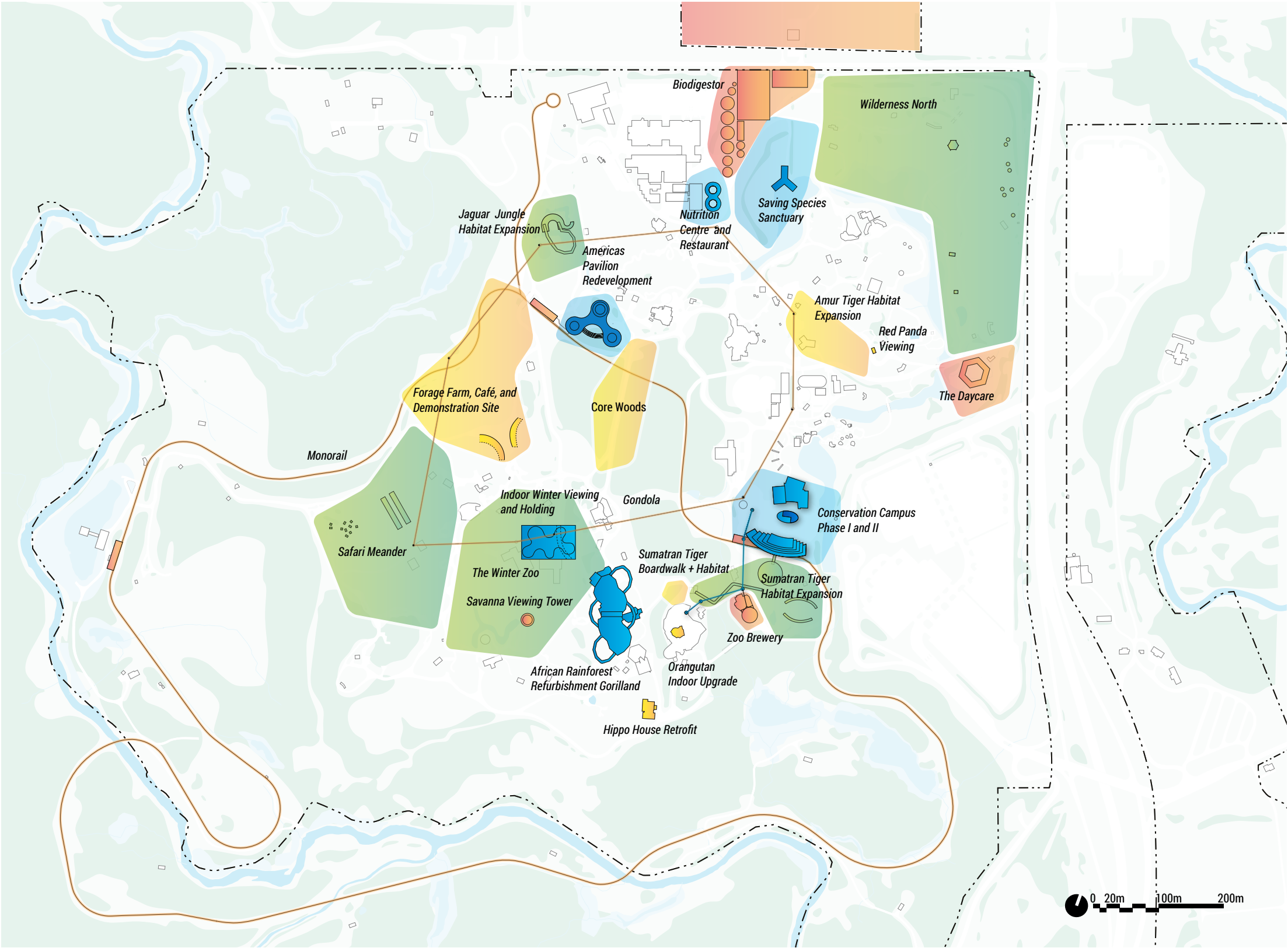

### Legend

- Heavy Lifters area modification
- Heavy Lifters new or modified building
- Mighties area modification
- Mighties new or modified building
- Low-hanging Fruit area modification
- Low-hanging Fruit new or modified building
- Partnership-Funded area modification
- Partnership-Funded building or structure

### Heavy lifters

These are projects that are bigger in scope, often involving new buildings, and requiring much more investment on the part of Your Zoo, although ideally external funders will also be secured. These projects will occur over a much longer timeline and will be the most impactful and exciting projects at Your Zoo, drawing in many new guests.

### Mighties

These projects have a slightly smaller scope, could be funded through the Capital Works Program through city funding either as exhibit refurbishments or separate projects, and are still very impactful and will bring new guests.

### Low-hanging fruit

These projects are much smaller in scope and budget, having a much shorter construction timeline, and often target pain points that can be addressed more quickly and at lower cost.

### Partnership-funded

These projects, while incredibly impactful in scope, will be externally funded, creating win-win partnerships for the Zoo and the funding partners. These are more infrastructural projects, that create incredible site experiences, offering new views onto the site, or views into different site processes.



# 5. THE NEW MASTER PLAN

## 5.3. CAPITAL PROJECTS: CONSERVATION CAMPUS PHASE I

Today, the arrival at Your Zoo lacks a real “WOW!” right near the entry. Two plaza-like spaces exist at the entry, however animal experiences are quite distant from here. The Conservation Carousel is well-loved, and holds an important place immediately upon entering Your Zoo. To bring new energy to the arrival experience, Phase I of the Conservation Campus will see Your Zoo creating a space that welcomes guests while also highlights the important work that Your Zoo is doing at home as well as abroad. An otter habitat will be out front so that guests encounter charismatic Canadian wildlife that are visible prior to entering the Zoo.

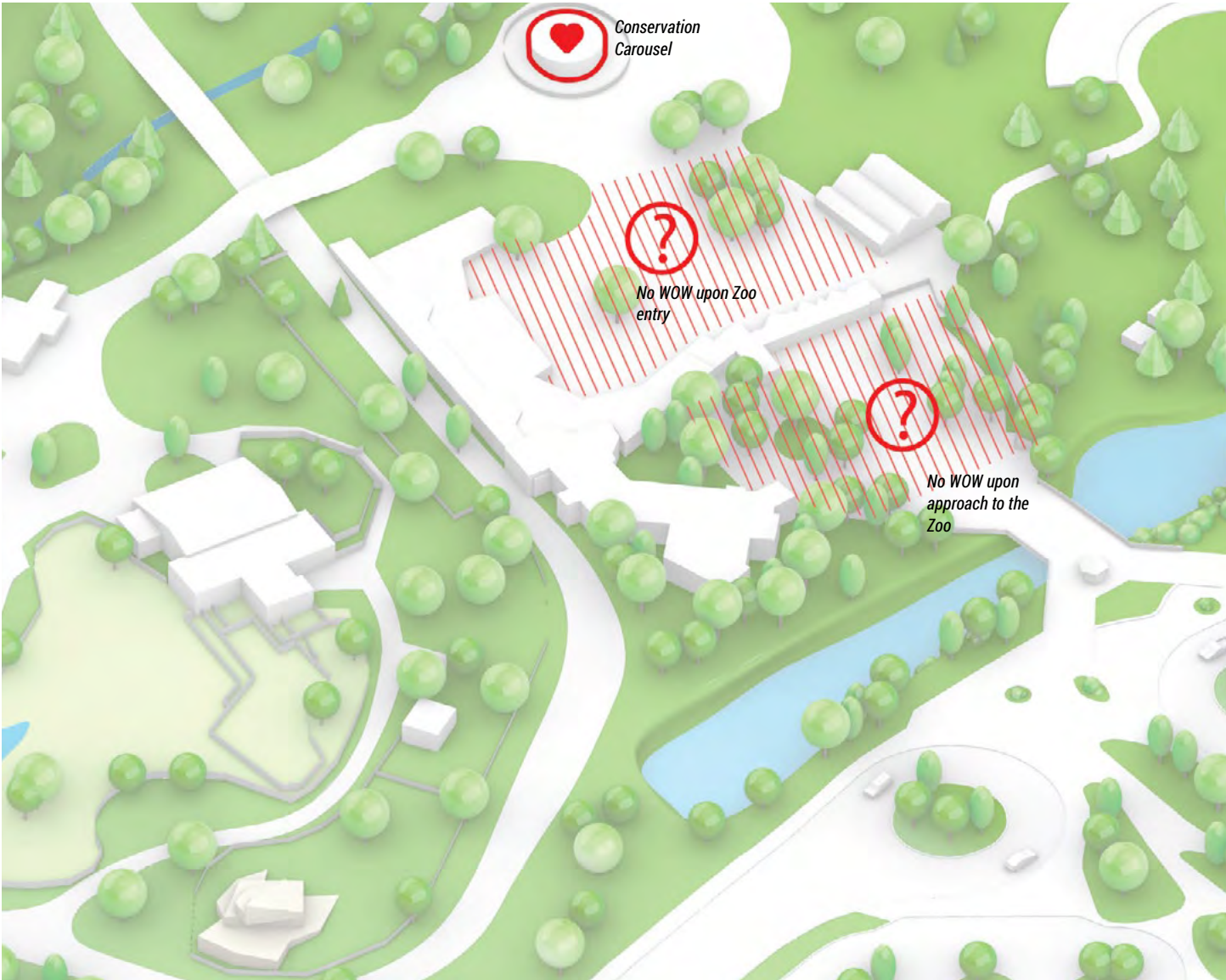
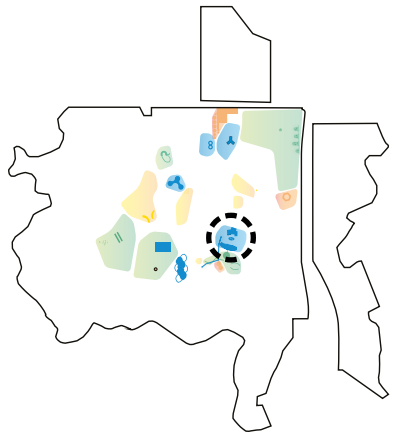

Existing

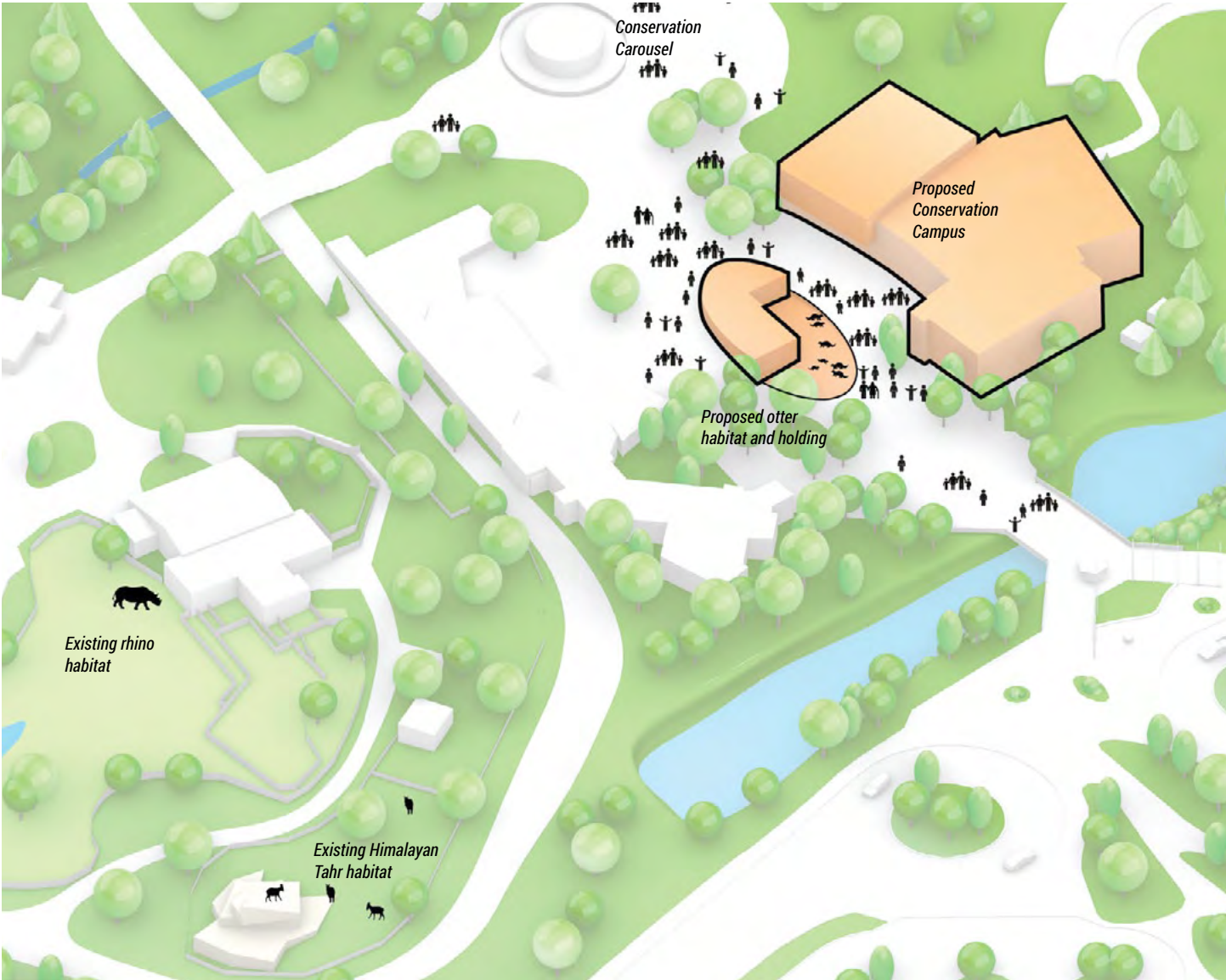

Conservation Campus Phase I



# 5. THE NEW MASTER PLAN

## 5.3. CAPITAL PROJECTS: CONSERVATION CAMPUS PHASE II (PARTNERSHIP PROJECT)

To bring even more energy to the arrival experience, Phase II of the Conservation Campus will see Your Toronto Zoo working with key partners to develop a hotel, theatre hall, changing exhibit hall, and wildlife conservation research centre. The ground floor remains entirely public, housing a transportation hub and arrival space. This will create a new, dynamic destination hub in the east end of Toronto. Orangutans are brought right near the entry, above guests, on the O-line, giving them freedom of choice and demonstrating the devotion that goes into animal care and enrichment at Your Zoo. A plaza space is created between the Conservation Campus and hotel, and trees are added around the plaza at the entry and inside the gate, providing ample shade for guests and creating a journey of discovery upon arrival. The Conservation Campus may be used outside of regular Zoo hours for functions that serve the Zoo's many communities. Refer to page 109 for a proposed partnership funding roadmap for the Conservation Campus Phase II project.

### Preliminary program

- **37 500 sqft building** (Hotel, event, conservation research, 4 upper levels)
- **9 000 sqft transportation hub** and arrival space (ground floor)
- **215 m O-line**, with four posts, allowing orangutans to move freely from their habitat to the front entrance plaza

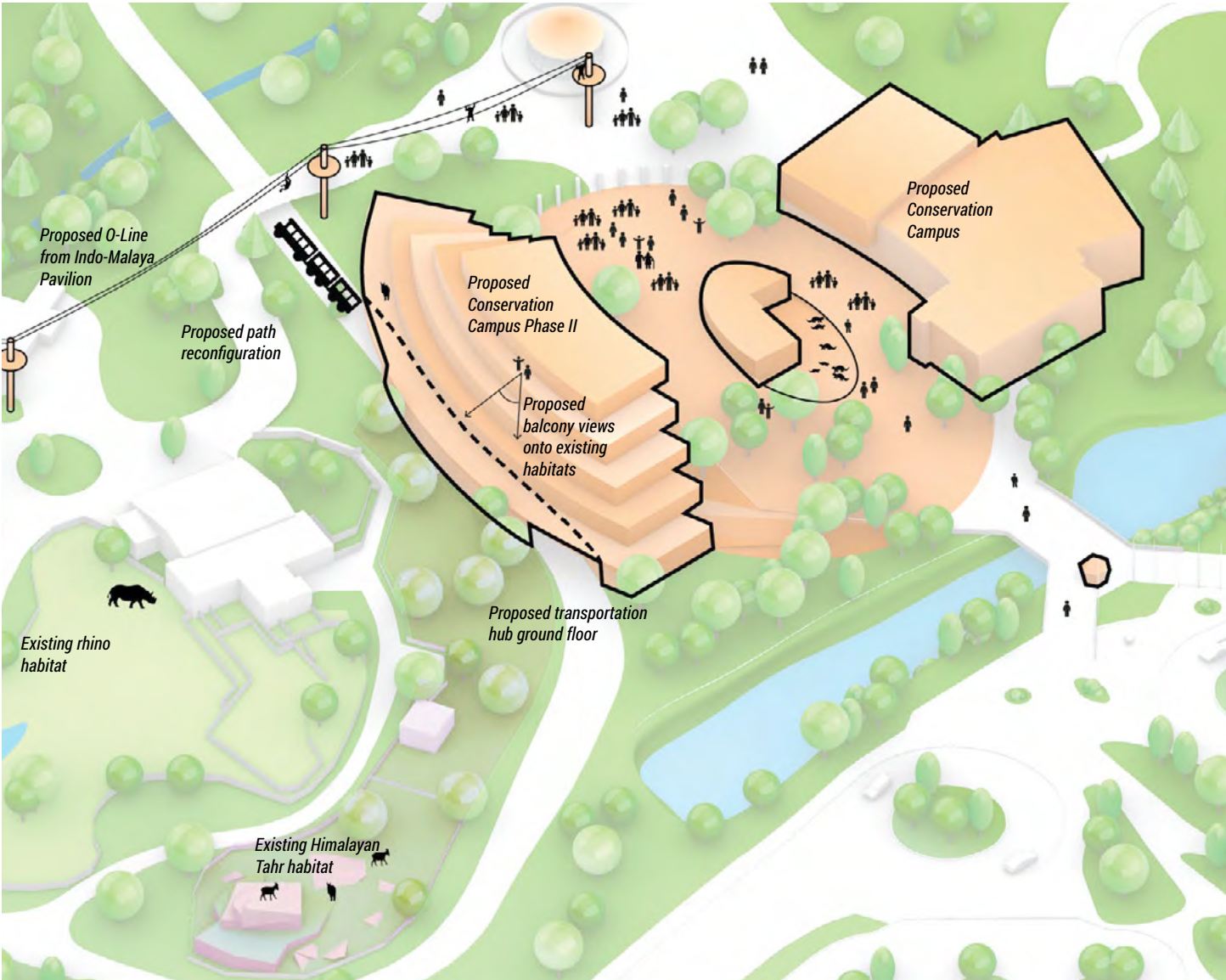
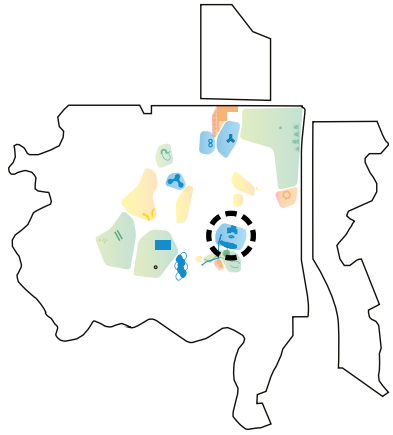

Conservation Campus Phase II Proposal Step 1

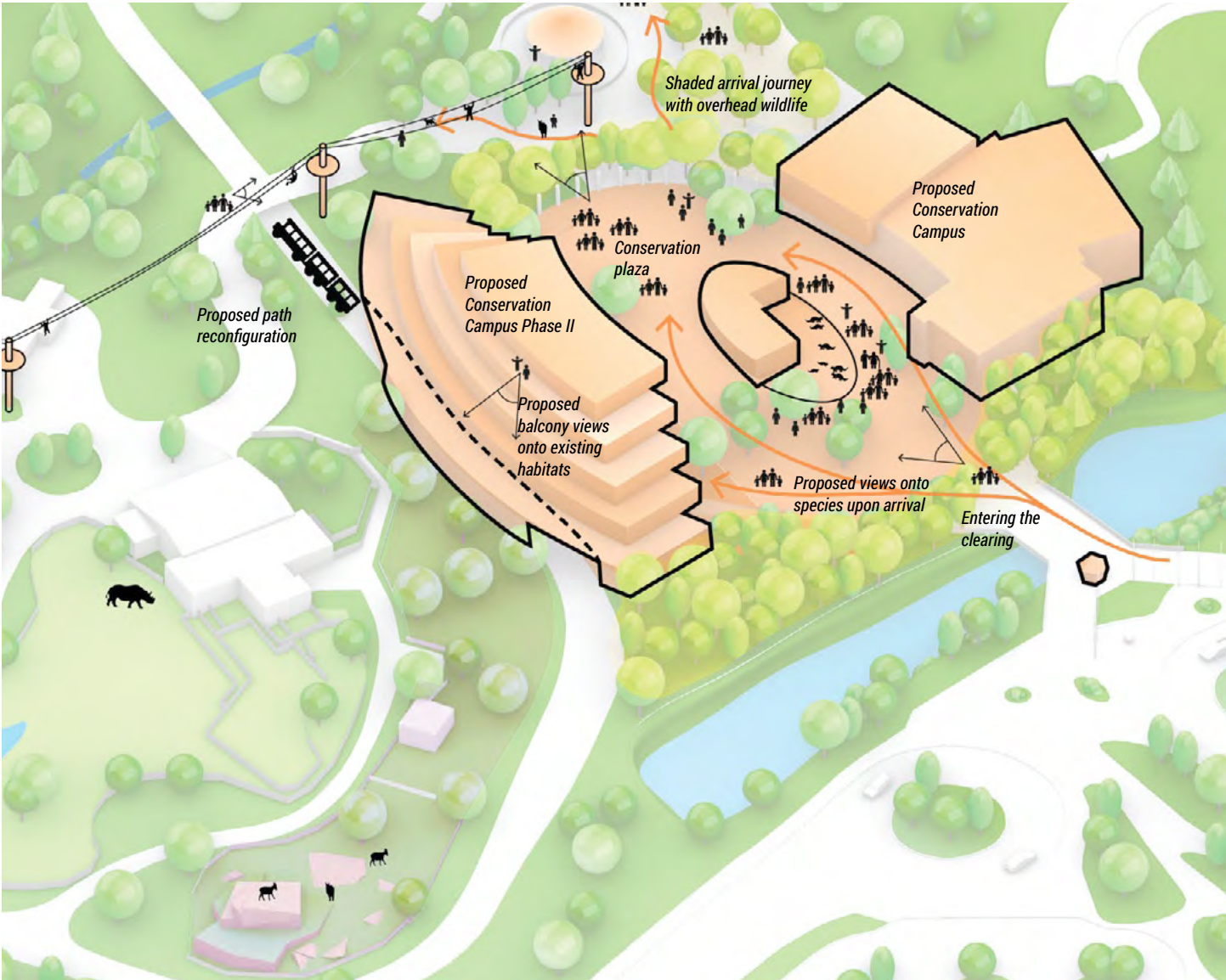

Conservation Campus Phase II Proposal Step 2



# 5. THE NEW MASTER PLAN

## 5.3. CAPITAL PROJECTS: CONSERVATION CAMPUS PHASE II VIEWS

The new Conservation Campus and Conservation Hotel provide guests with an inviting first glimpse into Your Zoo's mission and vision, both forefronting the importance of conservation and spending more time with animals, as well as developing programs that financially support these missions. The entrance experience also celebrates larger enclosures and more freedom of choice creating an enriching experience for both animals and guests. In the same way that they are greeted with a sense of awe upon arrival, an orangutan transfer line leaves guests with a memorable and important experience as they depart - a unique connection to animals, and especially animals that feel free-roaming, as they use the Zoo as their playground.

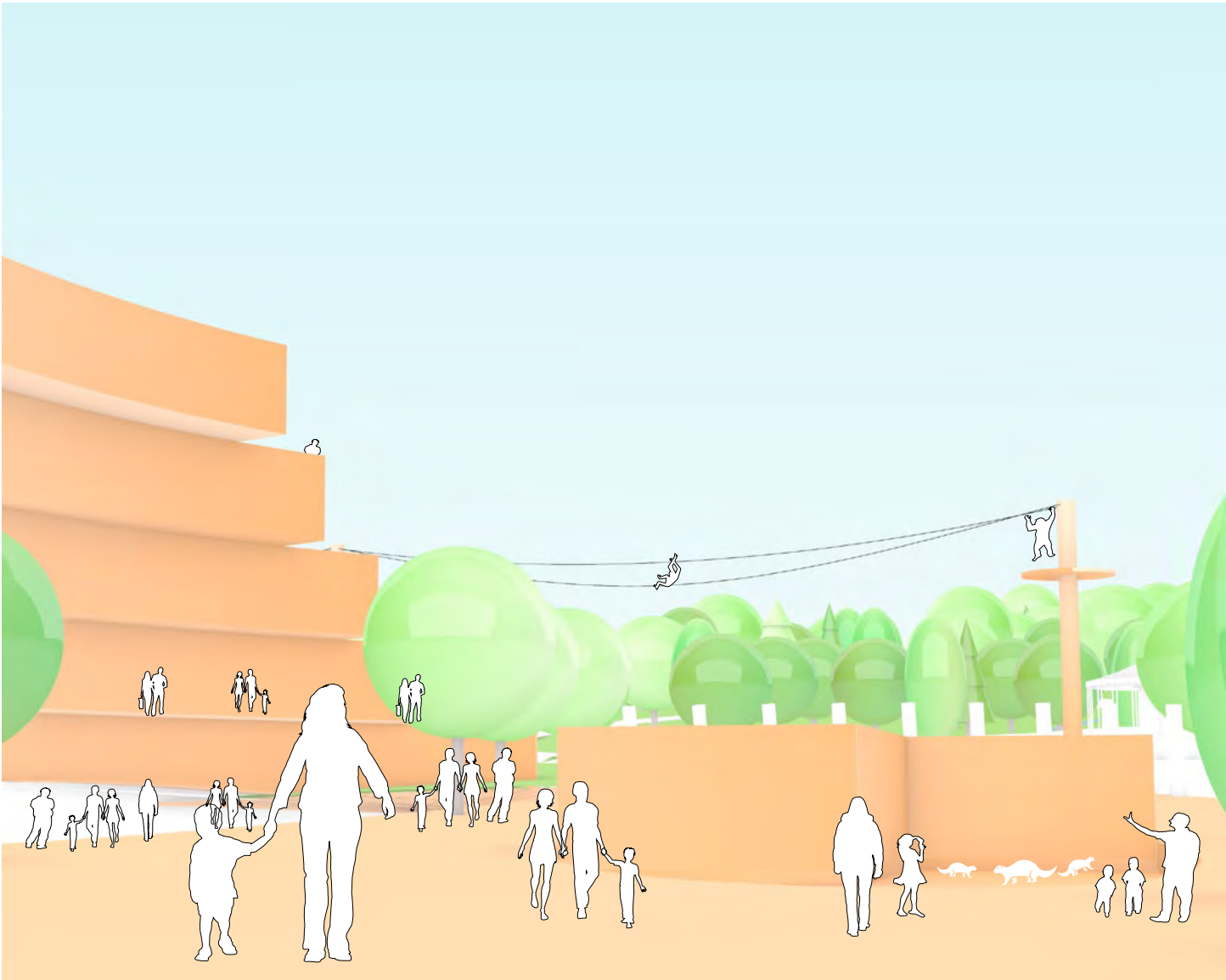
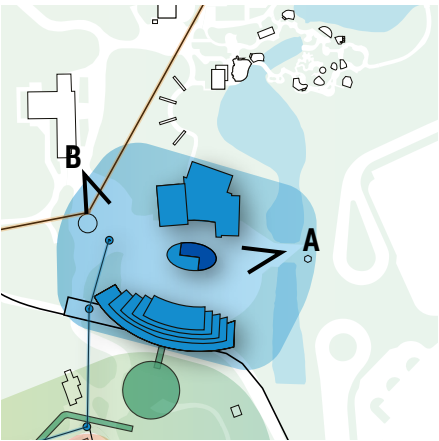

View A: an inviting arrival being greeted by river otters and orangutans near the Conservation Hotel upon entering



View B: views onto the Conservation Carousel and Conservation Hotel with species alongside you as you depart Your Zoo



# 5. THE NEW MASTER PLAN

## 5.3. CAPITAL PROJECTS: INDOOR WINTER VIEWING AND HOLDING

This dip in the landscape at the heart of Your Zoo, between the existing rhinoceros holding and the area behind the back of the African Rainforest Pavilion, currently serves as a material storage area and is inaccessible to guests. The proposed Indoor Winter Viewing and Holding Pavilion creates an extensive indoor habitat for African species currently not on display in winter, while also creating new vantage points onto the expansive Savanna landscape. This pavilion takes advantage of the location, as well as the existing topography, becoming an extension of the landscape, as guests move up onto the roof, with views out onto the Savanna habitat, as well as towards a new gorilla habitat and the existing penguin habitat. This building highlights Your Zoo’s mission and vision, putting animal welfare first, while inviting guests in to have more opportunity to connect with these animals throughout the entire year.

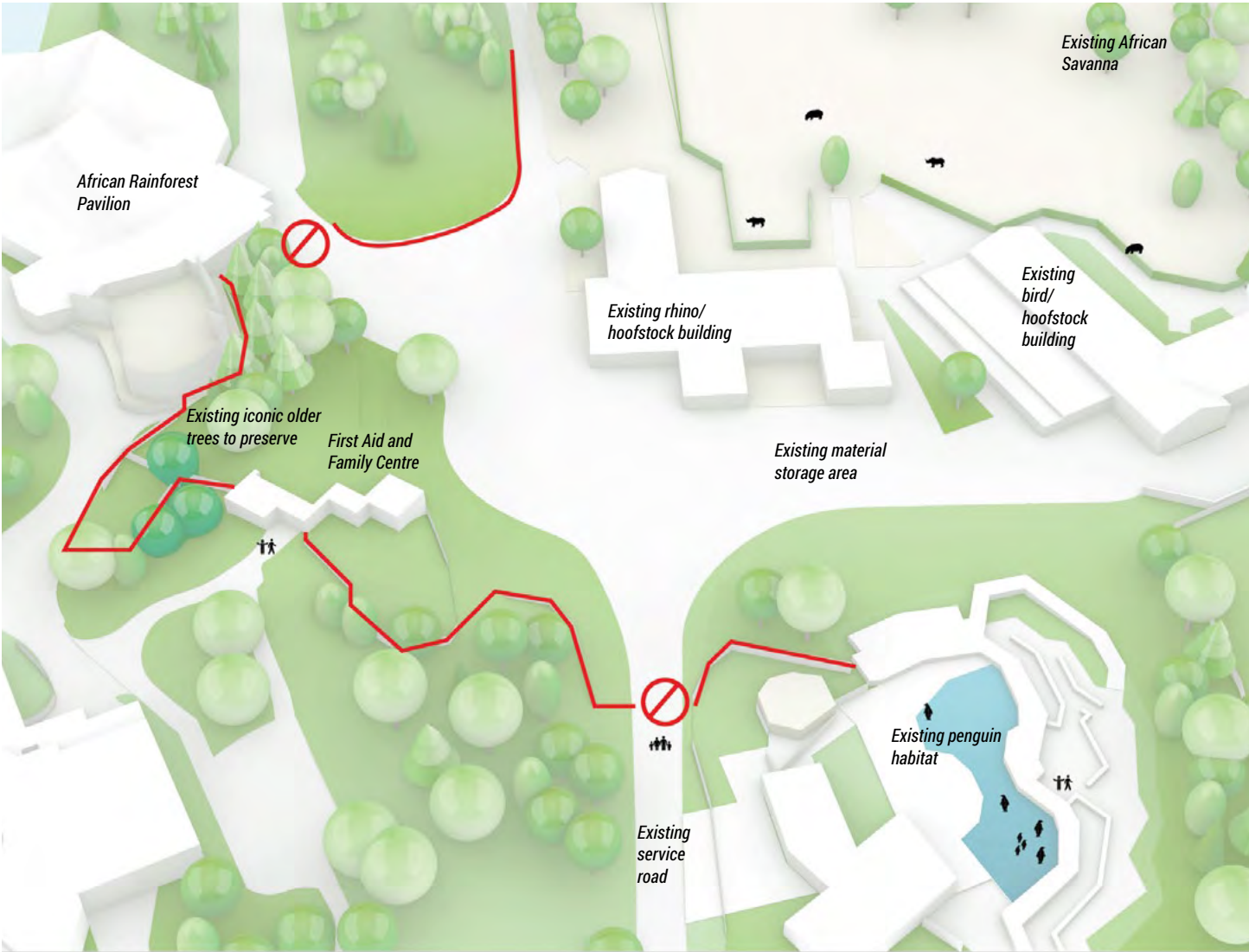
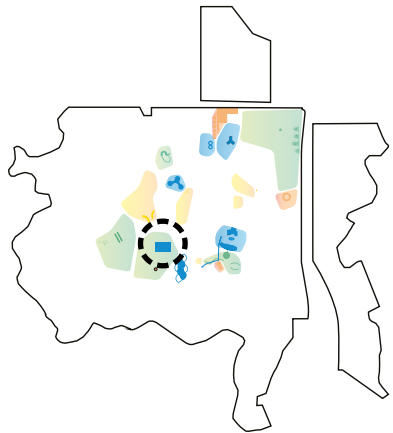

Existing

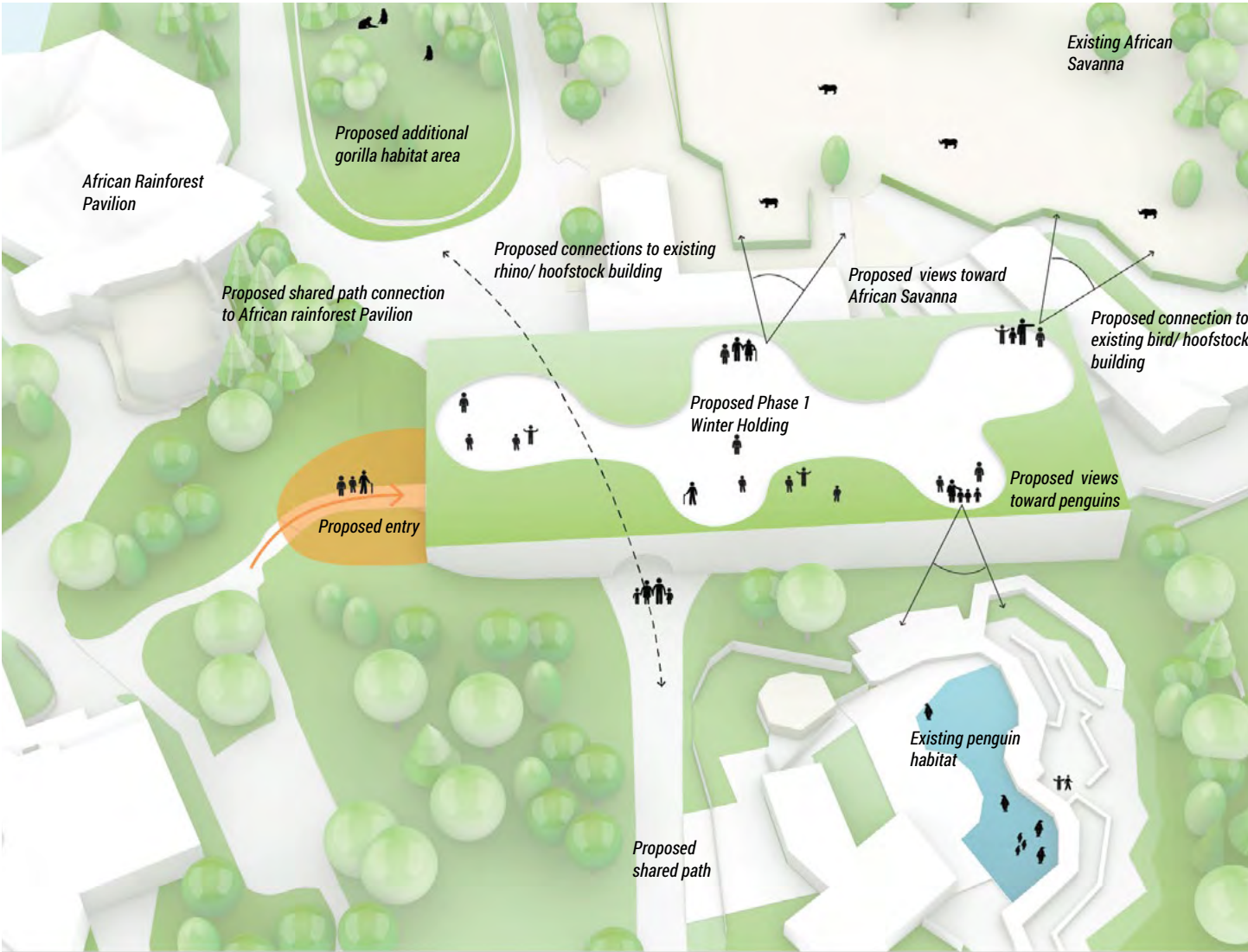

Proposal Step 1



# 5. THE NEW MASTER PLAN

## 5.3. CAPITAL PROJECTS: INDOOR WINTER VIEWING AND HOLDING

Outdoor habitats become an extension of the indoor pavilion habitats, and many species can be housed and viewed together in this pavilion, with ample space for all. While African species are outside during the summer, the pavilion has areas that can be rented and used as venues for events, with unique views onto Savanna species in the adjacent landscape, as well as onto penguins. The large indoor spaces provide guests more views onto these incredible species in the cooler months. The First Aid and Family Centre also becomes relocated within this pavilion, and food and beverage opportunities are developed within it as the building is expanded in its second phase. These offer unique opportunities for eating with views onto species from inside the pavilion or from the expansive rooftop terrace in the warmer months.

### Preliminary program

- **46 250 sqft building total** (over 2 levels), insulated for year-round use
- roof plaza for guests, with some green roof functions as well (roughly 50% plaza, 50% planted)
- partial second floor with viewing opportunities onto species
- driveable tunnel through building for guests on foot and for staff vehicles
- connection to 2 existing holding buildings + penguin habitat

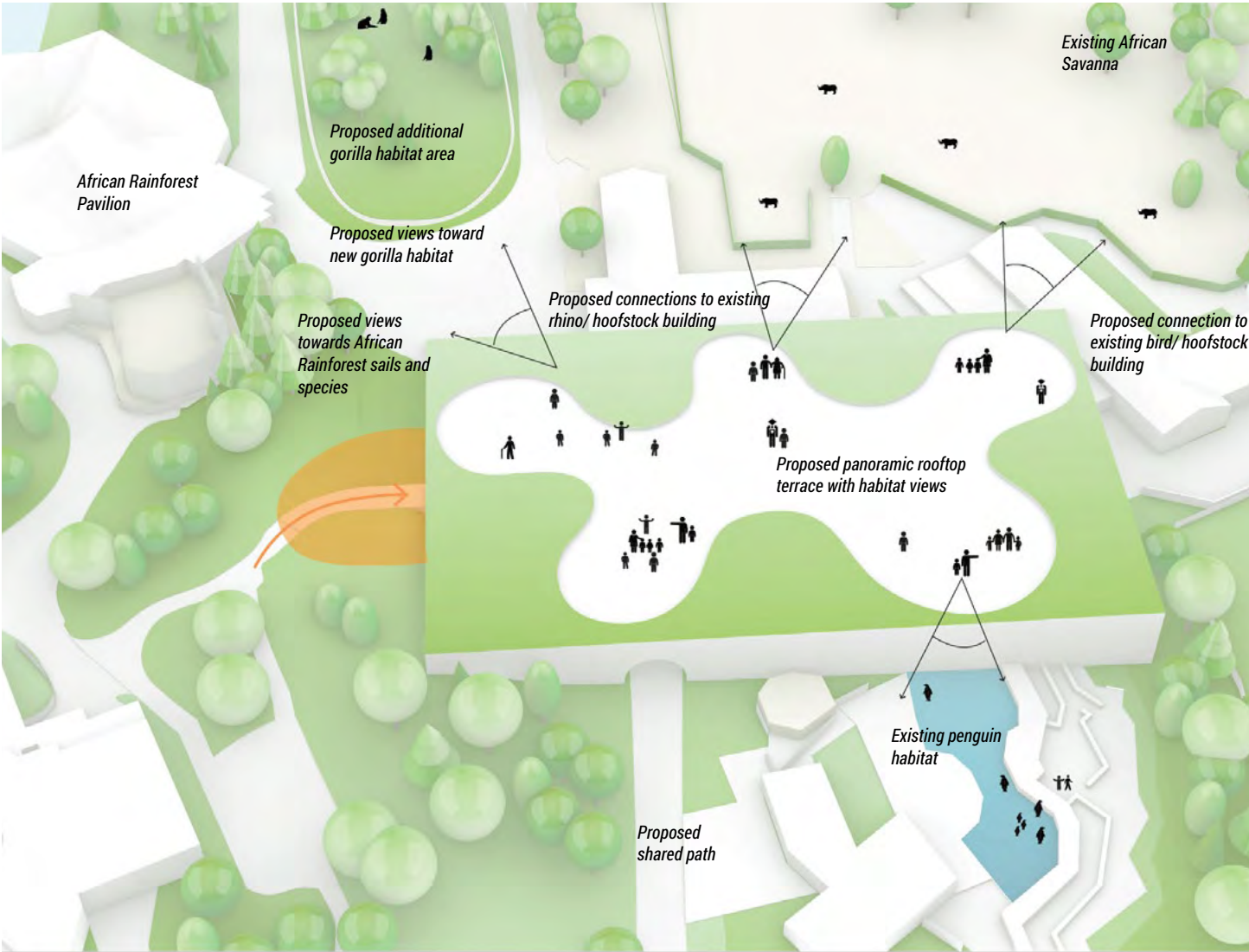
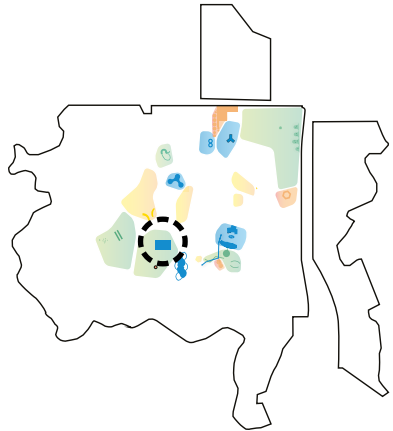

Proposal Step 2

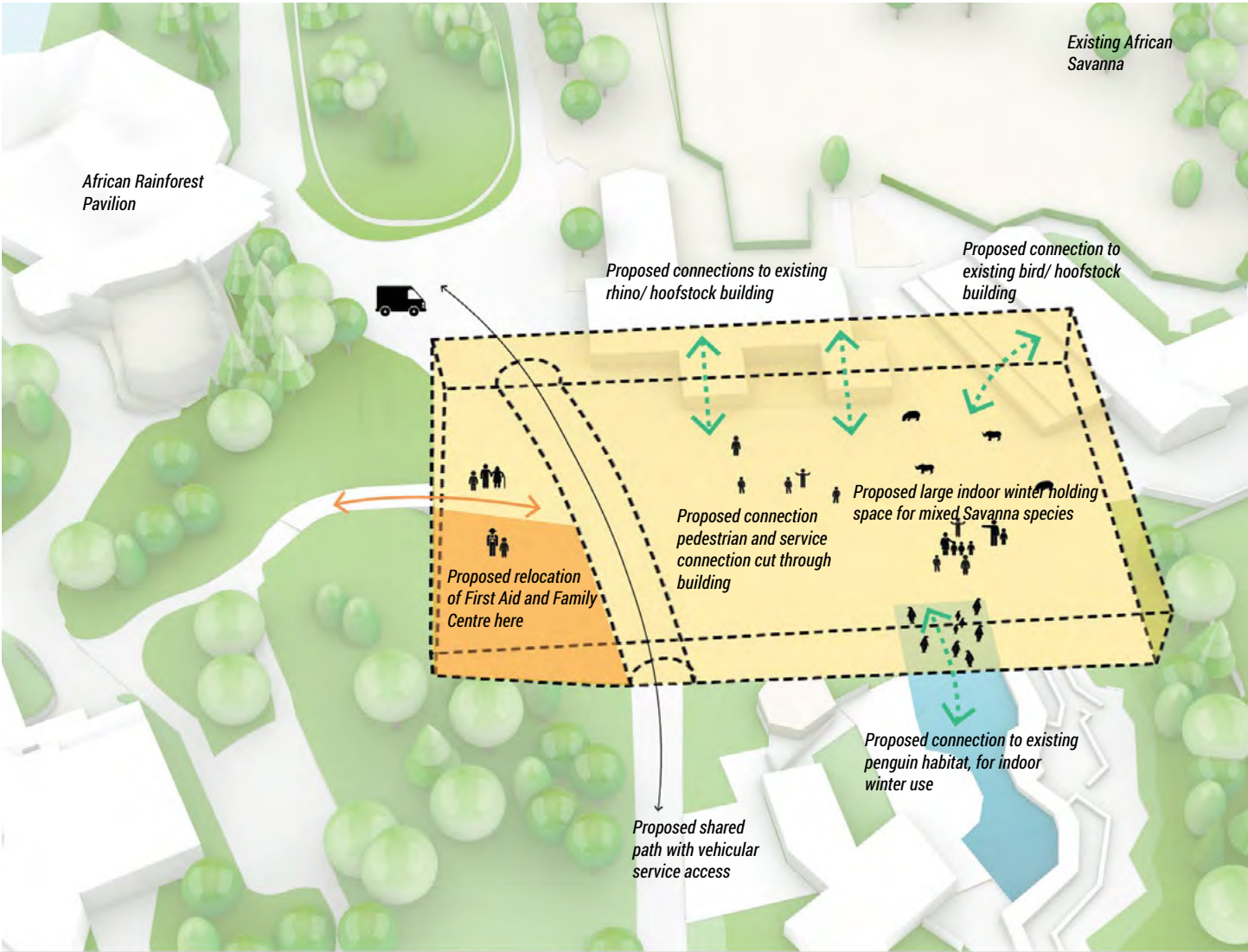

Proposal Step 2: internal connections



# 5. THE NEW MASTER PLAN

## 5.3. CAPITAL PROJECTS: INDOOR WINTER VIEWING AND HOLDING VIEWS

The Indoor Winter Viewing and Holding offers new views indoors onto species not currently seen in winter at Your Zoo, while also creating new vantage points looking out over the large Savanna habitat. With an outdoor illuminated lantern, as well as seating, the rooftop becomes a destination for gathering in all seasons. The installation brings together stories about African species, as well as data about conservation status and reports from the field, from conservation partners on the ground in Africa. Interactive technology turns the lantern into a jukebox, allowing visitors to select audio to play using their Zoo Passport app. The jukebox features music from the countries and cultures of animals in the winter viewing area and can also offer broadcasts of ambient soundscapes that express the sonic qualities of their natural environment. This roof space becomes a backdrop for theatre, film, dance, music, or spoken word performances, further enlivening the landscape, and creating additional opportunities for conversation and the presentation of new community-generated art.

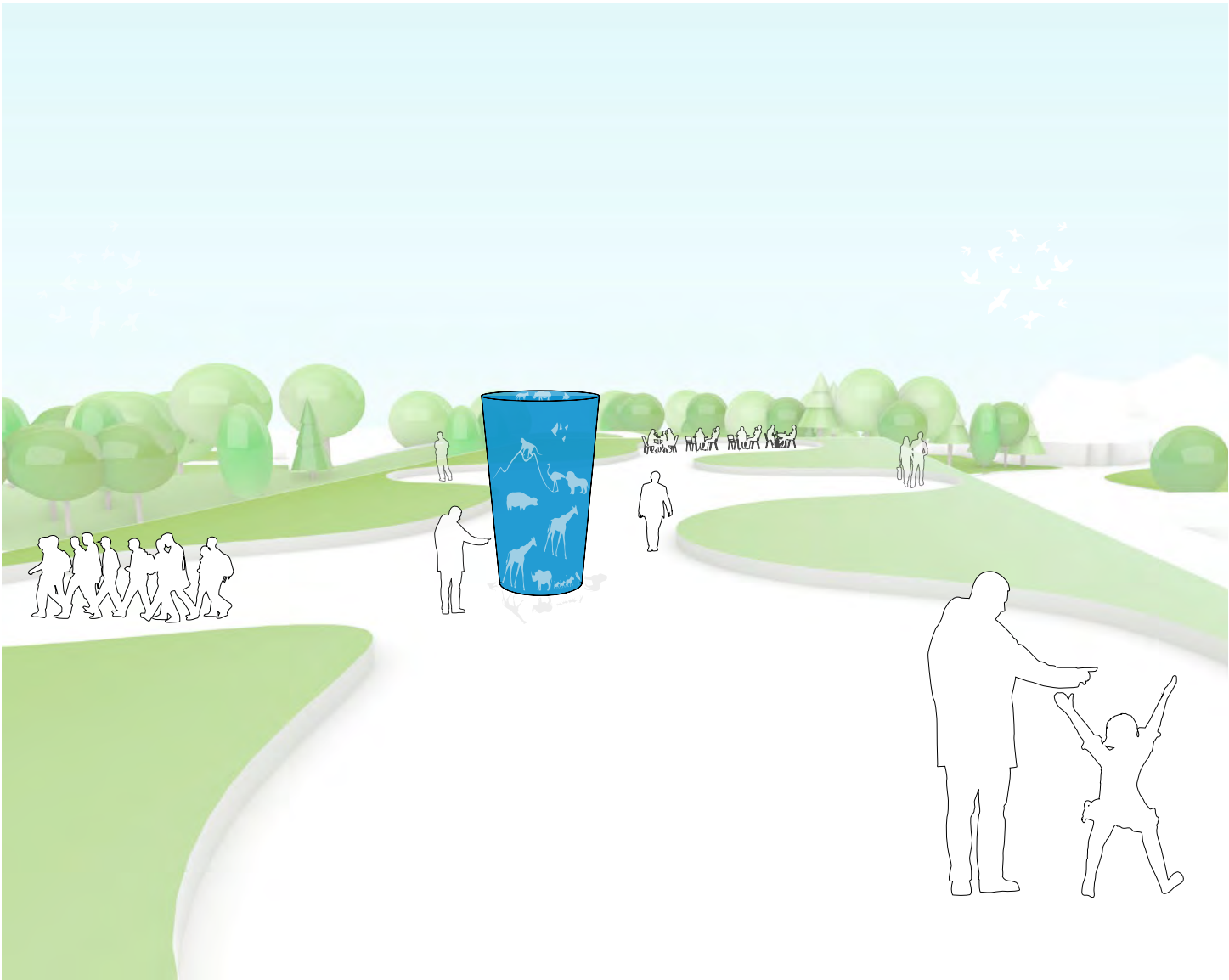
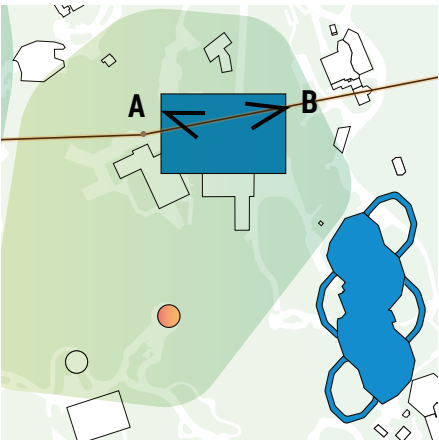

View A: looking across the large roofscape towards the illuminated interpretive lantern and rooftop café space

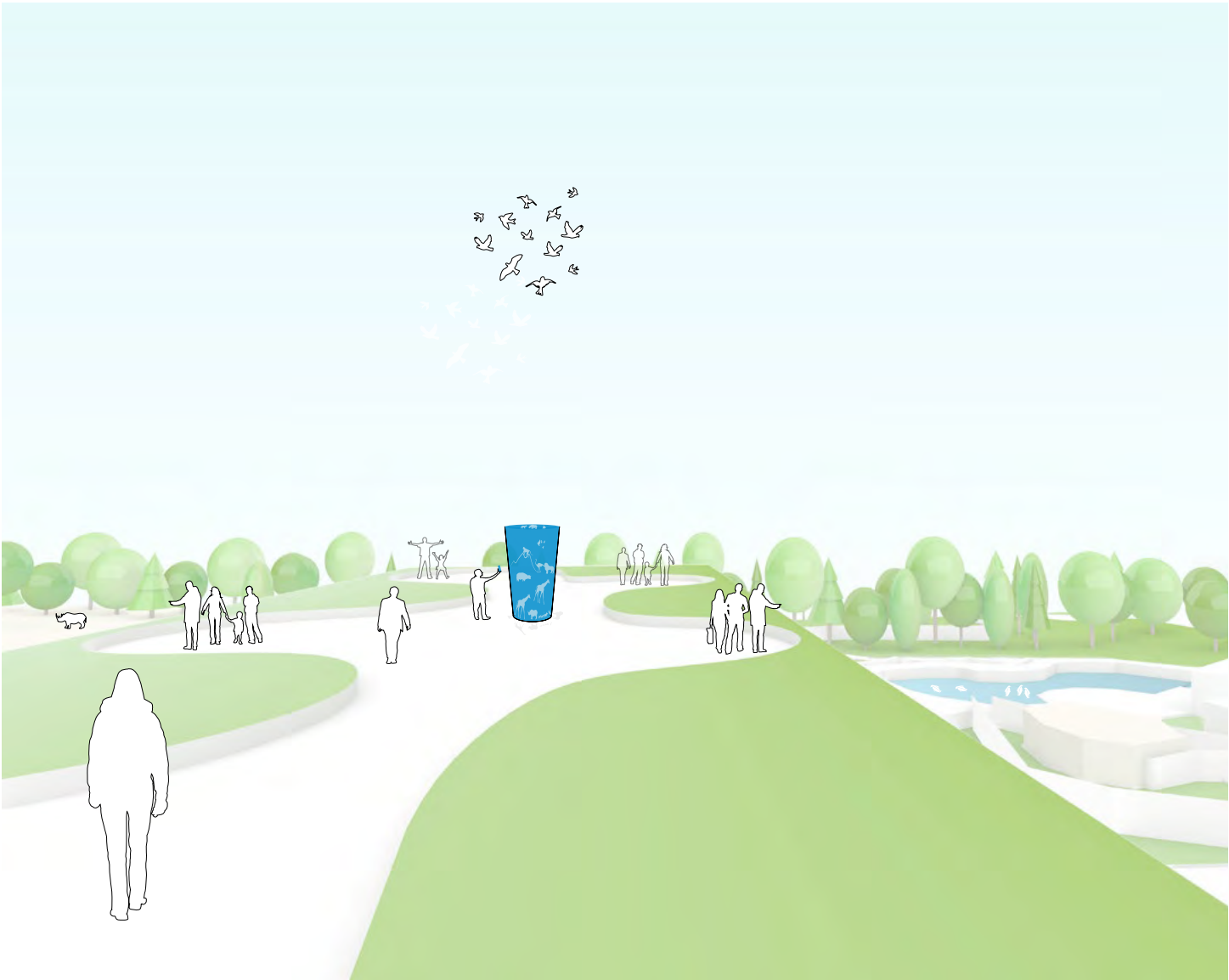

View B: views onto species on all sides of the building, from the rooftop terrace space



# 5. THE NEW MASTER PLAN

## 5.3. CAPITAL PROJECTS: HOLDING WELCOMING SAVANNA ANIMALS DURING WINTER





# 5. THE NEW MASTER PLAN

## 5.3. CAPITAL PROJECTS: HOLDING AS A FANTASTIC VENUE THROUGHOUT THE SUMMER





# 5. THE NEW MASTER PLAN

## 5.3. CAPITAL PROJECTS: THE INDOOR WINTER VIEWING EVENT SPACE

### Proposed experience of IT projects:

Implementing audiovisual equipment here helps to create a rich event space, allowing for more flexibility in the uses of this area, creating opportunities for one-of-a-kind mission-based community and VIP events. This added technology creates more opportunities for inviting the creative community into this space as well, creating more cross-pollination between the scientific and conservation community onsite and the creative communities. Implementation of a Centralized Inventory Management System allows for amenities and supplies onsite to be easily found, used, and rented, further facilitating event setup in this new event space.

### Building blocks of the Information Technologies (IT) strategy for this area:

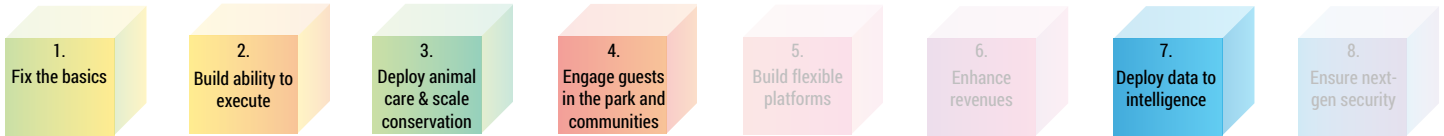

### IT projects recommended to be investigated in this capital project: (refer to Appendix 5 for the full Technology Master Plan):

- 1.1. Implement Wifi site wide / Install Network
- 1.7. Implement guest distress system / Zoo wide alarm
- 2.10. Implement Centralized Inventory Management System
- 3.3. Implement animal cameras and sensors (heat, location)
- 4.5. Implement AV equipment for boardrooms and event spaces
- 4.19. Build Zoo App V2
- 7.12. Implement Smart Washroom Facilities



Community events and VIP events facilitated by audiovisual technology, high-tech security, and wifi.



The Centralized Inventory Management System facilitates events with up-to-date information on supplies.