

PUBLIC APPENDIX "A"

YONGE & GERRARD

PROPOSED MIXED-USED DEVELOPMENT

372-378 YONGE STREET, TORONTO, ON



ARTIST RENDERING DO NOT USE FOR REFERENCE

DRAWING LIST	
Sheet Name	Sheet Number
CONCEPTUAL VIEWS	DP0.2
CONCEPTUAL VIEWS	DP0.3
CONTEXT PLAN	DP1.1
SITE PLAN	DP1.2
FLOOR PLANS	DP2.1
FLOOR PLANS	DP2.2
FLOOR PLANS	DP2.3
FLOOR PLANS	DP2.4
EXTERIOR ELEVATIONS	DP4.1
BUILDING SECTIONS	DP4.2
PODIUM EAST ELEVATION	DP4.3

DRAWING LIST	
Sheet Name	Sheet Number
PODIUM NORTH ELEVATION	DP4.4
PODIUM SOUTH ELEVATION	DP4.5
PODIUM WEST ELEVATION	DP4.6
SHADOW STUDY MARCH	DP5.1
SHADOW STUDY JUNE	DP5.2
SHADOW STUDY SEPTEMBER	DP5.3
SHADOW STUDY DECEMBER	DP5.4
SHADOW STUDY - COLLEGE PARK	DP5.5
VIEW CORRIDOR STUDY	DP5.6
VIEW CORRIDOR STUDY	DP5.7
VIEW CORRIDOR STUDY	DP5.8

RE-ISSUED FOR ZONING BYLAW AMENDMENT

2023-10-26





YONGE STREET LOOKING NORTH



YONGE STREET LOOKING SOUTH

ISSUED FOR

METRIC

THIS DRAWING IS COPYRIGHTED AND MUST NOT BE USED, REPRODUCED, OR REVISED WITHOUT WRITTEN PERMISSION. ALL DIMENSIONS ARE IN MILLIMETERS UNLESS OTHERWISE NOTED. VERIFY DIMENSIONS. DO NOT SCALE THIS DRAWING.

REPORT INCONSISTENCIES AND OMISSIONS TO THE CONSULTANT FOR CLARIFICATION BEFORE COMMENCING WITH THE WORK. DEVIATIONS FROM THE CONTRACT DOCUMENTS WITHOUT WRITTEN APPROVAL FROM THE CONSULTANT ARE SUBJECT TO CORRECTION AT THE CONTRACTOR'S EXPENSE.

ARCHITECT & PRIME CONSULTANT

DIALOG
35 John St #200
Toronto, ON M5V 3G6
Tel: (416) 966-0220 Fax:

CIVIL ENGINEER
Courtesport Engineering Inc.
8395 Jane St, Suite 100
Vaughan, ON L4K 5Y2
Tel: (905) 526-1404 Fax:

LANDSCAPE ARCHITECT
Ferra & Associates Inc
11 Church St
Toronto, ON M5E 1W1
Tel: (416) 366-6800 Fax:

STRUCTURAL ENGINEER
Jabroonky, Asif and Partners International
400-3 Concorde Gate
Toronto, ON M5C 3N7
Tel: (416) 447-7405 Fax:

MECHANICAL ENGINEER
Smith + Anderson
100 Sheppard Ave E
North York, ON M2N 6N5
Tel: (416) 487-8151 Fax:

ELECTRICAL ENGINEER

Tel: Fax:

KEYPLAN

SEAL

YONGE & GERRARD

CONCEPTUAL VIEWS

DRAWN: Author CHECKED: Checker
PLOT DATE: 2023-10-26 20:16:35

DP0.2



STREET LEVEL VIEW FROM YONGE & GERRARD INTERSECTION

ISSUED FOR

METRIC

THIS DRAWING IS COPYRIGHTED AND MUST NOT BE USED, REPRODUCED, OR REVISED WITHOUT WRITTEN PERMISSION. ALL DIMENSIONS ARE IN MILLIMETERS UNLESS OTHERWISE NOTED. VERIFY DIMENSIONS. DO NOT SCALE THIS DRAWING.

REPORT INCONSISTENCIES AND OMISSIONS TO THE CONSULTANT FOR CLARIFICATION BEFORE COMMENCING WITH THE WORK. DEVIATIONS FROM THE CONTRACT DOCUMENTS WITHOUT WRITTEN APPROVAL FROM THE CONSULTANT ARE SUBJECT TO CORRECTION AT THE CONTRACTOR'S EXPENSE.

ARCHITECT & PRIME CONSULTANT

DIALOG
35 John St #200
Toronto, ON M5V 3G6
Tel: (416) 966-0220 Fax:

CIVIL ENGINEER
Courtesport Engineering Inc.
8395 Jane St, Suite 100
Vaughan, ON L4K 5Y2
Tel: (905) 526-1624 Fax:

LANDSCAPE ARCHITECT
Ferra & Associates Inc
11 Church St
Toronto, ON M5E 1W1
Tel: (416) 366-6800 Fax:

STRUCTURAL ENGINEER
Jalovsky, Asst and Partners International
400-3 Concorde Gate
Toronto, ON M5C 3N7
Tel: (416) 447-7405 Fax:

MECHANICAL ENGINEER
Smith + Anderson
100 Sheppard Ave E
North York, ON M2N 6N5
Tel: (416) 487-8151 Fax:

ELECTRICAL ENGINEER

Tel: Fax:

KEYPLAN

SEAL

YONGE & GERRARD

CONCEPTUAL VIEWS

DRAWN: Author CHECKED: Checker
PLOT DATE: 2023-10-26 20:16:36

DP0.3

PROJECT STATISTICS

1.0 SITE AREA

1.1 Overall Site Area	hectares	acres	sq.m	sq.ft.
Site Area	0.096115	0.237505338	961.15	10,346

2.0 GROSS FLOOR AREAS (GFA)

2.1 Buildings GFA

Area per Level	No. of Levels	Retail (existing 378 Yonge)	Retail (new)	Residential	sq.m	sq.ft.
P4	70.0	1		70.0	70.0	753
P3	70.0	1		70.0	70.0	753
P2	80.0	1		80.0	80.0	861
P1	130.0	1	50.0	80.0	130.0	1,399
Podium - Ground	820.0	1	320.0	140.0	820.0	8,828
Podium - L2	120.0	1		120.0	120.0	1,292
Podium - L3	415.0	1	340.0	75.0	415.0	4,467
Podium - L4	30.0	1		30.0	30.0	323
Tower - L5 - 6	215.0	2		215.0	430.0	4,608
Tower - L7 - 8	475.0	2		475.0	950.0	10,228
Tower - L9 - 30	540.0	22		540.0	11,880.0	127,875
Tower - L31 - 32 (Amenity)	20.0	2		20.0	40.0	431
Tower - L33 - 34 (Mech)	540.0	2		540.0	1,080.0	11,625
Tower - L35 - 59	540.0	25		540.0	13,500.0	145,313
Tower - L60 - 61 (Amenity)	20.0	2		20.0	40.0	431
Tower - L62 - 63 (Mech)	540.0	2		540.0	1,080.0	11,625
Tower - L64 - 65	540.0	22		540.0	11,880.0	127,875
Total Proposed GFA	85	710.0	140.0	41,695.0	42,545.0	457,951

3.0 FLOOR SPACE INDEX (FSI)

Total Proposed GFA / Site Area

44.26

4.0 UNIT MIX

4.1 Unit Mix

Levels	Studio	1 Bed	Studio/1 Bed (Convertible to 2 Bed or 3 Bed)	2 Bed	3 Bed	Total per Floor	Total
Podium - Ground							
Podium - L2	1					1	1
Podium - L3	1					1	1
Podium - L4	1					1	1
Tower - L5 - 6	2	0	0	0	2	2	4
Tower - L7 - 8	1	1	2	0	2	1	6
Tower - L9 - 14	6	5	2	2	1	0	10
Tower - L15 - 30	14	3	2	2	1	1	9
Tower - L31 - 32 (Amenity)	2						
Tower - L33 - 34 (Mech)	2						
Tower - L35 - 59	23	3	2	2	1	1	9
Tower - L60 - 61 (Amenity)	2						
Tower - L62 - 63 (Mech)	2						
Tower - L64 - 72	10	1	2	4	1	1	9
Tower - L74 - 80	7	2	3	0	2	1	8
Tower - L81 - 85	5	3	0	3	3	1	7
Total No. of Units	85	183	154	134	94	63	628

4.2 Unit Mix Percentage

Overall Unit Mix	1 Bed / Studio	Studio/1 Bed (Convertible to 2 Bed or 3 Bed)	2 Bed	3 Bed	Total
Overall Unit Mix	53.7%	21.3%	15.0%	10.0%	100%

4.3 Unit Areas

Unit Size range (sq.m.)	Studio (sq.m.)	1 Bed (sq.m.)	Studio/1 Bed (Convertible to 2 Bed or 3 Bed) (sq.m.)	2 Bed (sq.m.)	3 Bed (sq.m.)
Unit Size range (sq.m.)	34 - 47	52 - 63	34 - 47	70 - 77	84
Unit Size average (sq.m.)	40	57	40	73	84

5.0 AMENITY

5.1 Amenity Required

Total Amenity	Units	Ratio	Total
Total Amenity	628	x	2,512 sq.m.
*Including minimum 2 sq.m. Indoor Amenity per unit	628	x	1,296 sq.m.

5.2 Indoor Amenity Provided

Levels	Amenity	Total
Podium - Levels 3	370.0	370.0
Podium - Levels 4	235.0	235.0
Tower - Levels 5 - 6	150.0	300.0
Tower - Levels 31-32	150.0	300.0
Tower - Level 60-63	150.0	300.0
Total		1,505 sq.m.

5.3 Outdoor Amenity Provided

Levels	Total
Level 3	10.0
Level 4	250.0
Level 31	375.0
Level 62	375.0
Total	1,010 sq.m.

5.4 Total Amenity Provided

Total Amenity	Total
Total Amenity	2,515.0 sq.m.

6.0 BICYCLE SPACES

6.1 Bicycle spaces Required

Ratio	Bicycle Spaces
Retail Short Term Bicycle spaces	0.3 per 100 sq.m.
Retail Long Term Bicycle spaces	0.2 per 100 sq.m.
Residential Short Term Bicycle spaces	0.1
Residential Long Term Bicycle spaces	0.9
Total	636

6.2 Bicycle spaces Provided

Category	Bicycle Spaces
Ground Level - Indoor	98
P2 - vertical	16
P3 - vertical	288
P4 - vertical	235
Total	636

7.0 LOADING SPACE

Loading Space provided	Type
	1 Type G

1.0 BUILDING HEIGHT

Height Proposed	Height
	276 meter

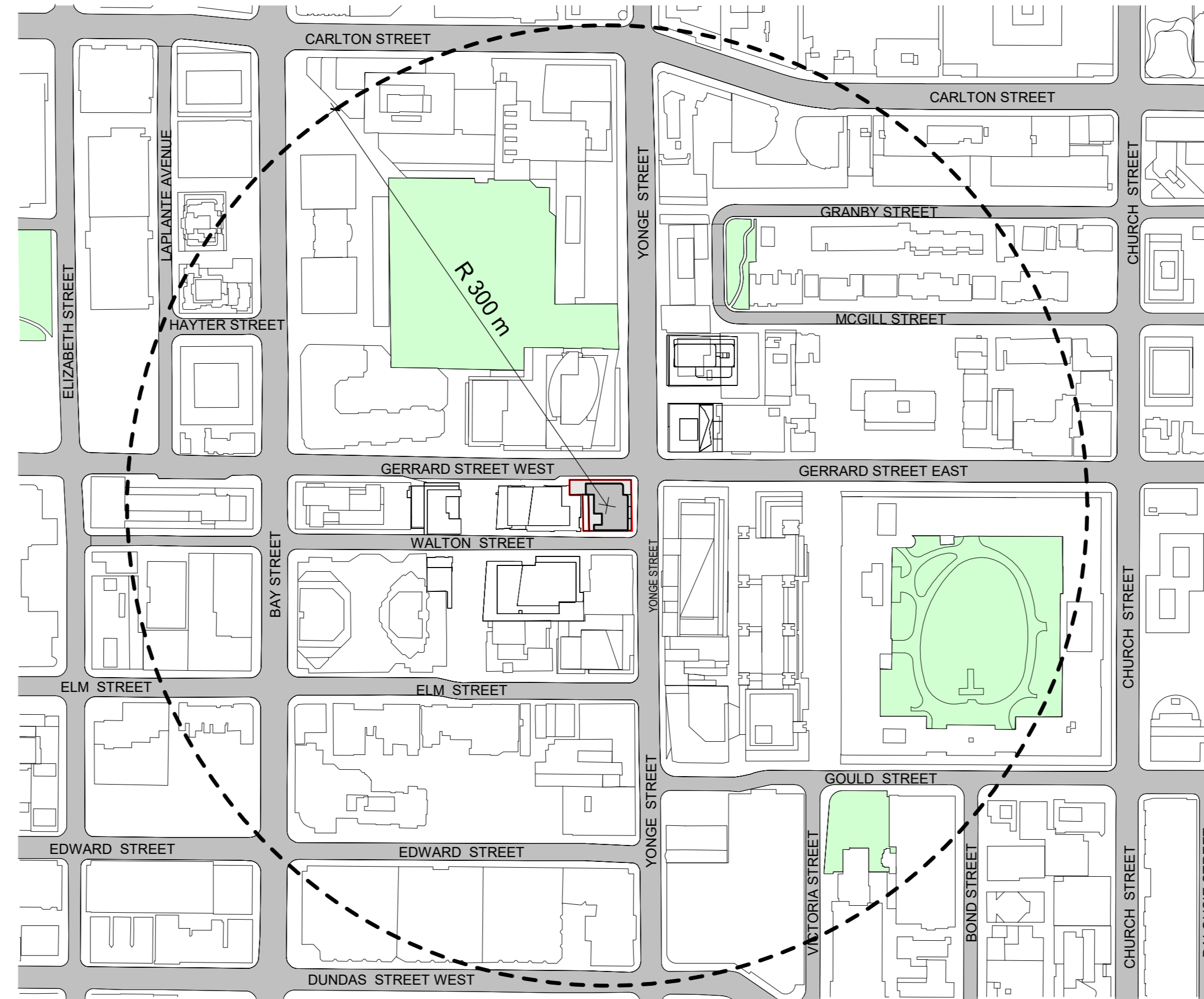

2 CONTEXT PLAN
SCALE: 1:2500

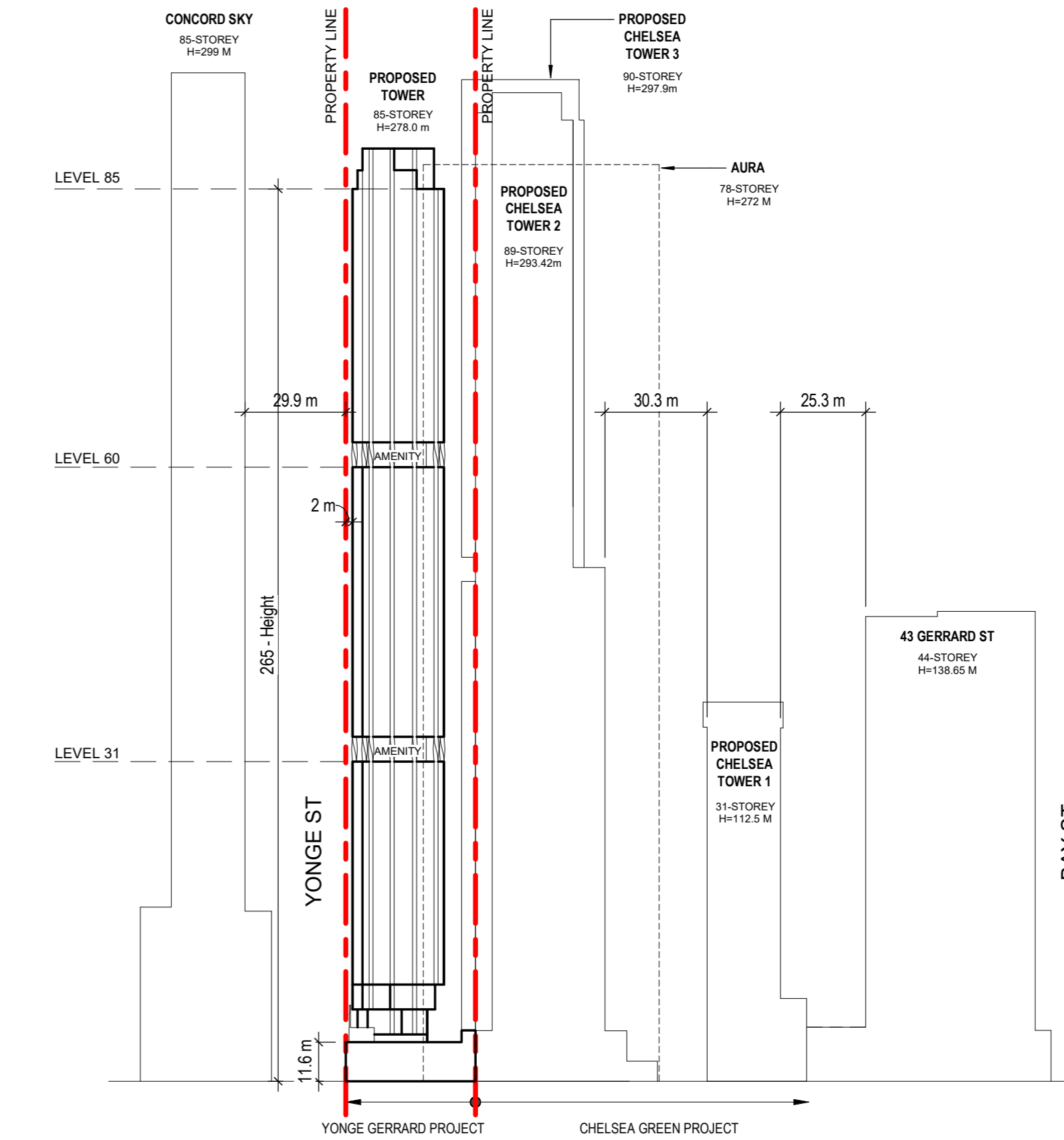

3 GERRARD CONTEXT ELEVATION
SCALE: 1:1500

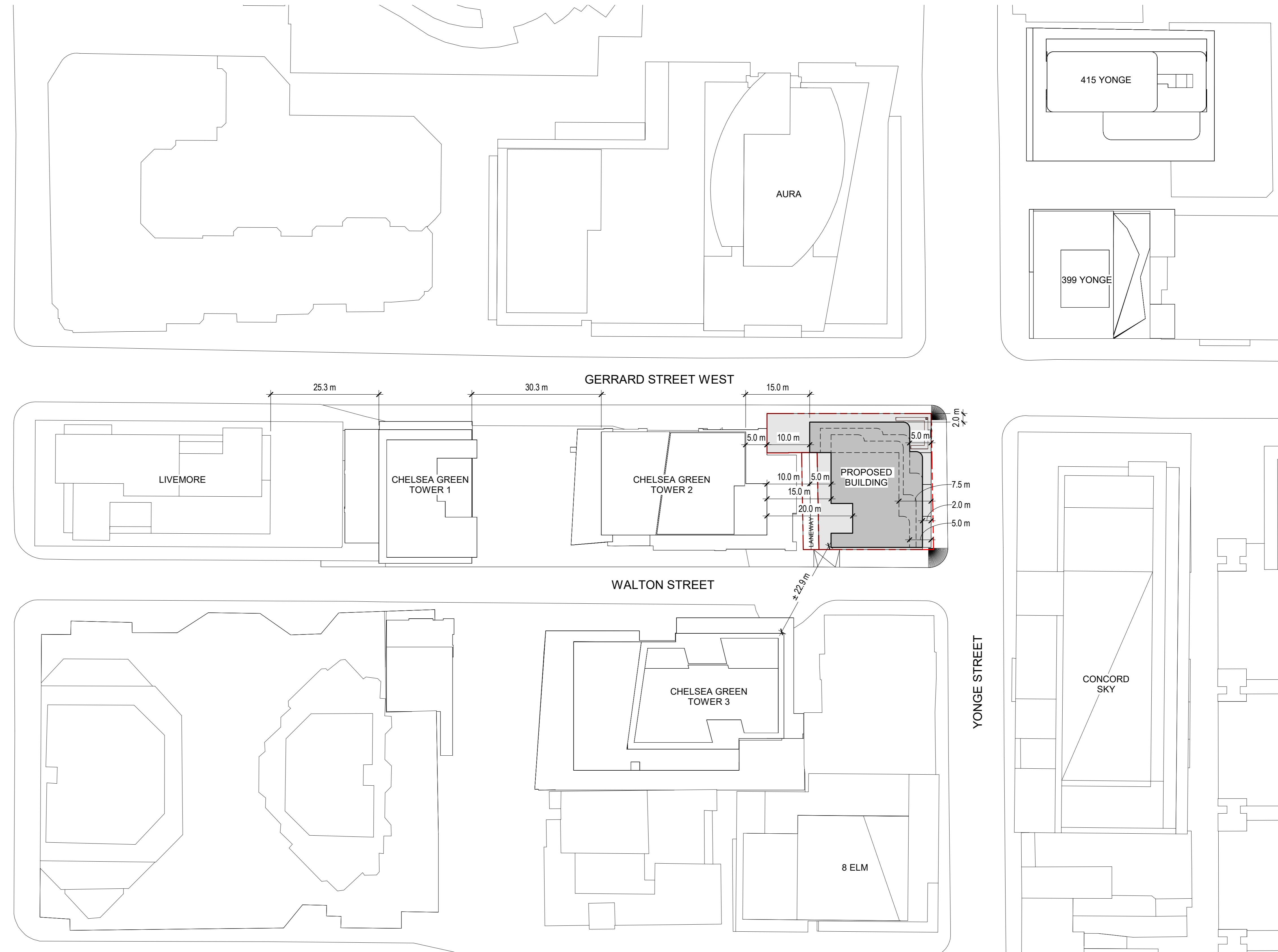

1 CONTEXT PLAN
SCALE: 1:500

ISSUED FOR

- 1 2020-06-11 ISSUED FOR ZBA
- 2 2021-09-08 REISSUED FOR ZBA
- 3 2021-09-08 ISSUED FOR SPA
- 4 2022-10-12 REISSUED FOR ZBA
- 5 2023-01-23 REISSUED FOR ZBA
- 6 2023-10-26 REISSUED FOR ZBA

METRIC

THIS DRAWING IS COPYRIGHTED AND MUST NOT BE USED, REPRODUCED, OR REVISED WITHOUT WRITTEN PERMISSION. ALL DIMENSIONS ARE IN MILLIMETERS UNLESS OTHERWISE NOTED. VERIFY DIMENSIONS DO NOT SCALE THIS DRAWING. REPORT INCONSISTENCIES AND OMISSIONS TO THE CONSULTANT FOR CLARIFICATION BEFORE COMMENCING WITH THE WORK. DEVIATIONS FROM THE CONTRACT DOCUMENTS WITHOUT WRITTEN APPROVAL FROM THE CONSULTANT ARE SUBJECT TO CORRECTION AT THE CONTRACTORS EXPENSE.

ARCHITECT & PRIME CONSULTANT

DIALOG
35 John St #500
Toronto, ON M5V 3G6
Tel: (416) 966-0220 Fax: (416) 966-8800

CIVIL ENGINEER
Courtesport Engineering Inc.
8395 Jane St, Suite 100
Vaughan, ON L4K 5Y2
Tel: (905) 326-1404 Fax: (905) 326-1404

LANDSCAPE ARCHITECT
Farris & Associates Inc
11 Church St
Toronto, ON M5E 1W1
Tel: (416) 366-6800 Fax: (416) 366-6800

STRUCTURAL ENGINEER
Jasany, Asif & Partners International
400-3 Concord Gate
Toronto, ON M5C 3M7
Tel: (416) 447-7405 Fax: (416) 447-7405

MECHANICAL ENGINEER
Smith + Anderson
100 Sheppard Ave E
North York, ON M2N 6N5
Tel: (416) 487-8151 Fax: (416) 487-8151

ELECTRICAL ENGINEER

Tel: Fax:

SEAL

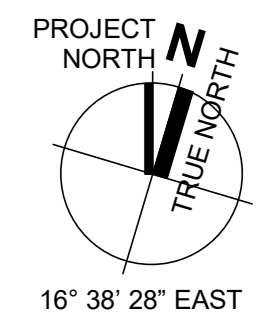

YONGE & GERRARD

CONTEXT PLAN

DRAWN: Author CHECKED: Checker
PLOT DATE: 2023-10-24 13:47:02

DP1.1

FOR SITE SERVICING AND GRADING REFER TO THE SITE SERVICING/GRADING PLAN PREPARED BY COUNTERPOINT ENGINEERING INC. DRAWINGS ESC-1, S-1, S-2, G-1, D-1 FOR THE PURPOSES OF OBTAINING SITE GRADING INFORMATION

SURVEY INFORMATION TAKEN FROM LOT A REGISTERED PLAN 145 LOTS 4, 5 AND 6 REGISTERED PLAN D-4 PART OF PARK LOT 9, CONCESSION 1, FROM THE BAY CITY OF TORONTO
 PREPARED BY: SCHAEFFER DZALDOV BENNETT LTD. ONTARIO LAND SURVEYORS
 64 JARDIN DRIVE, CONCORD, ONTARIO, L4K 3P3
 (416)987-0101

3 SITE SERVICE NOTE
 SCALE: N.T.S.

4 SURVEY CREDIT
 SCALE: N.T.S.

DIALOG	
25 John Street, Suite 300, Toronto, ON, Canada, M5V 3G6 Tel: (416) 966-0220	
Name of Project: 210 214 Yonge Street	
Location: 210, 214, 216, 218, 220, 222, 224, 226, 228, 230, 232, 234, 236, 238, 240, 242, 244, 246, 248, 250, 252, 254, 256, 258, 260, 262, 264, 266, 268, 270, 272, 274, 276, 278, 280, 282, 284, 286, 288, 290, 292, 294, 296, 298, 300, 302, 304, 306, 308, 310, 312, 314, 316, 318, 320, 322, 324, 326, 328, 330, 332, 334, 336, 338, 340, 342, 344, 346, 348, 350, 352, 354, 356, 358, 360, 362, 364, 366, 368, 370, 372, 374, 376, 378, 380, 382, 384, 386, 388, 390, 392, 394, 396, 398, 400, 402, 404, 406, 408, 410, 412, 414, 416, 418, 420, 422, 424, 426, 428, 430, 432, 434, 436, 438, 440, 442, 444, 446, 448, 450, 452, 454, 456, 458, 460, 462, 464, 466, 468, 470, 472, 474, 476, 478, 480, 482, 484, 486, 488, 490, 492, 494, 496, 498, 500, 502, 504, 506, 508, 510, 512, 514, 516, 518, 520, 522, 524, 526, 528, 530, 532, 534, 536, 538, 540, 542, 544, 546, 548, 550, 552, 554, 556, 558, 560, 562, 564, 566, 568, 570, 572, 574, 576, 578, 580, 582, 584, 586, 588, 590, 592, 594, 596, 598, 600, 602, 604, 606, 608, 610, 612, 614, 616, 618, 620, 622, 624, 626, 628, 630, 632, 634, 636, 638, 640, 642, 644, 646, 648, 650, 652, 654, 656, 658, 660, 662, 664, 666, 668, 670, 672, 674, 676, 678, 680, 682, 684, 686, 688, 690, 692, 694, 696, 698, 700, 702, 704, 706, 708, 710, 712, 714, 716, 718, 720, 722, 724, 726, 728, 730, 732, 734, 736, 738, 740, 742, 744, 746, 748, 750, 752, 754, 756, 758, 760, 762, 764, 766, 768, 770, 772, 774, 776, 778, 780, 782, 784, 786, 788, 790, 792, 794, 796, 798, 800, 802, 804, 806, 808, 810, 812, 814, 816, 818, 820, 822, 824, 826, 828, 830, 832, 834, 836, 838, 840, 842, 844, 846, 848, 850, 852, 854, 856, 858, 860, 862, 864, 866, 868, 870, 872, 874, 876, 878, 880, 882, 884, 886, 888, 890, 892, 894, 896, 898, 900, 902, 904, 906, 908, 910, 912, 914, 916, 918, 920, 922, 924, 926, 928, 930, 932, 934, 936, 938, 940, 942, 944, 946, 948, 950, 952, 954, 956, 958, 960, 962, 964, 966, 968, 970, 972, 974, 976, 978, 980, 982, 984, 986, 988, 990, 992, 994, 996, 998, 1000	
1. Project Description	2. Client
3. Design/Drawn By	4. Date
5. Revision/Checked By	6. Date
7. Title Block	8. Scale
9. Drawing No.	10. Drawing Date
11. Drawing Title	12. Drawing Description
13. Drawing Status	14. Drawing Version
15. Drawing Author	16. Drawing Designer
17. Drawing Checker	18. Drawing Approver
19. Drawing Date	20. Drawing Location
21. Drawing Project	22. Drawing Client
23. Drawing Site	24. Drawing Address
25. Drawing City	26. Drawing State
27. Drawing Country	28. Drawing Continent
29. Drawing Region	30. Drawing Sub-Region
31. Drawing District	32. Drawing Ward
33. Drawing Precinct	34. Drawing Sub-Precinct
35. Drawing Block	36. Drawing Lot
37. Drawing Parcel	38. Drawing Unit
39. Drawing Section	40. Drawing Sub-Section
41. Drawing Sub-Block	42. Drawing Sub-Lot
43. Drawing Sub-Parcel	44. Drawing Sub-Unit
45. Drawing Sub-Section	46. Drawing Sub-Sub-Section
47. Drawing Sub-Sub-Block	48. Drawing Sub-Sub-Lot
49. Drawing Sub-Sub-Parcel	50. Drawing Sub-Sub-Unit
51. Drawing Sub-Sub-Section	52. Drawing Sub-Sub-Sub-Section
53. Drawing Sub-Sub-Sub-Block	54. Drawing Sub-Sub-Sub-Lot
55. Drawing Sub-Sub-Sub-Parcel	56. Drawing Sub-Sub-Sub-Unit
57. Drawing Sub-Sub-Sub-Section	58. Drawing Sub-Sub-Sub-Sub-Section
59. Drawing Sub-Sub-Sub-Sub-Block	60. Drawing Sub-Sub-Sub-Sub-Lot
61. Drawing Sub-Sub-Sub-Sub-Parcel	62. Drawing Sub-Sub-Sub-Sub-Unit
63. Drawing Sub-Sub-Sub-Sub-Section	64. Drawing Sub-Sub-Sub-Sub-Sub-Section
65. Drawing Sub-Sub-Sub-Sub-Sub-Block	66. Drawing Sub-Sub-Sub-Sub-Sub-Lot
67. Drawing Sub-Sub-Sub-Sub-Sub-Parcel	68. Drawing Sub-Sub-Sub-Sub-Sub-Unit
69. Drawing Sub-Sub-Sub-Sub-Sub-Section	70. Drawing Sub-Sub-Sub-Sub-Sub-Sub-Section
71. Drawing Sub-Sub-Sub-Sub-Sub-Sub-Block	72. Drawing Sub-Sub-Sub-Sub-Sub-Sub-Lot
73. Drawing Sub-Sub-Sub-Sub-Sub-Sub-Parcel	74. Drawing Sub-Sub-Sub-Sub-Sub-Sub-Unit
75. Drawing Sub-Sub-Sub-Sub-Sub-Sub-Section	76. Drawing Sub-Sub-Sub-Sub-Sub-Sub-Sub-Section
77. Drawing Sub-Sub-Sub-Sub-Sub-Sub-Sub-Block	78. Drawing Sub-Sub-Sub-Sub-Sub-Sub-Sub-Lot
79. Drawing Sub-Sub-Sub-Sub-Sub-Sub-Sub-Parcel	80. Drawing Sub-Sub-Sub-Sub-Sub-Sub-Sub-Unit
81. Drawing Sub-Sub-Sub-Sub-Sub-Sub-Sub-Section	82. Drawing Sub-Sub-Sub-Sub-Sub-Sub-Sub-Sub-Section
83. Drawing Sub-Sub-Sub-Sub-Sub-Sub-Sub-Sub-Block	84. Drawing Sub-Sub-Sub-Sub-Sub-Sub-Sub-Sub-Lot
85. Drawing Sub-Sub-Sub-Sub-Sub-Sub-Sub-Sub-Parcel	86. Drawing Sub-Sub-Sub-Sub-Sub-Sub-Sub-Sub-Unit
87. Drawing Sub-Sub-Sub-Sub-Sub-Sub-Sub-Sub-Section	88. Drawing Sub-Sub-Sub-Sub-Sub-Sub-Sub-Sub-Sub-Section
89. Drawing Sub-Sub-Sub-Sub-Sub-Sub-Sub-Sub-Sub-Block	90. Drawing Sub-Sub-Sub-Sub-Sub-Sub-Sub-Sub-Sub-Lot
91. Drawing Sub-Sub-Sub-Sub-Sub-Sub-Sub-Sub-Sub-Parcel	92. Drawing Sub-Sub-Sub-Sub-Sub-Sub-Sub-Sub-Sub-Unit
93. Drawing Sub-Sub-Sub-Sub-Sub-Sub-Sub-Sub-Sub-Section	94. Drawing Sub-Sub-Sub-Sub-Sub-Sub-Sub-Sub-Sub-Sub-Section
95. Drawing Sub-Sub-Sub-Sub-Sub-Sub-Sub-Sub-Sub-Sub-Block	96. Drawing Sub-Sub-Sub-Sub-Sub-Sub-Sub-Sub-Sub-Sub-Lot
97. Drawing Sub-Sub-Sub-Sub-Sub-Sub-Sub-Sub-Sub-Sub-Parcel	98. Drawing Sub-Sub-Sub-Sub-Sub-Sub-Sub-Sub-Sub-Sub-Unit
99. Drawing Sub-Sub-Sub-Sub-Sub-Sub-Sub-Sub-Sub-Sub-Section	100. Drawing Sub-Sub-Sub-Sub-Sub-Sub-Sub-Sub-Sub-Sub-Sub-Section

2 OBC MATRIX
 SCALE: N.T.S.

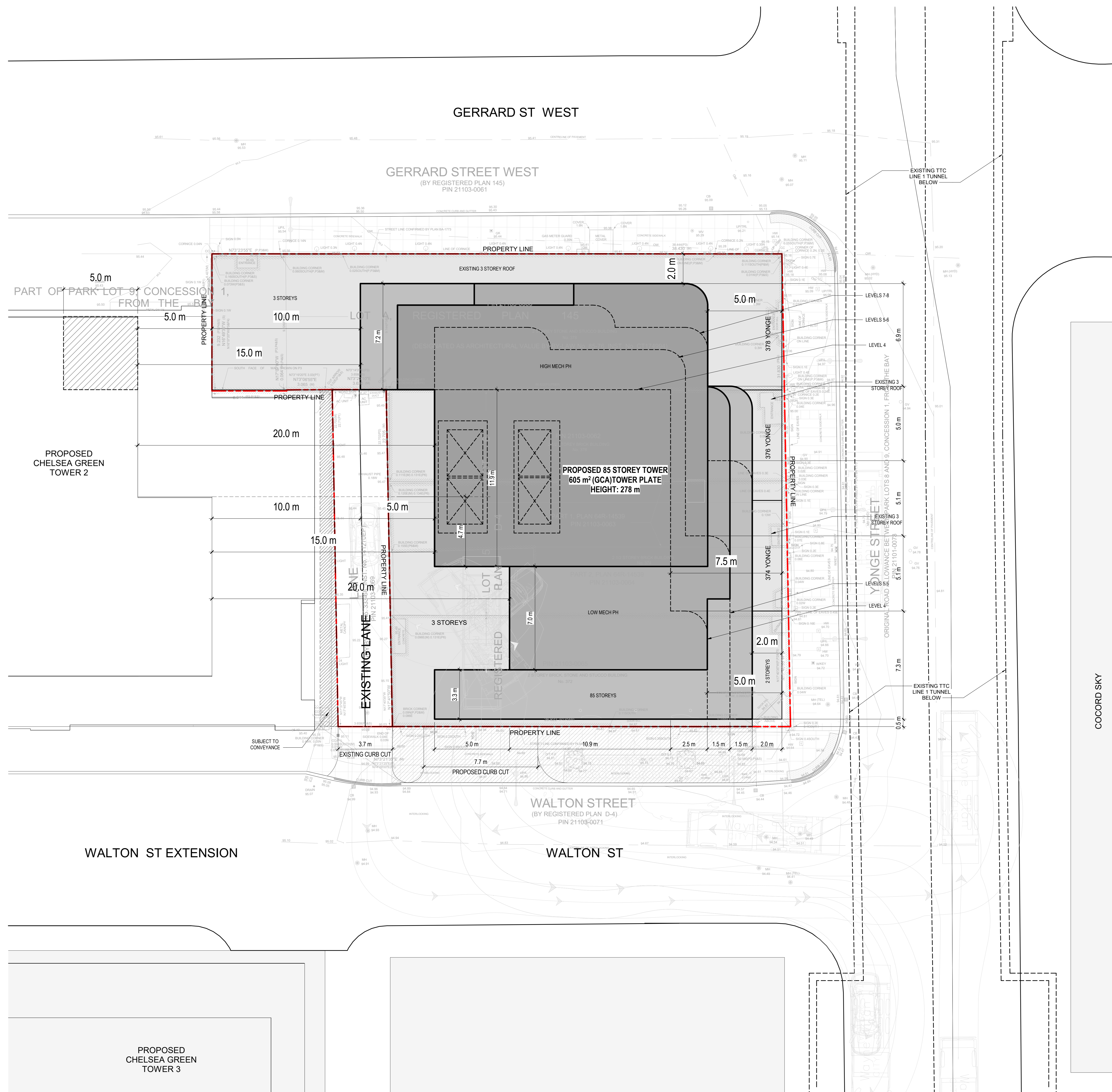

1 SITE PLAN
 SCALE: 1:100

ISSUED FOR

- 1 2020-06-11 ISSUED FOR ZBA
- 2 2021-09-08 REISSUED FOR ZBA
- 3 2021-09-08 ISSUED FOR SPA
- 4 2022-10-12 REISSUED FOR ZBA
- 5 2023-01-23 REISSUED FOR ZBA
- 6 2023-10-26 REISSUED FOR ZBA

METRIC

THIS DRAWING IS COPYRIGHTED AND MUST NOT BE USED, REPRODUCED, OR REVISED WITHOUT WRITTEN PERMISSION. ALL DIMENSIONS ARE IN MILLIMETERS UNLESS OTHERWISE NOTED. VERIFY DIMENSIONS DO NOT SCALE THIS DRAWING. REPORT INCONSISTENCIES AND OMISSIONS TO THE CONSULTANT FOR CLARIFICATION BEFORE COMMENCING WITH THE WORK. DEVIATIONS FROM THE CONTRACT DOCUMENTS WITHOUT WRITTEN APPROVAL FROM THE CONSULTANT ARE SUBJECT TO CORRECTION AT THE CONTRACTOR'S EXPENSE.

ARCHITECT & PRIME CONSULTANT

DIALOG
 25 John Street, Suite 300
 Toronto, ON M5V 3G6
 Tel: (416) 966-0220 Fax: (416) 966-0220

CIVIL ENGINEER

Counterpoint Engineering Inc.
 8395 Jane St, Suite 100
 Vaughan, ON L4K 5Y2
 Tel: (905) 326-1404 Fax: (905) 326-1404

LANDSCAPE ARCHITECT

Feris & Associates Inc
 11 Church St
 Toronto, ON M5E 1W1
 Tel: (416) 366-6800 Fax: (416) 366-6800

STRUCTURAL ENGINEER

Johnson, A&P Partners International
 400-3 Concorde Gate
 Toronto, ON M5C 3M7
 Tel: (416) 447-7405 Fax: (416) 447-7405

MECHANICAL ENGINEER

Smith + Anderson
 100 Sheppard Ave E
 North York, ON M2N 6N5
 Tel: (416) 487-8151 Fax: (416) 487-8151

ELECTRICAL ENGINEER

Tel: Fax:

SEAL

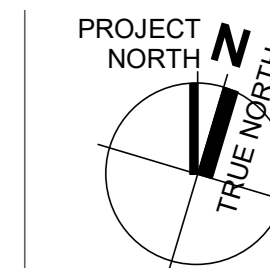

YONGE & GERRARD

SITE PLAN

DRAWN: Author CHECKED: Checker
 PLOT DATE: 2023-10-24 14:17:05

DP1.2

ABXXXXX - 111611

Autodesk Docs 0111611 - YONGE GERRARD MIX
 USE111611_YONGEGERRARD.rvt