

**Attachment 1**

With respect to lands municipally known in 2022 as 4711, 4723, 4733, 4751 Steeles Avenue East, 681 Silver Star Boulevard, 29 Redlea Avenue, 2901-2913, 3447 Kennedy Road, 3266, 3280, 3290, 3330, 3360 Midland Avenue, 50, 70 Silver Star Boulevard, 4016, 4020, 4040, 4140, 4186-4190 Finch Avenue East, 21 Trojan Gate, and 15-19 Milliken Boulevard:

- a. modify Map 2 in Appendix 1 by removing the lands from *Employment Areas*.
- b. modify Appendix 2 by re-designating from *General Employment Areas* and *Core Employment Areas* to *Regeneration Areas*.
- c. add a new Chapter 7 Site and Area Specific Policy 853.

**853. 4711, 4723, 4733, 4751 Steeles Avenue East, 681 Silver Star Boulevard, 29 Redlea Avenue, 2901-2913, 3447 Kennedy Road, 3266, 3280, 3290, 3330, 3360 Midland Avenue, 50, 70 Silver Star Boulevard, 4016, 4020, 4040, 4140, 4186-4190 Finch Avenue East, 21 Trojan Gate, and 15-19 Milliken Boulevard**

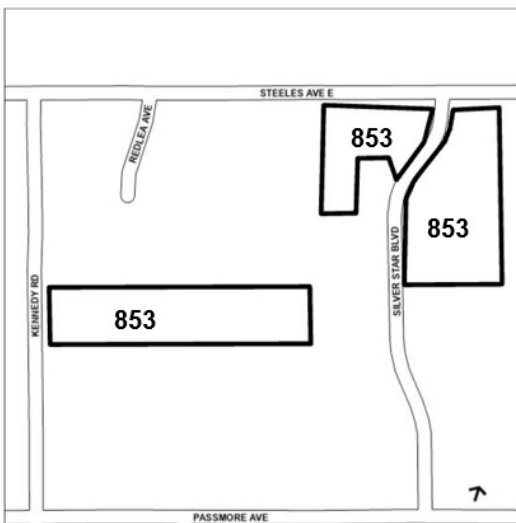

a) All uses permitted under the *Regeneration Areas*, *General Employment Areas*, and *Core Employment Areas* including interim uses, with the exception of residential uses, overnight accommodations, and live-work uses, are permitted on the lands prior to the completion of a Secondary Plan or Site and Area Specific Policy.

b) For the lands north of Finch Avenue East and south of Passmore Avenue, residential uses and live-work uses, or any land uses not permitted in *General Employment Areas*, *Core Employment Areas* or *Regeneration Areas*, may only be permitted once the GO Transit Station to be located on Finch Avenue East (Finch-Kennedy Station) is operational.

c) Prior to the re-designation of lands from *Regeneration Areas* to any other land use, a Compatibility/Mitigation Study will be prepared, in accordance with Policies 2.2.4.5 to 2.2.4.10 of the Official Plan. The Compatibility/Mitigation Study will identify:

i) any uses and Major Facilities on *Core* and *General Employment Areas* outside of but near to the Subject Lands that may impact or be impacted by sensitive land uses, including residential uses;

ii) the Influence Area of any Major Facility outside of but near to the Subject Lands; and

iii) potential and/or required mitigation measures for land use designations that permit residential or other sensitive land uses near *Core Employment Areas* and *General Employment Areas* outside of the Subject Lands.

d) In addition to the matters identified in Policy 2 of Section 4.7, *Regeneration Areas*, the area study leading to the Secondary Plan or Site and Area Specific Policy will include:

i) A Land Use Plan that provides for the redesignation of *Regeneration Areas* lands to *Mixed Use Areas* and/or *General Employment Areas* and/or *Institutional Areas* and/or *Parks and Open Space* as appropriate. The Land Use Plan will:

A) inform building heights and densities across the lands to be included within the Secondary Plan or Site and Area Specific Policy;

B) determine the minimum employment gross floor area, which will exceed the existing employment gross floor; and

C) determine the list of permitted non-residential uses, comprised of uses permitted in *Core* and *General Employment Areas*, that are compatible

with residential uses as well as maximum percentages of these uses that contribute to the employment gross floor area.

ii) A Phasing Strategy and Implementation Plan to provide for the sequencing of development, including the provision of infrastructure and services.

A) the Phasing Strategy must set out the amount of non-residential gross floor area to be constructed in each phase, prior to, or concurrent with residential gross floor area to provide a balance of employment and residential growth in all phases of development;

iii) A Community Services and Facilities Strategy that identifies community space and facilities needs and sets out priorities to support growth which may include potential locations and phasing as well as opportunities for co-location;

iv) A Block Context Plan that applies the City's "Complete Streets" principles and establishes a network of public streets, development blocks, pedestrian and cycling facilities and connections, and parks and open spaces that contributes to a safe, comfortable and connected public realm;

v) A Parks and Open Space Plan that identifies locations of new public parks;

vi) Urban Design Guidelines that set out the framework for the appropriate built form;

vii) An Infrastructure Master Plan that identifies water, sanitary, stormwater infrastructure requirements and development strategy including downstream improvements;

viii) A Green Infrastructure Strategy that includes consideration of low impact development, stormwater management systems, and trees;

ix) A Transportation Analysis that includes the impacts of the change in use on goods movement in the larger area of employment; and

x) An Economic Development Study and Strategy and Commercial Demand Analysis that identifies the maximum potential of contextually appropriate and compatible employment uses that can be integrated in new developments on lands redesignated *Mixed Use Areas*.

e) The Secondary Plan or Site and Area Specific Policy will also include a Housing Plan where new development containing residential units on the lands will secure a minimum amount of affordable housing as follows:

i) if a condominium development is proposed, a minimum of 7 percent of the total new residential gross floor area shall be secured as affordable ownership housing or a minimum of 5 percent of the total new residential gross floor area shall be secured as affordable rental housing; and

ii) the affordable housing shall be secured at affordable rents or affordable ownership prices for a period of at least 99 years from the date of first residential occupancy of the unit; and

iii) the unit mix of the affordable housing shall reflect the market component of the development, as appropriate, to achieve a balanced mix of unit types and sizes and support the creation of affordable housing suitable for families; and

iv) if a purpose-built rental development is proposed, there is no minimum requirement for affordable rental housing.

f) Where a complete application for a Zoning By-law Amendment has not been filed prior to January 1, 2025, the affordable rental housing required in Policy e) i) will increase by 1.5 percent per year. Affordable ownership housing requirements will be set at 1.4 times the affordable rental housing requirements.

g) The provision of affordable housing required by Policy e) and Policy f) shall be secured through one or more agreements with the City.

h) The use of holding provisions may be used to ensure the required affordable housing is secured. Conditions to be met prior to the removal of a holding ("H") provision on the lands shall include the following:

Attachment 1 to Motion "5.e" by Councillor Brad Bradford

- i) Entering into a Municipal Housing Project Facility Agreement or such other agreement(s) as may be satisfactory to the City Solicitor to secure the provision of affordable housing; and
  - ii) The submission and acceptance of a Housing Issues Report, to the satisfaction of the Chief Planner and Executive Director, that identifies the unit mix, unit sizes, and how affordable housing requirements will be met.
- i) If an Inclusionary Zoning By-law takes effect and becomes applicable to any development on the lands, then the Official Plan Inclusionary Zoning policies and by-law, as may be amended, will prevail and the affordable housing requirements in Policy e) and Policy f) will no longer apply, but only provided the applicable Inclusionary Zoning policy and by-law requirements meet or exceed the requirements of Policy e) and Policy f) above.
- j) As part of a complete Zoning By-law Amendment application for the lands:
- i) a Rail Safety and Rail Mitigation Report shall be submitted, peer reviewed and implemented to the City's satisfaction, and reviewed by the applicable rail operator; and
  - ii) a Compatibility/Mitigation Study shall be submitted that will be peer reviewed, at the applicant's expense, and implemented to the City's satisfaction, which may include lifting any holding provisions established through the Secondary Plan or Site and Area Specific Policy, pursuant to Policy d) above.
- k) Sensitive land uses, including new residential uses will be located, designed and buffered to mitigate impacts from, be compatible with, and not impede the continuation of and the expansion of existing employment uses, and any new employment uses within the surrounding *General* and *Core Employment Areas*.