

Attachment 1: Recommended Alignments and Designs

Disclaimer:  
The alignment curve on existing  
O'Connor Drive west of Victoria Park  
Avenue is subject to change.  
March 08, 2024.



DRAFT FOR DISCUSSION

O'CONNOR DRIVE RECONFIGURATION AND EXTENSION - ALIGNMENT 1b

PLAN

**GOLDEN MILE EA**

O'CONNOR DRIVE TO PHARMACY AVENUE



DRAWING  
NUMBER

**EXHIBIT 01d**

DATE: MAR 2024

Note: Alignment reflects a general alignment and does not reflect right-of-way requirements at key intersextions

# O'Connor Drive (2 Lanes) Reconfiguration

27.0m ROW

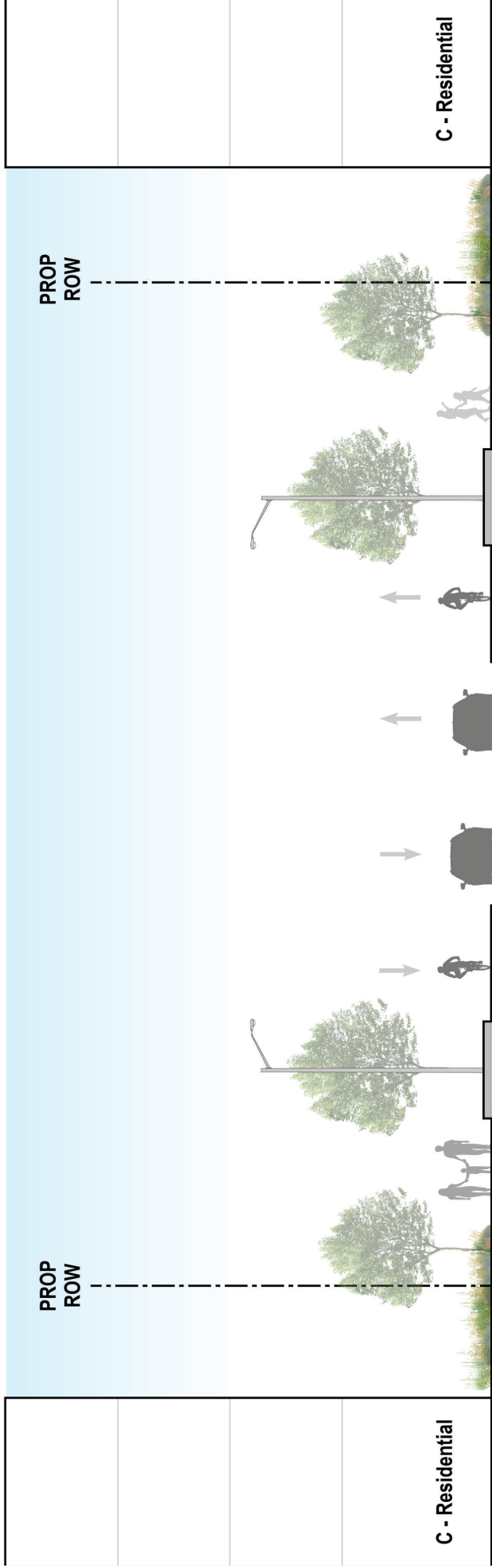

N

S

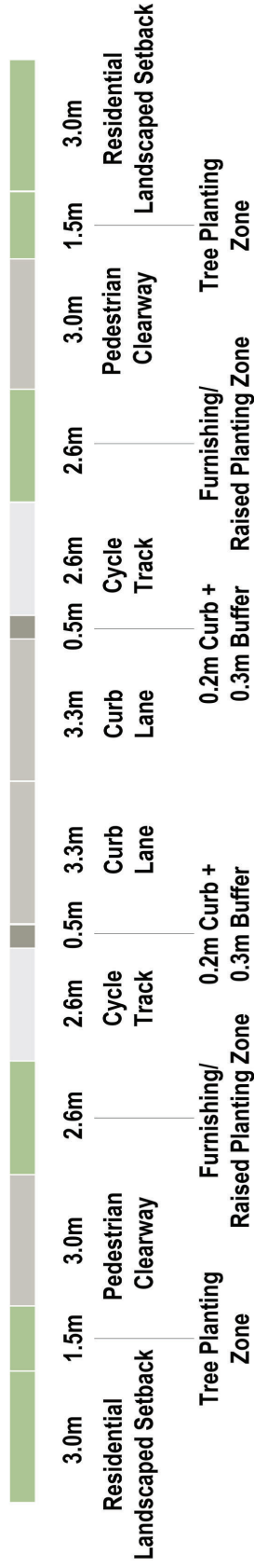

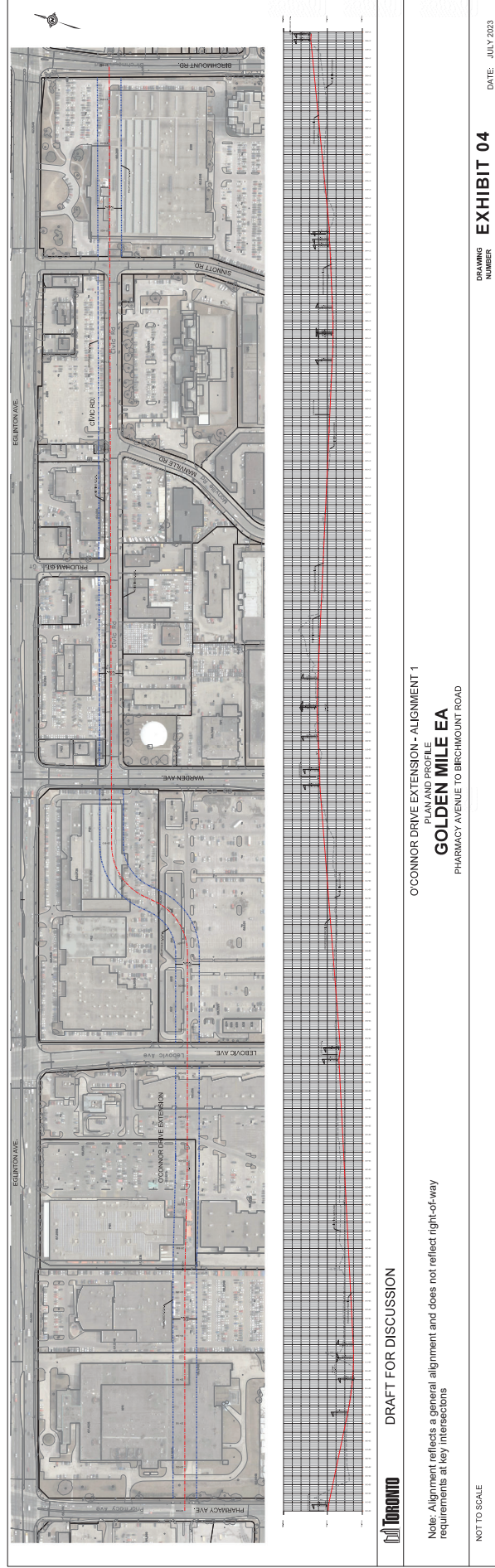

DRAFT FOR DISCUSSION

O'CONNOR DRIVE EXTENSION - ALIGNMENT 1  
 PLAN AND PROFILE  
**GOLDEN MILE EA**  
 PHARMACY AVENUE TO BIRCHMOUNT ROAD

Note: Alignment reflects a general alignment and does not reflect right-of-way requirements at key intersections

NOT TO SCALE

DRAWING NUMBER **EXHIBIT 04**

DATE: JULY 2023

**O'Connor Drive (2 Lanes) Extension to  
Birchmount Road**

27.0m ROW

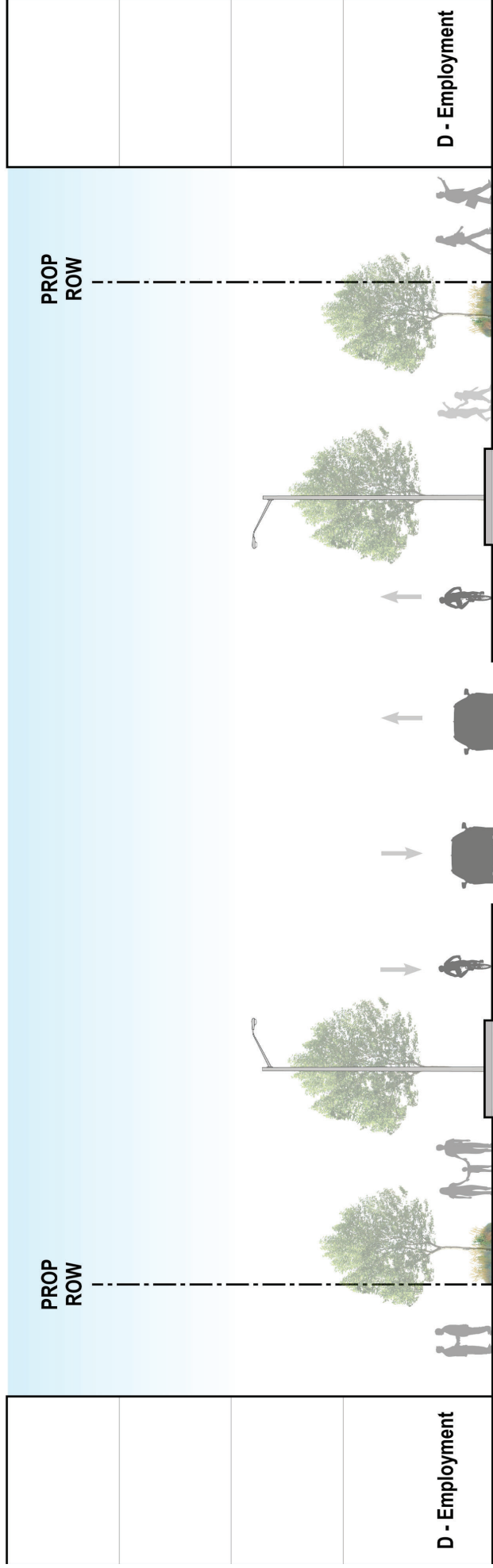

N

S

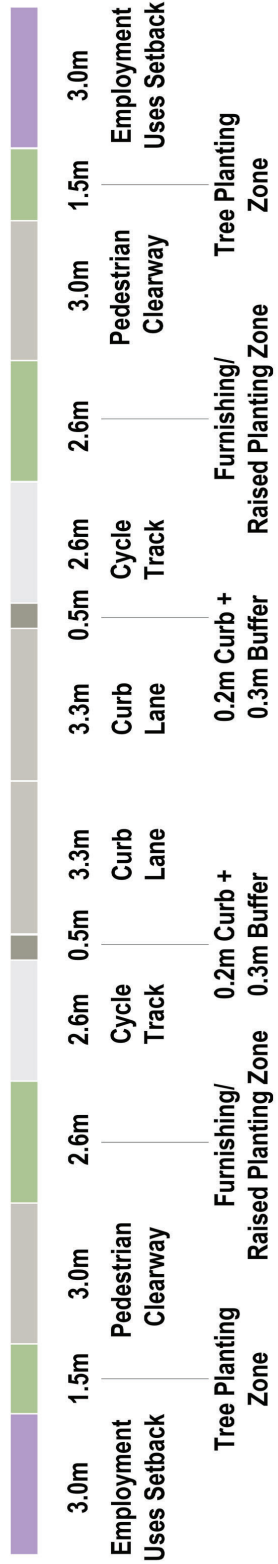



# Golden Mile Blvd (New Road) West Park to Birchmount Road

27.0m ROW

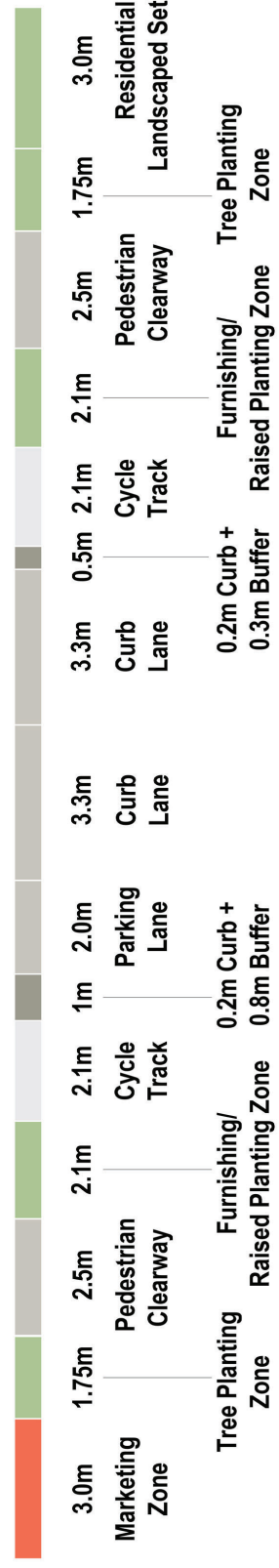
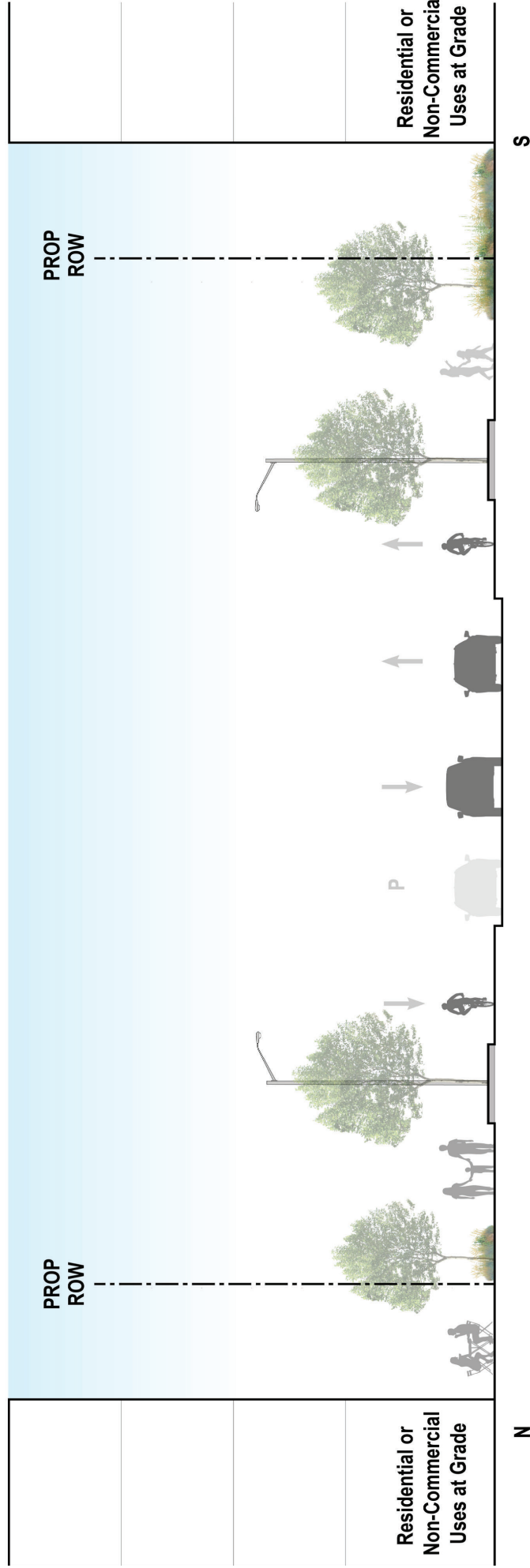

**Golden Mile Blvd (New Road) Victoria Park Ave to West Park (No Parking with Trees)**

20.0m ROW

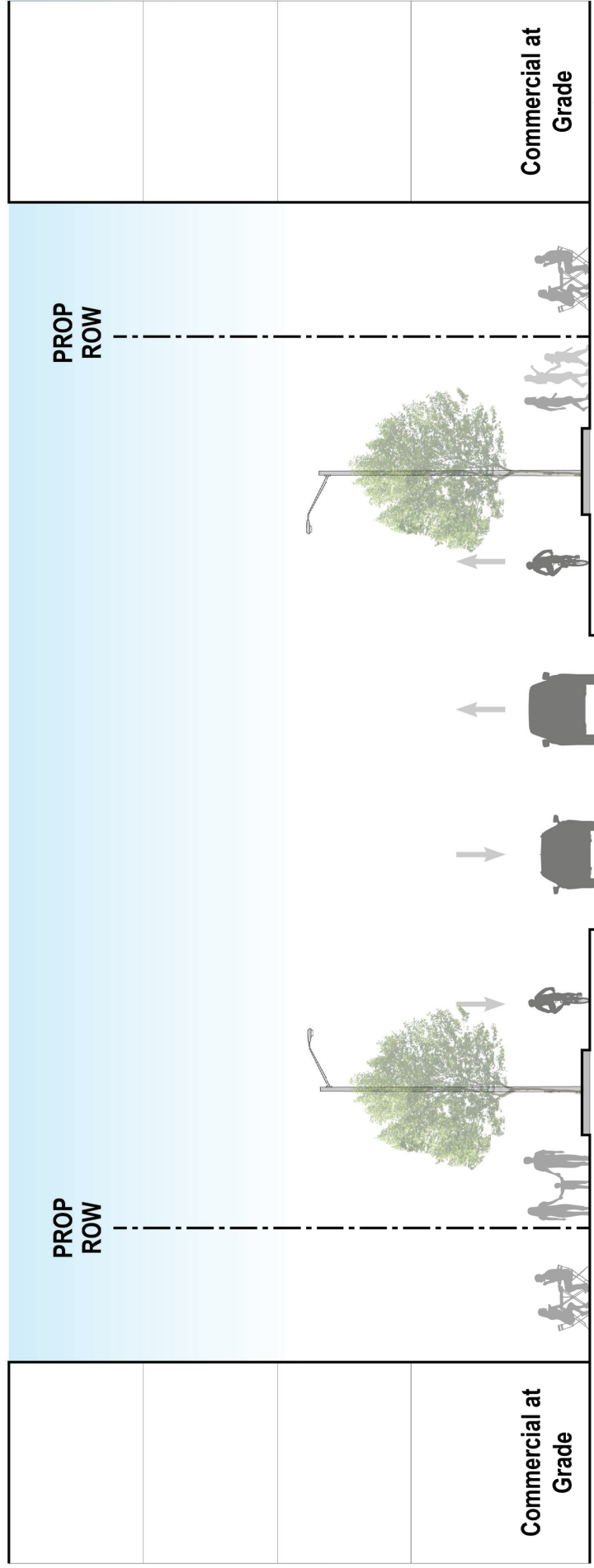

S

N

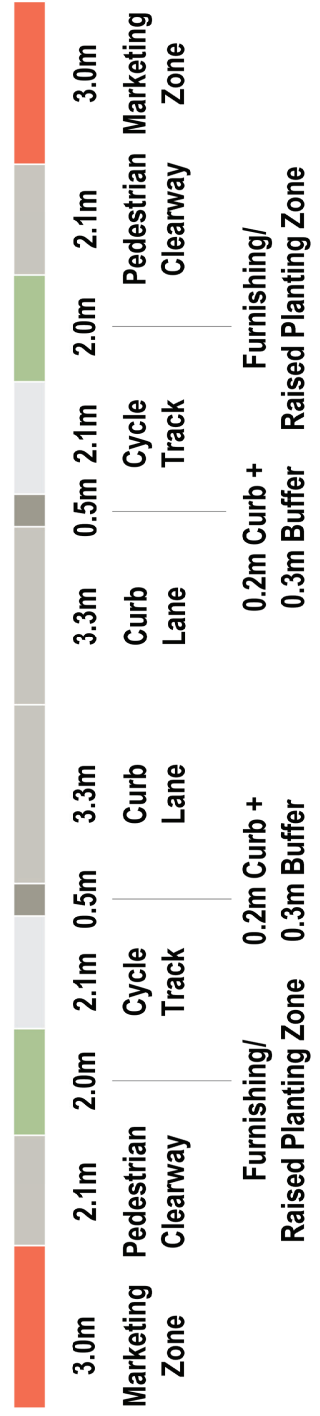

SvN

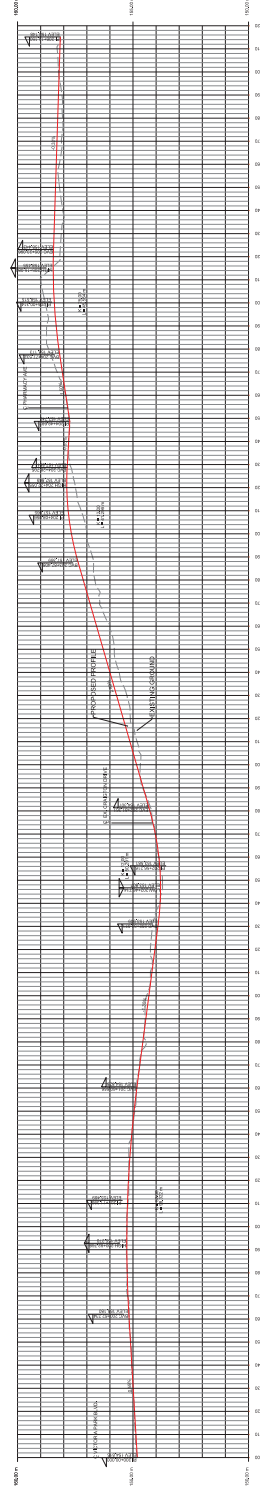
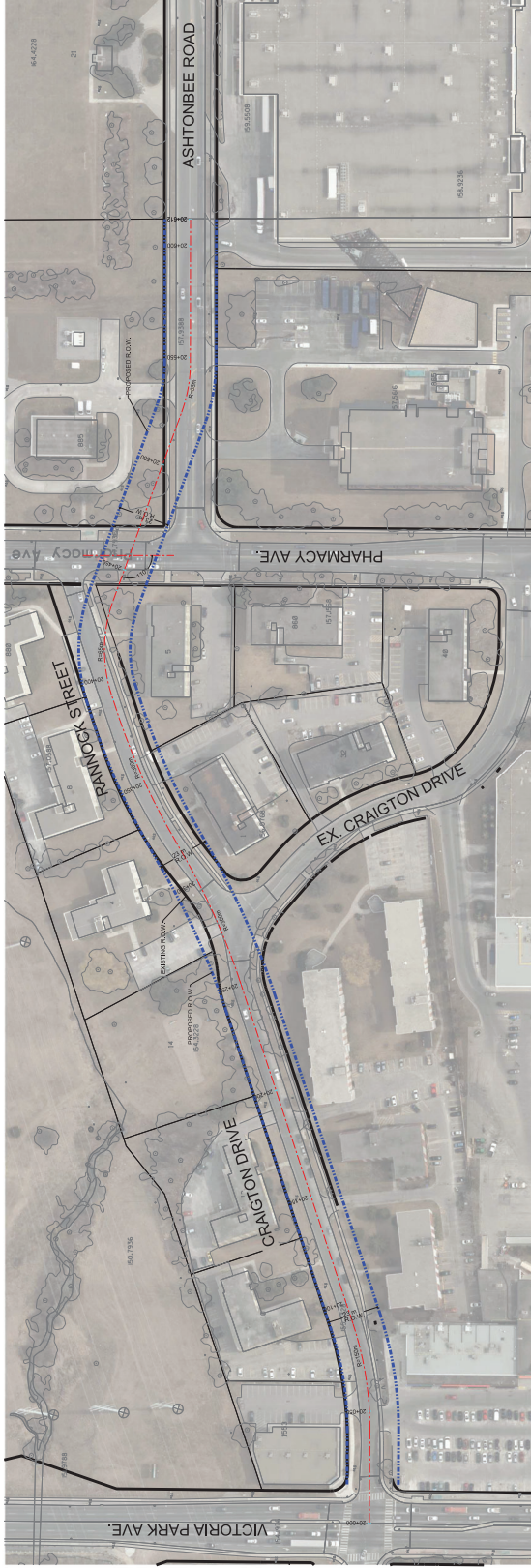

DRAFT FOR DISCUSSION

CRAIGTON DRIVE RECONFIGURATION - ALIGNMENT 2

PLAN AND PROFILE

**GOLDEN MILE EA**

VICTORIA PARK AVENUE TO PHARMACY AVENUE

Note: Alignment reflects a general alignment and does not reflect right-of-way requirements at key intersections

NOT TO SCALE

DRAWING NUMBER

**EXHIBIT 16**

DATE: JULY 2023



**Craigton Dr (2 Lanes) Victoria Park  
Ave to Birchmount Road**

23.0m ROW

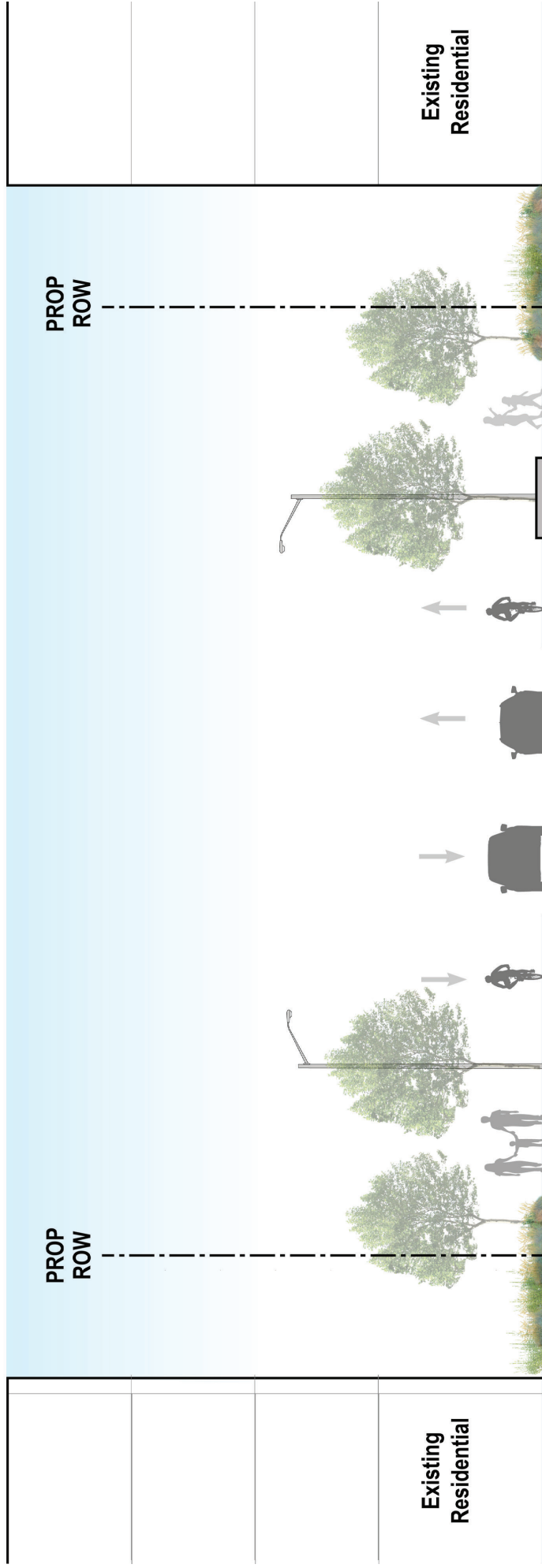

N

S

3.0m	1.5m	2.1m	2.0m	2.1m	0.5m	3.3m	0.5m	2.1m	2.0m	2.1m	1.5m	3.0m
Residential Landscaped Setback	Pedestrian Clearway	Cycle Track	Curb Lane	Curb Lane	Cycle Track	Curb Lane	0.2m Curb + 0.3m Buffer	Pedestrian Clearway	Furnishing/ Raised Planting Zone	Pedestrian Clearway	Tree Planting Zone	Residential Landscaped Setback

SvN

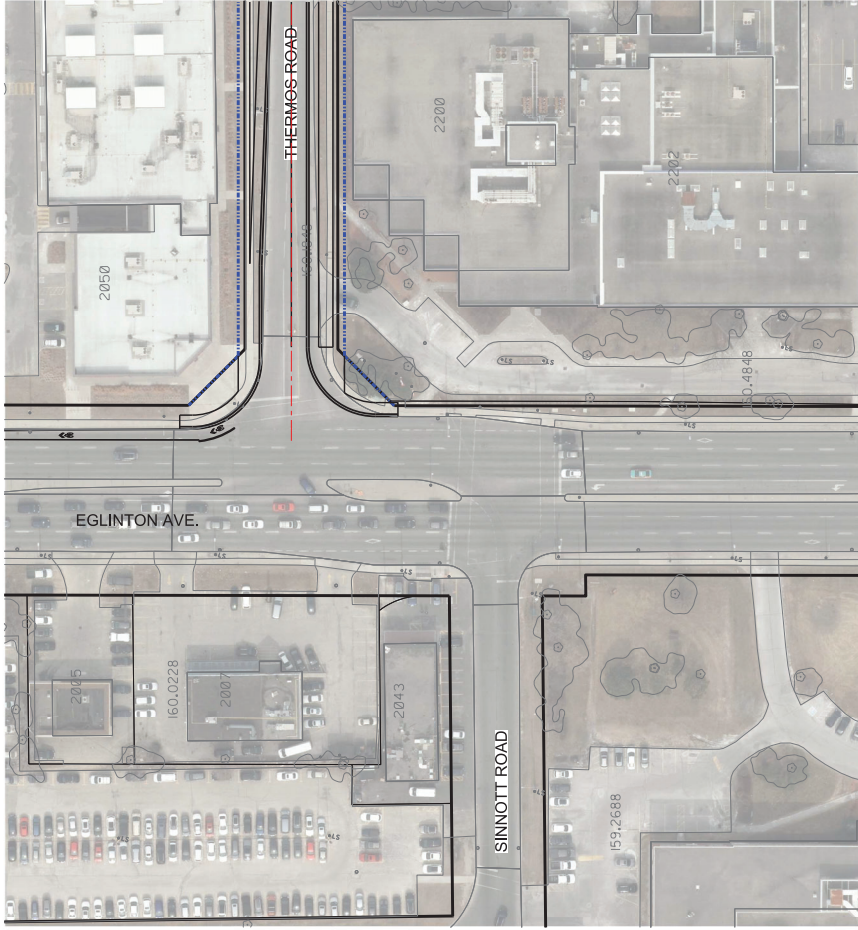

DRAFT FOR DISCUSSION

POTENTIAL RECONFIGURATION OF THERMOS ROAD & SINNOTT ROAD AT EGLINTON AVENUE - DO NOTHING + OPTION

PLAN AND PROFILE

**GOLDEN MILE EA**

CIVIC ROAD TO ASHTONBEE ROAD

Note: Alignment reflects a general alignment and does not reflect right-of-way requirements at key intersections

NOT TO SCALE

DRAWING NUMBER

**EXHIBIT 18**

DATE: JULY 2023

# Thermos Road/Sinnott Road

23.0m ROW

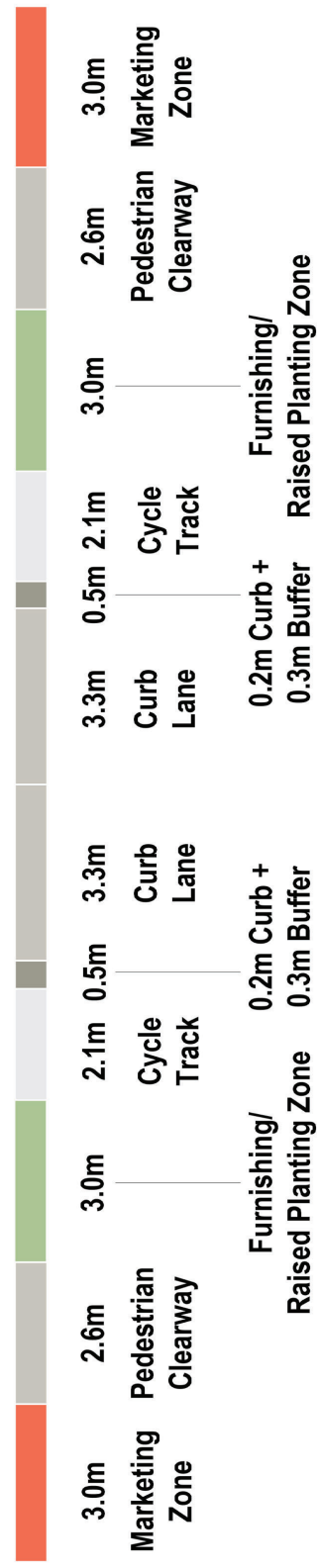
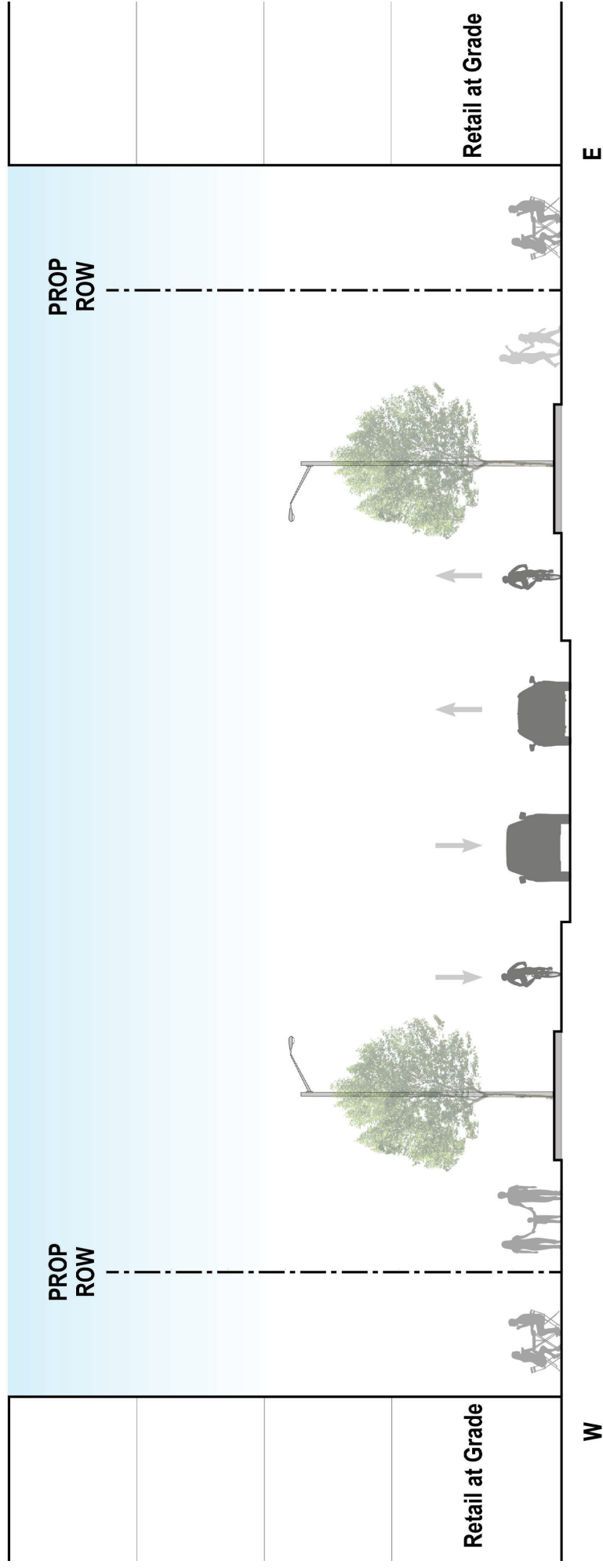

SvN