



PB25.2

94 Cortleigh Boulevard– Notice of Intention to Designate a Property under Part IV, Section 29 of the Ontario Heritage Act

PB25.2 94 Cortleigh Blvd.

This location map is for illustrative purposes only; the exact boundaries of the property are not shown.

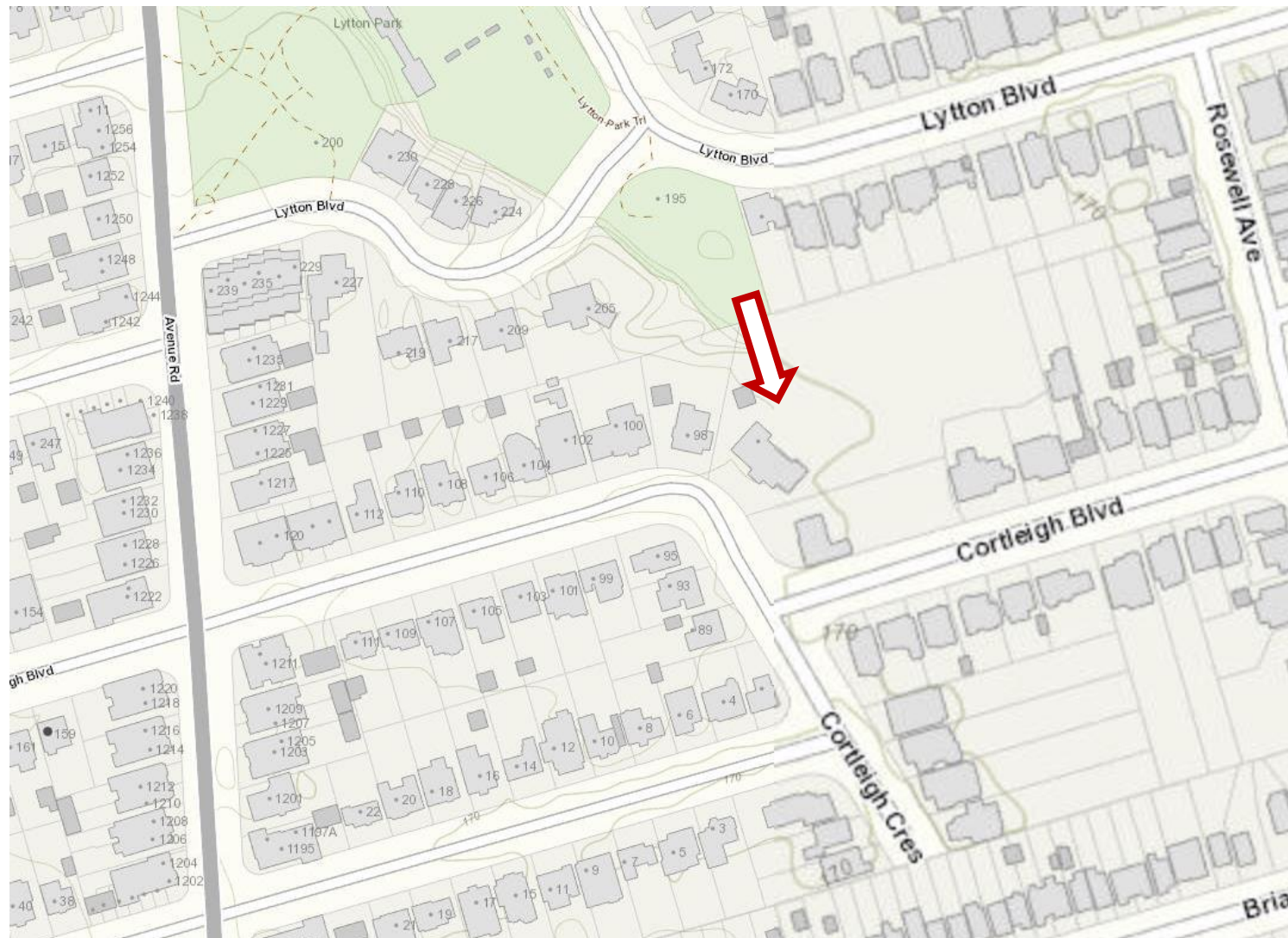

PB25.2
94 Cortleigh Blvd.

(l) Canadian Builder and Carpenter,
December 1915 and (r) January 1916
(University of Toronto Archives)

10 Advertisers, 34 Editorial Pages, 9

December, 1915

Price List - 30

TH
1
C254
v. 5
no. 12
c. 1
ENGS

**The Canadian
Builder and Carpenter**

Published Monthly by The Commercial Press, Limited, 32 Colborne St., Toronto

Who also publish: The Canadian Manufacturer, The Canadian Clay-Worker, Motoring, The Electrical Dealer and Contractor, Canadian Hardware Journal, Canadian Furniture World, The Retail Grocer and Provisioner, The Retail Druggist of Canada, and The Canadian Nurse.

ONE OF TORONTO'S MANY BEAUTIFUL HOMES

WE HAVE sixteen illustrations showing the plans, elevations and various rooms of the beautiful residence shown on this cover. The descriptive article will cover several pages and many hints will be given which may be incorporated in less costly houses. The electrical system is fully described showing how builders must provide for the growing use of electric current.

Building permits in particular and business generally show large increases in November 1915 over the same month last year. Your business will soon feel the upward trend. The advertisers in the Canadian Builder & Carpenter are prepared to supply your needs no matter how large they may be.

UNIVERSITY OF TORONTO LIBRARY
1915
987

10 THE CANADIAN BUILDER AND CARPENTER. January, 1916



Fig. 2—Back of grey stone and brick house, showing balcony, etc. See detail photo of balcony and lighting of same.



Fig. 3—Detail view of balcony, showing wall lighting fixture.



Fig. 4—Wardrobe in bedroom No. 1. A light is placed to shine into one wardrobe, shown at the right.

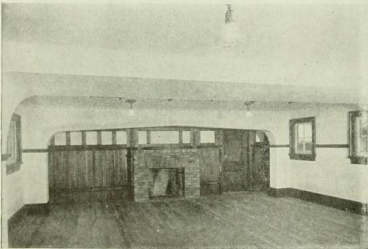

Fig. 5—Children's playroom, in basement, showing fireplace and ceiling lights.



Fig. 6—Living room looking towards palm room. See fireplace and fireplace lights and central fixture.

PB25.2
94 Cortleigh Blvd.

top: corbel and stone brackets below eaves

bottom: window aprons

right: rear façade showing partial removal of verandah

(All 2024, City of Toronto Heritage Planning)



PB25.2 94 Cortleigh Blvd.

below: Atlas of the City of Toronto, 1913 (Chas. E. Goad Company) showing location and context of 94 Cortleigh Boulevard (notated by blue arrow)

right: Toronto Daily Star, May 28, 1910 (Proquest - Toronto Public Library)

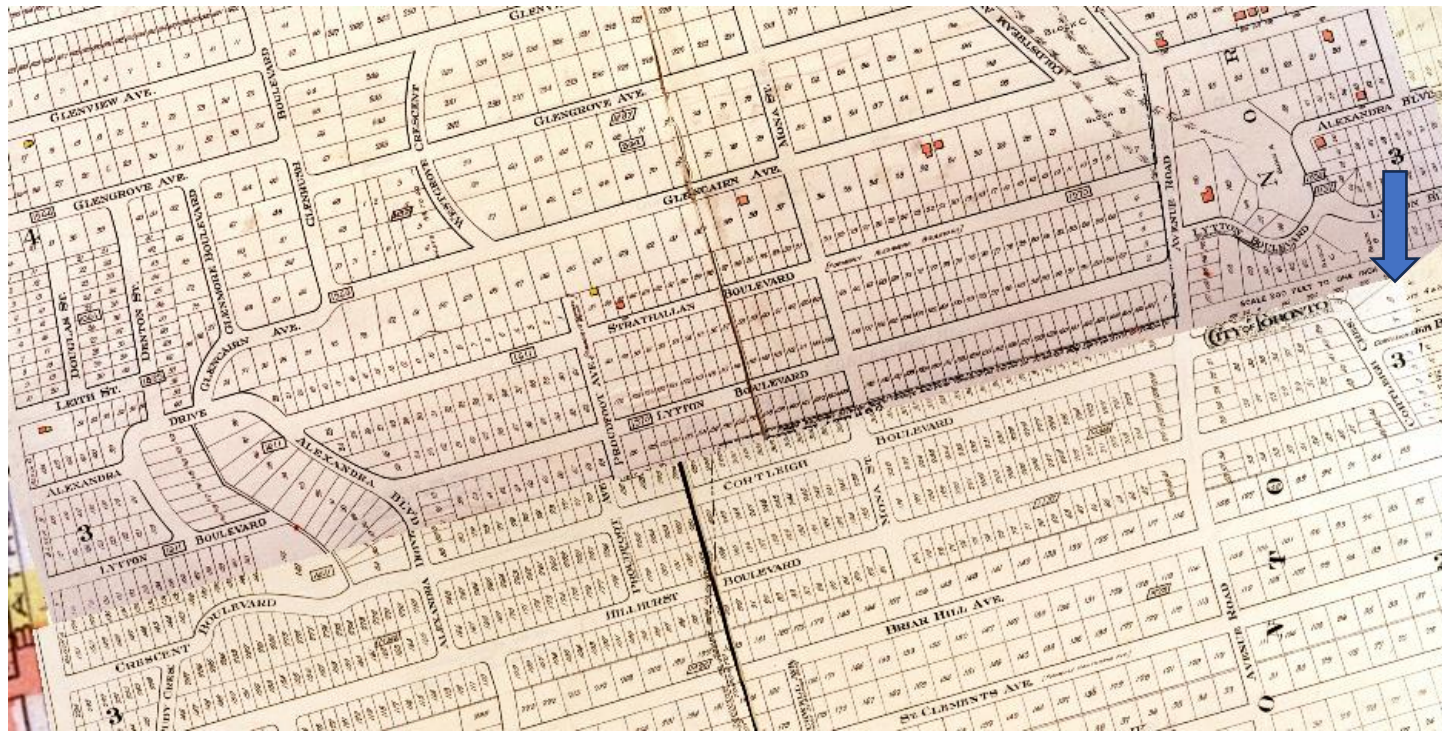

*For a Home---
As an Investment*



The Ravine in Alexandra Gardens set aside for a Park

ALEXANDRA GARDENS

"On the Highlands of Toronto"

Alexandra Gardens is accounted to be the finest location in the ideal residential suburb of North Toronto:—south of Glen Grove, opposite Victoria avenue. It stands on the highest point of land overlooking Toronto from any direction. It is beautifully wooded. The southeastern portion facing Yonge street is covered by an apple orchard. The land rises gradually westward, terminating in a beautiful ravine immediately east of Avenue road. This ravine is set aside for park purposes for the residents of Alexandra Gardens.

There is no question as to the investment value of land bought in Alexandra Gardens at present prices. Values will advance rapidly, and equal or exceed prevailing prices in the north central high-class residential district. The property is already surrounded by fine residences, and there is great activity in real estate throughout the district. So sure are the owners of Alexandra Gardens that there will be a steady increase in value in real estate in this district, and particularly in Alexandra Gardens, that they are prepared to make liberal advances to a limited number of purchasers of lots who desire to build themselves suitable homes. The building restrictions are very reasonable—only such as will ensure the erection of fireproof dwellings of neat architectural design.

**Roads have been Extended—Granolithic Sidewalks laid—Building Operations began two weeks ago.
See Alexandra Gardens and reserve a lot.**

Ussher, Strathy & Co.

North Toronto Agents
PHONE N. 1330

Get off at STOP 19, on the Metropolitan car, or Phone Main 7475 and make an appointment for an Automobile ride to "Alexandra Gardens"

The Trusts and Guarantee Co., Limited

Managers for the Owners

45 KING STREET WEST, TORONTO

Send to my address plans and terms of purchase for lots in "Alexandra Gardens."

STAR

PB25.2
94 Cortleigh Blvd.

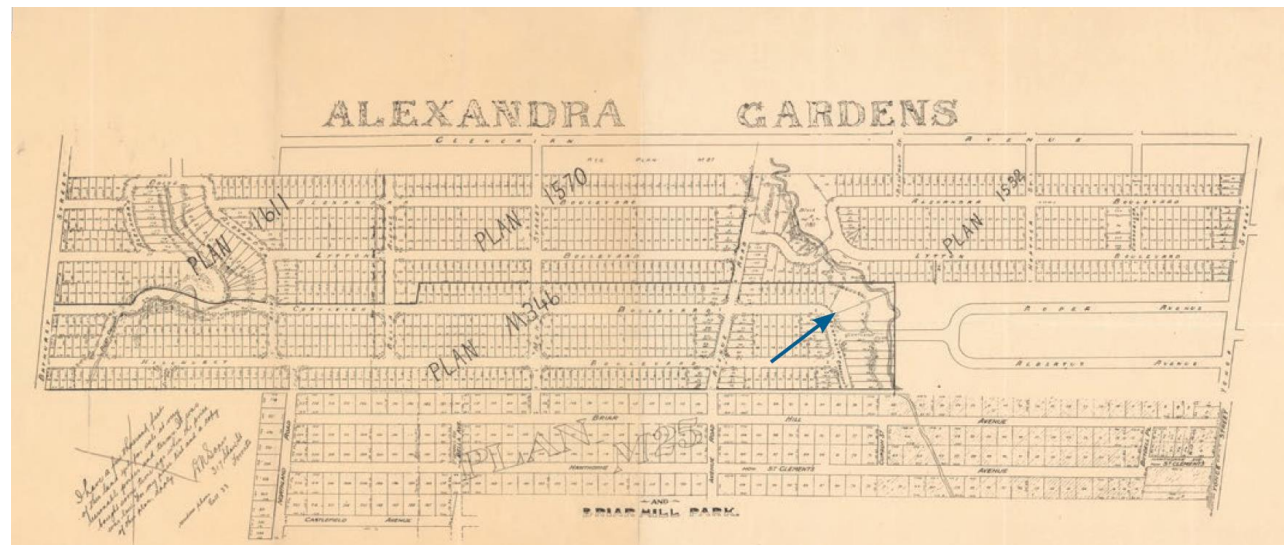

above: 1915 plan of the Alexander Gardens subdivisions comprising Registered Plans 1611, 1570, 1532, and M346 (City of Toronto Archives)

left: Contextual view from the northwest with subject property at centre of photograph, 2024 (City of Toronto Heritage Planning)

PB25.2
94 Cortleigh Blvd.



above: main (west) façade, 2024 (City of Toronto Heritage Planning)

right: View from the west of 94 Cortleigh Boulevard, 2024 (City of Toronto Heritage Planning)

