



SH PROPOSED TWO-WAY SPEED HUMPS

A |

B |

NOTE:
 EVERY ATTEMPT WILL BE MADE TO UTILIZE EXISTING POLES FOR SPEED HUMP SIGNS, HOWEVER, IT MAY BE NECESSARY TO INSTALL NEW POLES FOR THESE SIGNS.

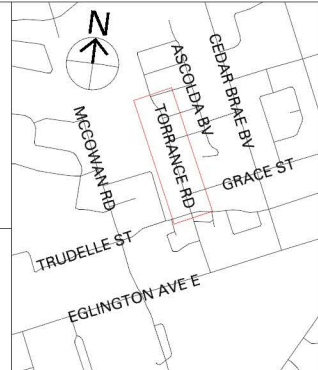

**SPEED HUMPS LOCATIONS PLAN
 TORRANCE ROAD
 STREET: TRUDELLE ST - RADISSON ST**