

**Attachment 1 - Proposed Amendments to Speed Limits on Local roads and Public Lanes in Ward 02 and Ward 03:**

1. Insert the following into Schedule XLV (Part 1) in § 950-1344 as follows:

(Column 1) Designated Area Name	(Column 2) East Limit/West Limit of Designated Area	(Column 3) North Limit/South Limit of Designated Area	(Column 4) Excluded Highways or Bridges	(Column 5) Speed (km/h)	(Column 6) Designated Area Map
(Area 3) in Ward 02	West Side of Kipling Avenue and East Side of Martin Grove Road	North Side of Burnhamthorpe Road and South of Rathburn Road		30	(Area 3) in Ward 02
(Area 4) in Ward 02	West side of Islington Avenue and east side of Kipling Avenue	South side of Eglinton Avenue West and north side of Mimico Creek	Princess Margaret Boulevard between Kipling Avenue and Islington Avenue Rathburn Road between Kipling Avenue and Islington Avenue The Kingsway between Kipling Avenue and Islington Avenue Street West between Islington Avenue and Mimico Creek	Dundas 30	(Area 4) in Ward 02
(Area 5) in Ward 02	West side of Highway 427 and east side of Etobicoke Creek	South side of Bloor Street West and north side of Dundas Street West; Dundas Street West between Etobicoke Creek and Highway 427; Etobicoke Creek between Bloor Street West and Dundas Street West	Neilson Drive between Dundas Street West and Bloor Street West The West Mall between Dundas Street West and Bloor Street West	30	(Area 5) in Ward 02
(Area 6) in Ward 02	West side of Highway 427 and east side of Etobicoke Creek	South side of Burnhamthorpe Road and north side of Bloor Street West	Eva Road between The West Mall and Highway 427 Ramp Mill Road between Burnhamthorpe Road and Bloor Street West Reinforth Drive between Bloor Street West and Burnhamthorpe Road The West Mall between Burnhamthorpe Road and Bloor Street West Silver Shadow Path between Burnhamthorpe Road (west intersection) and Burnhamthorpe Road (east intersection)	30	(Area 6) in Ward 02
(Area 7) in Ward 02	West side of Highway 427 and east side of Etobicoke Creek	South side of Rathburn Road between Highway 427 and a point 57m west of Mill Road and north side of Burnhamthorpe Road	Applewood Lane between Holiday Drive and its entirety Donegal Path between Permfield Path (west intersection) and Permfield Path (east intersection) Holiday Drive between The West Mall and Highway 427 Ramp Mill Road between Burnhamthorpe Road and Rathburn Road Permfield Path between Holiday Drive and its entirety Raintree Path between Mill Road (north intersection) and Mill Road (south intersection) Redstone Path between Mill Road (north intersection) and Mill Road (south intersection) Reinforth Drive between Burnhamthorpe Road and Rathburn Road The West Mall between Burnhamthorpe Road and Rathburn Road	30	(Area 7) in Ward 02
(Area 8) in Ward 02	West side of Humber River between Eglinton Avenue West and Dundas Avenue Street West and east side of Royal York Road	South side of Eglinton Avenue West and north side of Dundas Street West	Edenbridge Drive between Royal York Road and Scarlett Road Scarlett Road between Eglinton Avenue West and Humber River Brin Drive between Ackley Heights (north intersection) and Ackley Heights (south intersection)	30	(Area 8) in Ward 02
(Area 9) in Ward 02	West side of Royal York Road and east side of Islington Avenue	South side of Eglinton Avenue West and north side of Dundas Street West	Anglesey Boulevard between Islington Avenue and Royal York Road Ashley Road between Royal York Road and The Kingsway The Kingsway between Dundas Street West and Islington Avenue	30	(Area 9) in Ward 02
(Area 10) in Ward 02	West side of Kipling Avenue and east side of Martin Grove Road	South side of Eglinton Avenue West and north side of Rathburn Road	Princess Margaret Boulevard between Kipling Avenue and Martin Grove Road Lloyd Manor Road between Eglinton Avenue West and Princess Margaret Boulevard Centennial Park Blvd between Rathburn Road and Eglinton Avenue West	30	(Area 10) in Ward 02
(Area 11) in Ward 02	West side of Martin Grove Road and east side of Etobicoke Creek	South side of Highway 427; Eglinton Avenue West between Etobicoke Creek and Reinforth Drive; Eglinton Avenue West between Highway 427 and Martin Grove Road and North side of Rathburn Road between Centennial Park Boulevard and Martin Grove Road	Eringate Dr between Reinforth Drive and Highway 427 Ramp Gentian Drive between Wellesworth Drive and Reinforth Drive The East Mall between Eglinton Avenue West and Rathburn Road Ramage Lane between Wellesworth Drive and Reinforth Drive The West Mall between Rathburn Road and Wellesworth Drive Wellesworth Drive between The West Mall and Ragoon Road Ragoon Road between Wellesworth Drive and Eringate Drive	30	(Area 11) in Ward 02
(Area 12) in Ward 02	West side of Kipling Avenue and east side of Martin Grove Road	South side of Dixon Road and north side of Eglinton Avenue West	The Westway between Martin Grove Road and Kipling Avenue Widdcombe Hill Boulevard between Eglinton Avenue West and Kipling Avenue	30	(Area 12) in Ward 02
(Area 13) in Ward 02	West side of Islington Avenue and east side of Kipling Avenue	South side of Dixon Road and north side of Eglinton Avenue West	Wincoff Drive between The Westway and Eglinton Avenue West Hunting Ridge between Widdcombe Hill and Wincoff Drive Widdcombe Hill between Hunting Ridge and Kipling Avenue	30	(Area 13) in Ward 02
(Area 14) in Ward 02	West side of Royal York Road and east side of Islington Avenue	South side of Dixon Road and north side of Eglinton Avenue West	Summitcrest Drive between Islington Avenue and Royal York Road Tamarack Circle between Dixon Road and end of Tamarack Circle The Westway between Islington Avenue and Royal York Road	30	(Area 14) in Ward 02
(Area 15) in Ward 02	West side of Humber River and east side of Royal York Road	South side of Dixon Road between Royal York Road and Scarlett Road; a point 143 metres east of Dixon Road and Scarlett Road and north side of Eglinton Avenue West between Humber River and Royal York Road	La Rose Avenue between Royal York Road and Scarlett Road Lawrence Avenue West between Royal York Road and Humber River	30	(Area 15) in Ward 02
(Area 5) in Ward 03	West side of Islington Avenue / east side of Kipling Avenue	South side of Bloor Street West / north side of The Queensway	Fieldway Road between Green Lanes and Munster Avenue Green Lanes between Fieldway Road and Bloor Street West Munster Avenue between Kipling Avenue and Shawbridge Avenue Bering Avenue between Shawbridge Avenue and Islington Avenue Olivewood Road between Kipling Avenue and Shawbridge Avenue Shawbridge Avenue between Munster Avenue and Advance Road Advance Road between Kipling Avenue and Islington Avenue Norseman Street between Kipling Avenue and Islington Avenue Titan Road between Goodrich Road and Islington Avenue Goodrich Road between Titan Road and Julland Road Julland Road between Kipling Avenue and Islington Avenue Dundas Street West between Bloor Street West and Kipling Avenue	30	(Area 5) in Ward 03

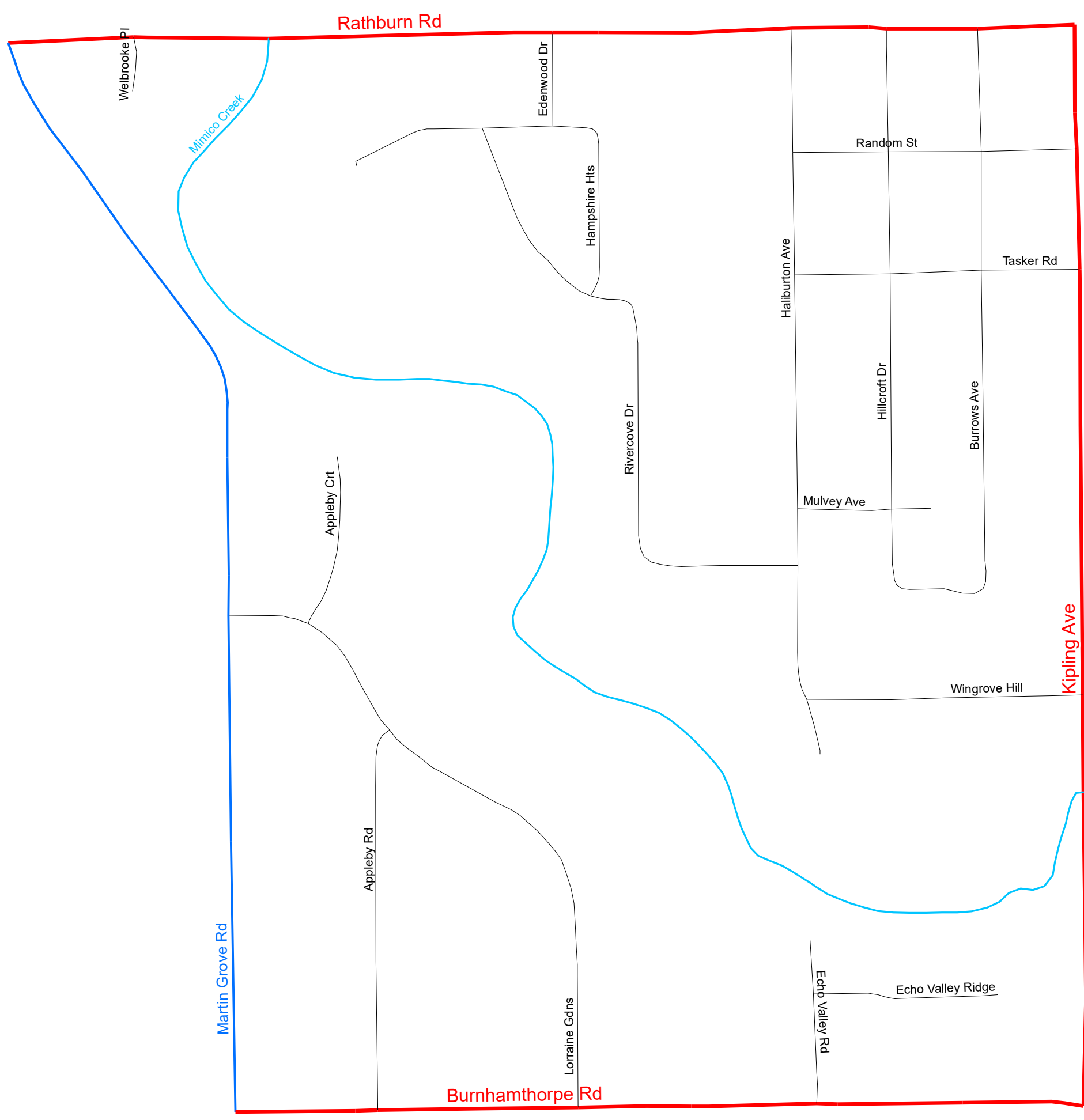

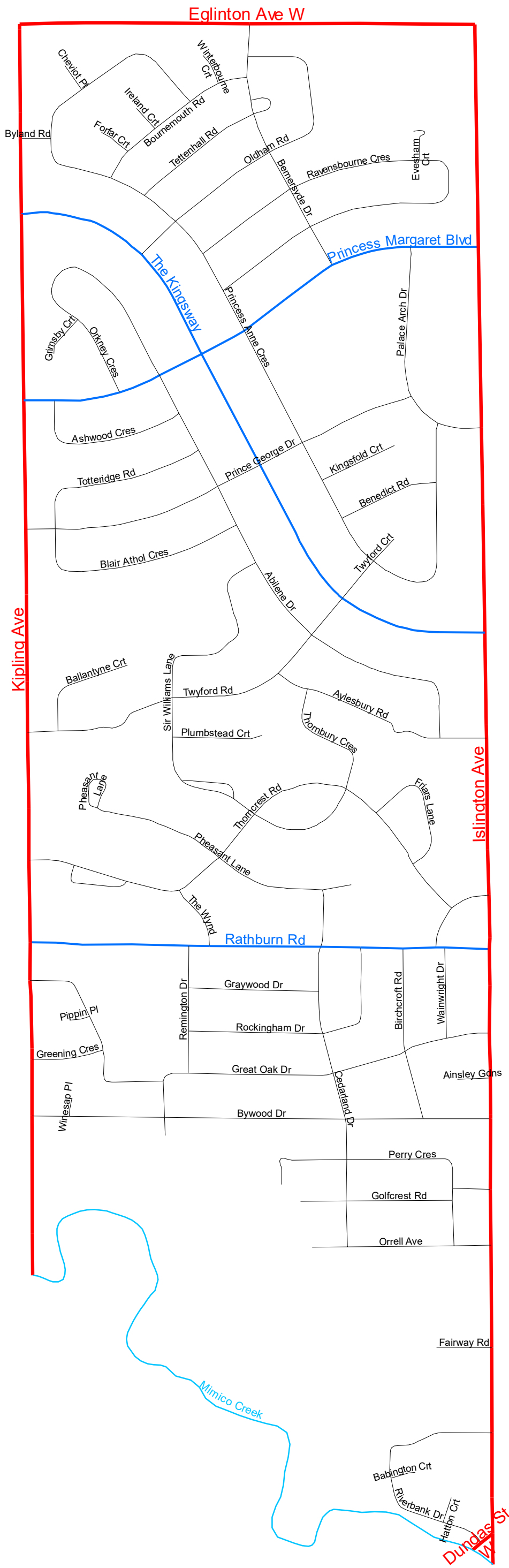

**Legend**

- Major Arterial; Minor Arterial
- Collector
- Local; Laneway
- River

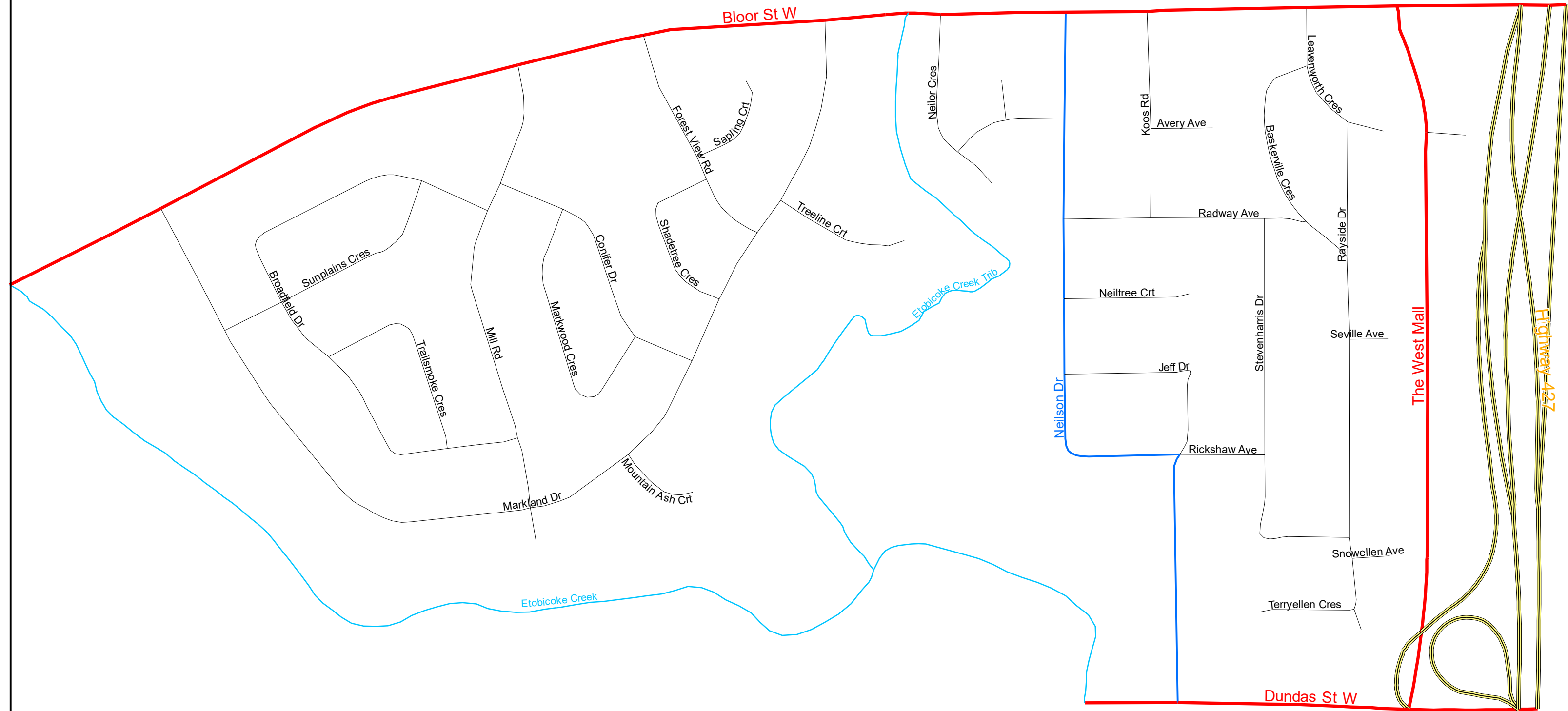

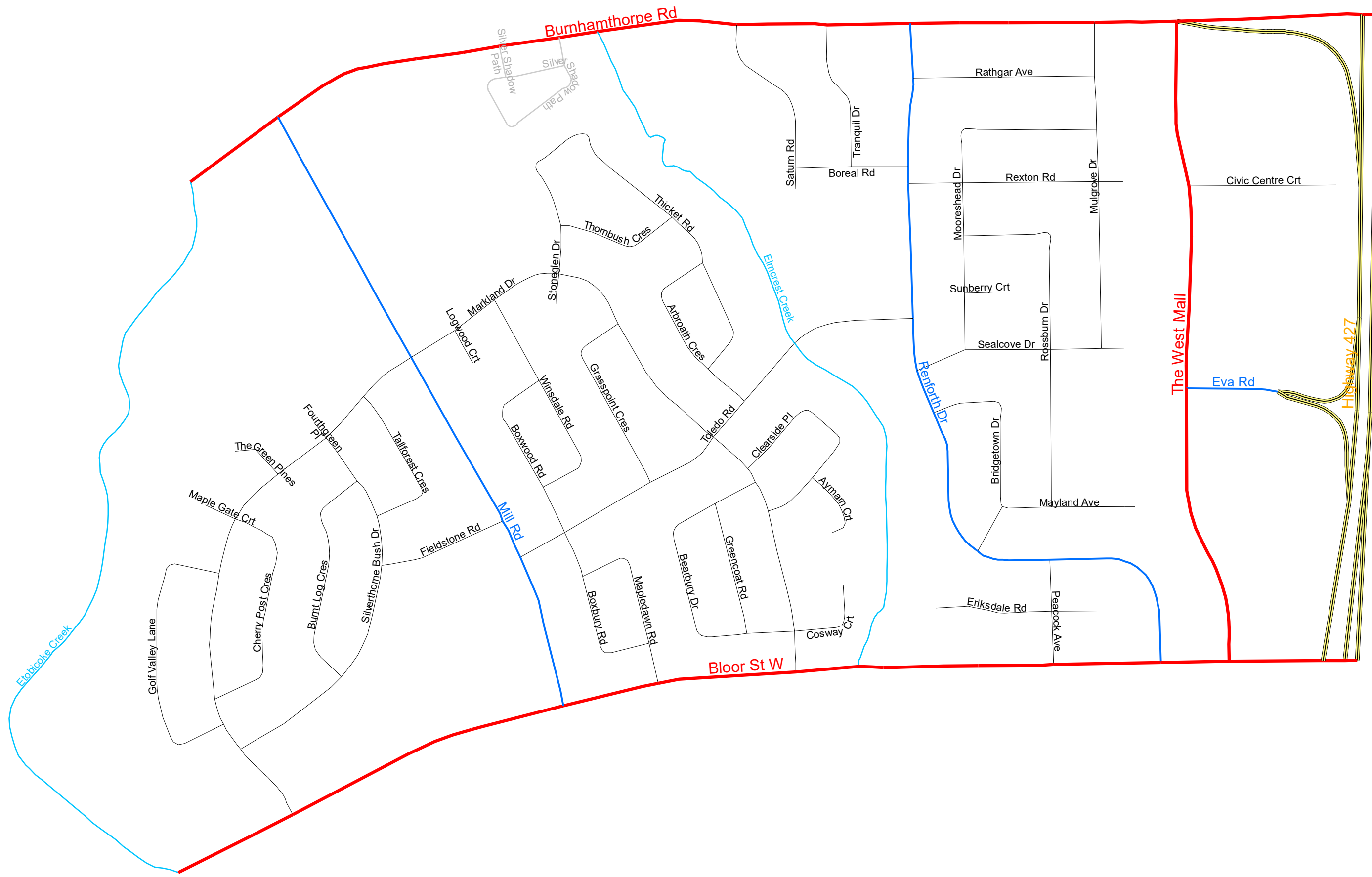

### Legend

- Expressway
- Collector
- Other; Pending
- Major Arterial; Minor Arterial
- Local; Laneway
- River

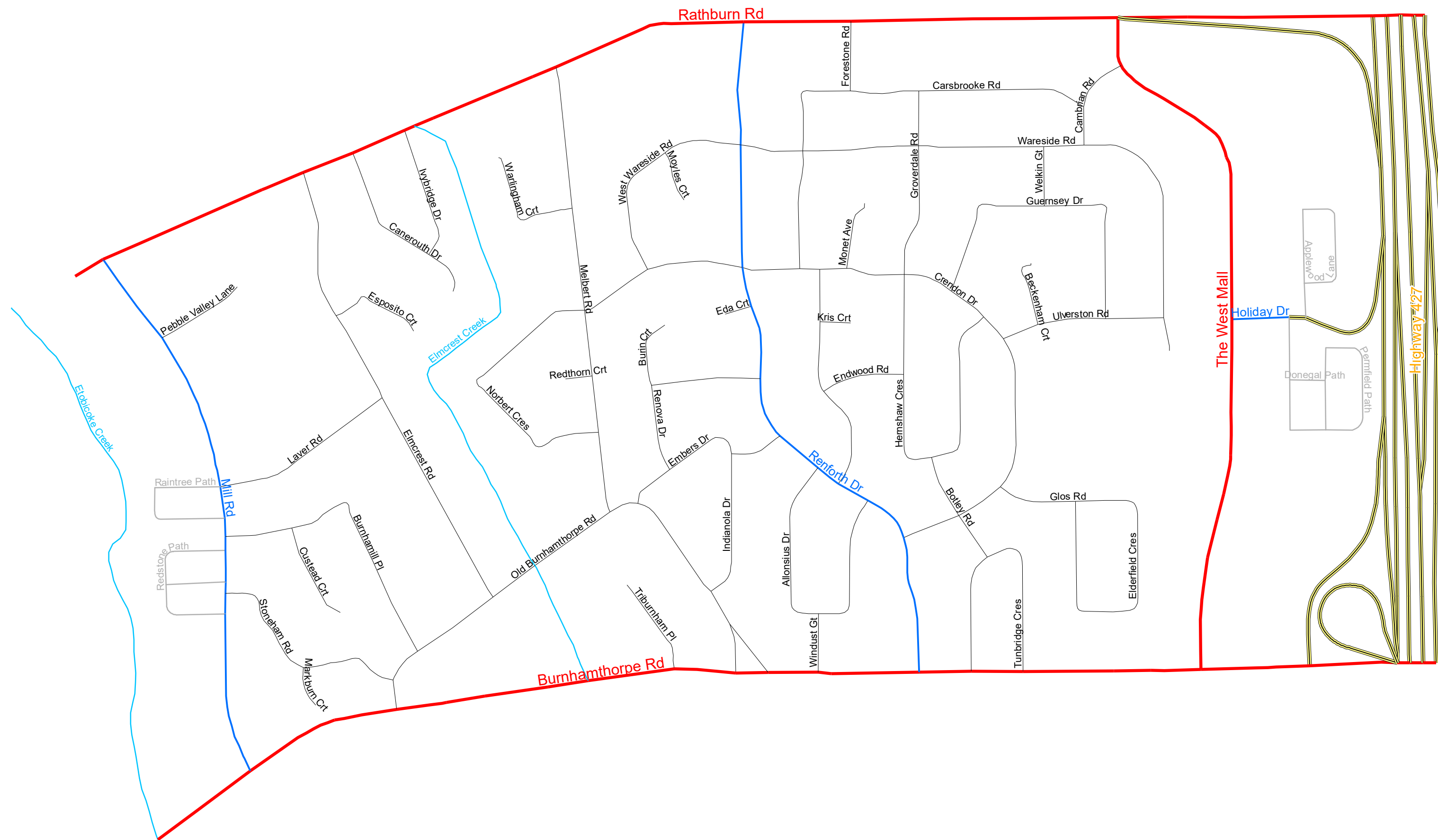

**Legend**

- == Expressway; Expressway Ramp
- Major Arterial; Minor Arterial
- Collector
- Local; Laneway
- Pending; Other
- River

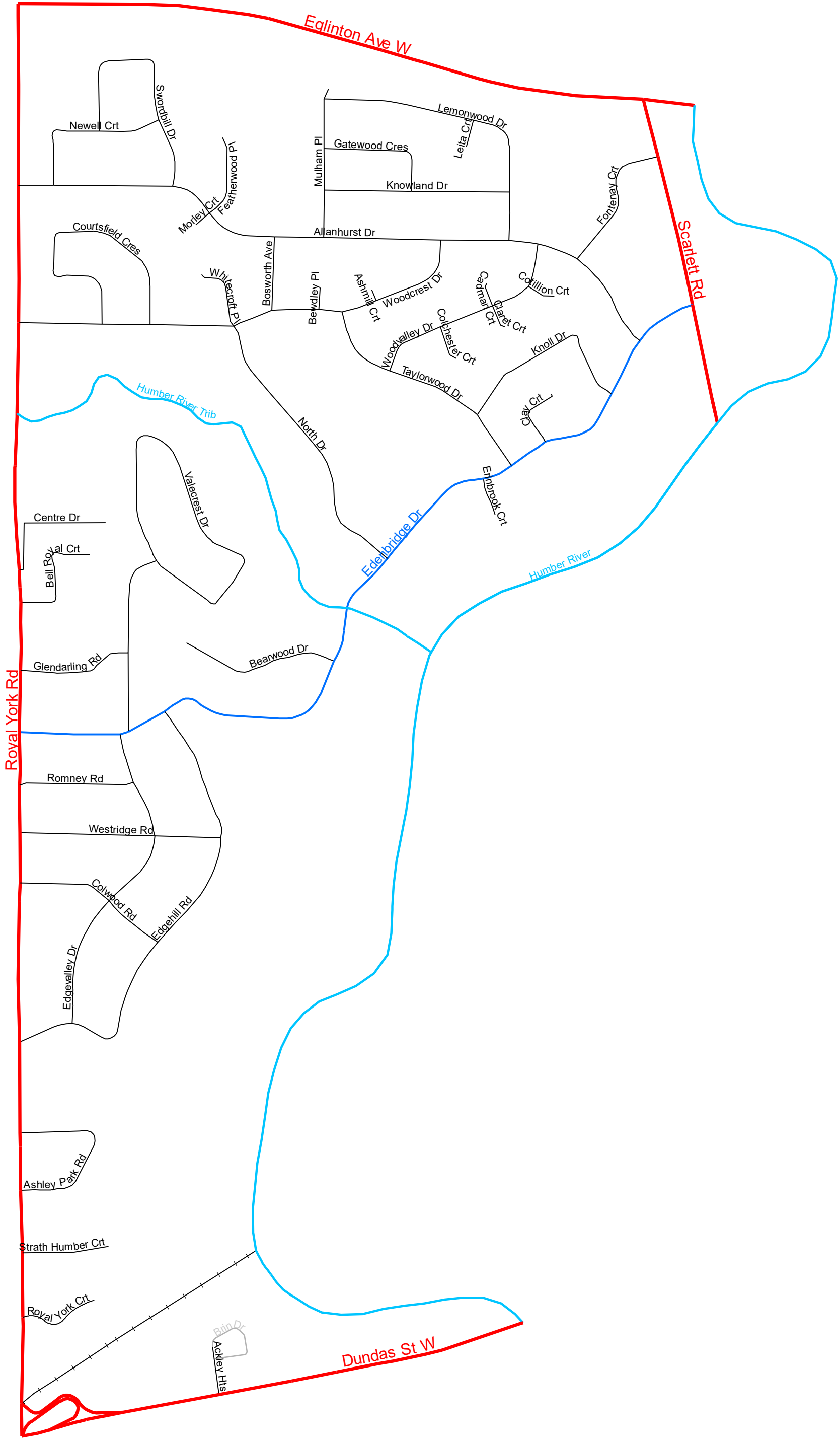

**Legend**

- Major Arterial; Minor Arterial
- Collector
- Local; Laneway
- Pending
- River
- +— Major Railway

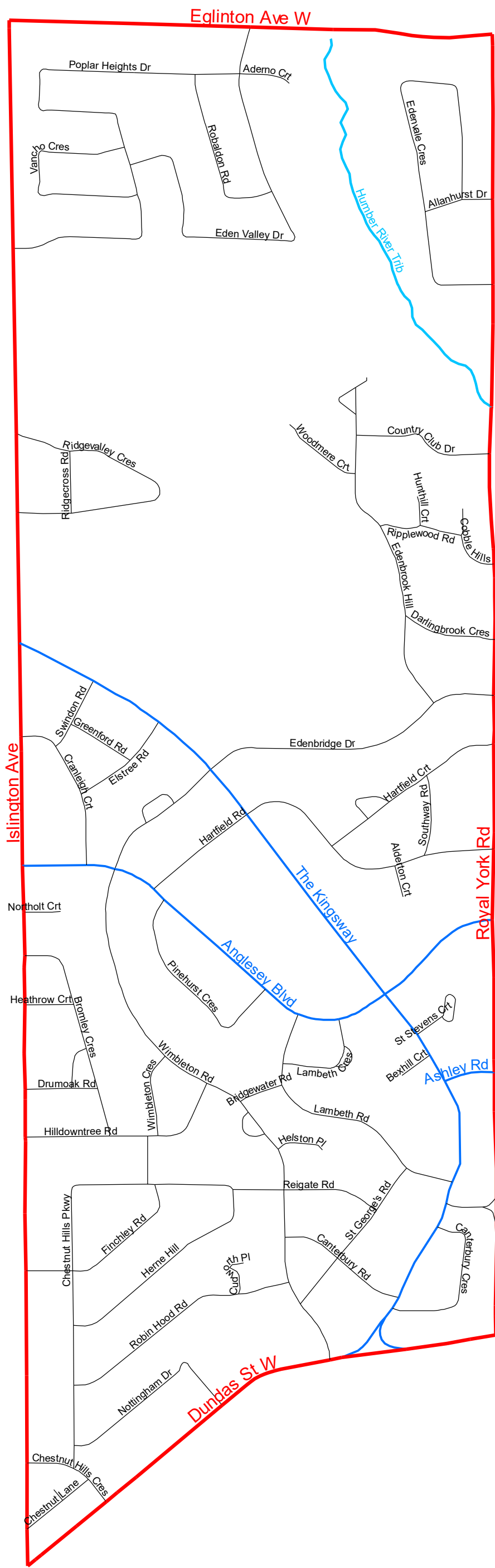

### Legend

- Major Arterial; Minor Arterial
- Collector
- Local; Laneway
- River

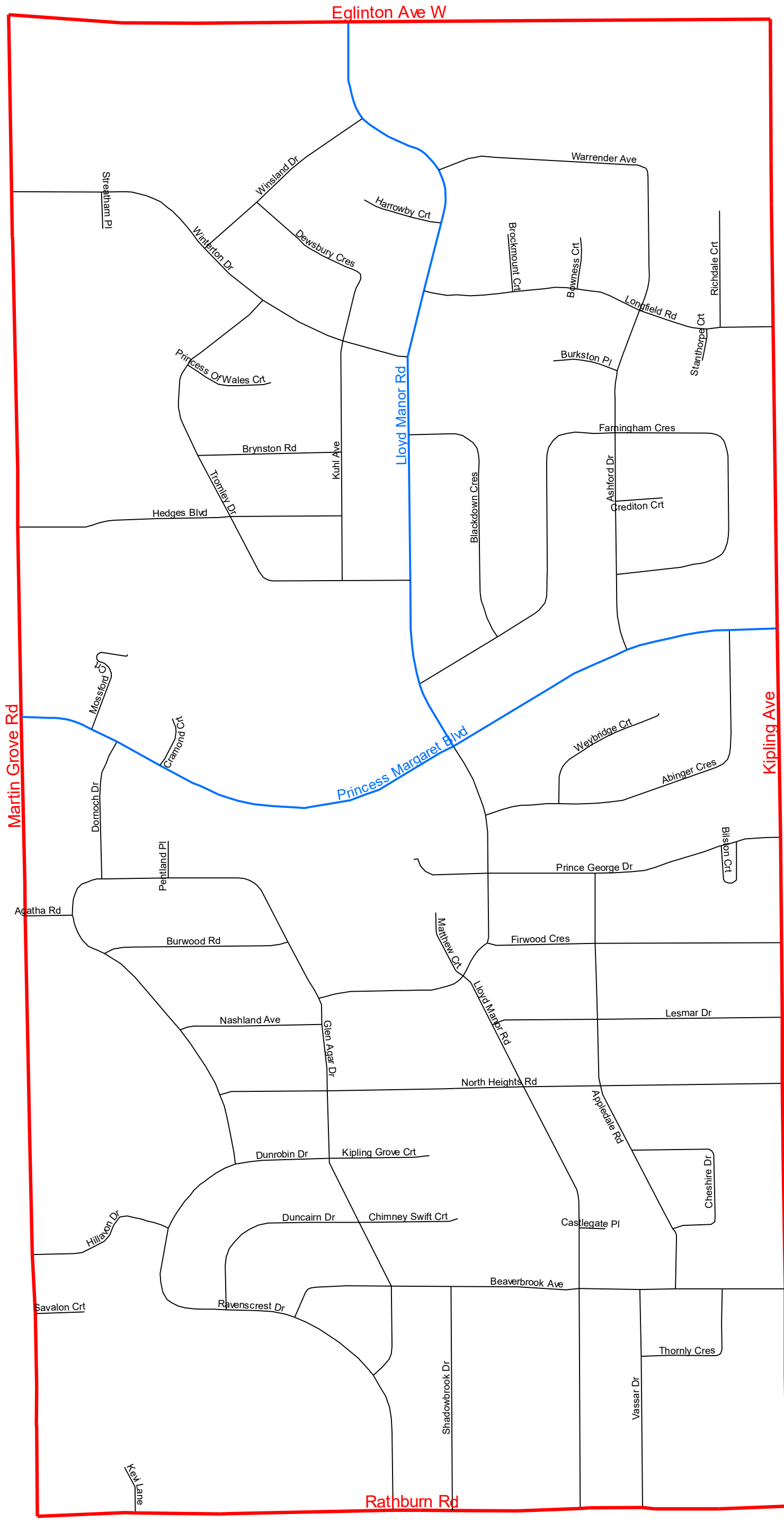

### Legend

- Major Arterial; Minor Arterial
- Collector
- Local; Laneway
- Pending; Other

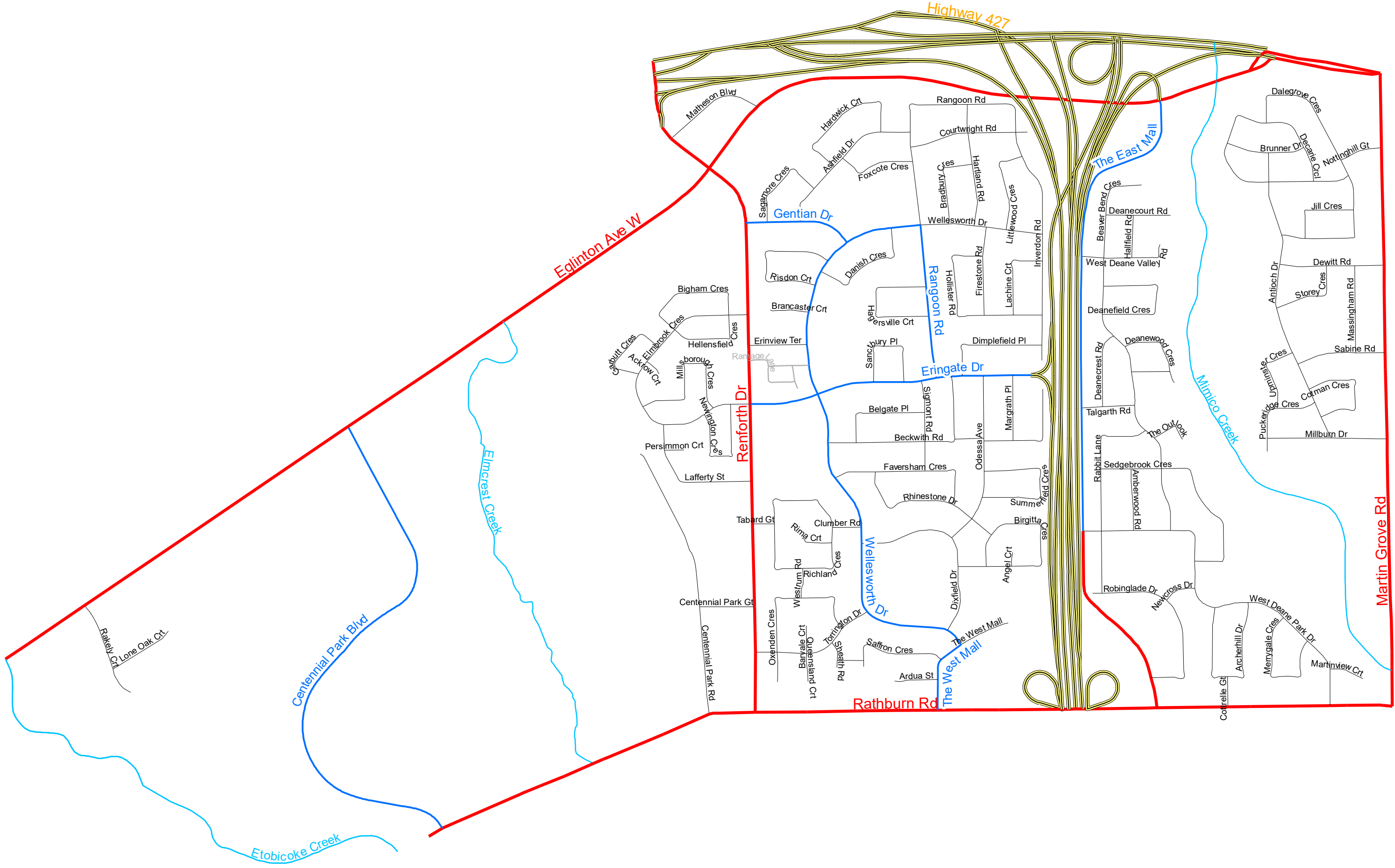



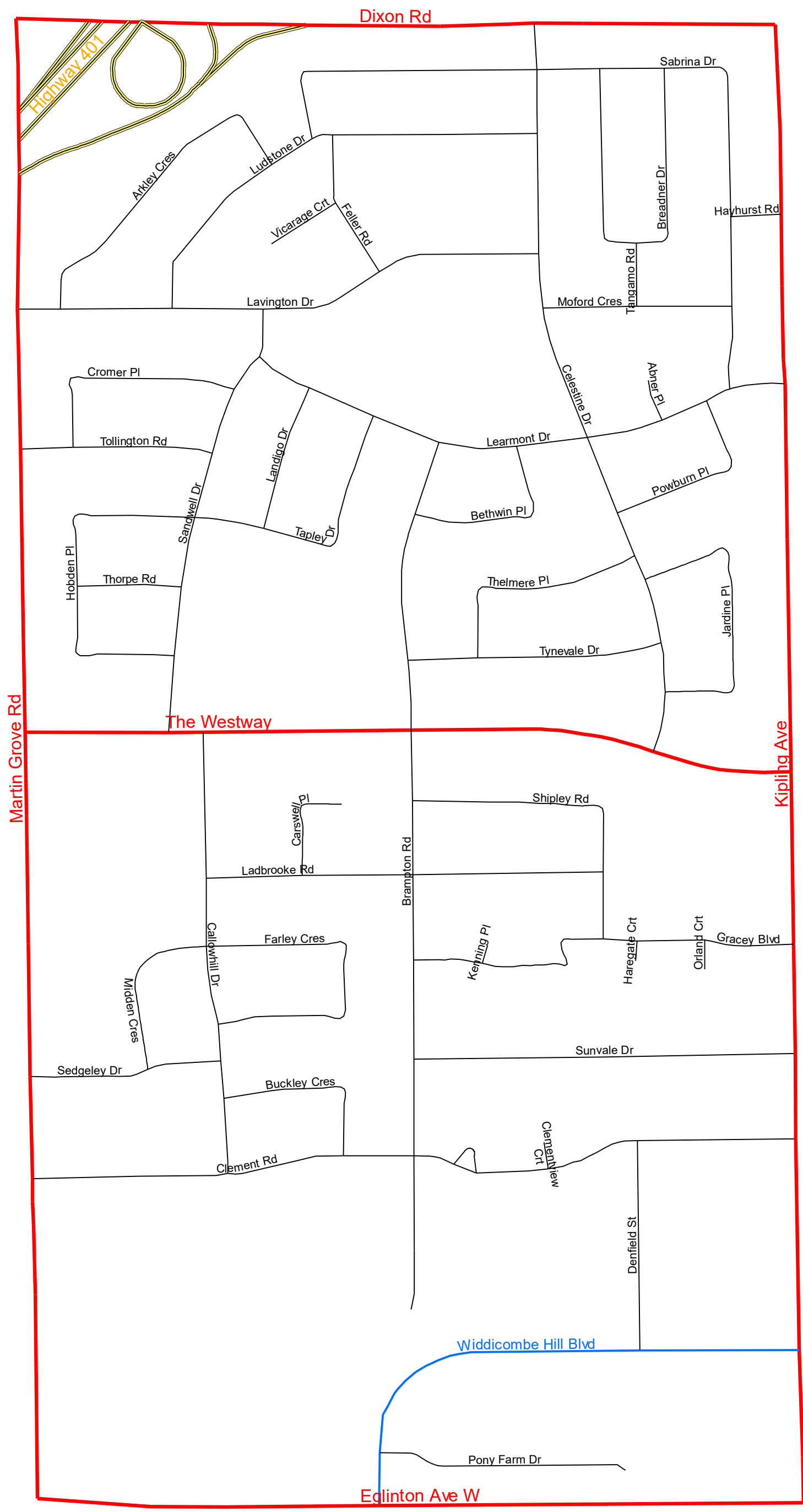

**Legend**

- Expressway
- Collector
- Major Arterial; Minor Arterial
- Pending; Other
- Local; Laneway
- River



**Legend**

-  Expressway
-  Collector
-  Pending; Other
-  Major Arterial; Minor Arterial
-  Local; Laneway

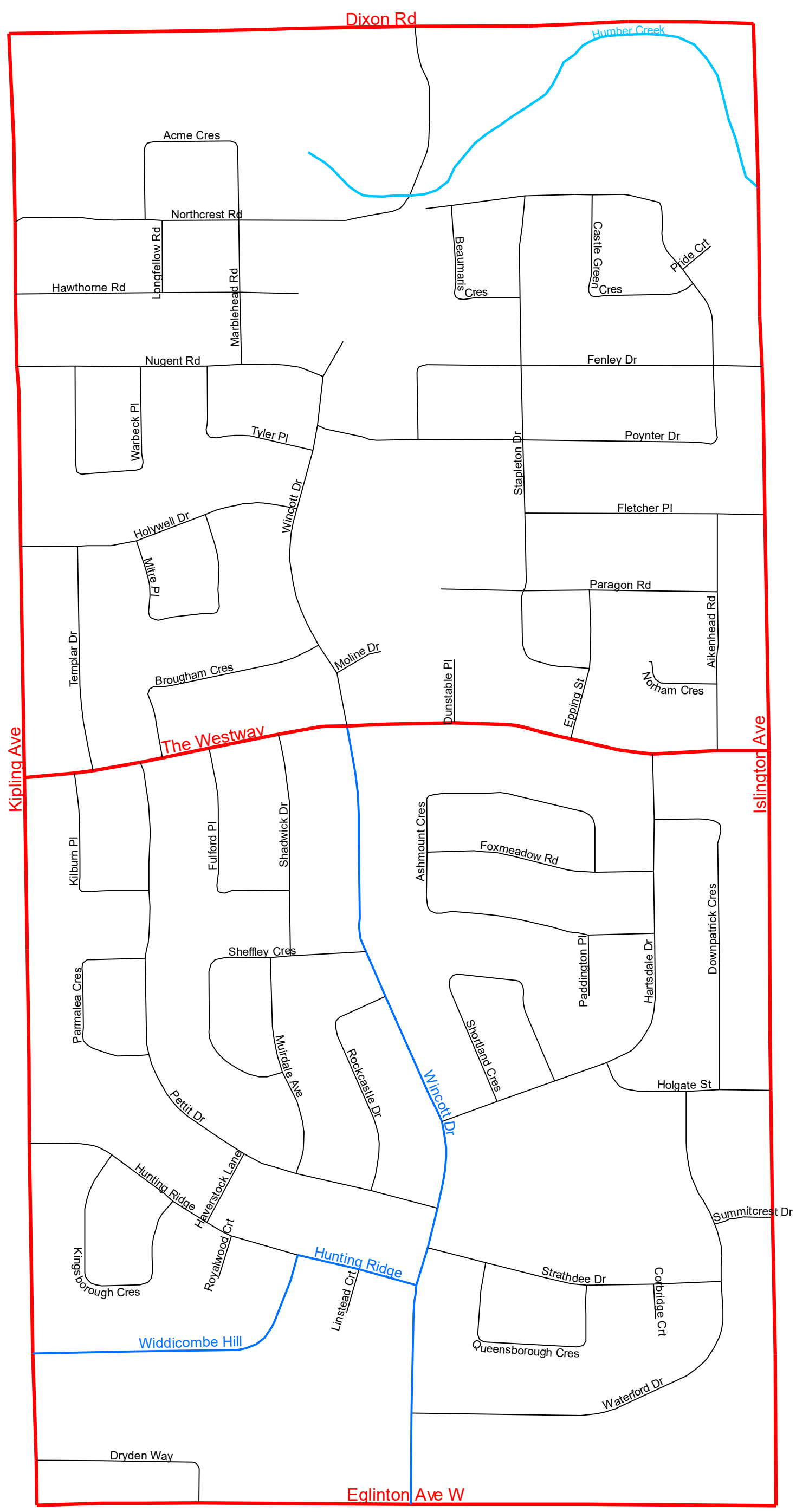

**Legend**

- Major Arterial; Minor Arterial
- Collector
- Local; Laneway
- Pending
- River

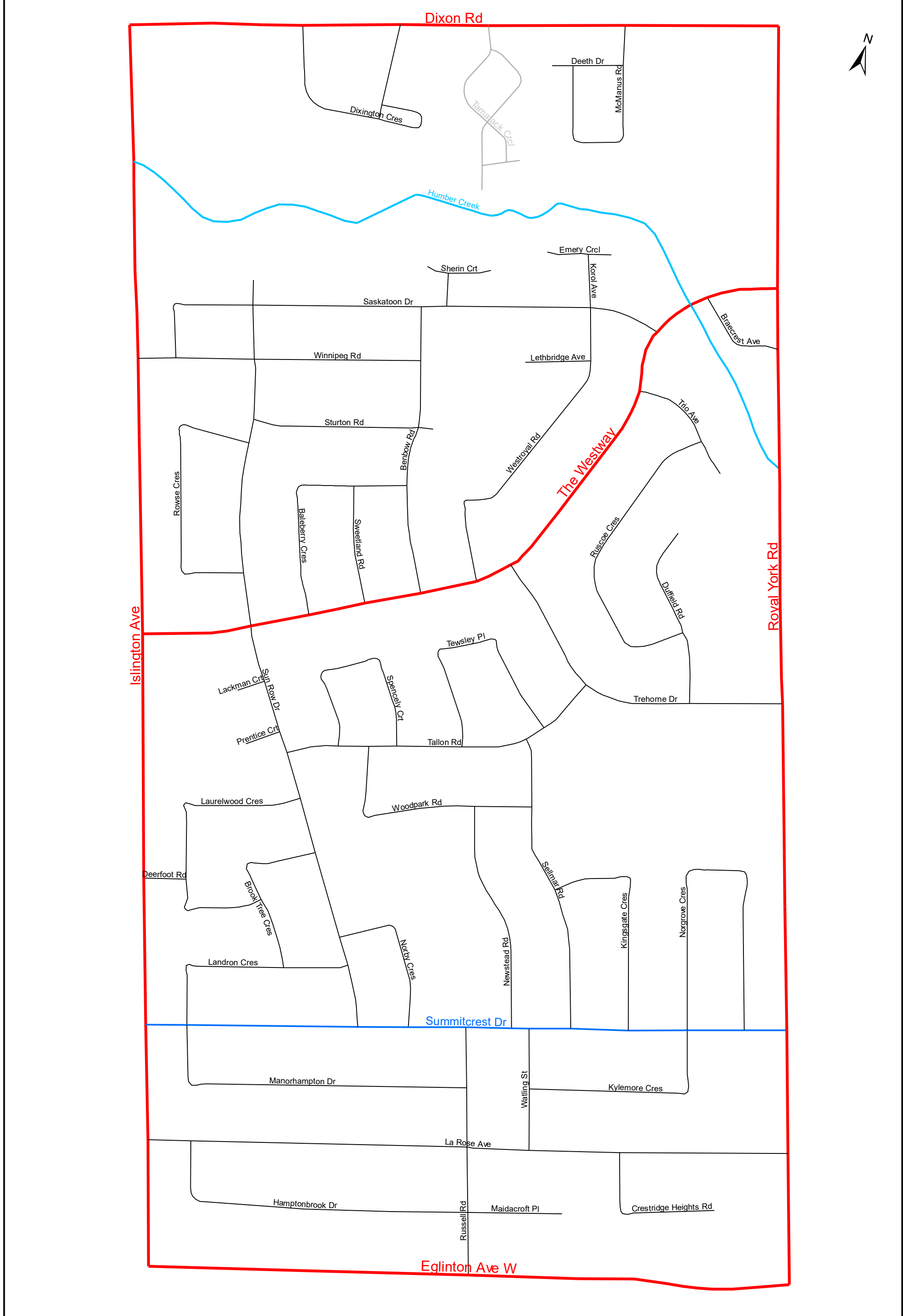

Dixon Rd



Islington Ave

Royal York Rd

Eglinton Ave W

The Westway

Summitcrest Dr

**Legend**

- Major Arterial; Minor Arterial
- Collector
- Local; Laneway
- Pending; Other
- River

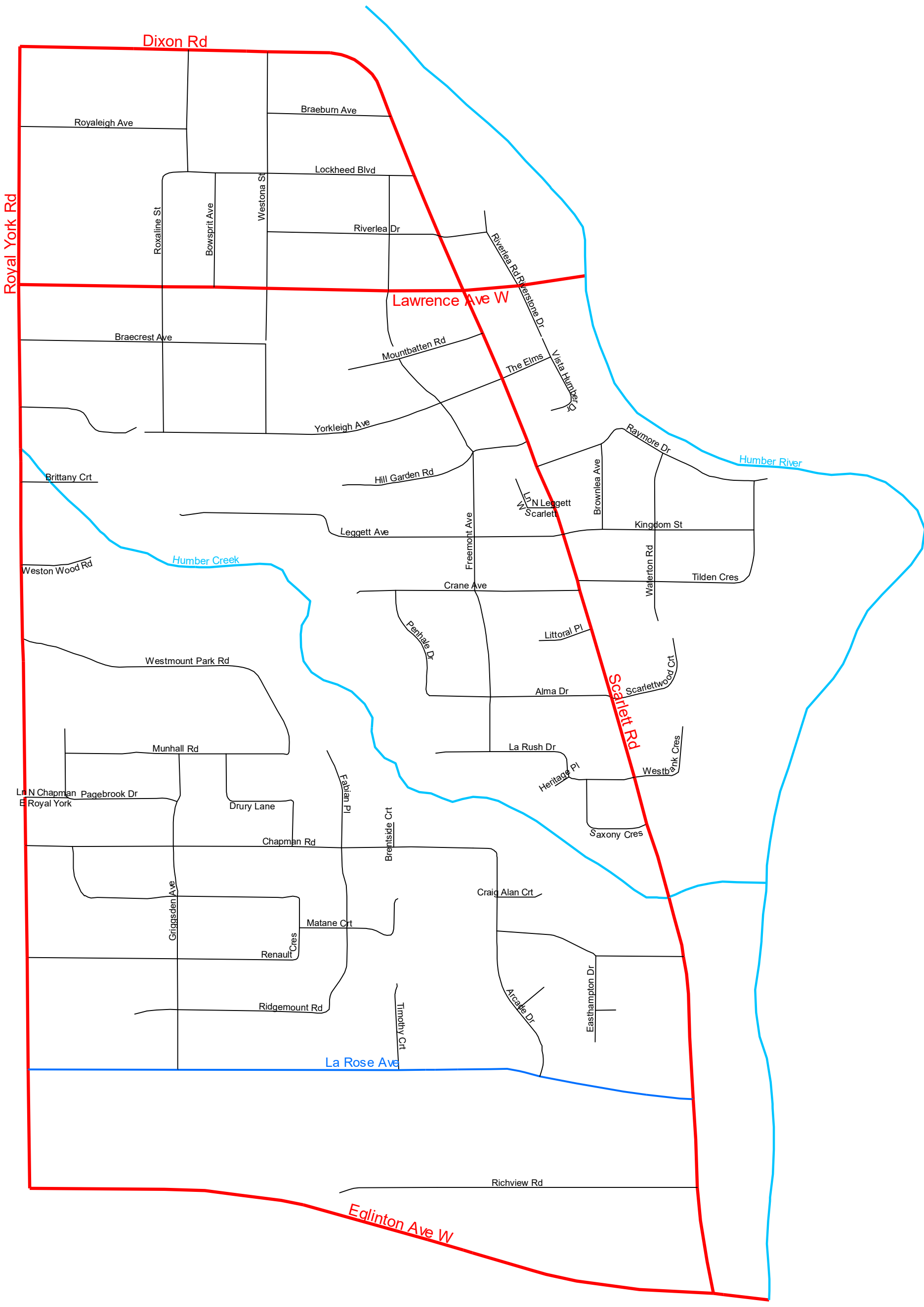

**Legend**

-  Major Arterial; Minor Arterial
-  Collector
-  Local; Laneway
-  River

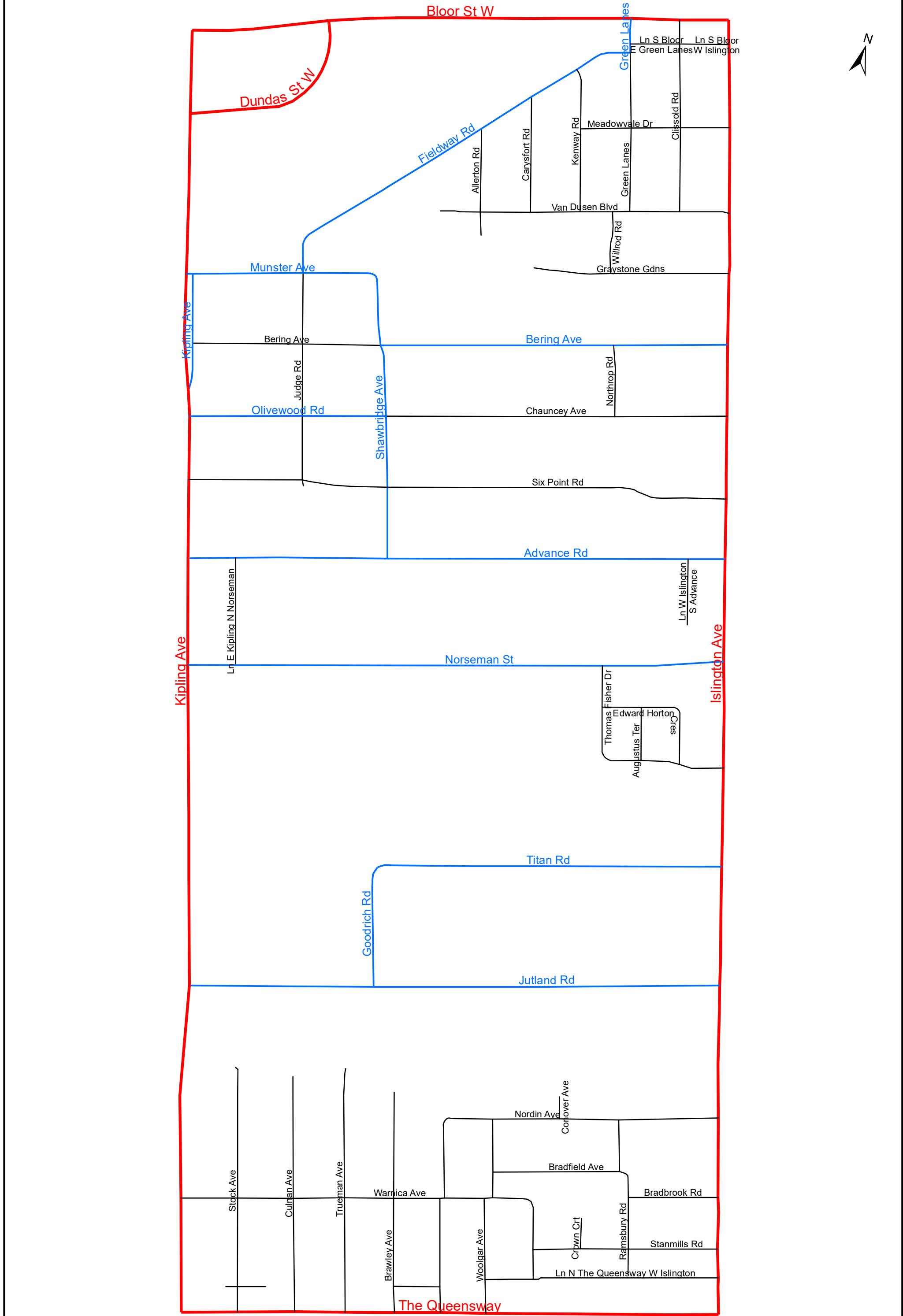

**Legend**

- Major Arterial; Minor Arterial
- Collector
- Laneway; Local
- Pending

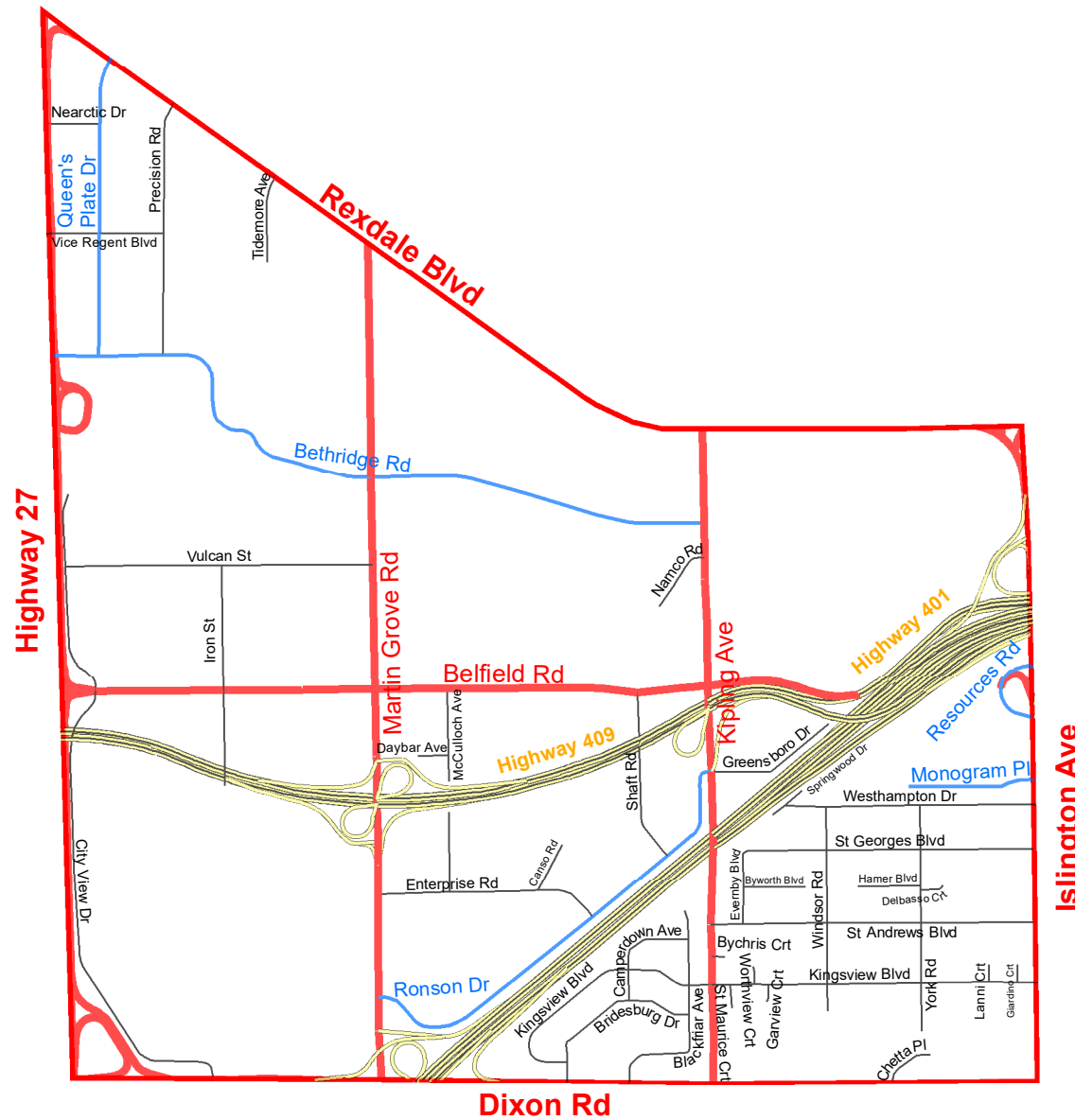

### Local Road Speed Limit Reduction (Area 12) in Ward 1 Legend

- Expressway
- Major Arterial; Minor Arterial
- Collector
- Local ; Laneway
- Pending

3. Rescind the following from Schedule XXXV in § 950-1334 as follows:

(From Column 1)	(From Column 2)	(From Column 3)	Action
Highway	Between	Speed Limit (km/h)	
Abilene Drive	Princess Margaret Boulevard and Aylesbury Road	40	Rescind
Abinger Crescent	Lloyd Manor Road and Princess Margaret Boulevard	40	Rescind
Ainsley Gardens	Islington Avenue and the west end of Ainsley Gardens	40	Rescind
Allanhurst Drive	Edenvale Crescent (west intersection) and Edenbridge Drive	40	Rescind
Alma Drive	Scarlett Road and Penhale Drive	40	Rescind
Arcade Drive	La Rose Avenue and Chapman Road	40	Rescind
Ashfield Drive	Gentian Drive and Rangoon Road	40	Rescind
Ashford Drive	Longfield Road and Princess Margaret Boulevard	40	Rescind
Ashwood Crescent	Princess Margaret Boulevard and Abilene Drive	40	Rescind
Aylesbury Road	Twyford Road and Islington Avenue	40	Rescind
Ballantyne Court	Twyford Road and the east end of Ballantyne Court	40	Rescind
Baskerville Crescent	Rayside Drive and Leavenworth Crescent	40	Rescind
Beaver Bend Crescent	West Deane Park Drive and the northeast end of Beaver Bend Crescent	40	Rescind
Beaverbrook Avenue	Ravenscrest Drive and Kipling Avenue	40	Rescind
Bemersyde Drive	Eglinton Avenue West	40	Rescind
Benbow Road	The Westway and Saskatoon Drive (west intersection)	40	Rescind
Benedict Road	Princess Anne Crescent (west intersection) and Princess Anne Crescent (east intersection)	40	Rescind
Bigham Crescent	Elmbrook Crescent (east intersection) and Elmbrook Crescent (west intersection)	40	Rescind
Birchcroft Road	Rathburn Road and Bywood Drive	40	Rescind
Blackdown Crescent	Lloyd Manor Road and Farningham Crescent	40	Rescind
Blair Athol Crescent	Prince George Drive and Abilene Drive	40	Rescind
Bournemouth Road	Princess Anne Crescent and Bemersyde Drive	40	Rescind
Bowness Court	Longfield Road and the north end of Bowness Court	40	Rescind
Braecrest Avenue	Royal York Road and Westona Street	40	Rescind
Brampton Road	The south end of Brampton Road and Sunvale Drive	40	Rescind
Bridgewater Road	Wimbleton Road and Lambeth Road	40	Rescind
Brockmount Court	Longfield Road and the north end of Brockmount Court	40	Rescind
Brougham Crescent	The Westway and Wincott Drive	40	Rescind
Burkston Place	Ashford Drive and the west end of Burkston Place	40	Rescind
Burnhamill Place	Old Burnhamthorpe Road and Mill Road	40	Rescind
Byland Road	Kipling Avenue and Princess Anne Crescent	40	Rescind
Bywood Drive	Kipling Avenue and Islington Avenue	30	Rescind
Cedarland Drive	Rathburn Road and Orrell Avenue	40	Rescind
Celestine Drive	Dixon Road and The Westway	40	Rescind
Centennial Park Road	Rathburn Road and Centennial Park Gate	40	Rescind
Centennial Park Road	Centennial Park Gate and the northwest end of Centennial Park Road	30	Rescind
Chapman Road	Arcade Drive and Royal York Road	40	Rescind
Chestnut Hills Parkway	Chestnut Hills Crescent and Reigate Road	40	Rescind
Cheviot Place	Princess Anne Crescent and the northwest end of Cheviot Place	40	Rescind
Clement Road	Callowhill Drive and Kipling Avenue	40	Rescind
Cobble Hills	Royal York Road and Ripplewood Road/Lincoln Woods Court	40	Rescind
Colwood Road	Royal York Road and Edgehill Road	40	Rescind
Country Club Drive	Royal York Road and Edenbrook Hill	40	Rescind
Crediton Court	Ashford Drive and the east end of Crediton Court	40	Rescind
Crendon Drive	Guemsey Drive and Botley Road	40	Rescind
Darlingbrook Crescent	Royal York Road and Edenbrook Hill	40	Rescind
Denfield Street	Widdicombe Hill Boulevard and Clement Road	40	Rescind
Dixfield Drive	Wellesworth Drive (north intersection) and Wellesworth Drive (south intersection)	40	Rescind
Dixington Crescent	Dixon Road (west intersection) and Dixon Road (east intersection)	40	Rescind
Dunrobin Drive	Ravenscrest Drive and Glen Agar Drive	40	Rescind
Edenbridge Drive	The Kingsway and Scarlett Road	40	Rescind
Edenbrook Hill	Edenbridge Drive and the north end of Edenbrook Hill	40	Rescind
Edenvale Crescent	Royal York Road and Allanhurst Drive (east intersection)	40	Rescind
Elmbrook Crescent	Renforth Drive (north intersection) and Renforth Drive (south intersection)	40	Rescind
Elmcrest Road	Rathburn Road and Eglinton Avenue West	40	Rescind
Evesham Court	Ravensbourne Crescent and the north end of Evesham Court	40	Rescind
Farningham Crescent	Lloyd Manor Road and Ashford Drive (south intersection)	40	Rescind
Finchley Road	Islington Avenue and Hilledowntree Road	40	Rescind
Fontenay Court	Allanhurst Drive and Scarlett Road	40	Rescind
Forfar Court	Bournemouth Road and the west end of Forfar Court	40	Rescind
Freemont Avenue	Lawrence Avenue West and Lockheed Boulevard	40	Rescind
Frars Lane	Thorncrest Road (east intersection) and Thorncrest Road (west intersection)	40	Rescind
Fulford Place	Shadwick Drive and The Westway	40	Rescind
Garbutt Crescent	Elmbrook Crescent (south intersection) and Elmbrook Crescent (north intersection)	40	Rescind
Glen Agar Drive	Ravenscrest Drive and Agatha Road	40	Rescind
Golfcrest Road	Islington Avenue and the west end of Golfcrest Road	40	Rescind
Graywood Drive	Remington Drive and Cedarland Drive	40	Rescind
Great Oak Drive	Kipling Avenue and Remington Drive (west intersection)	40	Rescind
Great Oak Drive	Remington Drive (west intersection) and Islington Avenue	40	Rescind
Greening Crescent	Kipling Avenue and Great Oak Drive	40	Rescind
Grimsby Court	Orkney Crescent and the south end of Grimsby Court	40	Rescind
Hagersville Court	Rangoon Road (south intersection) and Rangoon Road (north intersection)	40	Rescind
Haliburton Avenue	Rathburn Rd and Wingrove Hill	40	Rescind
Hartfield Road	Royal York Road and Anglesey Boulevard	40	Rescind
Hartsdale Drive	The Westway and Wincott Drive	40	Rescind
Hawthorne Road	Kipling Avenue and Marblehead Road	40	Rescind
Herne Hill	Chestnut Hills Parkway (southwest intersection) and Reigate Road	40	Rescind
Hillavon Drive	Martin Grove Road and Ravenscrest Drive	40	Rescind
Hilledowntree Road	Islington Avenue and Wimbleton Road	40	Rescind
Hunthill Court	Ripplewood Road and the north end of Hunthill Court	40	Rescind
Hunting Ridge	Kipling Avenue and Wincott Drive	40	Rescind
Ireland Court	Bournemouth Road and the northwest end of Ireland Court	40	Rescind
Kingsfold Court	Princess Anne Crescent and the northeast end of Kingsfold Court	40	Rescind
La Rose Avenue	Royal York Road and Scarlett Road	40	Rescind
La Rush Drive	The west end of La Rush Drive and Scarlett Road	40	Rescind
Lambeth Crescent	Anglesey Boulevard and Lambeth Road	40	Rescind
Lambeth Road	Anglesey Boulevard and The Kingsway	40	Rescind
Lavington Drive	Celestine Drive and Martin Grove Road	40	Rescind
Learmont Drive	Sandwell Drive and Kipling Avenue	40	Rescind
Leavenworth Crescent	Rayside Drive and Bloor Street West	40	Rescind
Leggett Avenue	Scarlett Road and the west end of Leggett Avenue	40	Rescind

Lincoln Woods Court	Ripplewood Road/Cobble Hills and the north end of Lincoln Woods Court	40	Rescind
Lloyd Manor Road	Rathburn Road and Eglinton Avenue West	40	Rescind
Lockheed Boulevard	Scarlett Road and Roxaline Street	40	Rescind
Longfield Road	Kipling Avenue and Lloyd Manor Road	40	Rescind
Lorraine Gardens	Burnhamthorpe Road and Martin Grove Road	40	Rescind
Ludstone Drive	Celestine Drive and Lavington Drive	40	Rescind
Mayland Avenue	Bridgetown Drive and the east end of Mayland Avenue	40	Rescind
Mill Road	Bloor Street West and Markland Drive (south intersection)	40	Rescind
Mulham Place	Allanhurst Drive and Lemonwood Drive	40	Rescind
Norby Crescent	Summitcrest Drive and Sun Row Drive	40	Rescind
North Drive	Royal York Road and Edenbridge Drive	40	Rescind
Nottingham Drive	Chestnut Hills Parkway and Dundas Street West	40	Rescind
Old Burnhamthorpe Road	Burnhamthorpe Road (west intersection) and Burnhamthorpe Road (east intersection)	30	Rescind
Oldham Road	The Kingsway and Bemersyde Drive (north intersection)	40	Rescind
Orkney Crescent	Princess Margaret Boulevard (west intersection) and Princess Margaret Boulevard (east intersection)	40	Rescind
Orrell Avenue	Islington Avenue and the west end of Orrell Avenue	40	Rescind
Palace Arch Drive	Princess Margaret Boulevard and Islington Avenue	40	Rescind
Perry Crescent	Orrell Crescent and the south end of Perry Crescent	40	Rescind
Pheasant Lane	The west end of Pheasant Lane and Rathburn Road	40	Rescind
Pippin Place	Great Oak Drive and the west end of Pippin Place	40	Rescind
Plumbstead Court	Sir Williams Lane and the east end of Plumbstead Court	40	Rescind
Poplar Heights Drive	Islington Avenue and Eden Valley Drive (north intersection)	40	Rescind
Poynter Drive	Wincott Drive and Fenley Drive (east intersection)	40	Rescind
Prince George Drive	Kipling Avenue and Palace Arch Drive	40	Rescind
Princess Anne Crescent	Bournemouth Road (east intersection) and Prince George Drive	40	Rescind
Princess Of Wales Court	Tromley Drive and the east end of Princess of Wales Court	40	Rescind
Rangoon Road	Eringate Drive and Ashfield Drive	40	Rescind
Ravensbourne Crescent	Princess Anne Crescent (north intersection) and Princess Anne Crescent (south intersection)	40	Rescind
Ravenscrest Drive	Dunrobin Drive and Agatha Drive	40	Rescind
Raymore Drive	Scarlett Road and the east end of Raymore Drive	40	Rescind
Remington Drive	Rathburn Road and Bywood Drive	40	Rescind
Renault Crescent	Royal York Road and Chapman Road	40	Rescind
Richdale Court	Longfield Road and the north end of Richdale Court	40	Rescind
Richland Crescent	Entire length	40	Rescind
Ripplewood Road	Edenbrook Hill and Cobble Hills/Lincoln Woods Court	40	Rescind
Riverbank Drive	Dundas Street West and Islington Avenue	40	Rescind
Riverlea Drive	Scarlett Road and Westona Street	40	Rescind
Robin Hood Road	Chestnut Hills Parkway and Wimbleton Road	40	Rescind
Rockingham Drive	Remington Drive and Rathburn Road	40	Rescind
Romney Road	Royal York Road and Edgevalley Drive	40	Rescind
Rossum Drive	Sealcove Drive and Mayland Avenue	40	Rescind
Roxaline Street	Lockheed Boulevard and Lawrence Avenue West	40	Rescind
Saskatoon Drive	The Westway and Winnipeg Road	40	Rescind
Saturn Road	The south end of Saturn Road and Burnhamthorpe Road	40	Rescind
Shadowbrook Drive	Rathburn Road and Beaverbrook Avenue	40	Rescind
Sir Williams Lane	Abilene Drive and Thorncrest Road (east intersection)	40	Rescind
Stanthorpe Court	Longfield Road and the south end of Stanthorpe Court	40	Rescind
Stapleton Drive	Northcrest Drive and Epping Street	40	Rescind
Stoneham Road	Mill Road and Old Burnhamthorpe Road	40	Rescind
Streatham Place	Winterton Drive and the south end of Streatham Place	40	Rescind
Sun Row Drive	Summitcrest Drive and Saskatoon Drive	40	Rescind
Tallon Road	Trehorne Drive and Sun Row Drive	40	Rescind
Tettenhall Road	Princess Anne Crescent and Bemersyde Drive	40	Rescind
The Wynd	Thorncrest Road and Rathburn Road	40	Rescind
Thicket Road	Stoneglenn Drive and Arbroath Crescent (southeast intersection)	40	Rescind
Thornbury Crescent	Aylesbury Road and Thorncrest Road	40	Rescind
Thorncrest Road	Kipling Avenue and Islington Avenue	40	Rescind
Tilden Crescent	Scarlett Road and Raymore Drive	40	Rescind
Toledo Road	Renforth Drive and Mill Road	40	Rescind
Torrington Drive	Renforth Drive and Wellesworth Drive	40	Rescind
Totteridge Road	Prince George Drive and Abilene Drive	40	Rescind
Trehorne Drive	A point 32 metres north of Tallon Road and Royal York Road	40	Rescind
Tromley Drive	Winterton Drive and Lloyd Manor Road	40	Rescind
Twyford Court	Princess Anne Crescent and the northeast end of Twyford Court	40	Rescind
Ulverston Road	Crendon Drive and Wareside Road	40	Rescind
Valecrest Drive	Edenbridge Drive and Valecrest Drive	40	Rescind
Wainwright Drive	Rathburn Road and Great Oak Drive	40	Rescind
Warbeck Place	Nugent Road (east intersection) and Nugent Road (west intersection)	40	Rescind
Warrender Avenue	Lloyd Manor Road and Longfield Road	40	Rescind
Waterford Drive	Wincott Drive and Holgate Street	40	Rescind
Wellesworth Drive	The West Mall and Inverdon Road	40	Rescind
West Deane Park Drive	The East Mall and Archerhill Drive (west intersection)	40	Rescind
Westmount Park Road	Royal York Road and Munhall Road	40	Rescind
Westona Street	Lawrence Avenue West and Yorkleigh Avenue	40	Rescind
Westridge Road	Royal York Road and Edgehill Road	40	Rescind
Westroyal Road	The Westway and Saskatoon Drive	40	Rescind
Wimbleton Road	Dundas Street West and The Kingsway	40	Rescind
Wincott Drive	Eglinton Avenue West and Nugent Road	40	Rescind
Winesap Place	Bywood Drive and the north end of Winesap Place	40	Rescind
Wingrove Hill	Haliburton Avenue and Kipling Avenue	40	Rescind
Winterbourne Court	Bournemouth Road and the northwest end of Winterbourne Court	40	Rescind
Winterton Drive	Martin Grove Road and Lloyd Manor Road	40	Rescind
Woodcrest Drive	North Drive and Allanhurst Drive	40	Rescind
Woodmere Court	Edenbrook Hill and the west end of Woodmere Court	40	Rescind
Yorkleigh Avenue	Scarlett Road and Royal York Road	40	Rescind

4. Rescind the following from Schedule XLV in § 950-1344 as follows:

(Column 1) Designated Area Name	(Column 2) East Limit/West Limit of Designated Area	(Column 3) North Limit/South Limit of Designated Area	(Column 4) Excluded Highways or Bridges	(Column 5) Speed (km/h)	(Column 6) Designated Area Map
(Area 5) in Ward 03	West side of Islington Avenue / east side of Kipling Avenue	South side of Bloor Street West / north side of The Queensway	Fieldway Road between Green Lanes and Munster Avenue Green Lanes between Fieldway Road and Bloor Street West Munster Avenue between Kipling Avenue and Shawbridge Avenue Bering Avenue between Shawbridge Avenue and Islington Avenue Olivewood Road between Kipling Avenue and Shawbridge Avenue Shawbridge Avenue between Munster Avenue and Advance Road Advance Road between Kipling Avenue and Islington Avenue Norseman Street between Kipling Avenue and Islington Avenue Titian Road between Goodrich Road and Islington Avenue Goodrich Road between Titian Road and Jutland Road Jutland Road between Kipling Avenue and Islington Avenue Thomas Fisher Drive between Norseman Street and Islington Avenue Edward Horton Crescent between Thomas Fisher Drive and (north) and Thomas Fisher Drive (south) Augustus Terrace between Edward Horton Crescent and Thomas Fisher Drive Dundas Street West between Bloor Street West and Kipling Avenue	30	(Area 5) in Ward 03

5. Enact the following into Schedule XXXV in § 950-1334 as follows:

(From Column 1)	(From Column 2)	(From Column 3)	Action
Highway	Between	Speed Limit (km/h)	
Lloyd Manor Road	Eglinton Avenue West and Princess Margaret Boulevard	40	Enact
Hunting Ridge	Widdicombe Hill and Wincott Drive	40	Enact
Rangoon Road	Eringate Drive and Wellesworth Drive	40	Enact
Wellesworth Drive	The West Mall and Rangoon Road	40	Enact
Wincott Drive	Eglinton Avenue West and The Westway	40	Enact