

Parking Amendments - Corktown, Distillery and Canary Districts

Date: April 11, 2025

To: Toronto and East York Community Council

From: Director, Traffic Management, Transportation Services

Wards: Ward 13, Toronto Centre

SUMMARY

This staff report is about a matter that Community Council has delegated authority from City Council to make a final decision.

Transportation Services is recommending that the existing parking prohibitions on the following streets in the Corktown, Distillery and Canary Districts, be increased to standing prohibitions:

- Bright Street, west side, between Queen Street East and King Street East
- Cooperage Street, east side, between Palace Street and Mill Street
- Palace Street, south side, between Cooperage Street and Tannery Road
- Rolling Mills Road, east side, between Eastern Avenue and Mill Street
- Tannery Road, east side, between Front Street East and Mill Street
- Trinity Street, east side, between Front Street East and Mill Street

The proposed amendments will further deter parking on these roadways, which will improve unobstructed two-way traffic flow and provide a safer environment for all road users.

During the course of the investigation, it was noted that the existing on-street parking limits on the west side of Cooperage Street, north of Mill Street, do not reflect the current road alignment following the development construction at 409 Front Street East. The proposed amendments will correct this inconsistency.

RECOMMENDATIONS

The Director, Traffic Management, Transportation Services recommends that:

1. Toronto and East York Community Council authorize the amendments to parking regulations on Bright Street, Cooperage Street, Palace Street, Rolling Mills Road, Tannery Road, and Trinity Street, as described in Attachment 4.

FINANCIAL IMPACT

The signage costs associated with the proposed amendments are approximately \$12,600.00. Funding is available within the Transportation Services 2025 Operating Budget.

DECISION HISTORY

This report addresses a new initiative.

COMMENTS

The Ward Councillor, on behalf of Toronto Police Services - Parking Enforcement Unit, requested that the parking prohibitions on Bright Street, Cooperage Street, Palace Street, Rolling Mills Road, Tannery Road, and Trinity Street, be increased to standing prohibitions in order to further deter parking on these roadways. These parking amendments will help maintain unobstructed traffic flow and will also create clear sightlines, improving safety for pedestrians.

Existing Conditions

Bright Street

Bright Street is characterized by the following conditions:

- It is a two-lane, north-south, local roadway
- It operates one-way southbound traffic on a pavement width of approximately six metres
- The speed limit is 30 km/h
- Heavy trucks are prohibited at all times
- There is no Toronto Transit Commission (TTC) service provided
- There are sidewalks located on both sides of the street

The parking regulations on Bright Street, between Queen Street East and King Street East, are as follows:

East side

- Maximum one-hour parking, anytime

West side

- No parking, anytime

Cooperage Street

Cooperage Street is characterized by the following conditions:

- It is a two-lane, north-south roadway
- The road classification is pending
- It operates two-way traffic on a pavement width of approximately 8.2 metres
- The daily two-way traffic volume is approximately 500 vehicles
- The speed limit is 30 km/h
- Heavy trucks are permitted at all times
- There is no TTC service provided
- There are sidewalks located on both sides of the street

The parking regulations on Cooperage Street, between Palace Street and Mill Street, are as follows:

East side

- No stopping, anytime, between Mill Street and a point 35 metres north
- No parking, anytime, between a point 35 metres north of Mill Street and a point 60 metres further north
- No stopping, anytime, between a point 95 metres north of Mill Street and a point 30 metres north of Front Street East
- No parking, anytime, between a point 30 metres north of Front Street East and a point 9 metres south of Palace Street
- No standing, anytime, between Palace Street and a point 9 metres south

West side

- No stopping, anytime, between Mill Street and a point 37 metres north
- Parking machines, from 8:00 a.m. to 9:00 p.m., Monday to Saturday, and from 1:00 p.m. to 9:00 p.m., Sunday, between a point 37 metres north of Mill Street and a point 67 metres further north
- No stopping, anytime, between a point 104 metres north of Mill Street and a point 30 metres north of Front Street East
- Parking machines, from 8:00 a.m. to 9:00 p.m., Monday to Saturday, and from 1:00 p.m. to 9:00 p.m., Sunday, between a point 30 metres north of Front Street East and a point 9 metres south of Palace Street
- No standing, anytime, between Palace Street and a point 9 metres south
- Maximum three-hour statutory parking at all other times, where permitted

Palace Street

Palace Street is characterized by the following conditions:

- It is a two-lane, east-west, local roadway
- It operates two-way traffic on a pavement width of approximately 8.2 metres
- The speed limit is 30 km/h
- Heavy trucks are permitted at all times
- There is no TTC service provided
- There are sidewalks located on both sides of the street

The parking regulations on Palace Street, between Cooperage Street and Tannery Road, are as follows:

North side

- No standing, anytime, between Cooperage Street and a point 9 metres east
- Parking machines, from 8:00 a.m. to 9:00 p.m., Monday to Saturday, and from 1:00 p.m. to 9:00 p.m., Sunday, between a point 9 metres east of Cooperage Street and a point 9 metres west of Tannery Road
- No standing, anytime, between Tannery Road and a point 9 metres west
- Maximum three-hour statutory parking at all other times, where permitted

South side

- No standing, anytime, between Cooperage Street and a point 9 metres east
- No parking, anytime, between a point 9 metres east of Cooperage Street and a point 9 metres west of Tannery Road
- No standing, anytime, between Tannery Road and a point 9 metres west

Rolling Mills Road

Rolling Mills Road is characterized by the following conditions:

- It is a two-lane, north-south roadway
- The road classification is pending
- It operates two-way traffic on a pavement width of approximately 8.2 metres
- The daily two-way traffic volume is approximately 1,200 vehicles
- The speed limit is 30 km/h
- Heavy trucks are permitted at all times
- There is no TTC service provided
- There are sidewalks located on both sides of the street

The parking regulations on Rolling Mills Road, between Eastern Avenue and Mill Street, are as follows:

East side

- No stopping, anytime, between Mill Street and a point 35 metres north
- No parking, anytime, between a point 35 metres north of Mill Street and a point 60 metres further north

- No stopping, anytime, between a point 95 metres north of Mill Street and a point 41 metres north of Front Street East
- No parking, anytime, between a point 41 metres north of Front Street East and a point 62 metres north of Palace Street
- No stopping, anytime, between a point 62 metres north of Palace Street and Eastern Avenue

West side

- No stopping anytime, between Mill Street and a point 35 metres north
- Parking machines, from 8:00 a.m. to 9:00 p.m., Monday to Saturday, and from 1:00 p.m. to 9:00 p.m., Sunday, between a point 35 metres north of Mill Street and a point 60 metres further north
- No stopping, anytime, between a point 95 metres north of Mill Street and a point 41 metres north of Front Street East
- No parking, anytime, between a point 41 metres north of Front Street West and Palace Street
- Parking machines, from 8:00 a.m. to 9:00 p.m., Monday to Saturday, and from 1:00 p.m. to 9:00 p.m., Sunday, between Palace Street and a point 62 metres north
- No stopping, anytime, between a point 62 metres north of Palace Street and Eastern Avenue
- Maximum three-hour statutory parking at all other times, where permitted

Tannery Road

Tannery Road is characterized by the following conditions:

- It is a two-lane, north-south roadway
- The road classification is pending
- It operates two-way traffic on a pavement width of approximately 8.2 metres
- The speed limit is 30 km/h
- Heavy trucks are permitted at all times
- There is no TTC service provided.
- There are sidewalks located on both sides of the street.

The parking regulations on Tannery Road, between Front Street East and Mill Street, are as follows:

East side

- No stopping, anytime, between Mill Street and a point 41 metres north
- No parking, anytime, between a point 41 metres north of Mill Street and a point 36 metres further north
- No stopping, anytime, between a point 77 metres north of Mill Street and Front Street East

West side

- No stopping, anytime, between Mill Street and a point 30 metres north
- Parking machines, from 8:00 a.m. to 9:00 p.m., Monday to Saturday, and from 1:00 p.m. to 9:00 p.m., Sunday, between a point 30 metres north of Mill Street and a point 55 metres further north
- No stopping, anytime, between a point 85 metres north of Mill Street and Front Street East
- Maximum three-hour statutory parking at all other times, where permitted

Trinity Street

Trinity Street is characterized by the following conditions:

- It is a two-lane, north-south, local roadway
- It operates one-way southbound traffic on a pavement width of approximately 7.8 metres
- The daily one-way traffic volume is approximately 1,300 vehicles
- The speed limit is 30 km/h
- Heavy trucks are permitted at all times
- There is no TTC service provided
- There are sidewalks located on both sides of the street

The parking regulations on Trinity Street, between Front Street East and Mill Street, are as follows:

East side

- No parking, anytime, between Front Street East and a point 30.5 metres south
- No standing, anytime, between a point 30.5 metres south of Front Street East and Mill Street

West side

- No stopping, anytime, between Front Street East and a point 9 metres south
- Bus loading zone anytime, between a point 9 metres south of Front Street East and a point 41.5 metres further south
- Parking machines, from 8:00 a.m. to 9:00 p.m., Monday to Saturday, and from 1:00 p.m. to 9:00 p.m. Sunday, between a point 54 metres north of Mill Street and a point 50.5 metres south of Front Street East
- Permit parking, from 12:01 a.m. to 7:00 a.m., daily, between a point 54 metres north of Mill Street and a point 50.5 metres south of Front Street East
- Taxicab stand, anytime, between a point 20 metres north of Mill Street and a point 34 metres further north
- Accessible loading zone, anytime between a point 9 metres north of Mill Street and a point 11 metres further north
- No stopping, anytime, between Mill Street and a point 9 metres north
- Maximum three-hour statutory parking at all other times, where permitted

Transportation Services staff conducted field observations on January 29, 2025, during the morning and afternoon periods. Staff observed no on-street parking taking place on Bright Street, Cooperage Street, Palace Street, Rolling Mills Road, Tannery Road, or Trinity Street during this time. It was noted that sightlines and unobstructed traffic flow would be affected if motorists parked on these roadways, potentially impacting traffic operations and safety for all road users.

Proposed Changes

Under the existing no parking, anytime regulations on these roadways, vehicles displaying an accessible parking permit are exempt from this prohibition. As a result, the Ward Councillor has received numerous complaints from area residents of vehicles displaying accessible parking permits parking on these roadways, obstructing traffic flow, sightlines and impacting safety for all road users. Transportation Services, in consultation with the Ward Councillor and Toronto Police Services - Parking Enforcement Unit, recommends that the existing parking prohibition on these roadways be increased to no standing, anytime. Under this regulation motorists, including those displaying an accessible parking permit, are not allowed to park but can pick-up/drop-off passengers only.

Under the current parking regulation (no parking, anytime) one can legally load/unload goods. This curbside activity will be eliminated with this parking proposal.

Also, the existing on-street parking limits on the west side of Cooperage Street, north of Mill Street, will be amended in order to reflect the current road alignment following the development construction at 409 Front Street East. The proposed amendments will correct this inconsistency.

Maps of the area and proposed parking amendments are included in Attachments 1, 2, and 3.

The Ward Councillor has been advised of the recommendation of this staff report.

CONTACT

Dan Clement, CET, Manager Traffic Operations (Area 1), Transportation Services
416-397-5021, Dan.Clement@toronto.ca

SIGNATURE



for

Roger Browne, M.A.Sc., P. Eng.
Director, Traffic Management, Transportation Services

ATTACHMENTS

Attachment 1: Map - Parking Amendments - Trinity Street

Attachment 2: Map - Parking Amendments - Bright Street

Attachment 3: Map - Parking Amendments - Rolling Mills Road, Cooperage Street,
Palace Street and Tannery Road

Attachment 4: Parking Amendments - Bright Street, Cooperage Street, Palace Street,
Rolling Mills Road, Tannery Road and Trinity Street

Attachment 1: Map - Parking Amendments - Trinity Street

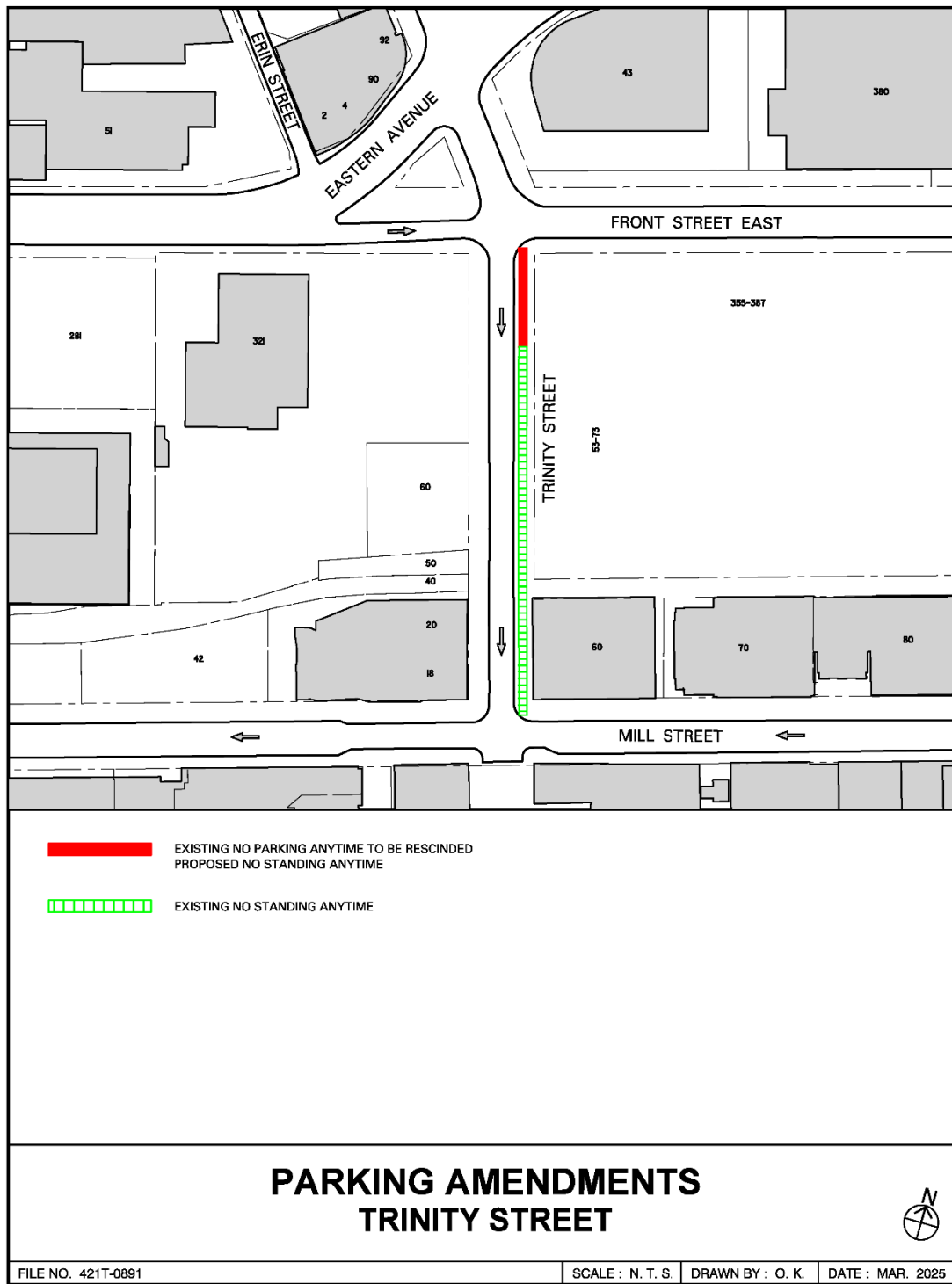

Attachment 2: Map - Parking Amendments - Bright Street

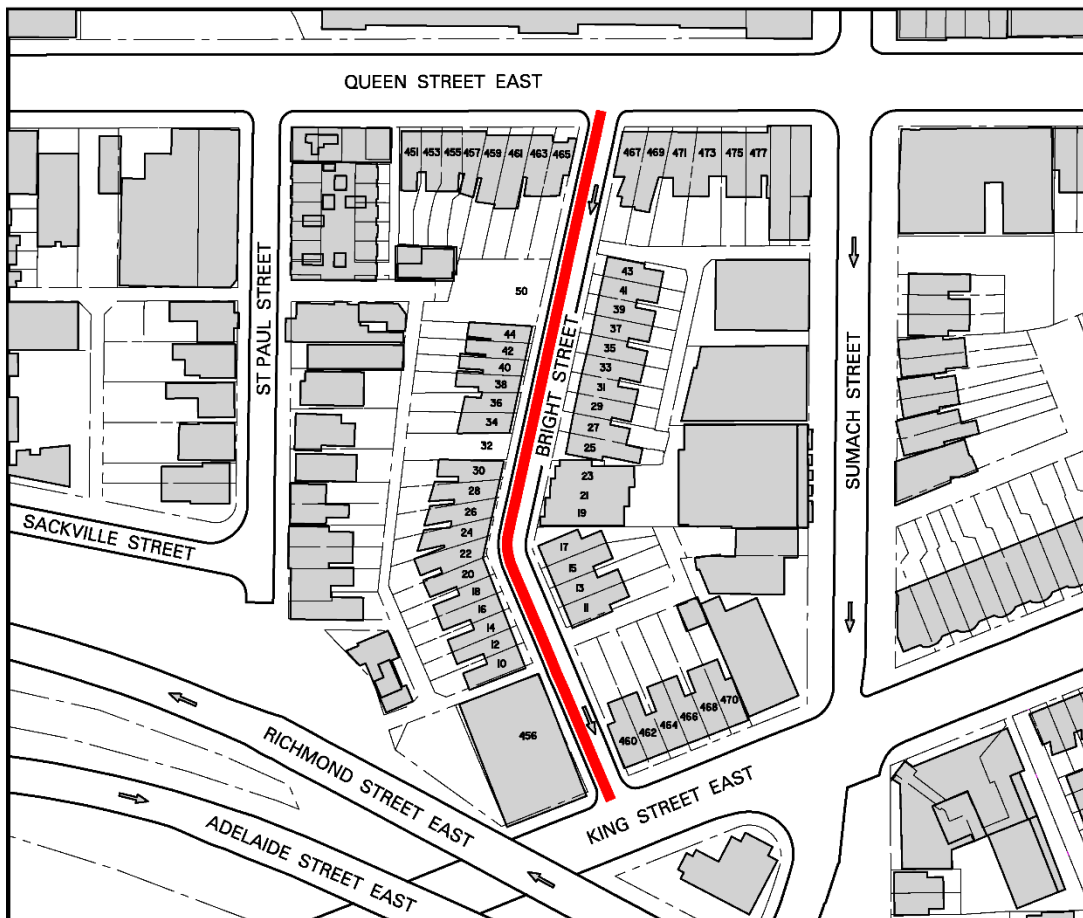

 EXISTING NO PARKING ANYTIME TO BE RESCINDED
 PROPOSED NO STANDING ANYTIME

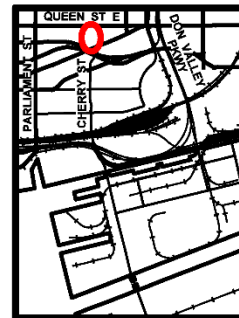

**PARKING AMENDMENTS
 BRIGHT STREET**



FILE NO. 421T-0892

SCALE: N. T. S.

DRAWN BY: O. K.

DATE: MAR. 2025

Attachment 3: Map - Parking Amendments - Rolling Mills Road, Cooperage Street, Palace Street and Tannery Road

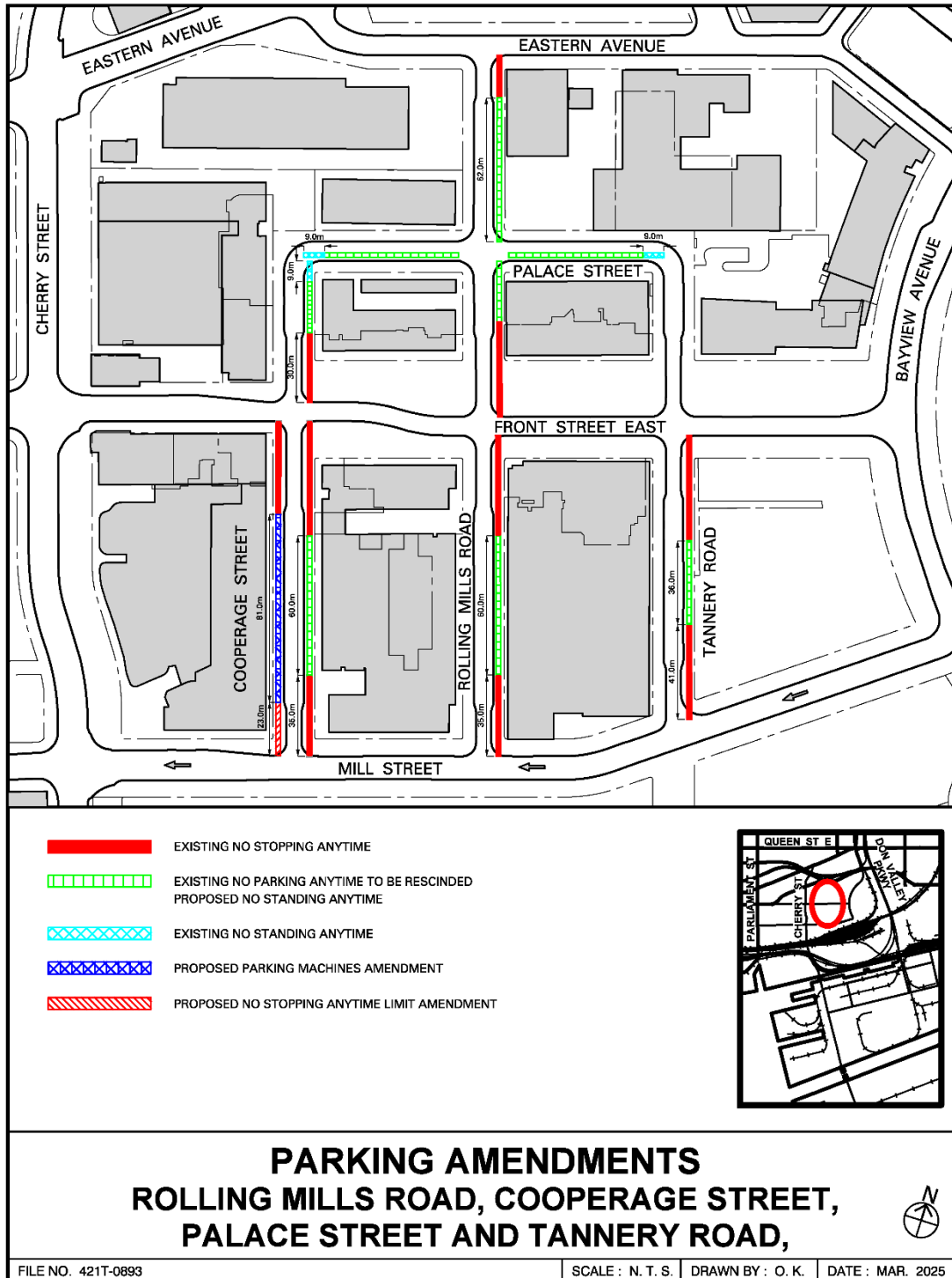

Attachment 4: Parking Amendments - Bright Street, Cooperage Street, Palace Street, Rolling Mills Road, Tannery Road and Trinity Street

Regulations to be rescinded:

Chapter 910, Schedule I: Parking Machines

Highway	Side Parking	Between	Hours (daily as indicated below)	Fee/Time Limit	Maximum Parking Period
Cooperage Street	West	A point 37 metres north of Mill Street and a point 67 metres further north	8:00 a.m. to 9:00 p.m., Mon. to Sat.; 1:00 p.m. to 9:00 p.m., Sun.	\$3.00 for 1 hour	3 hours

Chapter 950, Schedule XIII: No Parking

Highway	Side	Between	Prohibited Times and/or Days
Bright Street	West	King Street East and Queen Street East	Anytime
Cooperage Street	East	A point 35 metres north of Mill Street and a point 60 metres further north	Anytime
Cooperage Street	East	A point 30 metres north of Front Street East and a point 9 metres south of Palace Street	Anytime
Palace Street	South	A point 9 metres east of Cooperage Street and a point 9 metres west of Tannery Road	Anytime
Rolling Mills Road	East	A point 41 metres north of Front Street East and a point 62 metres north of Palace Street	Anytime
Rolling Mills Road	East	A point 35 metres north of Mill Street and a point 60 metres further north	Anytime
Tannery Road	East	A point 41 metres north of Mill Street and a point 36 metres further north	Anytime

Highway	Side	Between	Prohibited Times and/or Days
Trinity Street	East	Eastern Avenue and a point 30.5 metres south of Front Street East	Anytime

Chapter 950, Schedule XIV: No Stopping

Highway	Side	Between	Prohibited Times and/or Days
Cooperage Street	West	Mill Street and a point 37 metres north	Anytime

Regulations to be enacted:

Chapter 910, Schedule I: Parking Machines

Highway	Side Parking	Between	Hours (daily as indicated below)	Fee/Time Limit	Maximum Parking Period
Cooperage Street	West	A point 23 metres north of Mill Street and a point 81 metres further north	8:00 a.m. to 9:00 p.m., Mon. to Sat.; 1:00 p.m. to 9:00 p.m., Sun.	\$4.25 for 1 hour	3 hours

Chapter 950, Schedule XIII: No Parking

Highway	Side	Between	Prohibited Times and/or Days
Trinity Street	East	Eastern Avenue and Front Street East	Anytime

Chapter 950, Schedule XIV: No Stopping

Highway	Side	Between	Prohibited Times and/or Days
Cooperage Street	West	Mill Street and a point 23 metres north	Anytime

Chapter 950, Schedule XVI: No Standing

Highway	Side	Between	Prohibited Times and/or Days
Bright Street	West	King Street East and Queen Street East	Anytime
Cooperage Street	East	A point 35 metres north of Mill Street and a point 60 metres further north	Anytime
Cooperage Street	East	A point 30 metres north of Front Street East and a point 9 metres south of Palace Street	Anytime
Palace Street	South	A point 9 metres east of Cooperage Street and a point 9 metres west of Tannery Road	Anytime
Rolling Mills Road	East	A point 41 metres north of Front Street East and a point 62 metres north of Palace Street	Anytime
Rolling Mills Road	East	A point 35 metres north of Mill Street and a point 60 metres further north	Anytime
Tannery Road	East	A point 41 metres north of Mill Street and a point 36 metres further north	Anytime
Trinity Street	East	Front Street East and a point 30.5 metres south	Anytime