

SH

PROPOSED TWO-WAY SPEED HUMPS

A



B



NOTE:

EVERY ATTEMPT WILL BE MADE TO UTILIZE EXISTING POLES FOR SPEED HUMP SIGNS, HOWEVER, IT MAY BE NECESSARY TO INSTALL NEW POLES FOR THESE SIGNS.

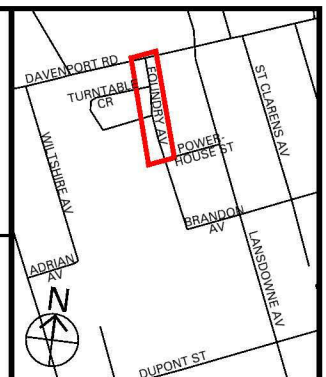

SPEED HUMPS LOCATIONS PLAN FOUNDRY AVENUE DAVENPORT ROAD - POWERHOUSE STREET