



**SH** PROPOSED TWO-WAY SPEED HUMP

A | 

B | 

B | 

NOTE:  
EVERY ATTEMPT WILL BE MADE TO UTILIZE EXISTING POLES FOR SPEED HUMP SIGNS, HOWEVER, IT MAY BE NECESSARY TO INSTALL NEW POLES FOR THESE SIGNS.

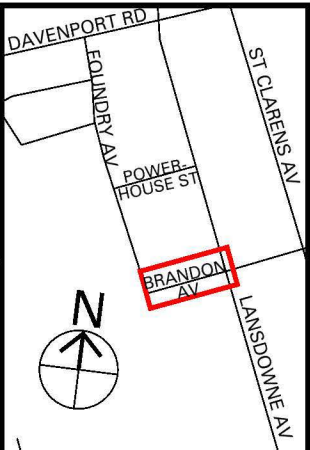

**SPEED HUMP LOCATIONS PLAN  
POWERHOUSE STREET  
FOUNDRY AVENUE - LANSDOWNE AVEUNE**