

SH	PROPOSED SPEED HUMP
A·	TRAFFIC CALMING ZONE
	MAXIMUM 30
B·	

NOTE:
 EVERY ATTEMPT WILL BE MADE TO UTILIZE EXISTING POLES FOR SPEED HUMP SIGNS, HOWEVER, IT MAY BE NECESSARY TO INSTALL NEW POLES FOR THESE SIGNS.

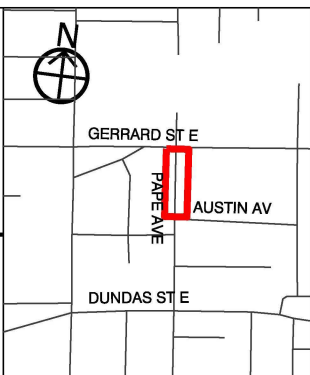

SPEED HUMP LOCATIONS PLAN

PAPE AVENUE

AUSTIN AVENUE - GERRARD STREET EAST