

**DELEGATED APPROVAL FORM
CHIEF CORPORATE OFFICER
DIRECTOR OF REAL ESTATE SERVICES**

TRACKING NO.: 2016-011

Approved pursuant to the Delegated Authority contained in Executive Committee Item EX43.7 entitled "**Delegation of Authority in Certain Real Estate Matters**" adopted by City Council on May 11 and 12, 2010 (City Council confirmatory By-law No. 532-2010, enacted on May 12, 2010), as amended by GM24.9 entitled "**Minor Amendments to Delegation of Authority in Certain Real Estate Matters**" adopted by City Council on October 8, 9, 10 and 11, 2013 (City Council confirmatory By-Law No. 1234-2013 enacted October 11, 2013), as amended by DAF 2013-307 and DAF 2014-087.

Approved pursuant to the Delegated Authority contained in Executive Committee Item EX33.44 entitled "**Union Station Revitalization Implementation and Head Lessee Selection**" adopted by City Council on August 5 and 6, 2009. City Council confirmatory By-law No. 749-2009, enacted on August 6, 2009.

Prepared By:	Adam Pressick	Division:	RES
Date Prepared:	January 14, 2016	Phone No.:	416-392-1166

Purpose
To obtain authority to amend the terms of a below market rent lease with the North York Harvest Food Bank (the "Tenant") at 2975 Don Mills Road (the "Leased Premises") approved by City Council in order to suspend the tenancy from November 1, 2015 to December 31, 2016, while the building housing the Leased Premises is under renovation.

Property
The Leased Premises are Room 123 and Room 124 of approximately 621 square feet of office and storage space at the Oriole Community Centre, known municipally as 2975 Don Mills Road (as shown on Schedule "A" and "B").

Actions

- To obtain authority to suspend a below market lease agreement with the Tenant from November 1, 2015 to December 31, 2016;
- The appropriate City Officials be authorized and directed to take the necessary action to give effect thereto.

Financial Impact
The amendments have no financial impact on the City.

The Deputy City Manager & Chief Financial Officer has reviewed this DAF and agrees with the financial impact information.

Comments
City Council on November 29, 30, and December 1, 2011 adopted Item GM9.9 and thereby authorized a below market lease agreement with the Tenant at the Leased Premises for a five (5) year term commencing February 1, 2012, and terminating on September 30, 2017. City Council on July 16, 17, 18 and 19, 2013, adopted Item GM23.13 which authorized an amendment to add approximately 117 square feet to the Leased Premises.

City Council authority stated that the Tenant is to continually operate at the Leased Premises throughout the term. On November 1, 2015, the City began extensive renovations to the Oriole Community Centre that necessitated total shutdown of the facility until December 31, 2016. The Tenant has agreed to a suspension of the below market lease agreement until renovations are completed. Upon completion of the renovations the Tenant will resume occupancy of the Leased Premises until the term of the lease ends on September 30, 2017. Parks, Forestry and Recreation staff have permitted the Tenant to occupy space at the Parkway Community Centre during the period of the suspension of the below market lease agreement.

Terms
All other terms and conditions of the below market lease agreement remain unchanged as approved by City Council, and are deemed to be fair and reasonable by Real Estate Services staff.

Property Details	Ward:	33 – Don Valley East
	Assessment Roll No.:	1908112740001000000
	Approximate Size:	Irregular
	Approximate Area:	57.7 m ² ± (621 ft ² ±)
	Other Information:	

A.	Director of Real Estate Services has approval authority for:	Chief Corporate Officer has approval authority for:
<p>1. Acquisitions:</p> <p>2. Expropriations:</p> <p>3. Issuance of RFPs/REOs:</p> <p>4. Permanent Highway Closures:</p> <p>5. Transfer of Operational Management to ABCDs:</p> <p>6. Limiting Distance Agreements:</p> <p>7. Disposals (including Leases of 21 years or more):</p> <p>8. Exchange of land in Green Space System & Parks & Open Space Areas of Official Plan:</p> <p>9. Leases/Licences (City as Landlord/Licensor):</p> <p>10. Leases/Licences (City as Tenant/Licensee):</p> <p>11. Easements (City as Grantor):</p> <p>12. Easements (City as Grantee):</p> <p>13. Revisions to Council Decisions in Real Estate Matters:</p> <p>14. Miscellaneous:</p>	<p><input type="checkbox"/> Where total compensation does not exceed \$1 Million.</p> <p><input type="checkbox"/> Statutory offers, agreements and settlements where total compensation does not cumulatively exceed \$1 Million.</p> <p>Delegated to a more senior position.</p> <p>Delegated to a more senior position.</p> <p>Delegated to a more senior position.</p> <p><input type="checkbox"/> Where total compensation does not exceed \$1 Million.</p> <p><input type="checkbox"/> Where total compensation does not exceed \$1 Million.</p> <p>Delegated to a more senior position.</p> <p><input type="checkbox"/> (a) Where total compensation (including options/renewals) does not exceed \$1 Million;</p> <p><input type="checkbox"/> (b) Where compensation is less than market value, for periods not exceeding three (3) months, including licences for environmental assessments and/or testing, etc.</p> <p><input type="checkbox"/> Where total compensation (including options/renewals) does not exceed \$1 Million.</p> <p><input type="checkbox"/> (a) Where total compensation does not exceed \$1 Million.</p> <p><input type="checkbox"/> (b) When closing road, easements to pre-existing utilities for nominal consideration.</p> <p><input type="checkbox"/> Where total compensation does not exceed \$1 Million.</p> <p><input checked="" type="checkbox"/> Amendment must not be materially inconsistent with original decision (and may include increase not to exceed the amount of the original decision by the lesser of 10 per cent and \$500,000).</p> <p><input type="checkbox"/> (a) Approvals, Consents, Notices and Assignments under all Leases/Licences;</p> <p><input type="checkbox"/> (b) Releases/Discharges;</p> <p><input type="checkbox"/> (c) Surrenders/Abandonments;</p> <p><input type="checkbox"/> (d) Enforcements/Terminations;</p> <p><input type="checkbox"/> (e) Consents/Non-Disturbance Agreements/Acknowledgements/Estoppels/Certificates;</p> <p><input type="checkbox"/> (f) Objections/Waivers/Cautions;</p> <p><input type="checkbox"/> (g) Notices of Lease and Sublease;</p> <p><input type="checkbox"/> (h) Consent to regulatory applications by City, as owner;</p> <p><input type="checkbox"/> (i) Consent to assignment of Agreement of Purchase/Sale; Direction re Title;</p> <p><input type="checkbox"/> (j) Documentation relating to Land Titles applications;</p> <p><input type="checkbox"/> (k) Correcting/Quit Claim Transfer/Deeds.</p>	<p><input type="checkbox"/> Where total compensation does not exceed \$3 Million.</p> <p><input type="checkbox"/> Statutory offers, agreements and settlements where total compensation does not cumulatively exceed \$3 Million.</p> <p><input type="checkbox"/> Issuance of RFPs/REOs.</p> <p><input type="checkbox"/> Initiate process & authorize GM, Transportation Services to give notice of proposed by-law.</p> <p><input type="checkbox"/> Transfer of Operational Management to ABCDs.</p> <p><input type="checkbox"/> Where total compensation does not exceed \$3 Million.</p> <p><input type="checkbox"/> Where total compensation does not exceed \$3 Million.</p> <p><input type="checkbox"/> Exchange of land in Green Space System and Parks and Open Space Areas of Official Plan.</p> <p><input type="checkbox"/> (a) Where total compensation (including options/renewals) does not exceed \$3 Million;</p> <p><input type="checkbox"/> (b) Where compensation is less than market value, for periods not exceeding six (6) months, including licences for environmental assessments and/or testing, etc.</p> <p><input type="checkbox"/> Where total compensation (including options/renewals) does not exceed \$3 Million.</p> <p><input type="checkbox"/> Where total compensation does not exceed \$3 Million.</p> <p>Delegated to a less senior position.</p> <p><input type="checkbox"/> Where total compensation does not exceed \$3 Million.</p> <p><input type="checkbox"/> Amendment must not be materially inconsistent with original decision (and may include increase not to exceed the amount of the original decision by the lesser of 10 per cent and \$1 Million).</p> <p><input type="checkbox"/> (a) Approvals, Consents, Notices and Assignments under all Leases/Licences;</p> <p><input type="checkbox"/> (b) Releases/Discharges;</p> <p><input type="checkbox"/> (c) Surrenders/Abandonments;</p> <p><input type="checkbox"/> (d) Enforcements/Terminations;</p> <p><input type="checkbox"/> (e) Consents/Non-Disturbance Agreements/Acknowledgements/Estoppels/Certificates;</p> <p><input type="checkbox"/> (f) Objections/Waivers/Cautions;</p> <p><input type="checkbox"/> (g) Notices of Lease and Sublease;</p> <p><input type="checkbox"/> (h) Consent to regulatory applications by City, as owner;</p> <p><input type="checkbox"/> (i) Consent to assignment of Agreement of Purchase/Sale; Direction re Title;</p> <p><input type="checkbox"/> (j) Documentation relating to Land Titles applications;</p> <p><input type="checkbox"/> (k) Correcting/Quit Claim Transfer/Deeds.</p>

B. Chief Corporate Officer and Director of Real Estate Services each has signing authority on behalf of the City for:

- 1. Agreements of Purchase and Sale and all implementing documentation for purchases, sales and land exchanges not delegated to staff for approval.
- 2. Expropriation Applications and Notices following Council approval of expropriation.
- 3. Documents required to implement the delegated approval exercised by him.

Chief Corporate Officer also has approval authority for:

- Leases/licences/permits at Union Station during the Revitalization Period, if the rent/fee is at market value.

Consultation with Councillor(s)									
Councillor:	Shelley Carroll					Councillor:			
Contact Name:	Shawna Teper					Contact Name:			
Contacted by:	Phone	<input checked="" type="checkbox"/>	E-Mail		Memo		Other		
Comments:	Concurs					Comments:			
Consultation with ABCDs									
Division:	PF&R/SDFA					Division:	Financial Planning		
Contact Name:	Marlene Rose/Faziela Bacchus					Contact Name:	Filisha Mohammed		
Comments:	No issues					Comments:	No issues		
Legal Division Contact									
Contact Name:	Barbara Cappell								
DAF Tracking No.: 2016-011					Date		Signature		
Recommended by: Wayne Duong, Manager of Leasing and Site Management					Feb/1/2016		Sgd.\ Wayne Duong		
<input type="checkbox"/>	Recommended by: Director of Real Estate Services Joe Casali				Feb/3/2016		Sgd.\ Joe Casali		
<input checked="" type="checkbox"/>	Approved by:								
<input type="checkbox"/>	Approved by: Chief Corporate Officer Josie Scioli						X		

General Conditions ("GC")

- (a) The local Councillor (or local Councillors if the subject property is located on a ward boundary or if the transaction involves an exchange of properties in more than one ward), will be consulted prior to the exercise of delegated Approving Authority by staff for all Acquisitions, Disposals, Land Exchanges and Leases.
- (b) Where approving power has been delegated to staff, the Chief Corporate Officer, in consultation with the applicable Deputy City Manager or the City Manager, may determine that such matter is of such special interest that same should be returned to the relevant Committee and Council for consideration and determination.
- (c) Exercise of delegated authority is subject to all applicable Council policies, statutes or other applicable law.
- (d) Authority to approve financial commitments/expenditures is subject to all amounts being available in an approved budget [or funding is available from alternative sources].
- (e) Property interests are to be based on appraised value, and no interest shall be granted at less than market value unless otherwise specifically authorized.
- (f) Authority to approve transactions at less than market value is subject to statutory anti-bonusing provisions.
- (g) Total compensation means the aggregate of all types of payments, including land value, estimated clean-up costs, potential arbitration awards, loss claims, etc, but exclusive of any applicable taxes and registration costs.
- (h) Authority to acquire property is conditional upon provision being made to bring the property into compliance with applicable MOE or other requirements such that it will be fit for its intended municipal purpose.
- (i) Authority to initiate the permanent road closure process in **A.4** is conditional upon confirmation by the GM of Transportation Services that it is feasible to permanently close the highway.
- (j) Disposal authorities in **A.7** are subject to the property having been declared surplus, and the disposal policy complied with.
- (k) Land exchanges, except for those in **A.8**, may be authorized based on the delegated Approving Authority for Disposals in **A.7**.
- (l) Approving Authority with respect to land located in the Designated Waterfront Area is conditional upon the approval of the Director, Waterfront Secretariat.
- (m) Authority to approve an exchange of land in **A.8** is conditional upon confirmation by the Chief Planner and Executive Director, and the GM of Parks, Forestry & Recreation, that the land being exchanged is (i) nearby land of equivalent or larger area, and (ii) of comparable or superior green space utility.
- (n) Approving Authority in **A.9** Leases (City as Landlord) but not Licences (City as Licensor) is limited to periods (including options/renewals) of less than twenty-one (21) years.
- (o) Total compensation in leasing matters where the City is landlord (**A.9**) includes the value of tenant improvements if factored into tenant's rental payments.
- (p) Total compensation in leasing matters where the City is the tenant (**A.10**) includes the value of any tenant improvements to be paid by the City.
- (q) Where options/renewals are included in leases, if the renewal rent is to be determined at a date later than the original approval date, total compensation is to be calculated as though all options are exercised, estimating the renewal rent based on the highest rent payable in the first term of the lease.
- (r) Total compensation in leasing matters where the City is landlord (**A.9**) or tenant (**A.10**) is to be calculated from the date of approval pursuant to this delegation (ie. first allowing for the expiry of any prior approvals, whether by Council or a delegated authority).
- (s) Approving Authority in leasing matters includes authority to approve renewals/extensions within the parameters of the delegated Approving Authority.
- (t) Approving Authority includes authority for amendments within the parameters of the delegated Approving Authority, the cumulative total of which may not exceed the delegated financial limit.
- (u) Where proposed additional amounts in **A.13** exceed 10 per cent of the original decision, even if otherwise in compliance with all other conditions, then approving authority is transferred upwards to the next more senior level of approving authority having the relevant overall financial limit.
- (v) Approving Authority includes authority for all documents necessary to implement the authority, on terms and conditions satisfactory to the Approving Authority, in consultation with the relevant operating Division(s).
- (w) Staff positions referred to in this delegation include successors from time to time.
- (x) Documents are to be in a form satisfactory to the City Solicitor (including indemnity and insurance provisions).
- (y) Delegated signing authorities in **B** are conditional upon the documents having received the City Solicitor's prior "Approval as to Form".
- (z) This delegation does not affect sales, acquisitions and leases over which the Affordable Housing Committee has responsibility.
- (aa) Authority to use land acquired by the City for parking purposes by the Toronto Parking Authority is conditional upon Council enacting a by-law designating such use.
- (bb) All residential leasing documents shall adhere to the *Residential Tenancies Act* and any successor legislation.
- (cc) Despite GC(n), Approving Authority in residential leasing matters is not limited to periods of less than twenty-one (21) years.

Schedule "A"- Location of Leased Premises

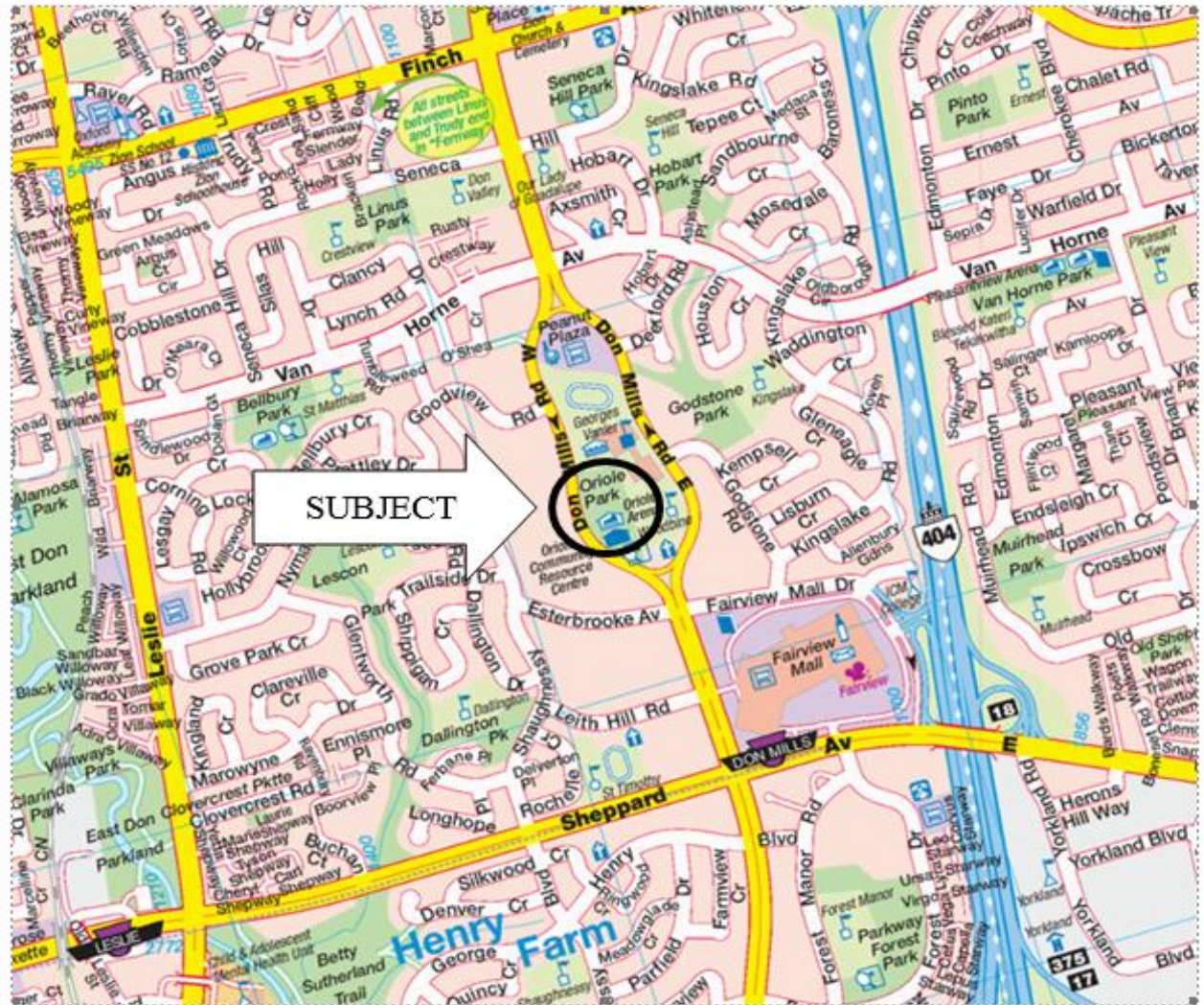

Schedule "B" – Site Plan of Leased Premises

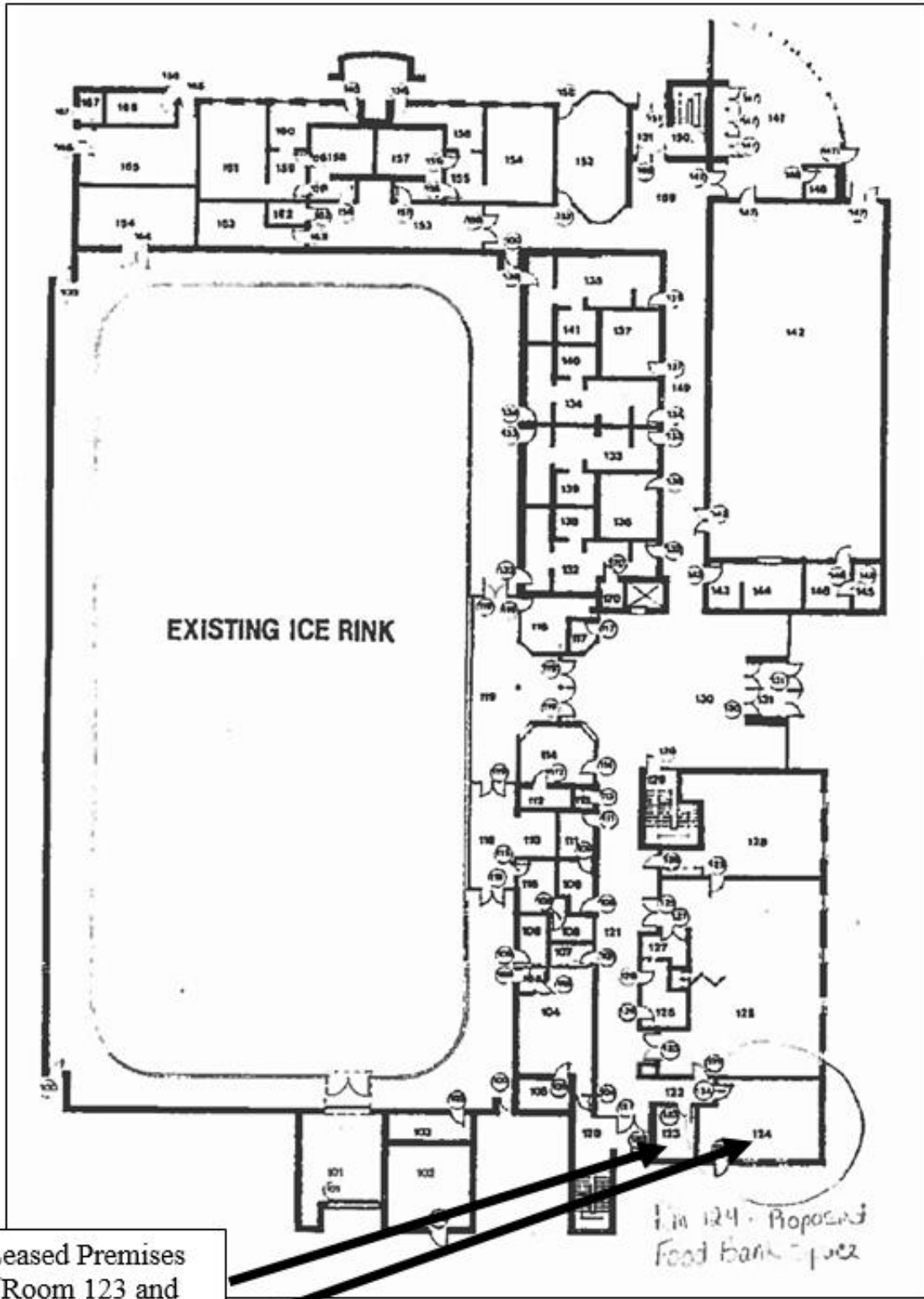

Leased Premises
(Room 123 and
Room 124)

Rm 124 - Proposed
Food Bank space