

Toronto Sidewalk Café Manual

SEPTEMBER 2015 . TRANSPORTATION SERVICES . PUBLIC REALM SECTION

FALL 2015 PROJECT UPDATE

*Project
Overview*

TORONTO SIDEWALK CAFÉ MANUAL

the project

THE MANUAL ...

- Describes the requirements for the design of sidewalk cafés
- Ensures that sidewalks are functional, well-designed, and meet the needs of all users
- Applies to all sidewalk patios within the public right-of-way
- Broken down into 'required', 'recommended' and 'optional' design criteria.



Project Scan

TORONTO SIDEWALK CAFÉ MANUAL

project scan

WHAT ARE OTHER CITIES DOING?

- Other cities have developed sidewalk café design guidelines & sidewalk design standards
- These cities have successfully balanced a vibrant café environment with pedestrian-oriented sidewalks

CHICAGO



SAN FRANCISCO



NEW YORK



BOSTON



project scan

WHAT ARE OTHER CITIES DOING?

- Many cities have adopted a higher pedestrian clearway standard for busy downtown commercial streets

<i>BUSY DOWNTOWN STREETS</i>	
Pedestrian Clearway Width (metres)	Jurisdiction
3.0 m to 6.5 m	Ottawa
4.6 m	San Francisco
3.66 m	Boston
3.66 m	Chicago
3.0 m to 3.5 m	Calgary
2.44 m <	Philadelphia
2.44 m	Portland
2.0 m to 4.0 m	Transportation Association of Canada
2.4m	Vancouver
2.4m	New York
2.1m	Toronto

TORONTO SIDEWALK CAFÉ MANUAL

project scan

POLICY CONTEXT

Existing Policies/Regulations

- Official Plan
- Vibrant Streets
- AODA IASR
- Toronto Accessibility Design Guidelines
- Toronto Green Standard

Emerging

- Complete Streets
- Engineering Guidelines for Roadworks

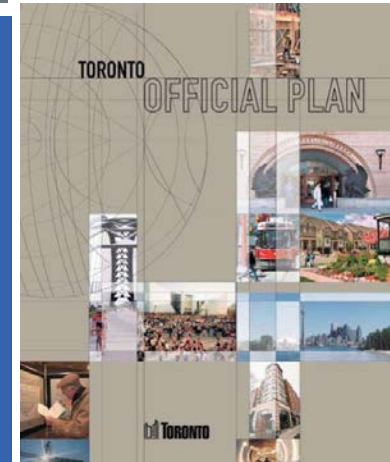
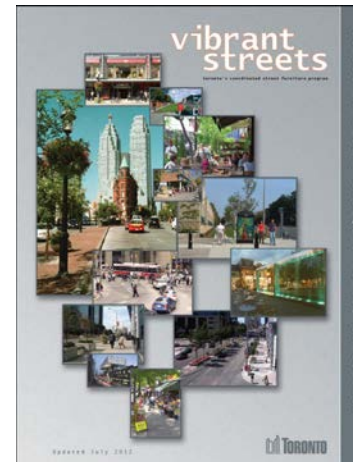

project scan

TORONTO'S CLEARWAYS

- Most existing bylaws require 2.1m pedestrian clearways
- Enhanced pedestrian clearways already exist on some of our busy downtown commercial streets

Chapter 743

Use of Streets & Sidewalks

743-3 Publication dispensing boxes: "No installation shall be placed, installed or maintained within 3.6 metres of the curb on Yonge Street, from Queen Street to Bloor Street".

Chapter 740

Street Vending

313-47 Boulevard cafes: "A total of at least 2.5 metres of paved sidewalk shall remain available for uninhibited pedestrian passage"

Toronto Community Council

July 1998

Boulevard Marketing:

" a minimum clear sidewalk width of 3.05m"

Spadina between Queen and Baldwin

Dundas between Spadina and Beverley

TORONTO SIDEWALK CAFÉ MANUAL

project scan

SIDEWALK DESIGN ISSUES

- Narrow pedestrian clearways



TORONTO SIDEWALK CAFÉ MANUAL

project scan

SIDEWALK DESIGN ISSUES

- Pedestrians forced to weave around sidewalk cafes



TORONTO SIDEWALK CAFÉ MANUAL

project scan

SIDEWALK DESIGN ISSUES

- Busy sidewalks

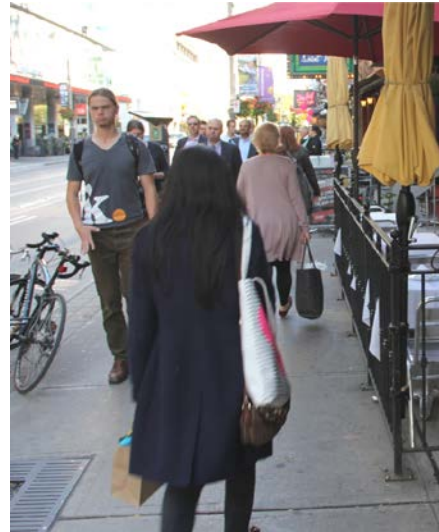

TORONTO SIDEWALK CAFÉ MANUAL

project scan

SIDEWALK DESIGN ISSUES

- Café encroachments

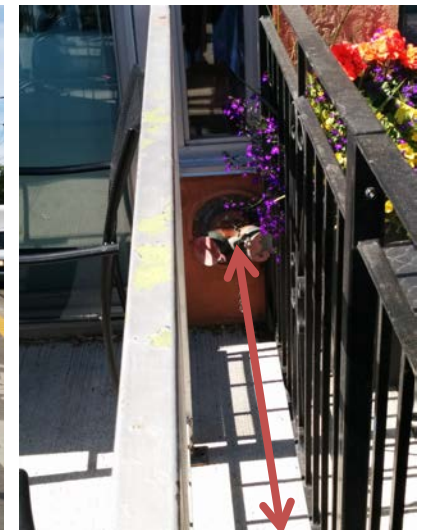

stakeholder consultation

FALL 2014 CONSULTATION PROGRAM

- Café Stakeholders 1
- Public Meetings 2
- Panel Displays 4
- Design Review Panel 1
- Disability Issues Committee 1
- Online Survey 1

Input and advice was received from over 700 individuals.

ONLINE SURVEY RESULTS

(>500 Completed Surveys)

“Wide sidewalks and straight clearways for pedestrians to pass unhindered is a significant priority.”

“Well designed and located patios can increase the attractiveness and ambiance of the street, and contribute to a more comfortable walking environment.”

“A diverse and thriving patio culture should be supported by the City, BIA’s, etc. through regulation and policy.”

“Noise emanating from sidewalk cafés can, at times, become an issue.”

“Flexibility to design creative and unique patios tailored to spaces and business needs is critical.”

“Patios contribute to safe and vibrant neighbourhoods.”

*Summary
of the
Manual*

TORONTO SIDEWALK CAFÉ MANUAL

objectives of the manual

GUIDANCE

Help people understand the by-law by providing additional guidance on planning and designing sidewalk cafés

SAFETY & ACCESSIBILITY

Provide for safety and accessibility for all sidewalk users regardless of age and ability

DESIGN EXCELLENCE

Encourage high quality well designed cafés that enhance the sidewalk experience and our City's economic competitiveness

FLEXIBILITY

Support local businesses by providing additional flexibility and options for the design of sidewalk cafés

SIMPLICITY

Help café applicants by explaining the process and providing links to resources

objectives of the manual

FLEXIBILITY

Additional sidewalk café options (curbside, parklet and small frontage café).

Option to use neighboring frontage to expand café (if owner agrees).

Reduction in clearway requirement to 1.7m for local streets.

Relaxed fencing requirements (planters, stanchions, portable fencing, no fencing).

Minimal restrictions on choice of café furniture and fencing (need to be sturdy and safe)

Streamlined application process.

Streamlined notification process.

SAFETY & ACCESSIBILITY

A straight, pedestrian clearway of minimum 2.1m (arterials/collectors) and 1.7m (local streets).

In some instances, a wider clearway on busy downtown streets with high pedestrian volumes.

TORONTO SIDEWALK CAFÉ MANUAL

using the manual

DIVIDED INTO ...

- **SIDEWALK DESIGN**
understanding sidewalk zones, design principles, and the pedestrian clearway
- **CAFÉ DESIGN**
understanding the potential café types, café location, and clearance requirements
- **ELEMENT SELECTION**
understanding the elements and furnishings of an sidewalk café, selecting the right elements for your design
- **PULLING IT ALL TOGETHER**
using the three previous sections to apply context appropriate cafés to various sidewalk types within the City
- **APPLICATION TOOL**
links and references located in the Appendices

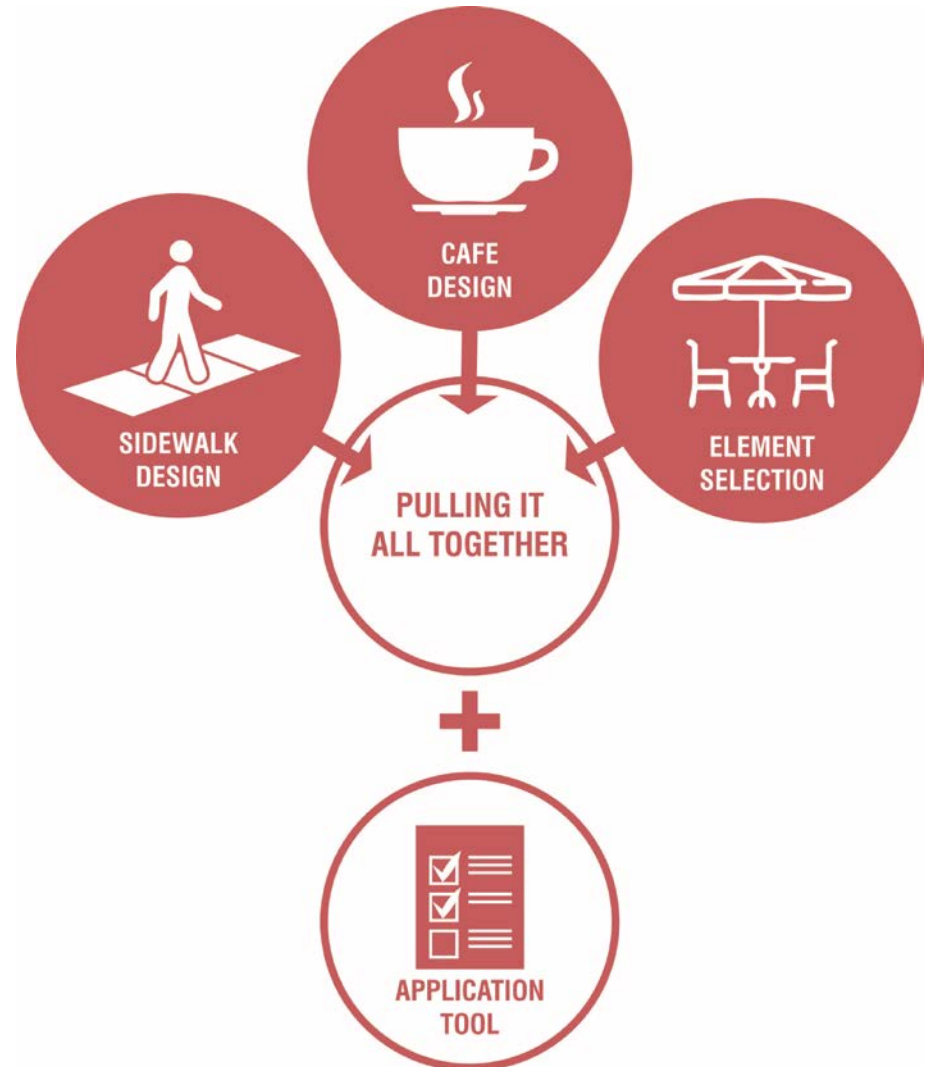

*Café
Design*

TORONTO SIDEWALK CAFÉ MANUAL

cafe design

CAFÉ DESIGN PRINCIPLES

- Safety & Accessibility
- Scale & integration
- Diversity
- Context

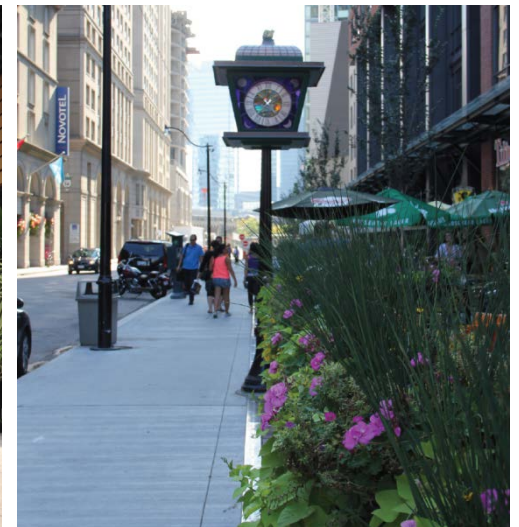
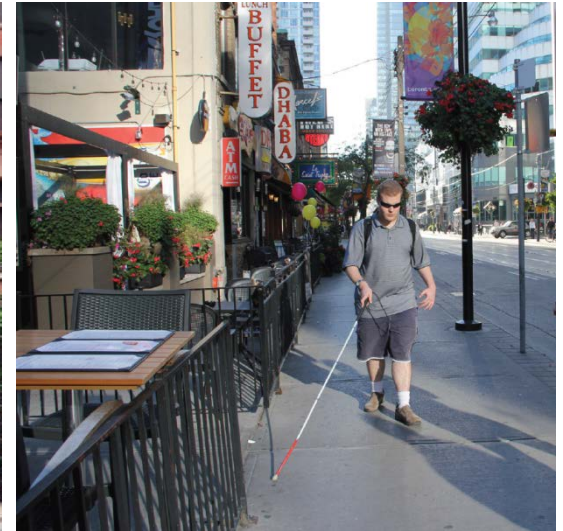

TORONTO SIDEWALK CAFÉ MANUAL

sidewalk design

SIDEWALK DESIGN PRINCIPLES

- Sidewalks of sufficient width
- Clear sidewalks
- Straight sidewalks
- Flexible sidewalks

VIBRANT STREETS



In 2006, Toronto City Council approved *Vibrant Streets* - Toronto's Coordinated Street Furniture Program.

Developed as a design and policy document, it focuses on key factors that contribute to good street design such as unobstructed and ample pedestrian sidewalks, sidewalk organization, reduction of clutter, and the design and maintenance of street furniture.

COMPLETE STREETS



The City of Toronto is developing *Complete Streets Guidelines* to provide a holistic approach for how we design our city streets. This builds on many of the City's existing policies, guidelines and recent successful street design and construction projects.

ACCESSIBILITY



The Manual responds to important pedestrian safety and accessibility legislation such as the *Accessibility for Ontarians with Disabilities Act* (AODA) and the *City of Toronto Accessibility Design Guidelines*.

The AODA is provincial legislation that governs accessibility issues in the public realm. It requires all public sidewalks to have minimum clearway widths to ensure all persons can navigate the public realm safely. Pedestrian volumes are a key factor in calculating minimum clearway widths. As such, high minimums are required for all City of Toronto streets.

The *City of Toronto Accessibility Design Guidelines* are specific to the Toronto context and help to further refine public realm design standards such as pedestrian clearway widths, among others.

Common accessibility requirements specific to cafés are explained in detail in the Manual based on these two documents.

sidewalk design

CLEAR STRAIGHT SIDEWALKS OF SUFFICIENT WIDTH

- Applies to new applications and patio renewals

Clearway Provisions (consultation draft)

A pedestrian clearway of minimum of 2.1 metres in width for arterial and collector streets and 1.7 metres in width for local streets unless the General Manager deems a greater minimum is required to safely accommodate pedestrians.

A pedestrian clearway that is straight and generally parallel to the property line, unless the General Manager deems that a deviation is permissible.

TORONTO SIDEWALK CAFÉ MANUAL

cafe design

CAFÉ TYPES

- Frontage café
- Small frontage café
- Flankage café
- Curbside café
- Parklet café

CAFÉ COMBINATIONS

- Curbside & parklet
- Frontage & curbside
- Frontage & parklet



TORONTO SIDEWALK CAFÉ MANUAL

café design

FRONTAGE CAFÉ

- Occupies the section of the sidewalk between the building and pedestrian clearway
- Effective on Main Streets with fairly generous sidewalk widths

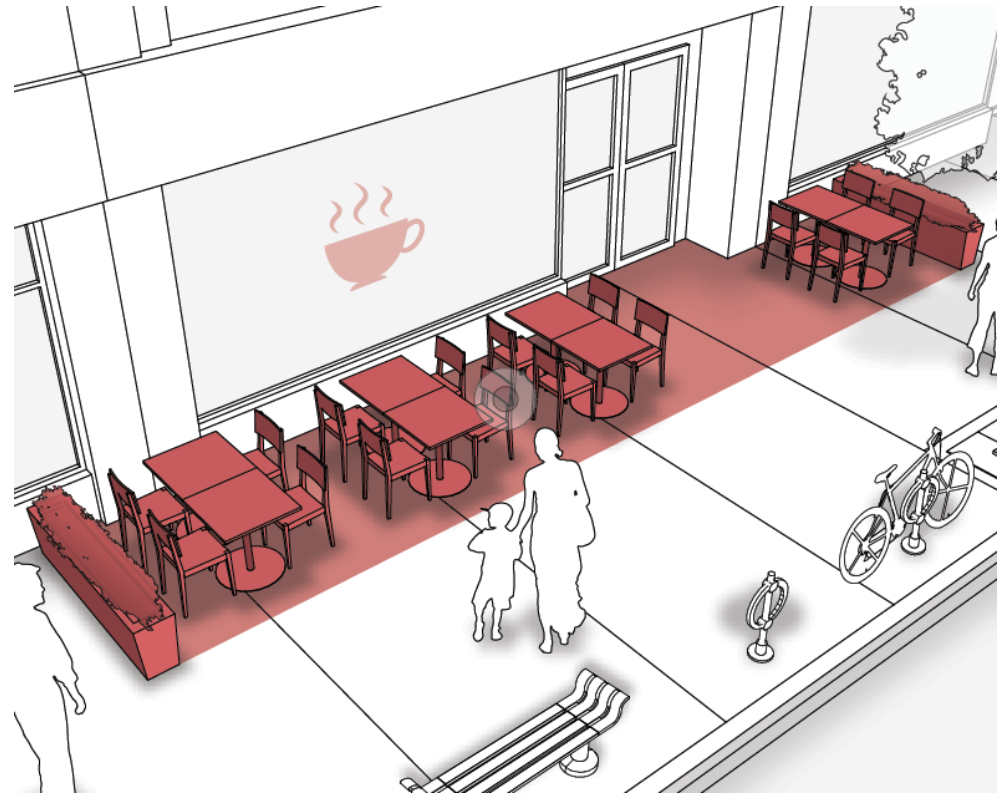

TORONTO SIDEWALK CAFÉ MANUAL

café design

SMALL FRONTAGE CAFÉ

- Located immediately adjacent to the building façade and extending to a maximum of 0.8m from the building
- Simplified application process
- Effective on streets with constrained sidewalks

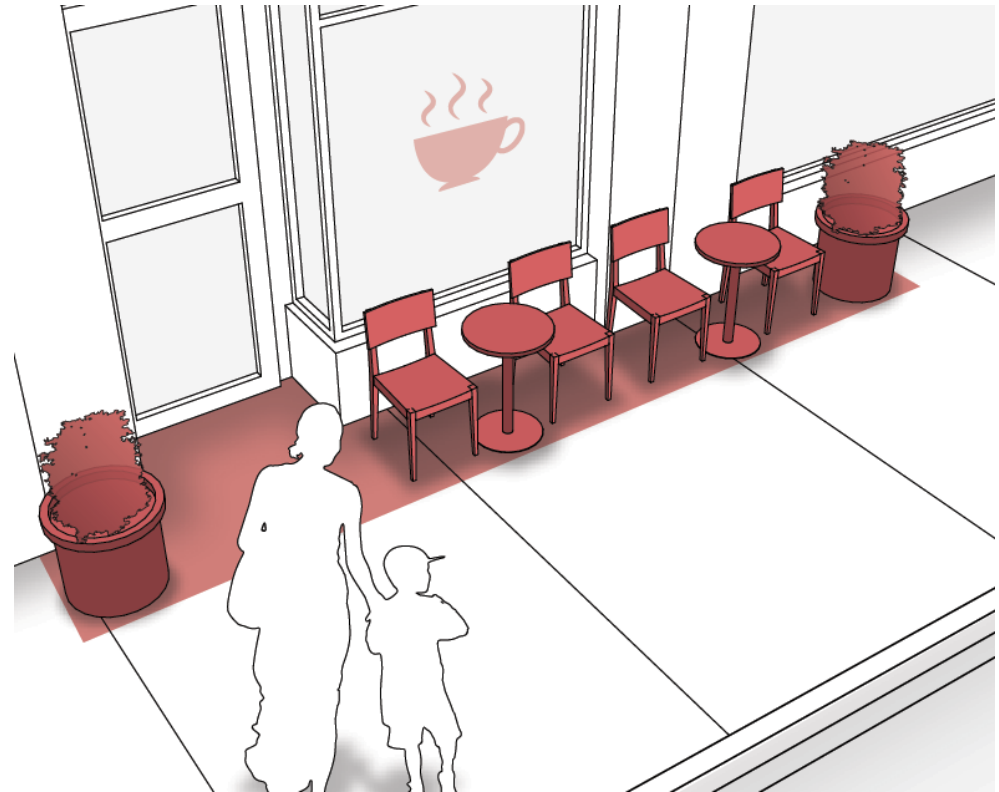

TORONTO SIDEWALK CAFÉ MANUAL

café design

FLANKAGE CAFÉ

- Located on the secondary frontage of the café
- Effective for side-streets with generous sidewalk widths

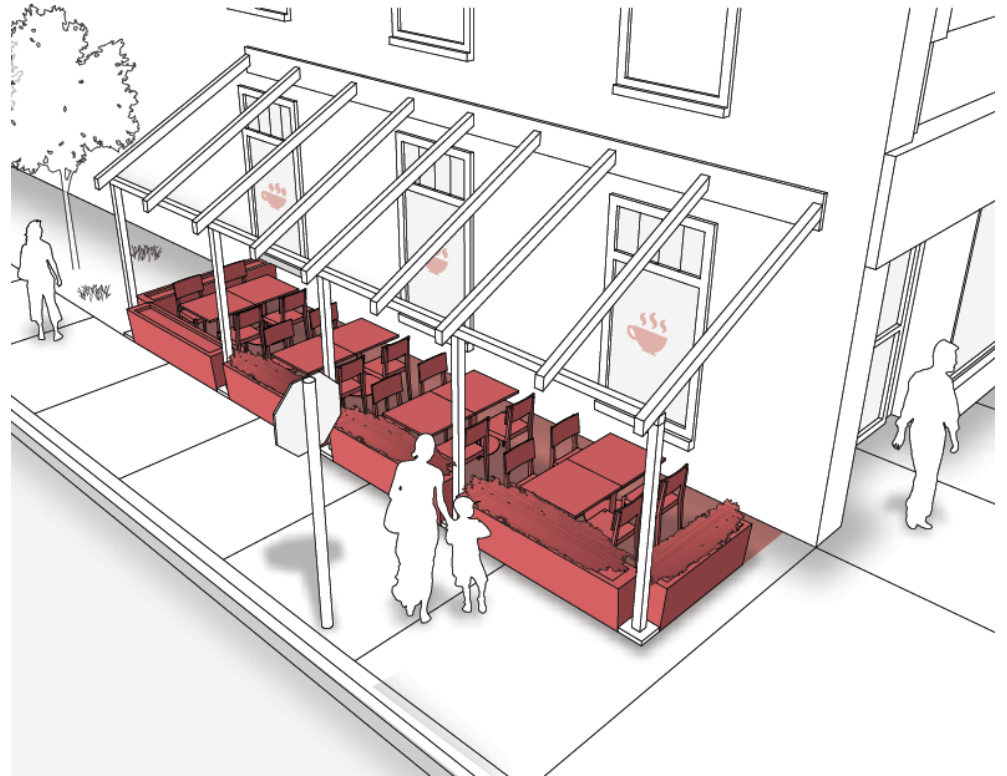

TORONTO SIDEWALK CAFÉ MANUAL

café design

CURBSIDE CAFÉ

- Occupies the sidewalk between the pedestrian clearway and the curb edge
- Effective when placed on streets with constrained sidewalks or with wider curbside zones

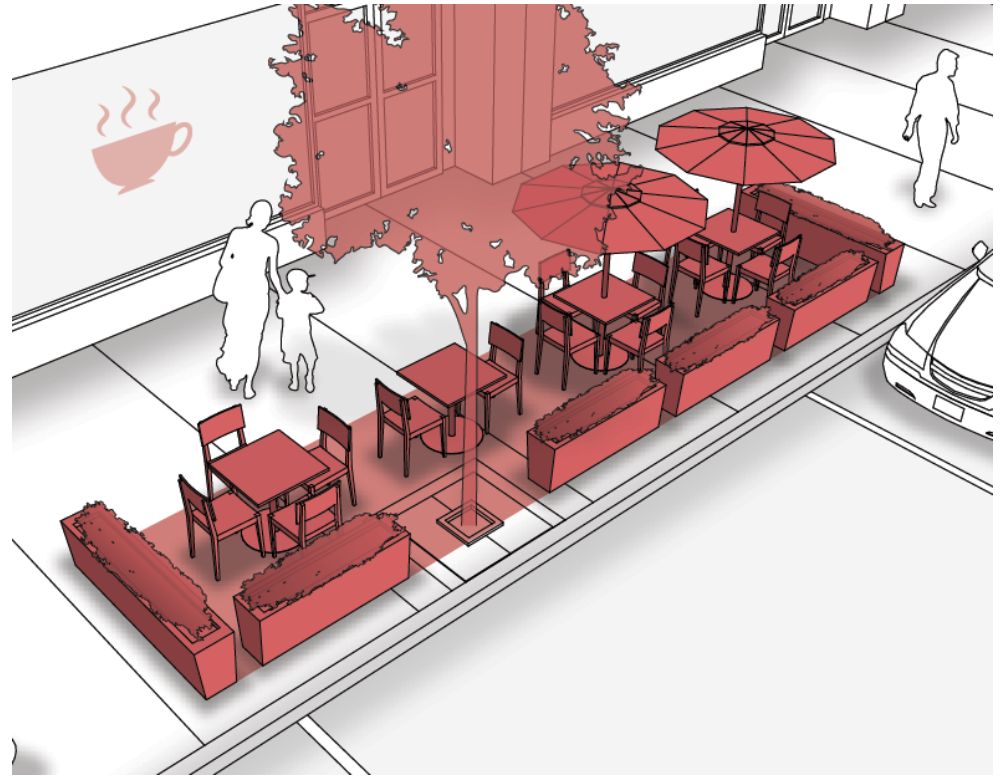

TORONTO SIDEWALK CAFÉ MANUAL

café design

PARKLET CAFÉ

- Occupies the curb lane or parking lane of a road
- Suitable for streets with permanent parking

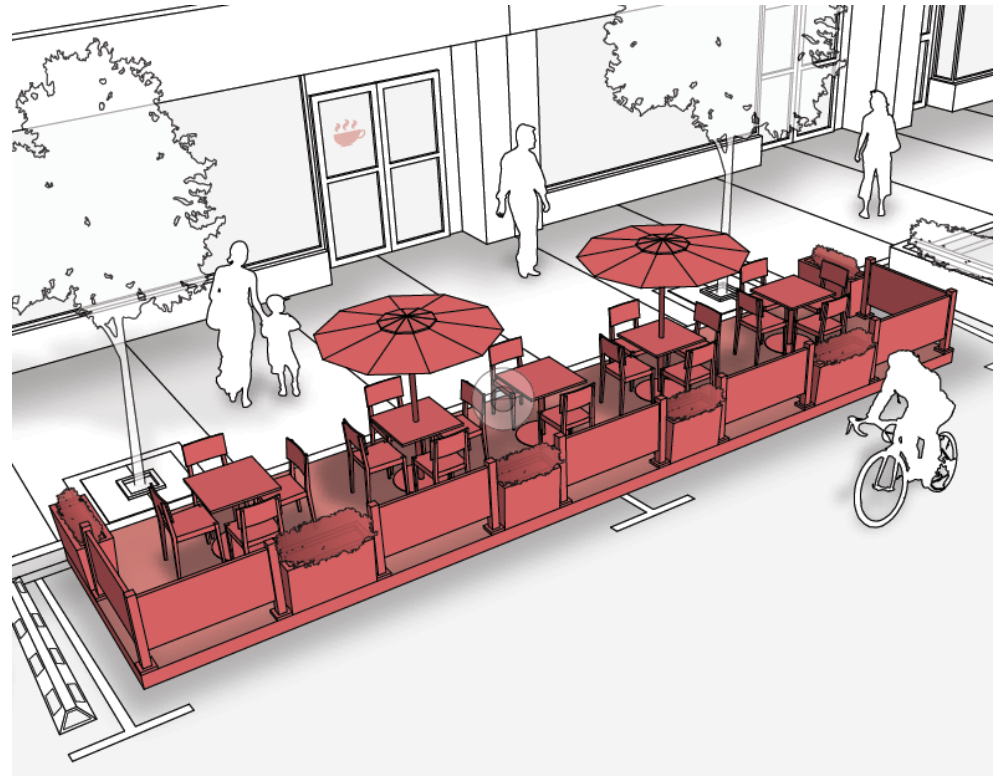

café design

CURBSIDE & PARKLET CAFÉ

- In some circumstances, the curbside zone can be added to the parklet café

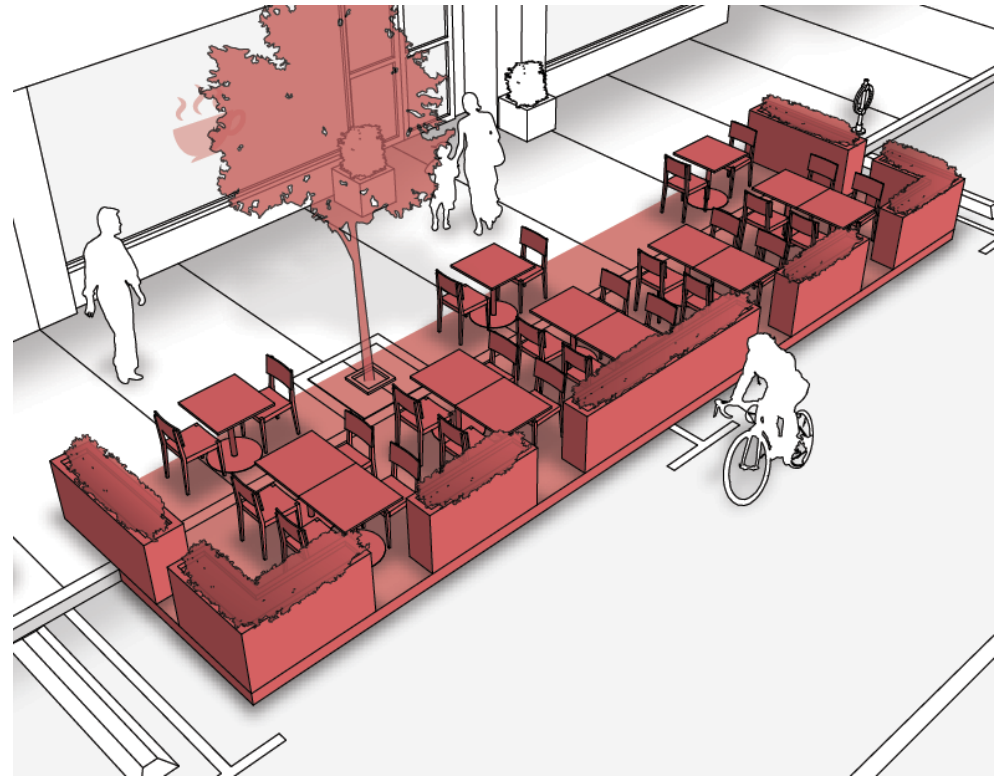

café design

FRONTAGE & CURBSIDE CAFÉ

- Creates two separate café areas that are bisected by the pedestrian clearway
- Can make more efficient use of the sidewalk
- If fencing is not used, a more generous clearway will be required

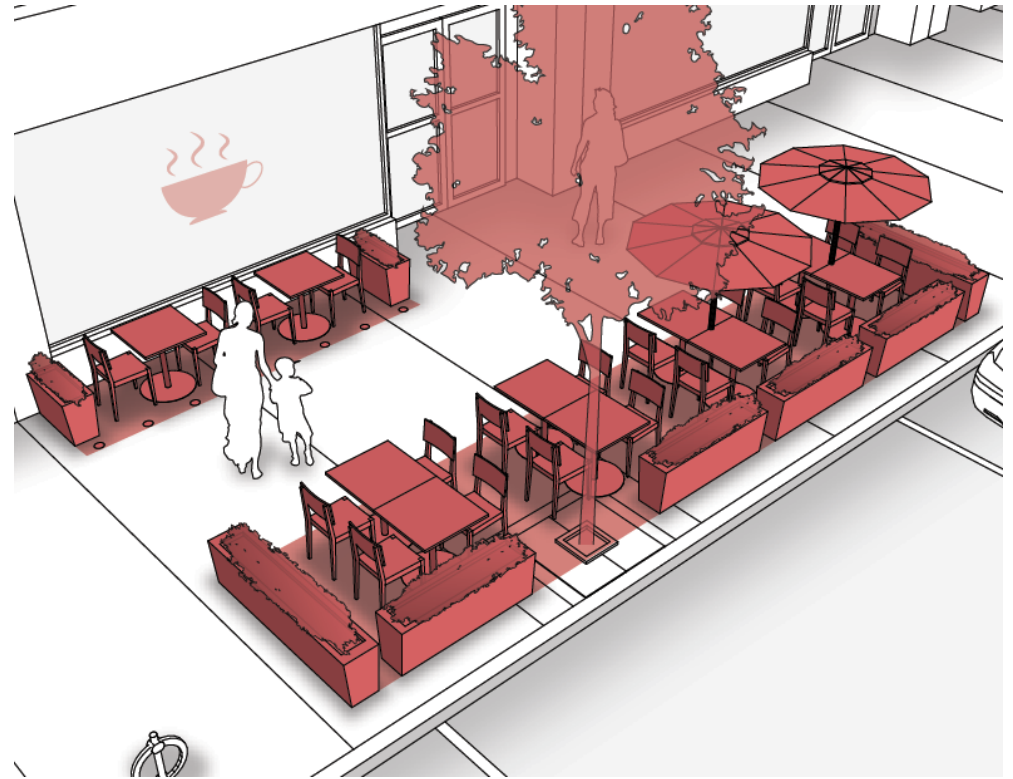

TORONTO SIDEWALK CAFÉ MANUAL

café design

SITE DESIGN REQUIREMENTS

- Sets out the site design requirements for the various café types and configurations

FRONTAGE & FLANKAGE CAFES

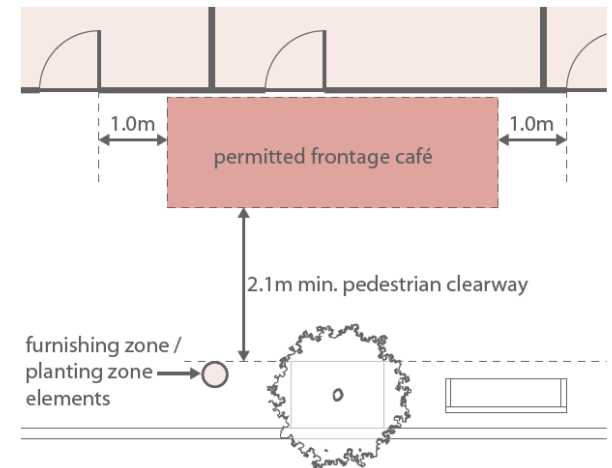

Required

Speed Limit – Frontage, small frontage and flankage cafés must be sited on streets with a speed limit of 60km/h or less.

Café Length – Frontage and small frontage cafés may be sited along the full width of the commercial street building frontage.

Separation – A minimum 1.0m separation is required between the café perimeter and any entrance to a dwelling unit located within an adjacent building, or within the building containing the establishment.

Other Requirements - Cafés must meet all clearance requirements specified in Section 3.4.

TORONTO SIDEWALK CAFÉ MANUAL

café design

ACCESSIBILITY REQUIREMENTS

- Appear throughout the document

COMMON ACCESSIBILITY REQUIREMENTS

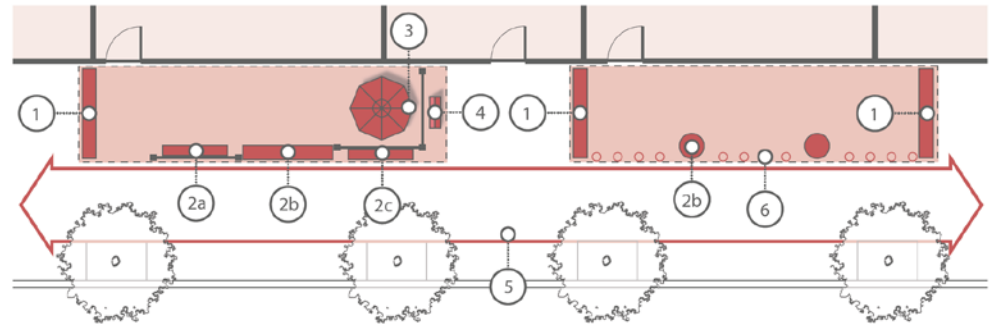

Required

Barriers - The roadway side of parklet cafés must have appropriate edge treatments such as planters, railings or cabling to protect café patrons from moving traffic.

Pedestrian Clearways - Pedestrian clearways must be straight, clear of obstructions, and of sufficient width to accommodate pedestrian movement.

Encroachments - All patio elements, with the exception of umbrella overhangs, must be contained within the permitted café area. Umbrellas must be a minimum of 2.2m above grade.

Cane Navigation Aids - Planters or fencing must be provided at the leading and trailing edge of the café (perpendicular to the building face).

Pavement Dots - Pavement markings that delineate the permitted café area must be provided.

Fencing - Fencing must be cane-detectable, with a bottom rail 75mm above grade.

Alignment - Planters at or near the edge of the pedestrian clearway must be aligned;

Recommended

Pedestrian Permeability - The side of parklet and curbside cafés facing the pedestrian clearway should be open and permeable to pedestrians.

Example Layouts

The sketches above illustrate these features:

- 1 - Cane navigation aids (planters or fencing)
- 2 - Planters sited within permitted café area
 - 2a - attached to inside of fence
 - 2b - placed on pavement
 - 2c - attached to outside of fence
- 3 - Umbrellas and awnings >2.2m above grade
- 4 - A-frame signs within permitted café area
- 5 - Pedestrian clearway
- 6 - Pavement dots

TORONTO SIDEWALK CAFÉ MANUAL

café elements

SUMMARY OF ELEMENTS

- Fencing and partitions
- Tables and chairs
- Awnings and umbrellas
- Café decks
- Temporary café enclosures
- Planters and planter boxes
- Branding and advertising
- Anchoring techniques
- Lighting
- Street trees



TORONTO SIDEWALK CAFÉ MANUAL

cafe elements

FENCING AND DELINEATION

Café operators are encouraged to consider using a wider range of fencing and perimeter delineation techniques:

- Planters
- Pavement dots
- Moveable fencing
- Stanchions

These options offer much more flexibility than the traditional fixed fencing option

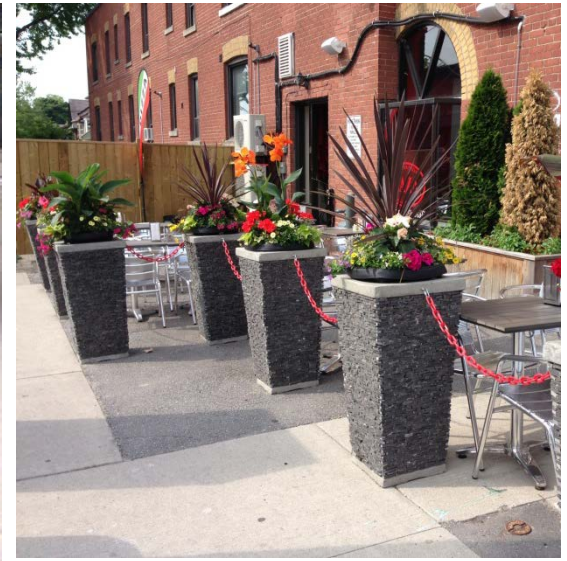

TORONTO SIDEWALK CAFÉ MANUAL

cafe elements

TABLES AND CHAIRS

Café operators are encouraged to consider using a range of furniture types:

- Moulded plastics
- Resin wicker
- Decorative metal
- Finish grade wood

All tables and chairs must be sturdy and safe for public use

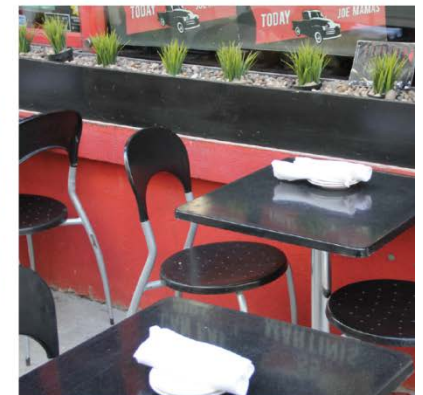

'pulling it all together'

'PULLING IT ALL TOGETHER'

- Pulls together the sidewalk design, café design and café element sections together
- Shows the reader how the various design elements can be applied to different types of sidewalks
- Organized into 'wide', 'average' and 'narrow' sidewalk configurations

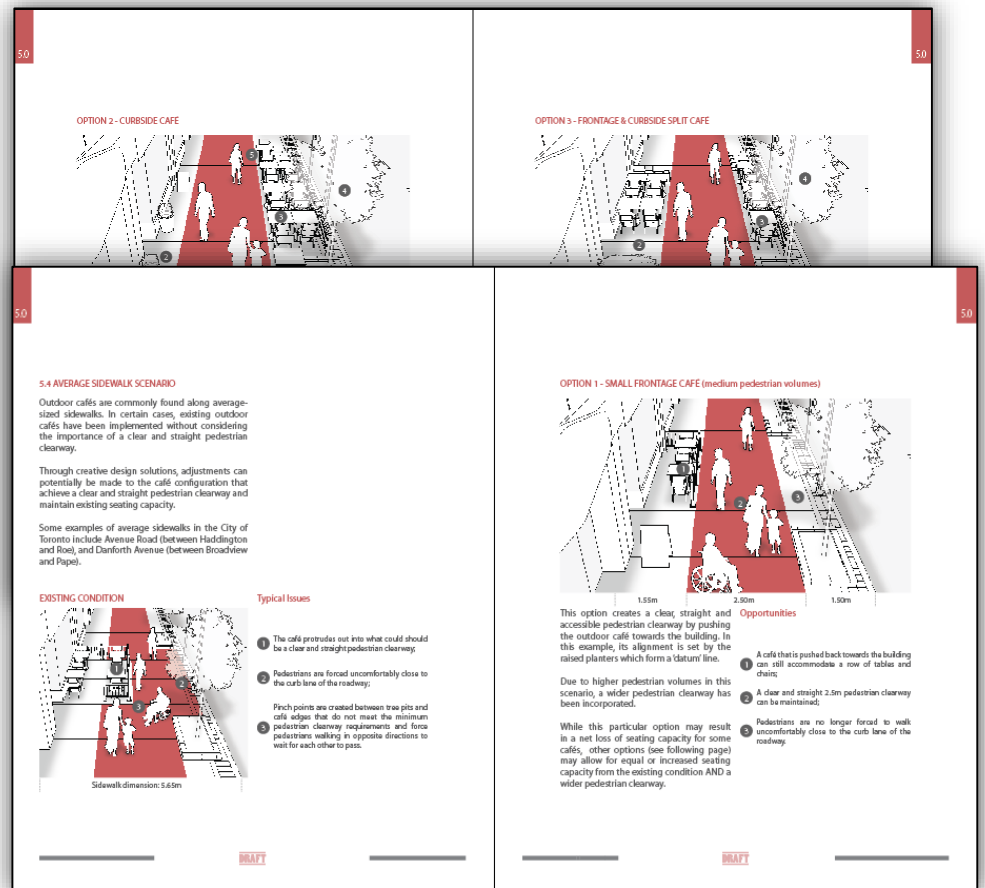

'pulling it all together'

EXISTING CONDITION

- A straight pedestrian clearway of sufficient width is not provided

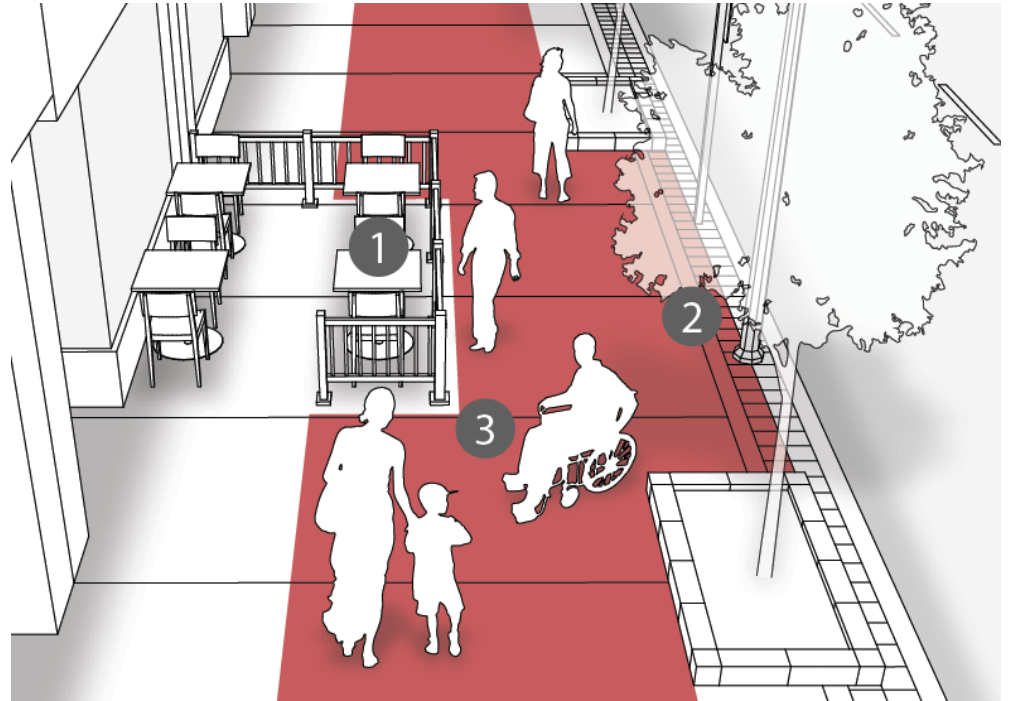

Typical Issues

- 1 - The café protrudes out into what should be a clear and straight pedestrian clearway;
- 2 - Pedestrians are forced uncomfortably close to the curb lane of the road;
- 3 - Pinch points are created between tree pits and café edges that do not meet the minimum pedestrian clearway requirements and force pedestrians walking in opposite directions to wait for each other to pass.

'pulling it all together'

OPTION 1:

RETAIN AS FRONTAGE CAFÉ

- Creates a clear, straight and accessible pedestrian clearway
- Pedestrian clearway alignment is set by the raised tree pits
- May result in a net loss of seating capacity for some cafés
- Other options (next slides) may allow for equal or increased seating capacity

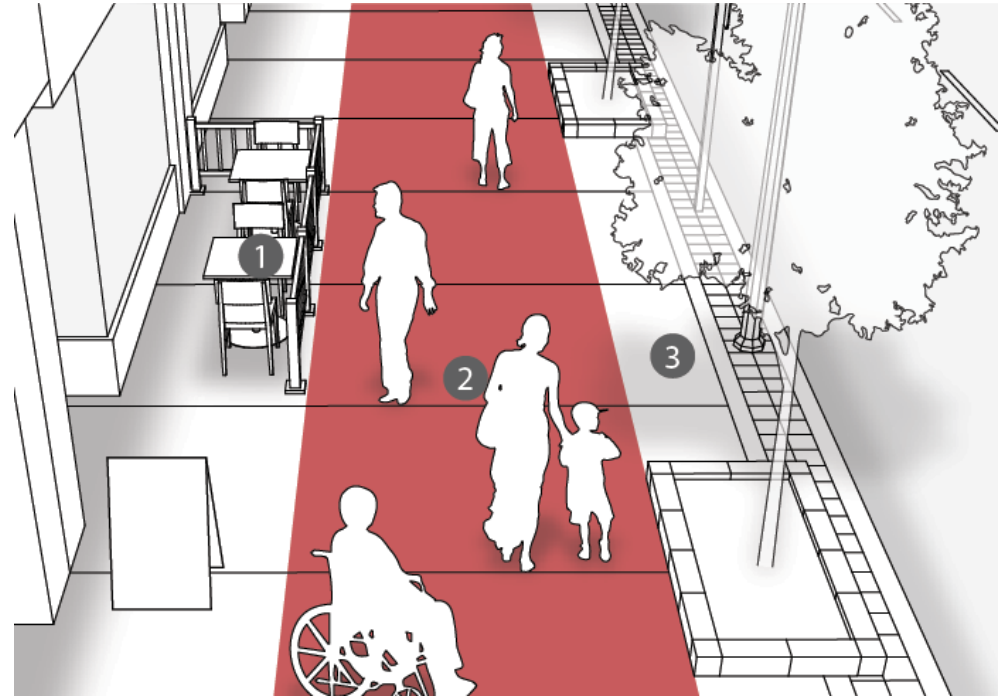

Opportunities

1 - A café that is pushed back towards the building can still accommodate a row of tables and chairs;

2 - A clear and straight 2.5m pedestrian clearway can be maintained;

3 - Pedestrians are no longer forced to walk uncomfortably close to the curb lane of the road.

'pulling it all together'

OPTION 2: USE CURBSIDE CAFÉ

- Creates a clear, straight and accessible pedestrian clearway
- May maintain existing café capacity & a wider pedestrian clearway
- Potential to use neighbouring business frontage

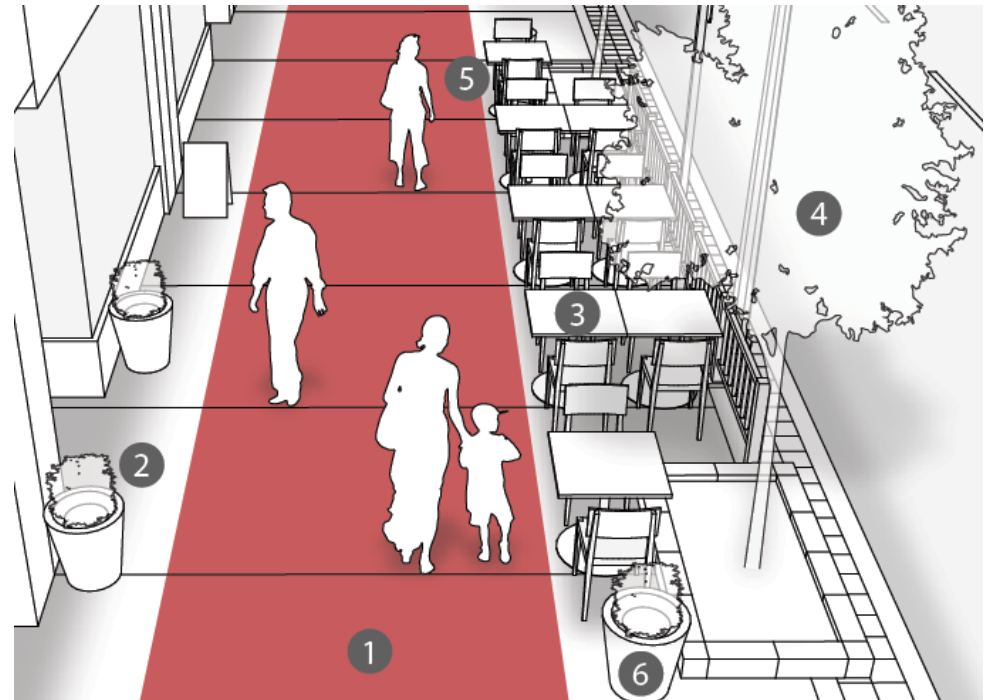

Opportunities

- 1 - Clear and straight 2.5m pedestrian clearway;
- 2 - Frontage zone accommodates planters and A-frame signs;
- 3 - The same or greater number of tables can be achieved;
- 4 - Existing street trees can be incorporated into the café area;
- 5 - The café may extend across the adjacent frontage;
- 6 - planters at the café edge provide cane navigation guides.

'pulling it all together'

OPTION 3: USE SPLIT CAFÉ

- Creates a clear, straight and accessible pedestrian clearway
- May maintain existing café capacity & a wider pedestrian clearway
- Potential to use neighbouring business frontage
- The alignment of the pedestrian clearway is set by the raised tree pits

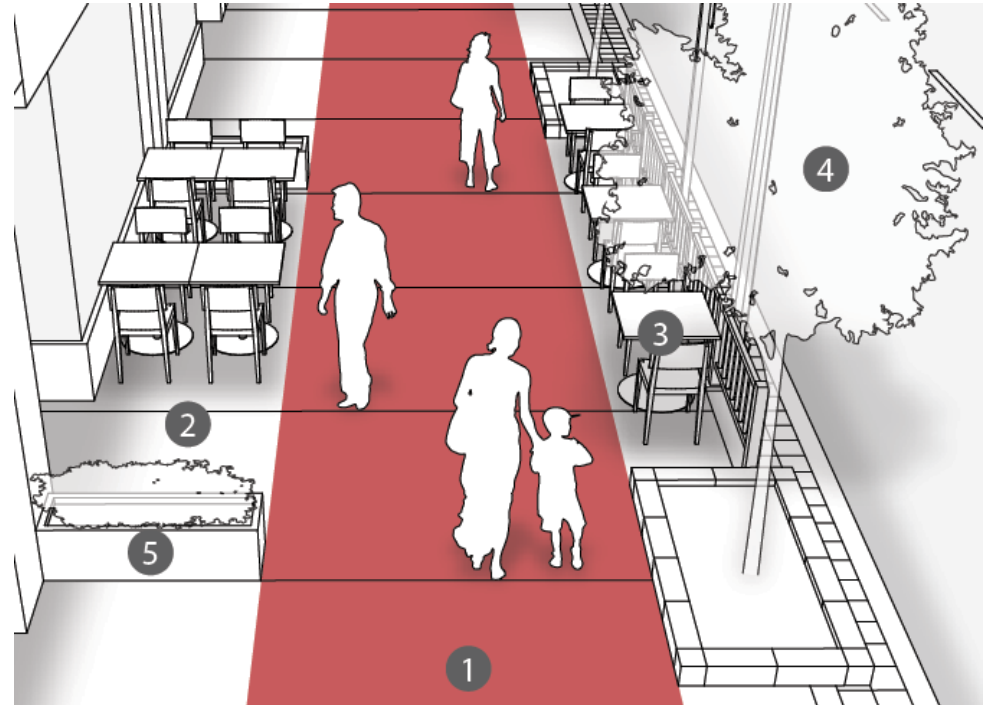

Opportunities

- 1 - Clear and straight 2.75m pedestrian clearway (0.25m buffer for open edges);
- 2 - Frontage zone expanded, allowing for a double row of tables;
- 3 - Single row of tables can fit between tree pits;
- 4 - Existing street trees incorporated into the café area providing shade;
- 5 - Planters at the café edge provide cane navigation guides.

applications

APPLICATION PROCESS

This section will help applicants understand:

- City roles & responsibilities
- Successful application features
- Key components of the application process
- Applicant responsibilities

Resources are provided to help the applicant successfully navigate the café application process

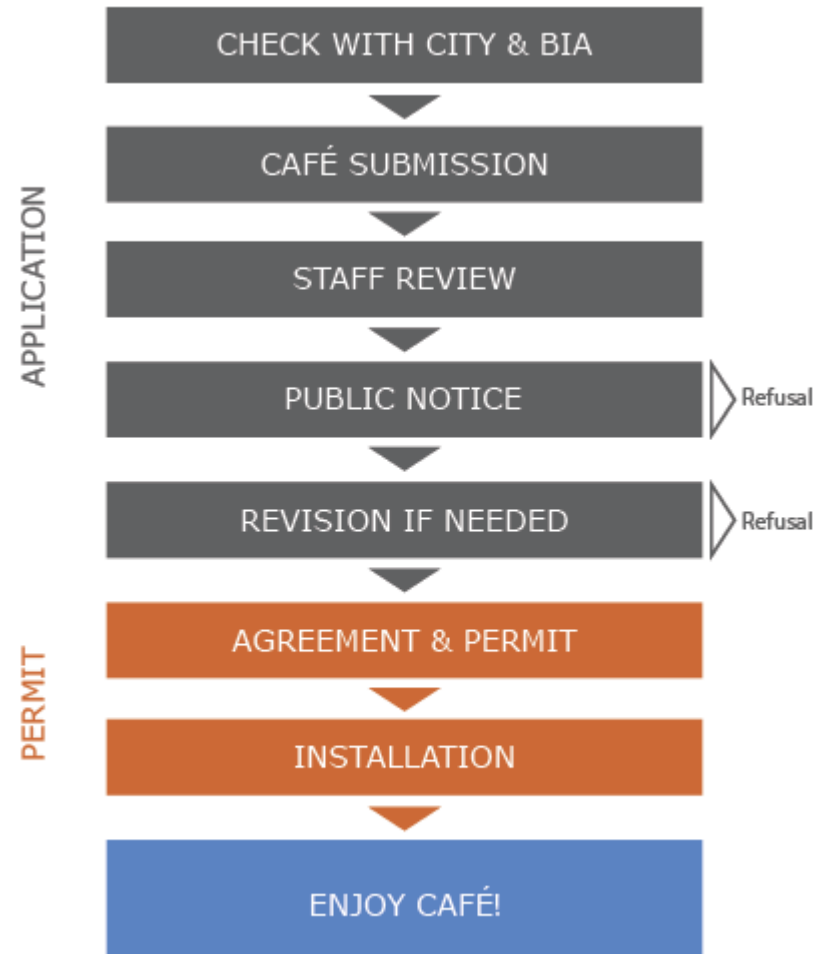

(standard application process)

Next Steps

next steps

DEVELOP A TRANSITION STRATEGY

- Transition period for compliance with minimum pedestrian clearway standards
- Identify patios with challenges and develop plans to bring them into compliance
- Target 'quick fixes' such as walkable tree pits
- Pilot projects with BIAs
- Design studies with BIAs
- Design assistance for café operators
- Road reconstruction projects

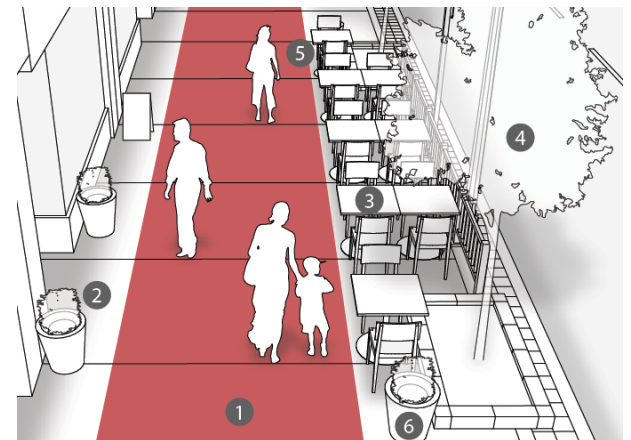
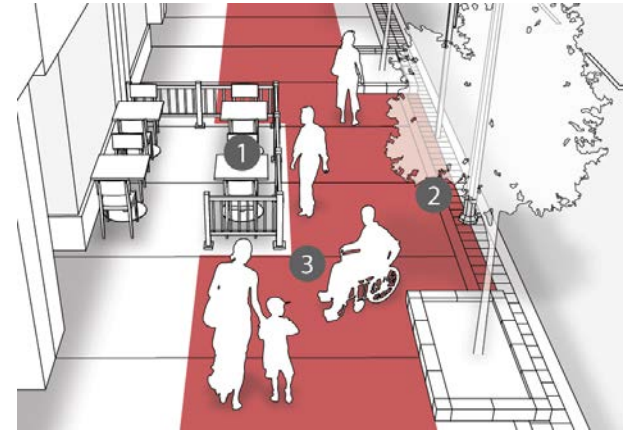

TORONTO SIDEWALK CAFÉ MANUAL

next steps

DEVELOP A PEDESTRIAN CLEARWAY TOOL

- Better understand where the pedestrian clearway should be enhanced

major, main, special and emerging main streets

+

in areas where high pedestrian volumes have been measured

+

near subway stations, along busy transit routes, on walking routes to Union Station

+

busy pedestrian commuter routes

- Consult with TOcore Study

2.1m

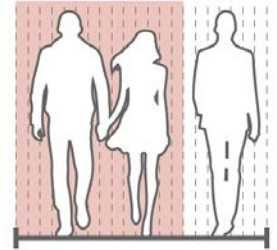

2.5m

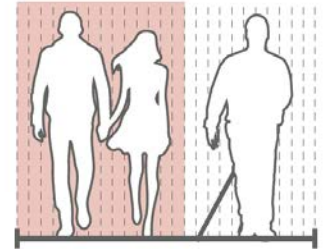

3.0m

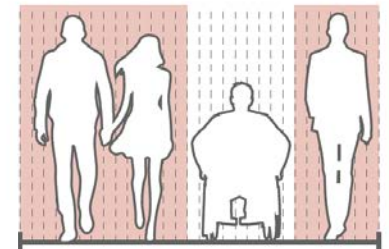

3.7m

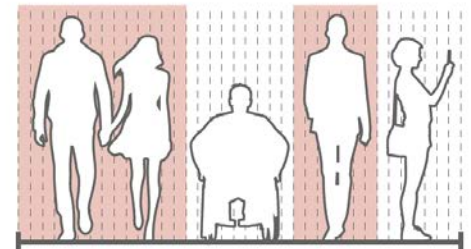

TORONTO SIDEWALK CAFÉ MANUAL

next steps

FINALIZE MANUAL

- September/October

COUNCIL REPORTING

- Public Works & Infrastructure Committee (November 12)
- Licensing & Standards Committee (November 26)
- City Council (December 06)

PROJECT REFINEMENT

- Transition strategy
- Draft pedestrian clearway tool
- Application tools

Chris Ronson

Project Manager

Public Realm Section

Transportation Services

416 392 8008

cronson@toronto.ca



Thank You.