

ANODE LEAD LOOPED AROUND PIPE AND KNOTTED PRIOR TO THERMITE WELDING TO PIPE

BOND STRAP  
NEW DUCTILE IRON WATER MAIN  
CONTROL VALVE

FIRE HYDRANT

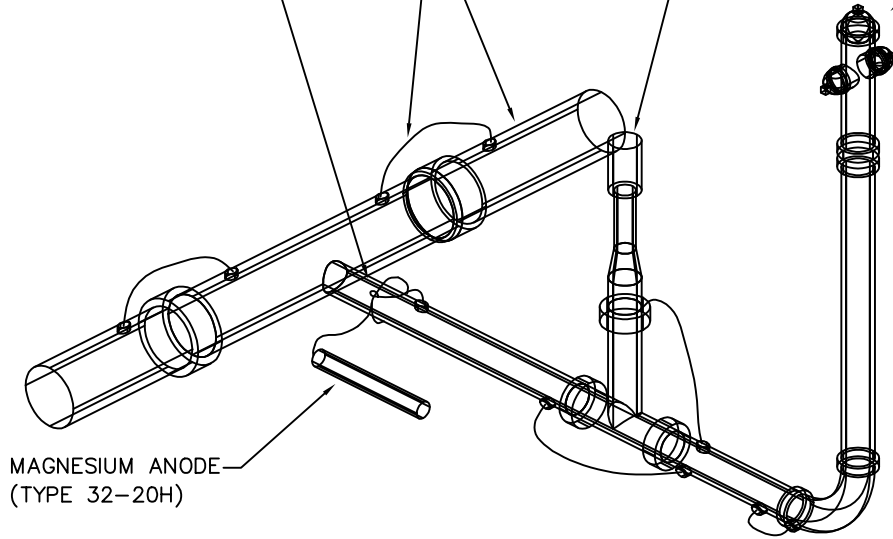

MAGNESIUM ANODE  
(TYPE 32-20H)

### ANODE CONNECTION TO HYDRANT

ANODE LEAD LOOPED AROUND PIPE AND KNOTTED PRIOR TO THERMITE WELDING TO PIPE

BOND STRAP  
NEW DUCTILE IRON WATER MAIN

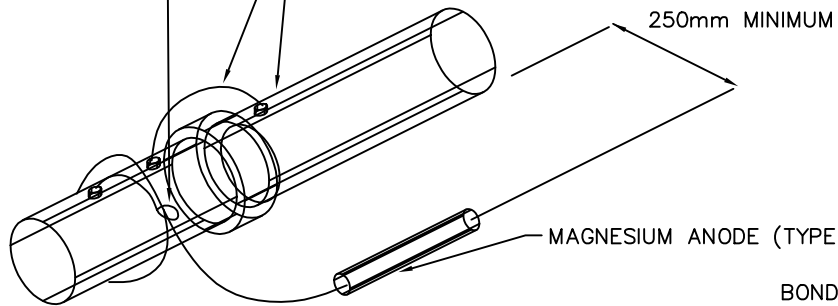

MAGNESIUM ANODE (TYPE 32-20H)

BOND STRAP IS NOT  
REQUIRED IF CONNECTION  
IS MADE TO AN EXISTING  
WATER MAIN

### ANODE CONNECTION TO WATER MAIN

ANODE SPACING FOR UNCOATED DUCTILE IRON MAINS	
DIAMETER	SPACING
100 mm	23 m
150 mm	15 m
200 mm	11 m
300 mm	8 m
400 mm	6 m

METRIC  
ALL DIMENSIONS SHOWN HERE ARE IN MILLIMETRES UNLESS OTHERWISE NOTED

APPROVED BY

*Tom Denes*  
TOM DENES, P. ENG.  
EXECUTIVE DIRECTOR TECHNICAL SERVICES

SCALE

N.T.S.



CATHODIC PROTECTION  
FOR NEW DUCTILE IRON WATER MAIN CONSTRUCTION

DATE: JUNE, 2001

REVISED:

STANDARD No.

T-1106.05