

NOTE: JOINTS SHALL BE SKEWED TO ALLOW LEFT WHEEL OF VEHICLES TO STRIKE JOINT FIRST.

PLAN

EXPANSION JOINTS TO ISOLATE THE INTERSECTION (TYPICAL)

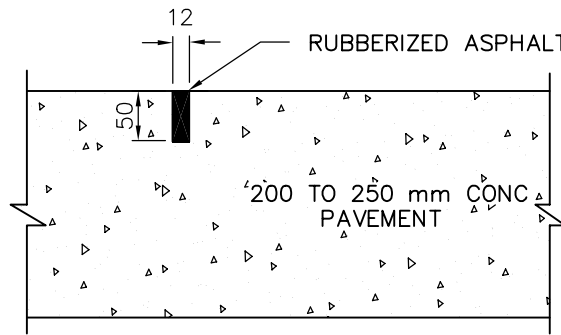

CONTRACTION JOINT

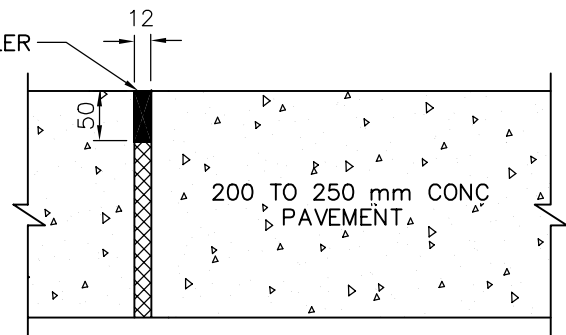

EXPANSION JOINT

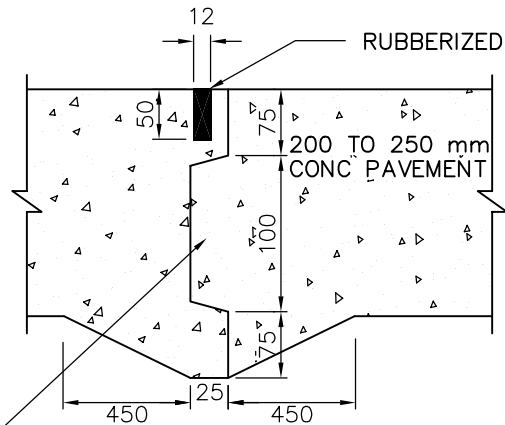

TONGUE SECTION OF JOINT SHALL BE CONSTRUCTED FIRST

CONSTRUCTION JOINT

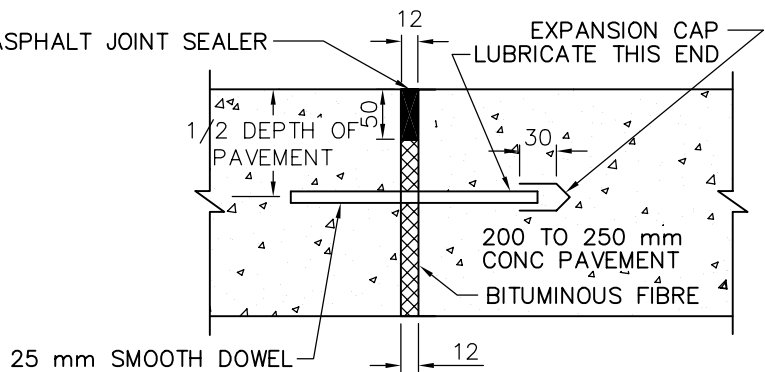

25 mm SMOOTH DOWEL
400 mm LONG,
@ 300 mm ctr.

TRANSVERSE CONTRACTION JOINT FOR ARTERIAL ROADS OR AS SPECIFIED

NOTES:

- PLACE STEEL MESH 100 x 100 @ 1.5 kg / m AROUND MANHOLES AND CATCH BASINS TO COVER AREA ENCLOSED BY 1.5 m FROM THE APPURTENANCE, AND BE CLEAR OF JOINTS BY 150 mm.
- RECONSTRUCTION SHOULD BE CARRIED FURTHER TO THE NEXT JOINT.

METRIC
ALL DIMENSIONS SHOWN HERE ARE IN MILLIMETRES UNLESS OTHERWISE NOTED



WORKS & EMERGENCY SERVICES

TECHNICAL SERVICES DIVISION
Engineering Services - Works Facilities & Structures

LOCATION AND DETAIL OF JOINTS FOR RIGID PAVEMENTS

SCALE: N.T.S.

DATE: DECEMBER, 2003

DRAFTING: V. DIDIANO

DRAWING NUMBER:

T-216.02-3

SHEET: 1