

Trees to be removed

Tree No	Tree Species		Condition	Diameter (cm)
400	ACER PLATANOIDES	Norway Maple	ModHigh	36
399	TILIA CORDATA	Littleleaf Linden	Moderate	72

Trees to be preserved (if possible)

Tree No	Tree Species		Condition	Diameter (cm)
393	ACER PLATANOIDES	Norway Maple	ModHigh	42
394	ACER PLATANOIDES	Norway Maple	Moderate	68
5196	GLEDITSIA TRIACANTHOS VAR INERMIS	Smooth Honeylocust	High	66

Trees not Impacted

Tree No	Tree Species		Conditions	Diameter (cm)
388	GINKGO BILOBA	Ginkgo	ModHigh	10
389	AMELANCHIER LAEVIS	Smooth Serviceberry	ModHigh	10
390	ULMUS SP	Elm	ModHigh	12
391	ACER PLATANOIDES	Norway Maple	ModHigh	48
392	ACER PLATANOIDES	Norway Maple	ModHigh	43
395	AMELANCHIER LAEVIS	Smooth Serviceberry	ModHigh	8
396	ACER SACCHARUM SSP SACCHARUM	Sugar Maple	Moderate	40
397	TILIA CORDATA	Littleleaf Linden	High	71
398	SYRINGA RETICULATA IVORY SILK	Japanese Tree Lilac	ModHigh	24
5197	ACER PLATANOIDES	Norway Maple	ModHigh	6
5198	BETULA PAPYRIFERA	Paper Birch	Moderate	28
5199	PICEA OMORIKA	Serbian Spruce	ModHigh	7
5200	GLEDITSIA TRIACANTHOS VAR INERMIS	Smooth Honeylocust	High	60
5201	GLEDITSIA TRIACANTHOS VAR INERMIS	Smooth Honeylocust	High	52
5202	GLEDITSIA TRIACANTHOS VAR INERMIS	Smooth Honeylocust	High	50
5203	GLEDITSIA TRIACANTHOS VAR INERMIS	Smooth Honeylocust	ModHigh	40

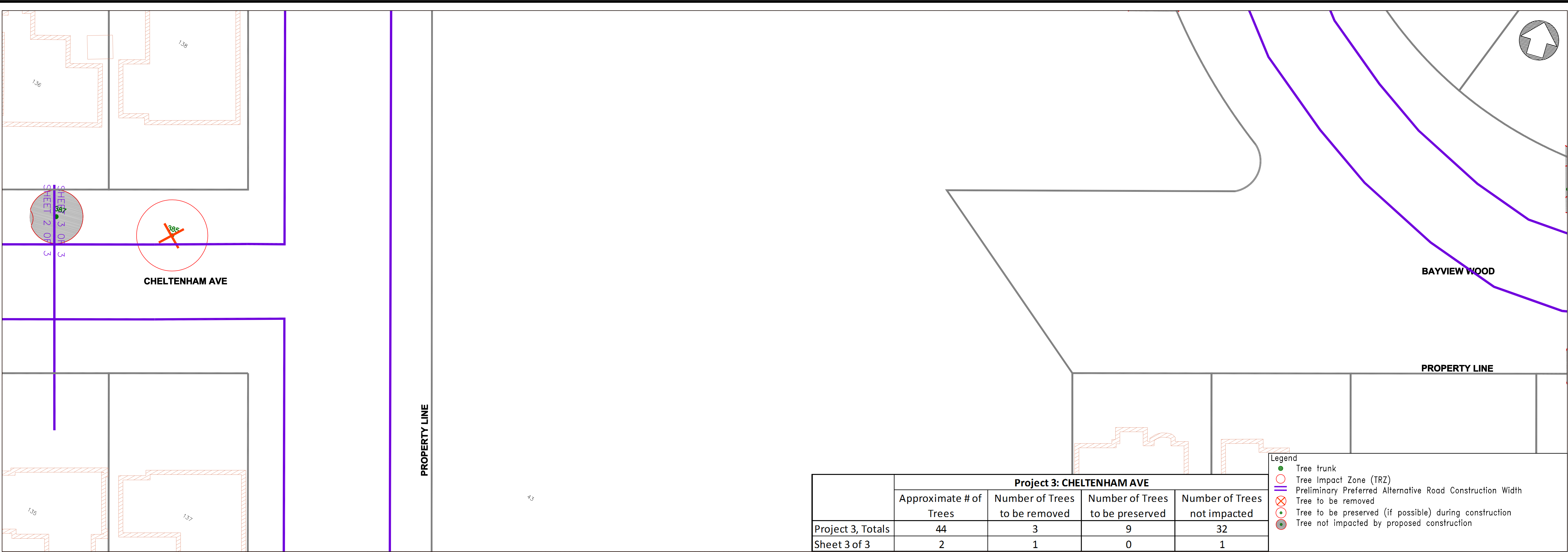

Trees to be removed



Tree No	Tree Species		Condition	Diameter (cm)
385	TILIA CORDATA	Littleleaf Linden	Moderate	60

Trees to be preserved (if possible)

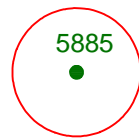

Tree No	Tree Species		Condition	Diameter (cm)
---	---	---	---	---

Trees not Impacted



Tree No	Tree Species		Conditions	Diameter (cm)
387	PRUNUS AVIUM	Wild Cherry	ModHigh	47