

UNRESTRAINED - LOW RISK

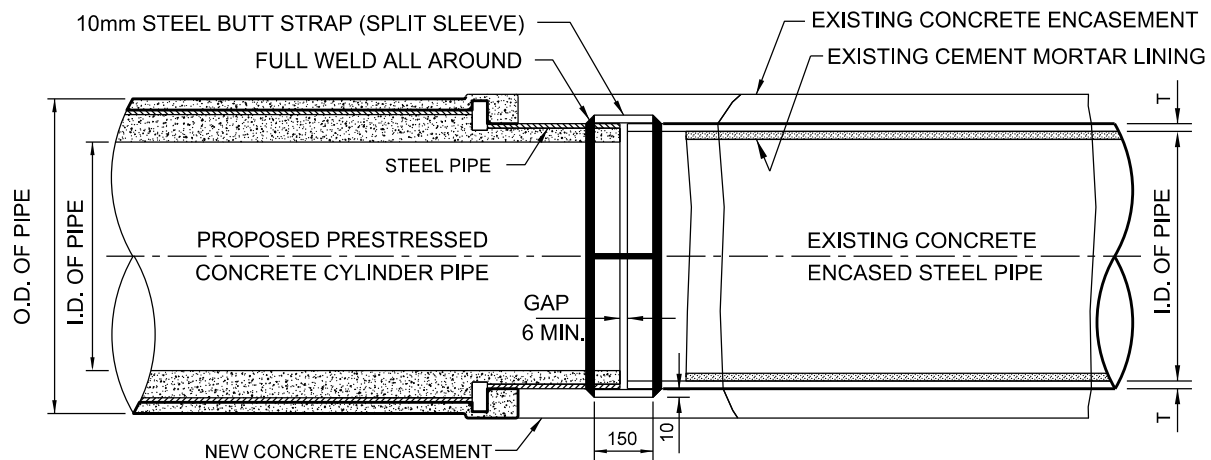

RESTRAINED - MEDIUM AND HIGH RISK

NOTES:

1. SUPPLY STEEL BUTT STRAP (SPLIT SLEEVE TYPE) FOR RESTRAINED CONNECTION.
2. SUPPLY CLOSURE COUPLING WITH GASKETS FOR UNRESTRAINED CONNECTION.
3. FIELD VERIFY O.D. EXISTING STEEL PIPE PRIOR TO ORDERING CONNECTION COUPLING.
4. CUT AND REMOVE THE REQUIRED SECTION OF THE EXISTING WATERMAIN AND TRIM BACK THE INTERIOR CEMENT MORTAR LINING A DISTANCE OF 150mm AND THE EXTERIOR ENCASEMENT AS REQUIRED.
5. INSTALL NEW CONCRETE ENCASED STEEL WATERMAIN AS PER DETAILS.
6. REBEVEL ENDS OF STEEL PIPES AS REQUIRED.
7. WELD ALL JOINTS USING STEEL BUTT STRAPS (FULL CIRCUMFERENTIAL) FOR RESTRAINED CONNECTION
8. INSTALL CLOSURE COUPLING FOR UNRESTRAINED CONNECTION.
9. PATCH LINING AT POINTS OF CONNECTION AND CLEAN AND REMOVE ANY DEBRIS.
10. REPLACE CONCRETE ENCASEMENT.
11. THIS DRAWING IS APPLICABLE TO LARGE DIAMETER WATERMAINS SIZES 750 TO 2300 mm DIA.

All dimensions are in millimetres unless otherwise shown.



ENGINEERING & CONSTRUCTION SERVICES STANDARD DRAWING

**PROPOSED PRESTRESSED CONCRETE
CYLINDER PIPE CONNECTION TO
EXISTING CONCRETE ENCASED STEEL PIPE**

REV 0 SEP 2017

T-1110.03-20

NTS SHEET 1