

WHERE HOUSE CONNECTIONS OR CATCH BASIN LEADS CROSS A SEWER TRENCH, THEY WILL BE SUPPORTED ON A NEW 100 mm x 200 mm TIMBER WHICH HAS A MINIMUM BEARING OF 1000 mm AT EACH END, ON UNDISTURBED GROUND. CONNECTION MUST BE PROPERLY SHIMMED. SEE DETAIL ABOVE - OR BEDDED ON 15 MPa CONCRETE FILL, TO SPRINGLINE, AS PER DETAIL BELOW.

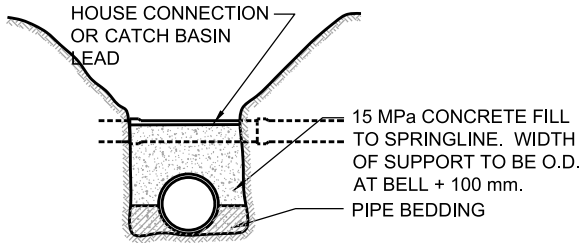

SUPPORT FOR CONNECTION CROSSING TRENCH

* WHEN WIDTH OF TRENCH IS LESS THAN 1500 mm

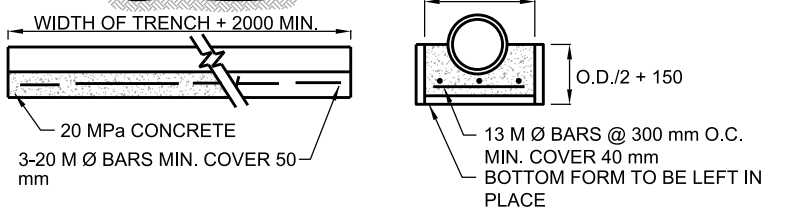
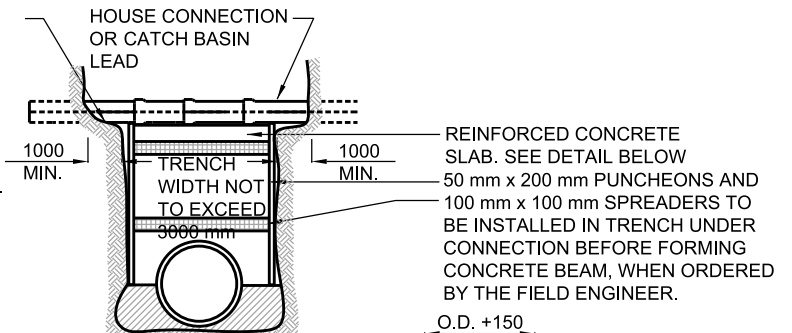

REINFORCED CONCRETE SUPPORT FOR HOUSE CONNECTIONS AND CATCH BASIN LEADS

WHEN WIDTH OF TRENCH EXCEEDS 1500 BUT LESS THAN 3000 mm

NOTE:

WHEN WIDTH OF TRENCH EXCEEDS 3000 mm, METHOD OF SUPPORTING HOUSE CONNECTIONS AND CATCH BASIN LEADS, WILL BE AS DIRECTED BY THE FIELD ENGINEER.

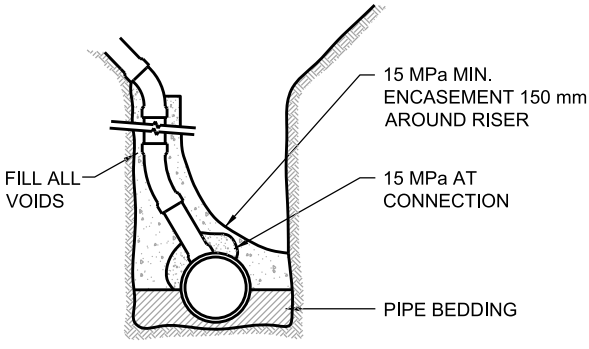

RISER DETAIL

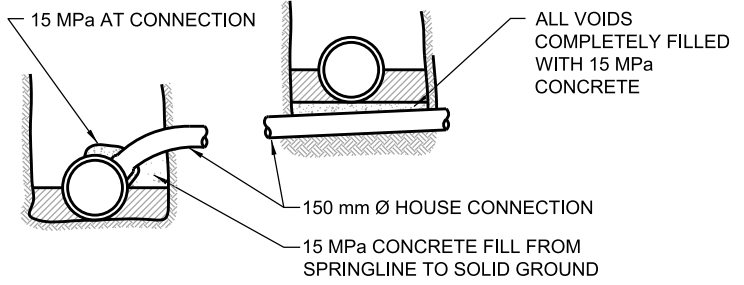

150 mm Ø CONNECTION CROSSING UNDER SEWER AND CONNECTED TO MAIN

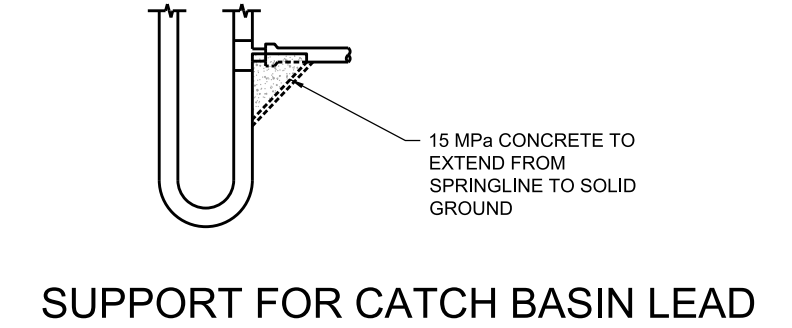
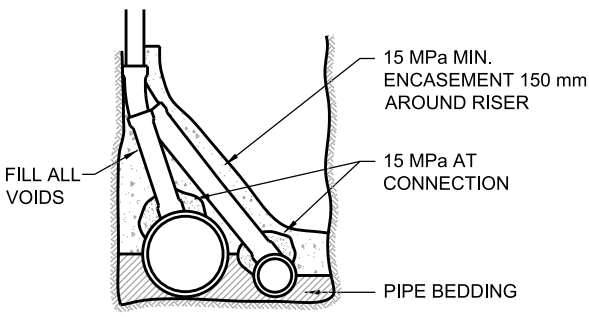

SUPPORT FOR CATCH BASIN LEAD

All dimensions are in millimetres unless otherwise shown.



ENGINEERING AND CONSTRUCTION SERVICES STANDARD DRAWING

TYPICAL METHODS OF SUPPORTING HOUSE CONNECTIONS AND CATCH BASIN LEADS

REV 1 APR 2013

T-708-01-3

NTS SHEET 1