

\* IF PROXIMITY OF FULL DEPTH REPAIR TO EXISTING JOINT OR CRACK IS 2.0 m OR LESS, EXTEND CONCRETE REPLACEMENT TO 300 mm BEYOND JOINT OR CRACK.

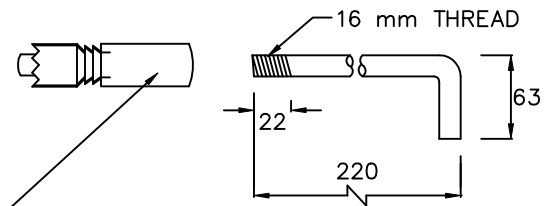
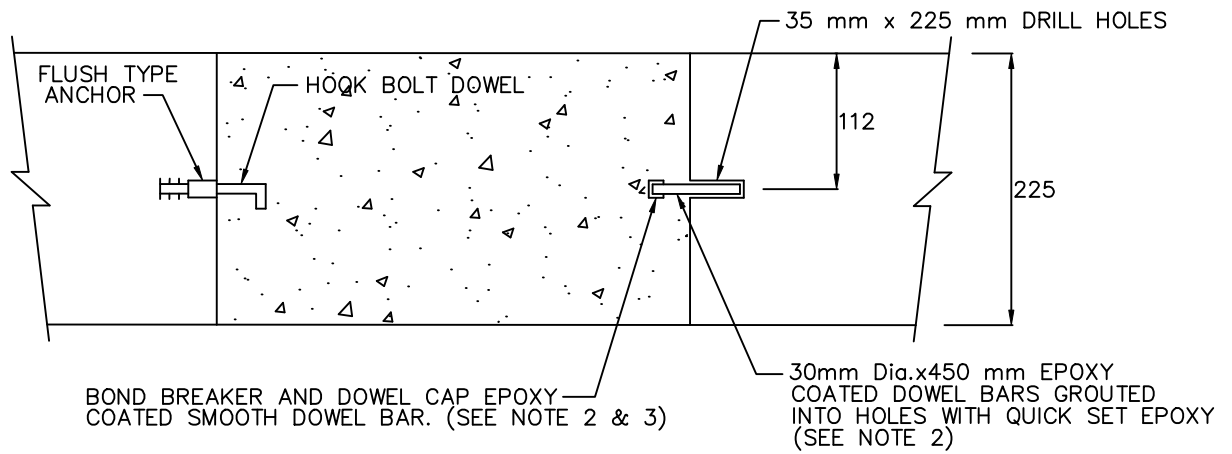

NOTES

1. JOINT SPACING TO MATCH EXISTING.
2. THE GROUT SHALL ENVELOP THE BAR WITHIN THE DRILL HOLE. THE GROUT SHALL BE FULLY SET PRIOR TO POURING THE NEW CONCRETE.
3. THE FREE END OF THE DOWEL BARS SHALL RECEIVE A THIN AND UNIFORM COATING OF GREASE (BOND BREAKER) AND A DOWEL CAP IMMEDIATELY PRIOR TO POURING NEW CONCRETE.

METRIC  
ALL DIMENSIONS SHOWN HERE ARE IN MILLIMETRES UNLESS OTHERWISE NOTED

APPROVED BY  
*Tom Denes*  
TOM DENES, P. ENG.  
EXECUTIVE DIRECTOR TECHNICAL SERVICES

SCALE  
N.T.S.

DATE: JUNE, 2001

REVISED:

STANDARD No.

T-508.010-1



ANCHORED HOOK BOLT DOWEL  
AND CONCRETE REPAIR DETAIL